



USB Charging Kit

Groundsmaster® 3200 or 3300 Series Traction Unit

Model No. 31984

Installation Instructions

Installation

1

Preparing the Machine

No Parts Required

Procedure

1. Park the machine on a level surface.
2. Engage the parking brake.
3. Lower the cutting unit.
4. Shut off the engine and remove the key.
5. Disconnect the battery; refer to the electrical system maintenance section of your *Operator's Manual*.

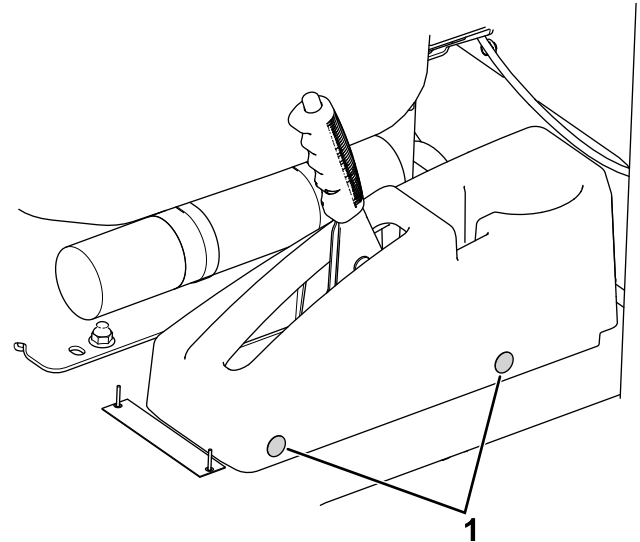

Figure 1

g301501

1. Plugs (4 total—2 shown)

2. Remove the parking-brake cover from the machine.
3. Drill a hole (3 cm or 1-3/16 inches) into the front of the cover as shown in [Figure 2](#)

2

Installing the Kit

Parts needed for this procedure:

1	USB port
4	Plug

Procedure

1. Remove the existing plugs ([Figure 1](#)) from both sides of the parking-brake cover.



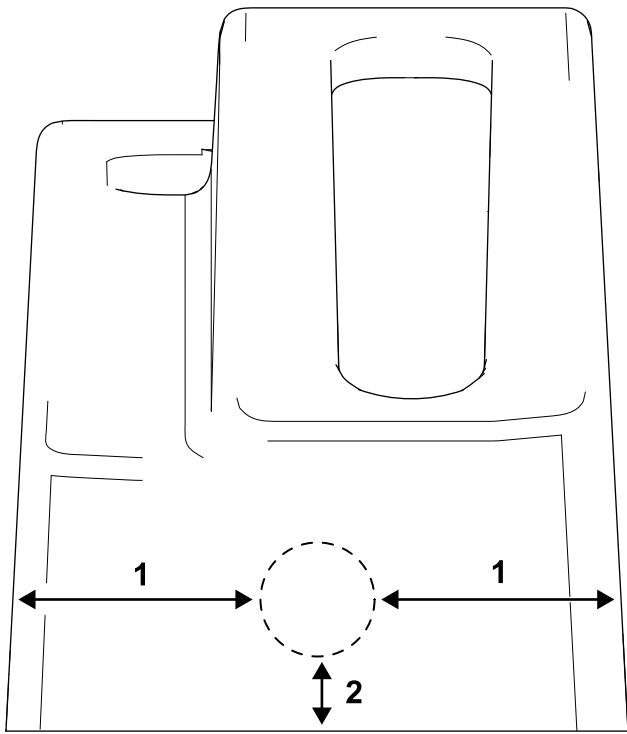

Figure 2

g301502

1. 6.8 cm (2.7 in)
2. 2.5 cm (1 in)

4. Remove the jam nut from the USB port.
5. Use the previously-removed jam nut to secure the USB port to the parking-brake cover ([Figure 3](#)).

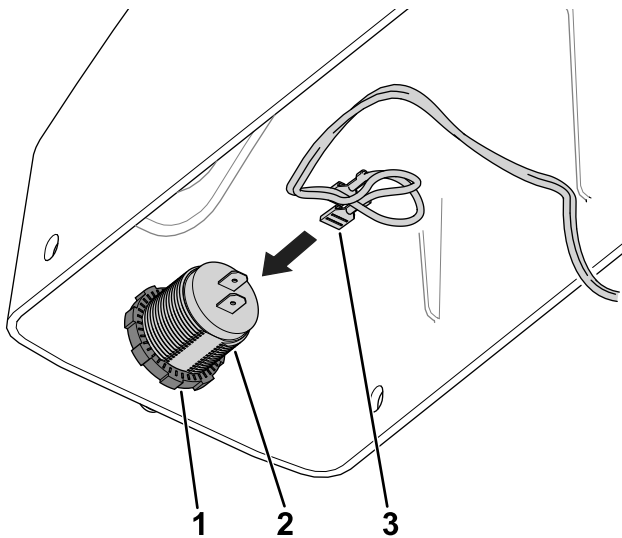

Figure 3

g302384

1. Jam nut
2. USB port
3. Wire-harness end

6. Connect the wire-harness end labeled USB PORT to the USB port ([Figure 3](#)).

Note: The wire-harness end is located near the base of the parking-brake lever.

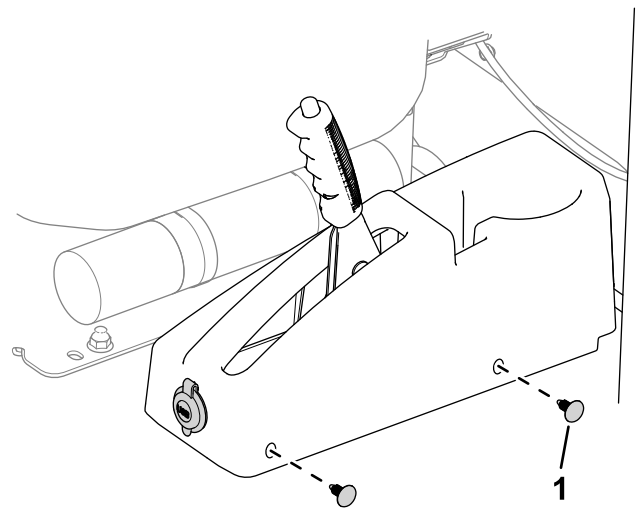

Figure 4

g301500

1. Plug (4)

7. Use 4 plugs to secure the parking-brake cover to the machine ([Figure 4](#)).

3

Connecting the Battery

No Parts Required

Procedure

Connect the battery; refer to the electrical system maintenance section of your *Operator's Manual*.