



# Switch Panel

## Groundsmaster® and Reelmaster® Traction Units with Universal Sunshade

Model No. 03248

### Installation Instructions

# Installation

## Loose Parts

Use the chart below to verify that all parts have been shipped.

Procedure	Description	Qty.	Use
<b>1</b>	No parts required	–	Prepare the machine.
<b>2</b>	No parts required	–	Remove the sunshade.
<b>3</b>	Decal Switch panel	1 1	Prepare the switch panel.
<b>4</b>	Fuse-block mount Wire harness Socket-head screw (#10 x 3/4 inch) Flange locknut (#10) Carriage bolt (#10 x 1/2 inch)	1 1 2 4 2	Assemble the wire harness to the switch panel.
<b>5</b>	Carriage bolt (#10 x 1/2 inch) Flange locknut (#10) Cable tie	4 4 6	Installing the switch panel to the sunshade frame.
<b>6</b>	No parts required	–	Install the sunshade.
<b>7</b>	No parts required	–	Connect the wire harness.
<b>8</b>	No parts required	–	Connect the battery.



# 1

## Preparing the Machine

No Parts Required

### Procedure

1. Park the machine on a level surface.
2. Shut off the engine, engage the parking brake, and remove the key from the ignition switch.
3. Disconnect the battery; refer to the electrical system maintenance section of your *Operator's Manual*.

# 2

## Removing the Sunshade

No Parts Required

### Procedure

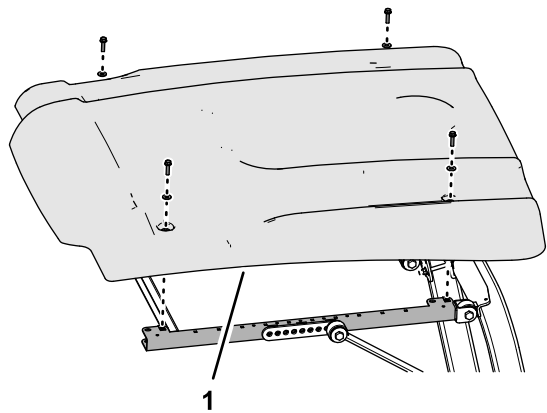

Figure 1

g244329

1. Sunshade

1. Remove the 4 flange-head bolts (5/16 x 1-1/4 inches) and 4 washers (5/16 inch) that secure the sunshade to the side-frame channels (Figure 1 and Figure 2).

**Note:** Do not remove the grommets from the sunshade.

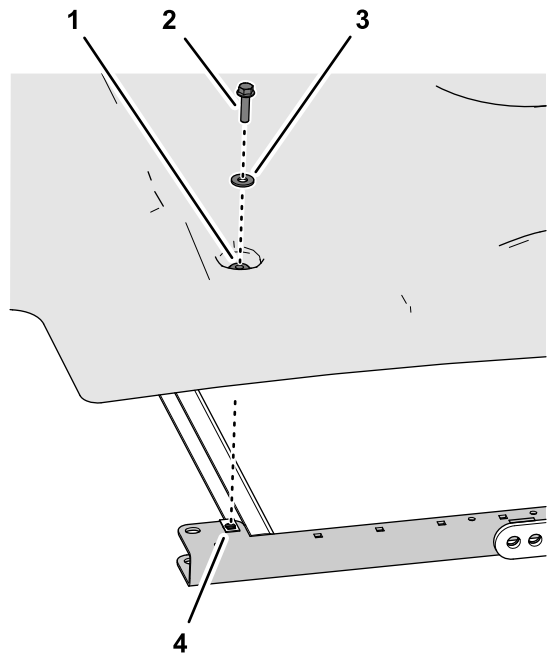

Figure 2

g244328

1. Grommet
2. Flange-head bolt (5/16 x 1-1/4 inches)
3. Washer (5/16 inch)
4. Clip nut (side-frame channel)

2. Remove the sunshade from the machine (Figure 1).

# 3

## Preparing the Switch Panel

Parts needed for this procedure:

1	Decal
1	Switch panel

### Installing the Decal to the Switch Panel

1. Carefully remove the backing from the decal (Figure 3).

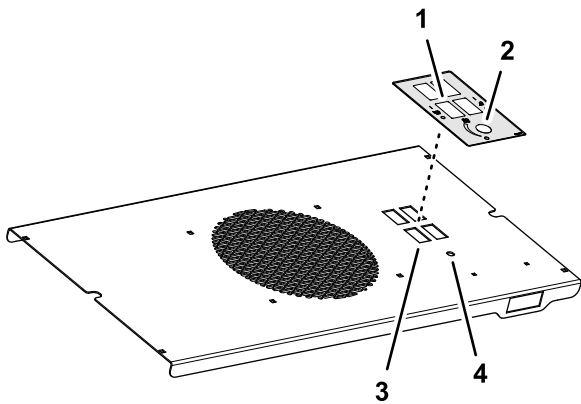

**Figure 3**

g245155

1. Rectangular opening (decal)
2. Hole (decal)
3. Rectangular opening (switch panel)
4. Hole (switch panel)

2. Align the rectangular openings and hole in the decal with the rectangular openings and hole in the switch panel as shown in [Figure 3](#).
3. Apply the decal to the switch panel.

## Installing the Plugs to the Switch Panel

1. Align the plug to the rectangular openings in the switch panel ([Figure 4](#)).

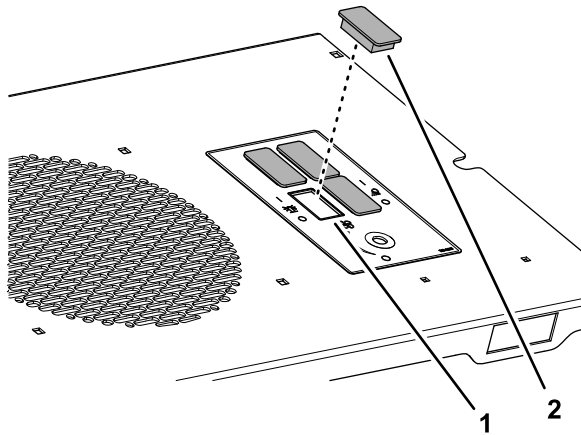

**Figure 4**

g245156

1. Rectangular opening (switch panel)
2. Plug

2. Insert the plug into the opening until the plug snaps securely into the panel ([Figure 4](#)).
3. Repeat step 1 and 2 for the 3 other plugs ([Figure 4](#)).

# 4

## Assembling the Wire Harness to the Switch Panel

Parts needed for this procedure:

1	Fuse-block mount
1	Wire harness
2	Socket-head screw (#10 x 3/4 inch)
4	Flange locknut (#10)
2	Carriage bolt (#10 x 1/2 inch)

## Assembling the Fuse-Block Mount to the Wire Harness

1. Align the holes in the fuse-block mount to the holes in the fuse block of the wire harness as shown in [Figure 5](#).

**Note:** Ensure that the mounting rails of the fuse block are aligned up.

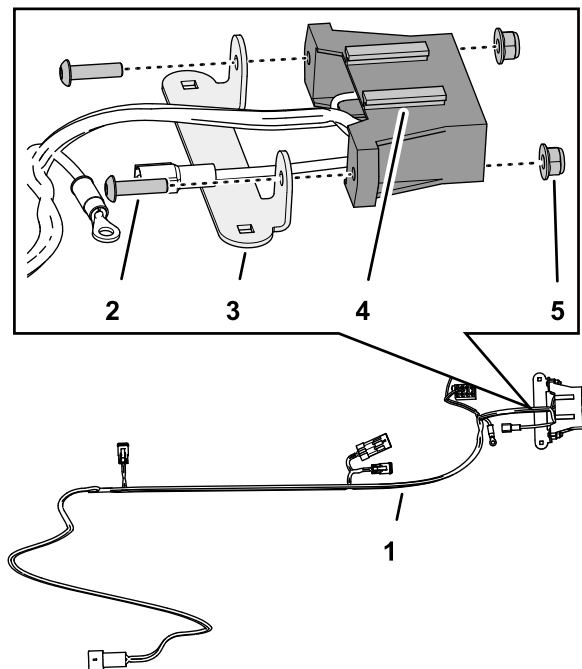

**Figure 5**

g250867

1. Wire harness
2. Socket-head screw (#10 x 3/4 inch)
3. Fuse-block mount
4. Fuse block (mounting rails up)
5. Flange locknut (#10)

2. Assemble the fuse-block mount to the fuse block (Figure 5) with the 2 socket-head screws (#10 x 3/4 inch) and 2 flange locknuts (#10).
3. Torque the socket-head screws and flange-locknuts to 419 to 513 N·cm (37 to 47 in-lb).

## Assembling the Wire Harness to the Switch Panel

1. Align the wire harness to the switch panel (Figure 6).

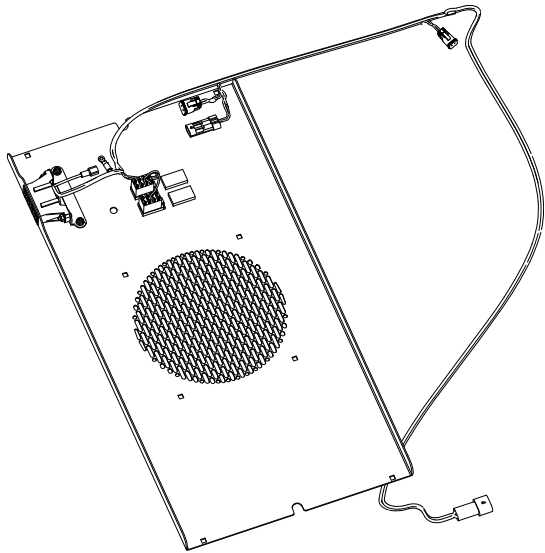
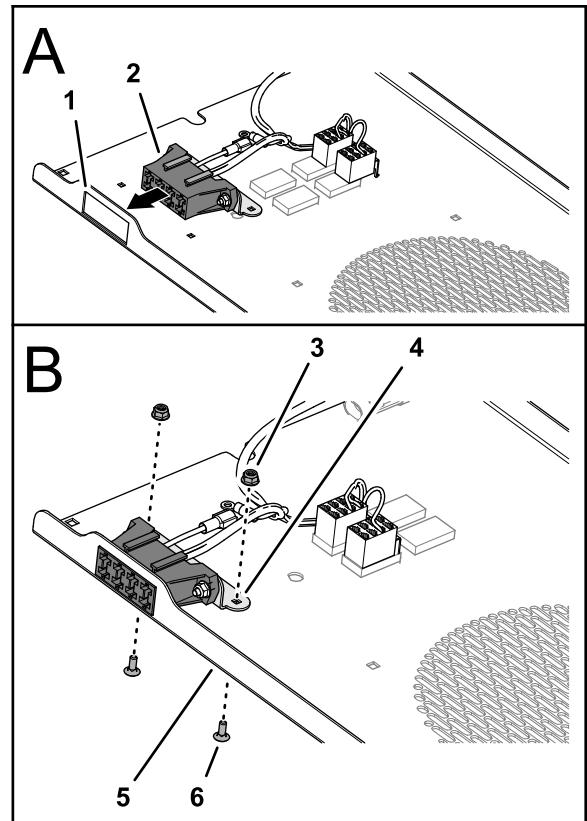

Figure 6

g250868



g245152

Figure 7

2. Align the mounting rails of the fuse block up and insert the fuse block into the rectangular opening in the switch panel as shown in Figure 7.

- |                                       |                                   |
|---------------------------------------|-----------------------------------|
| 1. Rectangular opening (switch panel) | 4. Fuse-block mount               |
| 2. Fuse block (mounting rails up)     | 5. Switch panel                   |
| 3. Flange locknut (#10)               | 6. Carriage bolt (#10 x 1/2 inch) |

3. Align the square holes in the fuse-block mount with the square holes in the switch panel (Figure 7).
4. Assemble the fuse-block mount to the switch panel (Figure 7) with the 4 carriage bolts (#10 x 1/2 inch) and 4 flange locknut (#10).
5. Torque the flange-locknuts to 419 to 513 N·cm (37 to 47 in-lb).

# 5

## Installing the Switch Panel to the Sunshade Frame

Parts needed for this procedure:

4	Carriage bolt (#10 x 1/2 inch)
4	Flange locknut (#10)
6	Cable tie

### Assembling the Switch Panel to the Sunshade Frame

1. Align the square holes in the switch panel with the square holes in the 2 side-frame channels of the sunshade as shown in [Figure 8](#).

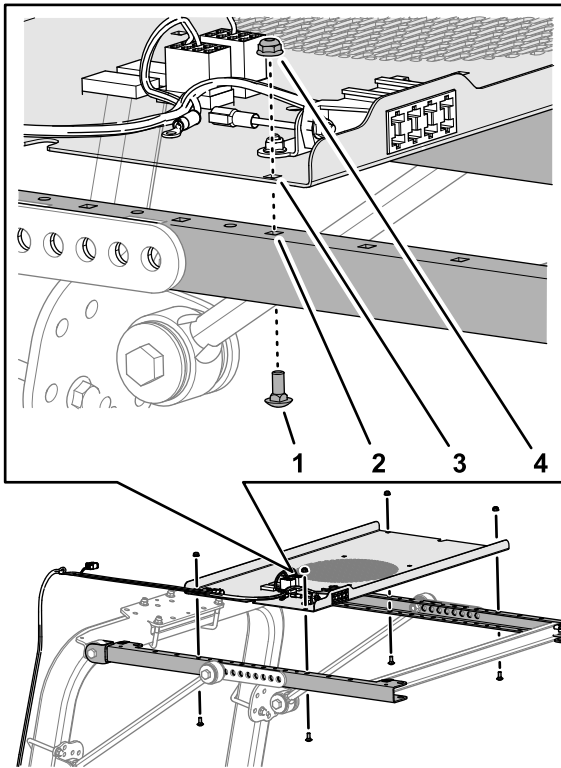

Figure 8

g245153

1. Carriage bolt (#10 x 1/2 inch)
2. Square hole (side-frame channel)
3. Square hole (switch panel)
4. Flange locknut (#10)

2. Assemble the switch panel to the side-frame channels ([Figure 8](#)) with the 4 carriage bolts (#10 x 1/2 inch) and 4 flange locknut (#10).

3. Torque the flange-locknuts to 419 to 513 N-cm (37 to 47 in-lb).

## Routing the Wire Harness

1. Route the wire harness of the switch panel kit along the roll-bar tube as shown in [Figure 9](#).

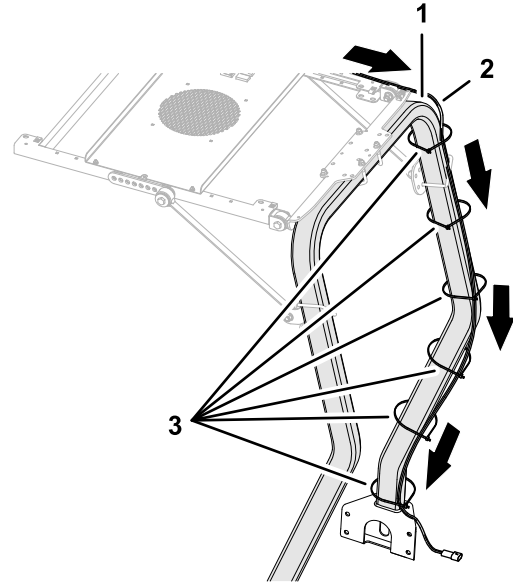

Figure 9

g245157

1. Roll-bar tube
2. Kit wire harness

3. Cable ties

2. Secure the wire harness to the roll-bar tube with the cable ties as needed ([Figure 9](#)).

# 6

## Installing the Sunshade

No Parts Required

### Procedure

1. Align the holes in the grommets of the sunshade with the 4 clipnuts of the side-frame channels.
2. Assemble the sunshade to the frame channels ([Figure 10](#)) with the 4 flange-head bolts (5/16 x 1-1/4 inches) and 4 washers (5/16 inch) that you removed in [2 Removing the Sunshade \(page 2\)](#).

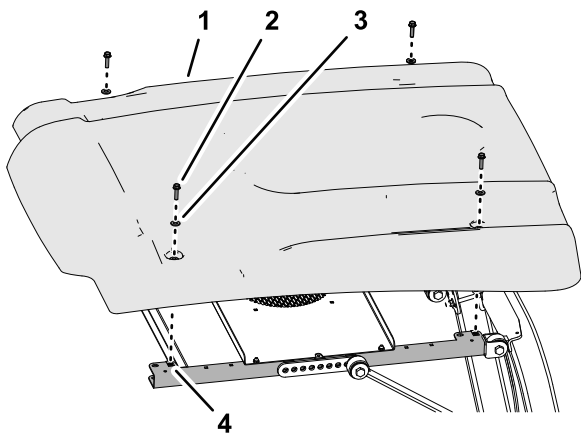

**Figure 10**

g245179

- |   |                                  |
|---|----------------------------------|
| 1. Sunshade                               | 3. Washer (5/16 inch)            |
| 2. Flange-head bolt (5/16 x 1-1/4 inches) | 4. Clip nut (side-frame channel) |

3. Torque the flange-head bolts to 1017 to 1355 N-cm (90 to 120 in-lb).

# 7

## Connecting the Wire Harness

No Parts Required

### Connecting the Wire Harness to the Chassis Harness

Groundsmaster 4000 Series or Groundsmaster 5900 Machines

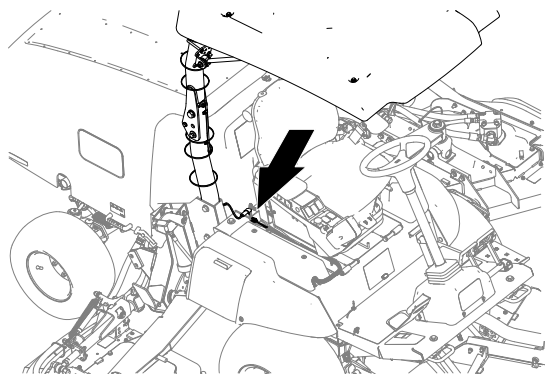

**Figure 11**

Groundsmaster 4000 Series Machines

g246394

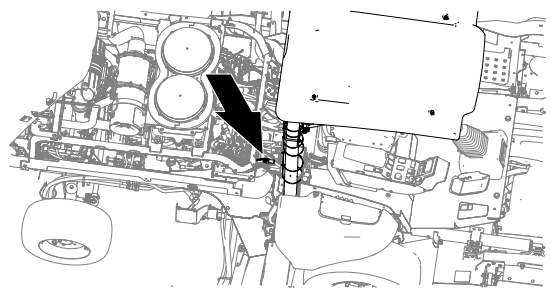
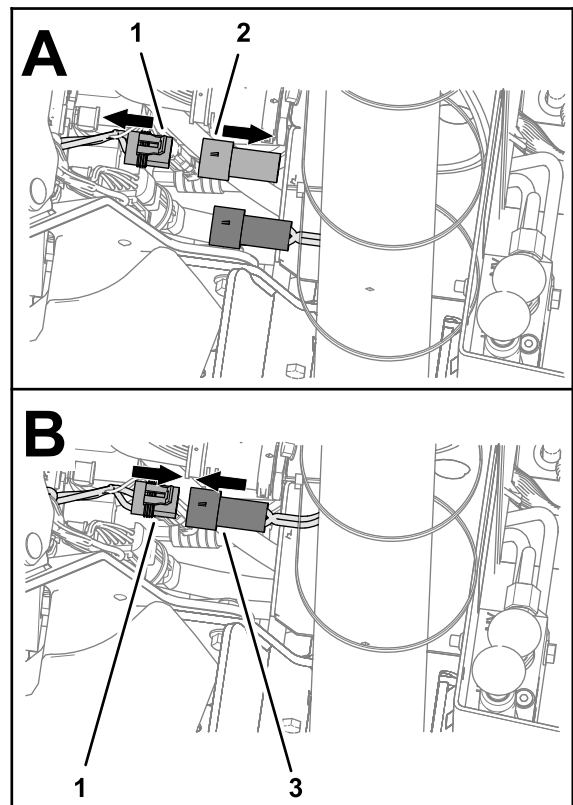

**Figure 12**

Groundsmaster 5900 Machines

g246397

1. For Groundsmaster 5900 machines, raise the hood; refer to the *Operator's Manual* for your machine.
2. If installed, remove the cap from the 2-socket connector of the machine wire harness ([Figure 13](#)).



**Figure 13**

Groundsmaster 5900 Machines

g246396

- |  |                                       |
|--|---------------------------------------|
| 1. 2-socket connector (machine wire harness) | 3. 2-pin connector (kit wire harness) |
| 2. Cap                                       |                                       |

3. Connect the 2-pin connector of the wire harness of the kit to the 2-socket connector of the machine wire harness ([Figure 13](#) or [Figure 14](#)).

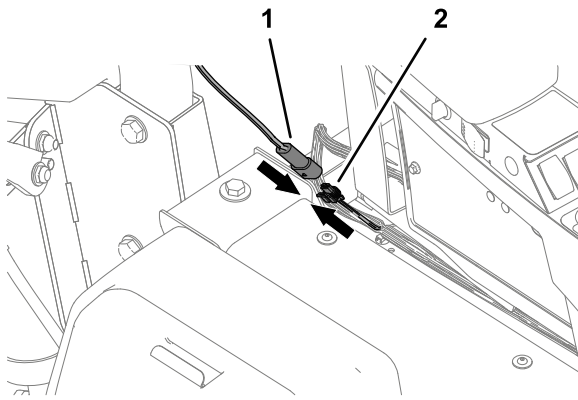

g246395

**Figure 14**

Groundmaster 4000 Series Machines

1. 2-pin connector (kit wire harness)
2. 2-socket connector (machine wire harness)

- 
4. For Groundmaster 5900 machines, lower the hood; refer to the *Operator's Manual* for your machine.

## Connecting the Wire Harness to the Optional Power Harness Kit

**Groundmaster 360, Groundmaster 3000 Series, Groundmaster 4500 Series and 4700 Series, Groundmaster 7200 Series; Reelmaster 3000 Series and 5000 Series, and Reelmaster 7000 Machines**

Connect the 2-pin connector of the wire harness of the kit to the 2-socket connector of the optional power harness; refer to the *Installation Instructions* for the power harness kit.

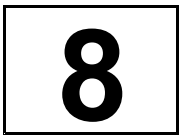

## Connecting the Battery

**No Parts Required**

### Procedure

Connect the battery; refer to the electrical system maintenance section of your *Operator's Manual*.



**Count on it.**