



# Cargo Bed Installation Kit with Manual Dump

## 2010 and Before Workman® MD Series Utility Vehicle

Model No. 131-3457

### Installation Instructions

---

# Installation

## 1

## Preparing the Machine

No Parts Required

### Procedure

1. Park the machine on a level surface.
2. Engage the parking brake.
3. Shut off the engine and remove the key.
4. Completely unload the cargo bed.
5. Ensure that the tailgate is closed.
6. Set the new cargo bed upside down on the ground next to the machine.

**Note:** Protect the cargo bed by placing cardboard or a tarp between the bed and the ground.



# 2

## Removing the Cargo Bed

No Parts Required

### Procedure

**Cargo bed weight:** approximately 57 kg (126 lb)

1. Lift the latch lever that is at the either side near the forward corner of the cargo bed, and fully raise the bed up (Figure 1).

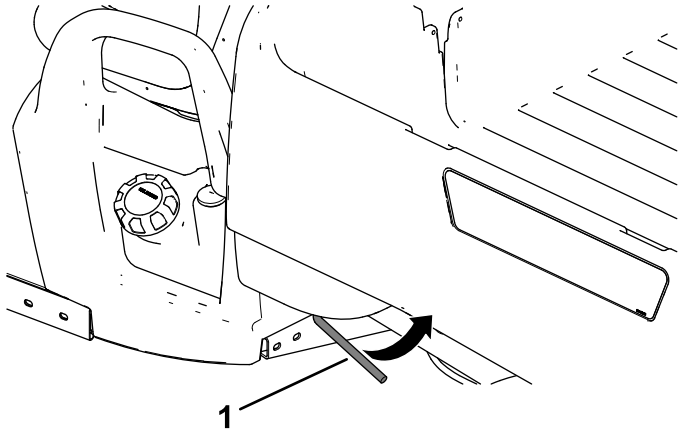

Figure 1

1. Latch lever

2. Secure the cargo bed by pulling the prop rod into the rear detent at end of the slot that is in the left frame of the machine (Figure 2).

**Note:** For machines with a bolt on rod-support bracket, pull the prop rod into the rear detent at the end of the slot in the bracket.

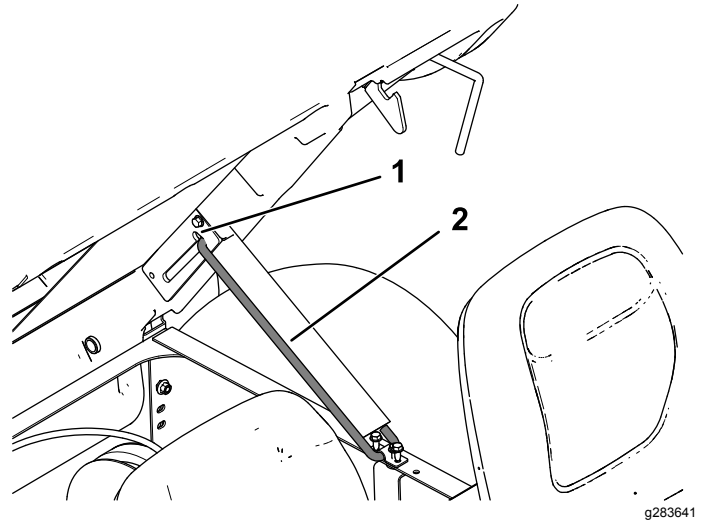

Figure 2

1. Detent slot
2. Prop rod

3. Attach the lifting equipment to the front and back ends of the cargo bed.

**Note:** Raise the lifting equipment at the front end of the bed until the front of the bed is supported.

4. Remove the 2 flange-head bolts (5/16 x 3/4 inch) and 2 serrated nuts (5/16) that secure the prop-rod bracket and the upper end of the prop rod to the bed (Figure 3).

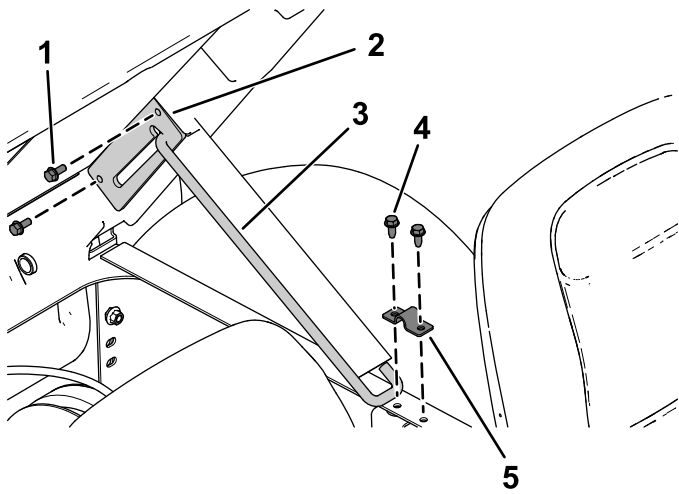
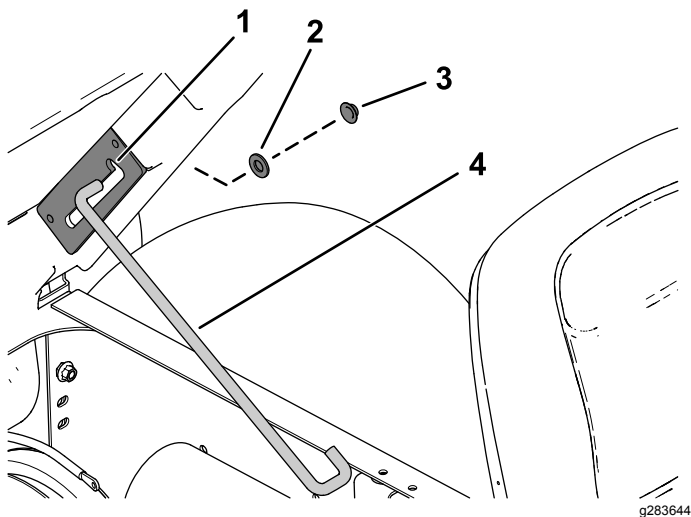

**Figure 3**

- |                                       |  |
|---------------------------------------|--|
| 1. Flange-head bolt (5/16 x 3/4 inch) | 4. Hex washer-head screw (5/16 x 3/4 inch) |
| 2. Upper prop-rod bracket             | 5. Lower prop-rod bracket                  |
| 3. Prop rod                           |  |

5. Remove the 2 hex washer-head screws (5/16 x 3/4 inch) and lower prop-rod bracket that secure the lower end of the prop rod to the bed (Figure 3).
6. Remove the prop rod through the key hole at the forward end of the slot for the prop rod (Figure 4).

**Note:** Discard the old prop rod, washer (1/2 inch), and push nut.

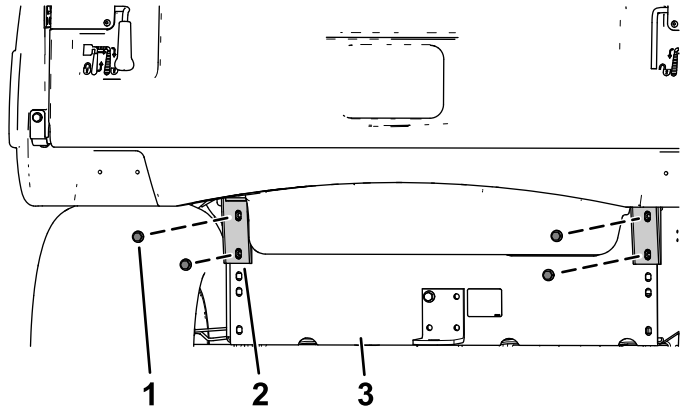

**Figure 4**

- |                      |             |
|----------------------|-------------|
| 1. Key hole          | 3. Push nut |
| 2. Washer (1/2 inch) | 4. Prop rod |

7. Lower the front of the bed.
8. Remove the 4 flanged-head bolts (3/8 x 1 inch) that secure the hinge brackets of the cargo bed to the rear frame channel of the machine (Figure 5).

**Note:** Retain the flanged-head bolts for installation of the new cargo bed.



**Figure 5**

- |                                      |                       |
|--------------------------------------|-----------------------|
| 1. Flanged-head bolts (3/8 x 1 inch) | 3. Rear frame channel |
| 2. Hinge bracket                     |                       |

9. Lift the latch lever of the cargo bed (Figure 1).
10. Lift the cargo bed up and off the machine (Figure 6).

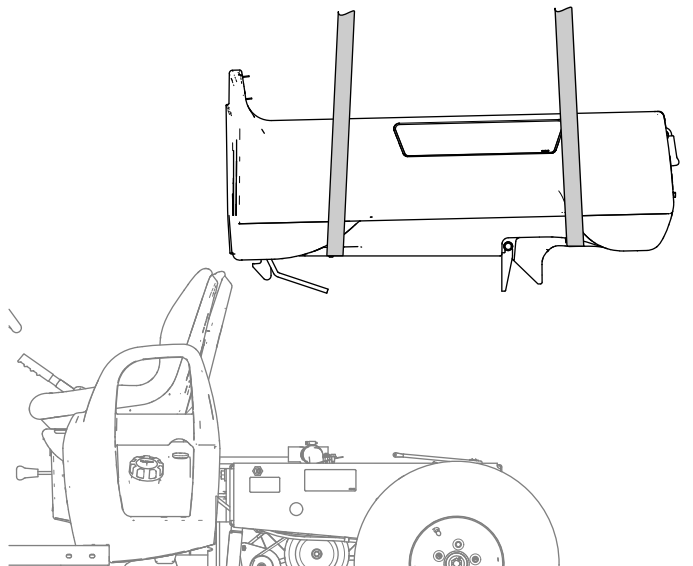

**Figure 6**

11. Rotate the cargo bed upside down and set it on the ground.

# 3

## Removing and Installing the Pivot Bracket Assembly

Parts needed for this procedure:

2	Pivot block
4	Flanged-head bolt (3/8 x 1-1/2 inches)

### Procedure

1. At the **new** cargo bed, align the holes of a new pivot block to the threaded inserts in the cargo bed, attach the block with the 2 flanged-head bolts (3/8 x 1-1/2 inches) and tighten the bolts hand tight (Figure 7).

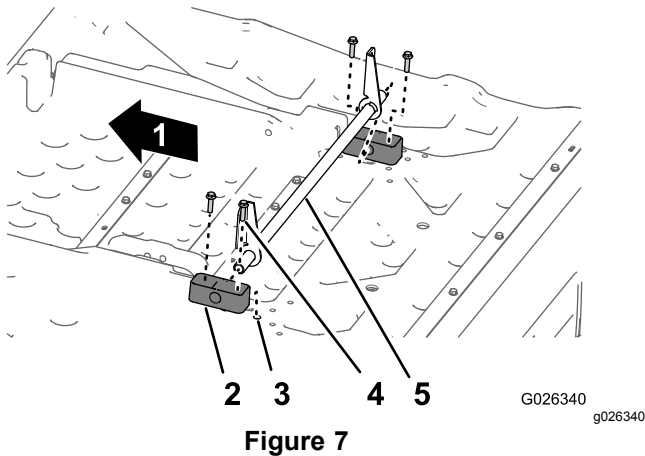

1. Forward
2. Pivot blocks
3. Threaded inserts (cargo bed)
4. Flanged-head bolts (3/8 x 1-1/2 inches)
5. Pivot-bracket assembly

2. Insert the tube end of the pivot-bracket assembly into the pivot block (Figure 7).
3. Install the other pivot block over the other tube end of the pivot-bracket (Figure 7).
4. Align the holes in the block to the threaded inserts in the cargo bed, attach the block with 2 flanged-head bolts (3/8 x 1-1/2 inches) and tighten the bolts hand tight (Figure 7).
5. Torque the flanged-head bolts to 37 to 45 N·m (27 to 33 ft-lb).

# 4

## Installing the Latch Assembly

Parts needed for this procedure:

1	Latch assembly
4	Flanged head bolt (5/16 x 3/4 inch)
2	Hand grip

### Procedure

1. Align the holes in the latch assembly from the kit to the threaded insert in the new cargo bed (Figure 8).

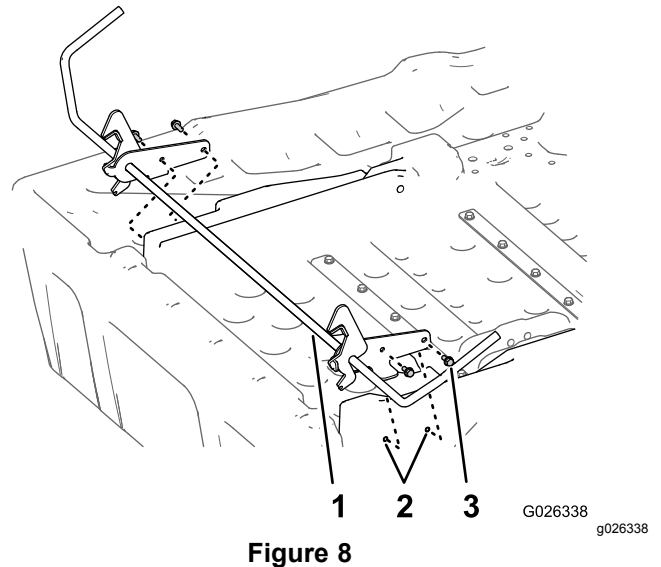

1. Latch assembly
2. Threaded inserts (cargo bed)
3. Flanged head bolt (5/16 x 3/4 inch)

2. Attach the latch to the cargo bed with 4 flanged head bolts (5/16 x 3/4 inch); refer to Figure 8.
3. Torque the bolts to 15 to 17 N·m (133 to 147 in-lb)
4. Slip the hand grips onto each end of the handle bar of the latch assembly (Figure 9).

# 5

## Installing the Prop Rod

### Parts needed for this procedure:

1	Prop rod
1	Washer (1/2 inch)
1	Hair pin

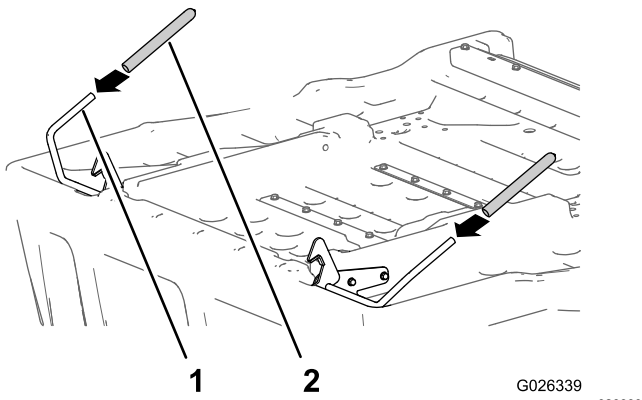

Figure 9

1. Handle lever (latch assembly)
2. Hand grip

5. Align the long tang of a spring to the spring saddle of the latch assembly (Figure 10).

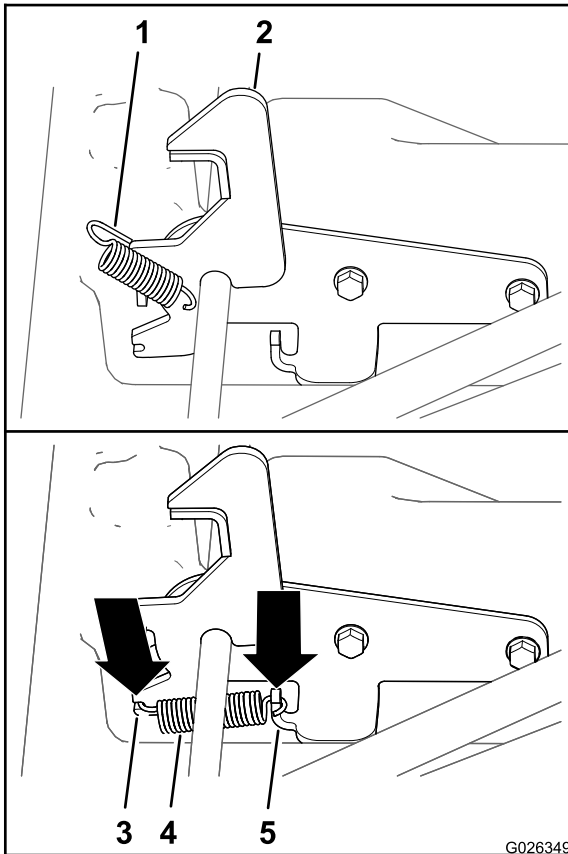

Figure 10

1. Long tang (spring)
2. Latch assembly
3. Spring saddle
4. Spring
5. Spring post

6. Connect the short tang of the spring to the spring post of the latch (Figure 10).
7. Repeat steps 5 and 6 for the other latch and spring (Figure 10).

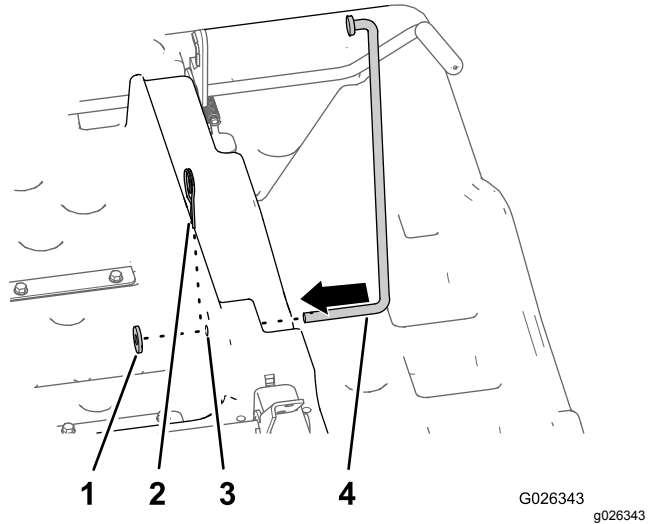

Figure 11

1. Washer (1/2 inch)
  2. Hair pin
  3. 13 mm (1/2 inch) hole (cargo bed)
  4. Prop rod (long leg)
2. Align a washer (1/2 inch) over the long leg of the prop rod and secure the rod to the cargo bed with a hair pin (Figure 11).
  3. Secure the prop rod by taping it against the bed

# 6

## Installing the Cargo Bed

### Parts needed for this procedure:

1	Cargo bed
1	Prop-rod bracket
2	Flange-head bolt (3/8 x 1 inch)
2	Locknut (3/8 inch)

### Procedure

1. Rotate the cargo bed so that the pivot-bracket assembly and prop rod are down.
2. Using lifting equipment at the front and back of the cargo bed, raise the cargo bed and align it over the frame of the machine with the pivot-bracket assembly rearward ([Figure 12](#))

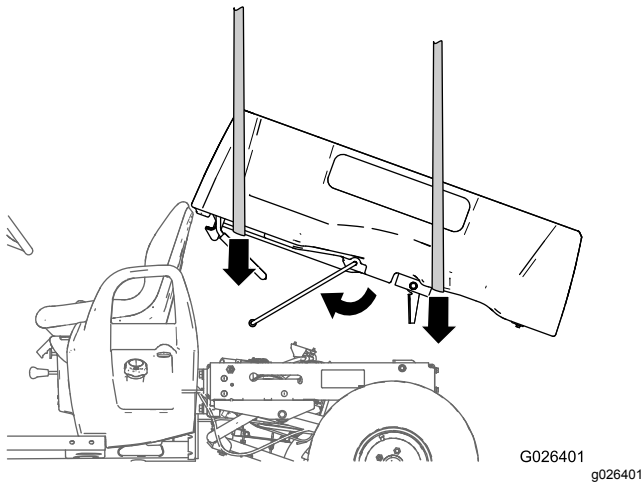
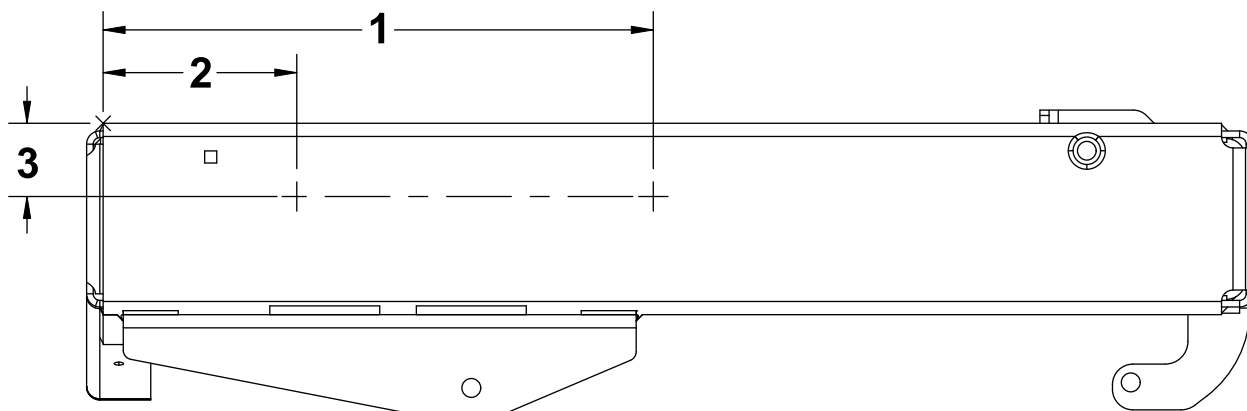

Figure 12

3. Remove the tape that is securing the prop rod to the cargo bed that you installed in step 3 of [Installing the Prop Rod \(page 5\)](#).
4. Adjust the height and position of the lifting equipment so that the short leg of the prop rod is aligned with the key hole at the end of the prop rod slot in the left frame channel or prop rod bracket ([Figure 12](#)).

**Note:** You will have to angle the cargo bed with the lifting equipment in order to align the prop rod to the key hole.

5. Using the template shown in [Figure 13](#), drill 2 holes (3/8 inch) into the left frame channel.



g284410

**Figure 13**

1. **MD/MDX**—38.18 cm (15.03 inches); **MDE**—43.26 cm (17.03 inches)
2. **MD/MDX**—13.46 cm (5.30 inches); **MDE**—18.54 cm (7.30 inches)
3. **MD/MDX**—51 mm (2 inches); **MDE**—51 mm (2 inches)

6. Secure the prop-rod bracket to the left frame channel using 2 flange-head bolts (3/8 x 1 inch) and 2 locknuts (3/8 inch) as shown in [Figure 14](#).

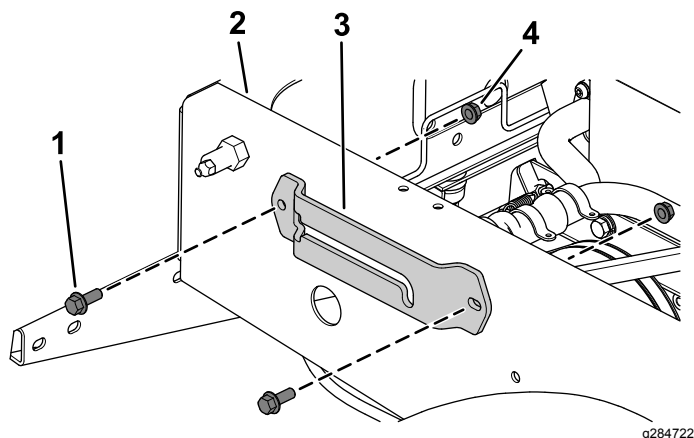

g284722

**Figure 14**

1. Flange-head bolt (3/8 x 1 inch)
2. Left frame channel
3. Prop-rod bracket
4. Locknut (3/8 inch)

7. Swing the prop rod forward and insert the short leg of the rod through the key hole ([Figure 12](#) and [Figure 15](#)).

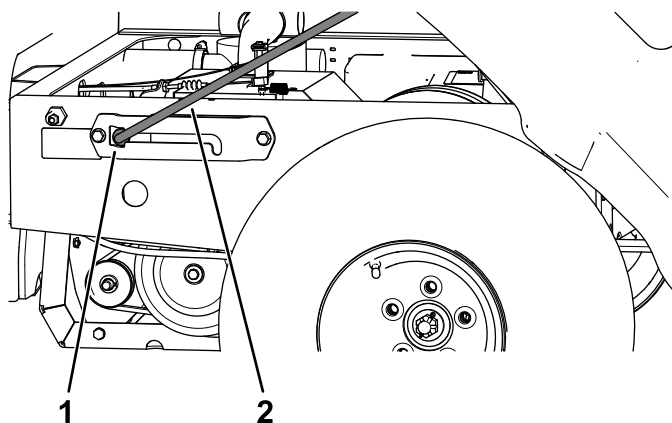

g283640

**Figure 15**

1. Key hole (prop rod slot)
2. Prop rod

8. Move the cargo bed and prop rod rearward until the pivot-bracket assembly is aligned over the rear frame channel ([Figure 15](#)).

9. Carefully lower the cargo bed until the holes in the pivot brackets align with the mounting holes for the cargo bed in the rear frame channel (Figure 16).

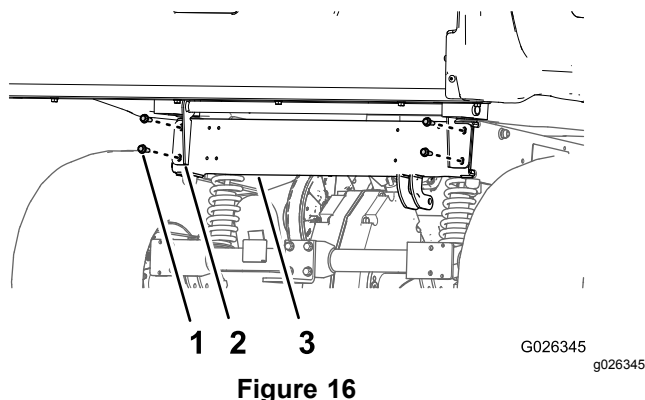

Figure 16

1. Flanged-head bolts (3/8 x 1 inch)
2. Hinge bracket
3. Rear frame channel

10. Attach the pivot brackets to the rear frame channel with the 4 flanged-head bolts (3/8 x 1 inch) that you removed in step 8; refer to Figure 16.
11. Torque the flanged-head bolts to 37 to 45 N·m (27 to 33 ft-lb).

# 7

## Adjusting the Cargo Bed Latches

No Parts Required

### Procedure

1. Release the prop rod for the cargo bed by moving the short leg of the rod out of the rear detent and
2. Gently lower the front of the cargo bed until the latch contacts the latch post (Figure 17).

**Note:** The latch post should align to the ramped portion of the latch.

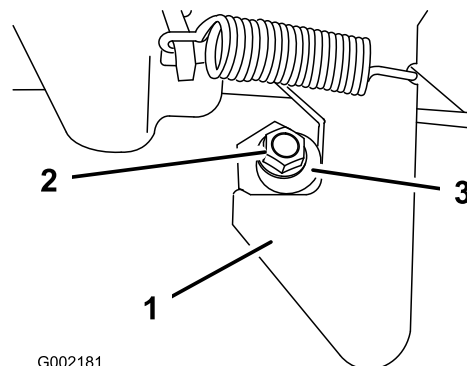

Figure 17

1. Latch
2. Locknut
3. Latch post

3. Pull up on the latch lever of the cargo bed latch, push down on the front of the cargo bed until it is fully seated, and release the latch lever.

**Note:** If the cargo bed latch is out of adjustment, the cargo bed vibrates up and down as you drive the machine. You can adjust the latch posts to make the latches hold the cargo bed snugly to the chassis.

4. Loosen the locknut on the end of the latch post (Figure 17).
5. Rotate the latch post clockwise until it is snug against the hook portion of the latch (Figure 17).
6. Torque the locknut to 19.7 to 25.4 N·m (175 to 225 in-lb).
7. Repeat steps 1 through 3 for the latch on the other side of the machine.