



Count on it.

Operator's Manual

**Commercial Walk-Behind Mower
Fixed Deck, Pistol Grip, Gear Drive with 32in,
36in, or 48in Cutting Unit**

Model No. 30632—Serial No. 404325000 and Up

Model No. 39634—Serial No. 404325000 and Up

Model No. 39638—Serial No. 404325000 and Up

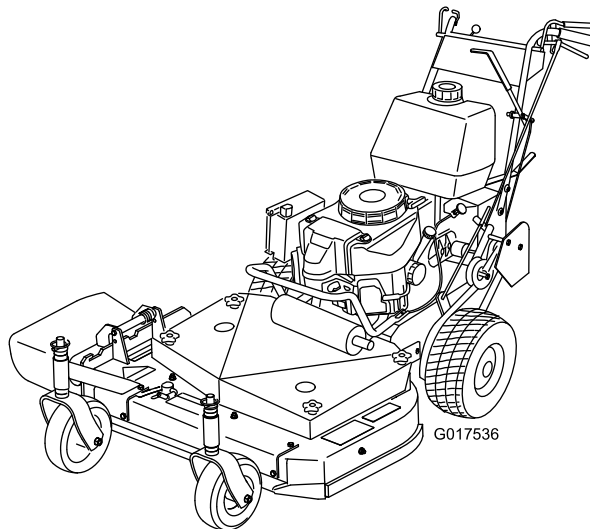

It is a violation of California Public Resource Code Section 4442 or 4443 to use or operate the engine on any forest-covered, brush-covered, or grass-covered land unless the engine is equipped with a spark arrester, as defined in Section 4442, maintained in effective working order or the engine is constructed, equipped, and maintained for the prevention of fire.

The enclosed engine owner's manual is supplied for information regarding the US Environmental Protection Agency (EPA) and the California Emission Control Regulation of emission systems, maintenance, and warranty. Replacements may be ordered through the engine manufacturer.

⚠ WARNING

**CALIFORNIA
Proposition 65 Warning**

The engine exhaust from this product contains chemicals known to the State of California to cause cancer, birth defects, or other reproductive harm.

Battery posts, terminals, and related accessories contain lead and lead compounds, chemicals known to the State of California to cause cancer and reproductive harm. Wash hands after handling.

Use of this product may cause exposure to chemicals known to the State of California to cause cancer, birth defects, or other reproductive harm.

Introduction

This rotary-blade lawn mower is intended to be used by residential homeowners or professional, hired operators. It is designed primarily for cutting grass on well-maintained lawns on residential or commercial properties. Using this product for purposes other than its intended use could prove dangerous to you and bystanders.

Read this information carefully to learn how to operate and maintain your product properly and to avoid injury and product damage. You are responsible for operating the product properly and safely.

Visit www.Toro.com for more information, including safety tips, training materials, accessory information, help finding a dealer, or to register your product.

Whenever you need service, genuine Toro parts, or additional information, contact an Authorized Service Dealer or Toro Customer Service and have the model and serial numbers of your product ready. **Figure 1** identifies the location of the model and serial numbers on the product. Write the numbers in the space provided.

Important: With your mobile device, you can scan the QR code on the serial number decal (if equipped) to access warranty, parts, and other product information.

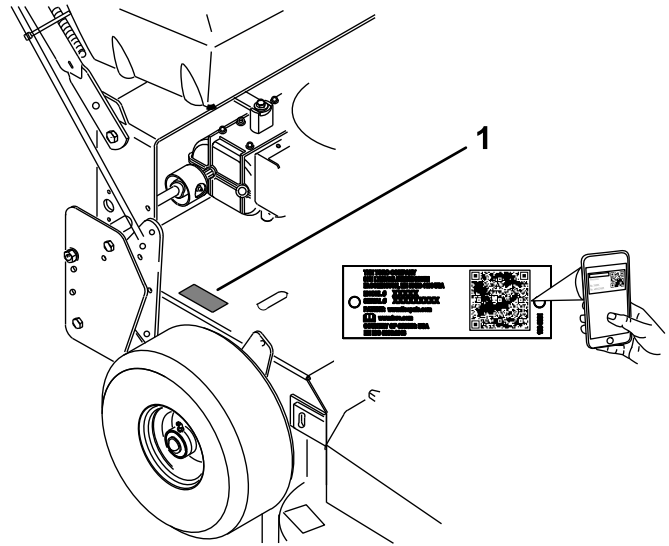

Figure 1

1. Model and serial number location

Model No. _____

Serial No. _____

This manual identifies potential hazards and has safety messages identified by the safety-alert symbol (**Figure 2**), which signals a hazard that may cause serious injury or death if you do not follow the recommended precautions.



Figure 2
Safety-alert symbol

This manual uses 2 words to highlight information. **Important** calls attention to special mechanical information and **Note** emphasizes general information worthy of special attention.

Contents

Safety	4	Belt Maintenance	35
General Safety	4	Inspecting the Belts	35
Safety and Instructional Decals	4	Adjusting the Wheel Drive Belt Tension	35
Product Overview	9	Replacing the Traction-Drive Belt	35
Controls	9	Replacing the Drive Belt	36
Specifications	10	Replacing the Mower Belt	36
Attachments/Accessories	10	Adjusting the Mower Belt Tension	37
Before Operation	11	Controls System Maintenance	41
Before Operation Safety	11	Adjusting the Control Rods	41
Adding Fuel	11	Mower Deck Maintenance	42
Performing Daily Maintenance	12	Blade Safety	42
During Operation	12	Servicing the Cutting Blades	42
During Operation Safety	12	Adjusting the Blade Brake	44
Operating the Parking Brakes and Neutral		Replacing the Grass Deflector	44
Locks	13	Cleaning	45
Starting the Engine	14	Cleaning under the Mower	45
Shutting Off the Engine	14	Disposing of Waste	45
Operating the Blade-Control Lever		Storage	46
(PTO)	15	Cleaning and Storing the Machine	46
Using the Safety-Interlock System	15	Troubleshooting	47
Driving the Machine	16	Schematics	49
Stopping the Machine	16		
Adjusting the Flow Baffle	16		
Positioning the Flow Baffle	17		
Side Discharging or Mulching Grass	18		
Adjusting the Height of Cut	18		
Height-of-Cut Chart	20		
After Operation	21		
After Operation Safety	21		
Transporting the Machine	21		
Maintenance	22		
Maintenance Safety	22		
Recommended Maintenance Schedule(s)	22		
Lubrication	23		
Greasing the Machine	23		
Lubricating the Caster and Wheel			
Bearings	23		
Greasing the Transmission Couplers	23		
Greasing the Mower Belt Idler	24		
Engine Maintenance	24		
Engine Safety	24		
Servicing the Air Cleaner	24		
Servicing the Engine Oil	25		
Servicing the Spark Plugs	27		
Fuel System Maintenance	28		
Servicing the Fuel System	28		
Electrical System Maintenance	30		
Electrical System Safety	30		
Servicing the Battery	30		
Drive System Maintenance	32		
Checking the Tire Pressure	32		
Cooling System Maintenance	33		
Cleaning the Air-Intake Screen	33		
Cleaning the Cooling System	33		
Brake Maintenance	34		
Servicing the Parking Brake	34		

Safety

This machine has been designed in accordance with ANSI B71.4-2017.

General Safety

This product is capable of amputating hands and feet and of throwing objects. Always follow all safety instructions to avoid serious personal injury.

- Read, understand, and follow the instructions and warnings in this *Operator's Manual* and on the machine and attachments before starting the engine.
- Do not put your hands or feet near moving parts of or under the machine. Keep clear of any discharge opening.
- Do not operate the machine without all guards and other safety protective devices in place and functioning properly on the machine.

- Keep bystanders and children out of the operating area. Do not allow children to operate the machine. Allow only people who are responsible, trained, familiar with the instructions, and physically capable to operate the machine.
- Stop the machine, shut off the engine, remove the ignition key (if equipped), and wait for all moving parts to stop before servicing, fueling, or unclogging the machine.

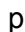
Improperly using or maintaining this machine can result in injury. To reduce the potential for injury, comply with these safety instructions and always pay attention to the safety-alert symbol , which means Caution, Warning, or Danger—personal safety instruction. Failure to comply with these instructions may result in personal injury or death.

Safety and Instructional Decals



Safety decals and instructions are easily visible to the operator and are located near any area of potential danger. Replace any decal that is damaged or missing.



decaloemmarkt

Manufacturer's Mark

1. Indicates the blade is identified as a part from the original machine manufacturer.



93-7010

decal93-7010

1. Thrown object hazard—keep bystanders away.
2. Thrown object hazard, mower—keep the deflector in place.
3. Cutting/dismemberment hazard of hand or foot, mower blade—stay away from moving parts.

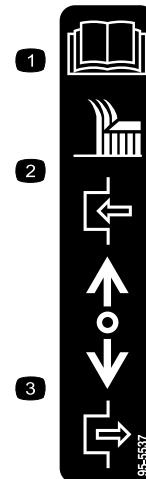

95-5537

decal95-5537(gear)

1. Read the *Operator's Manual* for instructions on operating the cutting blade.
2. Push forward to engage.
3. Pull back to disengage.

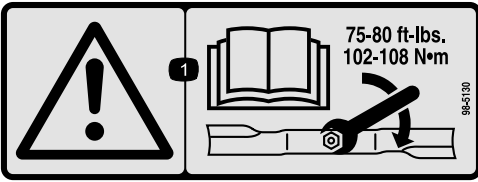

98-5130

decal98-5130

1. Warning—read the *Operator's Manual* for instructions on torquing the blade bolt/nut to 102 to 106 N·m (75 to 80 ft-lb).

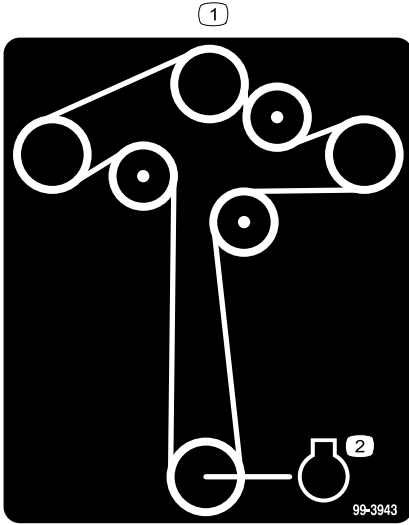

99-3943

decal99-3943

1. Belt routing
2. Engine



105-4104

decal105-4104

1. Reverse
2. Neutral
3. Transmission speeds

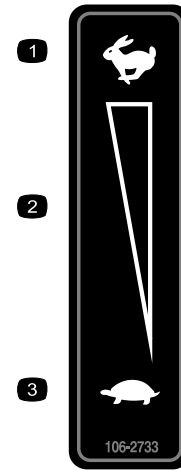

106-2733

decal106-2733

1. Fast
2. Continuous variable setting
3. Slow



106-5517

decal106-5517

1. Warning—do not touch the hot surface.

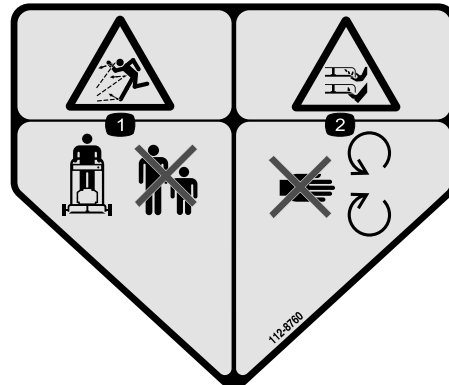

112-8760

decal112-8760

1. Thrown object hazard—keep bystanders away.
2. Cutting/dismemberment hazard of hand or foot, mower blade—stay away from moving parts.

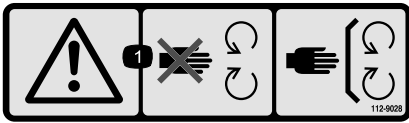

112-9028

decal112-9028

1. Warning—stay away from moving parts; keep all guards and shields in place.

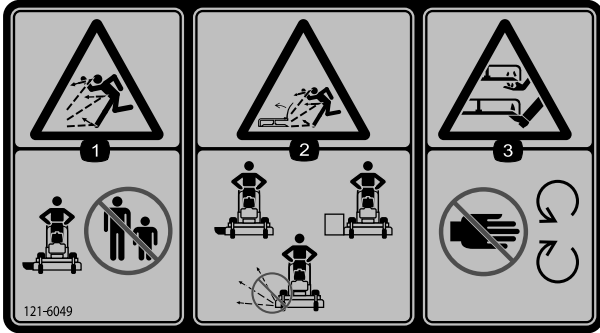

121-6049

decal121-6049

1. Thrown object hazard—keep bystanders away.
2. Thrown object hazard, mower—do not operate the mower with guards or shields removed.
3. Cutting/dismemberment hazard of hand or foot, mower blade—stay away from moving parts.

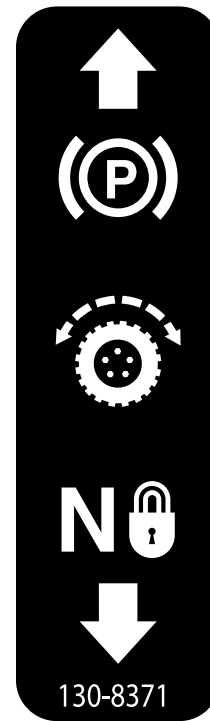

130-8371

decal130-8371

1. Parking brake
2. Traction drive
3. Neutral lock

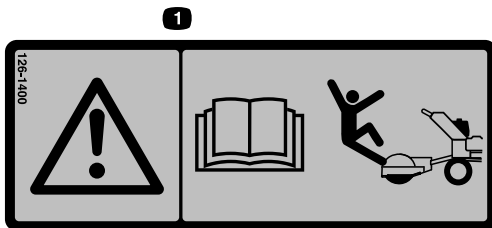

126-1400

decal126-1400

1. Warning—read the *Operator's Manual* for information about attachments; certain attachments can cause you to fall.

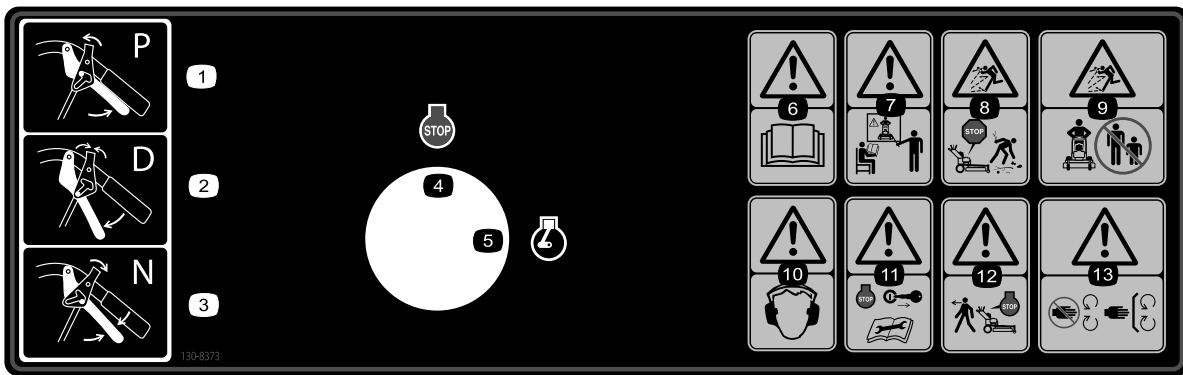

130-8373

decal130-8373

- | | | | |
|----------------|---|---|--|
| 1. Park | 5. Engine—Run | 9. Thrown object hazard—keep bystanders away. | 13. Warning—stay away from moving parts; keep all guards and shields in place. |
| 2. Drive | 6. Warning—read the <i>Operator's Manual</i> . | 10. Warning—wear hearing protection. | |
| 3. Neutral | 7. Warning—do not operate this machine unless you are trained. | 11. Warning—shut off the engine and remove the key before performing maintenance. | |
| 4. Engine—Stop | 8. Thrown object hazard—shut off the engine before leaving the machine to pick up debris. | 12. Warning—shut off the engine before leaving the machine. | |

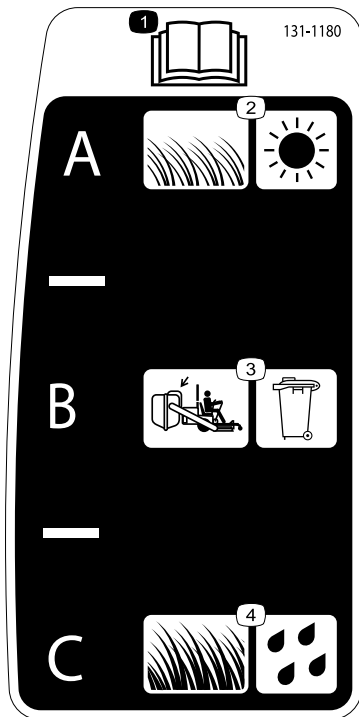

131-1180

decal131-1180

- | | |
|--|--------------------------------------|
| 1. Read the <i>Operator's Manual</i> . | 3. Bagging setting |
| 2. Short, light grass; dry conditions | 4. Tall, dense grass; wet conditions |



132-4708

decal132-4708

- | | |
|--|--|
| 1. Attention—do not adjust the shift lever while moving. | 2. Stop moving before adjusting the shift lever. |
|--|--|

⚠ WARNING: Cancer and Reproductive Harm - www.P65Warnings.ca.gov.
For more information, please visit www.ticoCAProp65.com

CALIFORNIA SPARK ARRESTER WARNING

Operation of this equipment may create sparks that can start fires around dry vegetation. A spark arrester may be required. The operator should contact local fire agencies for laws or regulations relating to fire prevention requirements.

133-8062

decal133-8062

133-8062

Product Overview

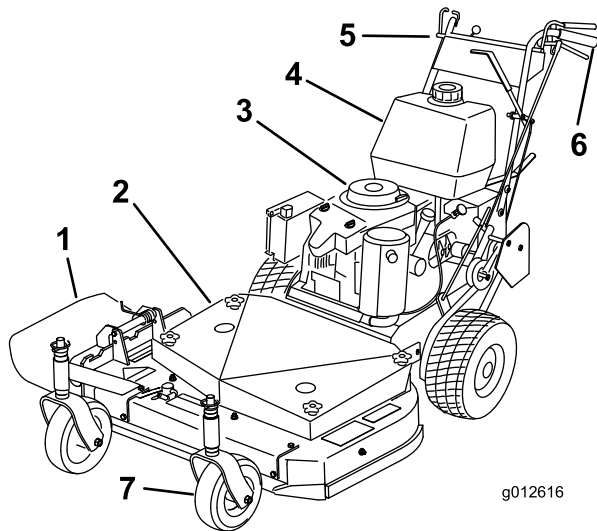

Figure 3

- | | |
|-------------------------|-----------------|
| 1. Side-discharge chute | 5. Controls |
| 2. Mower deck | 6. Handle |
| 3. Recoil-start handle | 7. Caster wheel |
| 4. Fuel tank | |

Control Panel

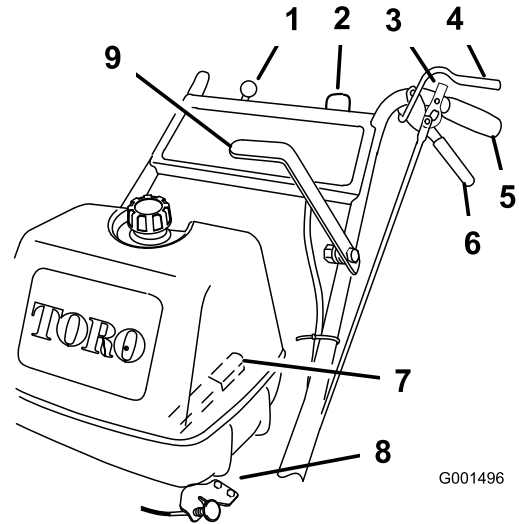

Figure 4

- | | |
|--|--|
| 1. Throttle control | 6. Drive lever |
| 2. Key switch | 7. Gear-shift lever |
| 3. Neutral/parking-brake lock | 8. Choke |
| 4. Operator-presence control (OPC) lever | 9. Blade-control lever (power takeoff) |
| 5. Handle | |

Controls

Become familiar with all the controls before you start the engine and operate the machine.

Throttle Control

The throttle control has 2 positions: FAST and SLOW (Figure 4).

Operator-Presence Control (OPC) Levers

When you squeeze the OPC levers (Figure 4) against the handles, the OPC system senses that you are in the normal operating position. When you release the OPC levers, the OPC system senses that you left the normal operating position, and the system shuts off the engine if either the gear-shift lever is not in the NEUTRAL position or the blade-control switch (power takeoff) is engaged.

Gear-Shift Lever

The gear-shift lever allows you to shift to 5 FORWARD positions, NEUTRAL position, and REVERSE position (Figure 4).

Note: It has an in-line shift pattern.

Important: Do not shift while the machine is moving, as you may damage the transmission.

Drive Levers

Release the drive levers to engage the forward traction operation. Squeeze the right drive lever to turn right or squeeze the left drive lever to turn left (Figure 4).

Neutral/Parking-Brake Lock

Squeeze the drive levers and move the locks rearward to the NEUTRAL-LOCK position. Squeeze the drive levers and move the locks forward to engage the parking brake (Figure 4).

Blade-Control Lever (Power Takeoff)

The blade-control lever, in conjunction with the OPC levers, engages and disengages power to the mower blades (Figure 4).

Recoil-Start Handle

Pull the recoil-start handle to start the engine (Figure 3).

Fuel-Shutoff Valve

Close the fuel-shutoff valve when transporting or storing the machine.

Key Switch

The key switch, used in conjunction with the recoil starter to start and shut off the engine, has 2 positions: RUN and OFF (Figure 4).

Choke

Use the choke to start a cold engine.

Specifications

Note: Specifications and design are subject to change without notice.

32-inch mowers:

Width with deflector down	116 cm (46 inches)
Length	198 cm (78 inches)
Height	104 cm (41 inches)
Weight	182 kg (402 lb)

36-inch mowers:

Width with deflector down	118 cm (47 inches)
Length	203 cm (80 inches)
Height	104 cm (41 inches)
Weight	210 kg (462 lb)

48-inch mowers:

Width with deflector down	161 cm (63-1/2 inches)
Length	199 cm (78 inches)
Height	104 cm (41 inches)
Weight	227 kg (500 lb)

Attachments/Accessories

A selection of Toro approved attachments and accessories is available for use with the machine to enhance and expand its capabilities. Contact your Authorized Service Dealer or authorized Toro distributor or go to www.Toro.com for a list of all approved attachments and accessories.

To ensure optimum performance and continued safety certification of the machine, use only genuine Toro replacement parts and accessories. Replacement parts and accessories made by other manufacturers could be dangerous, and such use could void the product warranty.

Operation

Note: Determine the left and right sides of the machine from the normal operating position.

Before Operation

Before Operation Safety

General Safety

- Do not allow children or untrained people to operate or service the machine. Local regulations may restrict the age of the operator. The owner is responsible for training all operators and mechanics.
- Become familiar with the safe operation of the equipment, operator controls, and safety signs.
- Always shut off the machine, remove the ignition key (if equipped), wait for all moving parts to stop, and allow the machine to cool before adjusting, servicing, cleaning, or storing it.
- Know how to stop the machine and shut off the engine quickly.
- Check that operator-presence controls, safety switches, and safety protective devices are attached and functioning properly. Do not operate the machine unless they are functioning properly.
- Inspect the area where you will use the machine, and remove all objects that could interfere with the operation of the machine or that the machine could throw.
- Evaluate the terrain to determine what accessories and attachments are needed to properly and safely perform the job.
- Before using, always visually inspect to see that the blades, blade bolts and mower deck are not worn or damaged. Replace worn or damaged blades and bolts in sets to preserve balance.

Fuel Safety

- Use extreme care in handling fuel. It is flammable and its vapors are explosive.
- Extinguish all cigarettes, cigars, pipes, and other sources of ignition.
- Use only an approved fuel container.
- Do not remove the fuel cap or add fuel to the tank while the engine is running or hot.
- Do not add or drain fuel in an enclosed space.
- Do not store the machine or fuel container where there is an open flame, spark, or pilot light, such as on a water heater or other appliance.

- If you spill fuel, do not attempt to start the engine; avoid creating a source of ignition until the fuel vapors have dissipated.
- Do not fill containers inside a vehicle or on a truck or trailer bed with a plastic liner. Always place containers on the ground, away from the vehicle before filling.
- Remove equipment from the truck or trailer and refuel it on the ground. If this is not possible, refuel such equipment with a portable container rather than from a fuel-dispenser nozzle.
- Keep the nozzle in contact with the rim of the fuel tank or container operating at all times until fueling is complete.

Adding Fuel

Recommended Fuel

- For best results, use only clean, fresh (less than 30 days old), unleaded gasoline with an octane rating of 87 or higher ((R+M)/2 rating method).
- **Ethanol:** Gasoline with up to 10% ethanol (gasohol) or 15% MTBE (methyl tertiary butyl ether) by volume is acceptable. Ethanol and MTBE are not the same. Gasoline with 15% ethanol (E15) by volume is not approved for use. **Never use gasoline that contains more than 10% ethanol by volume**, such as E15 (contains 15% ethanol), E20 (contains 20% ethanol), or E85 (contains up to 85% ethanol). Using unapproved gasoline may cause performance problems and/or engine damage which may not be covered under warranty.
- **Do not** use gasoline containing methanol.
- **Do not** store fuel either in the fuel tank or fuel containers over the winter unless you use a fuel stabilizer.
- **Do not** add oil to gasoline.

Using Stabilizer/Conditioner

Use a fuel stabilizer/conditioner in the machine to provide the following benefits:

- Keeps fuel fresh longer when used as directed by the fuel-stabilizer manufacturer
- Cleans the engine while it runs
- Eliminates gum-like varnish buildup in the fuel system, which causes hard starting

Important: Do not use fuel additives containing methanol or ethanol.

Add the correct amount of fuel stabilizer/conditioner to the fuel.

Note: A fuel stabilizer/conditioner is most effective when mixed with fresh fuel. To minimize the chance of varnish deposits in the fuel system, use fuel stabilizer at all times.

Filling the Fuel Tank

1. Park the machine on a level surface.
2. Engage the parking brake.
3. Shut off the engine and remove the key.
4. Clean around the fuel-tank cap.
5. Fill the fuel tank to the bottom of the filler neck.

Note: Do not fill the fuel tank completely full. The empty space in the tank allows the fuel to expand.

Performing Daily Maintenance

Before starting the machine each day, perform the Each Use/Daily procedures listed in [Maintenance \(page 22\)](#).

During Operation

During Operation Safety

General Safety

- The owner/operator can prevent and is responsible for accidents that may cause personal injury or property damage.
- Wear appropriate clothing, including eye protection; long pants; substantial, slip-resistant footwear; and hearing protection. Tie back long hair and do not wear loose clothing or loose jewelry.
- Use your full attention while operating the machine. Do not engage in any activity that causes distractions; otherwise, injury or property damage may occur.
- Do not operate the machine while ill, tired, or under the influence of alcohol or drugs.
- Before you start the engine, ensure that all drives are in neutral, the parking brake is engaged, and you are in the operating position.
- Keep bystanders out of the operating area. Stop the machine if anyone enters the area.
- Operate the machine only in good visibility and appropriate weather conditions. Do not operate the machine when there is the risk of lightning.
- Wet grass or leaves can cause serious injury if you slip and contact the blade. Avoid mowing in wet conditions.
- Keep your hands and feet away from the cutting unit.
- Look behind and down before backing up to be sure of a clear path.
- Use extreme care when approaching blind corners, shrubs, trees, or other objects that may block your view.
- Disengage the drive to the cutting unit and shut off the engine before adjusting the height of cut.
- Operate the engine only in well-ventilated areas. Exhaust gases contain carbon monoxide, which is lethal if inhaled.
- Do not leave a running machine unattended.
- Before leaving the operating position (including to empty the catchers or to unclog the cutting units), do the following:
 - Park the machine on level ground.
 - Disengage the cutting unit and lower the attachments.
 - Engage the parking brake.
 - Shut off the machine and remove the ignition key (if equipped).
 - Wait for all moving parts to stop.
 - Shut off the machine and disengage the drive to the cutting unit in the following situations:
 - ◇ Before fueling
 - ◇ Before clearing blockages
 - ◇ Before checking, cleaning, or maintaining the cutting unit
 - ◇ After striking a foreign object or if an abnormal vibration occurs. Inspect the cutting unit for damage and make repairs before starting and operating the machine
 - ◇ Before leaving the operating position
 - Use only accessories and attachments approved by The Toro® Company.
 - Be sure of your footing while using this machine, especially when backing up. Walk; do not run.
 - Never operate with the discharge deflector raised, removed or altered, unless you are using a grass catcher.
 - Never carry passengers on the machine.
 - Do not direct the discharge material toward anyone. Avoid discharging material against a wall or obstruction; material may ricochet

toward you. Stop the blade(s) when crossing gravel surfaces.

- Start the engine carefully according to instructions and with your feet well away from the blade(s) and not in front of the discharge chute.
- Use extreme caution when reversing or pulling the machine toward you.
- Stop the blade if you must transport the machine to and from the mowing area and when crossing surfaces other than grass.

Slope Safety

- Slopes are a major factor related to loss of control and rollover accidents, which can result in severe injury or death. You are responsible for safe slope operation. Operating the machine on any slope requires extra caution. Before using the machine on a slope, do the following:
 - Review and understand the slope instructions in the manual and on the machine.
 - Evaluate the site conditions of the day to determine if the slope is safe for machine operation. Use common sense and good judgment when performing this evaluation. Changes in the terrain, such as moisture, can quickly affect the operation of the machine on a slope.
- Operate across slopes, never up and down. Avoid operation on excessively steep or wet slopes. Poor footing could cause a slip-and-fall accident.
- Identify hazards at the base of the slope. Do not operate the machine near drop-offs, ditches, embankments, water, or other hazards. The machine could suddenly roll over if a wheel goes over the edge or the edge collapses. Keep a safe distance between the machine and any hazard. Use a handheld tool to operate in these areas.
- Avoid starting, stopping, or turning the machine on slopes. Avoid making sudden changes in speed or direction; turn slowly and gradually.
- Do not operate a machine under any conditions where traction, steering or stability is in question. Be aware that operating the machine on wet grass, across slopes or downhill may cause the machine to lose traction. Loss of traction to the drive wheels may result in sliding and a loss of braking and steering. The machine can slide even if the drive wheels are stopped.
- Remove or mark obstacles such as ditches, holes, ruts, bumps, rocks, or other hidden hazards. Tall grass can hide obstacles. Uneven terrain could overturn the machine.

- If you lose control of the machine, step away from the direction of travel of the machine.
- Always keep the machine in gear when going down slopes. Do not coast downhill (applicable only to gear-drive units).

Operating the Parking Brakes and Neutral Locks

⚠ WARNING

Children or bystanders may be injured if they move or attempt to operate the machine while it is unattended.

Always park the machine on a level surface, engage the parking brake, and remove the ignition key if you leave the machine unattended.

Engaging the Parking Brakes

1. Squeeze the drive levers (Figure 5).

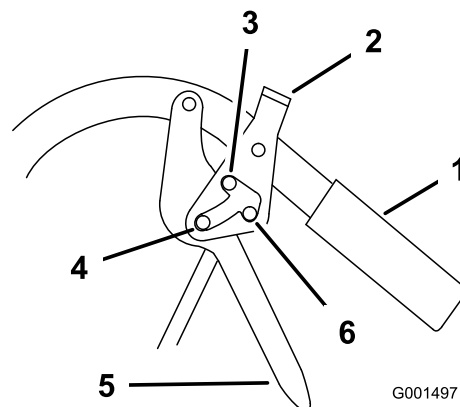

Figure 5

- | | |
|-------------------------------|--------------------------------|
| 1. Handle | 4. FULL SPEED FORWARD position |
| 2. Neutral/parking-brake lock | 5. Drive lever |
| 3. PARK position | 6. NEUTRAL position |

2. Place your thumbs on the upper part of the locks and move them forward in into the PARK position (Figure 5).
3. Disengage the drive levers.

Disengaging the Parking Brakes

1. Squeeze the drive levers rearward (Figure 5).
2. Place your thumbs on the upper part of the locks and move them rearward until they are in the DRIVE position (Figure 5).

Engaging the Neutral Locks

1. Squeeze the drive levers rearward (Figure 5).
2. Place your thumbs on the upper part of the locks and move them rearward into the NEUTRAL-LOCK position (Figure 5).

Disengaging the Neutral Locks

1. Squeeze the drive levers rearward.
2. Place your thumbs on the upper part of the locks and move them forward until they are in the DRIVE position (Figure 5).

Starting the Engine

1. Connect the spark-plug wires.
2. Open the fuel valve.
3. Disengage the PTO and shift to the NEUTRAL position.
4. Engage the parking brakes.
5. Turn the ignition key to the RUN position.
 - To start a cold engine, move the throttle control midway between the FAST and SLOW positions.
 - To start a warm engine, move the throttle control to the FAST position.
6. Pull the choke knob if the engine is cold.

Note: A warm or hot engine usually does not require any choking.

7. Grasp the recoil-start handle firmly and pull it to start the engine.

Note: Allow the rope to recoil slowly.

Important: Do not pull the recoil rope to its limit or release the starter handle when you pull out the rope, because the rope may break or the recoil assembly may be damaged.

8. Push the choke to the OFF position as the engine warms up.
9. If the engine is cold, allow it to warm up and then move the throttle control to the FAST position.

Shutting Off the Engine

1. Move the throttle lever to the SLOW position (Figure 6).
2. Idle the engine for 30 to 60 seconds before turning the ignition key to the OFF position.
3. Engage the parking brakes and remove the ignition key.
4. Disconnect the spark-plug wires.
5. Close the fuel-shutoff valve.

Important: Ensure that you close the fuel-shutoff valve before transporting or storing the machine, as fuel may leak.

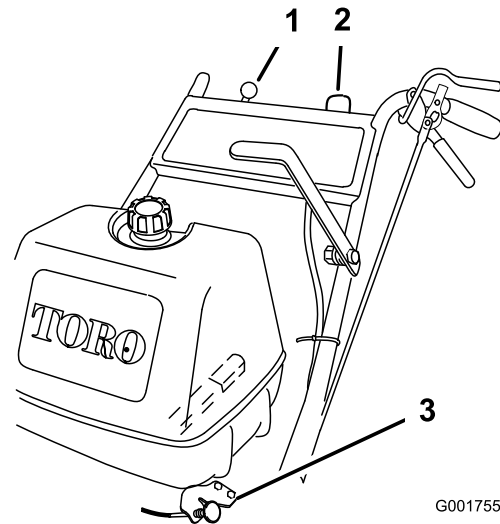

Figure 6

1. Throttle control
2. Key switch
3. Choke

Operating the Blade-Control Lever (PTO)

The blade-control lever (PTO) engages and disengages power to the mower blades.

Engaging the Mower Blades

1. Squeeze the operator-presence control levers against the handles (Figure 7).
2. Push the blade-control (PTO) lever firmly forward until it latches over the center (Figure 7).

Note: If you release the operator-presence control, start the engine and repeat this procedure to engage the mower blades.

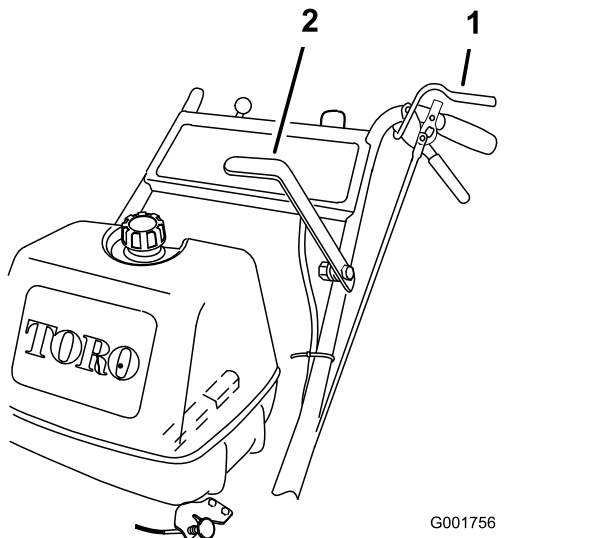

Figure 7

1. Operator Presence Control (OPC) lever
2. Power take-off lever (PTO)

Disengaging the Mower Blades (PTO)

Pull the blade-control lever (PTO) fully rearward (Figure 7).

Note: The engine shuts off if you release the operator-presence control with the blade-control lever engaged.

Using the Safety-Interlock System

⚠ WARNING

If the safety-interlock switches are disconnected or damaged, the machine could operate unexpectedly, causing personal injury.

- Do not tamper with the interlock switches.
- Check the operation of the interlock switches daily and replace any damaged switches before operating the machine.

Understanding the Safety-Interlock System

The safety-interlock system is designed to prevent the engine from starting unless:

- The PTO is disengaged.
- The machine is in the NEUTRAL position.
- The ignition key is in the RUN position.

The safety-interlock system is designed to shut off the engine when:

- The operator-presence control (OPC) levers are released when the transmission or the blades are engaged.
- The ignition key is turned to the OFF position.
- The machine is shifted into gear without holding the OPC levers.
- The blade-control lever (PTO) is engaged without holding the OPC levers.

Testing the Safety-Interlock System

Test the safety-interlock system each time before you use the machine. If the safety system does not operate as described, have an Authorized Service Dealer repair the safety system immediately.

1. Engage the parking brakes, move the shift lever to the NEUTRAL position, disengage the PTO, and move the throttle forward.
2. Start the engine.
3. Without holding the operator-presence control (OPC) levers, engage the blade-control lever (PTO).
The engine should shut off.
4. Disengage the blade-control lever (PTO).

5. With the engine running, hold down the OPC levers and engage the the blade-control lever (PTO).
The mower belt should engage and the mower blades should rotate.
6. Release the OPC levers.
The engine should shut off.
7. With the engine running, move the shift lever into gear and release the OPC levers.
The engine should shut off.
8. With the engine running, turn the ignition key to the OFF position.
The engine should shut off.
9. If all the above conditions are not met, have an Authorized Service Dealer repair the safety system immediately.

Driving the Machine

The throttle control regulates the engine speed (rpm). Move the throttle control to the FAST position for the best mowing performance.

⚠ WARNING

The machine can spin very rapidly. You may lose control of the machine and cause personal injury or damage to the machine.

- Use caution when making turns.
- Slow the machine down before making sharp turns.

Driving Forward

1. Engage the parking brakes.
2. Squeeze the OPC levers against the handles.
3. Move the shift lever into a forward gear.
4. Disengage the parking brakes.
5. Slowly release the drive levers.
To go straight, release the drive levers equally.
To turn, squeeze the drive lever on the same side as the direction you want to turn.

Driving Backward

1. Engage the parking brakes.
2. Squeeze the OPC levers against the handles.
3. Move the shift lever into the reverse gear.
4. Disengage the parking brakes.
5. Slowly release the drive levers.

Note: You must pull the mower backward to assist its rearward movement.

Stopping the Machine

⚠ CAUTION

You or bystanders may be injured if you move or attempt to operate the machine while it is unattended.

Always remove the ignition key and engage the parking brake if you leave the machine unattended.

1. Squeeze the drive levers back fully to engage the brakes.
2. Engage the parking brakes
3. Shift to the NEUTRAL position.
4. Move the throttle to the STOP position, and wait for all moving parts to stop before leaving the operating position.

Adjusting the Flow Baffle

You can adjust the mower discharge flow for different types of mowing conditions. Position the cam lock and baffle for the best quality of cut.

1. Disengage the PTO and engage the parking brake.
2. Shut off the engine, remove the key, and wait for all moving parts to stop before leaving the operating position.
3. Loosen the nut (Figure 8).
4. Adjust the baffle and nut in the slot to the desired discharge flow.
5. Tighten the nut.

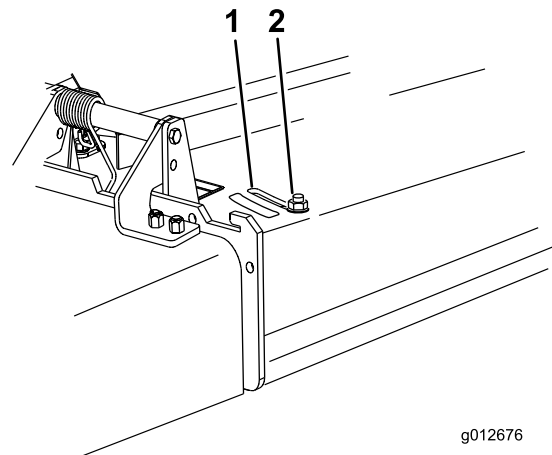

g012676

g012676

Figure 8

1. Slot
2. Nut

Positioning the Flow Baffle

The following figures are only recommendations for use. Adjustments vary by grass type, moisture content, and the height of the grass.

Note: If the engine power draws down and the mower ground speed is the same, open up the baffle.

Position A

This is the full rear position. The suggested use for this position is as follows:

- Short, light grass mowing conditions
- Dry conditions
- Smaller grass clippings
- Propels grass clippings farther away from the mower

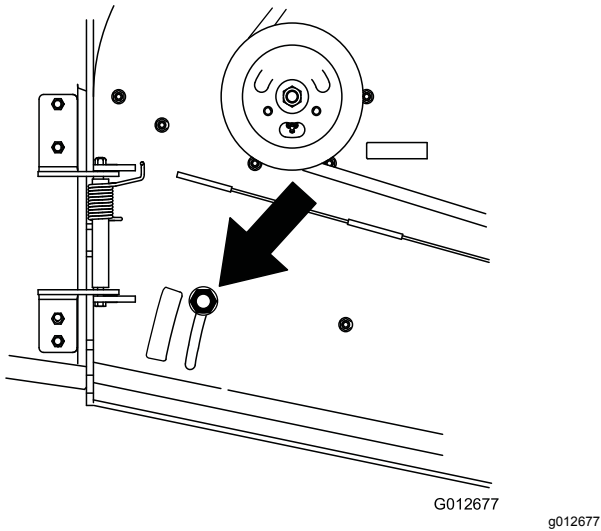

Figure 9

Position B

Use this position when bagging.

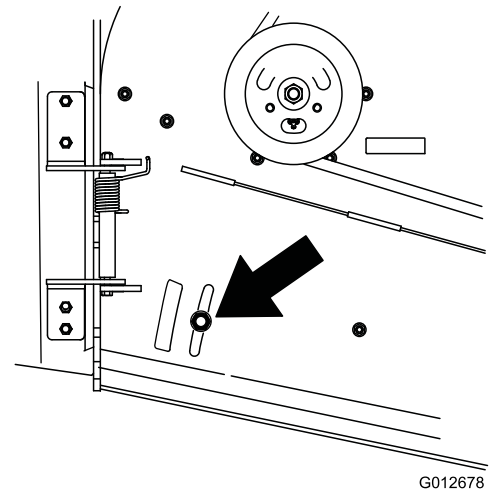

Figure 10

Position C

This is the full open position. The suggested use for this position is as follows:

- Tall, dense grass mowing conditions
- Wet conditions
- Lowers the engine-power consumption
- Allows increased ground speed in heavy conditions

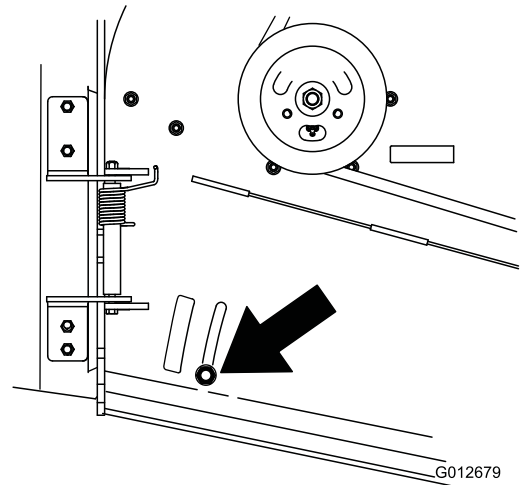

Figure 11

Side Discharging or Mulching Grass

This mower has a hinged grass deflector that disperses clippings to the side and down toward the turf.

⚠ DANGER

Without the grass deflector, discharge cover, or complete grass catcher assembly mounted in place, you and bystanders are exposed to blade contact and thrown debris. Contact with rotating mower blade(s) and thrown debris can cause serious injury or death.

- Never remove the grass deflector from the mower deck, because the grass deflector routes material down toward the turf. If the grass deflector is damaged, replace it immediately.
- Never put your hands or feet under the mower deck.
- Never try to clear the discharge area or mower blades before you disengage the mower blades. Turn the ignition key to the OFF position. Remove the key and disconnect the spark-plug wires.

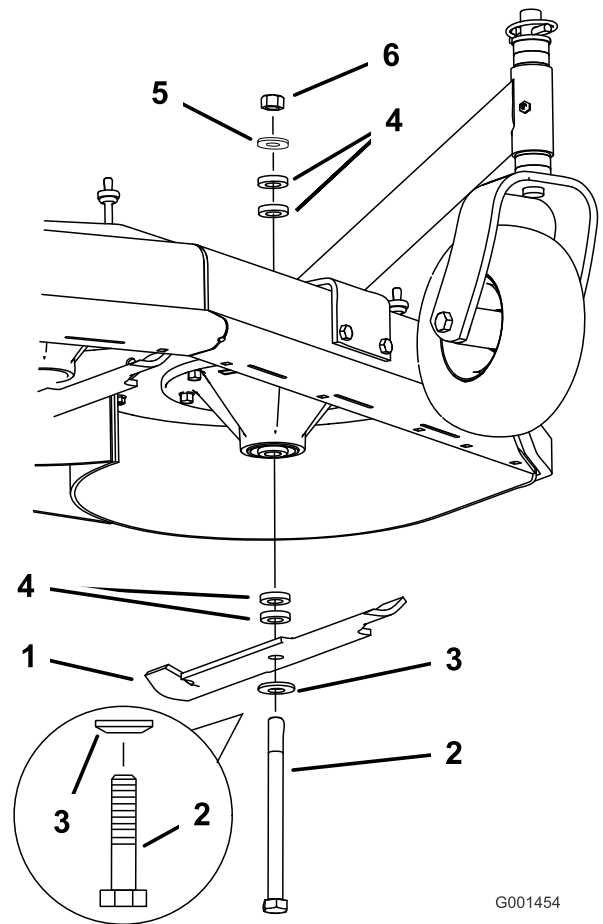

Figure 12

- | | |
|------------------|----------------|
| 1. Blade | 4. Spacer |
| 2. Blade bolt | 5. Thin washer |
| 3. Curved washer | 6. Nut |

Adjusting the Height of Cut

You can adjust the height of cut from 26 to 108 mm (1 to 4-1/4 inches) in 6 mm (1/4 inch) increments. You can achieve this by adjusting the blade spacers, rear axle height, or front caster spacers. Use the [Height-of-Cut Chart \(page 20\)](#) to select the combination of adjustments required.

Adjusting the Blade Height

Adjust the blades by using the 4 spacers (6 mm or 1/4 inch) on the blade spindle bolts. This allows for a 25 mm (1 inch) adjustment range, in 6 mm (1/4 inch) increments, of cutting height in any axle position. Use the same number of blade spacers on all the blades to achieve a level cut (for example, 2 above and 2 below, 1 above and 3 below, etc.).

1. Park the machine on a level surface, disengage the PTO, and engage the parking brake.
2. Shut off the engine, remove the key, and wait for all moving parts to stop before leaving the operating position.
3. Hold the blade bolt and remove the nut (Figure 12).

4. Remove the blade bolt from the spindle and change the spacers as needed (Figure 12).
5. Install the blade bolt, curved washer, and extra spacers, and secure them with a thin washer and a nut (Figure 12).
6. Torque the blade bolt to 101 to 108 N·m (75 to 80 ft-lb).

Adjusting the Axle Height

Adjust the axle position to the selected height-of-cut setting. Refer to the [Height-of-Cut Chart \(page 20\)](#).

1. Park the machine on a level surface, disengage the PTO, and engage the parking brake.
2. Shut off the engine, remove the key, and wait for all moving parts to stop before leaving the operating position.
3. Loosen, but do not remove, the 2 axle-pivot bolts and 2 axle-adjustment bolts (Figure 13).

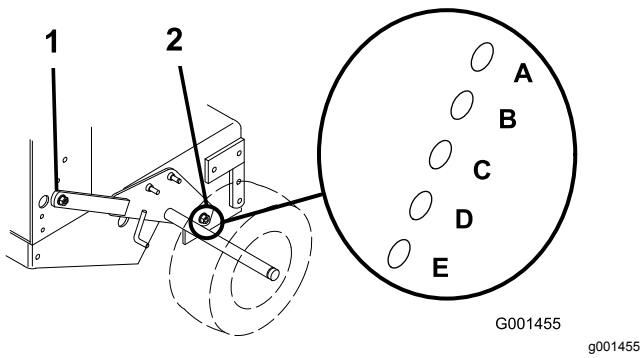

Figure 13

1. Axle-pivot bolt
2. Axle-adjustment bolt

4. Place a jack under the rear center of the engine frame. Raise the rear end of the engine frame up enough to remove the front 2 axle-adjustment bolts (Figure 13).

Note: Use jack stands to support the machine.

5. Raise or lower the engine frame with the jack so that you can install the front 2 axle-adjustment bolts in the desired hole location (Figure 13).

Note: Use a tapered punch to help align the holes.

6. Tighten all 4 bolts and lower the machine.
7. Adjust the control rods and brake linkages as required; refer to [Adjusting the Control Rods](#) (page 41) and [Adjusting the Parking Brake](#) (page 34).

Important: You must adjust the control rods and brake linkage when you change the axle positions for proper traction and brake function.

Adjusting the Caster Position

1. Using the [Height-of-Cut Chart](#) (page 20), adjust the caster spacers to match with the axle hole selected (Figure 14).

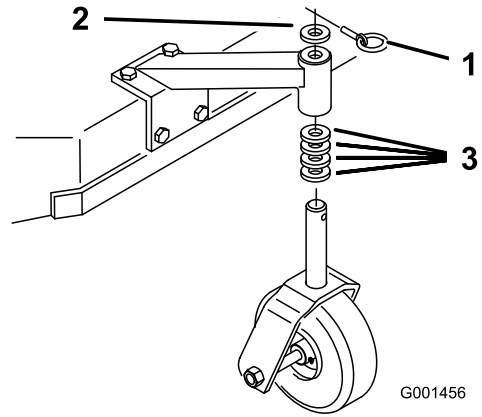

Figure 14

1. Latch pin
2. Spacer (5 mm or 3/16 inch)
3. Spacer (13 mm or 1/2 inch)

2. Remove the latch pin, slide the caster from the support, and change the spacers (Figure 14).
3. Install the caster in the support and insert the latch pin (Figure 14).

Height-of-Cut Chart

Axle position	Number of spacers below the caster		Number of 1/4-inch blade spacers below the spindle				
	13 mm (1/2 inch)	5 mm (3/16 inch)	4	3	2	1	0
A	0	0	26 mm (1 inch)	32 mm (1-1/4 inches)	38 mm (1-1/2 inches)	45 mm (1-3/4 inches)	51 mm (2 inches)
A	0	1	29 mm (1-1/8 inches)	35 mm (1-3/8 inches)	41 mm (1-5/8 inches)	48 mm (1-7/8 inches)	54 mm (2-1/8 inches)
A	1	0	35 mm (1-3/8 inches)	41 mm (1-5/8 inches)	48 mm (1-7/8 inches)	54 mm (2-1/8 inches)	60 mm (2-3/8 inches)
B	0	1	35 mm (1-3/8 inches)	41 mm (1-5/8 inches)	48 mm (1-7/8 inches)	54 mm (2-1/8 inches)	60 mm (2-3/8 inches)
B	1	0	41 mm (1-5/8 inches)	48 mm (1-7/8 inches)	54 mm (2-1/8 inches)	60 mm (2-3/8 inches)	67 mm (2-5/8 inches)
B	1	1	45 mm (1-3/4 inches)	51 mm (2 inches)	57 mm (2-1/4 inches)	64 mm (2-1/2 inches)	70 mm (2-3/4 inches)
B	2	0	51 mm (2 inches)	57 mm (2-1/4 inches)	64 mm (2-1/2 inches)	70 mm (2-3/4 inches)	76 mm (3 inches)
C	1	1	48 mm (1-7/8 inches)	54 mm (2-1/8 inches)	60 mm (2-3/8 inches)	67 mm (2-5/8 inches)	73 mm (2-7/8 inches)
C	2	0	55 mm (2-1/8 inches)	60 mm (2-3/8 inches)	67 mm (2-5/8 inches)	73 mm (2-7/8 inches)	79 mm (3-1/8 inches)
C	2	1	57 mm (2-1/4 inches)	64 mm (2-1/2 inches)	70 mm (2-3/4 inches)	76 mm (3 inches)	83 mm (3-1/4 inches)
C	3	0	64 mm (2-1/2 inches)	70 mm (2-3/4 inches)	76 mm (3 inches)	83 mm (3-1/4 inches)	89 mm (3-1/2 inches)
D	2	1	61 mm (2-3/8 inches)	67 mm (2-5/8 inches)	73 mm (2-7/8 inches)	79 mm (3-1/8 inches)	86 mm (3-3/8 inches)
D	3	0	64 mm (2-1/2 inches)	70 mm (2-3/4 inches)	76 mm (3 inches)	82 mm (3-1/4 inches)	89 mm (3-1/2 inches)
D	3	1	70 mm (2-3/4 inches)	76 mm (3 inches)	82 mm (3-1/4 inches)	89 mm (3-1/2 inches)	95 mm (3-3/4 inches)
D	4	0	76 mm (3 inches)	82 mm (3-1/4 inches)	89 mm (3-1/2 inches)	95 mm (3-3/4 inches)	102 mm (4 inches)
E	3	1	73 mm (2-7/8 inches)	79 mm (3-1/8 inches)	86 mm (3-3/8 inches)	92 mm (3-5/8 inches)	98 mm (3-7/8 inches)
E	4	0	79 mm (3-1/8 inches)	86 mm (3-3/8 inches)	92 mm (3-5/8 inches)	98 mm (3-7/8 inches)	105 mm (4-1/8 inches)
E	4	1	82 mm (3-1/4 inches)	89 mm (3-1/2 inches)	95 mm (3-3/4 inches)	102 mm (4 inches)	108 mm (4-1/4 inches)

After Operation

After Operation Safety

General Safety

- Always shut off the machine, remove the ignition key (if equipped), wait for all moving parts to stop, and allow the machine to cool before adjusting, servicing, cleaning, or storing it.
- Clean grass and debris from the machine to help prevent fires. Clean up oil or fuel spills.
- Never store the machine or fuel container where there is an open flame, spark, or pilot light, such as on a water heater or on other appliances.
- Use full-width ramps for loading the machine into a trailer or truck.
- Tie the machine down securely using straps, chains, cable, or ropes. Direct both front and rear straps down and outward from the machine.

Transporting the Machine

Use a heavy-duty trailer or truck to transport the machine. Ensure that the trailer or truck has all the necessary brakes, lighting, and marking required by the law. Carefully read all the safety instructions.

1. If using a trailer, connect it to the towing vehicle and connect the safety chains.
2. If applicable, connect the trailer brakes.
3. Load the machine on to the trailer or truck.
4. Park the machine on a level surface, engage the parking brake, shut off the engine, remove the key, and close the fuel valve.
5. Use the tie-down loops on the machine to securely fasten the machine to the towing vehicle with straps, chains, cable, or ropes (Figure 15).

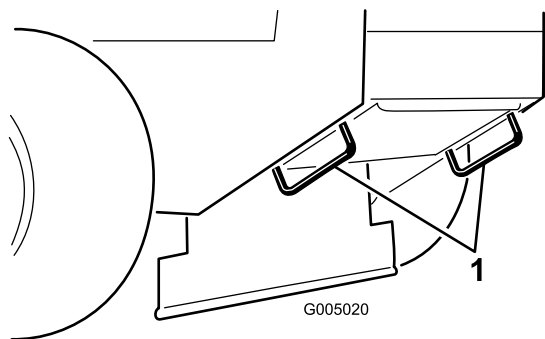

Figure 15

1. Tie-down loops

Maintenance

Note: Determine the left and right sides of the machine from the normal operating position.

Maintenance Safety

- Before adjusting, cleaning, servicing, or leaving the machine, do the following:
 - Park the machine on a level surface.
 - Move the throttle switch to the low-idle position.
 - Disengage the cutting units.
 - Ensure that the transmission is in neutral.
 - Engage the parking brake.
 - Shut off the engine and remove the key.
 - Wait for all moving parts to stop.
 - Allow machine components to cool before performing maintenance.
- Do not allow untrained personnel to service the machine.
- If the engine must be running to perform a maintenance adjustment, keep your hands, feet, clothing, and any parts of the body away from the cutting unit, attachments, and any moving parts. Keep bystanders away.
- Keep all parts in good working condition. Replace all worn, damaged, or missing parts and decals. Keep all fasteners tight to ensure that the machine is in safe working condition.
- Check the grass catcher components frequently and replace them when they are worn or damaged.
- Clean grass and debris from the cutting unit, drives, muffler, cooling screen, and the engine to help prevent fires. Clean up oil or fuel spills.
- Check the brake operation frequently. Adjust and service the brake as needed.
- Carefully release pressure from components with stored energy.
- To ensure safe, optimal performance of the machine, use only genuine Toro replacement parts. Replacement parts made by other manufacturers could be dangerous, and such use could void the product warranty.

Recommended Maintenance Schedule(s)

Maintenance Service Interval	Maintenance Procedure
After the first 8 hours	<ul style="list-style-type: none"> • Change the engine oil. • Check the mower belt tension.
After the first 25 hours	<ul style="list-style-type: none"> • Check the mower belt tension.
Before each use or daily	<ul style="list-style-type: none"> • Check the safety-interlock system. • Grease the caster wheels and caster pivot. • Check the engine-oil level. • Clean the air-intake screen. • Clean the grass and debris from the air-intake screen. • Check the parking brake. • Inspect the blades. • Clean the mower deck. • Clean the mower deck.
Every 25 hours	<ul style="list-style-type: none"> • Clean the foam air-cleaner element. • Check the battery electrolyte level. • Check the belts for wear or cracks.
Every 50 hours	<ul style="list-style-type: none"> • Grease the mower belt idler. • Check the paper air-cleaner element. • Check the tire pressure. • Check the traction-drive belt. • Check the mower belt tension.
Every 100 hours	<ul style="list-style-type: none"> • Change the engine oil. • Check the spark plugs. • Check and clean the engine-cooling fins and shrouds.

Maintenance Service Interval	Maintenance Procedure
Every 200 hours	<ul style="list-style-type: none"> • Replace the paper air-cleaner element. • Change the engine-oil filter. • Replace the fuel filter. • Replace the fuel-vent filter.
Every 250 hours	<ul style="list-style-type: none"> • Grease the transmission couplers (more often in dirty or dusty conditions).
Every 400 hours	<ul style="list-style-type: none"> • Grease the wheel bearings (more often in dirty or dusty conditions).
Before storage	<ul style="list-style-type: none"> • Paint any chipped surfaces. • Perform all maintenance procedures listed above before storing the machine.

Important: Refer to your engine owner's manual for additional maintenance procedures.

⚠ CAUTION

If you leave the key in the switch, someone could accidentally start the engine and seriously injure you or other bystanders.

Shut off the engine and remove the key from the switch before you perform any maintenance.

Lubrication

Greasing the Machine

Grease the machine more often in dirty or dusty conditions.

Grease Type: No. 2 lithium or molybdenum grease

1. Park the machine on a level surface, disengage the blade-control switch (PTO), and engage the parking brake.
2. Shut off the engine, remove the key, and wait for all moving parts to stop before leaving the operating position.
3. Clean the grease fittings with a rag.

Note: Scrape any paint off the front of the fitting(s).

4. Pump grease into the fittings until grease begins to ooze out of the bearings.
5. Wipe up any excess grease.

Lubricating the Caster and Wheel Bearings

1. Lubricate the front wheel bearings and front spindles (Figure 16).
2. Lubricate the drive-wheel bearings (Figure 16).

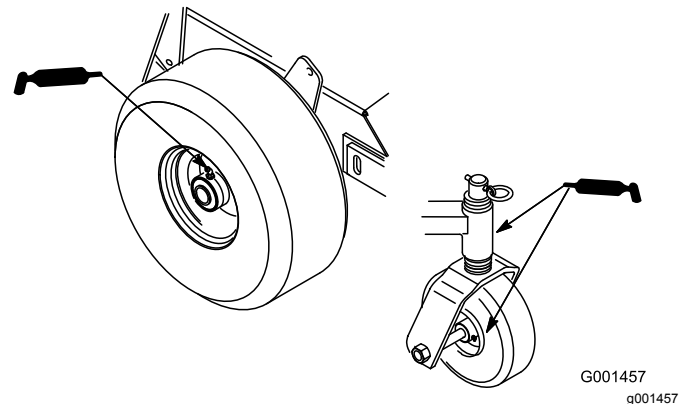

Figure 16

Greasing the Transmission Couplers

Lubricate the transmission couplers and idler-arm pivots located at the rear of the machine (Figure 17).

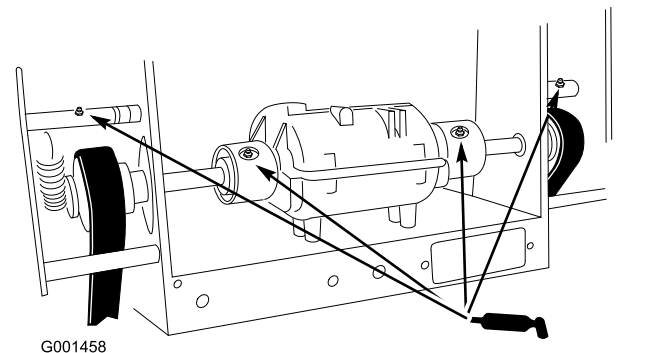

Figure 17

Greasing the Mower Belt Idler

Grease the fitting on the mower belt idler arm pivot (Figure 18).

Note: Remove the mower deck cover to access the grease fitting for the mower belt idler arm.

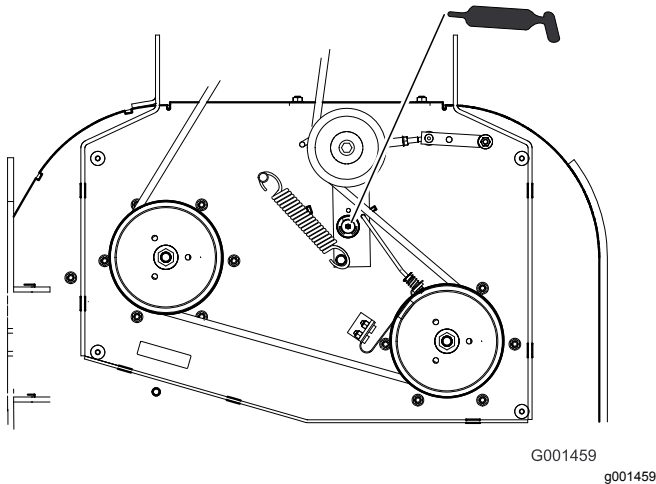

Figure 18

32-inch and 36-inch mower deck

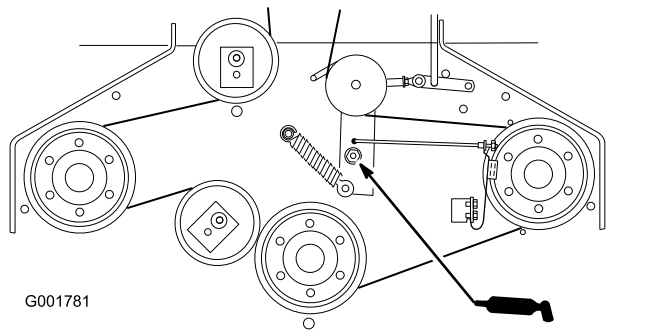

Figure 19

48-inch mower deck

Engine Maintenance

Engine Safety

- Do not change the governor speed or overspeed the engine.
- Run the engine dry or remove the fuel with a hand pump; never siphon the fuel. If you must drain the fuel tank, do it outdoors.

Servicing the Air Cleaner

Service Interval: Every 25 hours—Clean the foam air-cleaner element.

Every 50 hours—Check the paper air-cleaner element.

Every 200 hours—Replace the paper air-cleaner element.

Note: Service the air cleaner more frequently (every few operating hours) if the operating conditions are extremely dusty or sandy.

Important: Do not apply oil to the foam or paper element.

Removing the Foam and Paper Elements

1. Park the machine on a level surface, disengage the PTO, and engage the parking brake.
2. Shut off the engine, remove the key, and wait for all moving parts to stop before leaving the operating position.
3. Clean the area around the air cleaner to prevent dirt from entering the engine and causing damage (Figure 20).
4. Unscrew the cover knobs and remove the air-cleaner cover (Figure 20).
5. Unscrew the hose clamp and remove the air-cleaner assembly (Figure 20).
6. Carefully pull the foam element off the paper element (Figure 20).

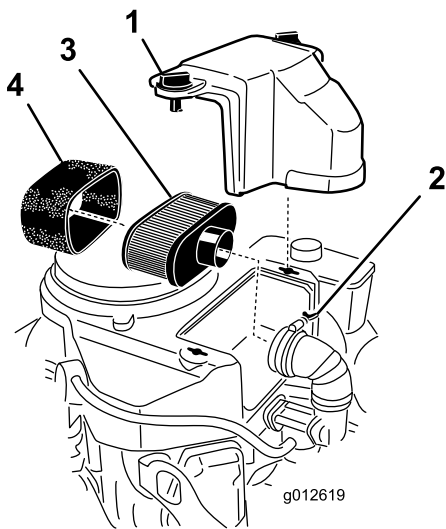

Figure 20

1. Cover
2. Hose clamp
3. Paper element
4. Foam element

Cleaning the Foam Air-Cleaner Element

1. Wash the foam element in liquid soap and warm water. When the element is clean, rinse it thoroughly.
2. Dry the element by squeezing it in a clean cloth.

Important: Replace the foam element if it is torn or worn.

Servicing the Paper Air-Cleaner Element

Important: Do not clean the paper filter, replace it (Figure 20).

1. Inspect the element for tears, an oily film, or damage to the rubber seal.
2. Replace the paper element if it is damaged.

Installing the Foam and Paper Elements

Important: To prevent engine damage, always operate the engine with the complete foam and paper air-cleaner assembly installed.

1. Carefully slide the foam element on to the paper air-cleaner element (Figure 20).
2. Place the air-cleaner assembly onto the air cleaner base and secure it with the 2 wing nuts (Figure 20).
3. Place the air-cleaner cover into position and tighten the cover knob (Figure 20).

Servicing the Engine Oil

Note: Change the oil more frequently when the operating conditions are extremely dusty or sandy.

Engine-Oil Specifications

Engine-Oil Type: Detergent oil (API service SF, SG, SH, SJ, or SL)

Crankcase Capacity: 1.7 L (58 oz) with the filter removed; 1.5 L (51 oz) without the filter removed

Viscosity: Refer to the table (Figure 21).

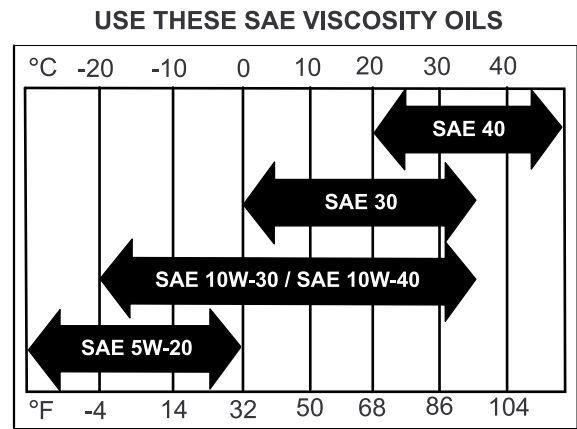

Figure 21

Checking the Engine-Oil Level

Service Interval: Before each use or daily—Check the engine-oil level.

1. Park the machine on a level surface, disengage the PTO, and engage the parking brake.
2. Shut off the engine, remove the key, and wait for all moving parts to stop before leaving the operating position.
3. Clean around the oil dipstick (Figure 22) so that dirt cannot fall into the filler hole and damage the engine.

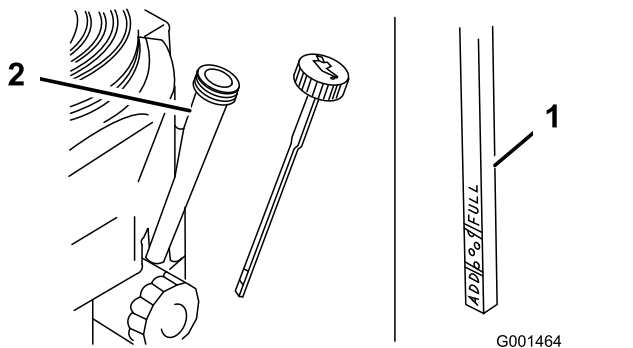

Figure 22

1. Oil dipstick
2. Filler tube

4. Unscrew the oil dipstick and wipe the end clean (Figure 22).
5. Slide the oil dipstick into the filler tube fully, but do not thread it onto the tube (Figure 22).
6. Pull the dipstick out and look at the end. If the oil level is low, slowly pour enough oil into the filler tube to raise the level to the Full mark.

Important: Do not overfill the crankcase with oil and run the engine, as this can damage the engine.

Changing the Engine Oil

Service Interval: After the first 8 hours—Change the engine oil.

Every 100 hours—Change the engine oil.

Every 200 hours—Change the engine-oil filter.

1. Start the engine and let it run for 5 minutes.
2. Park the machine so that the drain side is slightly lower than the opposite side, to ensure that the oil drains completely.
3. Disengage the PTO and engage the parking brake.
4. Shut off the engine, remove the key, and wait for all moving parts to stop before leaving the operating position.
5. Slide the drain hose over the oil-drain valve.
6. Place a drain pan below the drain hose.
7. Rotate the oil-drain valve to allow the oil to drain (Figure 23).
8. After the oil drains completely, close the drain valve.
9. Remove the drain hose (Figure 23).

Note: Dispose the used oil at a recycling center.

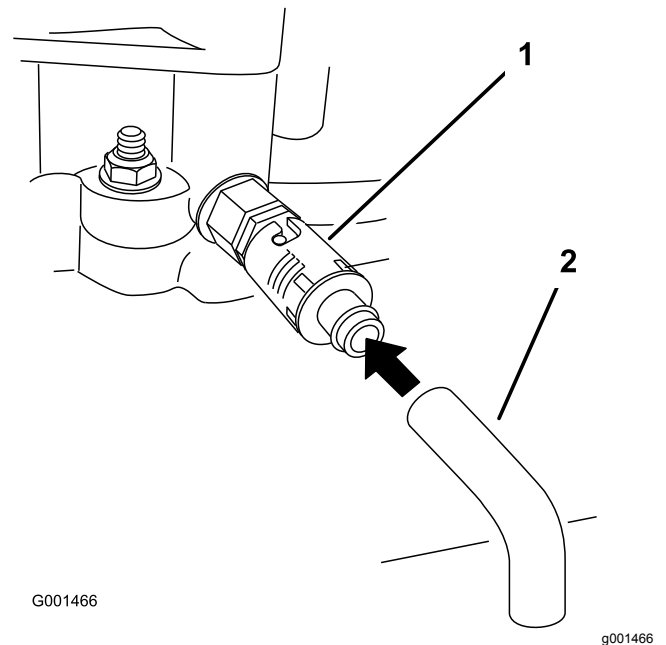

Figure 23

1. Oil-drain valve
2. Oil-drain hose

10. Slowly pour approximately 80% of the specified oil into the filler tube (Figure 22).
11. Check the engine-oil level.
12. Slowly add the additional oil to bring it to the Full mark.

Changing the Engine-Oil Filter

Note: Change the engine-oil filter more frequently when the operating conditions are extremely dusty or sandy.

1. Drain the oil from the engine.
2. Remove the old filter (Figure 24).

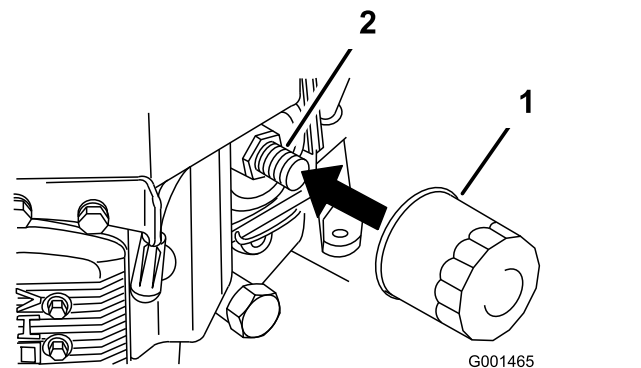

Figure 24

1. Engine-oil filter
2. Adapter

3. Apply a thin coat of new oil to the rubber gasket on the replacement filter (Figure 24).

4. Install the replacement oil filter to the filter adapter, turn the oil filter clockwise until the rubber gasket contacts the filter adapter, and tighten the filter an additional 3/4 turn (Figure 24).
5. Fill the crankcase with the proper type of new oil.
6. Run the engine for approximately 3 minutes, shut off the engine, and check for oil leaks around the oil filter and drain valve.
7. Check the engine-oil level and add oil, if needed.
8. Wipe up any spilled oil.

Servicing the Spark Plugs

Service Interval: Every 100 hours/Yearly (whichever comes first) Replace the spark plugs if necessary.

Type: Champion RCJ8Y (or equivalent)

Air Gap: 0.762 mm (0.03 inch)

Important: A cracked, fouled, dirty, or malfunctioning spark plug must be replaced. Do not sand-blast, scrape, or clean electrodes by using a wire brush because grit may eventually release from the plug and fall into the cylinder. The result is usually a damaged engine.

Note: The plug should be removed and checked whenever the engine malfunctions.

Removing the Spark Plugs

1. Park the machine on a level surface, disengage the PTO, and engage the parking brake.
2. Shut off the engine, remove the key, and wait for all moving parts to stop before leaving the operating position.
3. Disconnect the spark-plug wires (Figure 25).

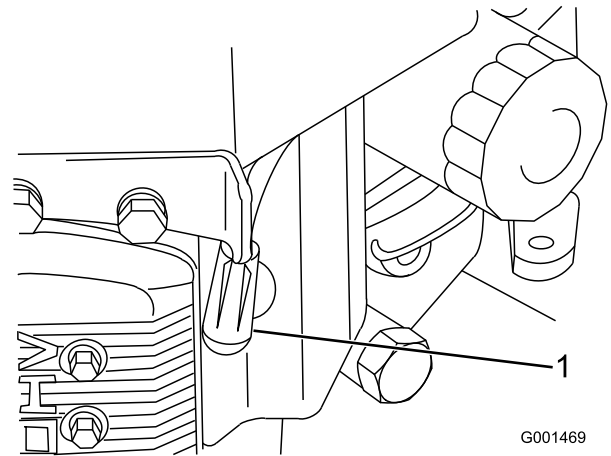

Figure 25

1. Spark plug
-
4. Clean around the spark plugs to prevent dirt from entering the engine and potentially causing damage.
 5. Remove the spark plugs and the washers.

Checking the Spark Plugs

1. Look at the center of the spark plugs (Figure 26).

Note: If you see light brown or gray on the insulator, the engine is operating properly. A black coating on the insulator usually means that the air cleaner is dirty.

2. If needed, clean the spark plug with a wire brush to remove carbon deposits.

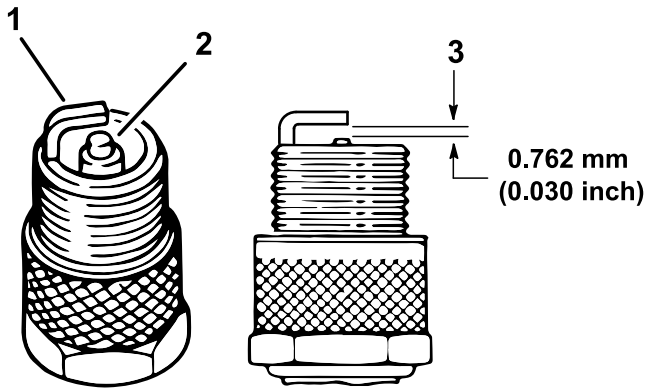

Figure 26

g238425

1. Side electrode
2. Center electrode insulator
3. Air gap (not to scale)

Important: Always replace the spark plugs when it has worn electrodes, an oily film on it, or has cracks in the porcelain.

3. Check the gap between the center and side electrodes (Figure 26).

Note: Bend the side electrode (Figure 26) if the gap is not correct.

Installing the Spark Plugs

1. Install the spark plugs and the metal washer. Ensure that the air gap is set correctly.
2. Tighten the spark plugs to 22 N·m (16 ft-lb).
3. Install the spark-plug wire (Figure 26).

Fuel System Maintenance

⚠ DANGER

In certain conditions, fuel is extremely flammable and highly explosive. A fire or explosion from fuel can burn you and others and can damage property.

Refer to [Adding Fuel \(page 11\)](#) for a complete list of fuel related precautions.

Servicing the Fuel System

Draining the Fuel Tank

1. Park the machine on a level surface, disengage the PTO, and engage the parking brake.
2. Shut off the engine, remove the key, and wait for all moving parts to stop before leaving the operating position.
3. Close the fuel-shutoff valve at the fuel tank (Figure 27).
4. Squeeze the ends of the hose clamp together and slide it up the fuel line away from the fuel filter (Figure 27).
5. Pull the fuel line off the fuel filter (Figure 27).
6. Open the fuel-shutoff valve and allow the fuel to drain into a fuel container or drain pan.

Note: Now is the best time to install a new fuel filter, because the fuel tank is empty; refer to [Replacing the Fuel Filter \(page 29\)](#).

7. Install the fuel line to the fuel filter.

Slide the hose clamp close to the valve to secure the fuel line.

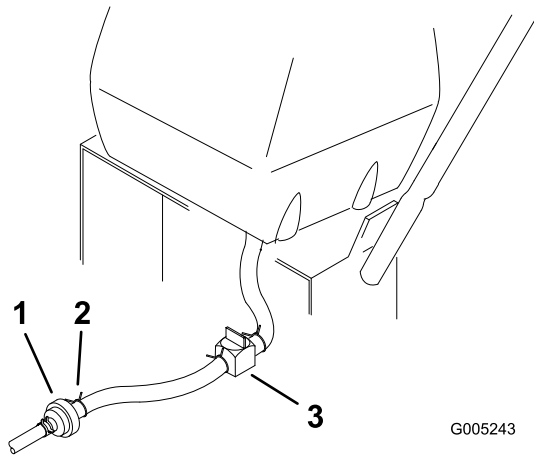

G005243

g005243

Figure 27

- | | |
|----------------|-----------------------|
| 1. Fuel filter | 3. Fuel-shutoff valve |
| 2. Clamp | |

8. Wipe up any spilled fuel.

Replacing the Fuel Filter

Service Interval: Every 200 hours/Yearly (whichever comes first)

Important: Never install a dirty filter if it is removed from the fuel line.

1. Park the machine on a level surface, disengage the PTO, and engage the parking brake.
2. Shut off the engine, remove the key, and wait for all moving parts to stop before leaving the operating position.
3. Close the fuel-shutoff valve at the fuel tank (Figure 27).
4. Squeeze the ends of the hose clamps together and slide them away from the filter (Figure 28).

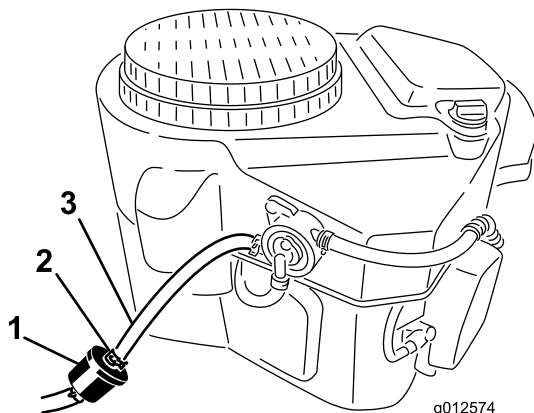

g012574

g012574

Figure 28

- | | |
|----------------|--------------|
| 1. Fuel filter | 3. Fuel line |
| 2. Hose clamp | |

5. Remove the filter from the fuel lines.

6. Install a new filter and move the hose clamps close to the filter.
7. Open the fuel-shutoff valve at the fuel tank (Figure 27).
8. Check for fuel leaks and repair, if needed.
9. Wipe up any spilled fuel.

Servicing the Fuel-Vent System

Service Interval: Every 200 hours/Yearly (whichever comes first)

1. Park the machine on a level surface, disengage the PTO, and engage the parking brake.
2. Shut off the engine, remove the key, and wait for all moving parts to stop before leaving the operating position.
3. Remove the existing fuel-vent filter (Figure 29).
4. Install a new fuel-vent filter.

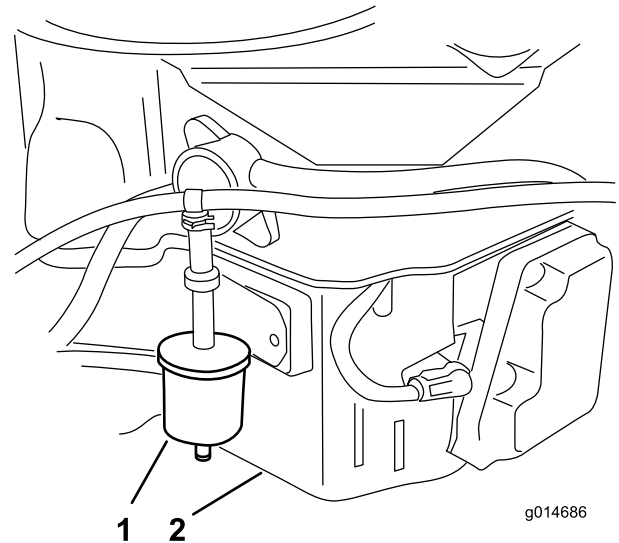

g014686

g014686

Figure 29

- | | |
|---------------------|-----------------------------|
| 1. Fuel-vent filter | 2. Right side of the engine |
|---------------------|-----------------------------|

Electrical System Maintenance

Electrical System Safety

- Disconnect the battery before repairing the machine. Disconnect the negative terminal first and the positive last. Connect the positive terminal first and the negative last.
- Charge the battery in an open, well-ventilated area, away from sparks and flames. Unplug the charger before connecting or disconnecting the battery. Wear protective clothing and use insulated tools.

Servicing the Battery

Battery voltage: 12 V with 300 A (cold-cranking) at -18°C (0°F).

- Always keep the battery clean and fully charged.
- If the battery terminals are corroded, clean them with a solution of 4 parts water and 1 part baking soda.
- Apply a light coating of grease to the battery terminals to prevent corrosion.

Removing the Battery

⚠ WARNING

Incorrect battery cable routing could damage the machine and cables, causing sparks. Sparks can cause the battery gasses to explode, resulting in personal injury.

- **Always disconnect the negative (black) battery cable before disconnecting the positive (red) cable.**
- **Always connect the positive (red) battery cable before connecting the negative (black) cable.**
- **Always keep the battery strap in place to protect and secure the battery.**

⚠ WARNING

Battery terminals or metal tools could short against metal machine components, causing sparks. Sparks can cause the battery gasses to explode, resulting in personal injury.

- **When removing or installing the battery, do not allow the battery terminals to touch any metal parts of the machine.**
- **Do not allow metal tools to short between the battery terminals and metal parts of the machine.**

1. Park the machine on a level surface, disengage the PTO, and engage the parking brake.
2. Shut off the engine, remove the key, and wait for all moving parts to stop before leaving the operating position.
3. Remove the black rubber cover from the negative cable and disconnect the negative battery cable from the negative (-) battery terminal (Figure 30).
4. Slide the red terminal boot off the positive (+) battery terminal, and remove the positive battery cable (Figure 30).
5. Remove the battery hold-down plate (Figure 30) and remove the battery.

Installing the Battery

1. Place the battery in the machine (Figure 30).
2. Secure the battery with the hold-down plate, j-bolts, and locknuts (Figure 30).
3. Install the positive (red) battery cable to positive (+) battery terminal with a nut, washer, and bolt (Figure 30).
4. Slide the rubber cover over the post.
5. Install the negative battery cable and ground wire to the negative (-) battery terminal with a nut, washer, and bolt (Figure 30).
6. Slide the rubber cover over the post.

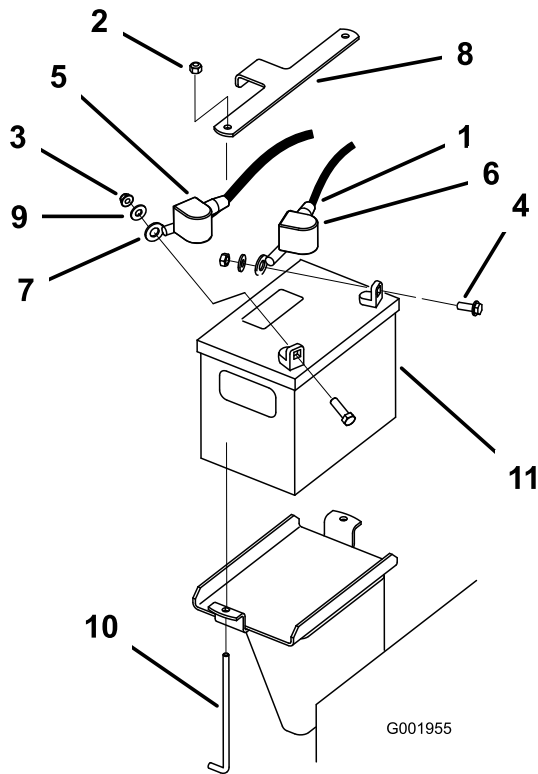

Figure 30

G001955

- | | |
|--------------------------------|----------------------------------|
| 1. J-bolt | 7. Wing nut |
| 2. Positive battery cable | 8. Negative battery cable |
| 3. Washer | 9. Negative (black) rubber cover |
| 4. Nut (5/16 inch) | 10. Bolt |
| 5. Positive (red) rubber cover | 11. Battery |
| 6. Battery hold-down | |

Checking the Battery Electrolyte Level

Service Interval: Every 25 hours

⚠ DANGER

Battery electrolyte contains sulfuric acid which is a deadly poison and causes severe burns.

- **Do not drink electrolyte and avoid contact with skin, eyes or clothing. Wear safety glasses to shield your eyes and rubber gloves to protect your hands.**
- **Fill the battery where clean water is always available for flushing the skin.**

1. Look at the side of the battery. The electrolyte must be at the upper line (Figure 31).

Do not allow the electrolyte to fall below the lower line (Figure 31).

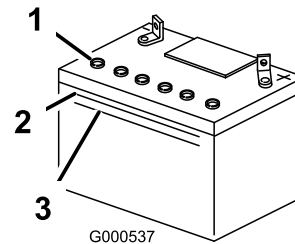

Figure 31

G000537

- | | |
|---------------|---------------|
| 1. Vent caps | 3. Lower line |
| 2. Upper line | |

2. If the electrolyte is low, add the required amount of distilled water; refer to [Adding Water to the Battery \(page 31\)](#).

Adding Water to the Battery

The best time to add distilled water to the battery is just before you operate the machine. This lets the water mix thoroughly with the electrolyte solution.

1. Remove the battery from the machine; refer to [Removing the Battery \(page 30\)](#).

Important: Never fill the battery with distilled water while the battery is installed in the machine. Electrolyte could be spilled on other parts and cause corrosion.

2. Clean the top of the battery with a paper towel.
3. Remove the vent caps from the battery (Figure 31).
4. Slowly pour distilled water into each battery cell until the electrolyte level is up to the upper line (Figure 31) on the battery case.

Important: Do not overfill the battery because electrolyte (sulfuric acid) can cause severe corrosion and damage to the machine.

5. Wait for 5 to 10 minutes after filling the battery cells.
6. Add distilled water, if necessary, until the electrolyte level is up to the upper line (Figure 31) on the battery case.
7. Install the battery vent caps.

Charging the Battery

⚠ WARNING

Charging the battery produces gasses that can explode.

Never smoke near the battery and keep sparks and flames away from battery.

Important: Always keep the battery fully charged (1.260 specific gravity). This is especially important to prevent battery damage when the temperature is below 0°C (32°F).

1. Remove the battery from the machine; refer to [Removing the Battery \(page 30\)](#).
2. Check the electrolyte level; refer to [Checking the Battery Electrolyte Level \(page 31\)](#).
3. Ensure that the filler caps are installed.
4. Connect a 3 to 4 A battery charger to the battery posts. Charge the battery at a rate of 3 to 4 A for 4 to 8 hours (12 V).

Note: Do not overcharge the battery.

5. When the battery is fully charged, unplug the charger from the electrical outlet, and disconnect the charger leads from the battery posts ([Figure 32](#)).
6. Install the battery; refer to [Installing the Battery \(page 30\)](#).

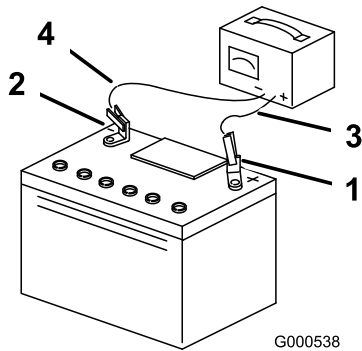

Figure 32

- | | |
|--------------------------|---------------------------|
| 1. Positive battery post | 3. Red (+) charger lead |
| 2. Negative battery post | 4. Black (-) charger lead |

Drive System Maintenance

Checking the Tire Pressure

Service Interval: Every 50 hours/Monthly (whichever comes first)

Maintain the air pressure in the rear tires at 83 to 97 kPa (12 to 14 psi). Uneven tire pressure can cause an uneven cut ([Figure 33](#)).

Note: The front tires are semi-pneumatic tires and do not require air-pressure maintenance.

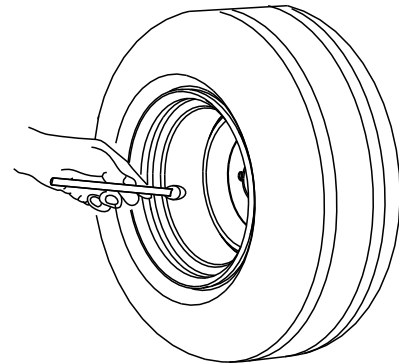

G001055

Figure 33

g001055

Storing the Battery

If you are storing the machine for more than 30 days, remove the battery and charge it fully. Either store it on the shelf or on the machine. Leave the cables disconnected if it is stored on the machine. Store the battery in a cool atmosphere to avoid quick deterioration of the charge in the battery. To prevent the battery from freezing, make sure that it is fully charged.

Cooling System Maintenance

Cleaning the Air-Intake Screen

Remove any buildup of grass, dirt, or other debris from the cylinder and cylinder head cooling fins, the air-intake screen on the flywheel end, and the carburetor-governor levers and linkage. This helps ensure adequate cooling and correct engine speed to reduce the possibility of overheating or mechanical damage to the engine.

Cleaning the Cooling System

Service Interval: Before each use or daily

Every 100 hours/Yearly (whichever comes first)

1. Park the machine on a level surface, disengage the PTO, and engage the parking brake.
2. Shut off the engine, remove the key, and wait for all moving parts to stop before leaving the operating position.
3. Remove the air-intake screen, recoil starter, and fan housing (Figure 34).
4. Clean the debris and grass from the engine parts.
5. Install the air-intake screen, recoil starter, and fan housing (Figure 34).

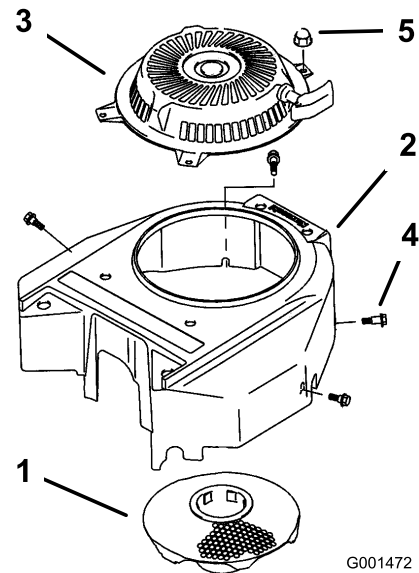

Figure 34

- | | |
|----------------------|---------|
| 1. Air-intake screen | 4. Bolt |
| 2. Fan housing | 5. Nut |
| 3. Recoil starter | |

Brake Maintenance

Servicing the Parking Brake

Check the brakes on both a level surface and a slope.

Always engage the parking brake when you stop the machine or leave it unattended. If the parking brake does not hold securely, adjust it.

Checking the Parking Brake

Service Interval: Before each use or daily

1. Park the machine on a level surface and disengage the PTO.
2. Shut off the engine, remove the key, and wait for all moving parts to stop before leaving the operating position.
3. Engage the parking brake.
Note: The wheels must lock when you try to push the machine forward.
4. If the wheels do not lock, adjust the brakes; refer to [Adjusting the Parking Brake \(page 34\)](#).
5. Disengage the brakes and move the neutral/brake locks to the NEUTRAL position.

Note: The wheels should rotate freely. If not, refer to [Adjusting the Parking Brake \(page 34\)](#).

Adjusting the Parking Brake

If the parking brakes do not hold securely, adjust them.

1. Check the brakes before you adjust them; refer to [Checking the Parking Brake \(page 34\)](#).
2. Disengage the parking brakes.
3. To adjust the brakes, rotate the wing nuts on the brake rods ([Figure 35](#)).

Rotate the wing nuts clockwise to tighten the brakes; rotate them counterclockwise to loosen them.

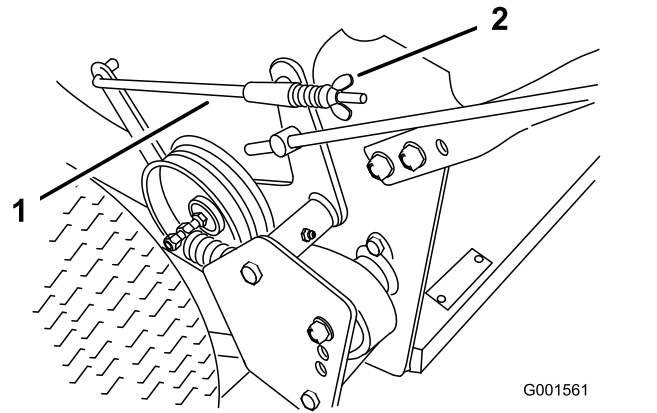

Figure 35

1. Brake rod
 2. Wing nut
-
4. Position the wing nuts so that the brakes engage when you squeeze the drive levers enough to place the neutral/parking brake locks forward, and engage the brakes.
 5. Check the operation of the brakes; refer to [Checking the Parking Brake \(page 34\)](#).
Important: When you disengage the parking brakes, the rear wheels should rotate freely when you push the machine. If they do not, contact an Authorized Service Dealer immediately.
 6. Check the control rod length, refer to [Adjusting the Control Rods \(page 41\)](#).

Belt Maintenance

Inspecting the Belts

Service Interval: Every 25 hours—Check the belts for wear or cracks.

Replace the belt if it is worn. The signs of a worn belt include squealing while the belt is rotating; the blades slipping while cutting grass; and frayed edges, burn marks, and cracks on the belt.

Adjusting the Wheel Drive Belt Tension

You may need to increase the wheel drive belt tension under certain operating conditions, such as mowing over hilly terrain or while pulling a sully.

1. Shut off the engine, remove the key, and wait for all moving parts to stop.
2. Disconnect the spark-plug wires.
3. Disengage the neutral/parking brake locks and release the drive levers to reduce the spring force.
4. Remove the drive spring from the adjustment bolt (Figure 36).

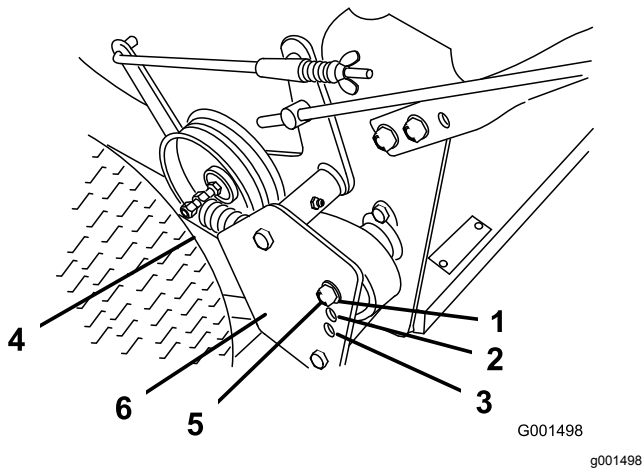

Figure 36

- | | |
|---------------|------------------------------------|
| 1. Position A | 4. Drive spring |
| 2. Position B | 5. Adjustment bolt (in position A) |
| 3. Position C | 6. Drive pulley shield |

5. Remove the locknut securing the adjustment bolt to the drive pulley shield (Figure 36).
6. Locate the bolt assembly in the desired tension position as follows:
 - Position A for normal conditions
 - Position B for more severe conditions
 - Position C for the most severe conditions

Note: The wheel drive tension is lowest when the bolt assembly is in position A. The tension increases in positions B and C (Figure 36).

7. Install the adjustment bolt and the drive spring.
8. Repeat this procedure on the other side.

Replacing the Traction-Drive Belt

Service Interval: Every 50 hours/Monthly (whichever comes first)—Check the traction-drive belt.

1. Park the machine on a level surface, disengage the PTO, and engage the parking brake.
2. Shut off the engine, remove the key, and wait for all moving parts to stop before leaving the operating position.
3. Remove the hairpin cotter securing the brake rod to the brake arm to relax the tension on the belt idler (Figure 37).
4. Remove the bottom bolt and loosen the top bolt of the shield to rotate it for belt clearance (Figure 37).
5. Lift the belt past the idler and off the drive pulley (Figure 37).
6. Raise the wheel off the ground enough to remove the belt.
7. Replace the traction-drive belt.
8. Secure the shield with the previously removed bolt and tighten the bolts (Figure 37).
9. Secure the brake rod to the brake arm with the hairpin cotter (Figure 37).

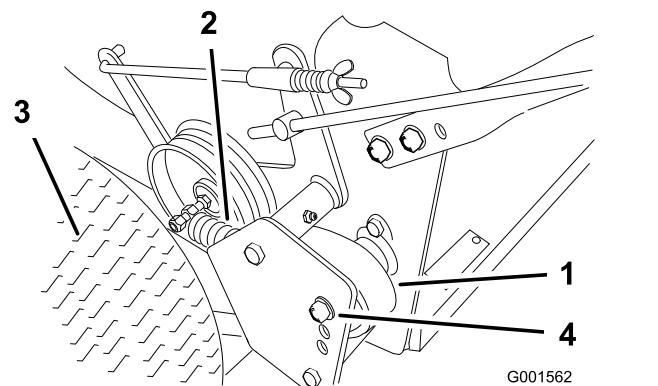

Figure 37

- | | |
|-----------------|--------------------|
| 1. Drive belt | 3. Tire |
| 2. Drive spring | 4. Adjustment bolt |

Replacing the Drive Belt

1. Park the machine on a level surface, disengage the PTO, and engage the parking brake.
2. Shut off the engine, remove the key, and wait for all moving parts to stop before leaving the operating position.
3. Raise the rear of the machine and hold it up with jack stands.
4. Remove the mower belt (Figure 38).

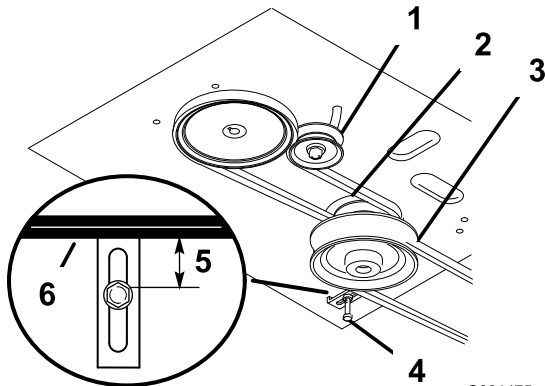

Figure 38

- | | |
|-----------------------------|---------------------|
| 1. Idler pulley in the slot | 4. Belt guide |
| 2. Traction belt | 5. 19 mm (3/4 inch) |
| 3. Mower belt | 6. Traction belt |

5. Loosen the pivot bolt enough to slide the idler pulley in the slot, and remove the traction belt from the engine and drive pulleys (Figure 38).
6. Install the new drive belt around the engine and drive pulleys (Figure 38).
7. Slide the idler pulley in the engine frame to tension the traction belt (Figure 38).
8. Install the mower belt (Figure 38).
9. Check the belt guide under the engine frame for the proper adjustment (Figure 38).

Note: The distance between the belt guide and mower belt should be 19 mm (3/4 inch) when you engage the mower belt. Adjust the belt, if necessary. The disengaged belt should not drag or fall off the pulley when the guides are properly adjusted.

Replacing the Mower Belt

Important: The brake needs to be adjusted when the belt tension or the brake linkage is adjusted.

1. Park the machine on a level surface, disengage the PTO, and engage the parking brake.

2. Shut off the engine, remove the key, and wait for all moving parts to stop before leaving the operating position.
3. Remove the knobs and belt cover from the mower.
4. Remove the idler pulley and worn belt.
5. Install the new mower belt.
6. Install the idler pulley.
7. Engage the PTO and check the belt tension.

Note: The proper mower belt tension is 44 to 67 N·m (10 to 15 ft-lb) with the belt deflected 13 mm (1/2 inch) halfway between the pulleys (Figure 42 or Figure 43).

8. Engage the PTO.
9. Check the clearance between the bell crank and transmission-output shaft (Figure 39).

Note: The clearance should be 2 to 3 mm (1/16 to 1/8 inch).

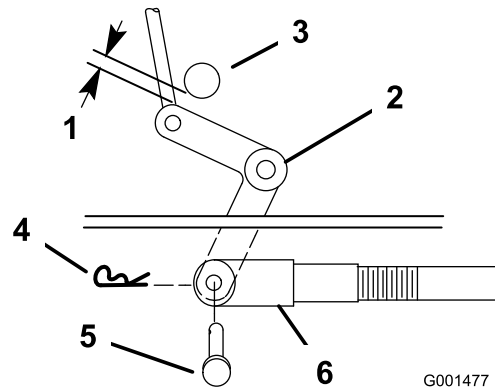
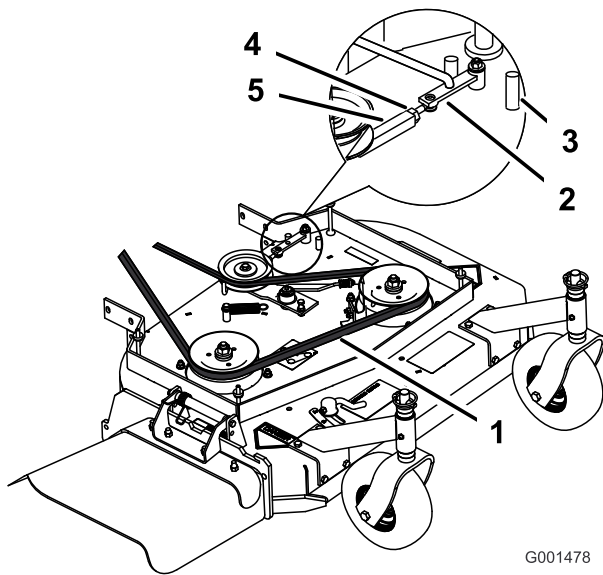

Figure 39

- | | |
|---------------------------------|-------------------|
| 1. 2 to 3 mm (1/16 to 1/8 inch) | 4. Hairpin cotter |
| 2. Bell crank | 5. Clevis pin |
| 3. Transmission-output shaft | 6. Clevis |

10. Remove the hairpin cotter and clevis pin from the bell crank (Figure 39).
11. Rotate the clevis clockwise on the rod to increase the clearance; rotate it counterclockwise to decrease it (Figure 39).
12. Disengage the PTO.

Note: If the assist arm does not contact the front stop on the mower deck (Figure 40 or Figure 41), adjust the clevis to bring the bell crank closer to the transmission-output shaft (Figure 39).



G001478

g001478

Figure 40

32-inch and 36-inch mower deck

- | | |
|-------------------------------------|---------------|
| 1. 13 mm (1/2 inch) deflection here | 4. Locknut |
| 2. Assist arm | 5. Turnbuckle |
| 3. Front stop | |

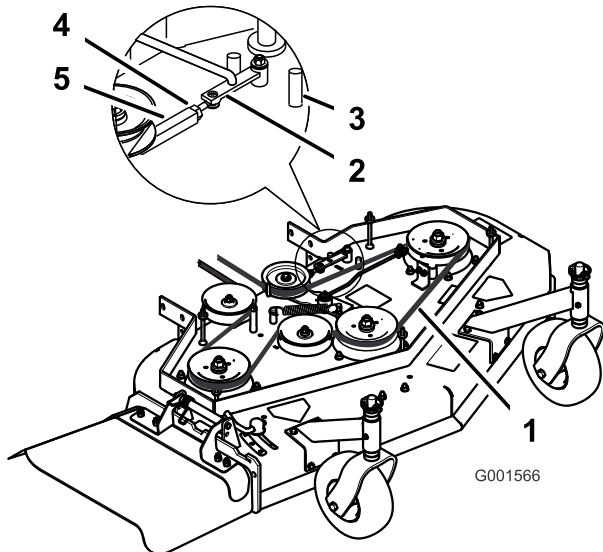

G001566

g001566

Figure 41

48-inch mower deck

- | | |
|-------------------------------------|---------------|
| 1. 13 mm (1/2 inch) deflection here | 4. Locknut |
| 2. Assist arm | 5. Turnbuckle |
| 3. Front stop | |

mower belt as necessary. The disengaged belt should not drag or fall off the pulley when the guides are properly adjusted.

Adjusting the Mower Belt Tension

Adjusting the Tension for 32-inch and 36-inch Mower Decks

Service Interval: After the first 8 hours—Check the mower belt tension.

After the first 25 hours—Check the mower belt tension.

Every 50 hours—Check the mower belt tension.

Important: Adjust the brake whenever you adjust the belt tension or brake linkage.

Important: The belt must be tight enough to not slip during heavy loads, while cutting grass. Over-tensioning the belt reduces the life of the spindle bearing, belt, and idler pulley.

The belt must be tight enough so that it does not slip during heavy loads while cutting grass, and over-tensioning will reduce belt and spindle bearing life.

1. Park the machine on a level surface, disengage the PTO, and engage the parking brake.
2. Shut off the engine, remove the key, and wait for all moving parts to stop before leaving the operating position.
3. Loosen the locknut on the turnbuckle (Figure 42).
4. Adjust the tension of the belt.
 - Rotate the turnbuckle toward the rear of the machine to increase the tension on the belt.
 - Rotate the turnbuckle toward the front of the machine to decrease the tension on the belt (Figure 42).

Note: The eyebolt threads on both ends of the turnbuckle should be engaged a minimum of 8 mm (5/16 inch).

5. Engage the PTO and check the belt tension. Adjust the tension until it is correct.

Note: The proper mower belt tension is 44 to 67 N·m (10 to 15 ft·lb) with the belt deflected 13 mm (1/2 inch) halfway between the pulleys (Figure 42).

13. Check the belt guide under the engine frame for the proper adjustment (Figure 38).

Note: The distance between the belt guide and mower belt should be 32 mm (1-1/4 inches) when you engage the mower belt. Adjust the

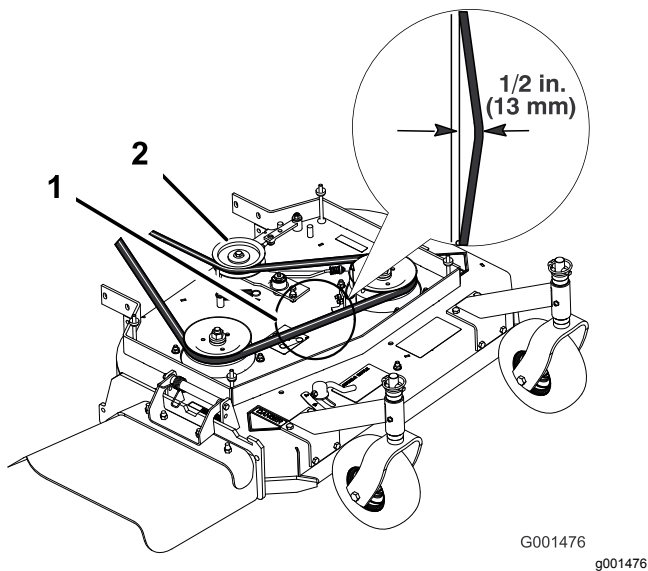

Figure 42

32-inch and 36-inch mower deck shown

1. Mower belt with 13 mm (1/2 inch) deflection
2. Idler pulley

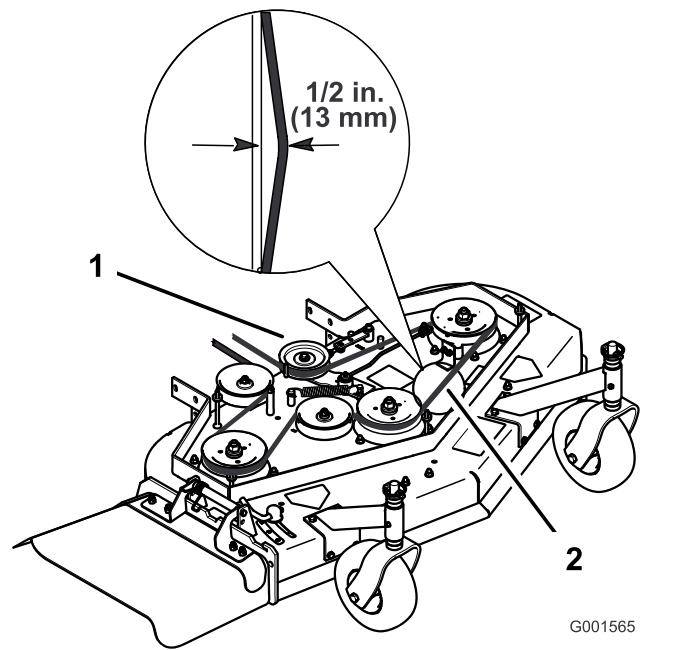

Figure 43

48-inch mower deck shown

1. Idler pulley
2. Mower belt with 13 mm (1/2 inch) deflection

6. Tighten the locknut on the turnbuckle.
7. Check the adjustment of the blade brake; refer to [Adjusting the Blade Brake \(page 44\)](#).

Adjusting the Tension for 48-inch Mower Decks

Important: Adjust the brake whenever you adjust the belt tension or brake linkage.

Important: The belt must be tight enough to not slip during heavy loads, while cutting grass. Over-tensioning the belt reduces the life of the spindle bearing, belt, and idler pulley.

1. Park the machine on a level surface, disengage the PTO, and engage the parking brake.
2. Shut off the engine, remove the key, and wait for all moving parts to stop before leaving the operating position.
3. Loosen the locknut on the turnbuckle ([Figure 44](#)).
4. Adjust the tension of the belt.
 - Rotate the turnbuckle toward the rear of the machine to increase the tension on the belt.
 - Rotate the turnbuckle toward the front of the machine to decrease the tension on the belt ([Figure 43](#)).

Note: The eyebolt threads on both ends of the turnbuckle should be engaged a minimum of 8 mm (5/16 inch).

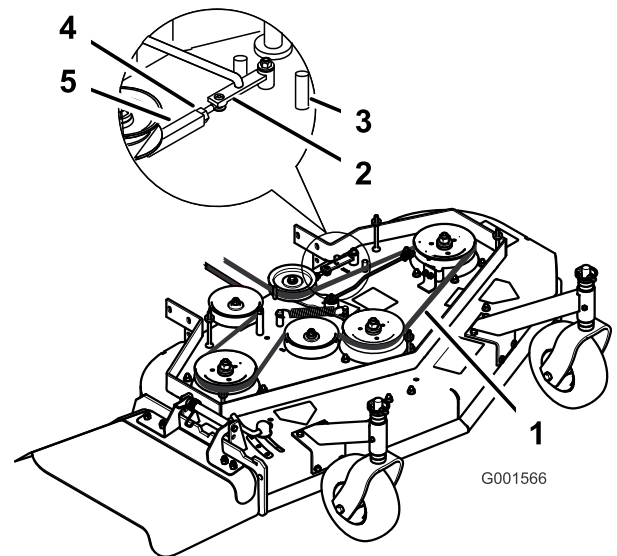

Figure 44

1. 13 mm (1/2 inch) deflection here
2. Assist arm
3. Front stop
4. Locknut
5. Turnbuckle

5. Engage the PTO and check the belt tension. Adjust the tension until it is correct.

Note: The proper mower belt tension is 44 to 67 N·m (10 to 15 ft-lb) with the belt deflected 13 mm (1/2 inch) halfway between the pulleys ([Figure 43](#)).

6. If there is no adjustment remaining in the turnbuckle and the belt is still loose, the rear idler pulley needs to be positioned to the middle or front hole ([Figure 45](#)). Use the hole that provides the correct adjustment.
7. When you move the idler pulley, you must move the belt guide. Move the belt guide to the front position ([Figure 45](#)).

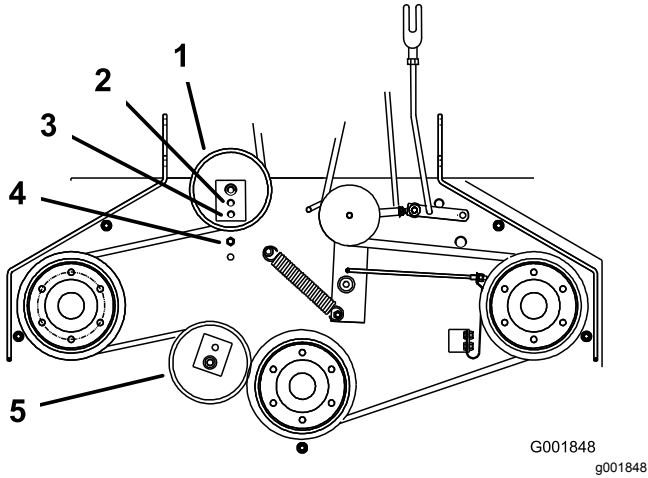

Figure 45

- | | |
|----------------------|------------------------------------|
| 1. Rear idler pulley | 4. Belt guide in the back position |
| 2. Middle hole | 5. Front idler pulley |
| 3. Front hole | |

8. Check the belt guide under the engine frame for proper adjustment ([Figure 46](#)).

Note: The distance between the belt guide and the mower belt should be 19 mm (3/4 inch) when you engage the mower belt ([Figure 46](#)). Adjust the mower belt as necessary. The disengaged belt should not drag or fall off the pulley when the guides and belt tension are properly adjusted.

9. Check the adjustment of the blade brake; refer to [Adjusting the Blade Brake](#) (page 44).

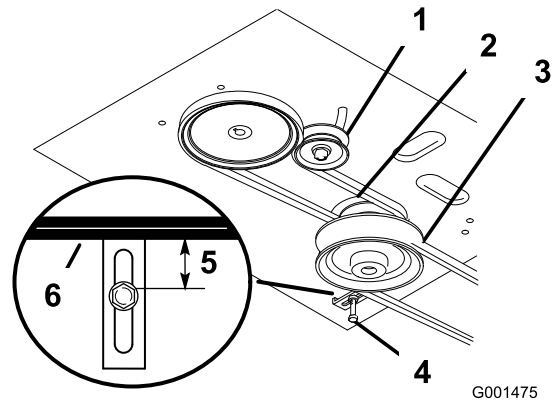

Figure 46

- | | |
|-----------------------------|---------------------|
| 1. Idler pulley in the slot | 4. Belt guide |
| 2. Traction belt | 5. 19 mm (3/4 inch) |
| 3. Mower belt | 6. Mower belt |

Adjusting the PTO-Engagement Linkage

The adjustment for the PTO-engagement linkage is located beneath the front, left corner of the engine deck.

1. Park the machine on a level surface, disengage the PTO, and engage the parking brake.
2. Shut off the engine, remove the key, and wait for all moving parts to stop before leaving the operating position.
3. Engage PTO.
4. Adjust the linkage length to where the lower end of the bellcrank just clears the axle-support gusset ([Figure 47](#)).

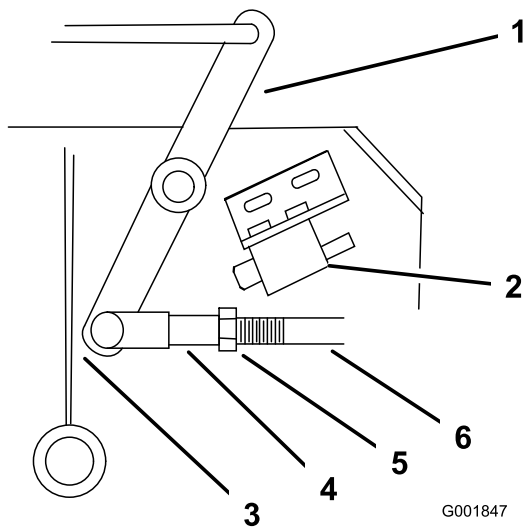

G001847

Figure 47

- | | |
|--|--------------------|
| 1. Bellcrank | 4. Yoke |
| 2. Safety switch located under the engine deck | 5. Nut |
| 3. Bellcrank just clears the gusset with the PTO engaged | 6. Assist-arm link |

5. Ensure that the assist arm is against the rear assist-arm stop on the deck (Figure 48).
6. Disengage the PTO.
7. The assist arm should contact the front assist-arm stop on the deck. If it does not contact, adjust the bellcrank so that it is closer to the gusset (Figure 48).

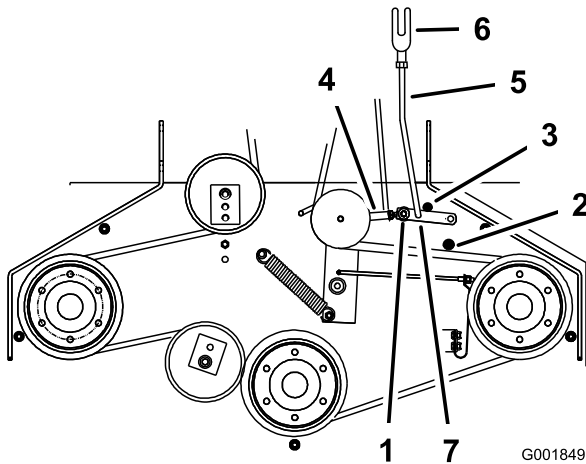

G001849

Figure 48

- | | |
|--------------------------|--------------------|
| 1. Yoke | 5. Assist-arm link |
| 2. Nut | 6. Assist arm |
| 3. Rear assist-arm stop | 7. Turnbuckle |
| 4. Front assist-arm stop | |

8. To adjust the assist-arm link, remove the hairpin cotter from the assist arm (Figure 48).

9. Loosen the nut against the yoke (Figure 47).
10. Remove the assist-arm link from the assist arm and rotate the link to adjust the length.
11. Install the assist-arm link into the assist arm and secure it with the hairpin cotter (Figure 48).
12. Check if the assist arm hits against the stops correctly.

Adjusting the PTO-Safety Switch

1. Park the machine on a level surface, disengage the PTO, and engage the parking brake.
2. Shut off the engine, remove the key, and wait for all moving parts to stop before leaving the operating position.
3. Ensure that the assist arm is against the front assist-arm stop.
4. If needed, adjust the PTO-safety switch by loosening the bolts securing the switch bracket (Figure 49).
5. Move the mounting bracket until the bellcrank presses the plunger by 6 mm (1/4 inch).

Important: Ensure that the bellcrank does not touch the switch body; otherwise, damage to the switch could occur (Figure 49).

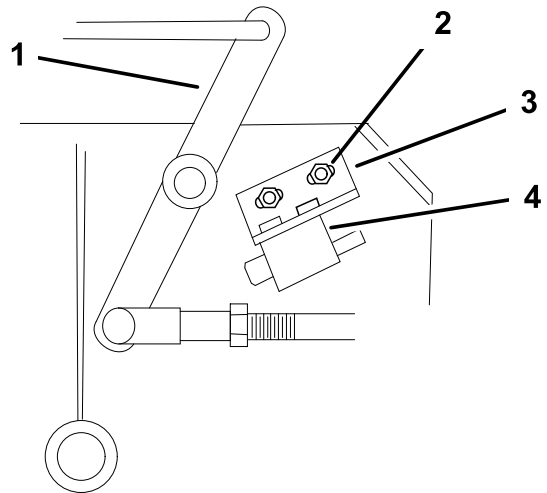

G001855

g001855

Figure 49

- | | |
|-------------------|----------------------------|
| 1. Bellcrank | 3. Switch-mounting bracket |
| 2. Bolts and nuts | 4. Switch body |

6. Tighten the switch-mounting bracket.

Controls System Maintenance

Adjusting the Control Rods

1. Park the machine on a level surface, disengage the PTO, and engage the parking brake.
2. Shut off the engine, remove the key, and wait for all moving parts to stop before leaving the operating position.
3. Remove the hairpin cotters and clevis pins from the drive levers and neutral locks (Figure 50).

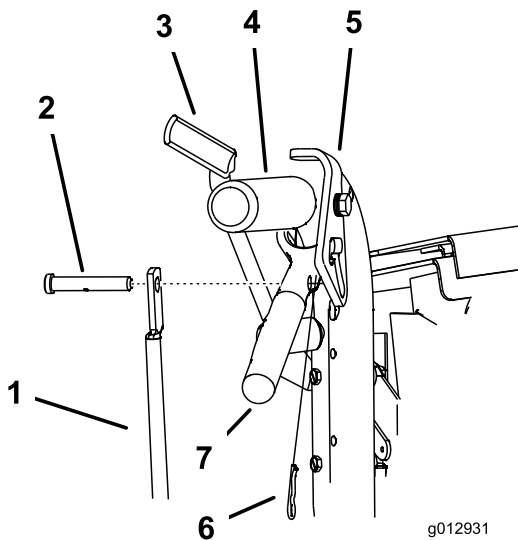

Figure 50

- | | |
|--|-------------------|
| 1. Control rod | 5. Neutral lock |
| 2. Clevis pin | 6. Hairpin cotter |
| 3. Operator-presence control (OPC) lever | 7. Left handle |
| 4. Handle | 8. Drive lever |

4. Adjust the control rod length by threading the rod in or out of the rod fitting until there is a 5 to 6 mm (3/16 to 1/4 inches) clearance between the control rod and the bottom of the neutral/parking-brake lock (Figure 51).

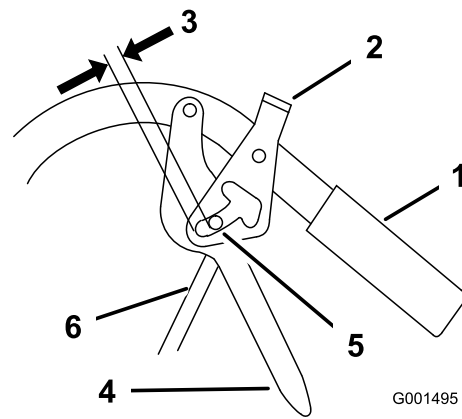

Figure 51

- | | |
|---|------------------|
| 1. Handle | 4. Drive lever |
| 2. Neutral/parking-brake lock | 5. Forward speed |
| 3. 5 to 6 mm (3/16 to 1/4 inch) clearance | 6. Control rod |

5. Secure the control rod to the drive lever and neutral/parking-brake lock.

Secure the control rod with a clevis pin and hairpin cotter (Figure 51).

6. Check the operation of the control rod.

Note: If you need to adjust it, remove the hairpin cotter and clevis pin that secure the control rod to the drive levers.

7. Adjust the control rod length by repeating the previous steps.

Mower Deck Maintenance

Blade Safety

A worn or damaged blade can break and a piece could be thrown toward you or bystanders, resulting in serious personal injury or death.

- Inspect the blades periodically for excessive wear or damage.
- Use care when checking the blades. Wear gloves and use caution when servicing them. Only replace the blades; never straighten or weld them.
- On multi-bladed machines, take care as rotating 1 blade can cause other blades to rotate.

Servicing the Cutting Blades

To ensure a superior quality of cut, keep the blades sharp. For convenient sharpening and replacement, you may want to keep extra blades on hand.

Before Inspecting or Servicing the Blades

1. Park the machine on a level surface, disengage the PTO, and engage the parking brake.
2. Shut off the engine, remove the key, and disconnect the spark-plug wires from the spark plugs.

Inspecting the Blades

Service Interval: Before each use or daily

1. Inspect the cutting edges (Figure 52).
2. If the edges are not sharp or have nicks, remove and sharpen the blade; refer to [Sharpening the Blades](#) (page 43).
3. Inspect the blades, especially in the curved area.
4. If you notice any cracks, wear, or a slot forming in this area, immediately install a new blade (Figure 52).

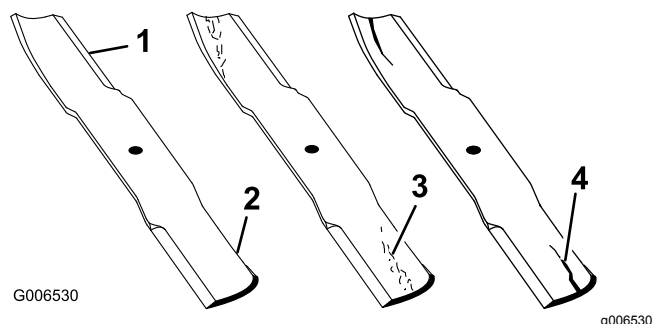

Figure 52

1. Cutting edge
2. Curved area
3. Wear/slot forming
4. Crack

Checking for Bent Blades

1. Rotate the blades until the ends face forward and backward (Figure 53).

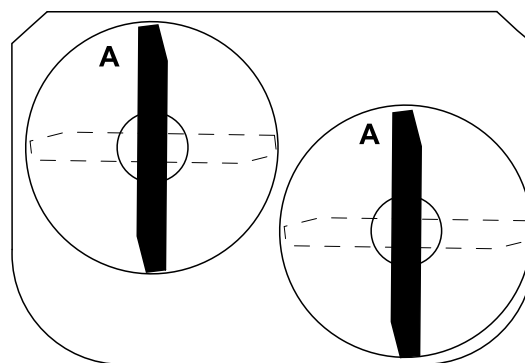

Figure 53

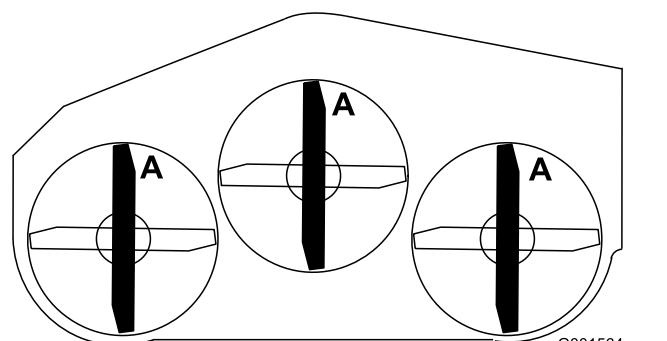
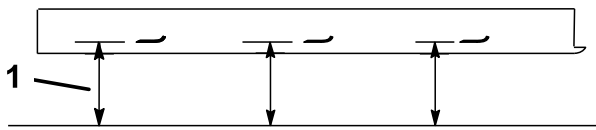

Figure 54

2. Measure from a level surface to the cutting edge, position A, of the blades (Figure 55).

Note: Note this dimension.



G001563
g001563

Figure 55

1. Measure from the cutting edge to a level surface.

3. Rotate the opposite ends of the blades forward.
4. Measure from a level surface to the cutting edge of the blades at the same position as in step 1.

Note: The difference between the dimensions obtained in steps 1 and 2 must not exceed 3 mm (1/8 inch). If this dimension exceeds 3 mm (1/8 inch), the blade is bent and must be replaced; refer to [Removing the Blades \(page 43\)](#) and [Installing the Blades \(page 44\)](#).

Removing the Blades

Replace the blades if you hit a solid object or if the blades are out of balance or bent. To ensure optimum performance and continued safety conformance of the machine, use genuine Toro replacement blades. Replacement blades made by other manufacturers may result in non-conformance with safety standards.

1. Hold the blade bolt with a wrench.
2. Remove the nut, blade bolt, curved washer, blade, spacers, and thin washer from the spindle ([Figure 56](#)).

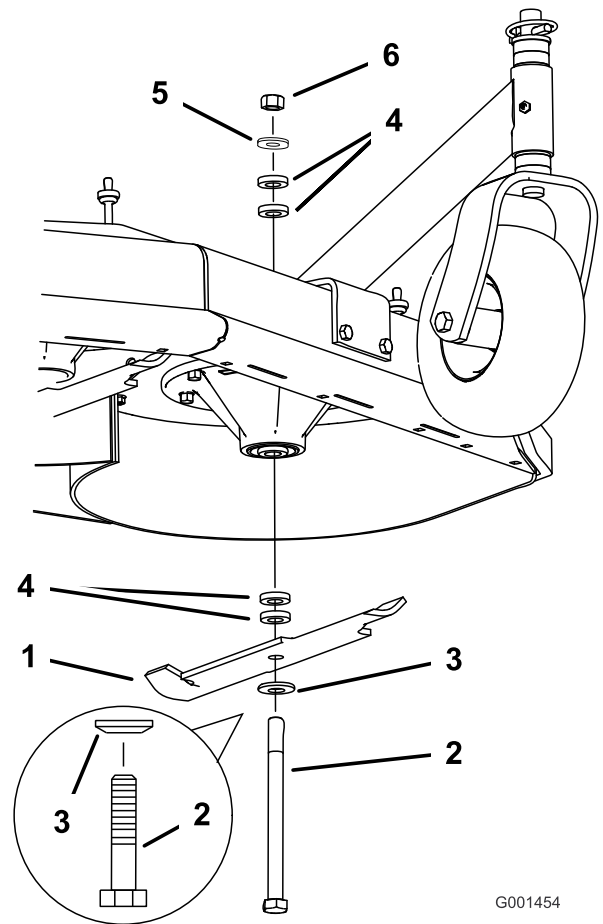

G001454

g001454

Figure 56

- | | |
|------------------|----------------|
| 1. Blade | 4. Spacer |
| 2. Blade bolt | 5. Thin washer |
| 3. Curved washer | 6. Nut |

Sharpening the Blades

1. Use a file to sharpen the cutting edge at both ends of the blade ([Figure 57](#)).

Note: Maintain the original angle.

Note: The blade retains its balance if the same amount of material is removed from both cutting edges.

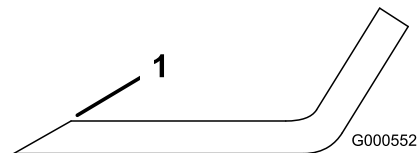

G000552

g000552

Figure 57

1. Sharpen at original angle.

2. Check the balance of the blade by putting it on a blade balancer ([Figure 58](#)).

Note: If the blade stays in a horizontal position, the blade is balanced and can be used.

Note: If the blade is not balanced, file some metal off the end of the sail area only (Figure 57).

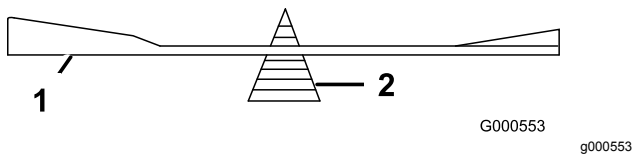

Figure 58

1. Blade
2. Balancer

3. Repeat this procedure until the blade is balanced.

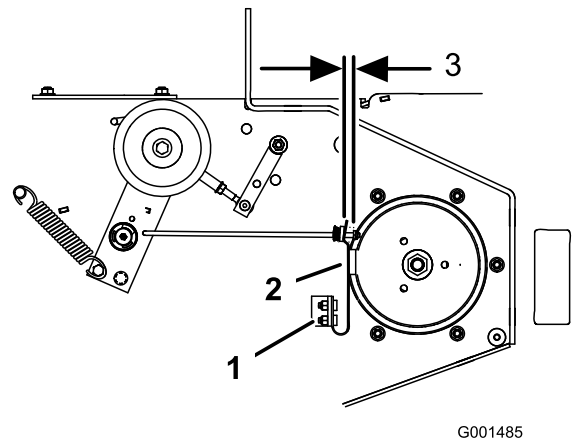

Figure 59

1. Spring-mounting bolts
2. Blade-brake pad
3. 3 mm to 5 mm (1/8 to 3/16 inch)

Installing the Blades

1. Install the curved washer and then the blade onto the bolt. Select the proper number of spacer(s) for the height of cut, and slide the bolt into the spindle (Figure 56).

Important: The curved part of the blade must point upward toward the inside of the mower to ensure proper cutting.

2. Install the remaining spacer(s) and secure them with a thin washer and a nut (Figure 56).
3. Torque the blade bolt to 101 to 108 N·m (75 to 80 ft-lb).

Adjusting the Blade Brake

1. Park the machine on a level surface, disengage the PTO, and engage the parking brake.
2. Shut off the engine, remove the key, and disconnect the spark-plug wires from the spark plugs.
3. If necessary, adjust the spring-mounting bolts so that the blade-brake pad rubs against both sides of the pulley groove (Figure 59).
4. Adjust the nut at the end of the blade brake rod until there is 3 mm to 5 mm (1/8 to 3/16 inch) between the nut and spacer (Figure 59).
5. Engage the blades.

Note: Ensure that the blade-brake pad no longer contacts the pulley groove.

Replacing the Grass Deflector

⚠ WARNING

An uncovered discharge opening could allow the machine to throw objects toward you or bystanders, resulting in serious injury. Also, contact with the blade could occur.

Never operate the machine without the grass deflector, the discharge cover, or the grass-collection system in place.

1. Park the machine on a level surface, disengage the PTO, and engage the parking brake.
2. Shut off the engine, remove the key, and disconnect the spark-plug wires from the spark plugs.
3. Remove the locknut, bolt, spring, and spacer securing the deflector to the pivot brackets (Figure 60).

Note: Remove the damaged or worn grass deflector.

Cleaning

Cleaning under the Mower

Service Interval: Before each use or daily

Remove the grass buildup under the mower daily.

1. Park the machine on a level surface, disengage the PTO, and engage the parking brake.
2. Shut off the engine, remove the key, and disconnect the spark-plug wires from the spark plugs.
3. Raise the front of the machine using a jack and use jack stands to support the machine.
4. Clean the machine with a rag. Do not spray the machine.

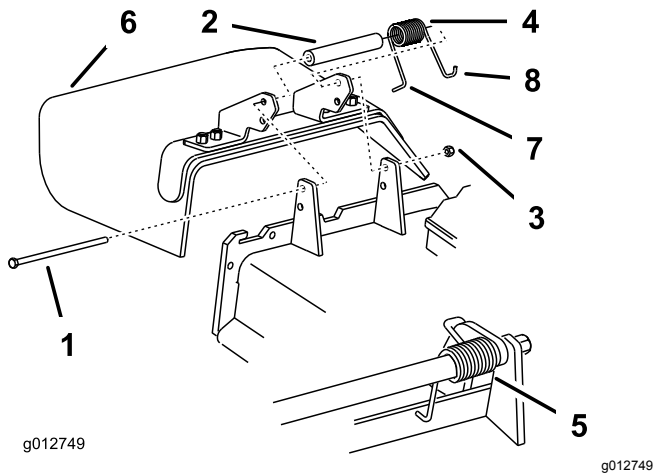

Figure 60

- | | |
|------------|---|
| 1. Bolt | 5. Spring (installed) |
| 2. Spacer | 6. Grass deflector |
| 3. Locknut | 7. L-end of the spring—place behind the deck edge before installing the bolt. |
| 4. Spring | 8. J-hook end of the spring |

4. Place the spacer and spring onto the grass deflector.
5. Place the L-end of spring behind deck edge (Figure 60).

Note: Ensure that the L-end of the spring is installed behind the deck edge before installing the bolt as shown in Figure 60.

6. Install the bolt and nut.
7. Place the J-hook end of the spring around the grass deflector (Figure 60).

Important: The grass deflector must be able to rotate. Lift the deflector up to the fully-open position and ensure that it rotates into the fully-down position.

Disposing of Waste

Engine oil, batteries, hydraulic fluid, and engine coolant are pollutants to the environment. Dispose of these according to your state and local regulations.

Storage

Cleaning and Storing the Machine

1. Park the machine on a level surface, disengage the PTO, and engage the parking brake.
2. Shut off the engine, remove the key, and wait for all moving parts to stop before leaving the operating position.
3. Remove grass clippings, dirt, and grime from the external parts of the entire machine, especially the engine and hydraulic system.

Important: You can wash the machine with mild detergent and water. Do not pressure-wash the machine. Avoid excessive use of water, especially near the control panel, engine, hydraulic pumps, and motors.

4. Check the parking brake operation; refer to [Checking the Parking Brake \(page 34\)](#).
5. Service the air cleaner; refer to [Servicing the Air Cleaner \(page 24\)](#).
6. Grease the machine; refer to [Lubrication \(page 23\)](#).
7. Change the crankcase oil; refer to [Servicing the Engine Oil \(page 25\)](#).
8. Check the tire pressure; refer to [Checking the Tire Pressure \(page 32\)](#).
9. Charge the battery; refer to [Charging the Battery \(page 32\)](#).
10. Scrape any heavy buildup of grass and dirt from the underside of the mower, then wash the machine with a garden hose.

Note: Run the machine with the blade-control switch (PTO) engaged and the engine at high idle for 2 to 5 minutes after washing.

11. Check the condition of the blades; refer to [Servicing the Cutting Blades \(page 42\)](#).
12. Prepare the machine for storage for over 30 days as follows:
 - A. Add fuel stabilizer/conditioner to fresh fuel in the tank. Follow mixing instructions from the fuel stabilizer manufacturer. Do not use an alcohol-based stabilizer (ethanol or methanol).
 - B. Run the engine to distribute conditioned fuel through the fuel system for 5 minutes.
 - C. Shut off the engine, allow it to cool, and drain the fuel tank.

- D. Start the engine and run it until it shuts off.
- E. Dispose of fuel properly. Recycle the fuel according to local codes.

Important: Do not store fuel containing stabilizer/conditioner longer than the duration recommended by the fuel-stabilizer manufacturer.

13. Remove and check the condition of the spark plug(s); refer to [Servicing the Spark Plugs \(page 27\)](#). With the spark plug(s) removed from the engine, pour 30 ml (2 tablespoons) of engine oil into the spark plug hole. Use the starter to crank the engine and distribute the oil inside the cylinder. Install the spark plug(s). Do not install the wire on the spark plug(s).
14. Check and tighten all fasteners. Repair or replace any part that is damaged.
15. Paint all scratched or bare metal surfaces. Paint is available from your Authorized Service Dealer.
16. Store the machine in a clean, dry garage or storage area. Remove the key from the switch and keep it out of reach of children or other unauthorized users. Cover the machine to protect it and keep it clean.

Troubleshooting

Problem	Possible Cause	Corrective Action
The fuel tank is showing signs of collapsing or the machine is frequently showing signs of running out of fuel.	1. The air-cleaner paper element clogged.	1. Clean the paper element.
The engine overheats.	<ol style="list-style-type: none"> 1. The engine load is excessive. 2. The oil level in the crankcase is low. 3. The cooling fins and air passages under the engine-blower housing are plugged. 4. The air cleaner is dirty. 5. Dirt, water, or stale fuel is in the fuel system. 	<ol style="list-style-type: none"> 1. Reduce the ground speed. 2. Add oil to the crankcase. 3. Remove the obstruction from the cooling fins and air passages. 4. Clean or replace the air-cleaner element. 5. Contact an Authorized Service Dealer
The starter does not crank.	<ol style="list-style-type: none"> 1. The PTO is engaged. 2. The battery is dead. 3. The electrical connections are corroded or loose. 4. A fuse is blown. 5. A relay or switch is damaged. 	<ol style="list-style-type: none"> 1. Disengage the PTO. 2. Charge the battery. 3. Check the electrical connections for good contact. 4. Replace the fuse. 5. Contact an Authorized Service Dealer.
The engine does not start, starts hard, or fails to keep running.	<ol style="list-style-type: none"> 1. The fuel tank is empty. 2. The choke (if applicable) is not on. 3. The air cleaner is dirty. 4. The spark-plug wire(s) is loose or disconnected. 5. The spark plug(s) is pitted, fouled, or the gap is incorrect. 6. There is dirt in fuel filter. 7. Dirt, water, or stale fuel is in fuel system. 8. There is incorrect fuel in the fuel tank. 9. The oil level in the crankcase is low. 	<ol style="list-style-type: none"> 1. Fill the fuel tank. 2. Move the choke lever to the ON position. 3. Clean or replace the air-cleaner element. 4. Install the wire(s) on the spark plug. 5. Install a new, correctly gapped spark plug(s). 6. Replace the fuel filter. 7. Contact an Authorized Service Dealer. 8. Drain the tank and replace the fuel with the proper type. 9. Add oil to the crankcase.
The engine loses power.	<ol style="list-style-type: none"> 1. The engine load is excessive. 2. The air cleaner is dirty. 3. The oil level in the crankcase is low. 4. The cooling fins and air passages under the engine blower housing are plugged. 5. The spark plug(s) is pitted, fouled, or the gap is incorrect. 6. The fuel-tank vent is blocked. 7. There is dirt in the fuel filter. 8. Dirt, water, or stale fuel is in the fuel system. 9. There is incorrect fuel in the fuel tank. 	<ol style="list-style-type: none"> 1. Reduce the ground speed. 2. Clean the air-cleaner element. 3. Add oil to the crankcase. 4. Remove the obstruction from the cooling fins and air passages. 5. Install a new, correctly gapped spark plug(s). 6. Contact an Authorized Service Dealer. 7. Replace the fuel filter. 8. Contact an Authorized Service Dealer. 9. Drain the tank and replace the fuel with the proper type.

Problem	Possible Cause	Corrective Action
The machine does not drive.	<ol style="list-style-type: none"> 1. The shift lever is in the NEUTRAL position. 2. The traction belts are worn, loose, or broken. 3. The traction belt is off a pulley. 4. The idler spring is broken or missing. 	<ol style="list-style-type: none"> 1. Move the shift lever to a drive gear position. 2. Contact an Authorized Service Dealer. 3. Contact an Authorized Service Dealer. 4. Contact an Authorized Service Dealer.
The machine vibrates abnormally.	<ol style="list-style-type: none"> 1. The cutting blade(s) is/are bent or unbalanced. 2. The blade mounting bolt is loose. 3. The engine mounting bolts are loose. 4. The engine pulley, idler pulley, or blade pulley is loose. 5. The engine pulley is damaged. 6. The blade spindle is bent. 7. The motor mount is loose or worn. 	<ol style="list-style-type: none"> 1. Install new cutting blade(s). 2. Tighten the blade mounting bolt. 3. Tighten the engine mounting bolts. 4. Tighten the appropriate pulley. 5. Contact an Authorized Service Dealer. 6. Contact an Authorized Service Dealer. 7. Contact an Authorized Service Dealer.
The cutting height is uneven.	<ol style="list-style-type: none"> 1. The blade(s) is not sharp. 2. A cutting blade(s) is/are bent. 3. The mower is not level. 4. The underside of the mower deck is dirty. 5. The tire pressure is incorrect. 6. A blade spindle is bent. 	<ol style="list-style-type: none"> 1. Sharpen the blade(s). 2. Install a new cutting blade(s). 3. Level the mower from side-to-side and front-to-rear. 4. Clean the underside of the mower deck. 5. Adjust the tire pressure. 6. Contact an Authorized Service Dealer.
The blades do not rotate.	<ol style="list-style-type: none"> 1. The drive belt is worn, loose or broken. 2. The drive belt is off of the pulley. 3. The power-takeoff (PTO) switch or PTO clutch is faulty. 4. The mower belt is worn, loose, or broken. 	<ol style="list-style-type: none"> 1. Install a new drive belt. 2. Install the drive belt and check the adjusting shafts and belt guides for the correct position. 3. Contact an Authorized Service Dealer. 4. Install a new mower belt.

Schematics

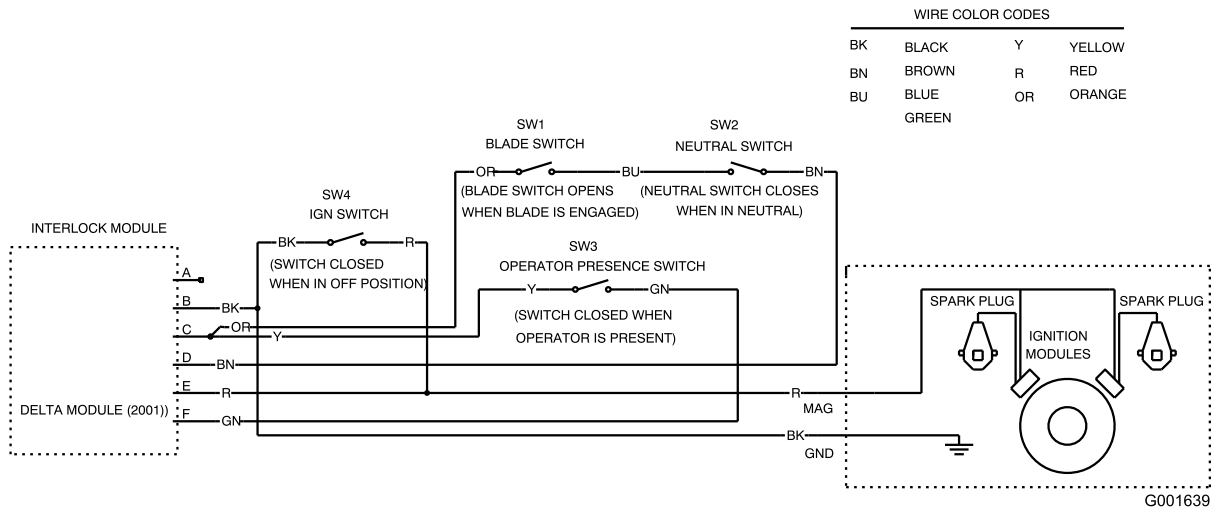

Electrical Schematic (Rev. A)

g001639

Notes:

Notes:

California Proposition 65 Warning Information

What is this warning?

You may see a product for sale that has a warning label like the following:



WARNING: Cancer and Reproductive Harm—www.p65Warnings.ca.gov.

What is Prop 65?

Prop 65 applies to any company operating in California, selling products in California, or manufacturing products that may be sold in or brought into California. It mandates that the Governor of California maintain and publish a list of chemicals known to cause cancer, birth defects, and/or other reproductive harm. The list, which is updated annually, includes hundreds of chemicals found in many everyday items. The purpose of Prop 65 is to inform the public about exposure to these chemicals.

Prop 65 does not ban the sale of products containing these chemicals but instead requires warnings on any product, product packaging, or literature with the product. Moreover, a Prop 65 warning does not mean that a product is in violation of any product safety standards or requirements. In fact, the California government has clarified that a Prop 65 warning "is not the same as a regulatory decision that a product is 'safe' or 'unsafe.'" Many of these chemicals have been used in everyday products for years without documented harm. For more information, go to <https://oag.ca.gov/prop65/faqs-view-all>.

A Prop 65 warning means that a company has either (1) evaluated the exposure and has concluded that it exceeds the "no significant risk level"; or (2) has chosen to provide a warning based on its understanding about the presence of a listed chemical without attempting to evaluate the exposure.

Does this law apply everywhere?

Prop 65 warnings are required under California law only. These warnings are seen throughout California in a wide range of settings, including but not limited to restaurants, grocery stores, hotels, schools, and hospitals, and on a wide variety of products. Additionally, some online and mail order retailers provide Prop 65 warnings on their websites or in catalogs.

How do the California warnings compare to federal limits?

Prop 65 standards are often more stringent than federal and international standards. There are various substances that require a Prop 65 warning at levels that are far lower than federal action limits. For example, the Prop 65 standard for warnings for lead is 0.5 µg/day, which is well below the federal and international standards.

Why don't all similar products carry the warning?

- Products sold in California require Prop 65 labelling while similar products sold elsewhere do not.
- A company involved in a Prop 65 lawsuit reaching a settlement may be required to use Prop 65 warnings for its products, but other companies making similar products may have no such requirement.
- The enforcement of Prop 65 is inconsistent.
- Companies may elect not to provide warnings because they conclude that they are not required to do so under Prop 65; a lack of warnings for a product does not mean that the product is free of listed chemicals at similar levels.

Why does Toro include this warning?

Toro has chosen to provide consumers with as much information as possible so that they can make informed decisions about the products they buy and use. Toro provides warnings in certain cases based on its knowledge of the presence of one or more listed chemicals without evaluating the level of exposure, as not all the listed chemicals provide exposure limit requirements. While the exposure from Toro products may be negligible or well within the "no significant risk" range, out of an abundance of caution, Toro has elected to provide the Prop 65 warnings. Moreover, if Toro does not provide these warnings, it could be sued by the State of California or by private parties seeking to enforce Prop 65 and subject to substantial penalties.