



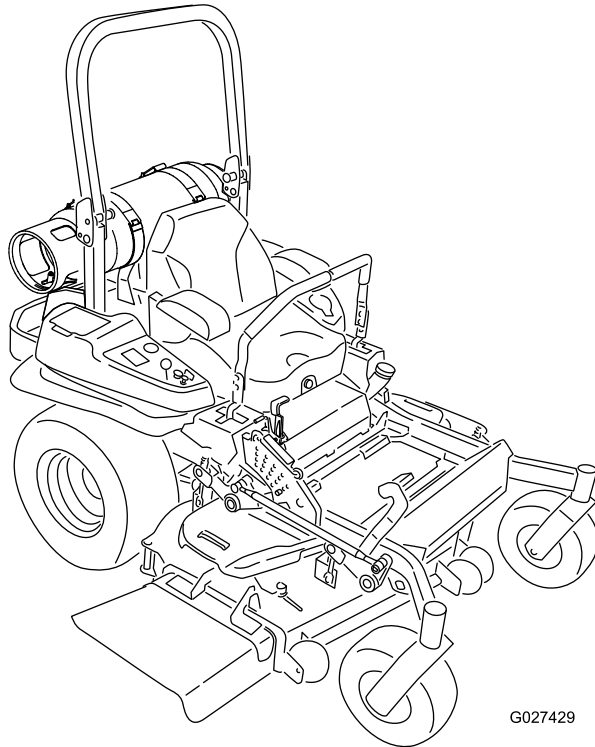
**Count on it.**

**Operator's Manual**

**Z Master<sup>®</sup> Professional 5000  
Series Riding Mower  
with 60in or 72in TURBO FORCE<sup>®</sup> Side  
Discharge Mower**

Model No. 74933—Serial No. 316000001 and Up

Model No. 74934—Serial No. 316000001 and Up



G027429



This spark ignition system complies with Canadian ICES-002

It is a violation of California Public Resource Code Section 4442 or 4443 to use or operate the engine on any forest-covered, brush-covered, or grass-covered land unless the engine is equipped with a spark arrester, as defined in Section 4442, maintained in effective working order or the engine is constructed, equipped, and maintained for the prevention of fire.

The enclosed *Engine Owner's Manual* is supplied for information regarding the US Environmental Protection Agency (EPA) and the California Emission Control Regulation of emission systems, maintenance, and warranty. Replacements may be ordered through the engine manufacturer.

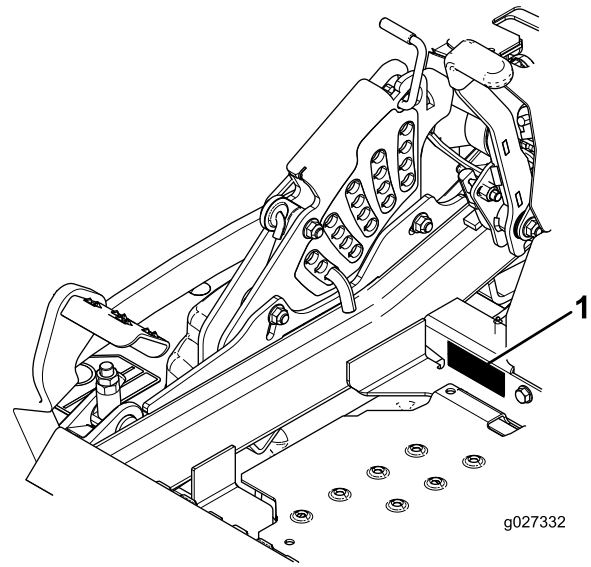


Figure 1

1. Model and serial number location

Model No. _____
Serial No. _____

This manual identifies potential hazards and has safety messages identified by the safety-alert symbol (Figure 2), which signals a hazard that may cause serious injury or death if you do not follow the recommended precautions.



Figure 2

1. Safety-alert symbol

This manual uses 2 words to highlight information. **Important** calls attention to special mechanical information and **Note** emphasizes general information worthy of special attention.

## Introduction

This rotary-blade, riding lawn mower is intended to be used by residential homeowners or professional, hired operators. It is designed primarily for cutting grass on well-maintained lawns on residential or commercial properties. It is not designed for cutting brush or for agricultural uses.

Read this information carefully to learn how to operate and maintain your product properly and to avoid injury and product damage. You are responsible for operating the product properly and safely.

You may contact Toro directly at [www.Toro.com](http://www.Toro.com) for product safety and operation training material, accessory information, help finding a dealer, or to register your product.

Whenever you need service, genuine Toro parts, or additional information, contact an Authorized Service Dealer or Toro Customer Service and have the model and serial numbers of your product ready. Figure 1 identifies the location of the model and serial numbers on the product. Write the numbers in the space provided.

# Contents

Safety .....	4	Checking the Knobs on the Rollover Protection System (ROPS) .....	49
Safe Operating Practices .....	4	Adjusting the Tracking .....	50
Slope Indicator .....	6	Checking the Tire Pressure .....	50
Safety and Instructional Decals .....	7	Checking the Wheel Lug Nuts .....	51
Product Overview .....	14	Checking the Wheel Hub Slotted Nut .....	51
Controls .....	14	Adjusting the Caster Pivot Bearing .....	51
Specifications .....	16	Using the Clutch Shim .....	52
Operation .....	17	Cooling System Maintenance .....	54
Adding Fuel .....	17	Cleaning the Engine Screen and Engine Oil Cooler .....	54
Checking the Engine-Oil Level .....	19	Cleaning the Engine Cooling Fins and Shrouds .....	54
Breaking in a New Machine .....	19	Check and Clean the Hydraulic Unit Shrouds .....	55
Using the Rollover-Protection System (ROPS) .....	20	Brake Maintenance .....	55
Think Safety First .....	21	Adjusting the Parking Brake .....	55
Operating the Parking Brake .....	21	Belt Maintenance .....	56
Operating the Mower Blade-Control Switch (PTO) .....	22	Inspecting the Belts .....	56
Operating the Throttle .....	22	Replacing the Mower Belt .....	56
Operating the Ignition Switch .....	22	Replacing the Hydraulic Pump Drive Belt .....	57
Starting and Shutting Off the Engine .....	22	Controls System Maintenance .....	58
Using the Safety-Interlock System .....	24	Adjusting the Control Handle Position .....	58
Driving Forward or Backward .....	25	Adjusting the Motion-Control Linkage .....	59
Stopping the Machine .....	26	Adjusting the Motion-Control Damper .....	60
Adjusting the Height-of-Cut .....	26	Adjusting the Motion-Control Neutral-Lock Pivot .....	60
Adjusting the Anti-Scalp Rollers .....	27	Hydraulic System Maintenance .....	61
Adjusting the Flow Baffle Cam Locks .....	28	Servicing the Hydraulic System .....	61
Positioning the Flow Baffle .....	28	Mower Deck Maintenance .....	63
Positioning the Seat .....	29	Leveling the Mower Deck .....	63
Unlatching the Seat .....	29	Servicing the Cutting Blades .....	64
Changing the Seat Suspension .....	30	Removing the Mower Deck .....	67
Using the Drive-Wheel-Release Valves .....	30	Replacing the Grass Deflector .....	68
Using the Side Discharge .....	31	Cleaning .....	68
Transporting the Machine .....	31	Cleaning the Mower Deck .....	68
Loading the Machine .....	32	Disposing of Waste .....	68
Operating Tips .....	34	Storage .....	69
Maintenance .....	35	Cleaning and Storing the Machine .....	69
Recommended Maintenance Schedule(s) .....	35	Troubleshooting .....	70
Lubrication .....	36	Schematics .....	72
Greasing and Lubrication .....	36		
Greasing the Mower .....	36		
Lubricating the Caster Wheel Hubs .....	37		
Engine Maintenance .....	38		
Servicing the Air Cleaner .....	38		
Servicing the Engine Oil .....	39		
Servicing the Spark Plug .....	42		
Checking Spark Arrester .....	44		
Fuel System Maintenance .....	44		
Inspecting the LPG System .....	44		
Servicing the Electronic Fuel Injection System .....	45		
Electrical System Maintenance .....	46		
Servicing the Battery .....	46		
Servicing the Fuses .....	47		
Jump-Starting the Machine .....	47		
Drive System Maintenance .....	49		
Checking the Seat Belt .....	49		

# Safety

Improper use or maintenance by the operator or owner can result in injury. To reduce the potential for injury, comply with these safety instructions, and pay attention to the safety-alert symbol, which means Caution, Warning, or Danger—personal safety instruction. Failure to comply with the instructions may result in personal injury or death.

This machine was manufactured according to the appropriate regulatory standards in effect at the time of manufacture. Modifying this machine in any way may cause it to be out of compliance with those standards and with the instructions in this *Operator's Manual*. Modifications to this machine should only be made by either the manufacturer or an Authorized Toro Dealer.

This product is capable of amputating hands and feet. Follow all safety instructions to avoid serious injury or death.

The owner/user can prevent and is responsible for accidents or injuries occurring to people, or damage to property.

The addition of attachments made by other manufacturers that do not meet American National Standards Institute certification will cause noncompliance of this machine.

## Safe Operating Practices

The following instructions are adapted from ANSI B71.4-2012.

### Training

- Read the *Operator's Manual* and other training material. If the operator(s) or mechanic(s) cannot read or understand the information it is the owner's responsibility to explain this material to them.
- Become familiar with the safe operation of the equipment, operator controls, and safety signs.
- All operators and mechanics should be trained. The owner is responsible for training the users.
- Never let children or untrained people operate or service the equipment. Local regulations may restrict the age of the operator.
- The owner/user can prevent and is responsible for accidents or injuries occurring to people or damage to property.

### Preparation

- Evaluate the terrain to determine what accessories and attachments are needed to properly and

safely perform the job. Only use accessories and attachments approved by the manufacturer.

- Wear appropriate clothing including substantial slip-resistant footwear, safety glasses, and hearing protection. Tie long hair back and do not wear jewelry.
- Inspect the area where the equipment is to be used and remove all objects such as rocks, toys, and wire which can be thrown by the machine.
- Check that operator's presence controls, safety switches, and shields are attached and functioning properly. Do not operate unless they are functioning properly.

### Operation

- Lightning can cause severe injury or death. If lightning is seen or thunder is heard in the area, do not operate the machine; seek shelter.
- Never run an engine in an enclosed area.
- Only operate in good light, keeping away from holes and hidden hazards.
- Be sure all drives are in neutral and parking brake is engaged before starting the engine. Only start the engine from the operator's position.
- Be sure of your traction while using this machine, especially when backing up. Walk; do not run. Never operate on wet grass. Reduced footing could cause slipping.
- Slow down and use extra care on hillsides. Be sure to travel side to side on hillsides. Turf conditions can affect the stability of the machine. Use caution while operating near drop-offs.
- Slow down and use caution when making turns and when changing directions on slopes.
- Never raise deck with the blades running.
- Never operate with the PTO shield or other guards not securely in place. Be sure all interlocks are attached, adjusted properly, and functioning properly.
- Never operate with the discharge deflector raised, removed or altered, unless using a grass catcher.
- Do not change the engine governor setting or overspeed the engine.
- Stop on level ground, disengage drives, engage the parking brake (if provided), and shut off the engine before leaving the operator's position for any reason, including emptying the catchers or unclogging the chute.
- Stop equipment and inspect blades after striking objects or if an abnormal vibration occurs. Make necessary repairs before resuming operations.
- Keep hands and feet away from the cutting unit.
- Look behind and down before backing up to be sure of a clear path.

- Never carry passengers on the machine.
- Keep pets and bystanders away.
- Slow down and use caution when making turns and crossing roads and sidewalks. Stop blades if not mowing.
- Be aware of the mower discharge direction and do not point it at anyone.
- Do not operate the mower while ill, tired, or under the influence of alcohol or drugs.
- Use care when loading or unloading the machine into or from a trailer or truck.
- Use care when approaching blind corners, shrubs, trees, or other objects that may obscure vision.
- Let the engine cool before storing and do not store near flame.
- Shut off the fuel while storing or transporting. Do not store fuel near flames.
- Park the machine on level ground. Set the parking brake. Never allow untrained personnel to service the machine.
- Use jack stands to support components when required.
- Carefully release pressure from components with stored energy.
- Disconnect the battery or the spark-plug wire before making any repairs. Disconnect the negative terminal first and the positive last. Connect the positive first and negative last.
- Use care when checking the blades. Wrap the blade(s) or wear thickly-padded gloves, and use caution when servicing them. Only replace blades. Never straighten or weld them.
- Keep hands and feet away from moving parts. If possible, do not make adjustments with the engine running.
- Keep all parts in good working condition and all hardware tightened. Replace all worn or damaged decals.
- To best protect your investment and maintain optimal performance of your Toro equipment, count on Toro genuine parts. When it comes to reliability, Toro delivers replacement parts designed to the exact engineering specifications of our equipment. For peace of mind, insist on Toro genuine parts.

## Rollover-Protection System (ROPS)

- The ROPS is an integral and effective safety device. Keep a folding ROPS in the raised and locked position and use the seat belt when operating the machine.
- Lower a folding ROPS temporarily only when absolutely necessary. Do not wear the seat belt when folded down.
- Be aware there is no rollover protection when a folded ROPS is in the down position.
- Be certain that the seat belt can be released quickly in the event of an emergency.
- Check the area to be mowed and never fold down a folding ROPS in areas where there are slopes, drop offs or water.
- Check carefully for overhead clearances (i.e., branches, doorways, electrical wires) before driving under any objects and do not contact them.
- Keep the ROPS in safe operating condition by periodically thoroughly inspecting for damage and keeping all mounting fasteners tight.
- Replace a damaged ROPS. Do not repair or revise.
- **Do not** remove the ROPS.
- Any alterations to a ROPS must be approved by the manufacturer.

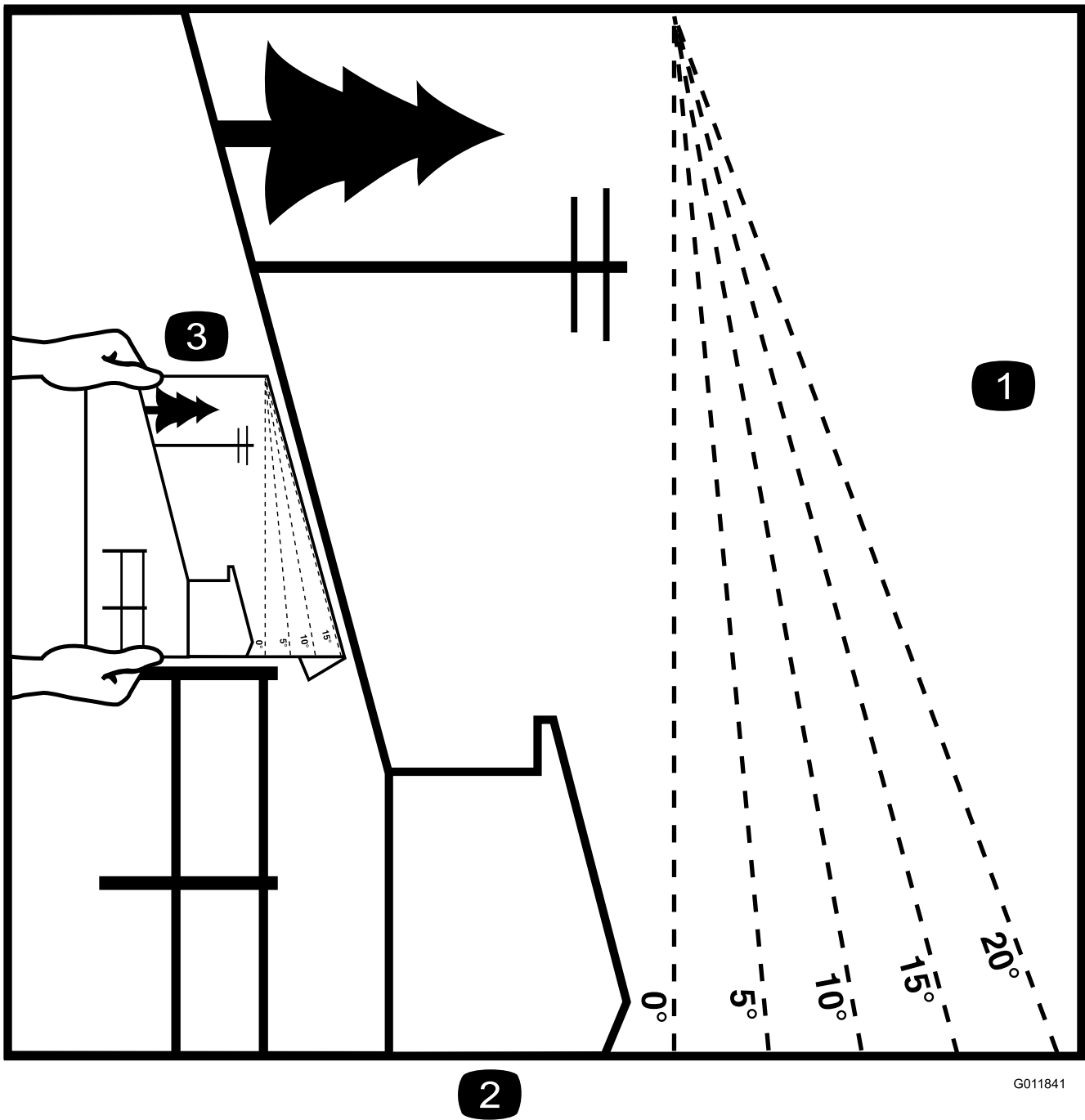
## Maintenance and Storage

- Disengage drives, set the parking brake, Shut off the engine and remove the key or disconnect the spark-plug wire. Wait for all movement to stop before adjusting, cleaning or repairing the machine.
- Clean grass and debris from the cutting unit, the drives, the mufflers, and the engine to help prevent fires. Clean up oil, fuel, or hydraulic fluid spills.

## Hauling

- Use care when loading or unloading the machine into a trailer or truck.
- Use full-width ramps for loading the machine into a trailer or truck.
- Tie the machine down securely using straps, chains, cable, or ropes. Both front and rear straps should be directed down and outward from the machine.

# Slope Indicator



G011841

g011841

**Figure 3**

This page may be copied for personal use.

1. The maximum slope you can safely operate the machine on is **15 degrees**. Use the slope chart to determine the degree of slope of hills before operating. **Do not operate this machine on a slope greater than 15 degrees.** Fold along the appropriate line to match the recommended slope.
2. Align this edge with a vertical surface, a tree, building, fence pole, etc.
3. Example of how to compare slope with folded edge.

# Safety and Instructional Decals



Safety decals and instructions are easily visible to the operator and are located near any area of potential danger. Replace any decal that is damaged or lost.

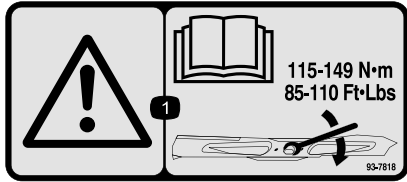


1

58-6520

decal58-6520

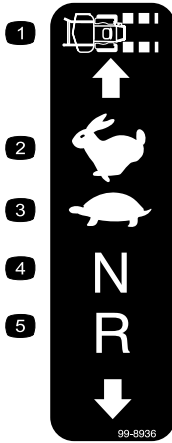
- Grease



93-7818

decal93-7818

- Warning—read the *Operator's Manual* for instructions on torquing the blade bolt/nut to 115-149 N·m (85-110 ft-lb).



99-8936

decal99-8936

- |                  |            |
|------------------|------------|
| 1. Machine speed | 4. Neutral |
| 2. Fast          | 5. Reverse |
| 3. Slow          |            |



106-5517

decal106-5517

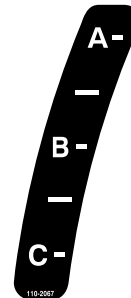
- Warning—do not touch the hot surface.



107-3069

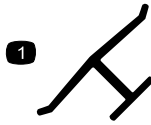
decal107-3069

- Warning—there is no rollover protection when the roll bar is down.
- To avoid injury or death from a rollover accident, keep the roll bar in the fully raised and locked position and wear the seat belt. Lower the roll bar only when absolutely necessary; do not wear the seat belt when the roll bar is down.
- Read the *Operator's Manual*; drive slowly and carefully.



110-2067

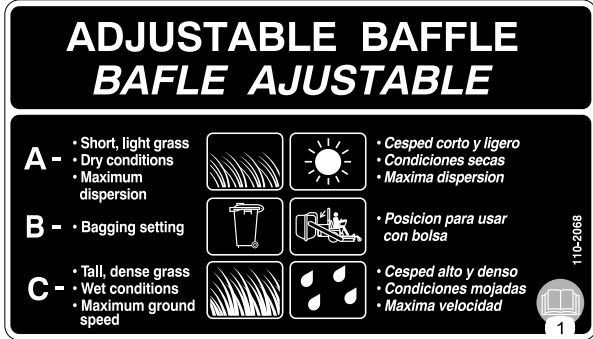
decal110-2067



decaloemmarkt

### Manufacturer's Mark

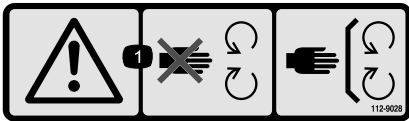
1. Indicates the blade is identified as a part from the original machine manufacturer.



110-2068

decal110-2068

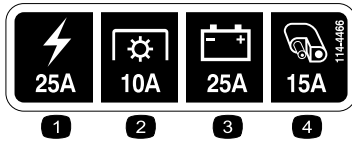
1. Read the *Operator's Manual*.



112-9028

decal112-9028

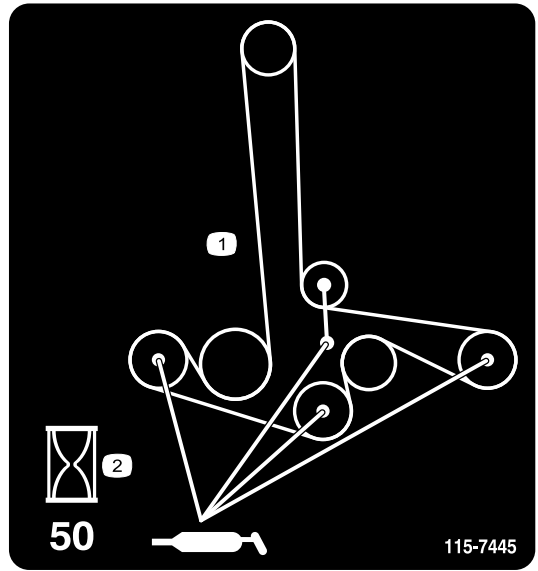
1. Warning—stay away from moving parts; keep all guards in place.



114-4466

decal114-4466

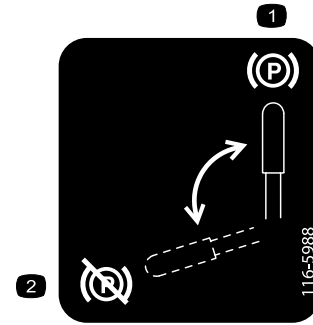
1. Main, 25 A
2. PTO, 10 A
3. Charge, 25 A
4. Auxiliary, 15 A



115-7445

decal115-7445

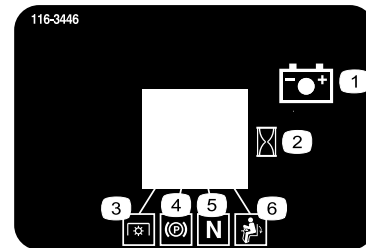
1. Grease pulleys and spindles
2. Maintenance interval—50 hours



116-5988

decal116-5988

1. Parking brake—engaged
2. Parking brake—disengaged



116-3446

decal116-3446

1. Battery
2. Hour meter
3. PTO
4. Parking brake
5. Neutral
6. Operator-presence switch



**CALIFORNIA SPARK ARRESTER WARNING**

Operation of this equipment may create sparks that can start fires around dry vegetation. A spark arrester may be required. The operator should contact local fire agencies for laws or regulations relating to fire prevention requirements.

116-4858

116-4858

decal116-4858

117-3848

117-3848

decal117-3848

1. Thrown-object hazard—keep bystanders a safe distance from the machine.
2. Thrown-object hazard, mower—do not operate the machine without deflector, discharge cover, or grass-collection system in place.
3. Cutting/dismemberment of hand or foot—stay away from moving parts; keep all guards and shields in place.



116-8726

decal116-8726

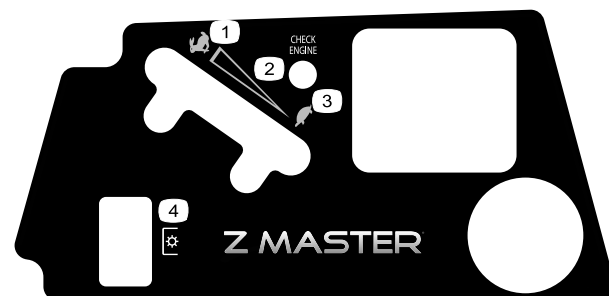
1. Read the *Operator's Manual* for recommended hydro fluid.

117-0346

117-0346

decal117-0346

1. Fuel-leak hazard—read the *Operator's Manual*; do not attempt to remove the roll bar; do not weld, drill, or modify the roll bar in any way.



121-7586

decal121-7586

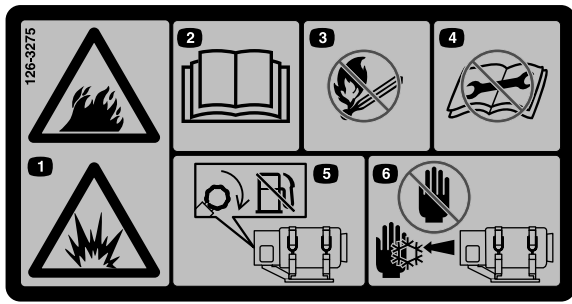
1. Fast
2. Variable-speed control
3. Slow
4. Power take off (PTO)

126-2055

126-2055

decal126-2055

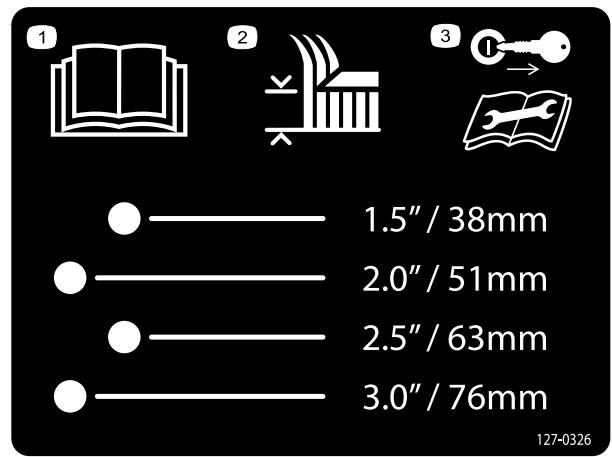
1. Wheel-lug-nut torque 129 N-m (95 ft-lb) (4x)
2. Wheel-hub-nut torque 319 N-m (235 ft-lb)
3. Read and understand the *Operator's Manual* before performing any maintenance, check torque after first 100 hours then every 500 hours thereafter.



decal126-3275

**126-3275**

1. Danger - LPG fuel is extremely flammable and vapors are explosive.
2. Read the Operator's manual. Consult NFPA 58: Liquefied Petroleum Gas Code for additional safety information.
3. Do not smoke or replace tank(s) around sources of fuel ignition.
4. Do not attempt to repair or modify the tank or its components. Contact trained and qualified person. Use only LPG tank(s) approved by the LPG System manufacturer.
5. Close fuel valve when mower is not in use, in storage, or transporting.
6. Avoid contact with LPG fuel. Escaping vapors and liquids freezes skin on contact.

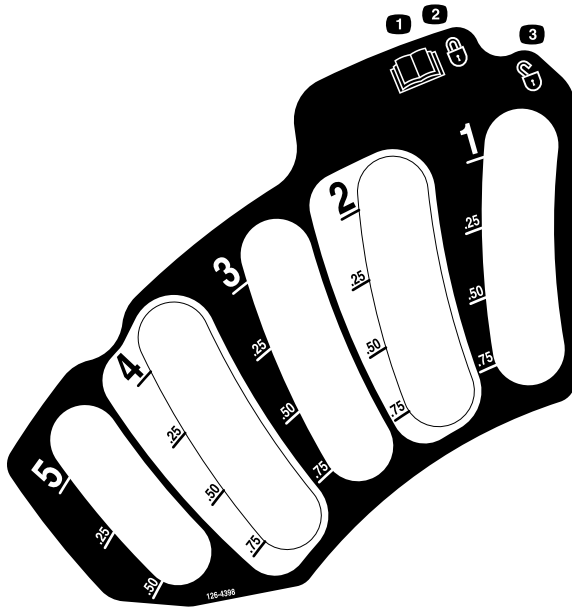


127-0326

**127-0326**

1. Read the *Operator's Manual*.
2. Height-of-cut
3. Remove the key from the ignition and read the *Operator's Manual* before performing maintenance or servicing the machine.

decal127-0326



decal126-4398

**126-4398**

1. Read the *Operator's Manual*
2. Lock
3. Unlock

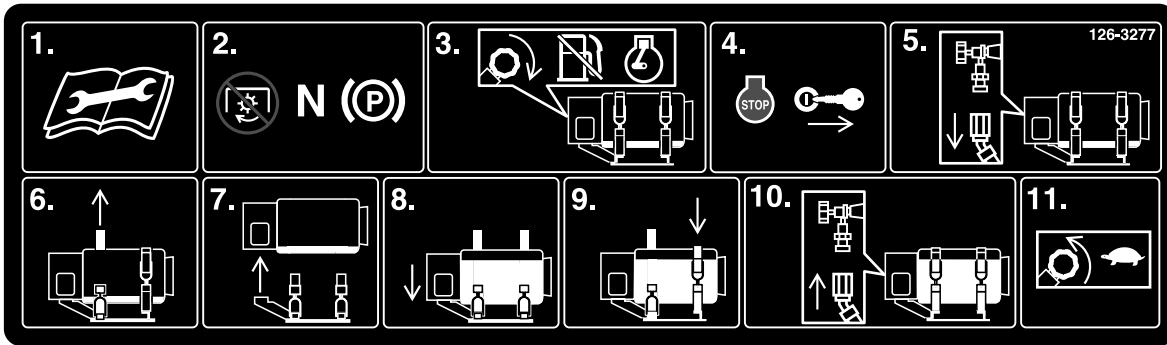


decalbatterysymbols

**Battery Symbols**

Some or all of these symbols are on your battery.

1. Explosion hazard
2. No fire, open flame, or smoking
3. Caustic liquid/chemical burn hazard
4. Wear eye protection.
5. Read the *Operator's Manual*.
6. Keep bystanders a safe distance from the battery.
7. Wear eye protection; explosive gases can cause blindness and other injuries.
8. Battery acid can cause blindness or severe burns.
9. Flush eyes immediately with water and get medical help fast.
10. Contains lead; do not discard



decal126-3277

**126-3277**

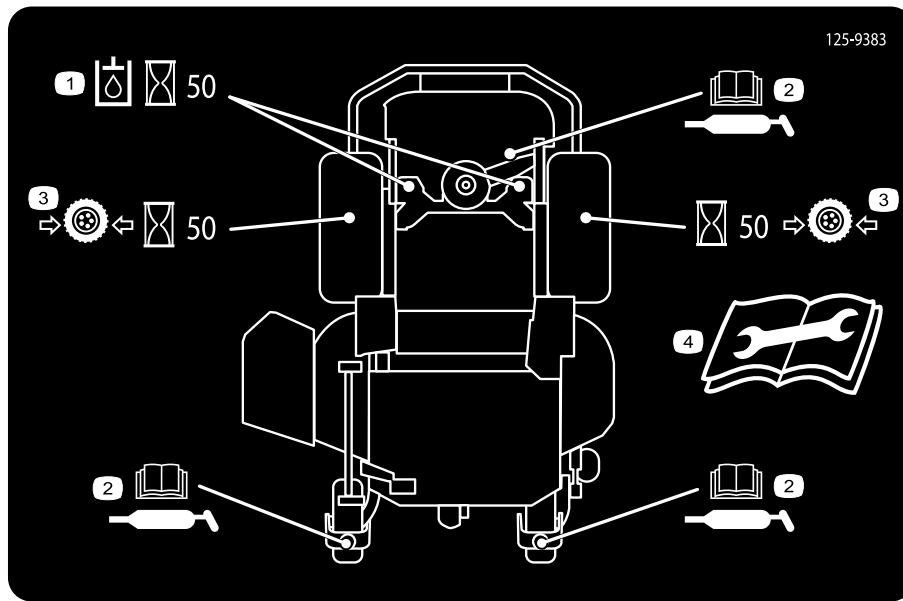
1. **IMPORTANT:** Use only replacement tank(s) that are free of dents or damage. Match size and type required on tank specification decal.
2. Stop the machine on a level surface, disengage the PTO, and engage the parking brake.
3. Close the fuel valve(s) on the tanks by rotating clockwise, continue to run the engine.
4. When the engine stops, remove the key.
5. Disconnect the LPG fuel hose(s).
6. Unlatch the cylinder bracket(s).
7. Remove the empty tank(s). Check the valve and fittings for debris or damaged O-rings.
8. Install full replacement tank(s) by aligning the center hole on the tank collar over the mounting tab/index pin.
9. Latch the bracket(s) and ensure that the tank(s) is securely fastened to the mower.
10. Connect the fuel hose(s).
11. Slowly open the fuel valve(s) counterclockwise to equalize the pressure. Check for leaks.

<p><b>DEPÓSITO DE GLP - ESPECIFICACIÓN</b></p> <p>UTILIZAR ÚNICAMENTE DEPÓSITOS AUTORIZADOS POR EL FABRICANTE DEL SISTEMA DE GLP</p> <p>MONTAJE: <b>HORIZONTAL</b></p> <p>ACOPPLAMIENTO DE DESCONEXIÓN: <b>ACME, ROSCA A IZQUIERDAS</b></p> <p>CAPACIDAD: <b>19.7 KG</b></p> <p>EXTRACCIÓN DE COMBUSTIBLE: <b>VAPOR</b></p>	<p><b>LPG TANK SPECIFICATION</b></p> <p>USE LPG SYSTEM MANUFACTURER APPROVED TANK ONLY</p> <p>MOUNTING: <b>HORIZONTAL</b></p> <p>DISCONNECT COUPLING: <b>LH-ACME THREADED</b></p> <p>CAPACITY: <b>43.5 LB</b></p> <p>FUEL WITHDRAWAL: <b>VAPOR</b></p>	<p><b>SPÉCIFICATIONS DU RÉSERVOIR DE GPL</b></p> <p>UTILISEZ UNIQUEMENT UN RÉSERVOIR AGRÉÉ PAR LE FABRICANT DU SYSTÈME DE GPL</p> <p>MONTAGE : <b>HORIZONTAL</b></p> <p>RACCORD RAPIDE : <b>FILETAGE ACME À GAUCHE</b></p> <p>CAPACITÉ : <b>19,7 KG</b></p> <p>RETRAIT DE CARBURANT : <b>VAPEUR</b></p>
---	--	---

126-4553

**126-4553**

decal126-4553

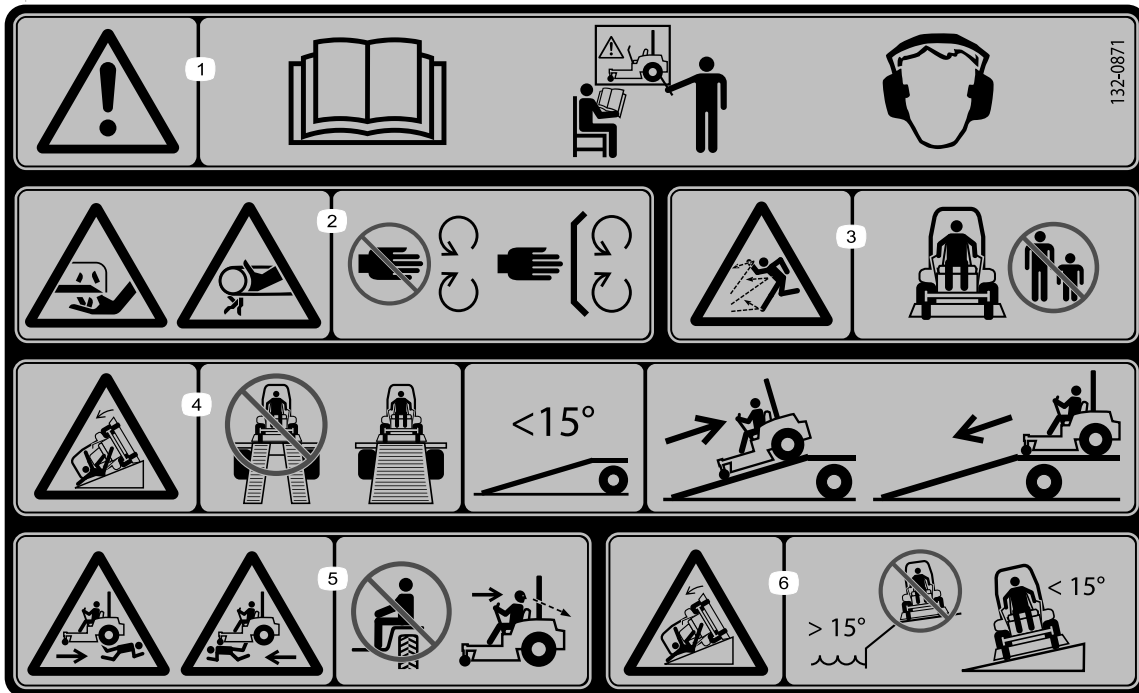


125-9383

**125-9383**

decal125-9383

1. Check the hydraulic fluid every 50 operating hours.
  2. Read the *Operator's Manual* for information on lubricating the machine.
  3. Check the tire pressure every 50 operating hours.
  4. Read the *Operator's Manual* before servicing or performing maintenance.
-



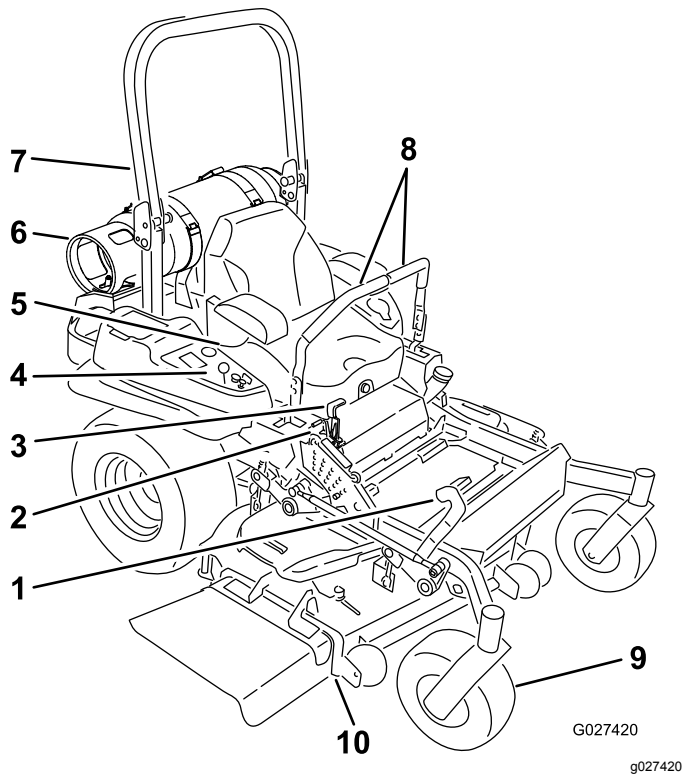
132-0871

decal132-0871

**Note:** This machine complies with the industry standard stability test in the static lateral and longitudinal tests with the maximum recommended slope indicated on the decal. Review the instructions for operating the machine on slopes in the *Operator's Manual* as well as the conditions in which you would operate the machine to determine whether you can operate the machine in those conditions on that day and at that site. Changes in the terrain can result in a change in slope operation for the machine. If possible, keep the cutting units lowered to the ground while operating the machine on slopes. Raising the cutting units while operating on slopes can cause the machine to become unstable.

1. Warning—read the *Operator's Manual*; do not operate this machine unless you are trained; wear hearing protection.
2. Cutting, dismembering, and entanglement hazard—keep hands away from moving parts; keep all guards and shields in place.
3. Thrown object hazard—keep bystanders away.
4. Ramp hazard—when loading onto a trailer, do not use dual ramps; only use a singular ramp wide enough for the machine and that has an incline less than  $15^\circ$ ; back up the ramp (in reverse) and drive forward off the ramp.
5. Bodily harm hazard—do not carry passengers; look behind you when mowing in reverse.
6. Tipping hazard on slopes—do not use on slopes near open water; do not use on slopes greater than  $15^\circ$ .

# Product Overview

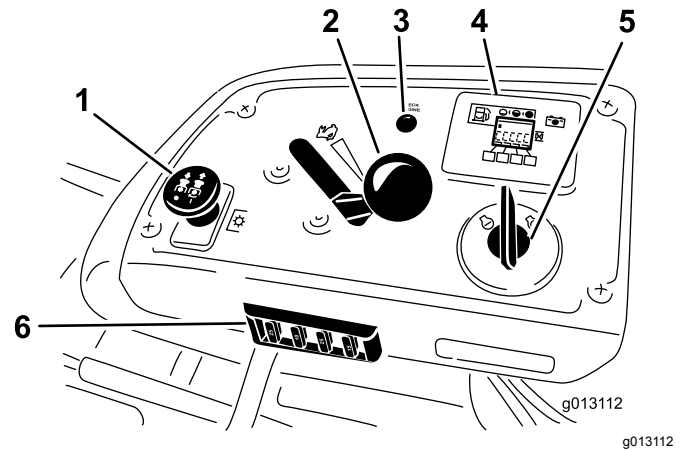


**Figure 4**

- |                                  |                          |
|----------------------------------|--------------------------|
| 1. Height-of-cut deck lift pedal | 6. LPG-fuel tank         |
| 2. Transport lock                | 7. Roll bar              |
| 3. Parking-brake lever           | 8. Motion-control levers |
| 4. Controls                      | 9. Caster wheel          |
| 5. Seat belt                     | 10. Mower deck           |

# Controls

Become familiar with all the controls before you start the engine and operate the machine (Figure 4 and Figure 5).



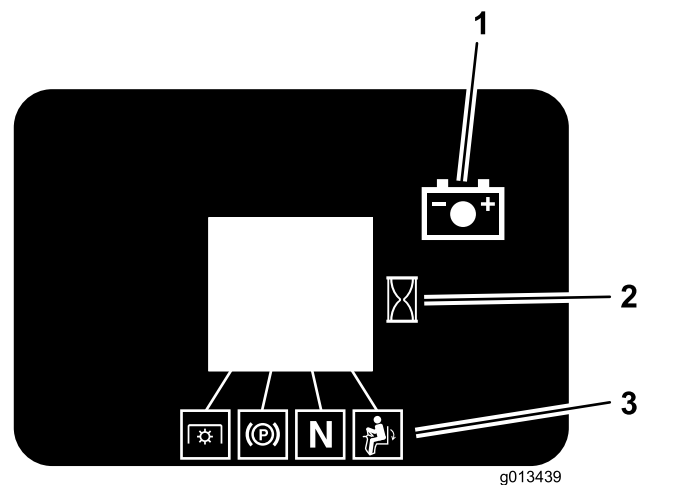
**Figure 5**

- |                                      |  |
|--------------------------------------|--|
| 1. PTO switch                        | 4. Hour meter/safety-interlock display |
| 2. Throttle control                  | 5. Ignition switch                     |
| 3. Malfunction-indicator light (MIL) | 6. Fuses                               |

## Battery-Indicator Light

If the ignition key is turned to the ON position for a few seconds, the battery voltage is displayed in the area where the hours are normally displayed.

The battery light turns on when the ignition is turned on and when the charge is below the correct operating level (Figure 6).



**Figure 6**

- |                  |                             |
|------------------|-----------------------------|
| 1. Battery light | 3. Safety-interlock symbols |
| 2. Hour meter    |                             |

## Hour Meter

The hour meter records the number of hours the engine has operated. It operates when the engine is running. Use these times for scheduling regular maintenance (Figure 5).

## Fuel Gauge

Located on the LPG-fuel tank.

This gauge monitors the amount of liquid LPG in the fuel tank.

## Safety Pressure-Relief Valve

The relief valve is located on the LPG-fuel tank (Figure 7).

The safety pressure-relief valve relieves the excess pressure in the LPG tank.

**Important:** This valve has a protective-plastic cap that should never be removed. If the cap is damaged or missing, contact trained and qualified personnel immediately.

## LPG Cylinder Brackets

The brackets are located on the engine deck.

The LPG-cylinder brackets are used to fasten the removable LPG tank to the mower.

## Safety-Interlock Indicators

The symbols on the hour meter indicate with a black triangle that the interlock component is in the correct position (Figure 6).

## Throttle Control

The throttle control is variable between the FAST and SLOW positions.

## Blade-Control Switch (PTO)

The blade-control switch (PTO) is used to engage the electric clutch and drive the mower blades. Pull the switch up to engage the blades and release. To disengage the blades, push the blade-control switch (PTO) down or move a motion-control lever into the NEUTRAL-LOCK position.

## Ignition Switch

This switch is used to start the mower engine and has three positions: START, RUN, and OFF.

## Motion-Control Levers

The motion-control levers are used to drive the machine forward, reverse, and turn either direction.

## Neutral-Lock Position

The NEUTRAL-LOCK position is used with the safety-interlock system to engage and to determine NEUTRAL position.

## Fuel-Shutoff Valve

Close the LPG-shutoff valve on the cylinder tank when transporting or storing the mower.

## Electronic Control Unit Malfunction Indicator Light

The electronic-control unit (ECU) continuously monitors the operation of the EFI system.

If a problem or fault within the system is detected, the malfunction-indicator light (MIL) is illuminated.

The MIL is the red light located in the right console panel.

Once the MIL illuminates, initial trouble shooting checks should be made. Refer to the MIL section under Troubleshooting.

If these checks do not correct the problem, further diagnosis and servicing by an Authorized Service Dealer is necessary.

## Attachments/Accessories

A selection of Toro approved attachments and accessories is available for use with the machine to enhance and expand its capabilities. Contact your Authorized Service Dealer or Distributor or go to [www.Toro.com](http://www.Toro.com) for a list of all approved attachments and accessories.

# Specifications

**Note:** Specifications and design are subject to change without notice.

and prevent the engine from operating. This may also result in permanent fuel-system damage and the release of highly-flammable-propane liquid or vapor.

## Width

	60-inch Deck	72-inch Deck
Without Deck	134.6 cm (53.0 inches)	150.1 cm (59.1 inches)
Deflector Up	156.8 cm (61.7 inches)	187 cm (73.6 inches)
Deflector Down	192.2 cm (75.7 inches)	222.4 cm (87.6 inches)

## Length

	60-inch Deck	72-inch Deck
Roll Bar - Up	211.1 cm (83.1 inches)	218.7 cm (86.1 inches)
Roll Bar - Down	215.4 cm (84.8 inches)	223.0 cm (87.8 inches)

## Height

Roll Bar - Up	Roll Bar - Down
179.1 cm (70.5 inches)	118.9 cm (46.8 inches)

## Weight

Model	Weight
60-inch Deck	593 kg (1,307 lb)
72-inch Deck	774 kg (1707 lb)

## Tank Type and Refilling

**Note:** The LPG tank used on this mower is a special tank with internal baffles designed for this application.

- Horizontal Tank Specifications:
  - Tank Material: Aluminum
  - Capacity: 43.5 lb
  - Disconnect coupling: Left hand ACME threaded
  - Fuel Withdrawal: Vapor
  - Fuel Shutoff Valve: Rotate clockwise to close.
  - Type of fuel: HD5 grade propane
- New tanks must be properly filled by trained and qualified personnel.
- Only use tanks recommended by Toro. Failure to do so will result in improper operation of the fuel system.

**Important:** Using a liquid-withdrawal tank will result in icing or freezing of the LPG regulator



# Operation

**Note:** Determine the left and right sides of the machine from the normal operating position.

## Adding Fuel

LPG (liquefied-petroleum gas) is more commonly called propane. LPG is a liquid fuel that is stored in a tank under pressure. Before the liquid leaves the tank, it is converted into a vapor. Since LPG is stored as both liquid and gas, it may leak from joints or connections that are not sealed properly. LPG becomes flammable when it is mixed with air.

The LPG information in this *Operator's Manual* is provided only as a guide. Consult the NFPA 58: Liquefied Petroleum Gas Code, 2008 Edition for additional safety information. This National Fire Protection Association (NFPA) code pertains to the handling, storing, transporting, and usage of LPG.

**Type of fuel:** HD5 grade propane

### **⚠ CAUTION**

Using overfilled tanks may result in the release of highly concentrated and extremely-flammable-liquid propane. Refer to the [Adding Fuel \(page 17\)](#) section.

Never use propane tanks that are filled beyond 80% capacity.

### **⚠ DANGER**

LPG vapors and liquid escaping from the tank may cause serious injury or death. Vapors or liquid may cause suffocation, freezing of tissue, or frostbite.

- Store and service the mower in a well-ventilated area.
- Install an approved LPG detector in trailers and storage areas.
- LPG is heavier than air and may accumulate in low lying areas, such as ditches, drains, or pits.
- Avoid breathing in vapors.
- Keep LPG vapors and liquid away from vent valves.
- Keep LPG vapors and liquid away from your eyes and skin.
- Contact trained and qualified personnel if the tank shows signs of frosted areas, makes a hissing sound, or emits a foul odor.
- Obtain immediate medical attention if vapors or liquid come in contact with your eyes or skin.

## **⚠ DANGER**

LPG fuel is extremely flammable and vapors are explosive.

A fire or explosion from LPG fuel can burn you, others, and cause property damage.

- Never smoke around fuel tank(s) and stay away from an open flame or where fumes may be ignited by a spark.
- Extinguish all sources of spark or flame when approaching LPG tanks or mowers. The hazard increases for enclosed trailers or storage locations where vapor leakage may occur and collect.
- LPG is heavier than air and may accumulate in low lying areas, such as ditches, drains, or pits.
- LPG tank(s) should be filled by trained and qualified personnel only.
- Never tamper with or repair the tank(s); contact trained and qualified personnel.
- Do not change the tank(s) when the engine is running.
- Before disconnecting the hoses, close the fuel valves on all of the tanks and allow the engine to run until it stops to purge all of the LPG vapors from the system.
- Store the tank(s) away from heat, sparks, or open flames.
- Do not operate without the entire exhaust system in place and in proper working condition.

## **⚠ DANGER**

LPG fuel is extremely flammable and vapors are explosive.

- In case of fire, take the following steps:
  1. If you can safely do so, stop the flow of gas as quickly as possible. Never put out the flame unless you can shut off the gas.
  2. Notify the fire department and clear the immediate area of all people.
  3. When the gas flow has stopped, put out the fire. Usually, when flow of gas is cut off, fire will automatically stop.
  4. If you cannot immediately stop the gas flow, direct water on to the tanks to keep them cool, but *do not* put out the fire.
- Storage locations and trailers should be equipped with at least 1 approved portable fire extinguisher that has a minimum capacity of 8.2 kg (18 lb) dry chemical with a B:C rating. Do not use carbon-tetrachloride extinguishers such as Pyrene.

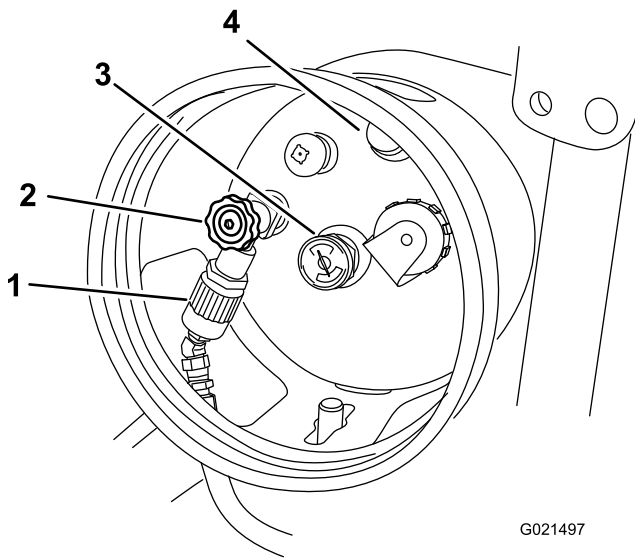
## **Changing the LPG Tank**

Change the LPG tank outdoors in a well-ventilated area.

**Important:** Only hand tighten tank-connection fitting. Over tightening by the use of tools may cause damage. If hand tightening does not stop a leak, contact trained and qualified personnel immediately.

1. Shut off the machine on level ground, disengage the blade-control switch (PTO), move the motion-control levers to the NEUTRAL-LOCK position, and set the parking brake.
2. Wait for all moving parts to stop before leaving the operating position.
3. With the engine running, close the fuel valve on the tank.
4. Run the engine until it stops.

**Note:** This purges all vapors from the hose.
5. Remove the key.
6. Carefully disconnect the LPG fuel hose.



G021497

g021497

**Figure 7**

- |                                     |                                 |
|-------------------------------------|---------------------------------|
| 1. LPG fuel hose connection fitting | 3. Fuel gauge                   |
| 2. Tank valve                       | 4. Safety pressure relief valve |

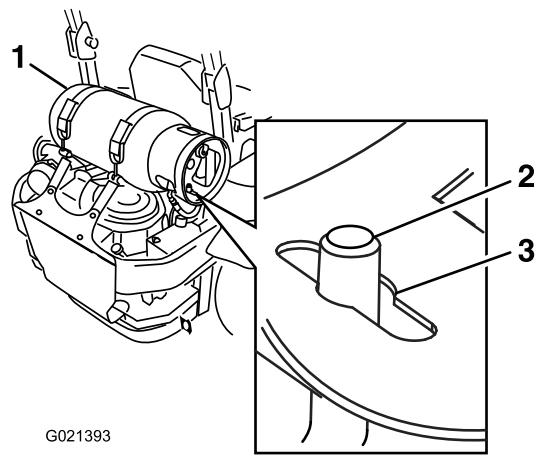
- Unlatch the cylinder brackets and remove the tank.

**⚠ WARNING**

**Fuel system components are under high pressure. The use of damaged or improper components can cause system failure, fuel leakage, and possible explosion, which may result in serious injury or death.**

- Do not attempt to repair or modify the valves, fittings, or other tank components.
- Only use the Toro approved LPG tank, fittings, and hoses that were designed for your mower.

- Inspect the filled tank valve and fitting openings for dirt, debris, or damage.
- Inspect the tank hose connection fitting for damaged or missing o-rings.
- Ensure that the replacement tank type and size match the tank specification decal.
- Align the center hole over the mounting pin that points straight up on the mower as shown in [Figure 8](#).



G021393

g021393

**Figure 8**

- |                      |                |
|----------------------|----------------|
| 1. Cylinder brackets | 3. Center hole |
| 2. Mounting pin      |                |

**Important:** The valves and gauges may not function properly if the LPG tank is not installed correctly.

- Latch the cylinder brackets and ensure that the tank is securely fastened to the mower.
  - Carefully connect the fuel hose. Ensure the hose is not kinked.
  - Slowly open the fuel valve to equalize the pressure in the tank.
- Note:** If the fuel valve is opened too quickly, the pressure relief valve is equipped with a back pressure check valve that will shut off the fuel supply. If this happens, close the fuel valve completely and wait 5 seconds.
- Check for leaks as described in [Inspecting the LPG System \(page 44\)](#).

## Checking the Engine-Oil Level

Before you start the engine and use the machine, check the oil level in the engine crankcase; refer to [Checking the Engine-Oil Level \(page 39\)](#).

## Breaking in a New Machine

New engines take time to develop full power. Mower decks and drive systems have higher friction when new, placing additional load on the engine. Allow 40 to 50 hours of break-in time for new machines to develop full power and best performance.

# Using the Rollover-Protection System (ROPS)

## **⚠ WARNING**

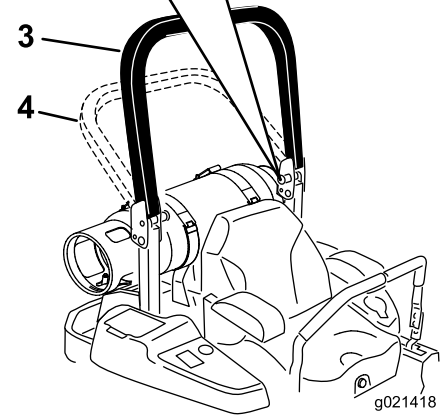
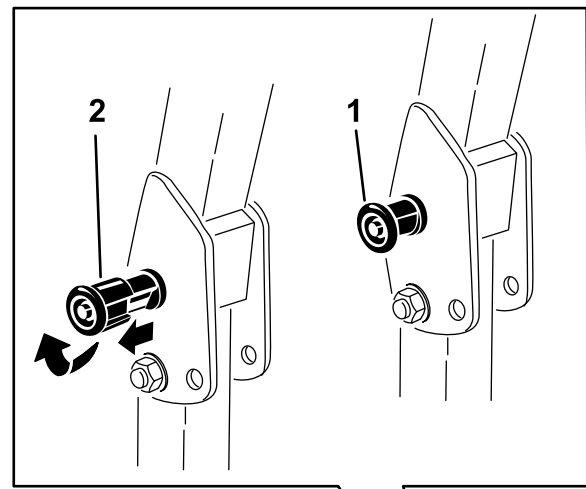
There is no rollover protection when the roll bar is in the down position.

- Lower the roll bar only when absolutely necessary.
- Do not wear the seat belt when the roll bar is in the down position.
- Drive slowly and carefully.
- Raise the roll bar as soon as clearance permits.
- Check carefully for overhead clearances (i.e., branches, doorways, electrical wires) before driving under any objects, and do not contact them.

**Important:** Lower the roll bar only when absolutely necessary.

**Important:** Ensure that the rear part of the seat is secured with the seat latch.

1. To lower the roll bar, apply forward pressure to the upper part of the roll bar.
2. Pull both knobs out and rotate them 90° so they are not engaged (Figure 9).
3. Lower the roll bar to the down position (Figure 9).



**Figure 9**

- |   |                                     |
|---|-------------------------------------|
| 1. ROPS knob                                | 3. Roll bar in the upright position |
| 2. Pull ROPS knob out and rotate 90 degrees | 4. Roll bar in the folded position  |
- 
4. To raise the roll bar, raise the roll bar to the operate position, rotate the knobs so they move partially into the grooves (Figure 9).
  5. Raise the roll bar to the full upright position while pushing on the upper roll bar and the pins will snap into position when the holes align with the pins (Figure 9). Push on the roll bar and ensure that both pins are engaged.

**Important:** Always use the seat belt with the roll bar in the fully raised position.

# Think Safety First

Please read all safety instructions and symbols in the safety section. Knowing this information could help you or bystanders avoid injury.

## **⚠ DANGER**

Operating the machine on wet grass or steep slopes can cause sliding and loss of control.

- Do not operate on slopes greater than 15 degrees.
- Reduce speed and use extreme caution on slopes.
- Do not operate the machine near water.

## **⚠ DANGER**

Wheels dropping over edges can cause rollovers, which may result in serious injury, death, or drowning.

Do not operate the machine near drop-offs.

## **⚠ DANGER**

Operating the machine while the roll bar is down may lead to serious injury or death in the event of a rollover.

Always keep the roll bar in the fully raised and locked position and use the seat belt.

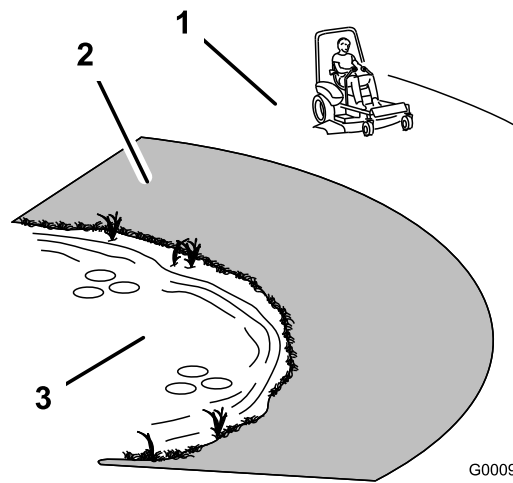


Figure 10

1. Safe zone—use the machine here on slopes less than 15 degrees or flat areas.
2. Danger zone—use a walk-behind mower and/or a hand trimmer on slopes greater than 15 degrees, near drop-offs and water.
3. Water

## **⚠ CAUTION**

This machine produces sound levels in excess of 85 dBA at the operator's ear and can cause hearing loss through extended periods of exposure.

Wear hearing protection when operating this machine.

The use of protective equipment for eyes, ears, hands, feet, and head is recommended.

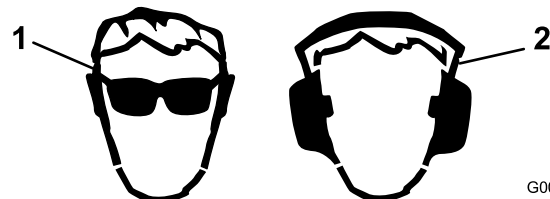


Figure 11

1. Wear eye protection.
2. Wear hearing protection.

## Operating the Parking Brake

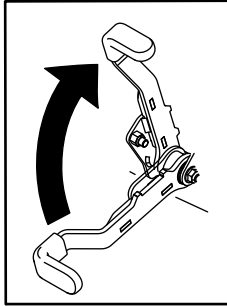
Always set the parking brake when you stop the machine or leave it unattended.

## Setting the Parking Brake

### **⚠ WARNING**

The parking brake may not hold a machine parked on a slope and could cause personal injury or property damage.

Do not park the machine on slopes unless the wheels are chocked or blocked.

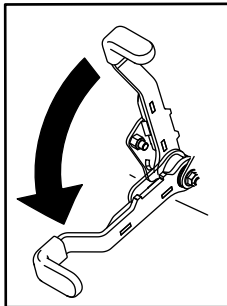


g027334

Figure 12

g027334

## Releasing the Parking Brake



g027335

Figure 13

g027335

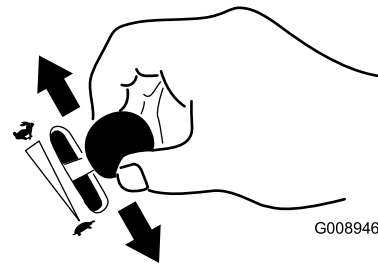
## Operating the Mower Blade-Control Switch (PTO)

The blade-control switch (PTO) starts and stops the mower blades and any powered attachments.

## Operating the Throttle

The throttle control can be moved between FAST and SLOW positions (Figure 14).

Always use the FAST position when turning on the mower deck with the blade-control switch (PTO).



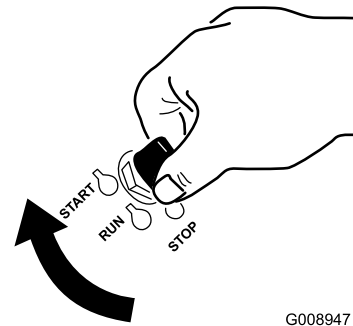
G008946

Figure 14

g008946

## Operating the Ignition Switch

1. Turn the ignition key to the START position (Figure 15).



G008947

Figure 15

g008947

2. When the engine starts, release the key.

**Important:** Do not engage starter for more than 5 seconds at a time. If the engine fails to start, allow a 15-second cool-down period between attempts. Failure to follow these instructions can burn out the starter motor.

3. Turn the ignition key to STOP to shut off the engine.

## Starting and Shutting Off the Engine

### Starting the Engine

1. Raise the ROPS up and lock into place, sit on the seat, and fasten the seat belt (Figure 16).
2. Slowly open the fuel valve to equalize the pressure in the tank (Figure 16).

**Note:** The fuel valve is located on the top end of the LPG tank. If the fuel valve is opened too

quickly, the pressure relief valve is equipped with a back pressure check valve that will shut off the fuel supply. If this happens, close the fuel valve completely and wait 5 seconds.

3. Move the motion controls to NEUTRAL-LOCK position (Figure 16).
4. Set the parking brake; refer to [Setting the Parking Brake](#) (page 22).
5. Move the blade-control switch (PTO) to the OFF position (Figure 16).
6. Move the throttle lever to the 3/4 throttle position between the SLOW and FAST positions (Figure 16).
7. Turn the ignition key to the START position (Figure 16). When the engine starts, release the key.

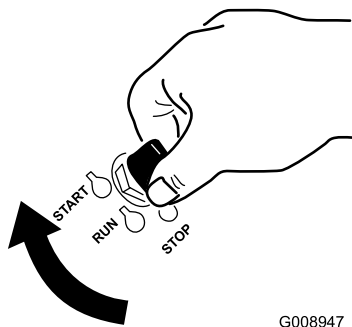
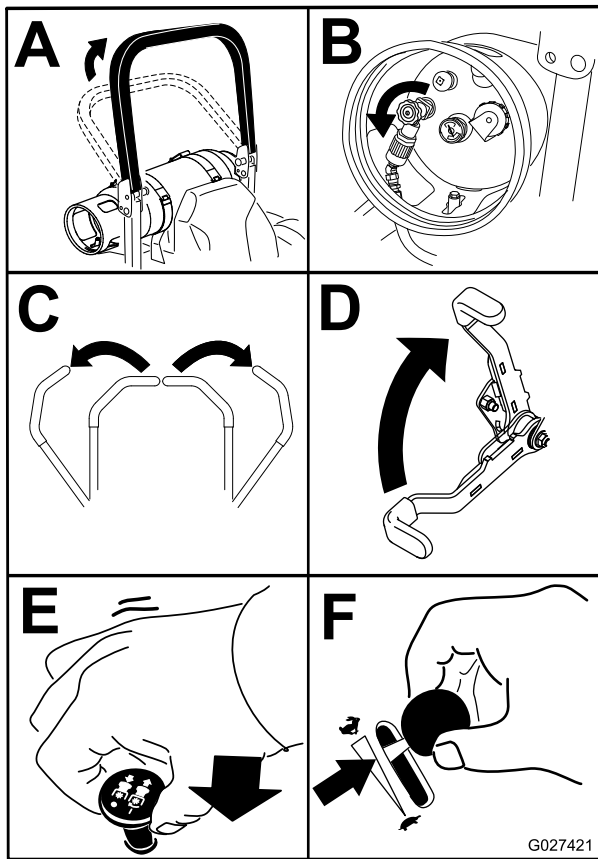


Figure 16

## Shutting Off the Engine

### ⚠ CAUTION

Children or bystanders may be injured if they move or attempt to operate the tractor while it is unattended.

Always remove the ignition key and set the parking brake when leaving the machine unattended, even if just for a few minutes.

Let the engine idle at SLOW throttle (turtle) for 60 seconds before turning the ignition switch OFF.

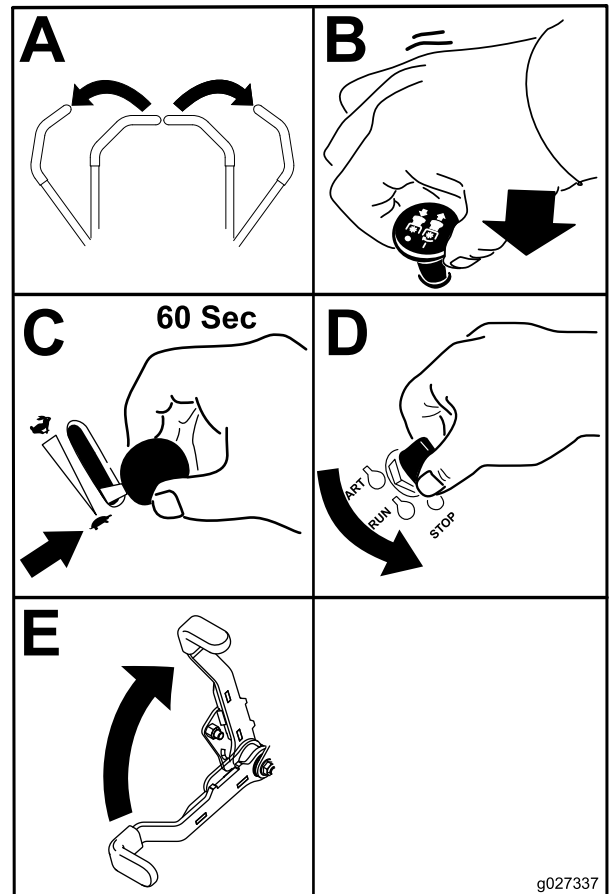


Figure 17

**Important:** Ensure that the fuel shut off valve is closed before transporting or storing the machine, as fuel leakage may occur. Set the parking brake before transporting. Ensure to remove the key as the fuel pump may run and cause the battery to lose charge.

# Using the Safety-Interlock System

## ⚠ CAUTION

If the safety-interlock switches are disconnected or damaged, the machine could operate unexpectedly, causing personal injury.

- Do not tamper with the interlock switches.
- Check the operation of the interlock switches daily and replace any damaged switches before operating the machine.

## Understanding the Safety-Interlock System

The safety-interlock system is designed to prevent the engine from starting unless:

- The parking brake is engaged.
- The blade-control switch (PTO) is disengaged.
- The motion-control levers are in the NEUTRAL-LOCK position.

The safety-interlock system also is designed to shut off the engine when you move the traction controls from the LOCK position with the parking brake engaged or if you rise from the seat when the PTO is engaged.

The hour meter has symbols to notify you when the interlock component is in the correct position. When the component is in the correct position, a triangle lights up in the corresponding square.

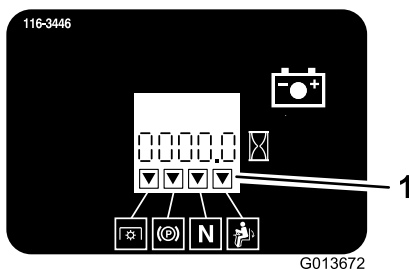


Figure 18

1. Triangles light up when the interlock components are in the correct position.

# Testing the Safety-Interlock System

**Service Interval:** Before each use or daily

Test the safety-interlock system before you use the machine each time. If the safety system does not operate as described below, have an Authorized Service Dealer repair the safety system immediately.

1. Sit on the seat, engage the parking brake and move the blade-control switch (PTO) to the ON position. Try starting the engine; the engine should not start.
2. Sit on the seat, engage the parking brake and move the blade-control switch (PTO) to the OFF position. Move either motion-control lever (out of the NEUTRAL-LOCK position). Try starting the engine; the engine should not start. Repeat for other control lever.
3. Sit on the seat, engage the parking brake, move the blade-control switch (PTO) to the OFF position, and move the motion-control levers to the NEUTRAL-LOCK position. Start the engine. While the engine is running, release the parking brake, engage the blade-control switch (PTO), and rise slightly from the seat; the engine should shut off.
4. Sit on the seat, engage the parking brake, move the blade-control switch (PTO) to the OFF position, and move the motion-control levers to NEUTRAL-LOCK position. Start the engine. While the engine is running, center either motion-control lever and move it forward or reverse; the engine should shut off. Repeat for other motion-control lever.
5. Sit on the seat, disengage the parking brake, move the blade-control switch (PTO) to the OFF position, and move the motion-control levers to NEUTRAL-LOCK position. Try starting the engine; the engine should not start.



# Driving Forward or Backward

The throttle control regulates the engine speed as measured in rpm (revolutions per minute). Place the throttle control in the FAST position for best performance. Always operate in the FULL-THROTTLE position when mowing.

## ⚠ CAUTION

Machine can spin very rapidly. Operator may lose control of machine and cause personal injury or damage to machine.

- Use caution when making turns.
- Slow the machine down before making sharp turns.

## Using the Motion-Control Levers

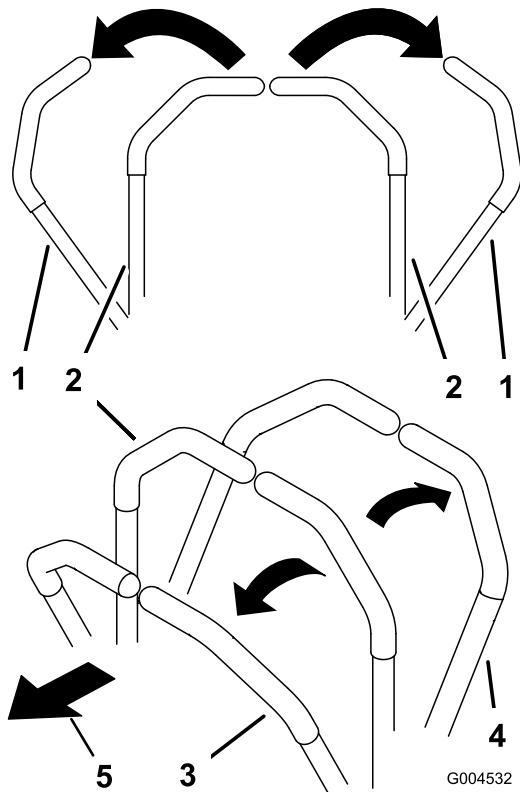


Figure 19

g004532

1. Motion-control lever—neutral-lock position
2. Center, unlocked position
3. Forward
4. Backward
5. Front of machine

# Driving Forward

**Note:** The engine will shut off when you move the traction-control levers with the parking brake engaged.

To stop the machine, pull the motion-control levers to the NEUTRAL position.

1. Release the parking brake; refer to [Releasing the Parking Brake \(page 22\)](#).
2. Move the levers to the center, unlocked position.
3. To go forward, slowly push the motion-control levers forward ([Figure 20](#)).

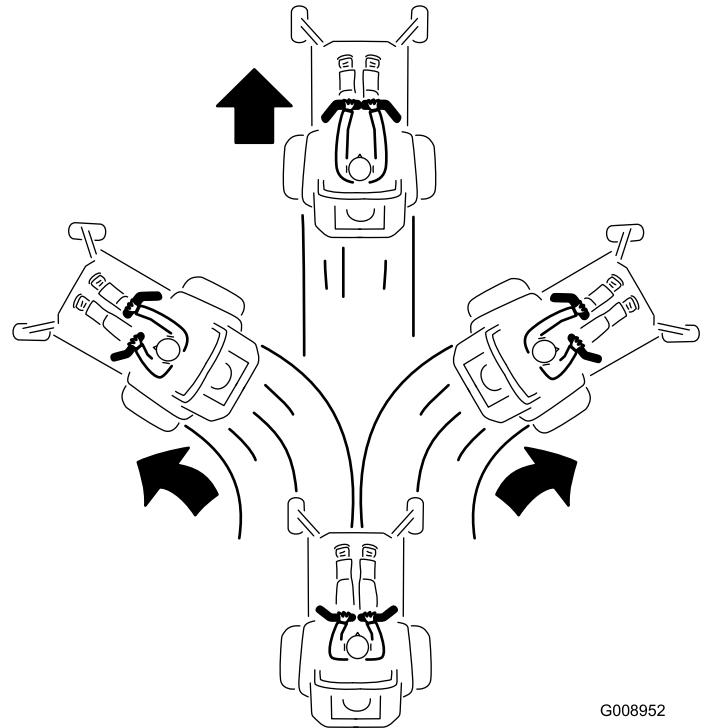


Figure 20

## Driving Backward

1. Move the levers to the center, unlocked position.
2. To go backward, slowly pull the motion-control levers rearward (Figure 21).

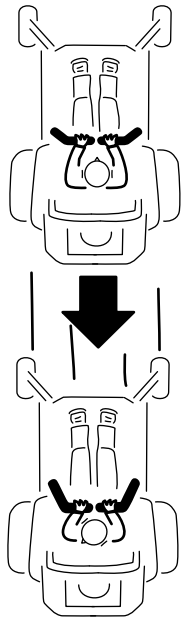


Figure 21

G008953

g008953

## Stopping the Machine

To stop the machine, move the traction-control levers to NEUTRAL, and then move them to the locked position, disengage the power take off blade-control switch (PTO), and turn the ignition key to the OFF position.

Set the parking brake when you leave the machine; refer to [Setting the Parking Brake \(page 22\)](#). Remove the key from the switch.

### CAUTION

Children or bystanders may be injured if they move or attempt to operate the machine while it is unattended.

Always remove the ignition key and set the parking brake when leaving the machine unattended, even if just for a few minutes.

## Adjusting the Height-of-Cut

### Using the Transport Lock

The transport lock has 2 positions and is used with the deck-lift pedal. There is a lock position and an unlock position for the transport position. You use the transport lock with the deck-lift pedal (Figure 22).

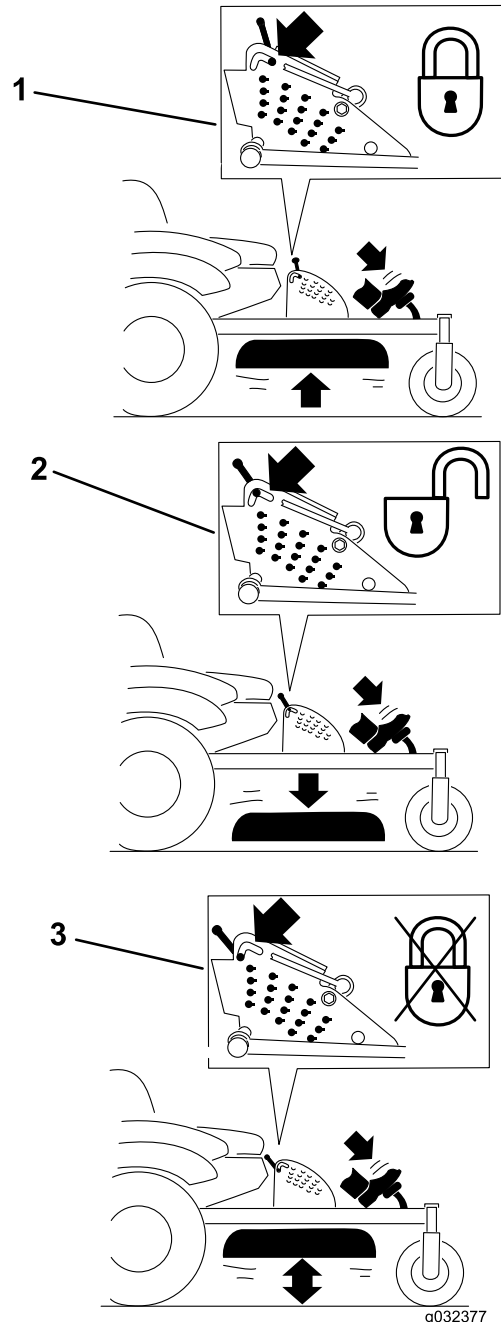


Figure 22

g032377

g032377

1. Transport lock
2. Lock position—mower deck will lock into the transport position
3. Unlock position—does not lock the mower deck into the transport position

## Adjusting the Height-of-Cut Pin

You can adjust the height of cut to from 25 to 140 mm (1 to 5-1/2 inches) in 6 mm (1/4 inch) increments by locating the clevis pin into different hole locations.

1. Move the transport lock to the lock position.
2. Push on the deck-lift pedal with your foot, and raise the mower deck to the transport position (also the 140 mm (5-1/2 inches) cutting-height position) as shown in Figure 23.
3. To adjust, rotate the pin 90 degrees and remove the pin from the height-of-cut bracket (Figure 23).
4. Select a hole in the height-of-cut bracket corresponding to the height-of-cut desired, and insert the pin (Figure 23).
5. Push on the deck lift, pull back on the transport lock, and slowly lower the mower deck.

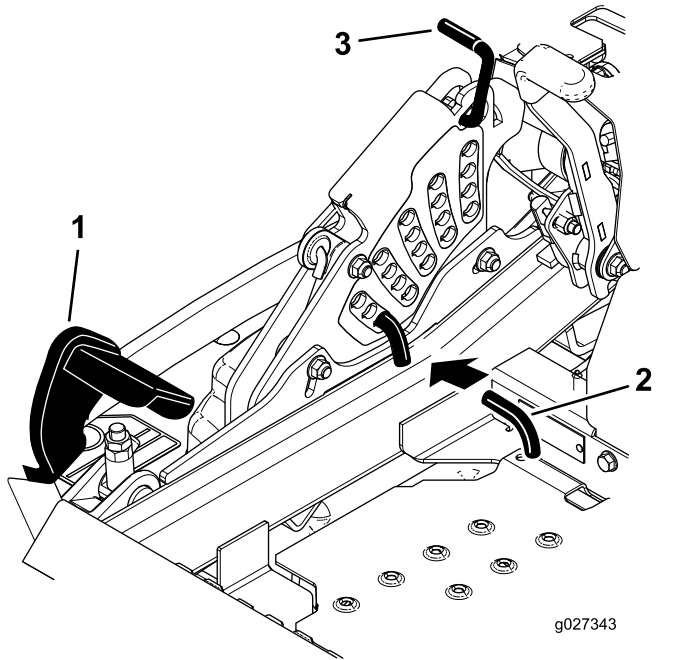


Figure 23

1. Deck-lift pedal
2. Cut-of-height pin
3. Transport lock

## Adjusting the Anti-Scalp Rollers

Whenever you change the height-of-cut, it is recommended to adjust the height of the anti-scalp rollers.

1. Disengage the BLADE-CONTROL switch (PTO), move the motion-control levers to the NEUTRAL-LOCK position, and set the parking brake.
2. Shut off the engine, remove the key, and wait for all moving parts to stop before leaving the operating position.
3. Adjust the anti-scalp rollers as shown in Figure 24, Figure 25, and Figure 26.

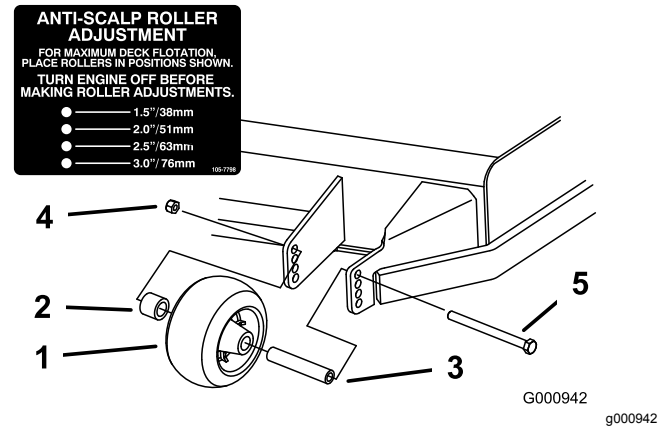


Figure 24

1. Anti-scalp roller
2. Spacer
3. Bushing
4. Flange nut
5. Bolt

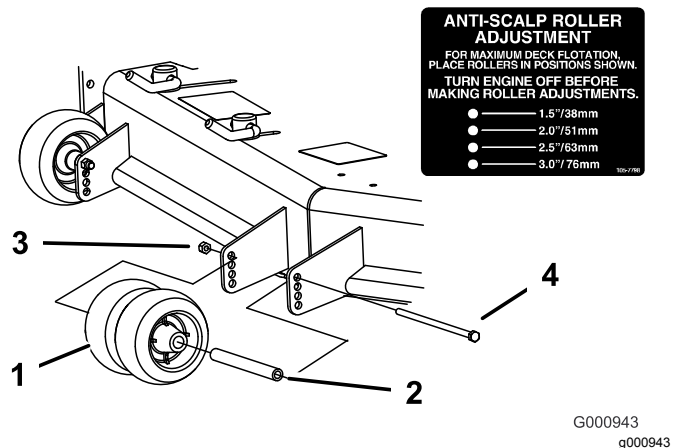


Figure 25

1. Anti-scalp roller
2. Bushing
3. Flange nut
4. Bolt

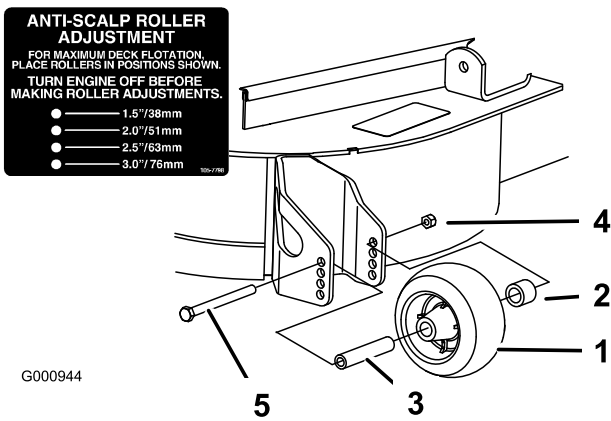


Figure 26

1. Anti-scalp roller
2. Spacer
3. Bushing
4. Flange nut
5. Bolt

## Adjusting the Flow Baffle Cam Locks

This procedure is applicable only to machines with the flow-baffle locks. Certain models have nuts and bolts in place of the flow-baffle locks and can be adjusted the same.

You can adjust the mower-discharge flow for different types of mowing conditions. Position the cam locks and baffle to give the best quality of cut.

1. Disengage the blade-control switch (PTO), move the motion-control levers to the NEUTRAL-LOCK position, and set the parking brake.
2. Shut off the engine, remove the key, and wait for all moving parts to stop before leaving the operating position.
3. To adjust the cam locks, swing the lever up to loosen the cam lock (Figure 27).
4. Adjust the baffle and cam locks in the slots to the desired discharge flow.
5. Swing the lever back over to tighten the baffle and cam locks (Figure 27).
6. If the cam locks do not lock the baffle into place or it is too tight, loosen the lever and then rotate the cam lock.

**Note:** Adjust the cam lock until you obtain the desired locking pressure.

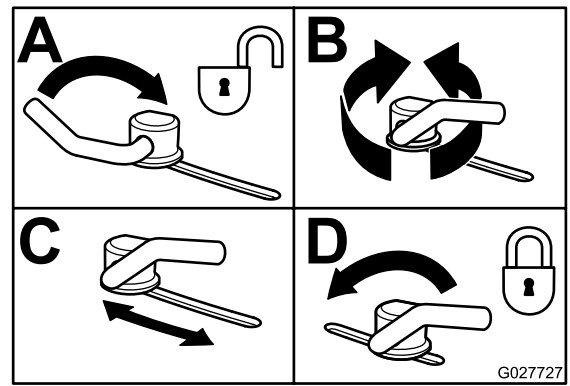


Figure 27

## Positioning the Flow Baffle

The following figures are only recommendations for use. Adjustments will vary by grass type, moisture content, and the height of the grass.

**Note:** If the engine power draws down and the mower ground speed is the same, open up the baffle.

### Position A

This is the full rear position. The suggested use for this position is as follows:

- Short, light grass mowing conditions
- Dry conditions
- Smaller grass clippings
- Propels grass clippings farther away from the mower.

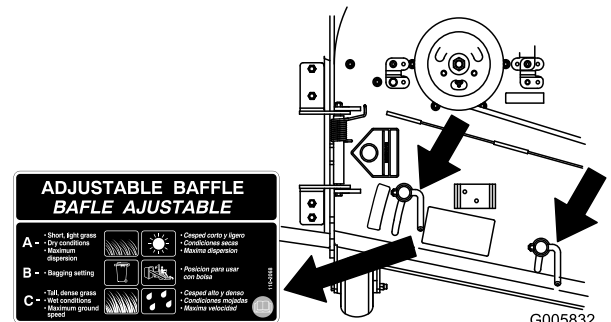


Figure 28

## Position B

Use this position when bagging. Always align it with the blower opening.

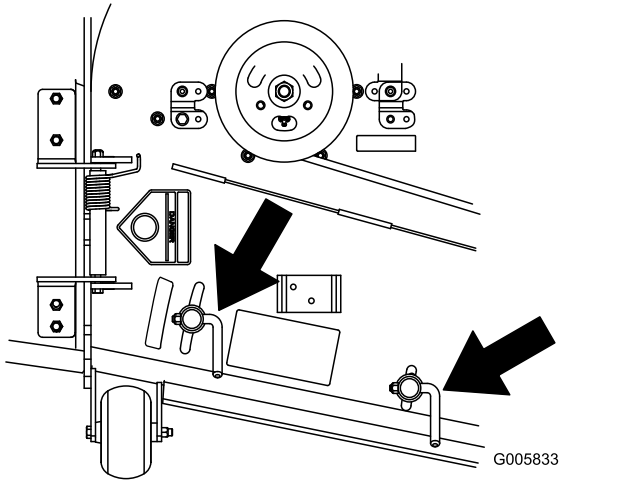


Figure 29

g005833

## Positioning the Seat

The seat moves forward and backward. Position the seat where you have the best control of the machine and are most comfortable.

To adjust, move the lever sideways to unlock the seat (Figure 31).

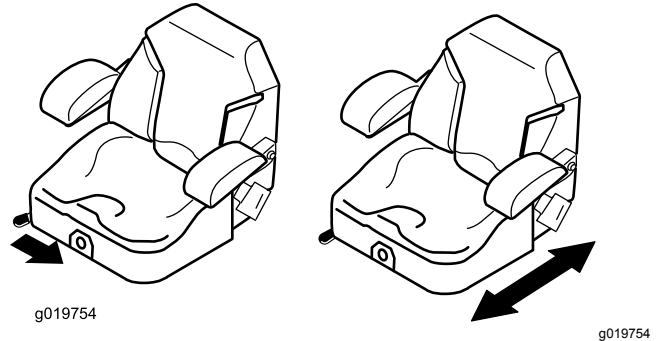


Figure 31

g019754

## Position C

This is the full-open position. The suggested use for this position is as follows:

- Tall, dense grass mowing conditions
- Wet conditions
- Lowers the engine-power consumption
- Allows increased ground speed in heavy conditions
- This position is similar to the benefits of the Toro SFS mower.

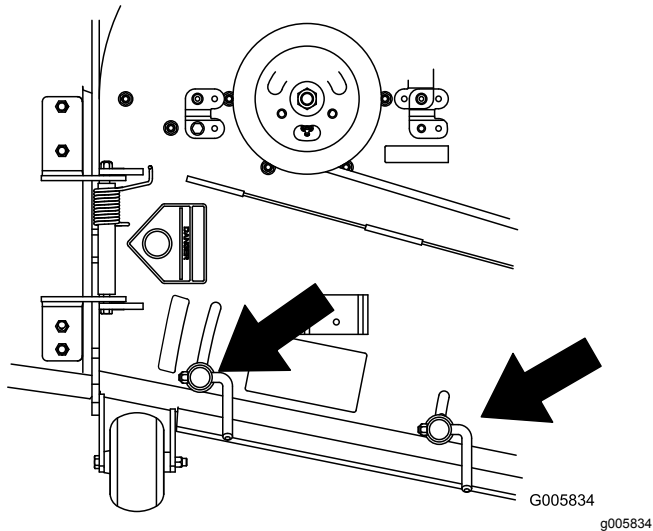


Figure 30

g005834

## Unlatching the Seat

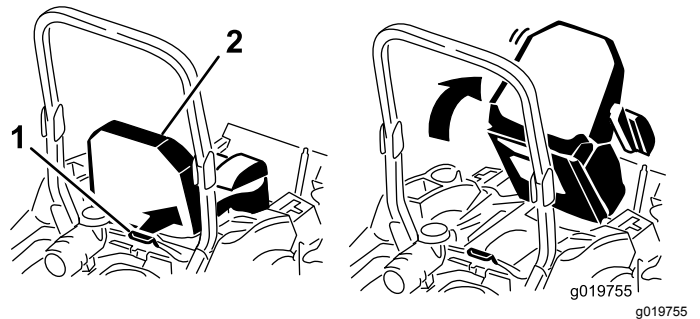


Figure 32

g019755

1. Seat latch

2. Seat

# Changing the Seat Suspension

The seat adjusts to provide a smooth and comfortable ride. Position the seat where you are most comfortable.

To adjust, turn the knob in front either direction to provide the best comfort (Figure 33).

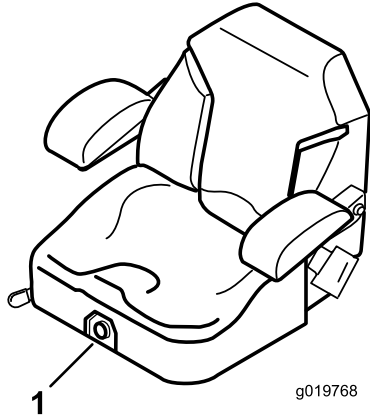


Figure 33

1. Seat-suspension knob

# Using the Drive-Wheel-Release Valves

## ⚠ WARNING

Hands may become entangled in the rotating drive components below the engine deck, which could result in serious injury.

Shut off the engine, remove the key, and allow all moving parts to stop before accessing the drive-wheel-release valves.

## ⚠ WARNING

The engine and hydraulic-drive units can become very hot. Touching a hot engine or hydraulic-drive units can cause severe burns.

Allow the engine and hydraulic-drive units to cool completely before accessing the drive-wheel-release valves.

The drive-wheel-release valves are located in the back of each hydraulic-drive unit, under the seat.

**Note:** Ensure that the release valves are in the fully horizontal position when operating the machine or severe damage to the hydraulic system can occur.

1. Disengage the PTO (blade-control switch) and turn the ignition key to the OFF position.
2. Move the levers to NEUTRAL-LOCK position, apply the parking brake, and remove the key.
3. Rotate the release-valve levers vertically to push the machine. This allows hydraulic fluid to bypass the pump enabling the wheels to turn (Figure 34).
4. Disengage the parking brake before pushing the machine.

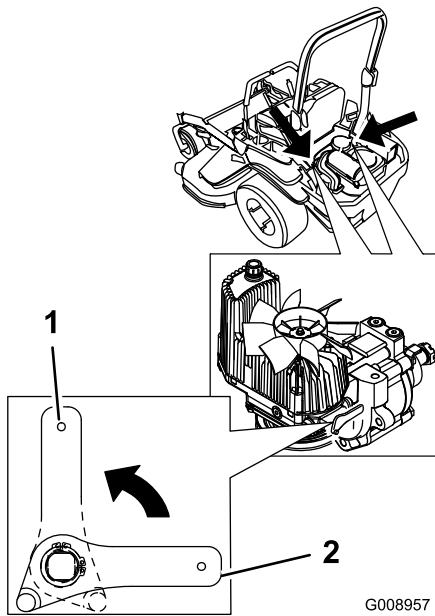
# Transporting the Machine

Use a heavy-duty trailer or truck to transport the machine. Ensure that the trailer or truck has all necessary brakes, lighting, and marking as required by law. Please carefully read all the safety instructions. Knowing this information could help you, your family, pets, or bystanders avoid injury.

## **⚠ WARNING**

**Driving on the street or roadway without turn signals, lights, reflective markings, or a slow-moving vehicle emblem is dangerous and can lead to accidents causing personal injury.**

**Do not drive the machine on a public street or roadway.**



**Figure 34**

1. Vertical to push the machine
2. Horizontal to run the machine

5. Rotate the release-valve levers horizontally to run the machine (Figure 34).

## Using the Side Discharge

The mower has a hinged grass deflector that disperses clippings to the side and down toward the turf.

### **⚠ DANGER**

**Without a grass deflector, discharge cover, or complete grass catcher assembly mounted in place, you and others are exposed to blade contact and thrown debris. Contact with rotating mower blade(s) and thrown debris will cause injury or death.**

- **Never remove the grass deflector from the mower because the grass deflector routes material down toward the turf. If the grass deflector is ever damaged, replace it immediately.**
- **Never put your hands or feet under the mower.**
- **Never try to clear the discharge area or mower blades unless you move the power take off (PTO) blade-control switch to the OFF position, rotate the ignition key to the OFF position, and remove the key.**
- **Ensure that the grass deflector is in the down position.**

- Be sure that the fuel valve is closed on the tank(s).
- Place spare LPG tank(s) in a DOT approved storage cage.
  - Transport the tanks in an upright, vertical, and secure position to minimize movement, tipping, or physical damage relative to other tanks or to the storage cage while in transit.
  - Place tanks so that valves, fittings, or gauges are protected from physical damage during transport.
- Place tank(s) in a well-ventilated trailer.
- Do not store the tank(s) or machine with tank(s) in an area where the temperature can rise above 120°F (49°C). If the temperature exceeds approximately 160°F (71°C), the tank will release highly flammable propane vapor. See Preparation in the Safety Section.
- Do not transport LPG tank(s) in the passenger space of a vehicle.
- Do not transport leaking fuel tanks.
- Trailers must have appropriate markings to transport LPG.
- Follow NFPA 58 and state and local regulations for transporting LPG.
  1. If using a trailer, connect it to the towing vehicle and connect the safety chains.
  2. If applicable, connect the trailer brakes.
  3. Load the machine onto the trailer or truck.
  4. Stop the engine, remove the key, set the brake, and close the fuel valve.
  5. Use the metal tie-down loops on the machine to securely fasten the machine to the trailer or truck with straps, chains, cable, or ropes (Figure 35).

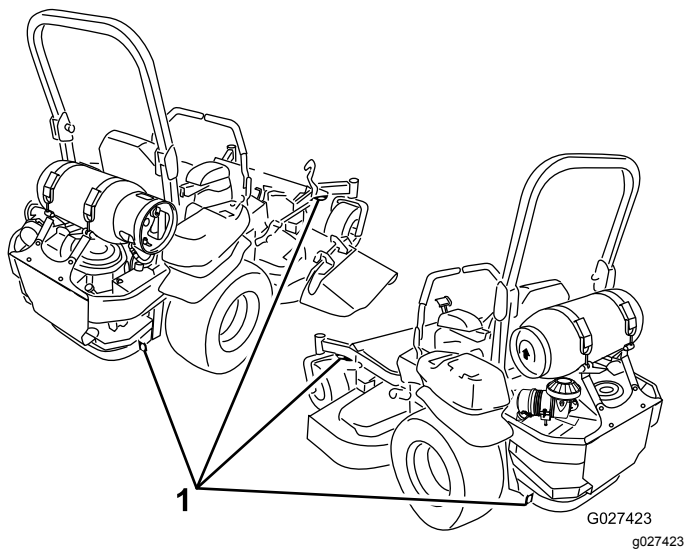


Figure 35

1. Tie-down loops

## Loading the Machine

Use extreme caution when loading or unloading machines onto a trailer or a truck. Use a full-width ramp that is wider than the machine for this procedure. Back up ramps and drive forward down ramps (Figure 36).

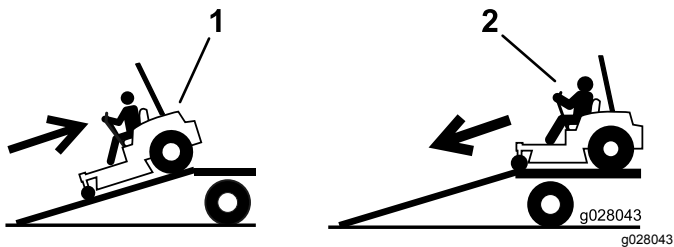


Figure 36

1. Back up ramps

2. Drive forward down ramps

**Important:** Do not use narrow individual ramps for each side of the machine.

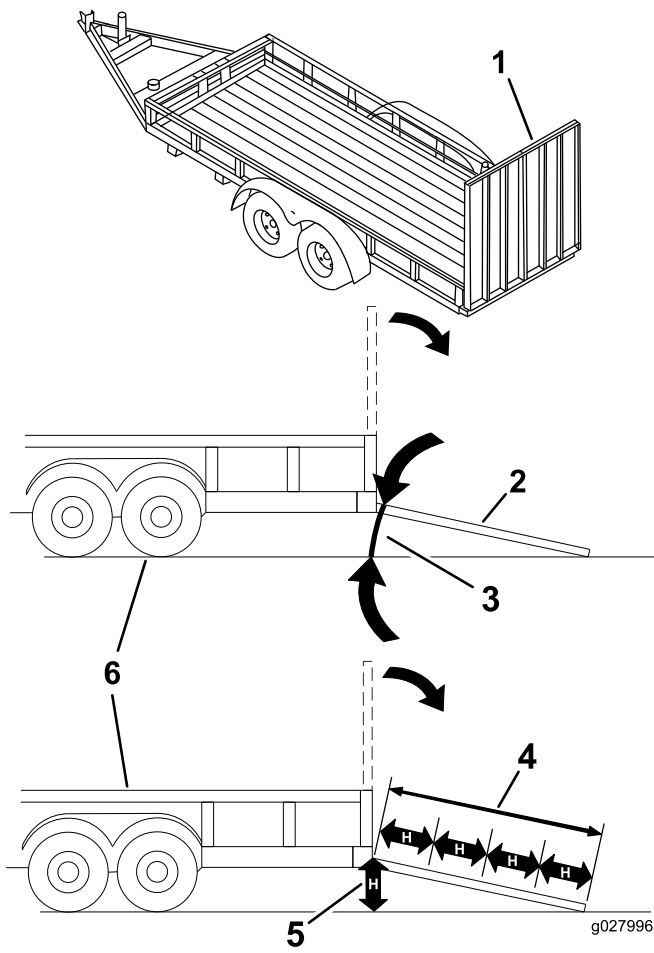
Ensure the ramp is long enough so that the angle with the ground does not exceed 15 degrees (Figure 37). On flat ground, this requires a ramp to be at least 4 times as long as the height of the trailer or truck bed to the ground. A steeper angle may cause mower components to get caught as the unit moves from the ramp to the trailer or truck. Steeper angles may also cause the machine to tip or lose control. If you are loading on or near a slope, position the trailer or truck so that it is on the down side of the slope and the ramp extends up the slope. This will minimize the ramp angle.

## ⚠ WARNING

Loading a machine onto a trailer or truck increases the possibility of tip-over and could cause serious injury or death.

- Use extreme caution when operating a machine on a ramp.
- Ensure that the ROPS is in the up position and use the seat belt when loading or unloading the machine. Ensure that the ROPS will clear the top of an enclosed trailer.
- Use only a full-width ramp; do not use individual ramps for each side of the machine.
- Do not exceed a 15-degree angle between the ramp and the ground or between the ramp and the trailer or truck.
- Ensure the length of ramp is at least 4 times as long as the height of the trailer or truck bed to the ground. This will ensure that ramp angle does not exceed 15 degrees on flat ground.
- Back up ramps and drive forward down ramps.
- Avoid sudden acceleration or deceleration while driving the machine on a ramp as this could cause a loss of control or a tip-over situation.





**Figure 37**

1. Full-width ramp in stowed position
2. Side view of full-width ramp in loading position
3. Not greater than 15 degrees
4. Ramp is at least 4 times as long as the height of the trailer or truck bed to the ground
5. H= height of the trailer or truck bed to the ground
6. Trailer

# Operating Tips

## Using the Fast Throttle Setting

For best mowing and maximum air circulation, operate the engine at the FAST position. Air is required to thoroughly cut grass clippings, so do not set the height-of-cut so low as to totally surround the mower in uncut grass. Always try to have 1 side of the mower free from uncut grass, which allows air to be drawn into the mower.

## Cutting a Lawn for the First Time

Cut grass slightly longer than normal to ensure that the cutting height of the mower does not scalp any uneven ground. However, the cutting height used in the past is generally the best one to use. When cutting grass longer than 15 cm (6 inches) tall, you may want to cut the lawn twice to ensure an acceptable quality of cut.

## Cutting a Third of the Grass Blade

It is best to cut only about a third of the grass blade. Cutting more than that is not recommended unless grass is sparse, or it is late fall when grass grows more slowly.

## Alternating the Mowing Direction

Alternate the mowing direction to keep the grass standing straight. This also helps disperse clippings which enhances decomposition and fertilization.

## Mowing at Correct Intervals

Grass grows at different rates at different times of the year. To maintain the same cutting height, mow more often in early spring. As the grass growth rate slows in mid summer, mow less frequently. If you cannot mow for an extended period, first mow at a high cutting height, then mow again 2 days later at a lower height setting.

## Using a Slower Cutting Speed

To improve cut quality, use a slower ground speed in certain conditions.

## Avoiding Cutting Too Low

When mowing uneven turf, raise the cutting height to avoid scalping the turf.

## Stopping

If you must stop the forward motion of the machine while mowing, a clump of grass clippings may

drop onto your lawn. To avoid this, move onto a previously cut area with the blades engaged or you can disengage the mower deck while moving forward.

## Keeping the Underside of the Mower Clean

Clean clippings and dirt from the underside of the mower after each use. If grass and dirt build up inside the mower, cutting quality will eventually become unsatisfactory.

## Maintaining the Blade(s)

Maintain a sharp blade throughout the cutting season because a sharp blade cuts cleanly without tearing or shredding the grass blades. Tearing and shredding turns grass brown at the edges, which slows growth and increases the chance of disease. Check the mower blades after each use for sharpness, and for any wear or damage. File down any nicks and sharpen the blades as necessary. If a blade is damaged or worn, replace it immediately with a genuine Toro replacement blade.

# Maintenance

## Recommended Maintenance Schedule(s)

Maintenance Service Interval	Maintenance Procedure
After the first 8 hours	<ul style="list-style-type: none"> <li>• Change the engine oil.</li> </ul>
After the first 100 hours	<ul style="list-style-type: none"> <li>• Check the wheel lug nut torque.</li> <li>• Check the wheel hub slotted-nut torque.</li> <li>• Check the parking brake adjustment.</li> </ul>
After the first 250 hours	<ul style="list-style-type: none"> <li>• Change the hydraulic filters and hydraulic fluid when using any type of fluid.</li> </ul>
Before each use or daily	<ul style="list-style-type: none"> <li>• Check the safety system.</li> <li>• Check the engine-oil level.</li> <li>• Check the LPG tank and components.</li> <li>• Check the seat belt.</li> <li>• Check the knobs on the rollover protection system (ROPS) .</li> <li>• Clean the engine screen and the oil cooler.</li> <li>• Check and clean the hydraulic unit shrouds.</li> <li>• Check the mower blades.</li> <li>• Clean the mower deck.</li> </ul>
Every 40 hours	<ul style="list-style-type: none"> <li>• Check the LPG hoses, regulator and connections.</li> </ul>
Every 50 hours	<ul style="list-style-type: none"> <li>• Grease the mower deck spindles and idler arm.</li> <li>• Check spark arrester (if equipped).</li> <li>• Check the tire pressure.</li> <li>• Inspect the belts for cracks and wear.</li> <li>• Check the hydraulic-fluid level.</li> </ul>
Every 100 hours	<ul style="list-style-type: none"> <li>• Lubricate the mower deck lift pivots.</li> <li>• Change the engine oil more often in dirty or dusty conditions.</li> <li>• Check, clean and regap the spark plug.</li> <li>• Check and clean engine cooling fins and shrouds.</li> </ul>
Every 150 hours	<ul style="list-style-type: none"> <li>• Inspect the primary filter and air-inlet screen.</li> </ul>
Every 200 hours	<ul style="list-style-type: none"> <li>• Change the engine oil filter.</li> </ul>
Every 250 hours	<ul style="list-style-type: none"> <li>• Change the hydraulic filters and hydraulic fluid when using Mobil® 1 fluid (more often in dirty or dusty conditions).</li> </ul>
Every 300 hours	<ul style="list-style-type: none"> <li>• Replace the primary air filter. (more often in dusty or sandy conditions)</li> <li>• Check the air filter.</li> </ul>
Every 500 hours	<ul style="list-style-type: none"> <li>• Check the wheel lug nut torque.</li> <li>• Check the wheel hub slotted-nut torque.</li> <li>• Adjust the caster pivot bearing.</li> <li>• Check the parking brake adjustment.</li> <li>• Change the hydraulic filters and hydraulic fluid when using Toro® HYPR-OIL™ 500 hydraulic fluid (more often in dirty or dusty conditions).</li> </ul>
Every 600 hours	<ul style="list-style-type: none"> <li>• Replace the air filter.</li> </ul>
Monthly	<ul style="list-style-type: none"> <li>• Check the battery.</li> </ul>
Yearly	<ul style="list-style-type: none"> <li>• Grease the pump-belt-idler arm.</li> <li>• Grease the front-caster pivots (more often in dirty or dusty conditions).</li> <li>• Repack the front caster-wheel bearings (more often in dirty or dusty conditions).</li> <li>• Lubricate the caster wheel hubs.</li> </ul>
Yearly or before storage	<ul style="list-style-type: none"> <li>• Paint chipped surfaces.</li> <li>• Check all maintenance procedures listed above before storage.</li> </ul>

**Important:** Refer to your engine operator's manual for additional maintenance procedures.

## ⚠ CAUTION

If you leave the key in the ignition switch, someone could start the engine and seriously injure you or other bystanders.

Remove the key from the ignition before you do any maintenance.

## Lubrication

### Greasing and Lubrication

Grease more frequently when operating conditions are extremely dusty or sandy.

**Grease Type:** No. 2 lithium or molybdenum grease

1. Disengage the blade-control switch (PTO), move the motion-control levers to the NEUTRAL-LOCK position and set the parking brake.
2. Shut off the engine, remove the key, and wait for all moving parts to stop before leaving the operating position.
3. Clean the grease fittings with a rag. Ensure to scrape any paint off the front of the fitting(s).
4. Connect a grease gun to the fitting. Pump grease into the fittings until grease begins to ooze out of the bearings.
5. Wipe up any excess grease.

### Adding Light Oil or Spray Lubrication

**Service Interval:** Every 100 hours—Lubricate the mower deck lift pivots.

Lubricate the mower-deck-lift pivots.

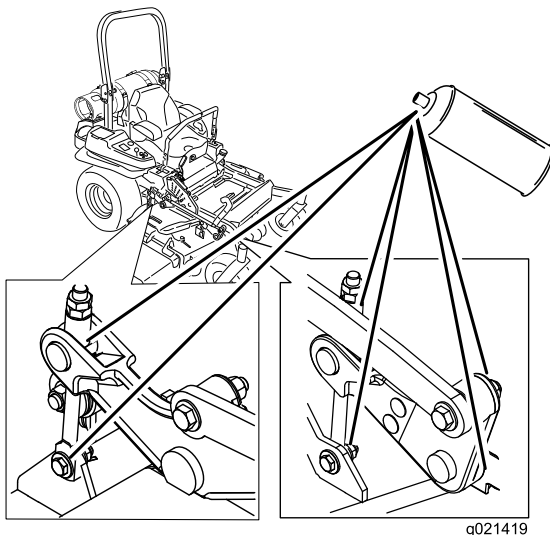


Figure 38

### Greasing the Mower

**Service Interval:** Every 50 hours—Grease the mower deck spindles and idler arm.

Yearly—Grease the pump-belt-idler arm.

Yearly—Grease the front-caster pivots (more often in dirty or dusty conditions).

Yearly—Repack the front caster-wheel bearings (more often in dirty or dusty conditions).

**Important:** Ensure that the cutting unit spindles are full of grease weekly.

1. Disengage the blade-control switch (PTO), move the motion-control levers to the NEUTRAL-LOCK position, and set the parking brake.
2. Shut off the engine, remove the key, and wait for all moving parts to stop before leaving the operating position.
3. Grease the mower-deck-idler pulley pivot until grease come out the bottom (Figure 39).
4. Grease the 3 spindle bearings until grease comes out the lower seals (Figure 39).

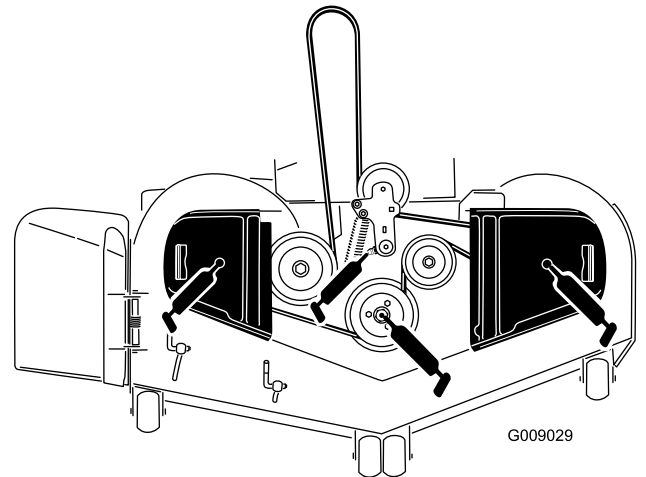


Figure 39

5. Grease the drive-belt-idler arm (Figure 39).

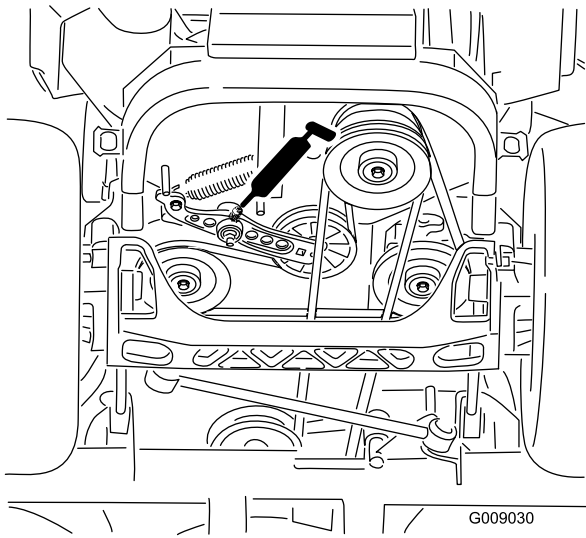


Figure 40

6. Remove the dust cap and adjust the caster pivots. Keep the dust cap off until greasing is done. Refer to [Adjusting the Caster Pivot Bearing \(page 51\)](#).
7. Remove the hex plug. Thread a grease fitting into the hole.
8. Pump grease into the fitting until it oozes out around the top bearing.
9. Remove the grease fitting in the hole. Install the hex plug and dust cap ([Figure 41](#)).

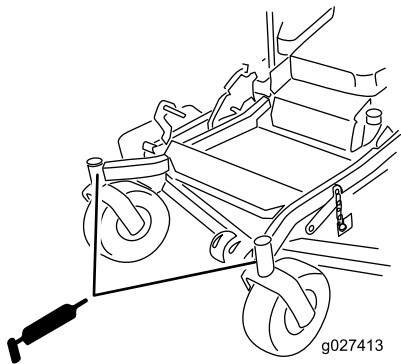


Figure 41

## Lubricating the Caster Wheel Hubs

**Service Interval:** Yearly

1. Shut off the engine, wait for all moving parts to stop, and remove the key. Engage the parking brake.

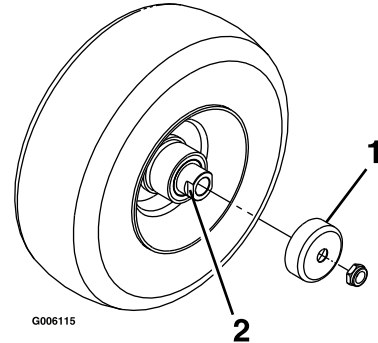


Figure 42

1. Seal guard
2. Spacer nut with wrench flats

2. Raise the front of the machine up and support it with jack stands.
3. Remove the caster wheel from the caster forks.
4. Remove the seal guards from the wheel hub.
5. Remove 1 of the spacer nuts from the axle assembly in the caster wheel.

**Note:** Note that thread-locking adhesive has been applied to lock the spacer nuts to the axle. Remove the axle (with the other spacer nut still assembled to it) from the wheel assembly.

6. Pry out the seals, and inspect the bearings for wear or damage and replace if necessary.
7. Pack the bearings with a general-purpose grease.
8. Insert 1 bearing and 1 new seal into the wheel.

**Note:** Replace the seals.

9. If the axle assembly has had both spacer nuts removed (or broken loose), apply a thread-locking adhesive to 1 spacer nut and thread it onto the axle with the wrench flats facing outward.

**Note:** Do not thread the spacer nut all of the way onto the end of the axle. Leave approximately 3 mm (1/8 inch) from the outer surface of the spacer nut to the end of the axle inside the nut.

10. Insert the assembled nut and axle into the wheel on the side of the wheel with the new seal and bearing.

# Engine Maintenance

## ⚠ WARNING

Contact with hot surfaces may cause personal injury.

Keep your hands, feet, face, clothing, and other body parts away from the muffler and other hot surfaces.

## Servicing the Air Cleaner

**Service Interval:** Every 150 hours

Every 300 hours/Yearly (whichever comes first)—Replace the primary air filter. (more often in dusty or sandy conditions)

Every 300 hours—Check the air filter.

Every 600 hours—Replace the air filter.

**Note:** Check the filters more frequently if the operating conditions are extremely dusty or sandy.

## Removing the Filters

1. Disengage the PTO, move the motion-control levers to the NEUTRAL-LOCK position, and set the parking brake.
2. Shut off the engine, remove the key, and wait for all moving parts to stop before leaving the operating position.
3. Release the latches on the air cleaner and pull the air-inlet cover off the air-cleaner body (Figure 43).
4. Clean the air-inlet screen and cover.
5. Install the air-inlet cover and secure it with the latches (Figure 43).

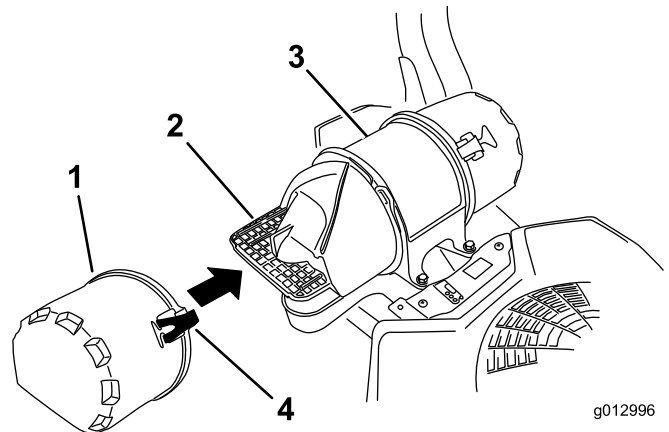


Figure 43

- |                     |                     |
|---------------------|---------------------|
| 1. Air-inlet cover  | 3. Air-cleaner body |
| 2. Air-inlet screen | 4. Latch            |

11. With the open end of the wheel facing up, fill the area inside the wheel around the axle full of general-purpose grease.
12. Insert the second bearing and new seal into the wheel.
13. Apply a thread-locking adhesive to the second spacer nut and thread it onto the axle with the wrench flats facing outward.
14. Torque the nut to 8 to 9 N·m (75 to 80 in-lb), loosen the nut, then torque it to 2 to 3 N·m (20 to 25 in-lb).

**Note:** Ensure that the axle does not extend beyond either nut.

15. Install the seal guards over the wheel hub and insert the wheel into the caster fork. Install the caster bolt and tighten the nut fully.

**Important:** To prevent seal and bearing damage, check the bearing adjustment often. Spin the caster tire. The tire should not spin freely (more than 1 or 2 revolutions) or have any side play. If the wheel spins freely, adjust the torque on the spacer nut until there is a slight amount of drag. Apply thread-locking adhesive.

- Release the latches on the air cleaner and pull the air-cleaner cover off the air-cleaner body (Figure 44).
- Clean the inside of the air-cleaner cover with compressed air.
- Gently slide the primary filter out of the air-cleaner body (Figure 44).

**Note:** Avoid knocking the filter into the side of the body.

- Remove the safety filter only if you intend to replace it.

**Important:** Never attempt to clean the safety filter. If the safety filter is dirty, then the primary filter is damaged. Replace both filters.

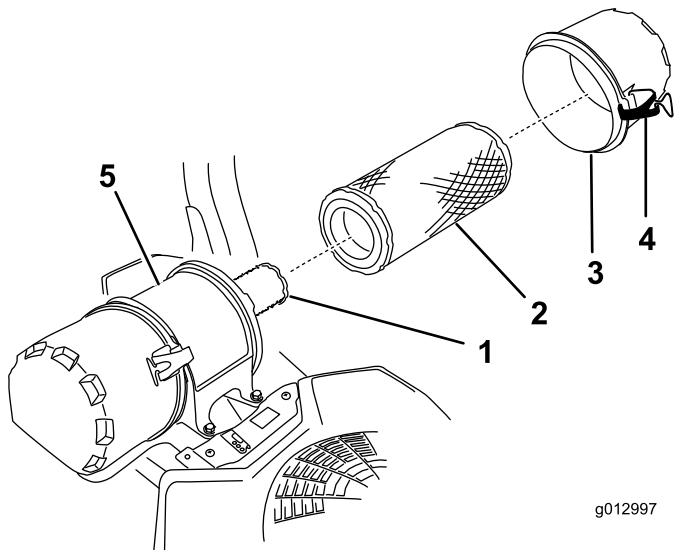


Figure 44

- Safety filter
- Primary filter
- Air-cleaner cover
- Latch
- Air-cleaner body

- Inspect the primary filter for damage by looking into the filter while shining a bright light on the outside of the filter. Holes in the filter will appear as bright spots. If the filter is damaged, discard it.

## Servicing the Primary Filter

- Replace the primary filter if it is dirty, bent, or damaged.
- Do not clean the primary filter.

## Servicing the Safety Filter

Replace the safety filter, never clean it.

**Important:** Never attempt to clean the safety filter. If the safety filter is dirty, then the primary filter is damaged. Replace both filters.

## Installing the Filters

**Important:** To prevent engine damage, always operate the engine with both air filters and cover installed.

**Note:** If installing new filters, check each filter for shipping damage. Do not use a damaged filter.

- To replace the safety filter, carefully slide it into the filter body (Figure 44).
- Carefully slide the primary filter over the safety filter (Figure 44).

**Note:** Ensure that the primary filter is fully seated by pushing on its outer rim while installing it.

**Important:** Do not press on the soft inside area of the filter.

- Install the air-cleaner cover and secure the latches (Figure 44).

## Servicing the Engine Oil

**Engine Oil Type:** Detergent oil (API service SG, SH, SJ, or SL)

**Engine Oil Capacity:** with a filter change, 2.3 L (77 oz); without a filter change, 2.1 L (70 oz)

**Viscosity:** See the table below.

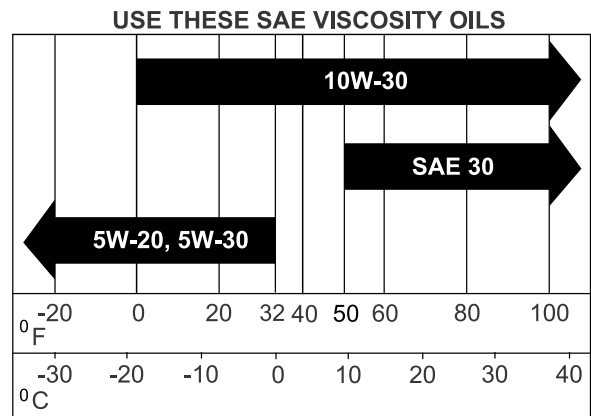


Figure 45

**Note:** Use of multi-grade oils (5W-20, 10W-30, or 10W-40) will increase oil consumption. Check the oil level more frequently when using them.

## Checking the Engine-Oil Level

**Service Interval:** Before each use or daily

**Note:** Check the oil when the engine is cold.

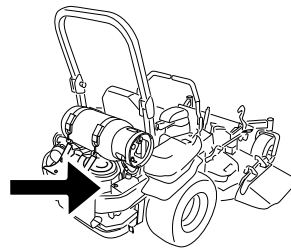
**▲ WARNING**

Contact with hot surfaces may cause personal injury.

Keep hands, feet, face, clothing, and other body parts away from the muffler and other hot surfaces.

**Important:** Do not overfill the crankcase with oil because damage to the engine may result. Do not run engine with oil below the low mark because the engine may be damaged.

1. Disengage the PTO, move the motion-control levers to the NEUTRAL-LOCK position, and set the parking brake.
2. Shut off the engine, remove the key, and wait for all moving parts to stop before leaving the operating position (Figure 46).



G021395  
g021395

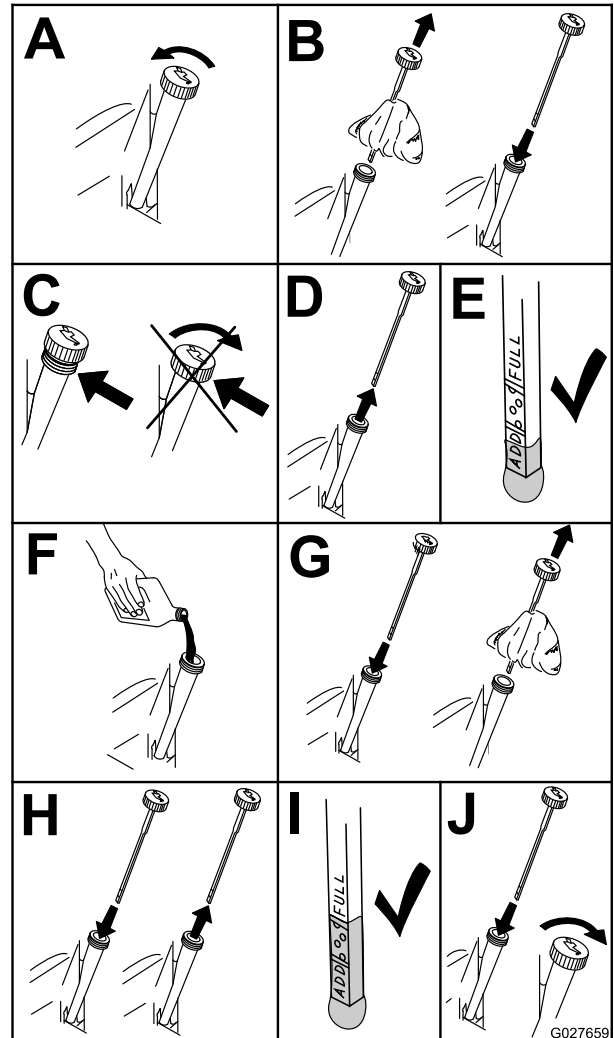


Figure 46

g027659



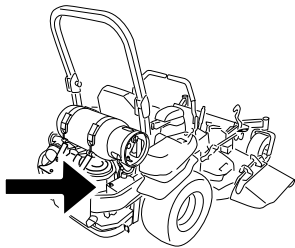
# Changing the Engine Oil

**Service Interval:** After the first 8 hours

Every 100 hours more often in dirty or dusty conditions.

**Note:** Dispose of the used oil at a recycling center.

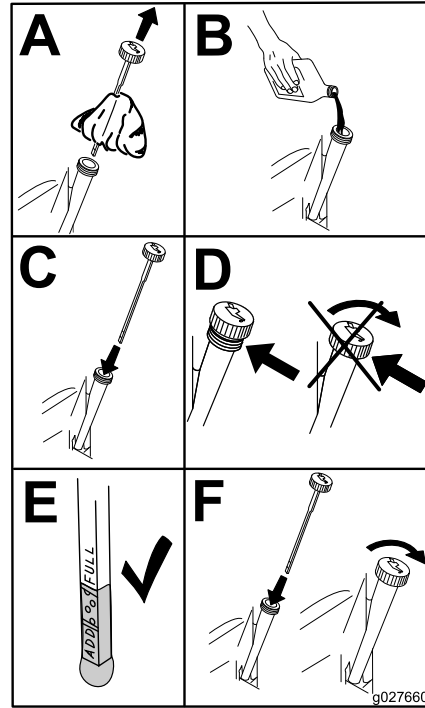
1. Park the machine so that the rear is slightly lower than the front to ensure that the oil drains completely.
2. Disengage the PTO, move the motion-control levers to the NEUTRAL-LOCK position, and set the parking brake.
3. Shut off the engine, remove the key, and wait for all moving parts to stop before leaving the operating position.
4. Drain the engine oil (Figure 47).



G021395

g021395

5. Slowly pour approximately 80% of the specified oil into the filler tube and slowly add the additional oil to bring it to the full mark (Figure 48).



g027660

Figure 48

g027660

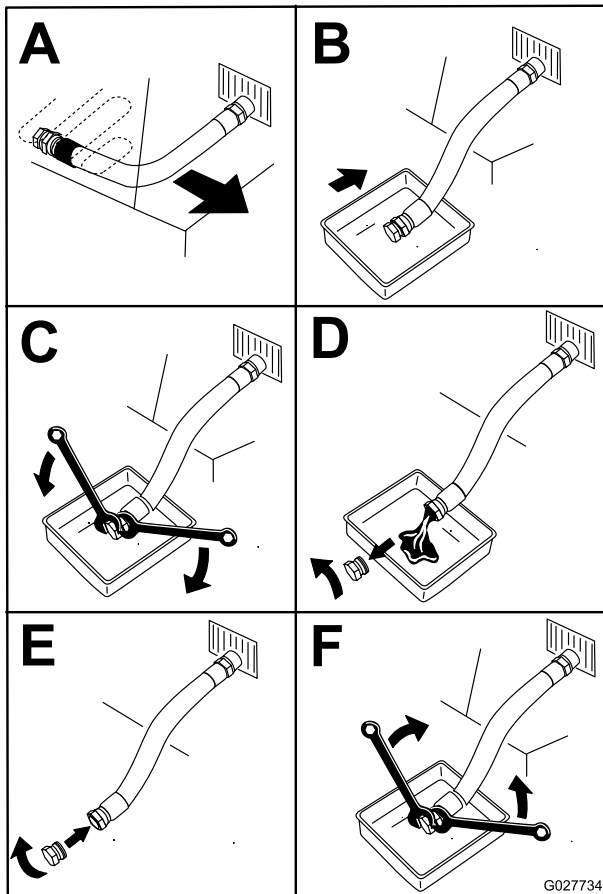
6. Start the engine and drive to a flat area. Check the oil level again.

# Changing the Engine-Oil Filter

**Service Interval:** Every 200 hours

**Note:** Change the engine oil filter more frequently when operating conditions are extremely dusty or sandy.

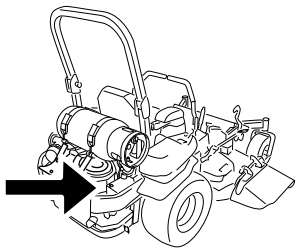
1. Drain the oil from the engine; refer to [Changing the Engine Oil](#) (page 41).
2. Change the engine-oil filter (Figure 49).



G027734

g027734

Figure 47



G021395  
g021395

# Servicing the Spark Plug

**Service Interval:** Every 100 hours

Ensure that the air gap between the center and side electrodes is correct before installing the spark plug. Use a spark plug wrench for removing and installing the spark plug(s) and a gapping tool/feeler gauge to check and adjust the air gap. Install a new spark plug(s) if necessary.

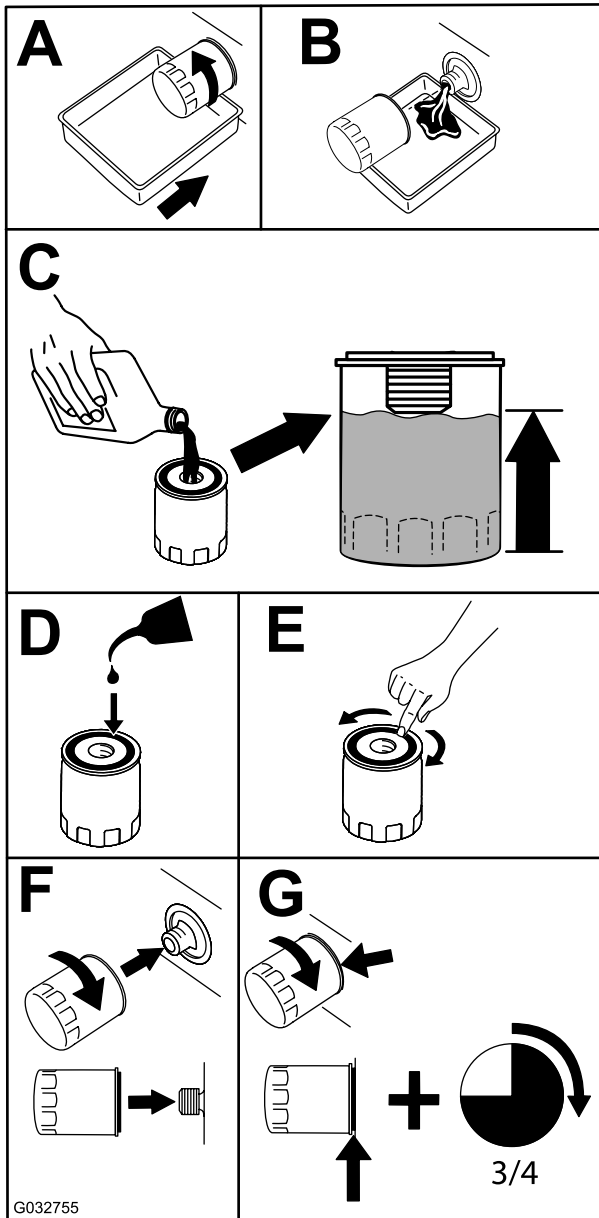
**Type:** Champion® XC12YC or equivalent

**Air Gap:** 0.75 mm (0.030 inch)

## Removing the Spark Plug

1. Shut off the engine, remove the key, and wait for all moving parts to stop before leaving the operating position.
2. Disengage the PTO, move the motion-control levers to the NEUTRAL-LOCK position and set the parking brake.
3. Remove the left-hydraulic-unit shroud in the order listed with [Figure 50](#).

**Note:** This gives you access to the front spark plug.



G032755

g032755

**Figure 49**

**Note:** Ensure that the oil filter gasket touches the engine and then turn it an extra 3/4 turn.

3. Fill the crankcase with the proper type of new oil; refer to [Changing the Engine Oil \(page 41\)](#).

## Checking the Spark Plug

**Important:** Never clean the spark plug(s). Always replace the spark plug(s) when it has: a black coating, worn electrodes, an oily film, or cracks.

If you see light brown or gray on the insulator, the engine is operating properly. A black coating on the insulator usually means the air cleaner is dirty.

Set the gap to 0.76 mm (0.030 inches).

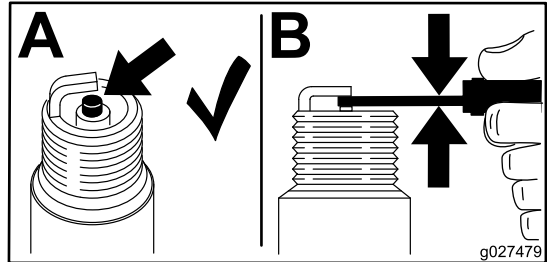


Figure 52

g027479

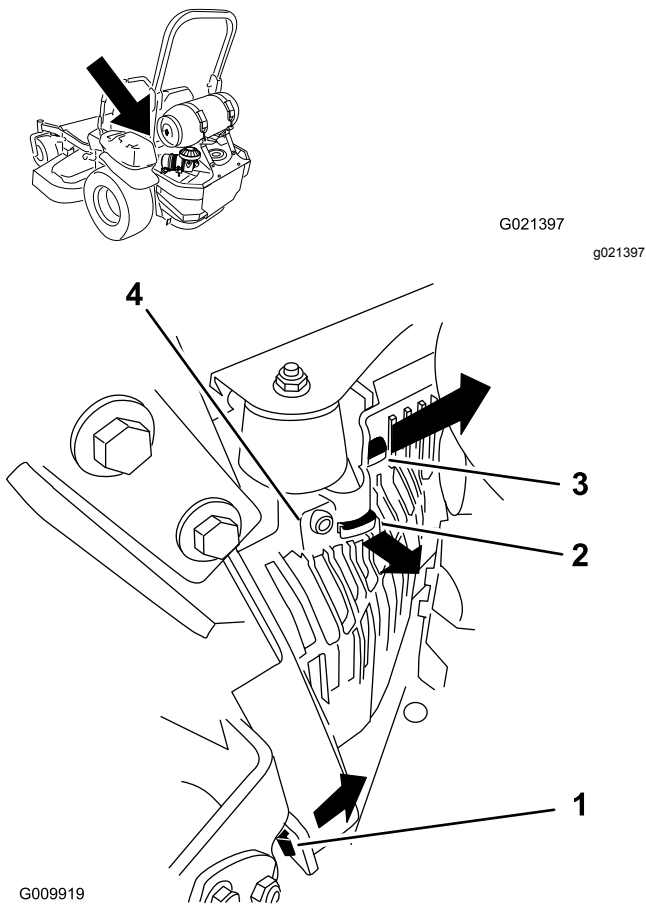


Figure 50

1. Pull this tab out to the side in the direction of the arrow.
2. Pull the shroud off this frame tab in the direction of the arrow.
3. Pull the shroud off this frame tab in the direction of the arrow.
4. Shroud

4. Remove the spark plug.

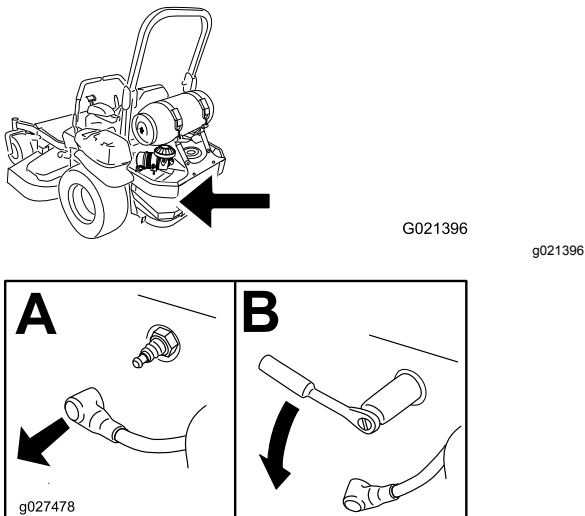


Figure 51

5. Install the left-hydraulic-unit shroud (Figure 50).

## Installing the Spark Plug

Tighten the spark plug(s) to 22 N·m (16 ft.-lb).

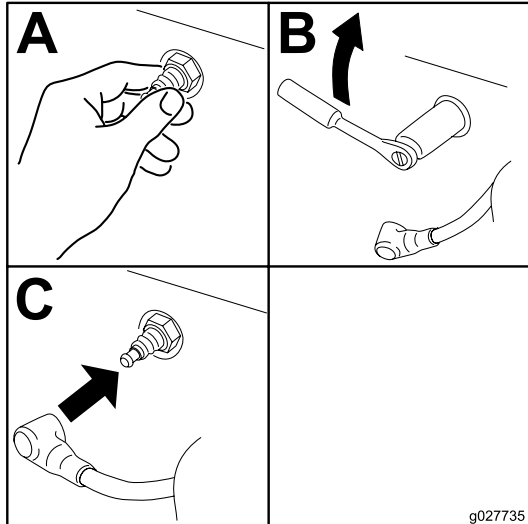


Figure 53

g027735

## Checking Spark Arrester

### If Equipped

**Service Interval:** Every 50 hours

#### **⚠ WARNING**

**Hot particles exhausted during engine operation may ignite flammable materials. Fire may result in personal injury or property damage.**

1. Shut off the engine, wait for all moving parts to stop, and remove the key. Engage parking brake.
2. Wait for the muffler to cool.
3. Replace the arrester if there are any breaks in the screen or welds.
4. If the screen is plugged, remove the arrester and shake loose any particles out of the arrester and clean the screen with a wire brush (soak the arrester in solvent if necessary). Install arrester on the exhaust outlet.

## Fuel System Maintenance

### Inspecting the LPG System

**Service Interval:** Before each use or daily—Check the LPG tank and components.

Every 40 hours—Check the LPG hoses, regulator and connections.

It is very important to check the LPG tank and components for wear or leaks.

**Important:** Never check for leaks using an open flame.

**Important:** Never use bare hands when checking the fitting or valve. Escaping LPG vapor and liquid freezes skin on contact.

- **Inspecting the LPG system before each use:**
  - Visually inspect the tank, hose, and fitting and be alert to a foul odor coming from the tank.
  - The LPG tank should be free of dents or damage. If the tank show signs of dents or damage, replace it immediately.
  - Check the valve and fitting openings for dirt and debris.
  - Slowly open the valve all the way and listen for a continuous hiss from the regulator, it may indicate a leak.
  - LPG has a rotten egg or skunk smell added to it to help detect a gas leak. If you detect a gas leak:
    - ◇ Turn off the LPG valve if you can safely do so.
    - ◇ Leave the area.
    - ◇ Contact trained and qualified personnel immediately.
  - Do not use if the hoses are abraded, damaged, kinked, or flattened.
  - Ensure that the tank is securely mounted to the mower. If the tank is loose, the hose or fittings may leak.
- **Inspecting the LPG system with each tank change:**
  - Check all gauges, fittings, and valves for damage.
  - Look for deterioration, worn or missing O-rings on the tank connection fitting.
  - Inspect the LPG tank and the fuel connection joint for leaks. Use the following procedure below to detect leaks:
    - ◇ Apply an approved leak detector solution, obtained from a trained and qualified LPG

distributor, or a thick non-ammonia soapy water solution (50% non-ammonia soap and 50% water). (A leak detector solution that contains ammonia will cause the fittings to corrode and leak.)

- ◇ Using a small brush or spray bottle, apply the solution around all the fittings of the LPG tank and the fuel connection joint.
- ◇ Slowly open the gas valve a half-turn.
- ◇ If bubbles are detected, the joint or fitting has a leak. Shut off the valve, tighten the leaking connection, and slowly open the valve again. If bubbles still appear, **do not** use the tank. If it is safe to do so, remove the tank from your mower; otherwise, contact trained and qualified personnel immediately.
- ◇ If no bubbles are detected, the LPG tank may be used.

- **Inspecting the LPG system weekly:**

- Check the LPG hoses, regulator, and connections for damage or deterioration.
- Check the LPG hoses, regulator, and connections for leaks at all joints using the same method as described in the previous section.
- Follow all the inspection checks as specified in the 2 previous inspection sections.

- **Tank Requalification:**

- USDOT (United States Department of Transportation) regulations require LPG tanks to be inspected, requalified, and marked within 12 years of the manufacture date and on a regular basis thereafter. Typically this occurs when the tank is refilled; contact a trained and qualified LPG tank provider for more details.
- Do not fill the LPG tank if it is beyond the requalification period.
- Do not fill damaged or rusted LPG tanks.

Once the MIL illuminates, initial trouble shooting checks should be made. Refer to the MIL section in [Troubleshooting \(page 70\)](#).

If these checks do not correct the problem, further diagnosis and servicing by an Authorized Service Dealer is necessary.

## Servicing the Electronic Fuel Injection System

This machine contains an electronic-fuel-injection (EFI) system. It controls the fuel flow under different operating conditions.

The electronic control unit (ECU) continuously monitors the operation of the EFI system.

If a problem or fault within the system is detected, the malfunction indicator light (MIL) is illuminated. The MIL is the red light located in the right console panel.

# Electrical System Maintenance

## Servicing the Battery

Service Interval: Monthly

### **⚠ DANGER**

Battery electrolyte contains sulfuric acid, which is a deadly poison and causes severe burns.

Do not drink electrolyte and avoid contact with skin, eyes or clothing. Wear safety glasses to shield your eyes and rubber gloves to protect your hands.

## Removing the Battery

### **⚠ WARNING**

Battery terminals or metal tools could short against metal machine components causing sparks. Sparks can cause the battery gasses to explode, resulting in personal injury.

- When removing or installing the battery, do not allow the battery terminals to touch any metal parts of the machine.
- Do not allow metal tools to short between the battery terminals and metal parts of the machine.

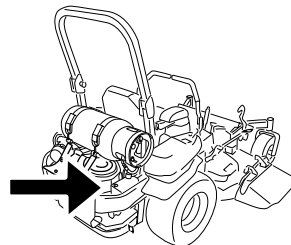
### **⚠ WARNING**

Incorrect battery cable routing could damage the machine and cables causing sparks. Sparks can cause the battery gasses to explode, resulting in personal injury.

- Always disconnect the negative (black) battery cable before disconnecting the positive (red) cable.
- Always reconnect the positive (red) battery cable before reconnecting the negative (black) cable.

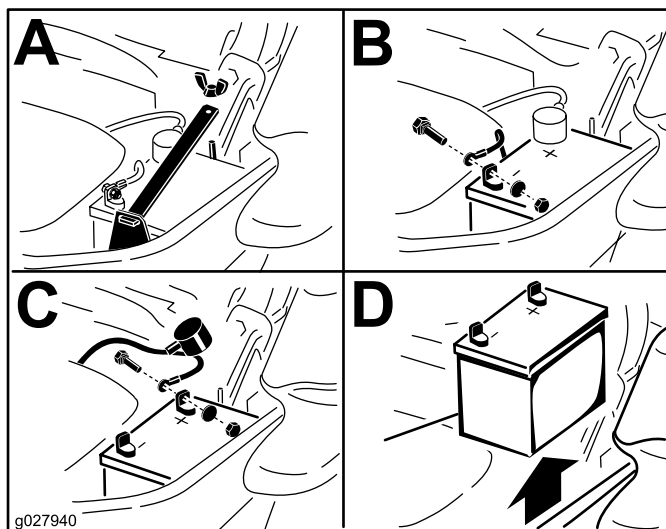
1. Disengage the blade-control switch (PTO), move the motion-control levers to the NEUTRAL-LOCK position and set the parking brake.
2. Shut off the engine, remove the key, and wait for all moving parts to stop before leaving the operating position.

3. First disconnect the negative battery cable (black) from the negative (-)(black) battery terminal (Figure 54).
4. Slide the red terminal boot off the positive (red) battery terminal and remove the positive (+)(red) battery cable (Figure 54).
5. Remove the wing nut securing the battery clamp (Figure 54).
6. Remove the clamp (Figure 54).
7. Remove the battery.



G021395

g021395



g027940

g027940

Figure 54

1. Remove the wing nut and clamp
2. Remove the negative battery cable before the positive
3. Remove the positive battery cable
4. Remove the battery

## Installing the Battery

1. Position battery in the tray with the terminal posts opposite from the hydraulic tank (Figure 54).
2. First, install the positive (red) battery cable to positive (+) battery terminal.
3. Then install the negative (black) battery cable and ground wire to the negative (-) battery terminal.
4. Secure the cables with 2 bolts, 2 washers, and 2 locknuts (Figure 54).

- Slide the red terminal boot onto the positive (red) battery post.
- Install the clamp and secure it with the wing nut ([Figure 54](#)).

## Charging the Battery

### **⚠ WARNING**

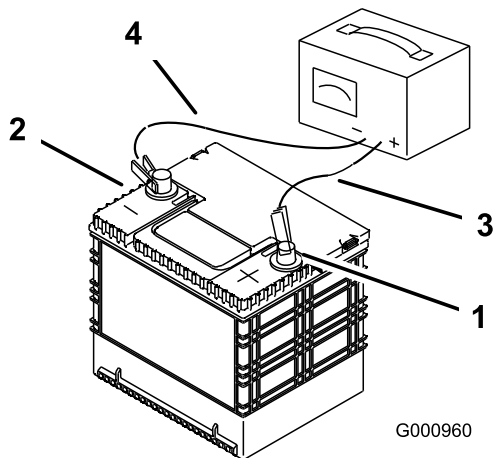
Charging the battery produces gasses that can explode.

Never smoke near the battery and keep sparks and flames away from battery.

**Important:** Always keep the battery fully charged (1.265 specific gravity). This is especially important to prevent battery damage when the temperature is below 32°F (0°C).

- Charge battery for 10 to 15 minutes at 25 to 30 amps or 30 minutes at 10 A.
- When the battery is fully charged, unplug the charger from the electrical outlet, then disconnect the charger leads from the battery posts ([Figure 55](#)).
- Install the battery in the machine and connect the battery cables, refer to [Installing the Battery](#) (page 46).

**Note:** Do not run the machine with the battery disconnected, electrical damage may occur.



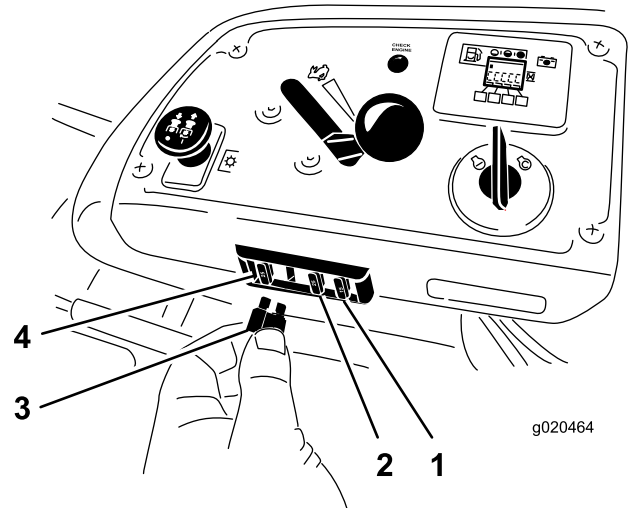
**Figure 55**

- Positive Battery Post
- Negative Battery Post
- Red (+) Charger Lead
- Black (-) Charger Lead

## Servicing the Fuses

The electrical system is protected by fuses. It requires no maintenance, however, if a fuse blows check the component/circuit for a malfunction or short.

- The fuses are located on right console next to the seat ([Figure 56](#)).
- To replace the fuses, pull out on the fuse to remove it.
- Install a new fuse ([Figure 56](#)).



**Figure 56**

- Optional accessory—15 A
- Charge—25 A
- PTO-10 A
- Main-25 A

## Jump-Starting the Machine

- Check and clean corrosion from the battery terminals before jump-starting. Ensure that the connections are tight.

### **⚠ CAUTION**

Corrosion or loose connections can cause unwanted electrical voltage spikes at any time during the jump-starting procedure.

Do not attempt to jump-start with loose or corroded battery terminals, or damage to the engine or EFI may occur.

## ⚠ DANGER

Jump-starting a weak battery that is cracked or frozen, or has a low electrolyte level or an open/shorted battery cell can cause an explosion resulting in serious personal injury.

Do not jump-start a weak battery if these conditions exist.

2. Ensure that the booster battery is a good and fully charged lead-acid battery at 12.6 V or greater.

**Note:** Use properly sized jumper cables with short lengths to reduce voltage drop between systems. Ensure that the cables are color coded or labeled for the correct polarity.

## ⚠ CAUTION

Connecting the jumper cables incorrectly (wrong polarity) can immediately damage the EFI system.

Be certain of battery terminal polarity and jumper cable polarity when hooking up batteries.

## ⚠ WARNING

Batteries contain acid and produce explosive gases.

- Shield the eyes and face from the batteries at all times.
- Do not lean over the batteries.

**Note:** Ensure that the vent caps are tight and level. Place a damp cloth, if available, over any vent caps on both batteries. Also ensure that the vehicles do not touch and that both electrical systems are off and at the same rated system voltage. These instructions are for negative ground systems only.

3. Connect the positive (+) cable to the positive (+) terminal of the discharged battery that is wired to the starter or solenoid as shown in [Figure 57](#).

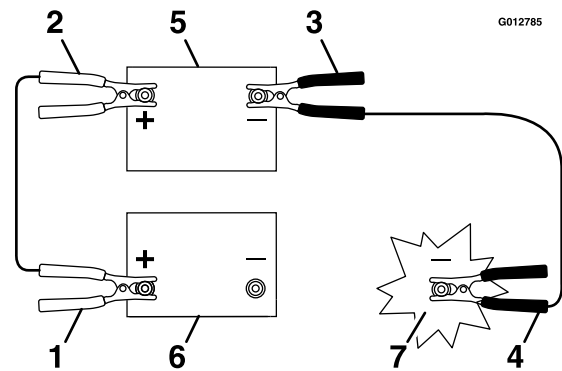


Figure 57

1. Positive (+) cable on discharged battery
2. Positive (+) cable on booster battery
3. Negative (-) cable on the booster battery
4. Negative (-) cable on the engine block
5. Booster battery
6. Discharged battery
7. Engine block

4. Connect the other end of the positive cable to the positive terminal of the booster battery.
5. Connect the black negative (-) cable to the other terminal (negative) of the booster battery.
6. **Make the final connection on the engine block of the stalled vehicle (not to the negative battery post) away from the battery and stand back ([Figure 59](#)).**

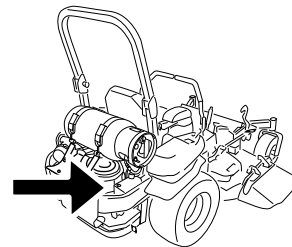


Figure 58

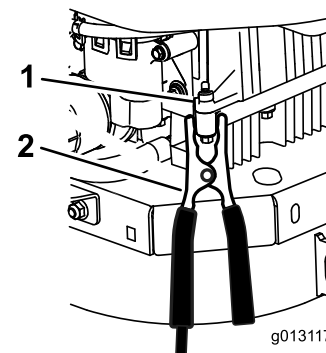


Figure 59

1. Engine block
2. Negative (-) cable



7. Start the vehicle and remove the cables in the reverse order of connection (the engine block (black) connection is the first to disconnect).

## ***Drive System Maintenance***

### **Checking the Seat Belt**

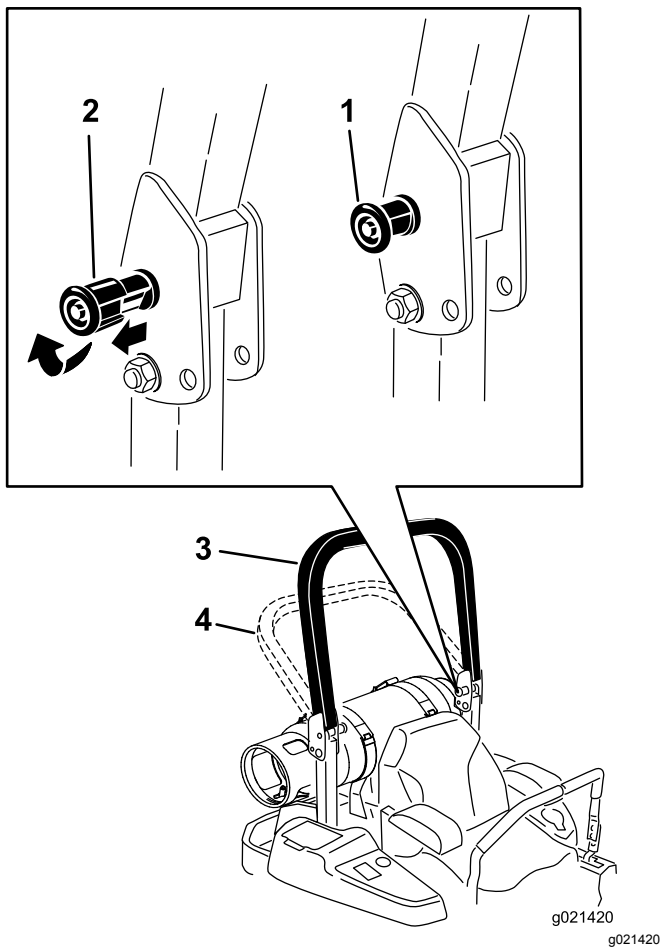
**Service Interval:** Before each use or daily

Visually inspect seat belt for wear, cuts, and proper operation of retractor and buckle. Replace before operating if damaged.

### **Checking the Knobs on the Rollover Protection System (ROPS)**

**Service Interval:** Before each use or daily

Check that both the mounting hardware and the knobs are in good working condition. Ensure that the knobs are fully engaged with the ROPS in the fully raised position. The upper hoop of the roll bar may need to be pushed forward or pulled rearward to get both knobs fully engaged.



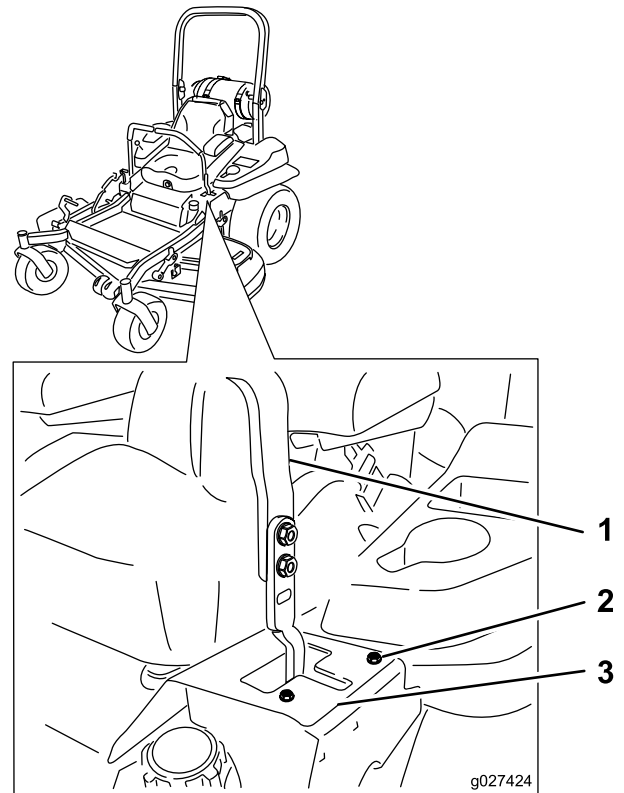
**Figure 60**

1. ROPS knob (locked position)
2. Pull ROPS knob out and rotate 90 degrees to change roll bar position
3. Roll bar in the upright position
4. Roll bar in the folded position

## Adjusting the Tracking

1. Disengage the blade-control switch (PTO).
2. Drive to an open flat area, move the motion-control levers to the NEUTRAL-LOCK position.
3. Move the throttle midway between FAST and SLOW.
4. Move both motion-control levers all the way forward until they both hit the stops in the T-slot.
5. Check which way the machine tracks.
6. If it tracks to the right, loosen the bolts and adjust the left stop plate rearward on the left T-slot until the machine tracks straight (Figure 61).
7. If it tracks to the left, loosen the bolts and adjust the right stop plate rearward on the right T-slot until the machine tracks straight (Figure 61).

8. Tighten the stop plate (Figure 61).



**Figure 61**  
Left control lever shown

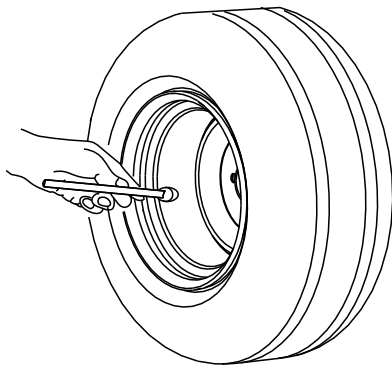
1. Control lever
2. Bolt
3. Stop plate

## Checking the Tire Pressure

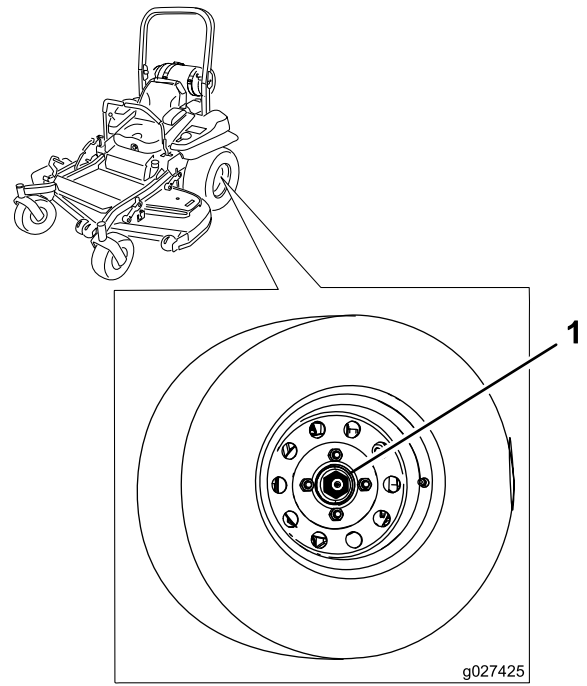
**Service Interval:** Every 50 hours/Monthly (whichever comes first)

Maintain the air pressure in the rear tires at 13 psi (90 kPa). Uneven tire pressure can cause uneven cut. Check the tires when they are cold to get the most accurate pressure reading.

**Note:** The front tires are semi-pneumatic tires and do not require air-pressure maintenance.



**Figure 62**



**Figure 63**

1. Slotted nut

---

## Checking the Wheel Lug Nuts

Check and torque the wheel lug nuts to 122-129 N·m (90-95 ft·lb).

## Checking the Wheel Hub Slotted Nut

**Service Interval:** After the first 100 hours

Every 500 hours

Check and ensure that the torque of the slotted nut is 286 to 352 N·m (211 to 260 ft·lb).

**Note:** Do not use anti-seize compound on the wheel hub.

---

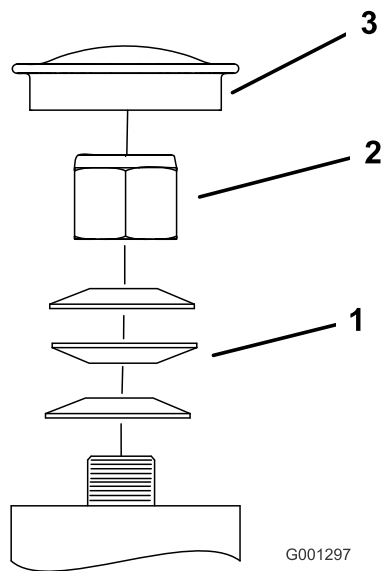
## Adjusting the Caster Pivot Bearing

**Service Interval:** Every 500 hours/Yearly (whichever comes first)

1. Disengage the blade-control switch (PTO), move the motion-control levers to the NEUTRAL-LOCK position, and set the parking brake.
2. Shut off the engine, remove the key, and wait for all moving parts to stop before leaving the operating position.
3. Remove the dust cap from caster and tighten the locknut (Figure 64).
4. Tighten the locknut until the spring washers are flat and then back off a 1/4 turn to properly set the pre-load on the bearings (Figure 64).

**Important:** Ensure the spring washers are installed correctly as shown in Figure 64.

5. Install the dust cap (Figure 64).

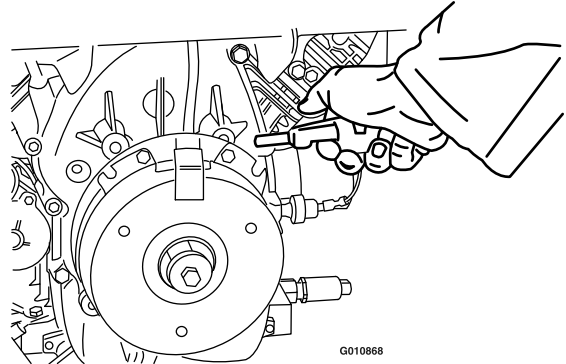


**Figure 64**

- |                   |             |
|-------------------|-------------|
| 1. Spring washers | 3. Dust cap |
| 2. Locknut        |             |

## Removing the Clutch Shim

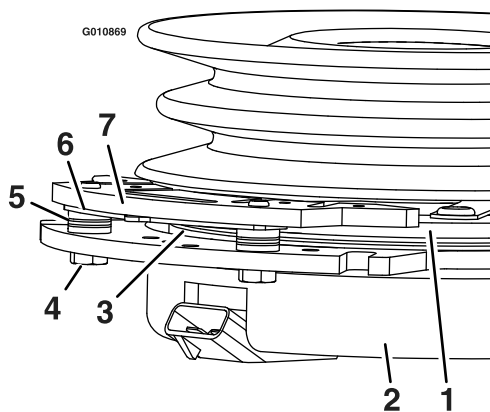
1. Shut off the engine, wait for all moving parts to stop, and remove the key.
2. Engage the parking brake and allow the machine to cool down completely.
3. Using an air compressor, blow out any debris from under the brake pole and around the brake spacers.



**Figure 66**

## Using the Clutch Shim

Some later model year units have clutches that contain a brake shim. When the clutch brake has worn to the point where the clutch no longer engages consistently, you can remove the shim to extend the clutch life.

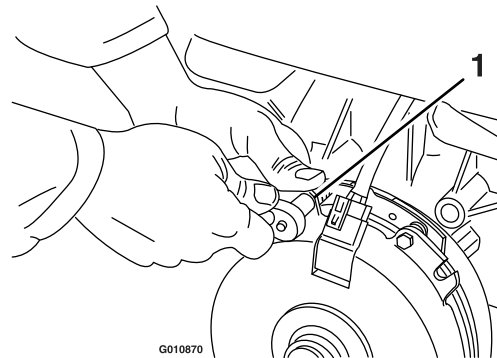


**Figure 65**

- |                        |                 |
|------------------------|-----------------|
| 1. Armature            | 5. Brake spacer |
| 2. Field shell         | 6. Re-gap shim  |
| 3. Rotor               | 7. Brake pole   |
| 4. Brake mounting bolt |                 |

4. Check the condition of the wire-harness leads, connectors, and terminals. Clean or repair as necessary.
5. Verify that 12 V is present at the clutch connector when you engage the PTO switch.
6. Measure the gap between the rotor and armature. If the gap is greater than 1 mm (.04 inch), proceed with the following steps:
  - A. Loosen both brake mounting bolts a half to a full turn as shown below.

**Note:** Do not remove the brake pole from the field shell/armature. The brake pole has worn to match the armature and needs to continue to match after you remove the shim to ensure proper brake torque.

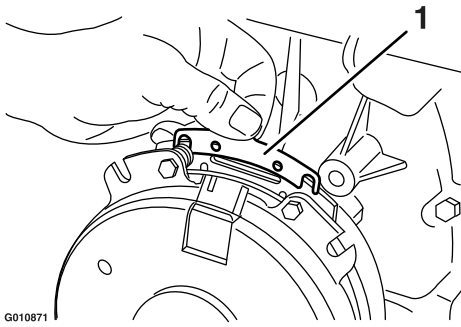


**Figure 67**

1. Brake-mounting bolt

- B. Take hold of the tab and remove the shim.

**Note:** Do not discard the shim until the clutch is functioning properly.



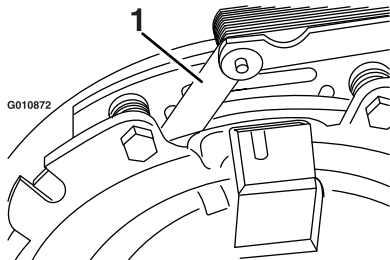
**Figure 68**

g010871

1. Shim

- 
- C. Using a pneumatic line, blow out any debris from under the brake pole and around the brake spacers.
  - D. Torque each bolt (M6 x 1) to 13 N·m (10 ft-lb) +/- 0.7 N·m (0.5 ft-lb).
  - E. Using a 0.010 inch thick feeler gauge, verify that a gap is present between the rotor and armature face on both sides of the brake pole as shown.

**Note:** Due to the way the rotor and armature faces wear (peaks and valleys) it is sometimes difficult to measure the true gap.



**Figure 69**

g010872

1. Feeler gauge

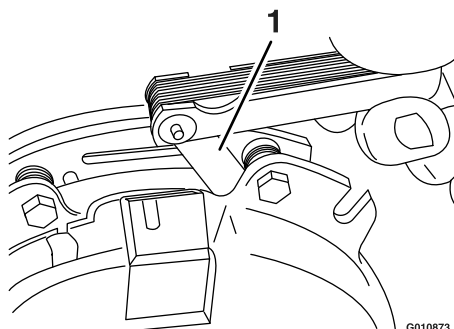
- If the gap is less than 0.010 inch, then install the shim and refer to [Troubleshooting \(page 70\)](#).
- If the gap is sufficient, proceed to the safety check in step F.

F. Perform the following safety check:

- i. Sit on the seat and start the engine.
- ii. Ensure the blades **do not** engage with the PTO switch in the off position and the clutch disengaged.

If the clutch does not disengage, install the shim and refer to [Troubleshooting \(page 70\)](#).

- iii. Engage and disengage the PTO switch 10 consecutive times to ensure that the clutch is functioning properly. If the clutch does not engage properly, refer [Troubleshooting \(page 70\)](#).



**Figure 70**

g010873

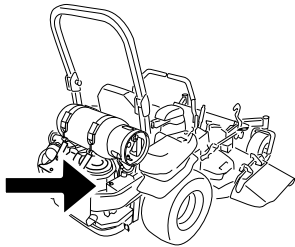
1. Feeler gauge

# Cooling System Maintenance

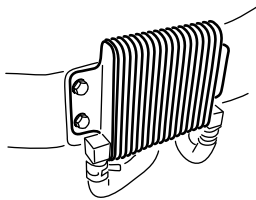
## Cleaning the Engine Screen and Engine Oil Cooler

**Service Interval:** Before each use or daily

Remove any build-up of grass, dirt, or other debris from the oil cooler (Figure 71).



G021395  
g021395



G009191  
g009191

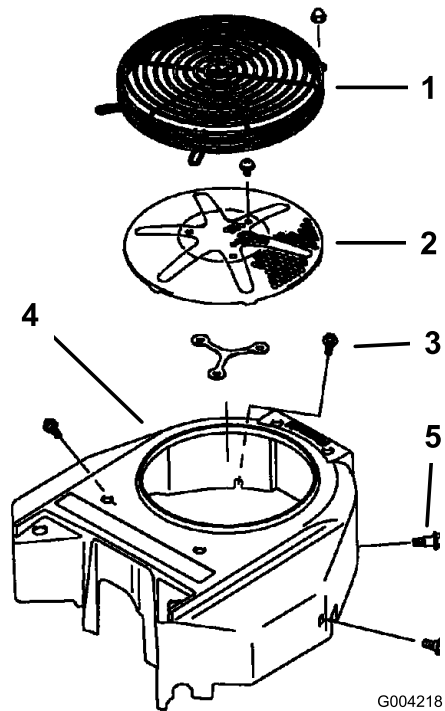
**Figure 71**

Before each use, remove any build-up of grass, dirt, or other debris from the engine screen. This helps to ensure adequate cooling, correct engine speed, and reduces the possibility of overheating and mechanical damage to the engine.

## Cleaning the Engine Cooling Fins and Shrouds

**Service Interval:** Every 100 hours/Yearly (whichever comes first)

1. Disengage the PTO and set the parking brake.
2. Shut off the engine, remove the key, and wait for all moving parts to stop before leaving the operating position.
3. Remove the cooling shrouds and fan housing.
4. Clean the debris and grass from the engine parts.
5. Install the cooling shrouds and fan housing (Figure 74).



G004218

g004218

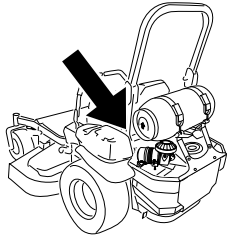
**Figure 72**

1. Engine guard
2. Engine-air-intake screen
3. Bolt
4. Fan housing
5. Screw

# Check and Clean the Hydraulic Unit Shrouds

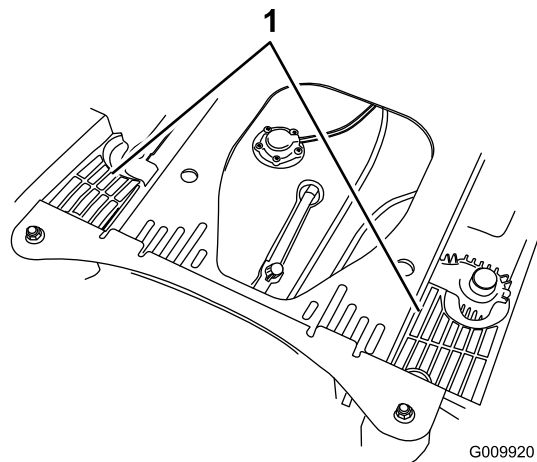
**Service Interval:** Before each use or daily

1. Disengage the PTO and set the parking brake.
2. Shut off the engine, remove the key, and wait for all moving parts to stop before leaving the operating position.
3. Raise the seat.
4. Clean the debris and grass from the hydraulic-unit shrouds ([Figure 73](#)).
5. Lower the seat.



G021397

g021397



G009920

g009920

**Figure 73**

1. Hydraulic-unit shrouds

# Brake Maintenance

## Adjusting the Parking Brake

**Service Interval:** After the first 100 hours

Every 500 hours thereafter

Ensure that the brake calipers are adjusted properly before adjusting the parking brake.

**Note:** Perform this procedure also when a brake component has been removed or replaced.

### **⚠ DANGER**

**Mechanical or hydraulic jacks may fail to support machine and cause a serious injury.**

- Use jack stand when supporting machine.
- Do not use hydraulic jacks.

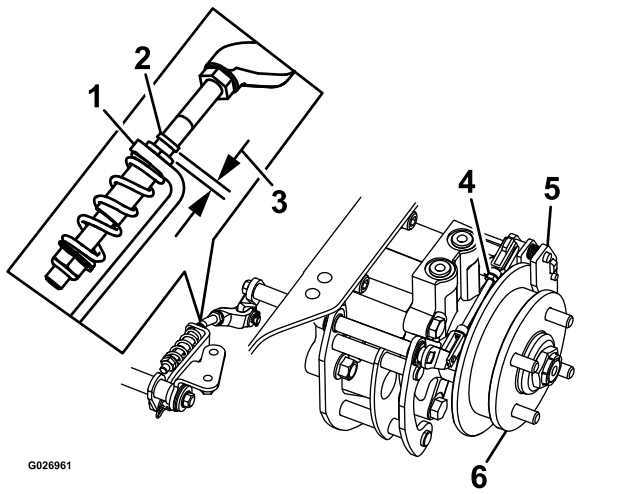
1. Drive the machine onto a level surface.
2. Disengage the blade-control switch (PTO), move the motion-control levers to the NEUTRAL-LOCK position and engage the parking brake.
3. Shut off the engine, wait for all moving parts to stop, and remove the key.
4. Raise the back of the machine up and support the machine with jack stands.
5. Remove the rear tires from the machine.
6. Remove any debris from the brake area.
7. Rotate the wheel-release handle to the released position. Refer to [Using the Drive-Wheel-Release Valves \(page 30\)](#).
8. Check to see if there is a visible gap between the L-bracket and the linkage stop ([Figure 74](#)).

# Belt Maintenance

## Inspecting the Belts

**Service Interval:** Every 50 hours

Check the belts for squealing when the belt is rotating, blades slipping when cutting grass, frayed belt edges, burn marks and cracks are signs of a worn mower belt. Replace the mower belt if any of these conditions are evident.



**Figure 74**  
Left Side Shown

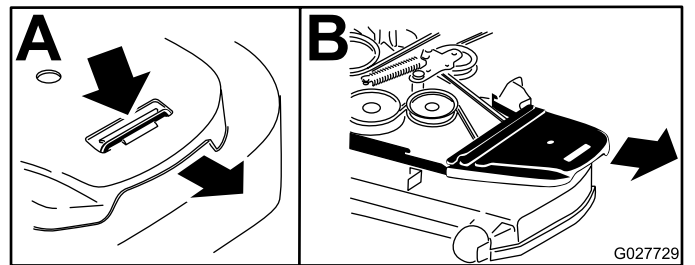
- |                 |                          |
|-----------------|--------------------------|
| 1. L-bracket    | 4. Rear-linkage assembly |
| 2. Linkage stop | 5. Caliper               |
| 3. Gap          | 6. Wheel hub             |

9. Disengage the parking brake, the lever should be in the down position.
10. Turn the wheel hub by hand in both directions relative to the caliper; the wheel hub should move freely between the caliper.
11. If a gap is needed or the wheel hub does not move freely:
  - A. Disengage the parking brake.
  - B. Disconnect and fine-tune the rear linkage assembly:
    - Shorten the link to create a gap.
    - Lengthen the link to allow wheel hub movement.
  - C. Connect the rear linkage assembly.
12. Engage the parking brake and check the gap.
13. Repeat steps 9 through 13 until a visible gap is achieved and the wheel hub rotates freely.
14. Repeat this procedure for the brake on the opposite side.
15. Rotate the drive wheel release handle to the operating position. Refer to [Using the Drive-Wheel-Release Valves \(page 30\)](#).
16. Install the rear tires and torque the lug nuts. Refer to [Checking the Wheel Lug Nuts \(page 51\)](#).
17. Remove the jack stands.

## Replacing the Mower Belt

Squealing when the belt is rotating, blades slipping when cutting grass, frayed belt edges, burn marks and cracks are signs of a worn mower belt. Replace the mower belt if any of these conditions are evident.

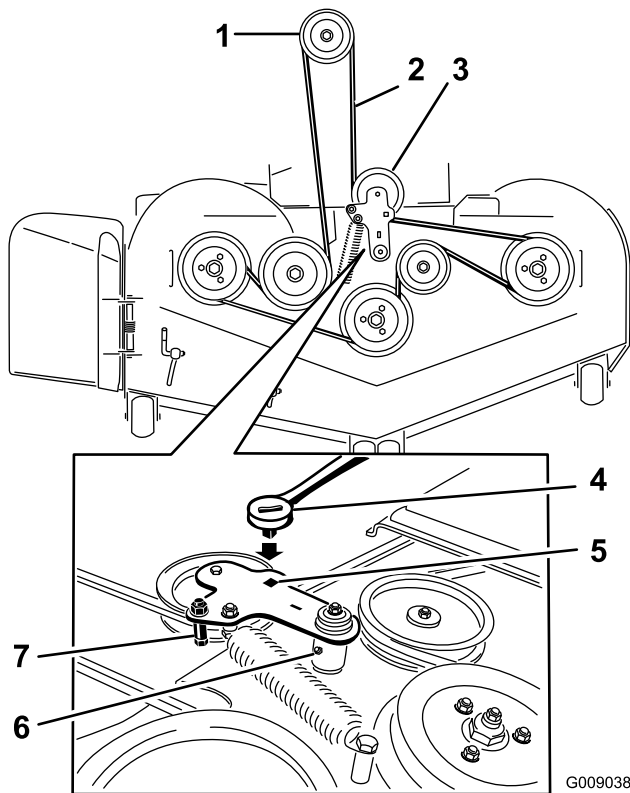
1. Disengage the PTO, move the motion-control levers to the NEUTRAL-LOCK position, and set the parking brake.
2. Shut off the engine, remove the key, and wait for all moving parts to stop before leaving the operating position.
3. Lower the mower to the 76 mm (3 inch) height-of-cut.
4. Remove the belt covers ([Figure 75](#)).



**Figure 75**

5. Use a ratchet in the square hole in the idler arm to remove tension on the idler spring ([Figure 76](#)).
6. Remove the belt from the mower-deck pulleys.
7. Remove the belt guide on the spring-loaded idler arm shown in [Figure 76](#).
8. Remove the existing belt.
9. Install the new belt around the mower pulleys and the clutch pulley under the engine ([Figure 76](#)).

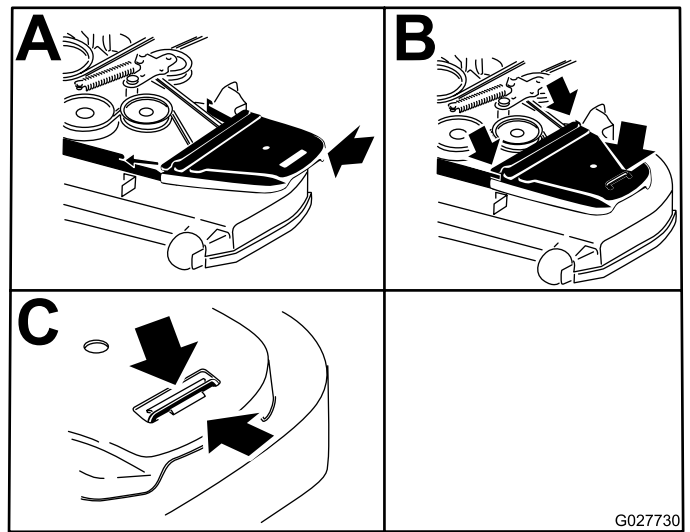




**Figure 76**

- |                               |   |
|-------------------------------|---|
| 1. Clutch pulley              | 5. Square hole in the idler arm for the ratchet |
| 2. Mower belt                 | 6. Idler grease zerk                            |
| 3. Spring-loaded idler pulley | 7. Belt guide                                   |
| 4. Ratchet                    |   |

10. Install the belt guide on the idler arm shown in [Figure 76](#).
11. Using the ratchet in the square hole, install the idler spring ([Figure 76](#)).  
Ensure that the spring ends are seated in the anchor grooves.
12. Install the belt covers ([Figure 77](#)).



**Figure 77**

1. Position the belt cover
2. Slide belt cover under the side catches
3. Ensure the tab is under the metal catch

## Replacing the Hydraulic Pump Drive Belt

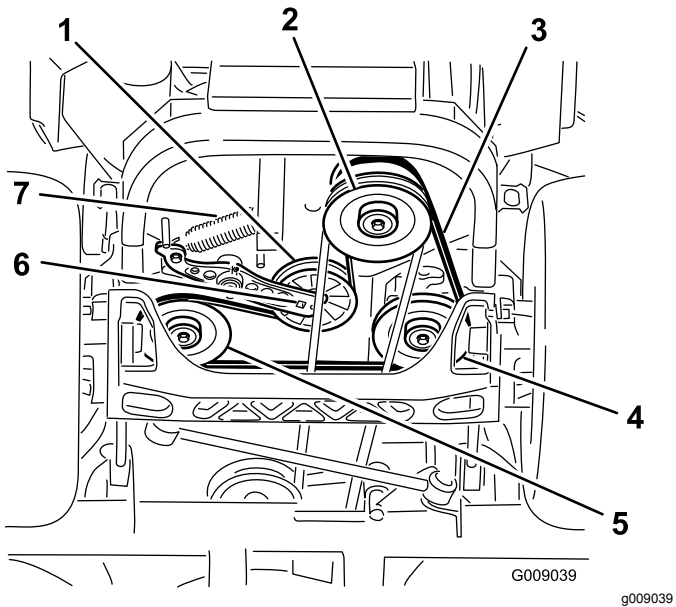
1. Disengage the PTO and set the parking brake.
2. Shut off the engine, remove the key, and wait for all moving parts to stop before leaving the operating position.
3. Remove the mower belt. Refer to [Replacing the Mower Belt \(page 56\)](#).
4. Raise the machine and support it with jack stands.
5. Use a ratchet in the square hole in the idler arm to remove the idler spring ([Figure 78](#)).
6. Unhook the idler spring from the frame ([Figure 78](#)).
7. Remove the belt from the hydraulic-unit-drive pulleys and the engine pulley.
8. Install the new belt around engine pulley and the 2 drive pulleys.
9. Using a ratchet in the square hole in the idler arm, install the idler spring to the frame ([Figure 78](#)).
10. Install the mower belt. Refer to [Replacing the Mower Belt \(page 56\)](#).

# Controls System Maintenance

## Adjusting the Control Handle Position

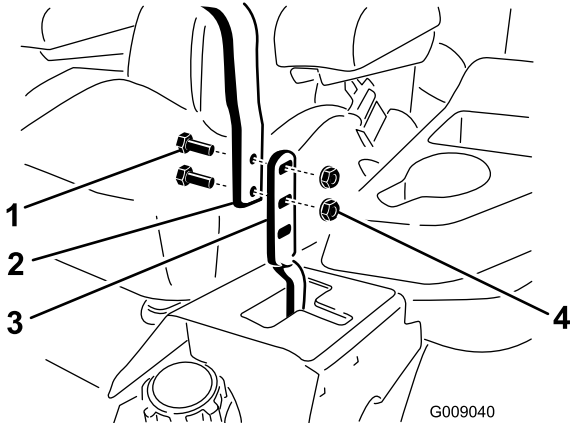
There are two height positions for the control levers; high and low. Remove the bolts to adjust the height for the operator.

1. Disengage the PTO, move the motion-control levers to the NEUTRAL-LOCK position, and set the parking brake.
2. Shut off the engine, remove the key, and wait for all moving parts to stop before leaving the operating position.
3. Loosen the bolts and flange nuts installed in the levers (Figure 79).
4. Align the levers front to rear position by bring the levers together to the NEUTRAL position and slide them until they are aligned, then tighten the bolts (Figure 80).



**Figure 78**

- |                                |                               |
|--------------------------------|-------------------------------|
| 1. Idler pulley                | 5. Left hydraulic-pump pulley |
| 2. Clutch pulley               | 6. Square hole in idler arm   |
| 3. Pump-drive belt             | 7. Idler spring               |
| 4. Right hydraulic-pump pulley |                               |



**Figure 79**

- |           |                  |
|-----------|------------------|
| 1. Bolt   | 3. Control lever |
| 2. Handle | 4. Nut           |

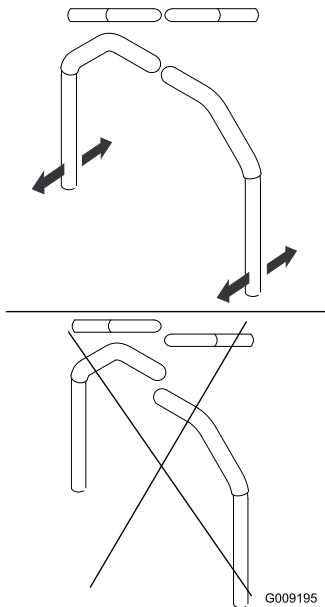


Figure 80

## Adjusting the Motion-Control Linkage

Located on either side of the fuel tank, below the seat are the pump-control linkages. Rotating the pump linkage with a 1/2-inch wrench allows fine-tuning adjustments so that the machine does not move in neutral. Any adjustments should be made for NEUTRAL positioning only.

### **⚠ WARNING**

The engine must be running and the drive wheels must be turning so that the motion control adjustment can be performed. Contact with moving parts or hot surfaces may cause personal injury.

Keep your fingers, hands, and clothing clear of rotating components and hot surfaces.

1. Prior to starting the engine, push the deck-lift pedal and remove the height-of-cut pin. Lower the deck to the ground.
2. Raise the rear of machine up and support it with jack stands (or equivalent support) just high enough to allow the drive wheels to turn freely.
3. Remove the electrical connection from the seat safety switch, located under the bottom cushion of the seat.

**Note:** The switch is a part of the seat assembly.

4. **Temporarily** install a jumper wire across the terminals in the connector of the main harness.

5. Start the engine.

**Note:** The brake must be engaged and the motion-control levers must be out to start the engine. You do not need to be in the seat because of the jumper wire being used. Run the engine at FULL throttle and release the brake.

6. Run the machine at least 5 minutes with the motion-control levers at full FORWARD speed to bring the hydraulic fluid up to operating temperature.

**Note:** The motion-control lever needs to be in NEUTRAL while making any necessary adjustments.

7. Bring the motion-control levers into the NEUTRAL position.
8. Adjust the pump-control rod lengths by rotating the double nuts on the rod in the appropriate direction until the wheels slightly creep in reverse (Figure 81).

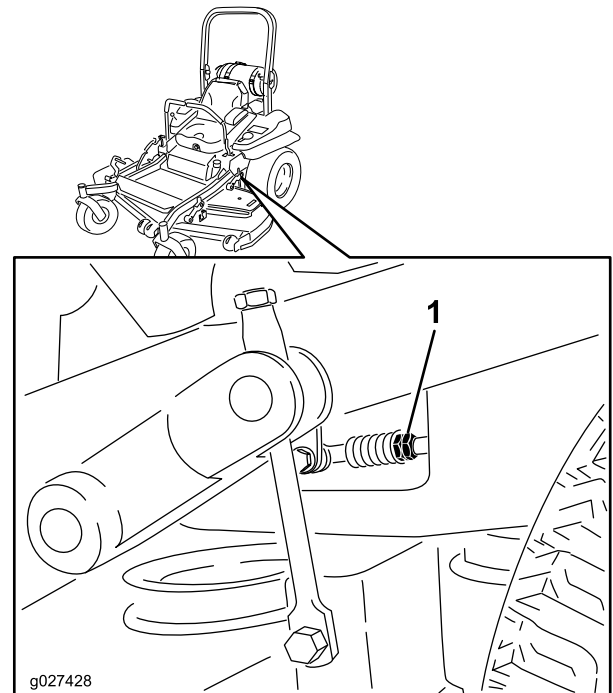


Figure 81

1. Double nuts

9. Move the motion-control levers to the REVERSE position, and while applying slight pressure to the lever, allow the reverse-indicator springs to bring the levers back to NEUTRAL.

**Note:** The wheels must stop turning or slightly creep in reverse.

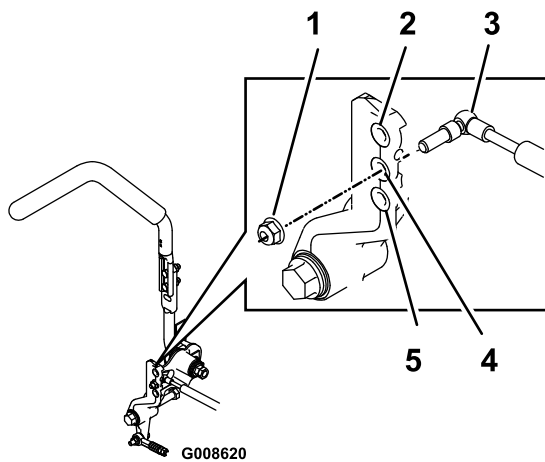
10. Shut off the machine. Remove the jumper wire from wire harness and plug the connector into the seat switch.

11. Remove the jack stands.
12. Raise the deck and install the height-of-cut pin.
13. Check that the machine does not creep in NEUTRAL with the park brakes disengaged.

## Adjusting the Motion-Control Damper

The top damper-mounting bolt can be adjusted to obtain a more desired motion-control lever resistance. See [Figure 82](#) for mounting options.

1. Insert the damper end into the desired position.
2. Torque the locknut to 23 N·m (17 ft-lb). The bolt must protrude past the end of the locknut after torquing.



**Figure 82**

Right motion control shown

- |                    |                      |
|--------------------|----------------------|
| 1. Locknut         | 4. Medium resistance |
| 2. Most resistance | 5. Least resistance  |
| 3. Damper          |                      |

## Adjusting the Motion-Control Neutral-Lock Pivot

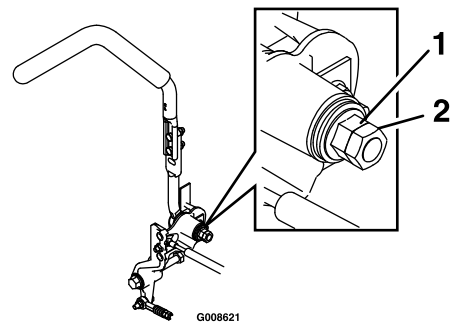
You can adjust the flanged nut to obtain a more desired motion-control lever resistance when moving it to the NEUTRAL-LOCK position. See [Figure 83](#) for adjustment options.

1. Loosen the jam nut.
2. Tighten or loosen the flanged nut to the desired feel.

For more resistance, tighten the flanged nut.

For less resistance, loosen the flanged nut

3. Tighten the jam nut.



**Figure 83**

- |                |            |
|----------------|------------|
| 1. Flanged nut | 2. Jam nut |
|----------------|------------|

# Hydraulic System Maintenance

## Servicing the Hydraulic System

**Hydraulic Fluid Type:** Toro® HYPR-OIL™ 500 hydraulic fluid or Mobil® 1 15W-50.

**Important:** Use the fluid specified. Other fluids could cause system damage.

**Each Hydraulic System Fluid Capacity:** 52 L (52 fl oz) per side with filter change

## Checking the Hydraulic Fluid

**Service Interval:** Every 50 hours—Check the hydraulic-fluid level.

1. Position the machine on a level surface.
2. Disengage the PTO, move the motion-control levers to the NEUTRAL-LOCK position, and set the parking brake.
3. Shut off the engine, remove the key, and wait for all moving parts to stop before leaving the operating position.
4. Allow the engine and hydraulic system to cool for 10 minutes.

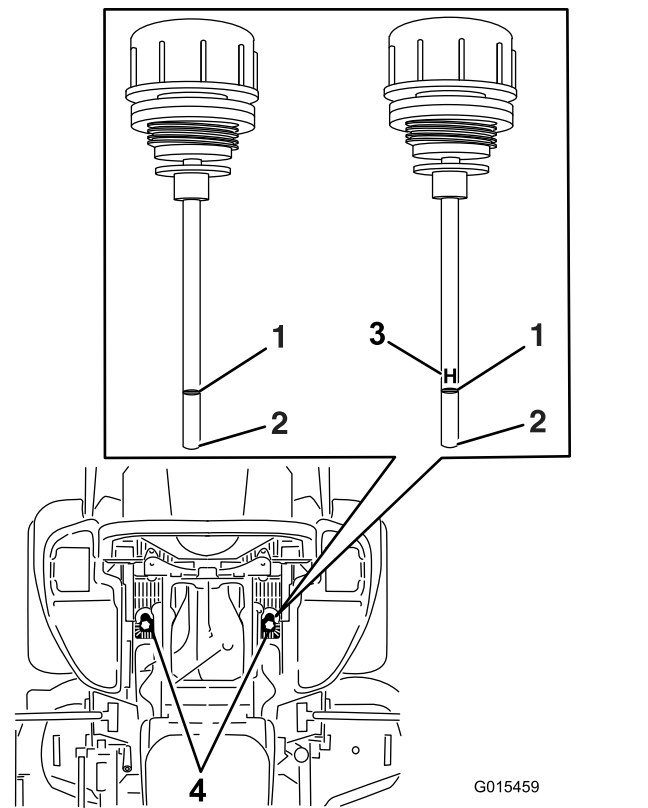
**Note:** The fluid level on the dipstick will be incorrect if the fluid is checked when the machine is hot.

5. Move the seat forward.
6. Clean the area around the dipsticks of the hydraulic-system reservoirs (Figure 84).
7. Remove 1 dipstick from the hydraulic reservoir (Figure 84).
8. Wipe the dipstick off and thread the dipstick into the reservoir.
9. Remove the dipstick and look at the end (Figure 84).

**Note:** If the fluid level is at the add mark, slowly pour only enough fluid into the hydraulic reservoir to raise the level to the full or H line.

**Important:** Do not overfill the hydraulic units with fluid as damage may occur. Do not run the machine with the fluid below the add mark.

10. Install the dipstick.
11. Repeat procedure for the opposite dipstick.



**Figure 84**

Either dipstick will be used in the machine

- |         |                                  |
|---------|----------------------------------|
| 1. Full | 3. H—means high level            |
| 2. Add  | 4. Dipstick locations under seat |

### **⚠ WARNING**

**Hydraulic fluid escaping under pressure can penetrate skin and cause injury.**

- If hydraulic fluid is injected into the skin it must be surgically removed within a few hours by a doctor familiar with this type of injury. Gangrene may result if this is not done.
- Keep body and hands away from pin-hole leaks or nozzles that eject high-pressure-hydraulic fluid.
- Use cardboard or paper to find hydraulic leaks.
- Safely relieve all pressure in the hydraulic system before performing any work on the hydraulic system.
- Ensure that all hydraulic-fluid hoses and lines are in good condition and that all hydraulic connections and fittings are tight before applying pressure to the hydraulic system.

# Replacing the Hydraulic Filters and Hydraulic Fluid

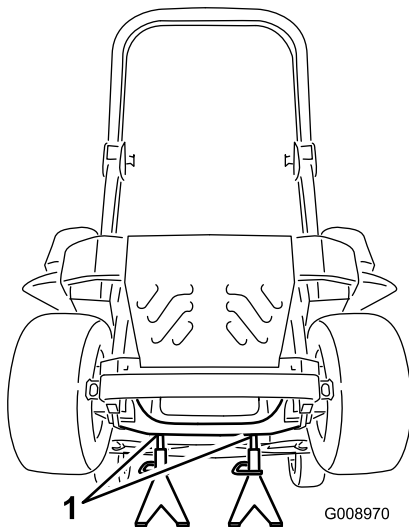
**Service Interval:** After the first 250 hours—Change the hydraulic filters and hydraulic fluid when using any type of fluid.

Every 250 hours—Change the hydraulic filters and hydraulic fluid when using Mobil® 1 fluid (more often in dirty or dusty conditions).

Every 500 hours—Change the hydraulic filters and hydraulic fluid when using Toro® HYPR-OIL™ 500 hydraulic fluid (more often in dirty or dusty conditions).

To replace the hydraulic fluid, you must remove the filters. Replace both filters at the same time; refer to [Servicing the Hydraulic System \(page 61\)](#) for the fluid specifications.

1. Disengage the blade-control switch (PTO), move the motion-control levers to the NEUTRAL-LOCK position, and set the parking brake.
2. Shut off the engine, remove the key, and wait for all moving parts to stop before leaving the operating position.
3. Raise the machine and support it with jack stands ([Figure 85](#)).



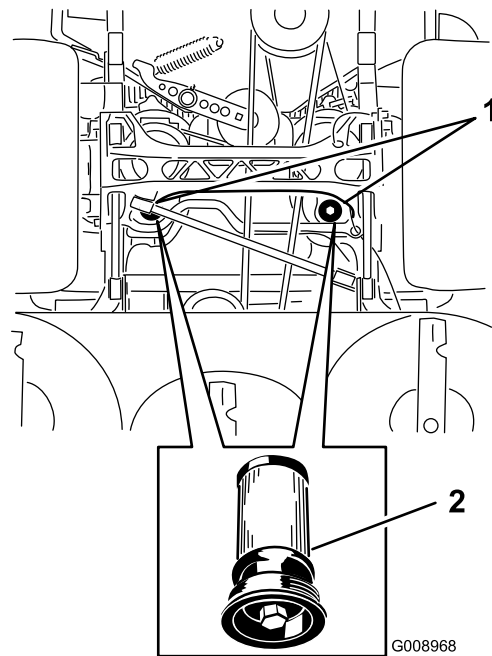
**Figure 85**

1. Jack stands

4. Remove both the mower belt and the pump-drive belt; refer to [Replacing the Mower Belt \(page 56\)](#) and [Replacing the Hydraulic Pump Drive Belt \(page 57\)](#).

**Note:** This prevents fluid from getting on the belts.

5. Place a drain pan under the filter, remove the old filter, and wipe the surface clean ([Figure 86](#)).



**Figure 86**

Bottom view of the machine

1. Filter locations
2. Hydraulic filter

6. Apply a thin coat of hydraulic fluid to the rubber gasket on the replacement filter ([Figure 86](#)).
7. Install the replacement hydraulic filter.
8. Install the pump-drive belt and the mower belt.
9. Remove the jack stands and lower the machine ([Figure 85](#)).
10. Add fluid to the hydraulic reservoir and check for any leaks.
11. Clean up any spilled fluid.
12. Start the engine and let it run for about 2 minutes to purge air from the system.
13. Shut off the engine and check for leaks.
14. Check the fluid level while the fluid is cold.
15. If required, add fluid to the hydraulic reservoir.

**Note:** Do not overfill.

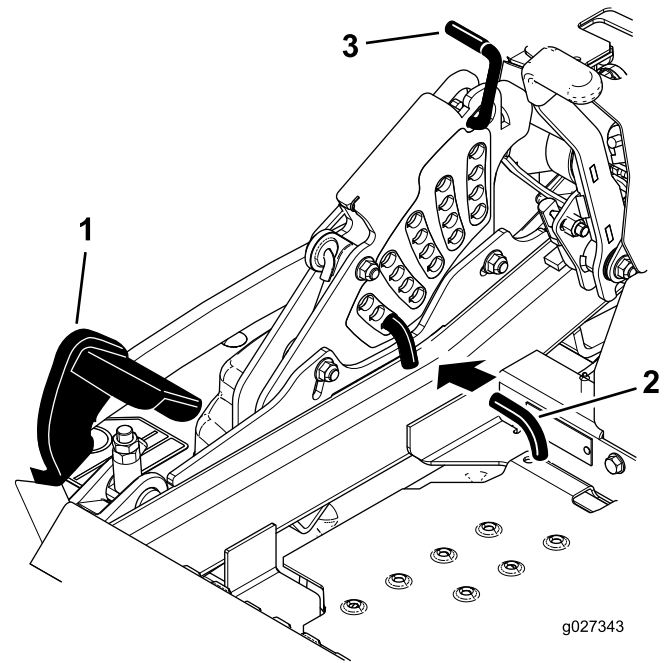
# Mower Deck Maintenance

## Leveling the Mower Deck

### Setting Up the Machine

**Note:** Ensure that the mower deck is leveled before matching the height-of-cut (HOC).

1. Position mower on a flat surface.
2. Disengage the blade-control switch (PTO), move the motion-control levers to the NEUTRAL-LOCK position and set the parking brake.
3. Shut off the engine, remove the key, and wait for all moving parts to stop before leaving the operating position.
4. Check tire pressure of the drive tires. If needed, adjust to 90 kPa (13 psi)
5. Position the mower to the 76 mm (3 inch) height-of-cut position.



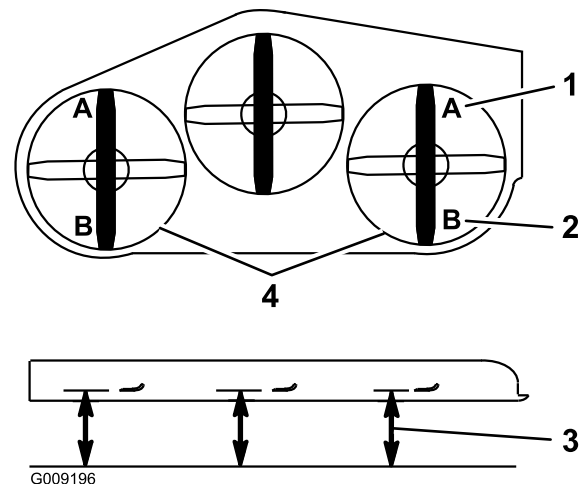
**Figure 87**

1. Deck lift pedal
2. Height-of-cut pin
3. Transport lock

### Leveling the Deck

1. Position the mower on a flat surface.
2. Shut off engine, wait for all moving parts to stop, and remove key. Engage parking brake.
3. Check the tire pressure in the drive tires. Proper inflation pressure for tires is 90 kPa (13 psi). Adjust the tire pressure if necessary.
4. Position the transport lock in the latching position.
5. Push the deck-lift pedal all the way forward and the deck will latch at the 140 mm (5-1/2 inch) transport position ([Figure 87](#)).

6. Insert the height-adjustment pin into the 76 mm (3 inch) cutting-height location.
7. Release the transport lock and allow the deck to lower to the cutting height.
8. Raise the discharge chute.
9. On both sides of the deck, measure from the level surface to the front tip of the blade (Position A). The measurement should read 76 mm (3 inches) ([Figure 88](#)).

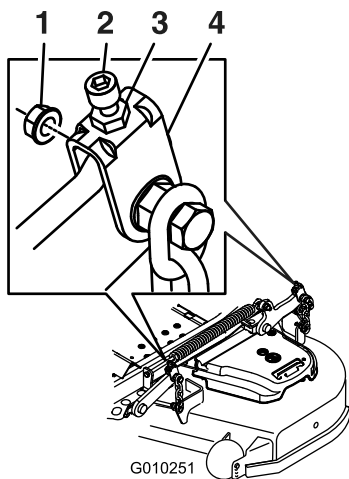


**Figure 88**

1. 76 mm (3 inches) at A is correct
2. 83 mm (3-1/4 inches) at B is correct
3. Measure from the blade tip to the hard surface
4. Measure at A and B on both sides

- If needed, loosen the whizlock nut on the side of the yoke and the jam nut on top. Fine tune the screw adjuster by turning it to get 76 mm (3 inch) height (see [Figure 89](#)).

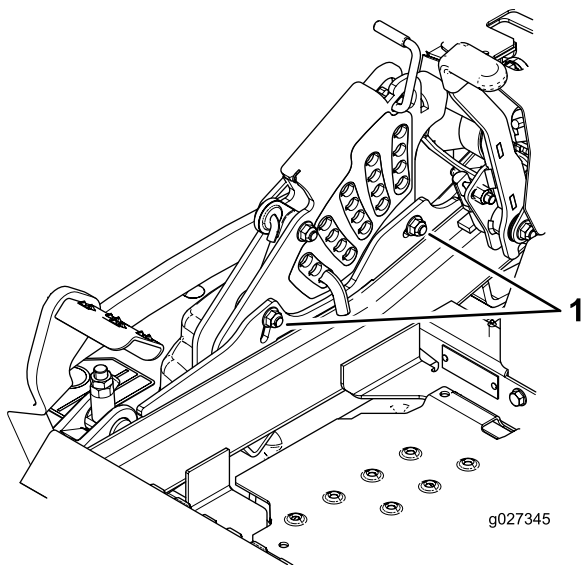
Turn the adjuster screw clockwise to increase the height, or counterclockwise to decrease the height.



**Figure 89**

- |                   |            |
|-------------------|------------|
| 1. Whizlock nut   | 3. Jam nut |
| 2. Adjuster screw | 4. Yoke    |

- If the front-deck links do not have enough adjustment to achieve accurate cut height, the single point adjustment can be utilized to gain more adjustment.
- Loosen the 2 bolts at the bottom of the height of cut plate to adjust the single point system ([Figure 90](#)).

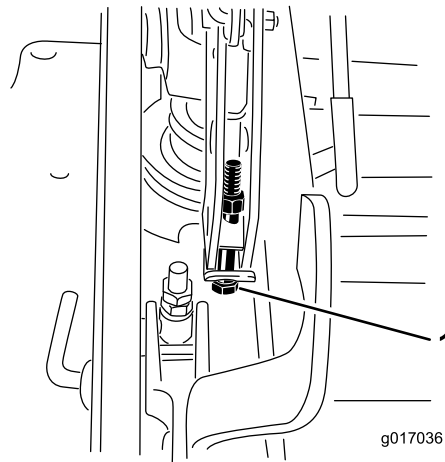


**Figure 90**

- Bolts at the bottom of the height-of-cut plate

- If the deck is too low, tighten the single point adjustment bolt by rotating it clockwise. If the deck is too high, loosen the single point adjustment bolt by rotating it counterclockwise ([Figure 91](#)).

**Note:** Loosen or tighten the single-point-adjustment bolt enough to move the height-of-cut plate mounting bolts at least 1/3 the length of the available travel in their slots. This will regain some up and down adjustment on each of the four deck links.



**Figure 91**

- Single-point-adjustment bolt

- Tighten the two bolts at the bottom of the height of cut plate ([Figure 90](#)).

**Note:** In most conditions, the back blade tip should be adjusted 6.4 mm (1/4 inch) higher than the front.

- Torque the bolts to 37 to 45 N·m (27 to 33 ft·lb).
- On both sides of the deck, measure from the level surface to the back tip of the blade (Position B). The measurement should read 83 mm (3-1/4 inches) ([Figure 88](#)).
- Fine tune the screw adjuster by turning it to get 83 mm (3-1/4 inches) height ([Figure 89](#)).  
To increase the height, turn the adjustment nut clockwise; to decrease, turn counterclockwise.
- Measure until all four sides are the correct height. Tighten all the nuts on the deck-lift-arm assemblies.
- Lower discharge chute.

## Servicing the Cutting Blades

Maintain sharp blades throughout the cutting season because sharp blades cut cleanly without tearing or



shredding the grass blades. Tearing and shredding turns grass brown at the edges, which slows growth and increases the chance of disease.

Check the cutter blades daily for sharpness, and for any wear or damage. File down any nicks and sharpen the blades as necessary. If a blade is damaged or worn, replace it immediately with a genuine Toro replacement blade. For convenient sharpening and replacement, you may want to keep extra blades on hand.

**▲ DANGER**

**A worn or damaged blade can break, and a piece of the blade could be thrown at you or bystanders, resulting in serious personal injury or death.**

- Inspect the blade periodically for wear or damage.
- Replace a worn or damaged blade.

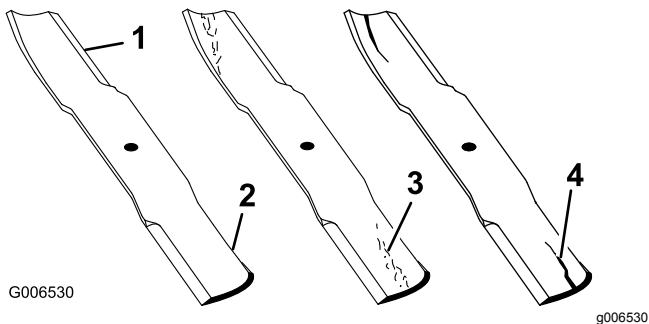
**Before Inspecting or Servicing the Blades**

Park the machine on a level surface, disengage the blade-control switch (PTO), and set the parking brake. Turn the ignition key to OFF. Remove the key.

**Inspecting the Blades**

**Service Interval:** Before each use or daily

1. Inspect the cutting edges (Figure 92). If the edges are not sharp or have nicks, remove and sharpen the blades. Refer to [Sharpening the Blades \(page 66\)](#).
2. Inspect the blades, especially the curved area (Figure 92). If you notice any damage, wear, or a slot forming in this area (Figure 92), immediately install a new blade.

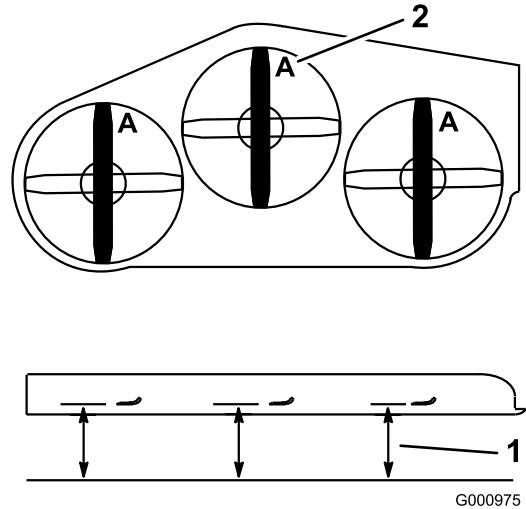


**Figure 92**

- |                 |                      |
|-----------------|----------------------|
| 1. Cutting edge | 3. Wear/slot Forming |
| 2. Curved area  | 4. Crack             |

**Checking for Bent Blades**

1. Disengage the blade-control switch (PTO), move the motion-control levers to the NEUTRAL-LOCK position and set the parking brake.
2. Shut off the engine, remove the key, and wait for all moving parts to stop before leaving the operating position.
3. Rotate the blades until the ends face forward and backward (Figure 93).
4. Measure from a level surface to the cutting edge, position A, of the blades (Figure 93).
5. Note this dimension.



**Figure 93**

1. Measure here from blade to hard surface.
2. Position A

6. Rotate the opposite ends of the blades forward.
7. Measure from a level surface to the cutting edge of the blades at the same position as in step 5 above.
8. The difference between the dimensions obtained in steps 5 and 6 must not exceed 1/8 inch (3 mm).
9. If this dimension exceeds 3 mm (1/8 inch), the blade is bent and must be replaced; refer to [Removing the Blades \(page 66\)](#) and [Installing the Blades \(page 66\)](#).

**▲ WARNING**

**A blade that is bent or damaged could break apart and could seriously injure or kill you or bystanders.**

- Always replace bent or damaged blade with a new blade.
- Never file or create sharp notches in the edges or surfaces of blade.

## Removing the Blades

Blades must be replaced if a solid object is hit, if the blade is out of balance or is bent. To ensure optimum performance and continued safety conformance of the machine, use genuine Toro replacement blades. Replacement blades made by other manufacturers may result in non-conformance with safety standards.

1. Hold the blade end using a rag or thickly-padded glove.
2. Remove the blade bolt, curved washer, and blade from the spindle shaft (Figure 94).

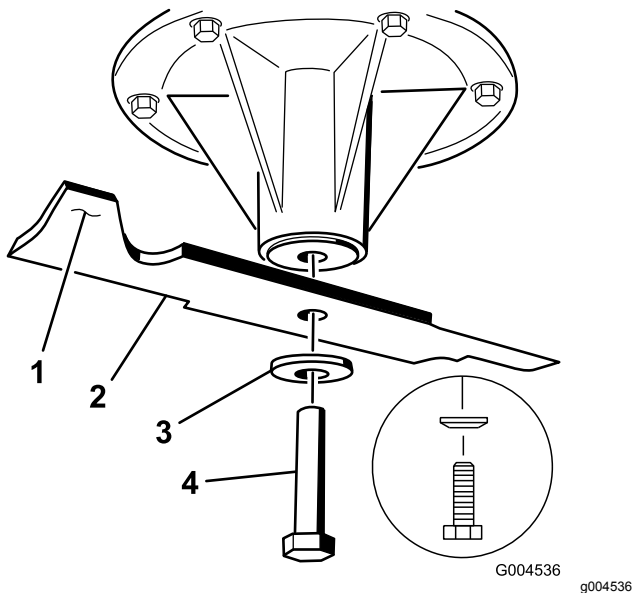


Figure 94

- |                       |                  |
|-----------------------|------------------|
| 1. Sail area of blade | 3. Curved washer |
| 2. Blade              | 4. Blade bolt    |

## Sharpening the Blades

### ▲ WARNING

When sharpening blade, pieces of blade could be thrown and cause serious injury.

Wear proper eye protection when sharpening blade.

1. Use a file to sharpen the cutting edge at both ends of the blade (Figure 95). Maintain the original angle. The blade retains its balance if the same amount of material is removed from both cutting edges.

**Note:** Maintain the original angle.

**Note:** The blade retains balance if you remove the same amount of material from both cutting edges.

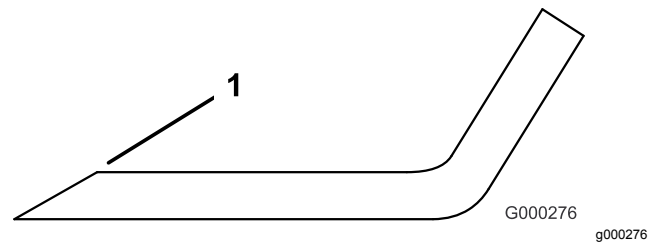


Figure 95

1. Sharpen at original angle
2. Check the balance of the blade by putting it on a blade balancer (Figure 96). If the blade stays in a horizontal position, the blade is balanced. If the blade is not balanced, file some metal off the end of the sail area only (Figure 97). Repeat this procedure until the blade is balanced.

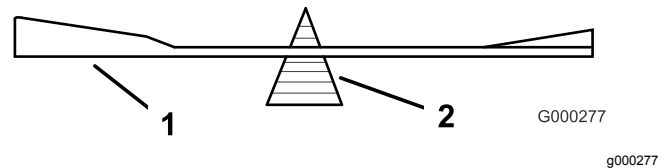


Figure 96

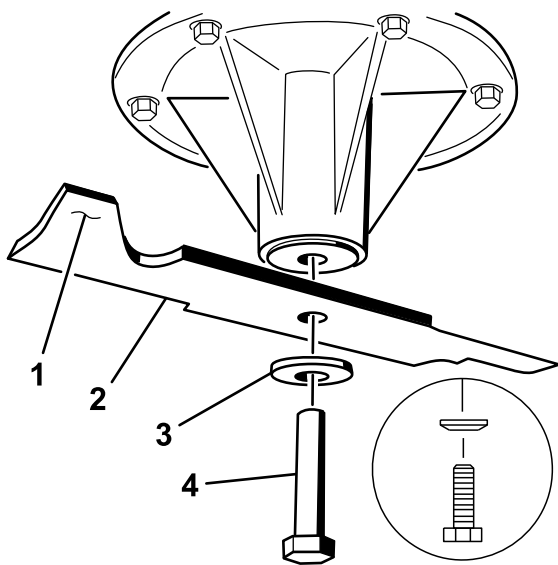
- |          |             |
|----------|-------------|
| 1. Blade | 2. Balancer |
|----------|-------------|

## Installing the Blades

1. Install the blade onto the spindle shaft (Figure 97).

**Important:** The curved part of the blade must point upward toward the inside of the mower to ensure proper cutting.

2. Install the spring disk and blade bolt. The spring disk cone must be installed toward the bolt head (Figure 97).



**Figure 97**

- |                           |                          |
|---------------------------|--------------------------|
| 1. Sail area of the blade | 4. Blade bolt            |
| 2. Blade                  | 5. Cone toward bolt head |
| 3. Spring disk            |                          |

- Torque the blade bolt to 115 to 150 N·m (85 to 110 ft·lb).

## Removing the Mower Deck

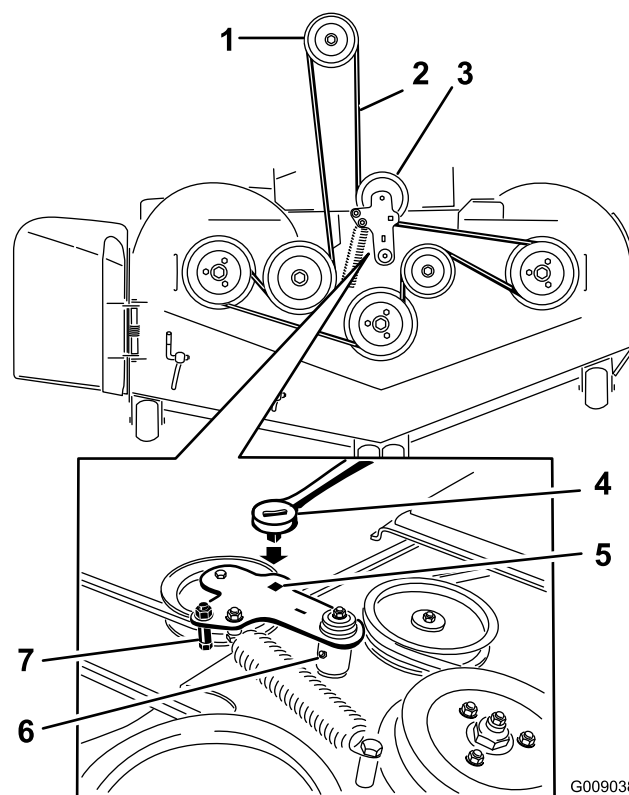
Before servicing or removing the mower deck, the spring loaded deck arms must be locked out.

### **▲ WARNING**

**Deck lift arm assemblies have stored energy. Removing the deck with out releasing the stored energy can cause serious injury or death.**

**Do Not attempt to disassemble the deck from the front frame without locking out the stored energy.**

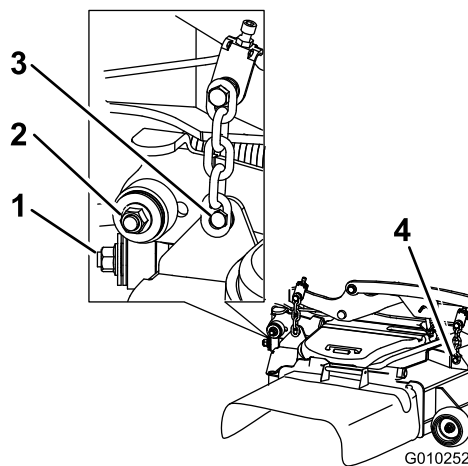
- Shut off the engine, wait for all moving parts to stop, and remove key. Engage parking brake.
- Remove the height adjustment pin and lower the deck to the ground.
- Place the height adjustment pin in the 76 mm (3 inch) cutting height location. This locks the deck lift arms in the lowest position when the deck is removed and the stored energy in the deck spring is released.
- Remove the belt covers.
- Lift up the floor pan and insert a ratchet into the square hole in the deck idler ([Figure 98](#)).
- Rotate the deck idler clockwise and remove the mower belt ([Figure 98](#)).



**Figure 98**

- |                               |   |
|-------------------------------|---|
| 1. Clutch pulley              | 5. Square hole in the idler arm for the ratchet |
| 2. Mower belt                 | 6. Idler grease zerk                            |
| 3. Spring-loaded idler pulley | 7. Belt guide                                   |
| 4. Ratchet                    |   |

- Remove and retain the hardware on both sides of the deck as shown in [Figure 99](#).



**Figure 99**

- |                                  |                                 |
|----------------------------------|---------------------------------|
| 1. Right stabilizer              | 3. Rear shoulder bolt and nut.  |
| 2. Deck strut (right side shown) | 4. Front shoulder bolt and nut. |

8. Raise the deck struts and secure them in the up position. Slide the deck out to the right side of the machine.

## Replacing the Grass Deflector

### **⚠ WARNING**

An uncovered discharge opening could allow the lawn mower to throw objects at you or a bystander result in serious injury or death.

Never operate the lawn mower unless you install a cover plate, a mulch plate, grass deflector or bagger.

1. Remove the locknut, bolt, spring, and spacer holding the deflector to the pivot brackets (Figure 100).
2. Remove damaged or worn grass deflector.

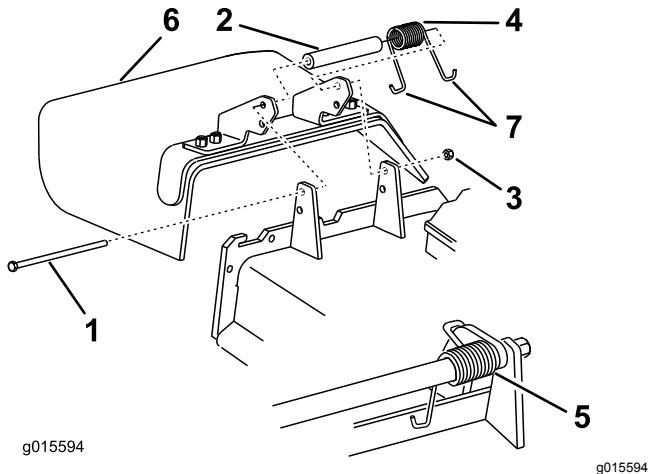


Figure 100

- |            |                         |
|------------|-------------------------|
| 1. Bolt    | 5. Spring installed     |
| 2. Spacer  | 6. Grass deflector      |
| 3. Locknut | 7. J-hook end of spring |
| 4. Spring  |                         |

3. Place spacer and spring onto grass deflector. Place 1 J-end of spring behind deck edge.

**Note:** Ensure one J-end of spring is installed behind deck edge before installing the bolt as shown in Figure 100.

4. Install bolt and nut. Place one J-hook end of spring around grass deflector (Figure 100).

**Important:** The grass deflector must be able to rotate. Lift the deflector up to the full open position and ensure that it rotates into the full down position.

## Cleaning

### Cleaning the Mower Deck

**Service Interval:** Before each use or daily

1. Disengage the blade-control switch (PTO), move the motion-control levers to the NEUTRAL-LOCK position and set the parking brake.
2. Shut off the engine, remove the key, and wait for all moving parts to stop before leaving the operating position.
3. Raise the mower to the transport position.
4. Clean the underside of the mower deck.

### Disposing of Waste

Engine oil, batteries, hydraulic fluid, and engine coolant are pollutants to the environment. Dispose of these according to your state and local regulations.

# Storage

## Cleaning and Storing the Machine

switch and keep it out of reach of children or other unauthorized users. Cover the machine to protect it and keep it clean.

1. Disengage the power-take off blade-control switch (PTO), set the parking brake, and turn the ignition key to the OFF position, and remove the key.
2. Remove grass clippings, dirt, and grime from the external parts of the entire machine (especially the engine and hydraulic system). Clean dirt and chaff from the outside of the engine-cylinder-head fins and the blower housing.

**Important:** You can wash the machine with mild detergent and water. Do not pressure-wash the machine. Avoid excessive use of water, especially near the control panel, engine, hydraulic pumps, and motors.

3. Check the brake; refer to [Brake Maintenance \(page 55\)](#).
4. Service the air cleaner; refer to [Servicing the Air Cleaner \(page 38\)](#).
5. Grease the machine; refer to [Greasing and Lubrication \(page 36\)](#).
6. Change the crankcase oil; refer to [Servicing the Engine Oil \(page 39\)](#).
7. Check the tire pressure; refer to [Checking the Tire Pressure \(page 50\)](#).
8. Change the hydraulic filters; refer to [Replacing the Hydraulic Filters and Hydraulic Fluid \(page 62\)](#).
9. Charge the battery; refer to [Charging the Battery \(page 47\)](#).
10. Scrape any heavy buildup of grass and dirt from the underside of the mower, then wash the mower with a garden hose.

**Note:** Run the machine with the blade-control switch (PTO) engaged and the engine at high idle for 2 to 5 minutes after washing.

11. Check the condition of the blades; refer to [Inspecting the Blades \(page 65\)](#).
12. Check and tighten all bolts, nuts, and screws. Repair or replace any part that is damaged.
13. Paint all scratched or bare metal surfaces. Paint is available from your Authorized Service Dealer.
14. Store the machine in a clean, dry garage or storage area. Remove the key from the ignition

# Troubleshooting

Problem	Possible Cause	Corrective Action
Malfunction indicator light (MIL) comes on.	<ol style="list-style-type: none"> <li>1. The engine is too hot.</li> <li>2. Faulty valve in fuel tank.</li> <li>3. The air cleaner is dirty.</li> <li>4. The battery is not charged.</li> <li>5. The connections to sensors-electronic-control-unit (ECU) and fuel injectors are not secured properly.</li> <li>6. Low voltage coming from the battery.</li> <li>7. A fuse is blown.</li> </ol>	<ol style="list-style-type: none"> <li>1. Shut off the engine and let it cool.</li> <li>2. Contact an Authorized Service Dealer.</li> <li>3. Ensure that the air cleaner and precleaner are clean. Replace if necessary.</li> <li>4. Charge or replace the battery.</li> <li>5. Contact an Authorized Service Dealer.</li> <li>6. Ensure you are using a good 12 V battery and it is fully charged.</li> <li>7. Check and replace the blown fuses.</li> </ol>
The starter does not crank.	<ol style="list-style-type: none"> <li>1. The blade-control switch (PTO) is ENGAGED.</li> <li>2. The parking brake is not on.</li> <li>3. The drive levers are not in NEUTRAL-LOCK position.</li> <li>4. The operator is not seated.</li> <li>5. The battery is dead.</li> <li>6. The electrical connections are corroded or loose.</li> <li>7. The fuse is blown.</li> <li>8. The relay or switch is defective.</li> </ol>	<ol style="list-style-type: none"> <li>1. Move the blade-control switch (PTO) to DISENGAGED.</li> <li>2. Set the parking brake.</li> <li>3. Ensure that the drive levers are in the NEUTRAL-LOCK position.</li> <li>4. Sit on the seat.</li> <li>5. Charge the battery.</li> <li>6. Check the electrical connections for good contact.</li> <li>7. Replace the fuse.</li> <li>8. Contact an Authorized Service Dealer.</li> </ol>
The engine does not start, starts hard, or fails to keep running	<ol style="list-style-type: none"> <li>1. The fuel tank is empty.</li> <li>2. The oil level in the crankcase is low.</li> <li>3. The throttle is not in the correct position.</li> <li>4. The air cleaner is dirty.</li> <li>5. The seat switch is not functioning properly.</li> <li>6. The electrical connections are corroded, loose or faulty.</li> <li>7. The relay or switch is defective.</li> <li>8. The spark plug is faulty.</li> <li>9. The spark plug wire is not connected.</li> </ol>	<ol style="list-style-type: none"> <li>1. Fill the fuel tank.</li> <li>2. Add oil to the crankcase.</li> <li>3. Be sure that the throttle control is midway between the SLOW and FAST positions.</li> <li>4. Clean or replace the air cleaner element.</li> <li>5. Check the seat switch indicator. Replace the seat if needed.</li> <li>6. Check the electrical connections for good contact. Clean the connector terminals thoroughly with electrical contact cleaner, apply dielectric grease, and reconnect.</li> <li>7. Contact an Authorized Service Dealer.</li> <li>8. Clean, adjust, or replace spark plug.</li> <li>9. Check the spark plug wire connection.</li> </ol>
The engine loses power.	<ol style="list-style-type: none"> <li>1. The engine load is excessive.</li> <li>2. The air cleaner is dirty.</li> <li>3. The oil level in the crankcase is low.</li> <li>4. The cooling fins and air passages above the engine are plugged.</li> </ol>	<ol style="list-style-type: none"> <li>1. Reduce the ground speed.</li> <li>2. Clean the air cleaner element.</li> <li>3. Add oil to the crankcase.</li> <li>4. Remove the obstruction from the cooling fins and air passages.</li> </ol>
The engine overheats.	<ol style="list-style-type: none"> <li>1. The engine load is excessive.</li> <li>2. The oil level in the crankcase is low.</li> <li>3. The cooling fins and air passages above the engine are plugged.</li> </ol>	<ol style="list-style-type: none"> <li>1. Reduce the ground speed.</li> <li>2. Add oil to the crankcase.</li> <li>3. Remove the obstruction from the cooling fins and air passages.</li> </ol>

<b>Problem</b>	<b>Possible Cause</b>	<b>Corrective Action</b>
The mower pulls left or right (with levers fully forward)	<ol style="list-style-type: none"> <li>1. The tracking needs adjustment</li> <li>2. The tire pressure in drive tires is not correct.</li> </ol>	<ol style="list-style-type: none"> <li>1. Adjust the tracking.</li> <li>2. Adjust tire pressure in the drive tires.</li> </ol>
The machine does not drive.	<ol style="list-style-type: none"> <li>1. The by pass valves are not closed tight.</li> <li>2. The pump belt is worn, loose or broken.</li> <li>3. The pump belt is off a pulley.</li> <li>4. The idler spring is broken or missing.</li> <li>5. The hydraulic fluid level is low or too hot.</li> </ol>	<ol style="list-style-type: none"> <li>1. Tighten the by pass valves.</li> <li>2. Change the belt.</li> <li>3. Change the belt.</li> <li>4. Replace the spring.</li> <li>5. Add hydraulic fluid to reservoirs or let it cool down.</li> </ol>
There is abnormal vibration.	<ol style="list-style-type: none"> <li>1. The cutting blade(s) is/are bent or unbalanced.</li> <li>2. The blade mounting bolt is loose.</li> <li>3. The engine mounting bolts are loose.</li> <li>4. The engine pulley, idler pulley, or blade pulley is loose.</li> <li>5. The engine pulley is damaged.</li> <li>6. The blade spindle is bent.</li> <li>7. The motor mount is loose or worn.</li> </ol>	<ol style="list-style-type: none"> <li>1. Install new cutting blade(s).</li> <li>2. Tighten the blade mounting bolt.</li> <li>3. Tighten the engine mounting bolts.</li> <li>4. Tighten the appropriate pulley.</li> <li>5. Contact an Authorized Service Dealer.</li> <li>6. Contact an Authorized Service Dealer.</li> <li>7. Contact an Authorized Service Dealer.</li> </ol>
Mowing is resulting in uneven cutting height.	<ol style="list-style-type: none"> <li>1. The blade(s) not sharp.</li> <li>2. The cutting blade(s) is/are bent.</li> <li>3. The mower deck is not level.</li> <li>4. The underside of mower is dirty.</li> <li>5. The tire pressure is not correct.</li> <li>6. The blade spindle bent.</li> </ol>	<ol style="list-style-type: none"> <li>1. Sharpen the blade(s).</li> <li>2. Install new cutting blade(s).</li> <li>3. Level the mower deck from side-to-side and front-to-rear.</li> <li>4. Clean the underside of the mower.</li> <li>5. Adjust the tire pressure.</li> <li>6. Contact an Authorized Service Dealer.</li> </ol>
The blades do not rotate.	<ol style="list-style-type: none"> <li>1. The mower deck belt is worn, loose or broken.</li> <li>2. The mower deck belt is off pulley.</li> <li>3. The pump drive belt is worn, loose or broken.</li> <li>4. The idler spring is broken or missing.</li> </ol>	<ol style="list-style-type: none"> <li>1. Install a new deck belt.</li> <li>2. Install the mower deck pulley and check the idler pulley, idler arm, and spring for correct position and function.</li> <li>3. Check the belt tension or install a new belt.</li> <li>4. Replace the spring.</li> </ol>
The clutch does not engage.	<ol style="list-style-type: none"> <li>1. The fuse is blown.</li> <li>2. There is low voltage supply at the clutch.</li> <li>3. The coil is damaged.</li> <li>4. There is inadequate current supply.</li> <li>5. The rotor/armature airgap is too large.</li> </ol>	<ol style="list-style-type: none"> <li>1. Replace the fuse. Check coil resistance, battery charge, charging system, and wiring connections and replace if necessary.</li> <li>2. Check coil resistance, battery charge, charging system, and wiring connections and replace if necessary.</li> <li>3. Replace the clutch.</li> <li>4. Repair or replace the clutch lead wire or electrical system. Clean the connector contacts.</li> <li>5. Remove the shim or replace the clutch.</li> </ol>





**Notes:**

**Notes:**

**Notes:**



# The Toro Warranty

## A Two-Year Limited Warranty

### Conditions and Products Covered

The Toro Company and its affiliate, Toro Warranty Company, pursuant to an agreement between them, jointly warrant your Toro Commercial product ("Product") to be free from defects in materials or workmanship for two years or 1500 operational hours\*, whichever occurs first. This warranty is applicable to all products with the exception of Aerators (refer to separate warranty statements for these products). Where a warrantable condition exists, we will repair the Product at no cost to you including diagnostics, labor, parts, and transportation. This warranty begins on the date the Product is delivered to the original retail purchaser.

\* Product equipped with an hour meter.

### Instructions for Obtaining Warranty Service

You are responsible for notifying the Commercial Products Distributor or Authorized Commercial Products Dealer from whom you purchased the Product as soon as you believe a warrantable condition exists. If you need help locating a Commercial Products Distributor or Authorized Dealer, or if you have questions regarding your warranty rights or responsibilities, you may contact us at:

Toro Commercial Products Service Department  
Toro Warranty Company  
8111 Lyndale Avenue South  
Bloomington, MN 55420-1196  
952-888-8801 or 800-952-2740  
E-mail: commercial.warranty@toro.com

### Owner Responsibilities

As the Product owner, you are responsible for required maintenance and adjustments stated in your *Operator's Manual*. Failure to perform required maintenance and adjustments can be grounds for disallowing a warranty claim.

### Items and Conditions Not Covered

Not all product failures or malfunctions that occur during the warranty period are defects in materials or workmanship. This warranty does not cover the following:

- Product failures which result from the use of non-Toro replacement parts, or from installation and use of add-on, or modified non-Toro branded accessories and products. A separate warranty may be provided by the manufacturer of these items.
- Product failures which result from failure to perform recommended maintenance and/or adjustments. Failure to properly maintain your Toro product per the Recommended Maintenance listed in the *Operator's Manual* can result in claims for warranty being denied.
- Product failures which result from operating the Product in an abusive, negligent, or reckless manner.
- Parts subject to consumption through use unless found to be defective. Examples of parts which are consumed, or used up, during normal Product operation include, but are not limited to, brake pads and linings, clutch linings, blades, reels, rollers and bearings (sealed or greasable), bed knives, spark plugs, castor wheels and bearings, tires, filters, belts, and certain sprayer components such as diaphragms, nozzles, and check valves, etc.
- Failures caused by outside influence. Conditions considered to be outside influence include, but are not limited to, weather, storage practices, contamination, use of unapproved fuels, coolants, lubricants, additives, fertilizers, water, or chemicals, etc.
- Failure or performance issues due to the use of fuels (e.g. gasoline, diesel, or biodiesel) that do not conform to their respective industry standards.

### Countries Other than the United States or Canada

Customers who have purchased Toro products exported from the United States or Canada should contact their Toro Distributor (Dealer) to obtain guarantee policies for your country, province, or state. If for any reason you are dissatisfied with your Distributor's service or have difficulty obtaining guarantee information, contact the Toro importer.

- Normal noise, vibration, wear and tear, and deterioration.
- Normal "wear and tear" includes, but is not limited to, damage to seats due to wear or abrasion, worn painted surfaces, scratched decals or windows, etc.

### Parts

Parts scheduled for replacement as required maintenance are warranted for the period of time up to the scheduled replacement time for that part. Parts replaced under this warranty are covered for the duration of the original product warranty and become the property of Toro. Toro will make the final decision whether to repair any existing part or assembly or replace it. Toro may use remanufactured parts for warranty repairs.

### Deep Cycle and Lithium-Ion Battery Warranty:

Deep cycle and Lithium-Ion batteries have a specified total number of kilowatt-hours they can deliver during their lifetime. Operating, recharging, and maintenance techniques can extend or reduce total battery life. As the batteries in this product are consumed, the amount of useful work between charging intervals will slowly decrease until the battery is completely worn out. Replacement of worn out batteries, due to normal consumption, is the responsibility of the product owner. Battery replacement may be required during the normal product warranty period at owner's expense. Note: (Lithium-Ion battery only): A Lithium-Ion battery has a part only prorated warranty beginning year 3 through year 5 based on the time in service and kilowatt hours used. Refer to the *Operator's Manual* for additional information.

### Maintenance is at Owner's Expense

Engine tune-up, lubrication, cleaning and polishing, replacement of filters, coolant, and completing recommended maintenance are some of the normal services Toro products require that are at the owner's expense.

### General Conditions

Repair by an Authorized Toro Distributor or Dealer is your sole remedy under this warranty.

**Neither The Toro Company nor Toro Warranty Company is liable for indirect, incidental or consequential damages in connection with the use of the Toro Products covered by this warranty, including any cost or expense of providing substitute equipment or service during reasonable periods of malfunction or non-use pending completion of repairs under this warranty. Except for the Emissions warranty referenced below, if applicable, there is no other express warranty. All implied warranties of merchantability and fitness for use are limited to the duration of this express warranty.**

Some states do not allow exclusions of incidental or consequential damages, or limitations on how long an implied warranty lasts, so the above exclusions and limitations may not apply to you. This warranty gives you specific legal rights, and you may also have other rights which vary from state to state.

### Note regarding engine warranty:

The Emissions Control System on your Product may be covered by a separate warranty meeting requirements established by the U.S. Environmental Protection Agency (EPA) and/or the California Air Resources Board (CARB). The hour limitations set forth above do not apply to the Emissions Control System Warranty. Refer to the Engine Emission Control Warranty Statement supplied with your product or contained in the engine manufacturer's documentation for details