



Heat Shield Kit

TimeCutter® Riding Mower

Model No. 138-2537

Installation Instructions

⚠ WARNING

CALIFORNIA Proposition 65 Warning

This product contains a chemical or chemicals known to the State of California to cause cancer, birth defects, or reproductive harm.

Loose Parts

Use the chart below to verify that all parts have been shipped.

Description	Qty.	Use
Heat shield	1	Install the kit.
Bolt	4	

Installing the Kit

1. Park the machine on a level surface, shut off the engine, engage the parking brake, and remove the key.
2. Wait for the machine to cool completely.
3. Remove and discard the existing 2 bolts and heat shield as shown in [Figure 1](#).

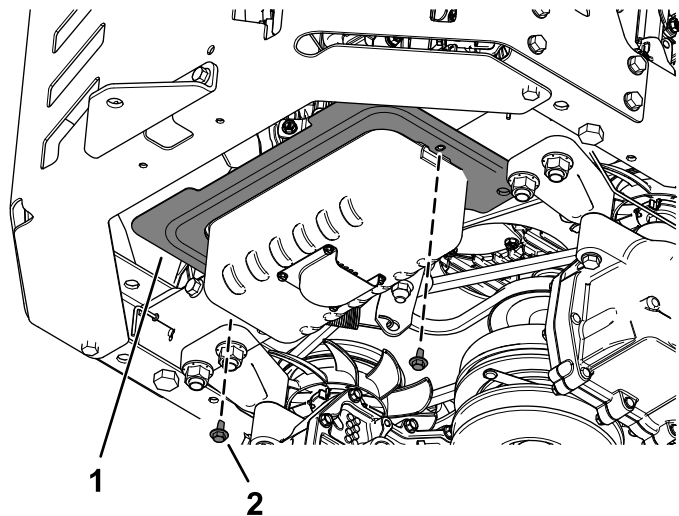

g246575

Figure 1

1. Existing heat shield 2. Bolt



4. For the front, left bolt, drill a hole (7.1 mm or 9/32 inch) into the rear crossmember (Figure 2).

Note: Use the new heat shield as a template.

Note: The other 3 bolts have aligning holes.

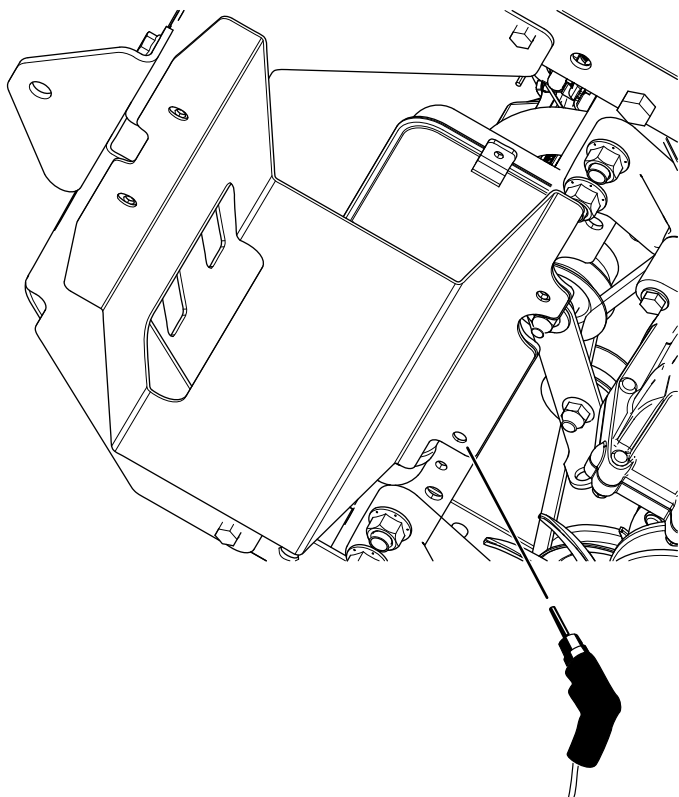

Figure 2

g247575

5. Install the new heat shield using the 4 bolts as shown in Figure 3.

Note: Ensure that the cutout of the shield faces rearward.

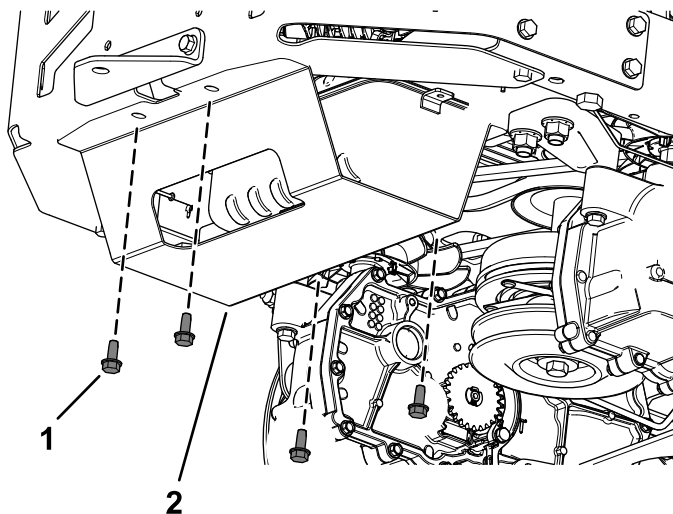

Figure 3

g246574

1. Bolt

2. New heat shield