



Steering Head Spring Breaks

Product: GreensPro® 1240

March 1, 2017

Affected Units:

Models:

Serial Numbers:

44912

314000101-316009999

Situation:

There have been reports of Spring (111-5883) failure during trailering in some GreensPro 1240 units. Roller Support Kit (136-6160) has been developed to address this issue. This kit includes Steer head support springs, steer head pivot support assemblies, and all associated mounting hardware.

Instructions:

Contact your local Toro Commercial Products Distributor to obtain Roller Support Kit and all details regarding installation. Please reference Toro Commercial Products Service Bulletin Specialty 10-03, "*Steering Head Spring Breaks*" dated March 1, 2017 when making your inquiry.



Roller Support Kit

GreensPro™ 1240 Series Greens Roller

Model No. 136-6160

Installation Instructions

▲ WARNING

CALIFORNIA Proposition 65 Warning

This product contains a chemical or chemicals known to the State of California to cause cancer, birth defects, or reproductive harm.

Installation

Loose Parts

Use the chart below to verify that all parts have been shipped.

Procedure	Description	Qty.	Use
1	No parts required	–	Prepare the machine.
2	Roller support	2	Install the rubber pads.
	Rubber pad	8	
	Screw (5 x 25 mm)	8	
	Locknut (5 mm)	8	
	Washer (5 mm)	16	
3	Spring	2	Install the kit.
	Flange-head bolt (8 x 40 mm)	2	
	Flange-head bolt (8 x 45 mm)	2	

1

Preparing the Machine

No Parts Required

Procedure

1. Park the machine on level ground, engage the parking brake, and shut off the engine before making adjustments to the machine.
2. Raise the machine, using a suitable hoist or lift.

Important: Ensure that the machine is properly supported to prevent movement during the installation of the kit.

3. Remove the roller cylinders from the steering heads (Figure 1).

Note: Retain all of the hardware for later installation.



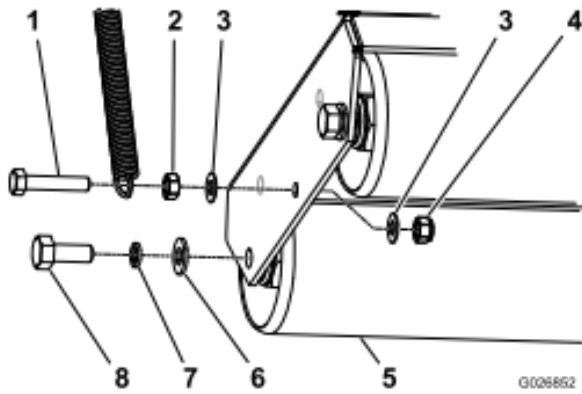

Figure 1

- | | |
|--------------------|--------------------|
| 1. Bolt (spring) | 5. Roller cylinder |
| 2. Nut | 6. Washer (roller) |
| 3. Washer (spring) | 7. Split washer |
| 4. Locknut | 8. Bolt (roller) |

- Remove the bolts, the nuts, and the washers securing the springs to each steering head and the frame.

Note: Retain the nuts and washers for later installation.

- Remove the steering heads from the machine as shown in Figure 2.

Note: Retain all the fasteners and the steering roller assemblies.

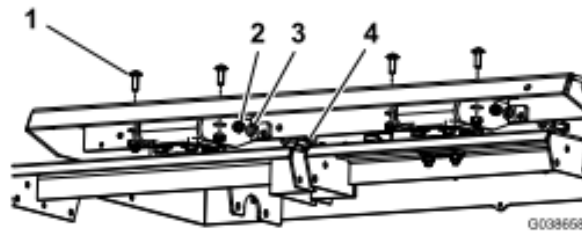

Figure 2

- | | |
|-----------------------|---------------|
| 1. Carriage screw (4) | 3. Washer (4) |
| 2. Locknut (4) | 4. Bolt (4) |

- Remove and discard the existing roller supports (Figure 3).

Note: Retain all of the fasteners and the grommet from each roller support.

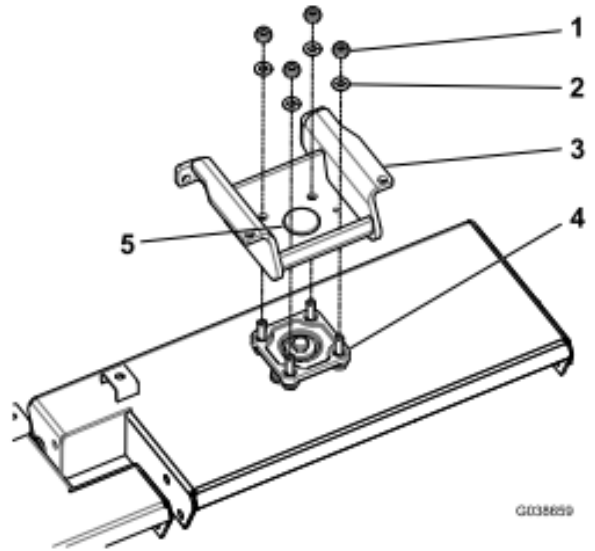

Figure 3

- | | |
|--------------------------|------------------------------|
| 1. Locknut (8) | 4. Steering bearing assembly |
| 2. Washer (existing), 16 | 5. Grommet (2) |
| 3. Roller support (2) | |

2

Installing the Rubber Pads

Parts needed for this procedure:

2	Roller support
8	Rubber pad
8	Screw (5 x 25 mm)
8	Locknut (5 mm)
16	Washer (5 mm)

Procedure

Install 4 rubber pads on each roller support (Figure 4).

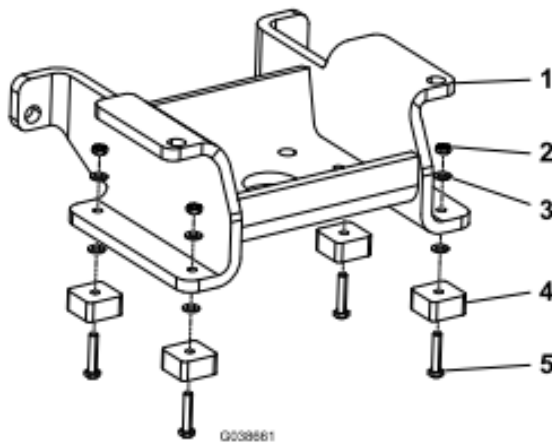

Figure 4

- | | |
|-----------------------|------------------------|
| 1. Roller support (2) | 4. Rubber pad (8) |
| 2. Locknut—5 mm (8) | 5. Screw—5 x 25 mm (8) |
| 3. Washer—5 mm (16) | |

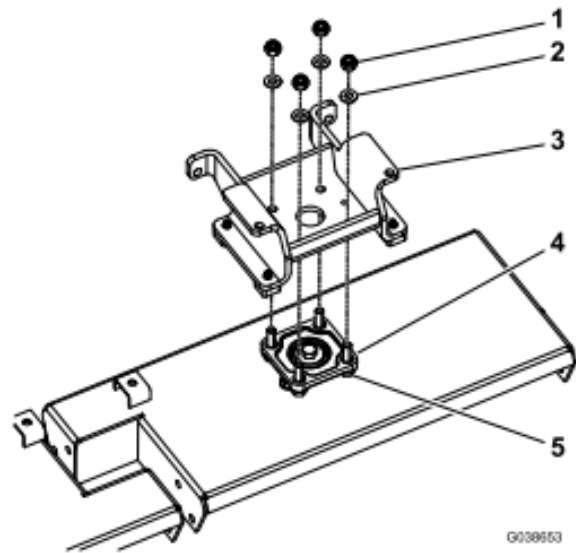

Figure 5

- | | |
|--------------------------|------------------------------|
| 1. Locknut (8) | 4. Steering bearing assembly |
| 2. Washer (existing), 16 | 5. Bolt—M10 x 40 mm (8) |
| 3. Roller support (2) | |

3

Installing the Kit

Parts needed for this procedure:

2	Spring
2	Flange-head bolt (8 x 40 mm)
2	Flange-head bolt (8 x 45 mm)

Procedure

- Using the previously removed bolts (M10 x 40 mm), locknuts (M10), and washers, secure a new roller support to each of the previously removed roller bearings and smoothing rollers (Figure 5).

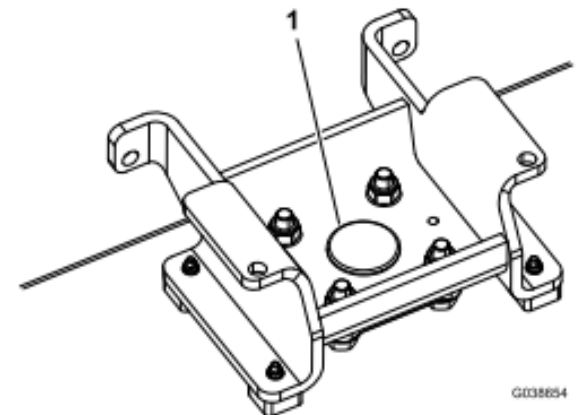

Figure 6

- Grommet
- Using 4 carriage screws, 4 bolts (M10 x 35 mm), 8 locknuts (M10), and 16 washers (M10), secure the roller supports to the frame (Figure 7).

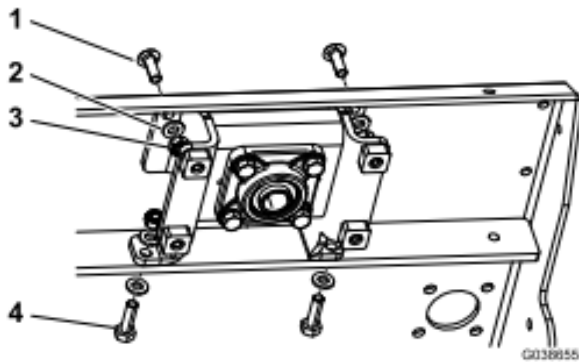

Figure 7
Steering head not shown for clarity

- | | |
|-----------------------|--------------------|
| 1. Carriage screw (4) | 3. Locknut—M10 (8) |
| 2. Washer—M10 (16) | 4. Bolt (4) |

Note: First tighten the nuts and bolts securing the supports to the frame rib, and then tighten the nuts and carriage screws securing the supports to the top of the frame (Figure 8).

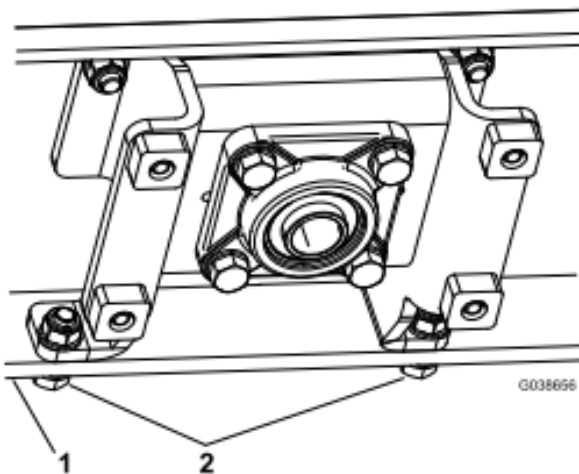

Figure 8
Steering head not shown for clarity

- | | |
|--------------|-----------------------------------|
| 1. Frame rib | 2. Tighten these fasteners first. |
|--------------|-----------------------------------|

4. Install the roller cylinders into the steering heads; refer to Figure 1.

Important: Align the short roller cylinders so that the short tubes are on the outside and the long tubes are on the inside (Figure 9). This staggers the joints between the roller tubes to improve the contact with the turf.

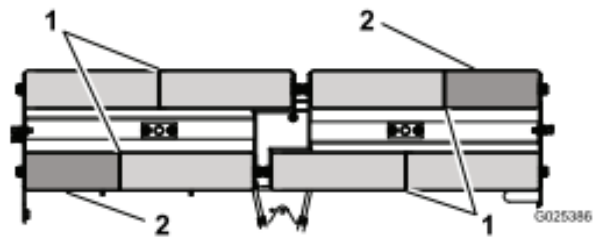

Figure 9

- | | |
|-----------|----------------------|
| 1. Joints | 2. Short roller tube |
|-----------|----------------------|

5. Connect each of the 2 springs to the appropriate steering head, using the flange-head bolts provided and the washers, nuts, and locknuts previously removed; refer to Figure 10.

Note: Keep part of the shank on each bolt exposed so that the springs can move freely.

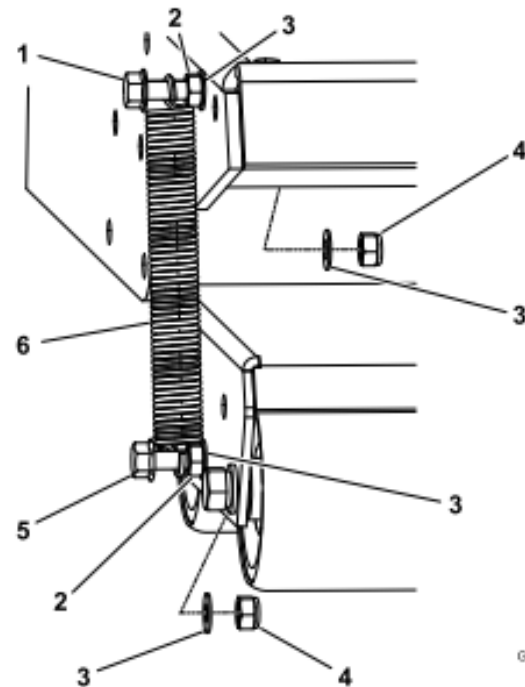

Figure 10

- | | |
|---------------------------------|---------------------------------|
| 1. Flange-head bolt (8 x 45 mm) | 4. Locknut (existing) |
| 2. Nut (existing) | 5. Flange-head bolt (8 x 40 mm) |
| 3. Washer (existing) | 6. Spring |