



**Count on it.**

**Operator's Manual**

**Workman® HDX-D Utility Vehicle  
with Bed**

- Model No. 07385—Serial No. 316000001 and Up
- Model No. 07385—Serial No. 400000000 and Up
- Model No. 07385H—Serial No. 316000001 and Up
- Model No. 07385TC—Serial No. 316000001 and Up
- Model No. 07385TC—Serial No. 400000000 and Up
- Model No. 07387—Serial No. 316000501 and Up
- Model No. 07387—Serial No. 400000000 and Up
- Model No. 07387H—Serial No. 316000001 and Up
- Model No. 07387TC—Serial No. 316000501 and Up
- Model No. 07387TC—Serial No. 400000000 and Up



## ⚠ WARNING

### CALIFORNIA Proposition 65 Warning

This product contains a chemical or chemicals known to the State of California to cause cancer, birth defects, or reproductive harm.

Diesel engine exhaust and some of its constituents are known to the State of California to cause cancer, birth defects, and other reproductive harm.

This machine is a utility vehicle intended to be used by professional, hired operators in commercial applications. It is primarily designed for the transport of implements used in such applications. This machine allows for the safe transport of an operator and one passenger in the identified seats. The bed of this machine is not suitable for any riders.

This product complies with all relevant European directives; for details, please see the separate product specific Declaration of Conformity (DOC) sheet.

It is a violation of California Public Resource Code Section 4442 or 4443 to use or operate the engine on any forest-covered, brush-covered, or grass-covered land unless the engine is equipped with a spark arrester, as defined in Section 4442, maintained in effective working order or the engine is constructed, equipped, and maintained for the prevention of fire.

# Introduction

Read this information carefully to learn how to operate and maintain your product properly and to avoid injury and product damage. You are responsible for operating the product properly and safely.

You may contact Toro directly at [www.Toro.com](http://www.Toro.com) for product and accessory information, help finding a distributor, or to register your product.

Whenever you need service, genuine Toro parts, or additional information, contact an Authorized Service Distributor or Toro Customer Service and have the model and serial numbers of your product ready. [Figure 1](#) identifies the location of the model and serial numbers on the product. Write the numbers in the space provided.

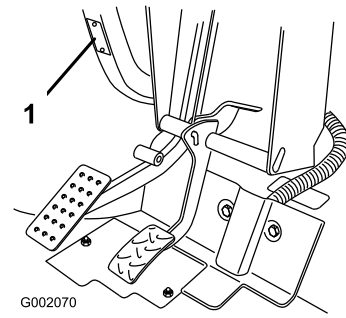

Figure 1

1. Model and serial number location

Model No. \_\_\_\_\_

Serial No. \_\_\_\_\_

This manual identifies potential hazards and has safety messages identified by the safety-alert symbol ([Figure 2](#)), which signals a hazard that may cause serious injury or death if you do not follow the recommended precautions.



Figure 2  
Safety-Alert Symbol

This manual uses 2 words to highlight information.

**Important** calls attention to special mechanical information and **Note** emphasizes general information worthy of special attention.

# Contents

Safety .....	4
Safe Operating Practices .....	4
Safety and Instructional Decals .....	8
Setup .....	14
1 Installing the Steering Wheel.....	14
2 Installing the Rollover-Protection System (ROPS) .....	14
3 Checking the Fluid Levels .....	15
4 Adjusting the Ball Switch .....	16
5 Burnishing the Brakes.....	16
Product Overview .....	17
Controls .....	17
Specifications .....	21
Attachments/Accessories.....	21
Operation .....	21
Operating the Cargo Box.....	21
Checking the Engine-Oil Level.....	22
Adding Fuel.....	24
Checking the Coolant Level .....	25
Checking the Transaxle/Hydraulic-Fluid Level.....	25
Checking the High Flow Hydraulic-Fluid Level.....	26
Checking the Front-Differential-Oil Level.....	27
Checking the Torque of the Wheel Nuts.....	27
Checking the Tire Pressure .....	27
Checking the Brake-Fluid Level .....	28
Starting the Engine.....	29
Driving the Machine .....	29
Stopping the Machine .....	29
Shutting Off the Engine .....	29
Breaking in a New Machine.....	29
Checking the Safety-Interlock System.....	30
Ensuring Passenger Safety .....	30
Ensuring Proper Speed .....	31
Ensuring Proper Turning.....	31
Ensuring Proper Braking.....	31
Preventing Tip-Overs .....	31
Operating on Hills.....	31
Loading and Dumping .....	32
Using the Differential Lock.....	32
Using 4-Wheel Drive .....	33
Transporting the Machine.....	33
Towing the Machine .....	33
Towing a Trailer with the Machine.....	34
Using the Hydraulic Control .....	34
Maintenance .....	36
Recommended Maintenance Schedule(s) .....	36
Operating in Adverse Conditions.....	37
Pre-Maintenance Procedures .....	38
Using the Bed Support .....	38
Removing the Full Bed.....	39
Installing the Full Bed .....	39
Raising the Machine.....	40
Removing the Hood .....	41
Installing the Hood.....	41

Lubrication .....	42
Greasing the Bearings and Bushings.....	42
Engine Maintenance .....	44
Servicing the Air Cleaner .....	44
Changing the Engine Oil and Filter .....	44
Fuel System Maintenance .....	45
Checking the Fuel Lines and Connections .....	45
Servicing the Fuel Filter/Water Separator.....	45
Electrical System Maintenance .....	46
Servicing the Fuses .....	46
Jump-Starting the Machine .....	47
Servicing the Battery .....	48
Drive System Maintenance .....	48
Changing the Front Differential Oil .....	48
Inspecting the Constant-Velocity Boot .....	49
Adjusting the Shift Cables.....	49
Adjusting the High-to-Low Cable .....	49
Adjusting Differential-Lock Cable .....	49
Inspecting the Tires .....	50
Checking the Front-Wheel Alignment .....	50
Cooling System Maintenance .....	51
Removing Debris from the Cooling System .....	51
Changing the Engine Coolant.....	51
Brake Maintenance .....	52
Adjusting the Parking Brake.....	52
Adjusting the Brake Pedal.....	53
Belt Maintenance .....	54
Adjusting the Alternator Belt .....	54
Controls System Maintenance .....	54
Adjusting the Accelerator Pedal.....	54
Adjusting the Clutch Pedal.....	55
Converting the Speedometer.....	55
Hydraulic System Maintenance .....	56
Changing the Hydraulic Fluid and Cleaning the Strainer.....	56
Replacing the Hydraulic Filter .....	57
Changing the High-Flow Hydraulic Fluid and Filter .....	57
Raising the Cargo Box in an Emergency .....	58
Cleaning .....	60
Washing the Machine .....	60
Storage .....	60

# Safety

Improper use or maintenance by the operator or owner can result in injury. To reduce the potential for injury, comply with these safety instructions and always pay attention to the safety-alert symbol, which means **Caution**, **Warning**, or **Danger**—personal safety instruction. Failure to comply with the instruction may result in personal injury or death.

The machine meets the requirements of SAE J2258.

**Important:** For CE required regulatory data, refer to the Declaration of Conformity supplied with the machine.

## Safe Operating Practices

**Important:** This machine is designed primarily as an off-road machine and is not intended for extensive use on public roads.

When using the machine on public roads, follow all traffic regulations and use any additional accessories that may be required by law, such as lights, turn signals, slow-moving vehicle (SMV) signs, and others as required.

This machine was designed and tested to offer safe service when operated and maintained properly. Although hazard control and accident prevention are dependent upon the design and configuration of the machine, these factors are also dependent upon the awareness, concern, and proper training of the operator, maintenance, and storage of the machine. Improper use or maintenance of the machine can result in injury or death.

This machine has a different feel than what drivers experience with passenger cars or trucks. So take time to become familiar with your machine.

Not all of the attachments that adapt to the machine are covered in this manual. See the specific *Operator's Manual* provided with each attachment for additional safety instructions.

To reduce the potential for injury or death, comply with the following safety instructions:

## Supervisor's Responsibilities

Make sure that the operators are thoroughly trained and familiar with the *Operator's Manual* and all labels on the machine.

## Before Operating

- This machine is designed to carry **only you**, the operator, and **1 passenger** in the seat provided by the manufacturer. **Never** carry any other passengers on the machine.
- Become familiar with the controls and know how to shut off the engine quickly.

- **Never** operate the machine when tired, ill, or under the influence of drugs or alcohol.
- Wear substantial, slip-resistant shoes. Do not wear loose-fitting clothing, tie back long hair, and do not wear jewelry.
- **Never** allow children to operate the machine. **Never** allow adults to operate it without proper instructions. Only trained and authorized persons should operate this machine.
- Always be aware of where bystanders are.
- Keep all shields, safety devices and decals in place. If a shield, safety device or decal is malfunctioning, illegible, or damaged, repair or replace it before operating the machine.
- Avoid driving when it is dark, especially in unfamiliar areas. If you must drive when it is dark, be sure to drive cautiously, use the headlights.
- Before operating the machine, always check all parts of the machine and any attachments. If something is wrong, **stop using the machine**. Make sure that the problem is corrected before you operate the machine or attachment again.
- Operate the machine only outdoors or in a well-ventilated area.

## Safe Handling of Fuels

- To avoid personal injury or property damage, use extreme care in handling fuel. Fuel is extremely flammable and the vapors are explosive.
- Do not smoke near the machine.
- Use only an approved nonmetal, portable fuel container.
- Static electric discharge can ignite fuel vapors in a fuel container that is not grounded. Never fill containers inside a machine or on a truck or trailer bed with a plastic liner. Remove the fuel container from the bed of the machine and place it on the ground and away from the machine before filling.
- Keep the nozzle in contact with the container while filling the fuel container. Remove equipment from the bed of the machine before fueling it. Do not use a nozzle lock-open device.
- Never remove the fuel cap or add fuel with the engine running.
- Allow engine to cool before refueling.
- Never refuel the machine indoors.
- Never store the machine or fuel container where there is an open flame, spark, or pilot light, such as on a water heater or on other appliances.
- Remove equipment from the truck or trailer and refuel it on the ground. If this is not possible, then refuel such

equipment with a portable container rather than from a fuel-dispenser nozzle.

- If fuel is spilled on clothing, change clothing immediately.
- Never overfill the fuel tank. Replace the fuel cap and tighten it securely.

## Operation

- The operator and passenger must use seat belts and remain seated whenever the machine is in motion. Keep both hands on the steering wheel, whenever possible, and the passenger should use the handholds provided. Keep your arms and legs within the machine body at all times. Never carry passengers in the box or on attachments. Remember, your passenger may not be expecting you to brake or turn, and may not be ready.
- Never overload the machine. The name plate (located under the middle of the dash) shows the load limits for the machine. Never overfill attachments or exceed the machine maximum gross vehicle weight (GVW).
- When starting the engine:

1. Sit on the operator's seat and engage the parking brake.
2. Disengage the PTO and high-flow hydraulics (if equipped) and move the hand-throttle lever to the OFF position (if equipped).
3. Move the shift lever to the NEUTRAL position and press the clutch pedal.
4. Ensure that the hydraulic-lift lever is in the center position.
5. Keep your foot off the accelerator pedal.
6. Rotate the key switch to the ON position.

**Note:** When the glow-plug-indicator light turns on, the engine is ready to start.

7. Rotate the key switch to the START position.

**Note:** Release the key immediately when the engine starts and allow it to return to the RUN position.

**Note:** The glow-plug indicator turns on for an additional 15 seconds when the switch returns to the RUN position.

**Note:** Do not run the starter motor more than 10 seconds at a time or premature starter failure may result. If engine fails to start after 10 seconds, turn the key to the OFF position. Check the controls and starting procedure, wait 10 additional seconds, and repeat the starting operation.

- Failure to operate machine safely may result in an accident, tipping over the machine, and/or serious injury or death. To prevent tipping or loss of control, take the following precautions:
  - Use extreme caution, reduce your speed, and maintain a safe distance around sand traps, ditches, creeks, ramps, any unfamiliar areas, or other hazards.

- Watch for holes or other hidden hazards.
- Use caution when operating the machine on a slope. Normally, travel straight up and down slopes. Reduce your speed when making sharp turns or when turning on hillsides. Avoid turning on hillsides whenever possible.
- Use extra caution when operating the machine on wet surfaces, at higher speeds, or with a full load. Stopping time increases with a full load. Shift into a lower gear before starting up or down a hill.
- When loading the bed, distribute the load evenly. Use extra caution if the load exceeds the dimensions of the machine/bed. Operate the machine with extra caution when handling off-center loads that cannot be centered. Keep loads balanced and secure to prevent them from shifting.
- Avoid sudden stops and starts. Do not go from reverse to forward or forward to reverse without first coming to a complete stop.
- Do not attempt sharp turns or abrupt maneuvers or other unsafe driving actions that may cause a loss of machine control.
- When dumping, do not let anyone stand behind the machine, and do not dump the load on anyone's feet. Release the tailgate latches from the side of box, not from behind.
- Keep all bystanders away. Before backing up, look to the rear and ensure that no one is behind the machine. Back up slowly.
- Watch out for traffic when near or crossing roads. Always yield the right of way to pedestrians and other machines. This machine is not designed for use on streets or highways. Always signal your turns or stop early enough so other persons know what you plan to do. Obey all traffic rules and regulations.
- Never operate the machine in or near an area where there is dust or fumes in the air which are explosive. The electrical and exhaust systems of the machine can produce sparks capable of igniting explosive materials.
- Always watch out for and avoid low overhangs such as tree limbs, door jambs, overhead walkways, etc. Make sure that there is enough room over head to easily clear the machine and your head.
- If you are ever unsure about safe operation, **stop work**, and ask your supervisor.
- Do not touch the engine, transaxle, radiator, muffler, or muffler manifold while the engine is running or soon after it has stopped, because these areas may be hot enough to cause burns.
- If the machine ever vibrates abnormally, stop immediately, shut off the engine, wait for all motion to stop, and inspect for damage. Repair all damage before resuming operation.

- Before getting off the seat:
  1. Stop the movement of the machine.
  2. Engage the parking brake.
  3. Shut off the engine and remove the key.
- **Note:** If the machine is on an incline, block the wheels after getting off the machine.
- Lightning can cause severe injury or death. If lightning is seen, do not operate the machine; seek shelter.

## Braking

- Slow down the machine before you approach an obstacle. This gives you extra time to stop or turn away. Hitting an obstacle can injure you and your passenger. In addition, it can damage the machine and its contents.
- Gross vehicle weight (GVW) has a major impact on your ability to stop and/or turn. Heavy loads and attachments make the machine harder to stop or turn. The heavier the load, the longer it takes to stop.
- Decrease the speed of the machine if the cargo box has been removed and there is no attachment installed on the machine. The braking characteristics change and fast stops may cause the rear wheels to lock up, which affects the control of the machine.
- Turf and pavement are much more slippery when they are wet. It can take 2 to 4 times longer to stop the machine on wet surfaces as on dry surfaces. If you drive through deep-standing water and get the brakes wet, they will not work well until they are dry. After driving through water, you should test the brakes to make sure that they work properly. If they do not, drive slowly on a level ground while putting light pressure on the brake pedal. This dries out the brakes.

## Operating on Hills

### **⚠ WARNING**

Operating the machine on a hill may cause tipping or rolling of the machine, or the engine may stall and you could lose headway on the hill. This could result in personal injury.

- **Do not operate the machine on excessively steep slopes.**
- **Do not accelerate quickly or slam the brakes when backing down a hill, especially with a load.**
- **If the engine stalls or you lose headway on a hill, slowly back straight down the hill. Never attempt to turn the machine around.**
- **Operate the machine slowly on a hill and use caution.**
- **Avoid turning on a hill.**
- **Reduce your load and the speed of the machine.**
- **Avoid stopping on hills, especially with a load.**

Take these precautions when operating the machine on a hill:

- Slow the machine down before starting up or down a hill.
- If the engine stalls or you begin to lose momentum while climbing a hill, gradually apply the brakes and slowly back the machine straight down the hill.
- Turning while traveling up or down hills can be dangerous. If you have to turn while on a hill, do it slowly and cautiously. Never make sharp or fast turns.
- Heavy loads affect stability. Reduce the weight of the load and your ground speed when operating on hills or if the load has a high center of gravity. Secure the load to the cargo box of the machine to prevent the load from shifting. Take extra care when hauling loads that shift easily (liquid, rock, sand, etc.).
- Avoid stopping on hills, especially with a load. Stopping while going down a hill takes longer than stopping on level ground. If you must stop the machine, avoid sudden speed changes, which may initiate tipping or rolling of the machine. Do not slam on the brakes when rolling backward, as this may cause the machine to overturn.

## Operating on Rough Terrain

Reduce the ground speed of the machine and load carried in the machine when operating on rough terrain, uneven ground, and near curbs, holes, and other sudden changes in terrain. Loads may shift, causing the machine to become unstable.

### **⚠ WARNING**

**Sudden changes in terrain may cause abrupt steering wheel movement, possibly resulting in hand and arm injuries.**

- **Reduce your speed when operating on rough terrain and near curbs.**
- **Grip the steering wheel loosely around the perimeter keeping thumbs up and out of the way of the steering-wheel spokes.**

## Loading and Dumping

The weight and position of cargo and passenger can affect the stability and handling of the machine. Be aware of the following condition to avoid losing control of the machine or tipping it over:

- Do not exceed the rated weight capacity of the machine when operating it with a load in the cargo box, when towing a trailer, or both; refer to [Specifications \(page 21\)](#).
- Use caution when operating the machine on a hillside or on rough terrain, particularly with a load in the cargo box or when towing a trailer or both.
- Be aware that the stability and control of the machine are reduced when the load in the cargo box is poorly distributed.
- Carrying oversized loads in the cargo box changes the stability of the machine.

- The steering, braking, and stability of the machine are affected when carrying a load where the weight of the material cannot be bound to the machine, such as the liquid in a large tank.

## **▲ WARNING**

**The weight of the box may be heavy. Hands or other body parts could be crushed.**

- **Keep hands and other body parts clear when lowering the box.**
- **Do not dump materials on bystanders.**
- Never dump a loaded cargo box while the machine is sideways on a hill. The change in weight distribution may cause the machine to overturn.
- When operating with a heavy load in the cargo box, reduce your speed and allow for sufficient braking distance. Do not suddenly apply the brakes. Use extra caution on slopes.
- Be aware that heavy loads increase your stopping distance and reduce your ability to turn quickly without tipping over.
- The rear cargo space is intended for load carrying purposes only, not for passengers.

## Maintenance

### **▲ WARNING**

**Hydraulic fluid escaping under pressure can have sufficient force to penetrate skin and do serious damage. If fluid is injected into the skin, it must be surgically removed within a few hours by a doctor familiar with this form of injury; otherwise gangrene may result.**

**Keep your body and hands away from pinhole leaks or nozzles that eject hydraulic fluid under high pressure. Use paper or cardboard, not your hands, to search for leaks.**

- Before servicing or making adjustments to the machine, park the machine on a level surface, engage the parking brake, shut off the machine, and remove the key to prevent accidental starting of the machine.
- Never work under a raised bed without placing the bed safety support on the fully extended cylinder rod.
- Make sure that all hydraulic-line connectors are tight, and that all hydraulic hoses and lines are in good condition before applying pressure to the system.
- Before disconnecting or performing any work on the hydraulic system, all pressure in the system must be

relieved by shutting off the engine, cycling the dump valve from raise to lower and/or lowering box and attachments. Place the remote hydraulics lever in the float position. If the box must be in raised position, secure it with the safety support.

- To make sure that the entire machine is in good condition, keep all nuts, bolts, and screws properly tightened.
- To reduce the potential fire hazard, keep the engine area free of excessive grease, grass, leaves, and accumulation of dirt.
- If the engine must be running to perform a maintenance adjustment, keep hands, feet, clothing, and any parts of the body away from the engine and any moving parts. Keep everyone away.
- Do not overspeed the engine by changing the governor settings. The maximum engine speed is 3,650 rpm. To ensure safety and accuracy, have an Authorized Toro Distributor check the maximum engine speed with a tachometer.
- If major repairs are ever needed or assistance is required, contact an Authorized Toro Distributor.
- To be sure of optimum performance and safety, always purchase genuine Toro replacement parts and accessories. Replacement parts and accessories made by other manufacturers could be dangerous. Altering this machine in any manner may affect the operation of the machine, performance, durability or its use may result in injury or death. Such use could void the product warranty of The Toro® Company.

## Rollover Protection System (ROPS)

- The ROPS is an integral and effective safety device. Use the seat belt when operating the machine with the ROPS.
- Be certain that you can release the seat belt quickly in the event of an emergency.
- Check carefully for overhead clearances (i.e., branches, doorways, electrical wires) before driving under any objects and do not contact them.
- Keep the ROPS in safe-operating condition by periodically inspecting for damage and keeping all mounting fasteners tight.
- Replace a damaged ROPS. Do not repair or revise.
- **Do not** remove the ROPS.
- Any alterations to a ROPS must be approved by the manufacturer.

# Safety and Instructional Decals



Safety decals and instructions are easily visible to the operator and are located near any area of potential danger. Replace any decal that is damaged or missing.



**106-6755**

decal106-6755

1. Engine coolant under pressure.
2. Explosion hazard—read the *Operator's Manual*.
3. Warning—do not touch the hot surface.
4. Warning—read the *Operator's Manual*.

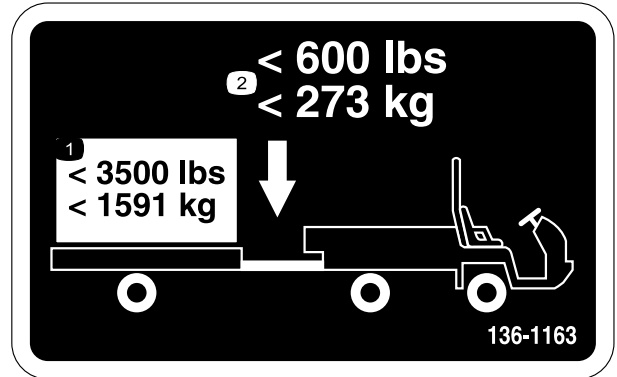

**136-1163**

decal136-1163

1. Do not exceed a transport load of 1591 kg (3,500 lb).
2. Do not exceed a towing weight of 273 kg (600 lb).

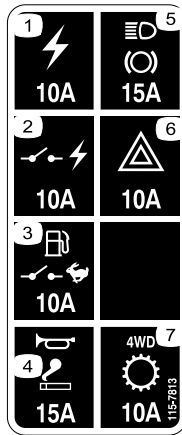

**115-7813**

decal115-7813

1. Power outlet (10 A)
2. Switched power (10 A)
3. Fuel pump, supervisor switch (10 A)
4. Horn, power point (15 A)
5. Lights, brake (15 A)
6. Hazard (10 A)
7. 4WD, Transmission (10 A)

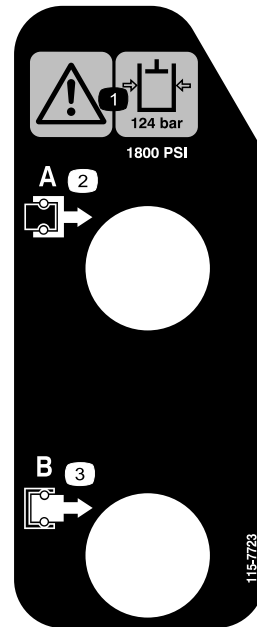

**115-7723**

decal115-7723

1. Warning—the hydraulic-fluid pressure is 124 bar (1,800 psi).
2. Coupler A
3. Coupler B

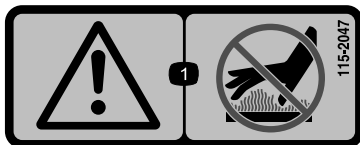

**115-2047**

decal115-2047

1. Warning—do not touch the hot surface.



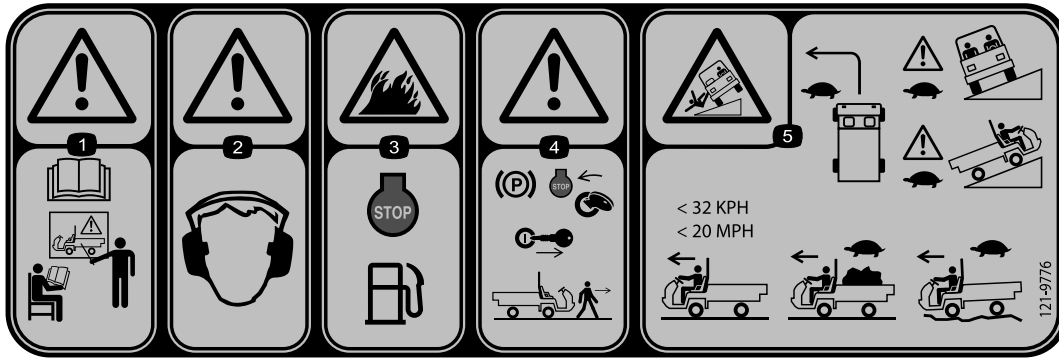

121-9776

decal121-9776

1. Warning—read the *Operator's Manual* and receive proper training before operating the machine.
2. Warning—wear hearing protection.
3. Fire hazard—shut off the engine before refueling the machine.
4. Warning—engage the parking brake, shut off the engine, and remove the key from the key switch before walking away from the machine.
5. Tipping hazard—take turns slowly; drive slowly up and across cliffs; with no load, do not exceed 32 kph (20 mph); while carrying a load or when driving on uneven terrain, drive slowly.

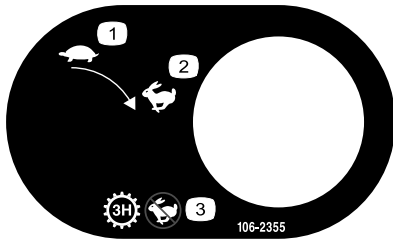

106-2355

decal106-2355

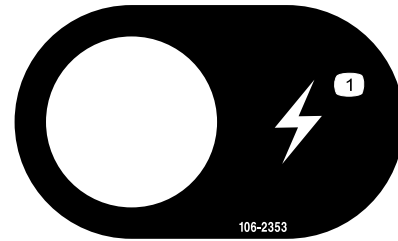

106-2353

decal106-2353

1. Slow
2. Fast
3. Transmission—third high; no fast speed

1. Electrical power point

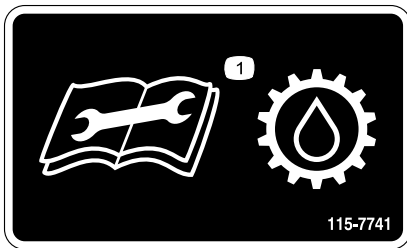

115-7741

decal115-7741

1. Read the *Operator's Manual* before servicing transmission fluid.

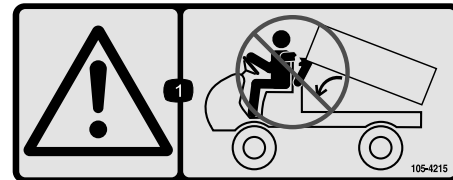

105-4215

decal105-4215

1. Warning—avoid pinch points.

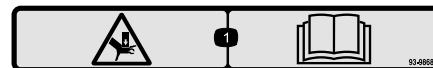

93-9868

decal93-9868

1. Crushing hazard of hand—read the *Operator's Manual*.



### Battery Symbols

Some or all of these symbols are on your battery.

- |  |   |
|--|---|
| 1. Explosion hazard                    | 6. Keep bystanders a safe distance away from the battery.                       |
| 2. No fire, open flame, or smoking     | 7. Wear eye protection; explosive gases can cause blindness and other injuries. |
| 3. Caustic liquid/chemical burn hazard | 8. Battery acid can cause blindness or severe burns.                            |
| 4. Wear eye protection.                | 9. Flush eyes immediately with water and get medical help fast.                 |
| 5. Read the <i>Operator's Manual</i> . | 10. Contains lead; do not discard   |

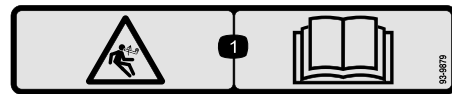

93-9879

decal93-9879

1. Stored energy hazard—read the *Operator's Manual*.

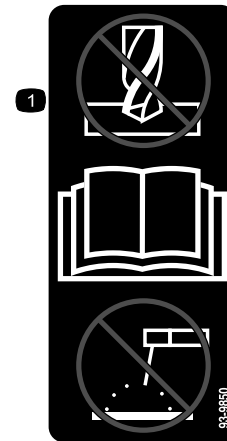

93-9850

decal93-9850

1. Do not repair or revise—read the *Operator's Manual*.

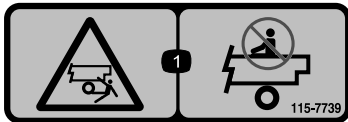

115-7739

decal115-7739

1. Falling, crushing hazard, bystanders—no riders on machine

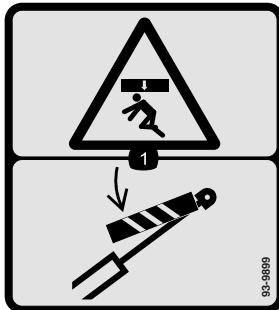

93-9899

decal93-9899

1. Crushing hazard—install the cylinder lock.



115-7756

decal115-7756

1. High-flow hydraulics—engaged



106-7767

decal106-7767

1. Warning—read the *Operator's Manual*; avoid tipping the machine; wear the seat belt; lean away from the direction the machine is tipping.

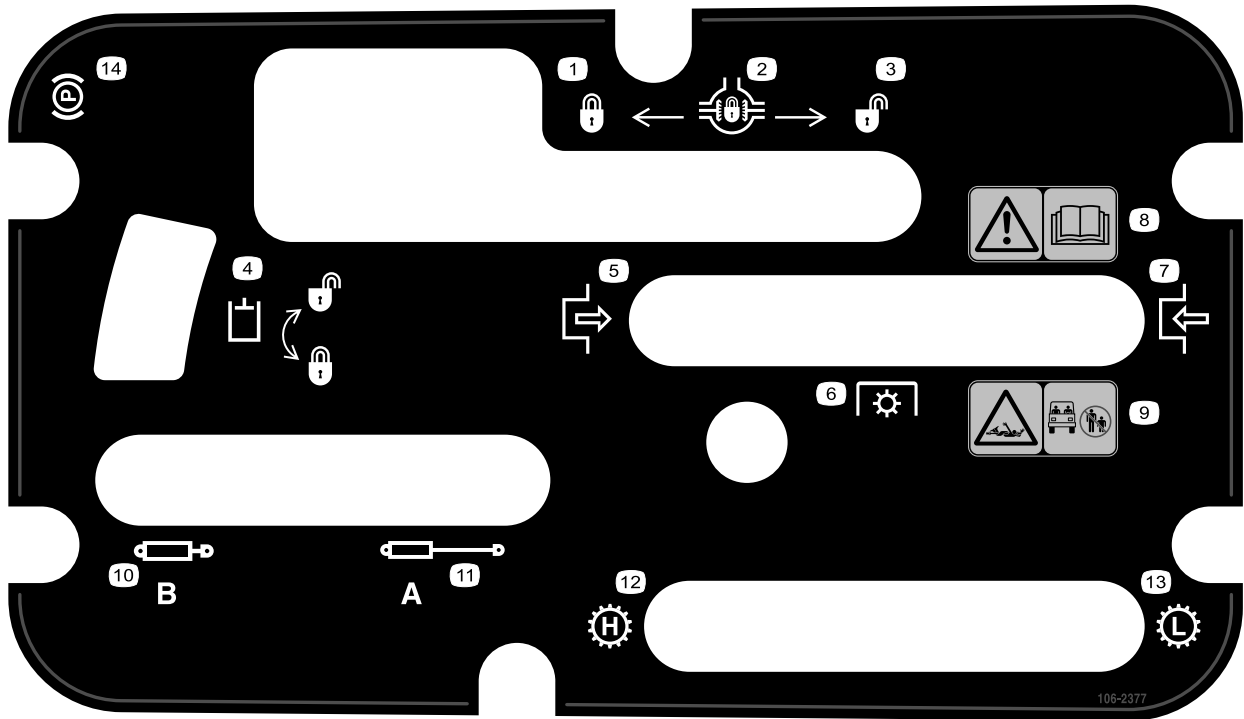

decal106-2377

**106-2377**

- |                        |   |
|------------------------|---|
| 1. Locked              | 8. Warning—read the <i>Operator's Manual</i> .  |
| 2. Differential lock   | 9. Entanglement hazard, shaft—keep bystander's a safe distance away from the machine. |
| 3. Unlocked            | 10. Retract hydraulics  |
| 4. Hydraulic lock      | 11. Extend hydraulics   |
| 5. Engage              | 12. Transmission—high speed   |
| 6. Power takeoff (PTO) | 13. Transmission—low speed  |
| 7. Disengage           | 14. Parking brake   |

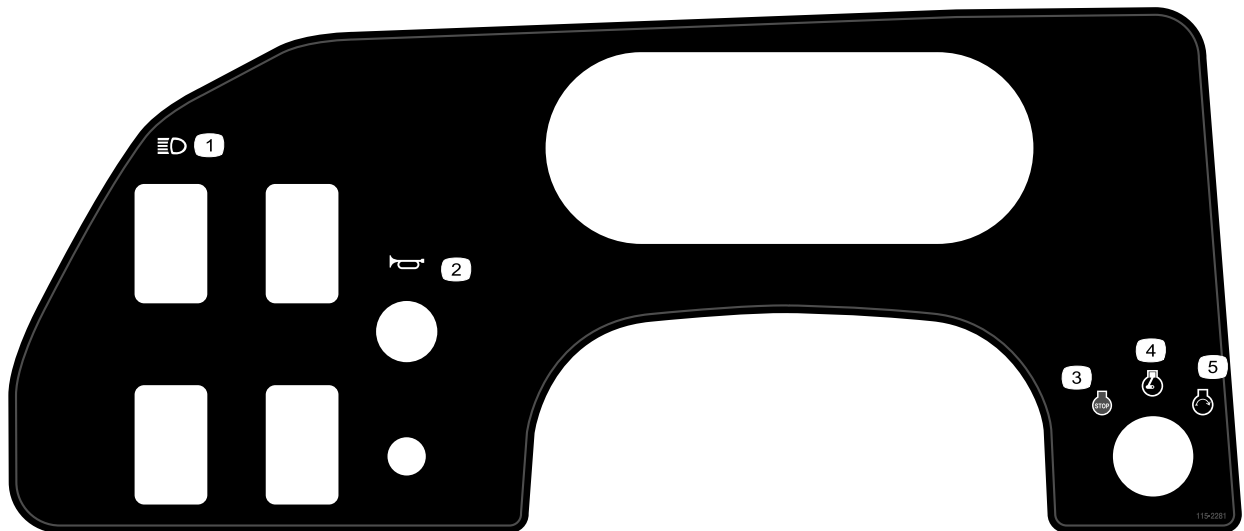

decal115-2281

**115-2281**

- |                    |                 |
|--------------------|-----------------|
| 1. Headlights      | 4. Engine—run   |
| 2. Horn            | 5. Engine—start |
| 3. Engine—shut off |                 |

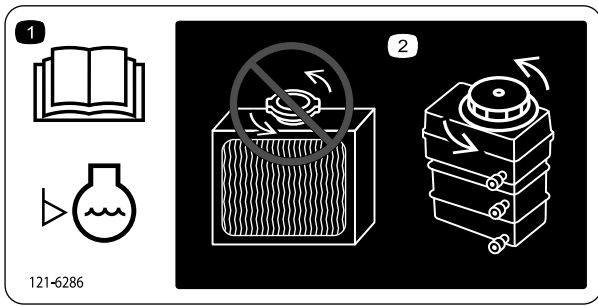

121-6286

decal121-6286

**121-6286**

1. The coolant level must be checked daily before use. Read the *Operator's Manual* before checking the engine-coolant level.
2. Do not open or add coolant to the radiator; doing so introduces air into the system and results in engine damage. Add only engine coolant to the reservoir.

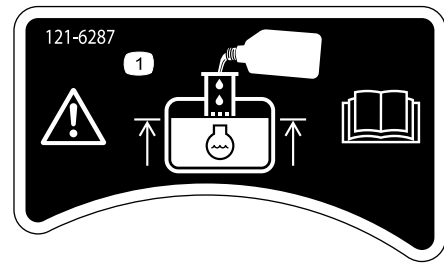

121-6287

decal121-6287

**121-6287**

1. Fill the reservoir with engine coolant to the bottom of the standpipe.



93-9852

decal93-9852

**93-9852**

1. Warning—read the *Operator's Manual*.
2. Crushing hazard—install the cylinder lock.



115-2282

decal115-2282

**115-2282**

1. Warning—read the *Operator's Manual*.
2. Warning—stay away from moving parts, keep all guards and shields in place.
3. Crushing/dismemberment hazard of bystanders—keep bystanders a safe distance away from the machine, do not carry passengers in the cargo bed, keep arms and legs inside of the machine at all times, and use seat belts and handholds.

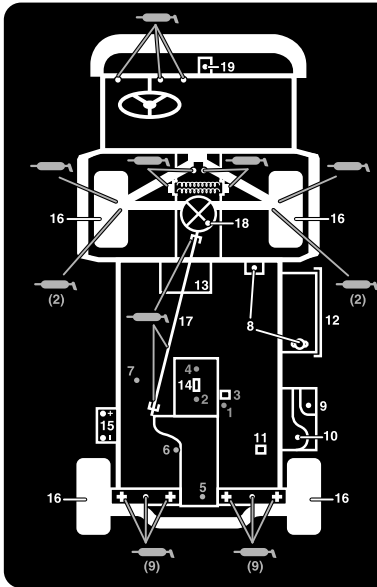

# WORKMAN QUICK REFERENCE AID



## CHECK/SERVICE

1. ENGINE OIL DIP STICK
2. ENGINE OIL DRAIN
3. ENGINE OIL FILTER
4. ENGINE OIL FILL
5. HYDRAULIC OIL DIP STICK
6. HYDRAULIC OIL STRAINER
7. HYDRAULIC OIL FILTER
8. COOLANT FILL
9. FUEL
10. FUEL PUMP/FILTER (EFI ONLY)
11. FUEL FILTER/WATER SEPARATOR (AC GAS & DIESEL)
12. RADIATOR SCREEN
13. AIR FILTER (LCG & DIESEL)
14. AIR FILTER (AC GAS ONLY)
15. BATTERY
16. TIRE PRESSURE -  
32 PSI MAX FRONT, 18 PSI MAX REAR
17. 4WD SHAFT (4WD ONLY)
18. FRONT DIFFERENTIAL FILL (4WD ONLY)
19. BRAKE FLUID

➔ GREASE POINTS (100 HRS)

## FLUID SPECIFICATIONS/CHANGE INTERVALS

SEE OPERATOR'S MANUAL FOR INITIAL CHANGES	FLUID TYPE	CAPACITY		CHANGE INTERVALS	
		L	QT	FLUID	FILTER
ENGINE OIL LCG ONLY	SEE MANUAL	3.3	3.5	200 HRS.	200 HRS.
ENGINE OIL LCD ONLY		3.3	3.5	150 HRS.	150 HRS.
ENGINE OIL AC ONLY		1.9	2	100 HRS.	100 HRS.
TRANS/HYDRAULIC OIL	DEXRON III ATF	7.1	7.5	800 HRS.	800 HRS.
AIR CLEANER					100 HRS.
FUEL	SEE MANUAL	24.6	6.5 GAL	--	400 HRS.
FUEL PUMP	--	--	--	--	400 HRS.
COOLANT 50/50 ETHYLENE GLYCOL WATER	--	3.5	3.7	1200 HRS.	--
TRANS AXLE STRAINER	--	--	--	CLEAN 800 HRS.	
DIFFERENTIAL OIL	MOBILE 424	0.25	0.26	800 HRS.	--

FOR HEAVY DUTY OPERATION, MAINTENANCE SHOULD BE PERFORMED TWICE AS FREQUENTLY.

115-7814

115-7814

decal115-7814

# Setup

## Loose Parts

Use the chart below to verify that all parts have been shipped.

Procedure	Description	Qty.	Use
<b>1</b>	Steering wheel	1	Install the steering wheel (TC models only).
<b>2</b>	ROPS frame Bolt (1/2 inch)	1 6	Mount the Rollover-Protection System (ROPS).
<b>3</b>	No parts required	–	Check the engine oil, the transaxle/hydraulic fluid, and the brake-fluid levels.
<b>4</b>	No parts required	–	Adjust the ball switch.
<b>5</b>	No parts required	–	Burnish (break-in) the brakes.

**Note:** Determine the left and right side of the machine from the normal operating position.

# 1

## Installing the Steering Wheel

Parts needed for this procedure:

1	Steering wheel
---	----------------

## Procedure

1. Release the tabs on the back of the steering wheel that hold the center cover in place, and remove the cover from the hub of the steering wheel.
2. Remove the locknut and washer from the steering shaft.
3. Slide the steering wheel and washer onto the shaft.

**Note:** Align the steering wheel on the shaft so that the cross beam is horizontal when the tires are pointed straight ahead and the thicker spoke of the steering wheel is downward.

4. Secure the steering wheel to the shaft with the locknut and torque the locknut to 24 to 29 N·m (18 to 22 ft-lb) as shown in [Figure 3](#).

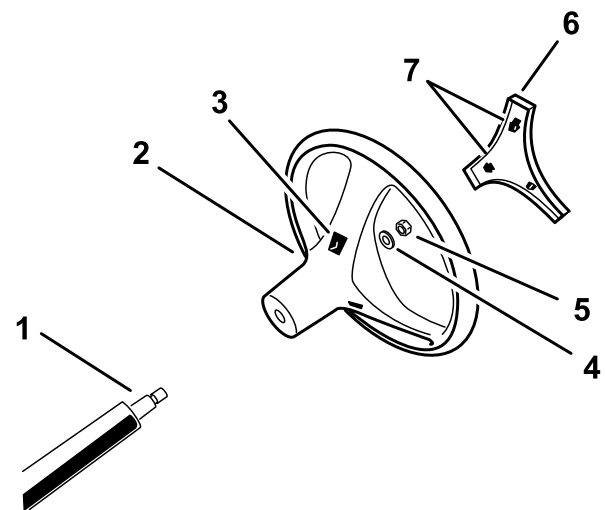

**Figure 3**

g20/5931

- |                       |                  |
|-----------------------|------------------|
| 1. Steering shaft     | 5. Locknut       |
| 2. Steering wheel     | 6. Cover         |
| 3. Tab slots in wheel | 7. Tabs in cover |
| 4. Washer             |                  |

5. Align the tabs of the cover with the slots in the steering wheel, and snap the cover onto the steering-wheel hub ([Figure 3](#)).

# 2

## Installing the Rollover-Protection System (ROPS)

Parts needed for this procedure:

1	ROPS frame
6	Bolt (1/2 inch)

### Procedure

1. Align each side of the ROPS with the mounting holes in the frame at each side of the machine as shown in [Figure 4](#).

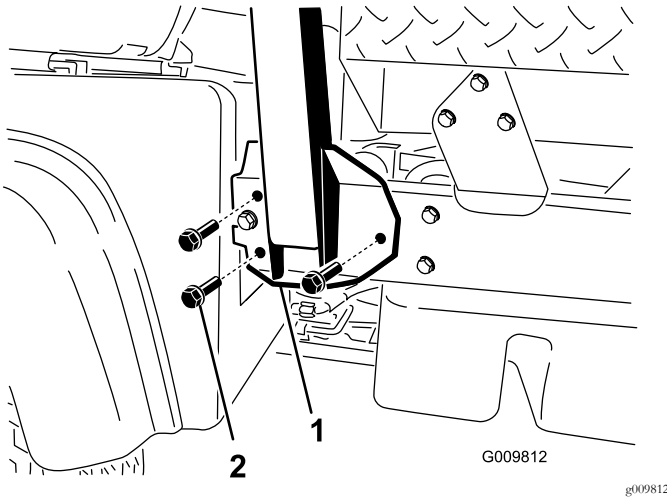

Figure 4

1. ROPS-mounting bracket
2. Flanged bolts (1/2 x 1-1/4 inches)

2. Secure each side of the ROPS to frame with 3 flanged bolts (1/2 x 1-1/4 inches) and tighten the bolts to 115 N·m (85 ft-lb).

# 3

## Checking the Fluid Levels

No Parts Required

### Procedure

1. Check the engine-oil level before and after the engine is first started; refer to [Checking the Engine-Oil Level \(page 22\)](#).
2. Check the transaxle/hydraulic-fluid level before the engine is first started; refer to [Checking the Transaxle/Hydraulic-Fluid Level \(page 25\)](#).
3. Check the brake-fluid level before the engine is first started; refer to [Checking the Brake-Fluid Level \(page 28\)](#).

# 4

## Adjusting the Ball Switch

No Parts Required

### Procedure

1. Move the shift lever to the NEUTRAL position.
2. Ensure that the ball switch is in front of the bump on the shift lever (Figure 5).

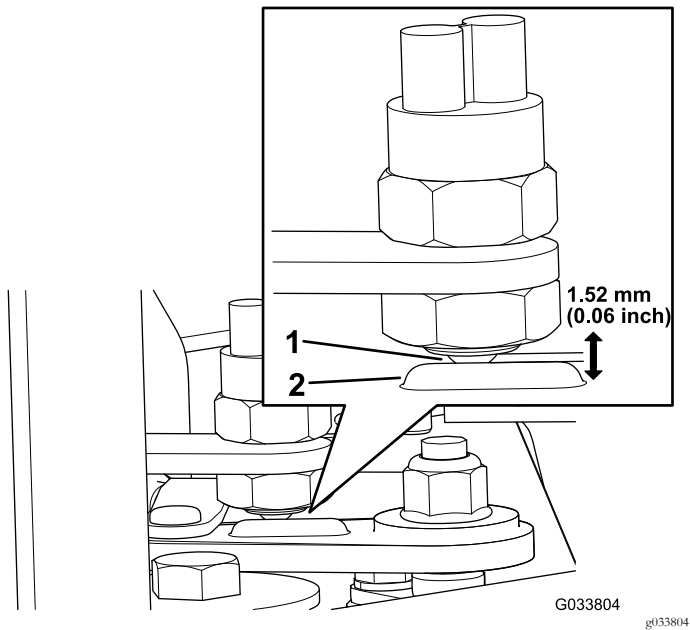

Figure 5

1. Ball switch location—note that the ball switch is in front of the bump.
  2. Bump on the shift lever
- 
3. Adjust the depth of the ball switch to 1.52 mm (0.06 inch) clearance between the bump of the shift lever and the face of the ball switch (Figure 5).
  4. Install a continuity-reading device (VOM or test light) across the ball-switch terminals.
  5. Shift the vehicle between the FIRST and REVERSE positions.

**Note:** The ball switch only has continuity momentarily when switching from neutral to reverse.

# 5

## Burnishing the Brakes

No Parts Required

### Procedure

To ensure optimum performance of the brake system, burnish (break-in) the brakes before use.

1. Bring the machine up to full speed, apply the brakes to rapidly stop the machine without locking up the tires.
2. Repeat this procedure 10 times, waiting 1 minute between stops, to avoid overheating the brakes.

**Important:** This procedure is most effective if the machine is loaded with 454 kg (1,000 lb).



# Product Overview

## Controls

**Note:** Determine the left and right sides of the machine from the normal operating position.

### Accelerator Pedal

The accelerator pedal (Figure 6) gives the operator the ability to vary the engine and ground speed of the machine when the transmission is in gear. Pressing the pedal increases the engine speed and ground speed. Releasing the pedal decreases the engine speed and ground speed of the machine.

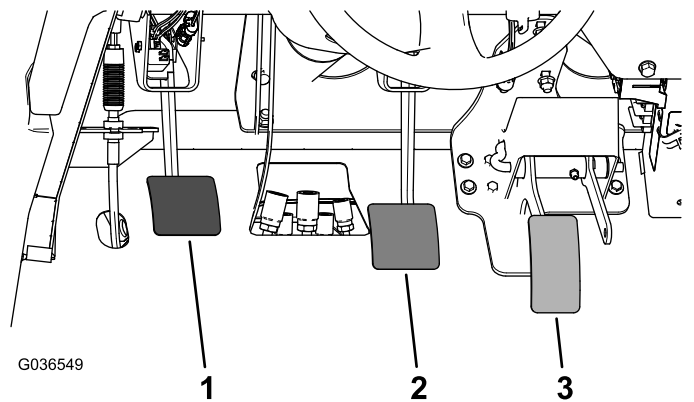

Figure 6

1. Clutch pedal
2. Brake pedal
3. Accelerator pedal

### Clutch Pedal

You must fully press the clutch pedal (Figure 6) to disengage the clutch when starting the engine or shifting transmission gears. Release the pedal smoothly when the transmission is in gear to prevent unnecessary wear on the transmission and other related parts.

**Important:** Do not ride the clutch pedal during operation. The clutch pedal must be fully out or the clutch slips, causing heat and wear. Never hold the machine stopped on a hill using the clutch pedal. Damage to the clutch may occur.

### Brake Pedal

Use the brake pedal (Figure 6) to apply the service brakes to stop or slow the machine.

## ⚠ CAUTION

Worn or maladjusted brakes may result in personal injury.

If the brake pedal travels to within 3.8 cm (1-1/2 inches) of the machine floor board, the brakes must be adjusted or repaired.

### Gear-Shift Lever

Fully press the clutch pedal and move the shift lever (Figure 7) into the desired gear selection. A diagram of the shift pattern is shown below.

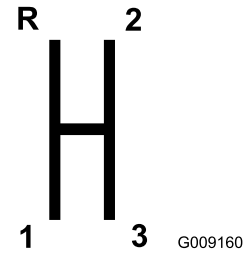

Figure 7

**Important:** Do not shift the transaxle to the reverse or forward gear unless the machine is standing still. Damage to the transaxle may occur.

## ⚠ CAUTION

Down shifting from too high a speed can cause the rear wheels to skid, resulting in loss of machine control as well as clutch and/or transmission damage.

Shift smoothly to avoid grinding gears.

### Differential Lock

The differential lock allows the rear axle to lock for increased traction. You can engage the differential lock when the machine is in motion (Figure 8). Move the lever forward and to the right to engage the lock.

**Note:** Machine motion plus a slight turn is required to engage or disengage the differential lock.

## ⚠ CAUTION

Turning with the differential lock on can result in the loss of machine control.

Do not operate the machine with the differential lock on when making sharp turns or at high speeds; refer to [Using the Differential Lock \(page 32\)](#).

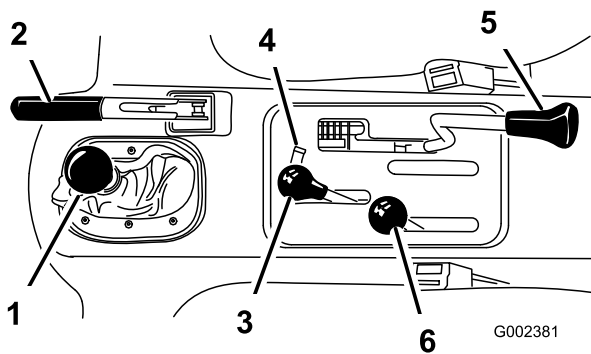

**Figure 8**

- |                       |                           |
|-----------------------|---------------------------|
| 1. Gear-shift lever   | 4. Hydraulic-lift lock    |
| 2. Parking brake      | 5. Differential lock      |
| 3. Hydraulic-bed lift | 6. High-low range shifter |

## Parking Brake

Whenever the engine is shut off, engage the parking brake (Figure 8) in order to prevent the machine from accidentally moving.

- To engage the parking brake, pull back on the lever.
- To disengage, push the lever forward.

**Note:** Disengage the parking brake before moving the machine.

If you park the machine on a steep grade, engage the parking brake, shift the transmission into first gear on a uphill grade or reverse gear on a down hill grade, and place chocks at the downhill side of the wheels.

## Hydraulic Lift

The hydraulic lift raises and lowers the bed. Move it rearward to raise the bed, and forward to lower it (Figure 8).

**Important:** When lowering the bed, hold the lever in the forward position for 1 or 2 seconds after the bed contacts the frame to secure it in the lowered position. Do not hold the hydraulic lift in either the raise or lower position, for more than 5 seconds, once the cylinders have reached the end of their travel.

## Hydraulic-Lift Lock

The hydraulic-lift lock locks the lift lever, so the hydraulic cylinders do not operate when the machine is not equipped with a bed (Figure 8). It also locks the lift lever in the ON position when using the hydraulics for attachments.

## High-Low Range Shifter

The high-low range shifter adds 3 additional speeds for precise speed control (Figure 8):

- The machine must be completely stopped before shifting between the HIGH and LOW range.
- Shift only on level ground.
- Press the clutch pedal fully.
- Move the lever fully forward for HIGH and fully rearward for LOW.

High is for higher speed driving on level, dry surfaces with light loads.

Low is for low-speed driving. Use this range when greater than normal power or control is required. For example, steep grades, difficult terrain, heavy loads, slow speed but high-engine speed (spraying).

**Important:** There is a location between HIGH and LOW in which the transaxle is in neither range. Do not use this position as a NEUTRAL position because the machine could move unexpectedly if the High-Low shifter is bumped and the gear-shift lever is in gear.

## Key Switch

Use the key switch (Figure 9) to start and shut off the engine. It has 3 positions: OFF, ON, and START. Rotate the key clockwise to the START position to engage the starter motor. Release the key when the engine starts. The key moves automatically to the ON position. To shut off the engine, rotate the key counterclockwise to the OFF position.

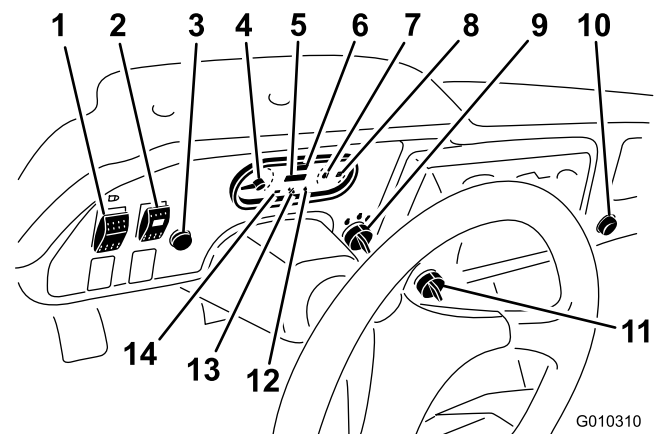

**Figure 9**

- |   |                                |
|---|--------------------------------|
| 1. Light switch                                 | 8. Fuel gauge                  |
| 2. High-flow-hydraulics switch (TC models only) | 9. Key switch                  |
| 3. Horn (TC models only)                        | 10. Power point                |
| 4. Tachometer                                   | 11. Third-high-lockout switch  |
| 5. Hour meter                                   | 12. Oil-pressure-warning light |
| 6. Speedometer                                  | 13. Glow-plug indicator        |
| 7. Coolant-temperature gauge and light          | 14. Charge indicator           |

## Hour Meter

The hour meter indicates the total hours of machine operation. The hour meter (Figure 9) starts to function whenever you rotate the key switch to the ON position or if the engine is running.

## Third-High-Lockout Switch

Move the third-high-lockout switch (Figure 9) to the SLOW position and remove the key to prevent the use of third gear when in the HIGH range. The engine shuts off if the shift lever moves to third gear when in HIGH range.

**Note:** The key is removable in either position.

## Light Switch

Push the light switch (Figure 9) to toggle the headlights on or off.

## Oil-Pressure-Warning Light

The oil-pressure-warning light glows (Figure 9) if the engine-oil pressure drops below a safe level while the engine is running. If the light flickers or remains on, stop the machine, shut off the engine, and check the oil level. If the oil level is low, but adding oil does not cause the light to go out when the engine is started, shut off the engine immediately and contact your local Toro distributor for assistance.

Check the operation of warning lights as follows:

1. Engage the parking brake.
2. Turn the key switch to the ON/PREHEAT position, but do not start the engine.

**Note:** The oil-pressure light should glow red. If the light does not function, either a bulb is burned out or there is a malfunction in the system which must be repaired.

**Note:** If engine was just turned off, it may take 1 to 2 minutes for the light to come on.

## Glow-Plug Indicator

The glow-plug indicator (Figure 9) glows red when the glow plugs are activated.

**Important:** The glow-plug indicator turns on for an additional 15 seconds when the switch returns to the START position.

## Coolant-Temperature Gauge and Light

The gauge and light registers the coolant temperature in the engine and operates only when the key switch is in ON

position (Figure 9). The indicator light blinks red if the engine overheats.

## Charge Indicator

The charge indicator illuminates when the battery is discharging. If the light illuminates during operation, stop the machine, shut off the engine, and check for possible causes, such as the alternator belt (Figure 9).

**Important:** If the alternator belt is loose or broken, do not operate the machine until the adjustment or repair is complete. Failure to observe this precaution may damage the engine.

Check the operation of the warning lights as follows:

- Engage the parking brake.
- Turn the key switch to the ON/PREHEAT position, but do not start the engine. The coolant temperature, charge indicator, and oil-pressure lights should glow. If any light does not function, either a bulb is burned out or there is a malfunction in the system that you must repair.

## Fuel Gauge

The fuel gauge shows the amount of fuel in the tank. It operates only when key switch is in the ON position (Figure 9). Red indicates low fuel level and blinking red indicates near empty.

## High-Flow-Hydraulics Switch

### TC Models Only

Turn on the switch to activate the high-flow hydraulics (Figure 9).

## Horn Button

### TC Models Only

Pressing the horn button activates the horn (Figure 9).

## Tachometer

Registers the speed of the engine (Figure 9 and Figure 10). The white triangle indicates 540 rpm for PTO operation (Figure 10).

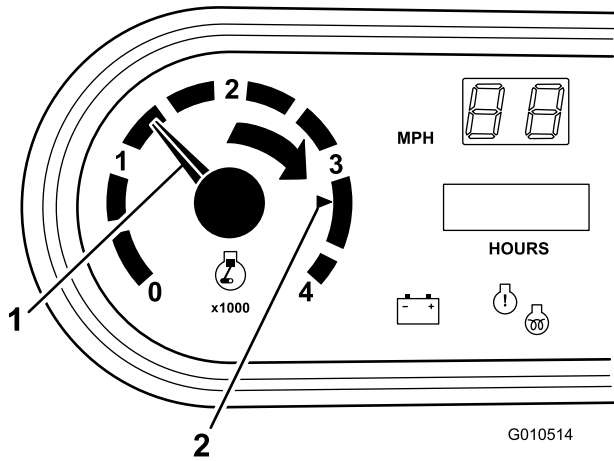

Figure 10

1. Speed of the engine
2. 3,300 rpm for 540 rpm PTO operation

## Passenger Handhold

The passenger handhold is located on the dashboard (Figure 11).

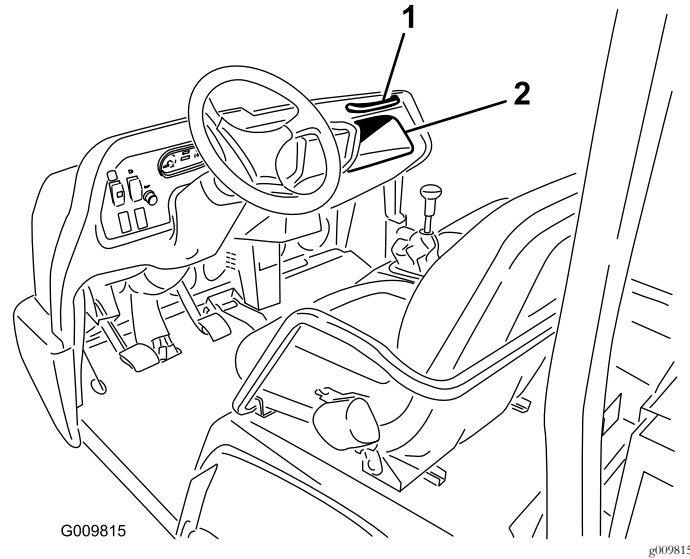

Figure 11

1. Passenger handhold
2. Storage compartment

## Speedometer

The speedometer registers the ground speed of the machine (Figure 9). It displays mph but can easily be converted to km/h; refer to [Converting the Speedometer](#) (page 55).

## Power Point

Use the power point (Figure 9) to power optional 12 V electrical accessories.

## Seat-Adjustment Lever

You can adjust the seat forward and rearward for your comfort (Figure 12).

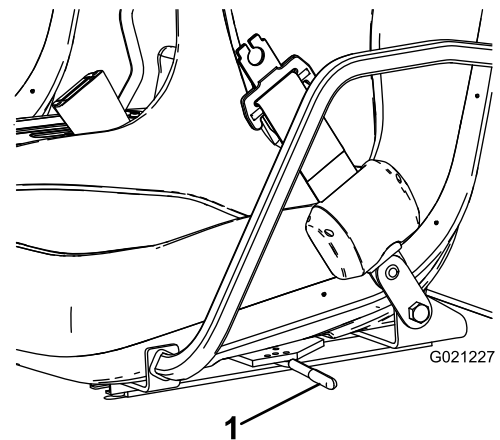

Figure 12

1. Seat-adjustment lever

# Specifications

**Note:** Specifications and design are subject to change without notice.

## Dimensions

<b>Overall Width</b>	160 cm (63 inches)
<b>Overall Length</b>	Without bed: 326 cm (128 inches)
	With full bed: 331 cm (130 inches)
	With 2/3 bed in rear-mounting location: 346 cm (136 inches)
<b>Base Weight (Dry)</b>	Model 07385—887 kg (1,956 lb)
	Model 07385H—887 kg (1,956 lb)
	Model 07385TC—924 kg (2,037 lb)
	Model 07387—914 kg (2,015 lb)
	Model 07387H—914 kg (2,015 lb)
	Model 07387TC—951 kg (2,096 lb)
<b>Rated Capacity (includes 91 kg (200 lb) operator, 91 kg (200 lb) passenger and loaded attachment)</b>	Model 07385—1471 kg (3,244 lb)
	Model 07385TC—1435 kg (3,163 lb)
	Model 07387—1445 kg (3,185 lb)
	Model 07387TC—1408 kg (3,104 lb)
<b>Maximum Gross Vehicle Weight</b>	2359 kg (5,200 lb)
<b>Tow Capacity</b>	Tongue weight: 272 kg (600 lb)
	Maximum trailer weight: 1587 kg (3,500 lb)
<b>Ground Clearance</b>	18 cm (7 inches) with no load
<b>Wheel Base</b>	118 cm (70 inches)
<b>Wheel Tread (center line to center line)</b>	Front: 117 cm (46 inches)
	Rear: 121 cm (48 inches)
<b>Height</b>	191 cm (75 inches) to the top of the roll bar

## Attachments/Accessories

A selection of Toro approved attachments and accessories is available for use with the machine to enhance and expand its capabilities. Contact your Authorized Service Dealer or Distributor or go to [www.Toro.com](http://www.Toro.com) for a list of all approved attachments and accessories.

# Operation

**Note:** Determine the left and right sides of the machine from the normal operating position.

## ⚠ CAUTION

A raised bed full of material without the proper safety support may lower unexpectedly. Working under an unsupported raised bed may cause injury to you or others.

- Before servicing or making adjustments to the machine, park the machine on a level surface, engage the parking brake, shut off the engine, and remove the key.
- Remove any load material from the bed or other attachment and insert the safety support on a fully extended cylinder rod before working under a raised bed.

## Operating the Cargo Box

**Note:** If possible, center loads in the cargo box.

**Note:** Remove all cargo from the box before lifting the box up to service the machine.

## Raising the Cargo Box

### ⚠ WARNING

Driving the machine with the cargo box raised may cause the machine to tip or roll easier. The box structure may become damaged if you operate the machine with the box raised.

- Operate the machine only when the cargo box is down.
- After emptying the cargo box, lower it.

Move the lever rearward to raise the cargo box (Figure 13).



**Note:** The best time to check the engine oil is when the engine is cool before it has been started for the day. If it has already ran, allow the oil to drain back down to the sump for at least 10 minutes before checking. If the oil level is at or below the Add mark on the dipstick, add oil to bring the oil level to the Full mark. **Do not overfill the engine with oil.** If the oil level is between the Full and Add marks, no additional oil is required.

1. Position the machine on a level surface.
2. Remove the dipstick and wipe it with a clean rag (Figure 16).

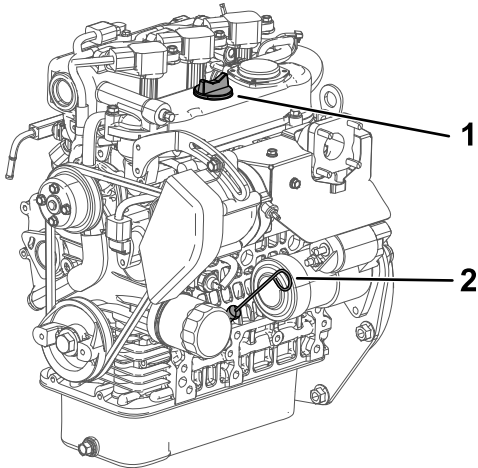
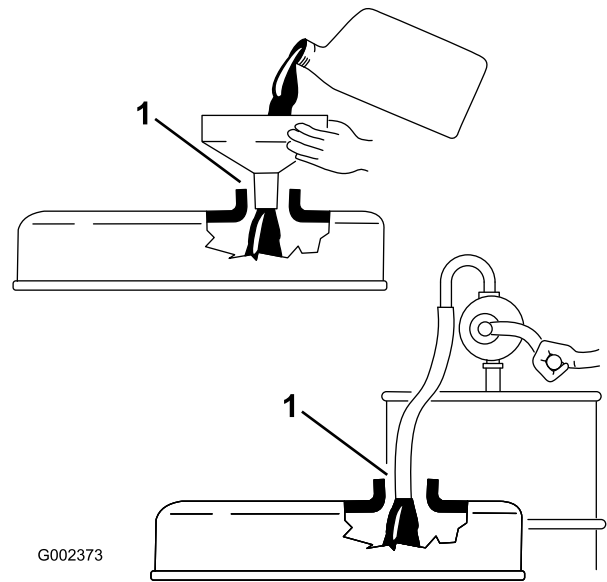

**Figure 16**

1. Filler cap
2. Dipstick

g028637

g028637



**Figure 17**

g002373

1. Note clearance

6. Install the dipstick firmly in place (Figure 16).

3. Insert the dipstick into the tube and make sure that it is seated fully (Figure 16).
4. Remove dipstick and check the level of the oil (Figure 16).
5. If the oil level is low, remove the filler cap (Figure 16), and add enough oil to raise the level to the Full mark on the dipstick.

**Note:** When adding oil, remove dipstick to allow proper venting. Pour the oil slowly and check the level often during this process. **Do not overfill the engine with oil.**

**Important:** When adding engine oil or filling oil, there must be clearance between the oil fill device and the oil fill hole in the valve cover as shown in Figure 17. This clearance is necessary to permit venting when filling, which prevents oil from overrunning into the breather.

# Adding Fuel

**Fuel-tank capacity:** 22 L (5.85 US gallons).

Use only clean, fresh diesel fuel or biodiesel fuels with low (<500 ppm) or ultra-low (<15 ppm) sulfur content. The minimum cetane rating should be 40. Purchase fuel in quantities that can be used within 180 days to ensure fuel freshness.

- Use summer grade diesel fuel (No. 2-D) at temperatures above -7°C (20°F) and winter grade (No. 1-D or No. 1-D/2-D blend) below that temperature.
- Using winter-grade fuel at lower temperatures provides lower flash point and cold-flow characteristics, which eases starting and reduces fuel filter plugging.

**Note:** Using of summer-grade fuel above -7°C (20°F) contributes toward longer fuel pump life and increased power compared to winter-grade fuel.

**Important:** Do not use kerosene or gasoline instead of diesel fuel. Failure to observe this caution will damage the engine.

## ⚠ WARNING

Fuel is harmful or fatal if swallowed. Long-term exposure to vapors can cause serious injury and illness.

- Avoid prolonged breathing of vapors.
- Keep your face away from the nozzle and fuel tank or conditioner opening.
- Keep fuel away from your eyes and skin.

## ⚠ DANGER

Under certain conditions, diesel fuel and fuel vapors are highly flammable and explosive. A fire or explosion from fuel can burn you and others and can cause property damage.

- Before removing the fuel tank cap, make sure that the machine is positioned on a level surface. Open fuel tank cap slowly.
- Use a funnel and fill the fuel tank outdoors, in an open area, when the engine is off and is cold. Wipe up any fuel that spills.
- Do not fill the fuel tank completely full. Add fuel to the fuel tank until the level is 25 mm (1 inch) below the bottom of the filler neck. This empty space in the tank allows the fuel to expand.
- Never smoke when handling fuel, and stay away from an open flame or where fuel fumes may be ignited by a spark.
- Store fuel in a clean, safety-approved container and keep the cap in place.

# Using Biodiesel Fuel

This machine can also use a biodiesel blended fuel of up to B20 (20% biodiesel, 80% petrodiesel). The petrodiesel portion should be low or ultra low sulfur. Observe the following precautions:

- The biodiesel portion of the fuel must meet specification ASTM D6751 or EN14214.
  - The blended fuel composition should meet ASTM D975 or EN590.
  - Painted surfaces may be damaged by biodiesel blends.
  - Use B5 (biodiesel content of 5%) or lesser blends in cold weather.
  - Monitor seals, hoses, gaskets in contact with fuel as they may be degraded over time.
  - Fuel filter plugging may be expected for a time after converting to biodiesel blends.
  - Contact your distributor if you wish for more information on biodiesel.
1. Clean the area around the fuel-tank cap.
  2. Remove the fuel-tank cap (Figure 18).

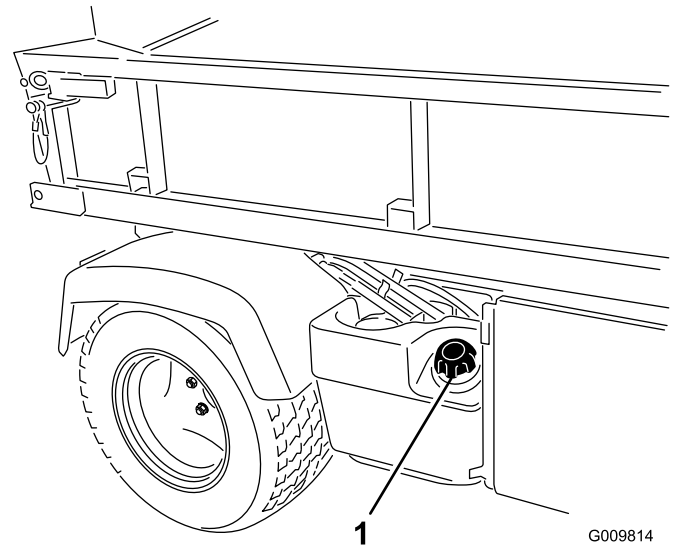

**Figure 18**

1. Fuel-tank cap
- 
3. Fill the tank slightly below the top of the tank, (bottom of the filler neck), then install the cap.
- Note:** Do not overfill the fuel tank with fuel.
4. Wipe up any fuel that may have spilled to prevent a fire hazard.



# Checking the Coolant Level

**Service Interval:** Before each use or daily

**Cooling system capacity:** 3.7 L (4 US qt)

**Coolant type:** a 50/50 solution of water and permanent ethylene-glycol antifreeze.

## ⚠ CAUTION

If the engine has been running, the pressurized, hot coolant can escape and cause burns.

- Do not open the radiator cap.
- Allow the engine to cool at least 15 minutes or until the reserve tank is cool enough to touch without burning your hand.
- Use a rag when opening the reserve-tank cap, and open the cap slowly to allow steam to escape.
- Do not check the coolant level at the radiator; only check the coolant level at the reserve tank.

1. Park the machine on a level surface.
2. Check the coolant level inside the reserve tank (Figure 19).

**Note:** The coolant should be up to the bottom of the filler neck when the engine is cold.

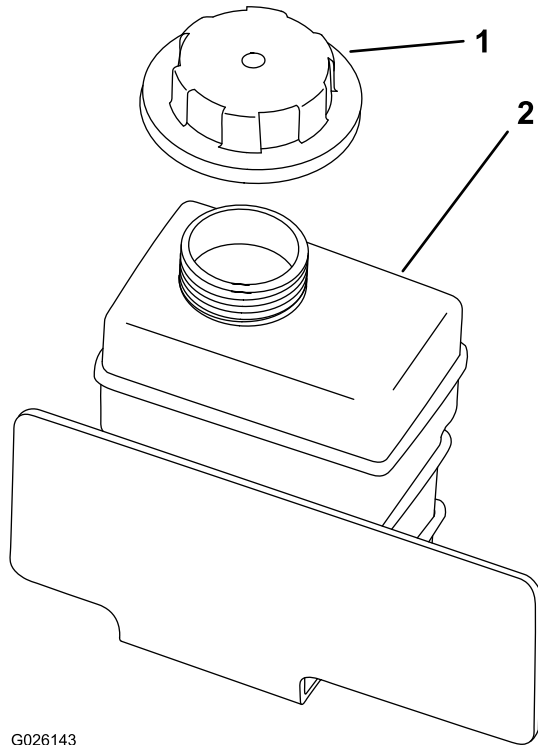

**Figure 19**

1. Reserve-tank cap
2. Reserve tank

3. If the coolant is low, remove the reserve tank cap and add a 50/50 mixture of water and permanent ethylene-glycol antifreeze.

**Note:** Do not overfill the reserve tank with coolant.

4. Install the reserve-tank cap.

# Checking the Transaxle/Hydraulic-Fluid Level

**Service Interval:** Before each use or daily (check the fluid level before the engine is first started and every 8 hours or daily, thereafter.)

**Transaxle fluid type:** Dexron III ATF

1. Position the machine on a level surface.
2. Clean the area around the dipstick (Figure 20).

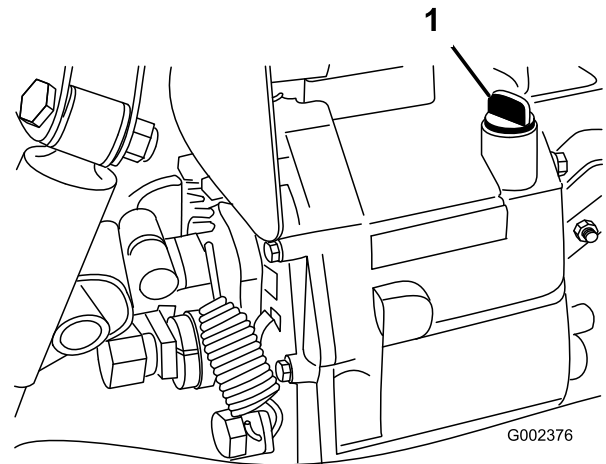

**Figure 20**

1. Dipstick

3. Unscrew the dipstick from the top of the transaxle and wipe it with a clean rag.
4. Screw the dipstick into the transaxle and ensure that it is fully seated.
5. Unscrew the dipstick and check the fluid level.

**Note:** The fluid should be up to top of the flat portion of the dipstick.

6. If the level is low, add enough of the specified fluid to achieve the proper level.

# Checking the High Flow Hydraulic-Fluid Level

## TC Models Only

**Service Interval:** Before each use or daily (check the level of hydraulic fluid before the engine is first started, and daily thereafter).

**Hydraulic-fluid type: Toro Premium All Season Hydraulic Fluid** (Available in 5-gallon pails or 55-gallon drums. See parts catalog or Toro distributor for part numbers.)

**Alternate fluids:** If the Toro fluid is not available, another conventional petroleum-based fluid may be used provided it meets the following material properties and industry specifications. Consult with your lubricant distributor to identify a satisfactory product.

**Note:** Toro will not assume responsibility for damage caused by improper substitutions, so use only products from reputable manufacturers who will stand behind their recommendation.

**High Viscosity Index/Low Pour Point Antiwear Hydraulic Fluid, ISO VG 46**

### Material Properties:

- Viscosity—ASTM D445 cSt @ 40°C: 44 to 48/cSt @ 100°C: 7.9 to 8.5
- Viscosity Index, ASTM D2270—140 to 152
- Pour Point, ASTM D97— -35°F to -46°F
- FZG, Fail stage—11 or better
- Water content (new fluid)—500 ppm (maximum)

### Industry Specifications:

Vickers I-286-S, Vickers M-2950-S, Denison HF-0, Vickers 35 VQ 25 (Eaton ATS373-C)

1. Clean the area around the filler neck and the cap of the hydraulic tank (Figure 21).
2. Remove the cap from the filler neck.

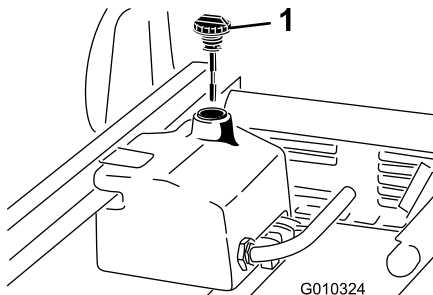

Figure 21

1. Cap

3. Remove the dipstick (Figure 21) from the filler neck and wipe it with a clean rag.
4. Insert the dipstick into the filler neck, then remove it and check the fluid level.

**Note:** The fluid level should be between the 2 marks on the dipstick.

5. If the level is low, add the appropriate fluid to raise the level to the upper mark; refer to [Changing the High-Flow Hydraulic Fluid and Filter](#) (page 57).
6. Install the dipstick and cap onto the filler neck.
7. Start the engine and turn on the attachment.

**Note:** Let them run for about 2 minutes to purge air from the system.

**Important:** The machine must be running before starting the high-flow hydraulics.

8. Shut off the engine and attachment and check for leaks.

## ▲ WARNING

Hydraulic fluid escaping under pressure can penetrate skin and cause injury.

- Make sure that all hydraulic fluid hoses and lines are in good condition and all hydraulic connections and fittings are tight before applying pressure to the hydraulic system.
- Keep your body and hands away from pin hole leaks or nozzles that eject high-pressure hydraulic fluid.
- Use cardboard or paper to find hydraulic leaks.
- Safely relieve all pressure in the hydraulic system before performing any work on the hydraulic system.
- Seek immediate medical attention if fluid is injected into your skin.

# Checking the Front-Differential-Oil Level

## 4-Wheel-Drive Models Only

**Service Interval:** Every 100 hours/Monthly (whichever comes first)

**Differential-oil type:** Mobil 424 hydraulic fluid

1. Position the machine on a level surface.
2. Clean the area around the fill/check plug on side of the differential (Figure 22).

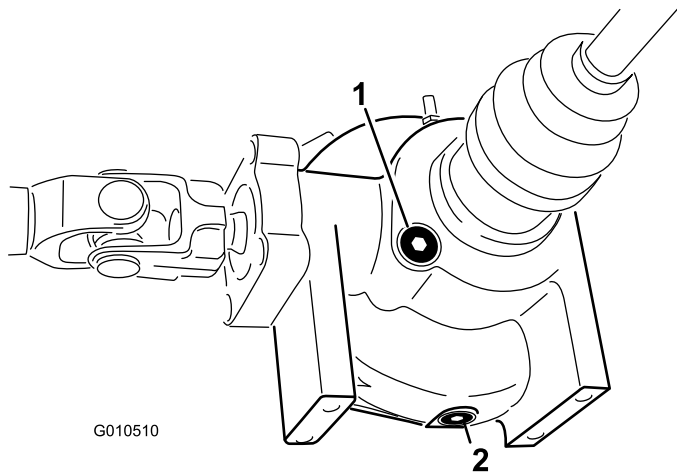

**Figure 22**

1. Fill/check plug
2. Drain plug

3. Remove the fill/check plug and check the level of the oil.

**Note:** The oil should be up to hole.

4. If the oil is low, add specified oil.
5. Install the fill/check plug.

# Checking the Torque of the Wheel Nuts

**Service Interval:** After the first 2 hours

After the first 10 hours

Every 200 hours

## ⚠ WARNING

Failure to maintain proper torque of the wheel nuts could result in failure or loss of a wheel and may result in personal injury.

Torque the front and rear wheel nuts to 109 to 122 N·m (80 to 90 ft-lb) after 1 to 4 hours of operation and again after 10 hours of operation. Torque every 200 hours thereafter.

# Checking the Tire Pressure

**Service Interval:** Before each use or daily

The air pressure in the front tires should be 220 kPa (32 psi) and the rear tires should be 124 kPa (18 psi).

**Important:** Check the tire pressure frequently to ensure proper inflation. If the tires are not inflated to the correct pressure, the tires will wear prematurely and may cause 4-wheel drive to bind.

Figure 23 is an example of tire wear caused by under-inflation.

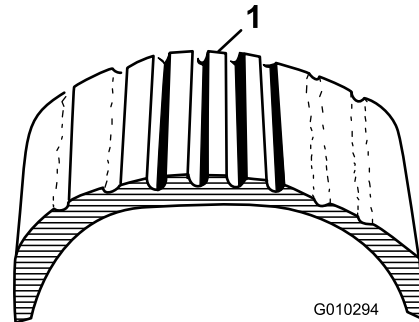

**Figure 23**

1. Under-inflated tire

Figure 24 is an example of tire wear caused by over inflation.

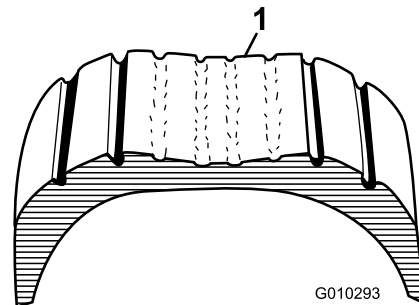

**Figure 24**

1. Over-inflated tire

# Checking the Brake-Fluid Level

**Service Interval:** Before each use or daily—Check the brake-fluid level. (Check the level before the engine is first started and every 8 hours or daily, thereafter.)

Every 1,000 hours/Every 2 years (whichever comes first)—Change the brake fluid.

**Brake fluid type:** DOT 3 brake fluid

The brake-fluid reservoir is located under the dash.

1. Park the machine on a level surface.
2. Ensure that the fluid level is up to the Full line on the reservoir (Figure 25).

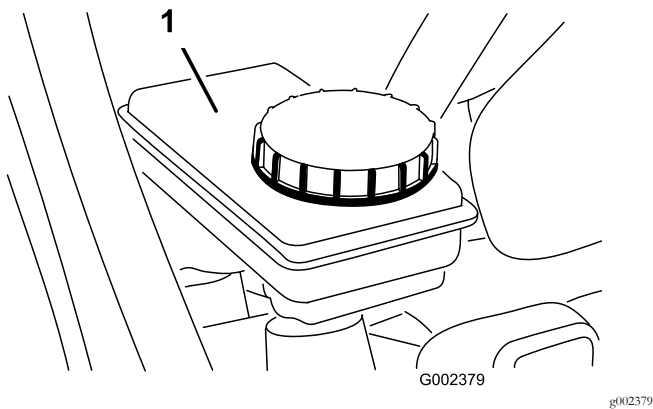

**Figure 25**

1. Brake-fluid reservoir

3. If the fluid level is low, clean the area around the cap, remove the reservoir cap, and fill the reservoir to the proper level with the specified brake fluid (Figure 25).

**Note:** Do not overfill the reservoir with brake fluid.

**Note:** You can remove the hood access to the reservoir from the front of the machine (Figure 26).

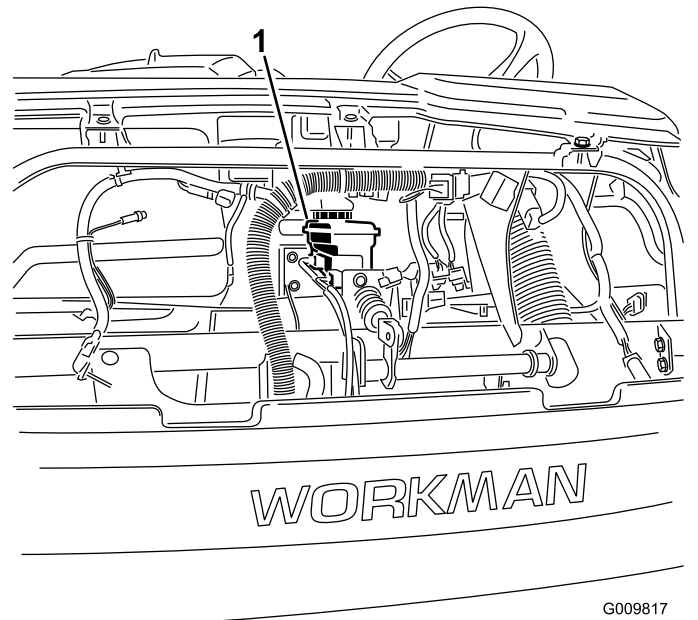

**Figure 26**

1. Brake-fluid reservoir

# Starting the Engine

1. Sit on the operator's seat and engage the parking brake.
2. Disengage the PTO and high-flow hydraulics (if equipped) and move the hand-throttle lever to the OFF position (if equipped).
3. Move the shift lever to the NEUTRAL position and press the clutch pedal.
4. Ensure that the hydraulic-lift lever is in the center position.
5. Keep your foot off the accelerator pedal.
6. Rotate the key switch to the ON position.

**Note:** When the glow-plug-indicator light turns on, the engine is ready to start.

7. Rotate the key switch to the START position.

**Note:** Release the key immediately when the engine starts and allow it to return to the RUN position.

**Note:** The glow-plug indicator turns on for an additional 15 seconds when the switch returns to the RUN position.

**Note:** Do not run the starter motor more than 10 seconds at a time or premature starter failure may result. If engine fails to start after 10 seconds, turn the key to the OFF position. Check the controls and starting procedure, wait 10 additional seconds, and repeat the starting operation.

# Driving the Machine

1. Disengage the parking brake.
2. Fully press the clutch pedal.
3. Move the gear-shift lever to first gear.
4. Release the clutch pedal smoothly while pressing the accelerator pedal.
5. When the machine gains enough speed, remove your foot from the accelerator pedal, fully press the clutch pedal, move the gear shift lever to the next gear and release the clutch pedal while pressing the accelerator pedal.
6. Repeat the procedure until the desired speed is attained.

**Important:** Always stop the machine before shifting to reverse a forward gear or to a forward gear from reverse.

**Note:** Avoid long periods of engine idling.

Use the chart below to determine the ground speed of the machine at 3,600 rpm.

Gear	Range	Ratio	Speed (kmh)	Speed (mph)
1	L	82.83 : 1	4.7	2.9
2	L	54.52 : 1	7.2	4.5
3	L	31.56 : 1	12.5	7.7
1	H	32.31 : 1	12.2	7.6
2	H	21.27 : 1	18.5	11.5
3	H	12.31 : 1	31.9	19.8
R	L	86.94 : 1	4.5	2.8
R	H	33.91 : 1	11.6	7.1

**Important:** Do not attempt to push or tow the machine to get it started. Damage to the drive train could result.

# Stopping the Machine

To stop the machine, remove your foot from the accelerator pedal, press the clutch pedal, then press the brake pedal.

# Shutting Off the Engine

To shut off the engine, rotate the key switch to the OFF position and engage the parking brake. Remove the key to prevent accidental starting.

# Breaking in a New Machine

To provide proper performance and long machine life, follow these guidelines for the first 100 operating hours.

- Ensure that the brakes are burnished; refer to [5 Burnishing the Brakes \(page 16\)](#).
- Check the fluid and engine-oil levels regularly and be alert for indications of overheating in any component of the machine.
- After starting a cold engine, let it warm up for about 15 seconds before shifting into gear.
- Avoid racing the engine.
- Vary the machine speed during operation. Avoid excessive idling. Avoid fast starts and quick stops.
- A break-in oil for the engine is not required. The original engine oil is the same type specified for regular oil changes.
- Refer to [Maintenance \(page 36\)](#) for any special low-hour checks.

# Checking the Safety-Interlock System

**Service Interval:** Before each use or daily

The purpose of the safety-interlock system is to prevent the engine from cranking or starting unless the clutch pedal is pressed.

## ⚠ CAUTION

If the safety-interlock switches are disconnected or damaged, the machine could operate unexpectedly causing personal injury.

- Do not tamper with the interlock switches.
- Check the operation of the interlock switches daily and replace any damaged switches before operating the machine.

**Note:** Refer to *Attachment Operator's Manual* for procedures on checking the attachment interlock system.

## Verifying the Clutch-Interlock Switch

1. Sit on the operator's seat and engage the parking brake.
2. Move the shift lever to the NEUTRAL position.

**Note:** The engine does not start if the hydraulic-lift lever is locked in the forward position.

3. Without pressing the clutch pedal, rotate the key switch clockwise to the START position.

**Note:** If the engine cranks or starts, there is a malfunction in the interlock system that must be repaired before operating the machine.

## Verifying the Hydraulic-Lift Lever Interlock Switch

1. Sit on the operator's seat and engage the parking brake.
2. Move the shift lever to the NEUTRAL position and ensure that the hydraulic-lift lever is in the center position.
3. Press clutch pedal.
4. Move the hydraulic-lift lever forward and rotate the key switch clockwise to the START position.

**Note:** If engine cranks or starts, there is a malfunction in the interlock system that must be repaired before operating the machine.

# Ensuring Passenger Safety

Whenever you have a passenger riding in the machine, make sure that he or she is wearing the seat belt and holding on securely. Drive slower and turn less sharply because your passenger does not know what you are going to do next and may not be prepared for turning, stopping, accelerating, and bumps.

You and your passenger should remain seated at all times, keeping arms and legs inside the machine. The operator should keep both hands on steering wheel, whenever possible, and the passenger should use the handholds provided (Figure 27 and Figure 28).

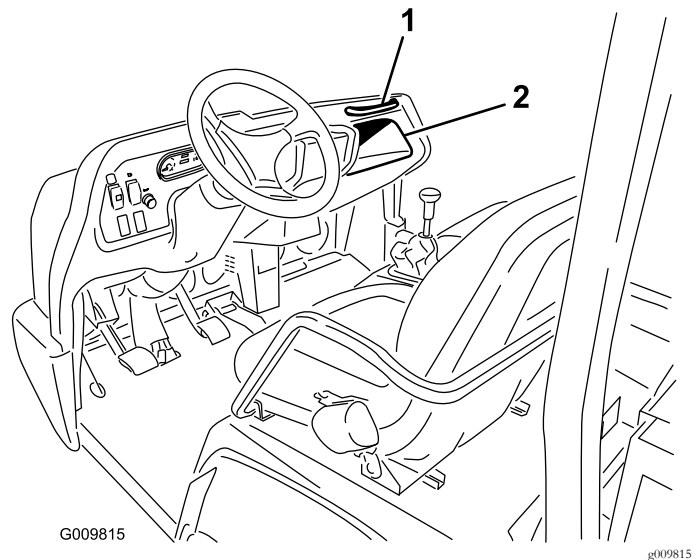

**Figure 27**

1. Passenger handhold
2. Storage compartment

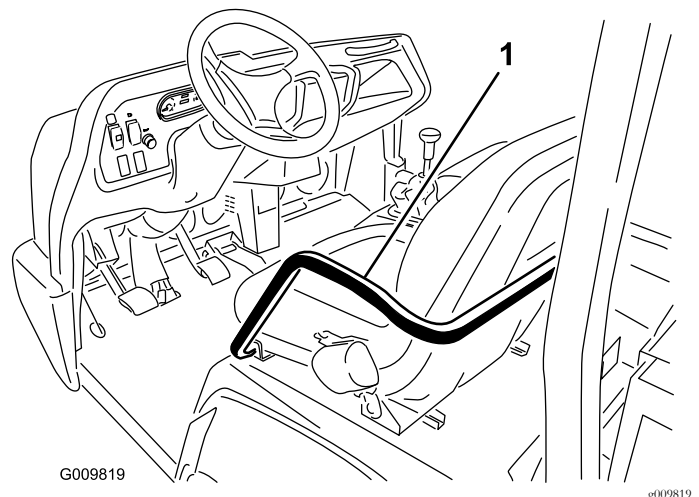

**Figure 28**

1. Handhold and hip restraint

Never allow passengers in the cargo box or on any attachments. The machine is meant to have 1 driver and only 1 passenger.

## Ensuring Proper Speed

Speed is an important variable leading to accidents. Driving too fast for the conditions can cause you to lose control and have an accident. Speed can also make a minor accident worse. Driving head on into a tree at slow speed can cause injury and damage, but, driving into a tree at high speed can destroy the machine and kill you and your passenger.

Never drive too fast for the conditions. If there is any doubt about how fast to drive, slow down.

When using heavy attachments, more than 454 kg (1,000 lb), such as sprayers, top dressers, or spreaders, etc., restrict your operating speed by moving the supervisor switch to the slow position.

## Ensuring Proper Turning

Turning is another important variable leading to accidents. Turning too sharply for the conditions can cause the machine to lose traction and skid, or even tip over.

Wet, sandy, and slippery surfaces make turning more difficult and risky. The faster you are going, the worse this situation becomes so, slow down before turning.

During a sharp turn at higher speeds, the inside rear wheel may lift off the ground. This is not a flaw in the design, it happens with most 4-wheel machine including passenger cars. If this happens, you are turning too sharply for the speed at which you are traveling.

## Ensuring Proper Braking

It is good practice to slow down before you get near an obstacle. This gives you extra time to stop or turn away. Hitting an obstacle can damage the machine and its contents. More important, it can injure you and your passenger. Gross machine weight has a major impact on your ability to stop and/or turn. Heavier loads and heavier attachments make a machine harder to stop or turn. The heavier the load, the longer it takes to stop.

The braking characteristics also change with no bed or attachment on the machine. Fast stops may cause the rear wheels to lock up before the front wheels lock up, which may affect the control of the machine. It is a good idea to decrease machine speed with no bed or attachment.

Turf and pavement are much slipperier when they are wet. It can take 2 to 4 times as long to stop on wet surfaces as on dry surfaces.

If you drive through standing water deep enough to get the brakes wet, they will not work well until they are dry. After driving through water, you should test the brakes to make sure that they work properly. If they do not, drive slowly in first gear while putting light pressure on the brake pedal. This will dry the brakes out.

Do not downshift for braking on icy or slippery surfaces (wet grass) or while going down a hill because engine braking may cause skidding and loss of control. Shift to a lower gear before starting down a hill.

## Preventing Tip-Overs

The machine is equipped with a roll bar, hip restraints, seat belts, and handhold. The Rollover-Protection System (ROPS) used on the machine reduces the risk of serious or fatal injury in the unlikely event of a tip over, although the system cannot protect the operator from all possible injuries.

Replace a damaged ROPS; do not repair or revise. Any alteration of the ROPS must be approved by the manufacturer.

The best way to prevent accidents involving utility machine is through continuous supervision and training of operators and paying constant attention to the area where they are operating the machine.

The best way for operators to prevent serious injury or death to themselves or others is to familiarize themselves with the proper operation of the machine, to stay alert and to avoid actions or conditions which could result in an accident. In the event of a tip-over, the risk of serious injury or death is reduced if you are using the ROPS system and seat belts and following the instructions provided.

## Operating on Hills

### **⚠ WARNING**

**Tipping or rolling the machine on a hill could cause serious personal injury.**

- **Do not operate the machine on steep slopes.**
- **If engine stalls or you lose headway on a hill, never attempt to turn the machine around.**
- **Always back straight down a hill in reverse gear.**
- **Never back down in neutral or with the clutch depressed, using only the brakes.**
- **Never drive across a steep hill, always drive straight up or down.**
- **Avoid turning on a hill.**
- **Do not “drop the clutch” or slam on the brakes. Sudden speed change can initiate a tip over.**

Use extra care when on hills. Never go on hills that are extremely steep. Stopping while going down a hill takes longer than on level ground. Turning while going up or down a hill is more dangerous than turning on the level. Turns while going downhill, especially with the brakes on, and turning uphill while traversing a hill are particularly dangerous. Even

at a slow speed and without a load, tip-overs are more likely if you turn on a hill.

Slow down and shift into a lower gear before starting up or down a hill. If you have to turn while on a hill, do it as slowly and cautiously as possible. Never make sharp or fast turns on a hill.

If you stall or begin to lose headway while climbing a steep hill, quickly apply the brakes, shift to neutral, start the engine and shift to reverse. At idle speed, the engine and transaxle drag aids the brakes in controlling the machine on the hill and help you back down the hill more safely.

Reduce the weight of the load if it is a steep hill or if the load has high center of gravity. Remember, loads can shift, secure them.

**Note:** The machine has excellent hill-climbing ability. The differential lock increases this ability. Hill climbing traction can also be increased by adding weight to the rear of the machine in one of the following ways:

- Adding weight to inside of box, making sure that it is secured.
- Mounting wheel weights to rear wheels.
- Adding liquid ballast (calcium chloride) to rear tires.
- Traction increases with no passenger in front seat.

## Loading and Dumping

The weight and position of the cargo and passenger can change the machine center of gravity and machine handling. To avoid loss of control resulting in personal injury, follow these guidelines.

Do not carry loads which exceed the load limits described on the machine-weight label.

### **▲ WARNING**

**The bed lowers whenever the dump lever is pushed down, even when the engine is off. Turning off the engine *will not* prevent the box from lowering.**

**Always place the safety support on the extended lift cylinder to hold the box up if you are not going to lower it right away.**

The machine has several combinations of boxes, platforms, and attachments available. These can be used in various combinations that allow for maximum capacity and versatility. The full sized box is 140 cm (55 inches) wide by 165 cm (65 inches) long and can hold up to 1477 kg (3,249 lb) of evenly-distributed cargo.

Loads vary in how they are distributed. Sand spreads out evenly and quite low. Other items, such as bricks, fertilizer or landscape timbers, stack higher in the box.

The height and weight of the load has a significant influence on tip overs. The higher a load is stacked, the more likely the machine is to tip over. You may find that 1477 kg (3,249 lb) stacks too high for safe operation. Reducing the total weight is one way to reduce the risk of a tip over. Distributing the load as low as possible is another way to reduce the risk of a tip-over.

If the load is positioned toward 1 side, it makes the machine much more likely to tip over on that side. This is especially true when turning if the load is on the outside of the turn.

Never position heavy loads behind the rear axle. If the load is positioned so far to the rear that it is behind the rear axle, it reduces the weight on the front wheels and this reduces the steering traction. With the load all the way to the back, the front wheels can even come off of the ground when going over bumps or up a hill. This results in a loss of steering and may lead to the machine tipping over.

**As a general rule, position the weight of the load evenly from front to rear and evenly from side to side.**

If a load is not secured, or you are transporting a liquid in a large container such as a sprayer, it can shift. This shifting happens most often while turning, going up or down hills, suddenly changing speeds, or while driving over rough surfaces. Shifting loads can lead to tip-overs. Always secure loads so that they do not shift. Never dump the load while the machine is sideways on the hill.

Heavy loads increase stopping distance and reduce your ability to turn quickly without tipping over.

The rear cargo space is intended for load carrying purposes only, not for passengers.

## Using the Differential Lock

The differential lock increases the machine traction by locking the rear wheels so 1 wheel does not spin out. This can help when you have heavy loads to haul on wet turf or slippery areas, going up hills, and on sandy surfaces. It is important to remember, however, that this extra traction is only for temporary limited use. Its use does not replace the safe operation, already discussed concerning steep hills and heavy loads.

The differential lock causes the rear wheels to spin at the same speed. When using the differential lock, your ability to make sharp turns is somewhat restricted and may scuff the turf. Use the differential lock only when needed, at slower speeds and only in first or second gear.



## ▲ WARNING

Tipping or rolling the machine on a hill will cause serious injury.

- The extra traction available with the differential lock can be enough to get you into dangerous situations such as climbing slopes that are too steep to turn around. Be extra careful when operating with the differential lock on, especially on steeper slopes.
- If the differential lock is on when making a sharp turn at a higher speed and the inside rear wheel lifts off the ground, there may be a loss of control, which could cause the machine to skid. Use the differential lock only at slower speeds.

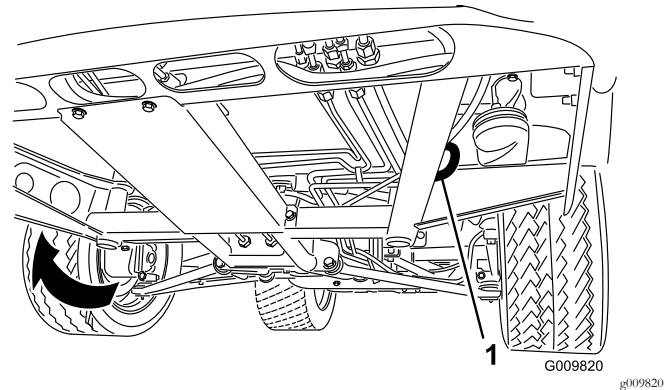

Figure 29

1. Eye hole in the frame (each side)

## Using 4-Wheel Drive

### 4-Wheel-Drive Models Only

The automatic, on demand 4-wheel-drive feature, on this machine does not require operator activation. The front wheel drive is not engaged (no power delivered to front wheels) until the rear wheels begin to lose traction. The bidirectional clutch senses the rear wheels slipping, engages the front wheel drive, and delivers power to the front wheels. The 4-wheel-drive system continues to deliver power to the front wheels until the rear wheels have enough traction to move the machine without slipping. Once this occurs, the system stops delivering power to the front wheels and the handling characteristics become similar to that of a 2-wheel-drive machine. The 4 wheel drive system functions in both forward and reverse; however, when turning, the rear wheels slip slightly more before power is delivered to the front wheels.

## ▲ WARNING

Tipping or rolling the machine on a hill will cause serious injury.

The extra traction available with the 4-wheel-drive feature can be enough to get you into dangerous situations such as climbing slopes that are too steep to turn around. Be careful when operating the machine, especially on steeper slopes.

## Transporting the Machine

For moving the machine long distances, use a trailer. Make sure that the machine is secured to the trailer. Refer to [Figure 29](#) and [Figure 30](#) for the location of the tie-down points.

**Note:** Load the machine on the trailer with the front of the machine facing forward. If that is not possible, secure the machine hood to the frame with a strap, or remove the hood and transport and secure it separately or the hood may blow off during transport.

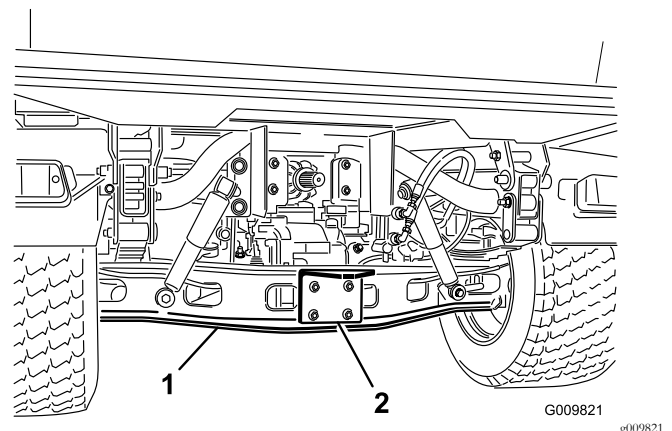

Figure 30

1. Axle
2. Hitch plate

## Towing the Machine

In case of an emergency, the machine can be towed for a short distance. However, Toro does not recommend this as a standard procedure.

## ▲ WARNING

Towing at excessive speeds could cause the machine to lose steering control.

**Never tow the machine at faster than 8 kph (5 mph).**

Towing the machine is a 2-person job. Affix a tow line to holes in the front frame member. Move the shift lever to the NEUTRAL position and disengage the parking brake. If you must move the machine a considerable distance, transport it on a truck or trailer.

**Note:** The power steering does not function, making it difficult to steer.

# Towing a Trailer with the Machine

The machine is capable of pulling trailers and attachments of greater weight than the machine itself.

Several types of tow hitches are available for the machine, depending on your application. Contact your Authorized Toro Distributor for details.

When equipped with a tow hitch bolted onto the rear axle tube, your machine can tow trailers or attachments with a gross trailer weight (GTW) up to 1587 kg (3,500 lb). Always load a trailer with 60% of the cargo weight in the front of the trailer. This places approximately 10% (272 kg (600 lb) maximum) of the gross trailer weight (GTW) on the tow hitch of the machine.

When hauling cargo or towing a trailer (attachment), do not overload the machine or trailer. Overloading can cause poor performance or damage to the brakes, axle, engine, transaxle, steering, suspension, body structure, or tires.

**Important:** To reduce potential for drive line damage, use low range.

When towing fifth-wheel attachments, like a fairway aerator, always install the wheel bar (included with the fifth wheel kit) to prevent the front wheels from lifting off the ground if the towed attachments movement is suddenly impaired.

# Using the Hydraulic Control

The hydraulic control supplies hydraulic power from the machine pump whenever the engine runs. You can use the power through the quick couplers at the rear of the machine.

## ⚠ CAUTION

Hydraulic fluid escaping under pressure can have sufficient force to penetrate skin and do serious damage.

Use care when connecting or disconnecting hydraulic quick couplers. Shut off the engine, engage the parking brake, lower the attachment, and place the remote hydraulic valve in the float detent position to relieve the hydraulic pressure before connecting or disconnecting the quick couplers.

**Important:** If multiple machines use the same attachment, cross contamination of the transmission fluid may occur. Change the transmission fluid more frequently.

# Using the Hydraulic-Bed-Lift Lever to Control Hydraulic Attachments

- OFF Position

This is the normal position for the control valve when it is not in use. In this position, the work ports of the control valve are blocked and any load is held by the check valves in both directions.

- RAISE (Quick Coupler “A”) Position

This is the position which lifts the bed, and rear hitch attachment, or applies pressure to the quick coupler A. This also allows hydraulic fluid to return from quick coupler B to flow back into the valve and then out to the reservoir. This is a momentary position, and when you release the lever, it spring returns to the center, OFF position.

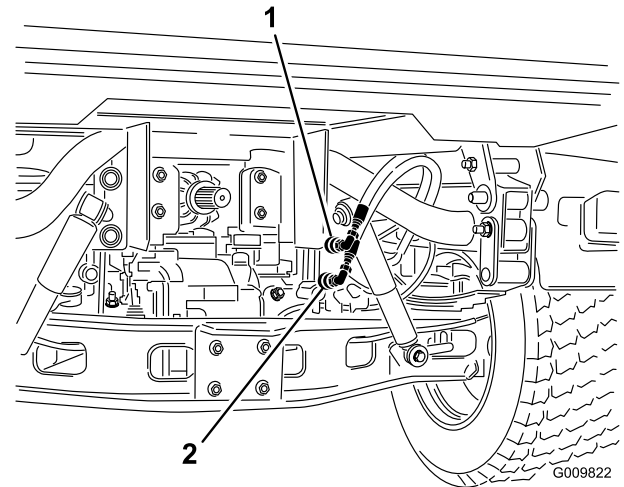

Figure 31

1. Quick coupler A position    2. Quick coupler B position

- LOWER (Quick Coupler “B”) Position

This position lowers the bed, rear hitch attachment, or apply pressure to quick coupler B. This also allows hydraulic fluid to return from quick coupler A to flow back into the valve and then out to the reservoir. This is a momentary position, and when you release the lever, it spring returns to the center-off position. Momentarily holding and then releasing the control lever in this position provides hydraulic-fluid flow to quick coupler B, which provides power down on the rear hitch. When you release it, it holds the down pressure on the hitch.

**Important:** If you use it with a hydraulic cylinder, holding the control lever in the lower position causes the hydraulic-fluid flow to go over a relief valve which can damage the hydraulic system.

- ON Position

This position is similar to Lower (quick coupler B position). It also directs hydraulic fluid to quick coupler B except that the lever is held in this position by a detent lever in the control panel. This allows hydraulic fluid

to flow continuously to equipment that uses a hydraulic motor. Use this position only on attachments with a hydraulic motor attached.

**Important:** If you use it with a hydraulic cylinder or no attachment, the ON position causes the hydraulic-fluid flow to go over a relief valve, which can damage the hydraulic system. Use this position only momentarily or with a motor attached.

**Important:** Check the hydraulic-fluid level after installation of an attachment. Check the operation of the attachment by cycling the attachment several times to purge air from the system, then check hydraulic-fluid level again. The attachment cylinder slightly affects the fluid level in the transaxle. Operating the machine with a low hydraulic-fluid level can damage the pump, remote hydraulics, power steering, and the machine transaxle.

## Connecting the Quick Couplers

**Important:** Clean dirt from quick couplers before connecting them. Dirty couplers can introduce contamination into the hydraulic system.

1. Pull back the locking ring on the coupler.
2. Insert the hose nipple into the coupler until it snaps into position.

**Note:** When attaching remote equipment to the quick couplers, determine which side requires pressure, then attach that hose to quick coupler B, which has pressure when you push the control lever forward or locked in the ON position.

## Disconnecting the Quick Couplers

**Note:** With both the machine and attachment turned off, move the lift lever back and forth to remove the system pressure and ease the disconnection of the quick couplers.

1. Pull back the locking ring on the coupler.
2. Pull the hose firmly from the coupler.

**Important:** Clean and install the dust plug and dust covers to the quick coupler ends when not in use.

## Troubleshooting the Hydraulic Control

- Difficulty in connecting or disconnecting quick couplers.
  - The pressure not relieved (the quick coupler is under pressure).
- The power steering is turning with great difficulty or it is not turning at all.
  - The hydraulic-fluid level is low.
  - The hydraulic-fluid temperature is hot.
  - The pump is not operating.
- There are hydraulic leaks.
  - The fittings are loose.
  - The fitting is missing the O-ring.
- An attachment does not function.
  - The quick couplers are not fully engaged.
  - The quick couplers are interchanged.
- There is a squealing noise.
  - Remove the valve left in the ON detent position causing hydraulic fluid to flow over the relief valve.
  - The belt is loose.
- The engine does not start.
  - The hydraulic lever is locked in the FORWARD position

# Maintenance

## Recommended Maintenance Schedule(s)

Maintenance Service Interval	Maintenance Procedure
After the first 2 hours	<ul style="list-style-type: none"> <li>• Torque the front and rear wheel nuts.</li> </ul>
After the first 8 hours	<ul style="list-style-type: none"> <li>• Check the condition and tension of the alternator belt.</li> </ul>
After the first 10 hours	<ul style="list-style-type: none"> <li>• Torque the front and rear wheel nuts.</li> <li>• Check the adjustment of the shift cables.</li> <li>• Check the adjustment of the parking brake.</li> <li>• Replace the hydraulic filter.</li> <li>• Change the high-flow hydraulic fluid filter (TC models only).</li> </ul>
After the first 50 hours	<ul style="list-style-type: none"> <li>• Change the engine oil and filter.</li> <li>• Adjust the engine-valve clearance.</li> </ul>
Before each use or daily	<ul style="list-style-type: none"> <li>• Check the engine-oil level.</li> <li>• Check the level of the coolant.</li> <li>• Check the transaxle/hydraulic-fluid level. (check the fluid level before the engine is first started and every 8 hours or daily, thereafter.)</li> <li>• Check the high flow hydraulic-fluid level (TC models only); (check the level of hydraulic fluid before the engine is first started, and daily thereafter).</li> <li>• Check the tire pressure.</li> <li>• Check the brake-fluid level. (Check the level before the engine is first started and every 8 hours or daily, thereafter.)</li> <li>• Check the operation of the safety-interlock system.</li> <li>• Drain water or other contaminants from the water separator.</li> <li>• Remove debris from the engine area and radiator (clean more frequently in dirty conditions).</li> </ul>
Every 25 hours	<ul style="list-style-type: none"> <li>• Remove the air-cleaner cover and clean out the debris.</li> </ul>
Every 50 hours	<ul style="list-style-type: none"> <li>• Check the battery-fluid level (every 30 days if in storage).</li> <li>• Check the battery-cable connections.</li> </ul>
Every 100 hours	<ul style="list-style-type: none"> <li>• Check the level of front differential oil (4-wheel-drive models only).</li> <li>• Grease all bearings and bushings (lubricate more frequently in heavy duty applications).</li> <li>• Change the air-cleaner filter (more frequently in dusty or dirty conditions).</li> <li>• Inspect the condition of the tires.</li> </ul>
Every 200 hours	<ul style="list-style-type: none"> <li>• Torque the front and rear wheel nuts.</li> <li>• Change the engine oil and filter.</li> <li>• Inspect the constant-velocity boot for cracks, holes, or a loose clamp (4-wheel-drive models only).</li> <li>• Check the adjustment of the shift cables.</li> <li>• Check the adjustment of the high-to-low cable.</li> <li>• Check the adjustment of the differential-lock cable.</li> <li>• Check the adjustment of the parking brake.</li> <li>• Check the adjustment of the brake pedal.</li> <li>• Check the condition and tension of the alternator belt.</li> <li>• Check the adjustment of the clutch pedal.</li> <li>• Inspect the service and parking brakes.</li> </ul>
Every 400 hours	<ul style="list-style-type: none"> <li>• Check the fuel lines and connections.</li> <li>• Replace the fuel filter.</li> <li>• Check the front-wheel alignment.</li> <li>• Visually inspect the brakes for worn brake shoes.</li> </ul>
Every 600 hours	<ul style="list-style-type: none"> <li>• Adjust the engine-valve clearance.</li> </ul>

Maintenance Service Interval	Maintenance Procedure
Every 800 hours	<ul style="list-style-type: none"> <li>• Change the front differential oil (4-wheel-drive models only).</li> <li>• Change the hydraulic fluid and clean the strainer.</li> <li>• Replace the hydraulic filter.</li> <li>• Change the high-flow hydraulic fluid and filter (TC models only).</li> </ul>
Every 1,000 hours	<ul style="list-style-type: none"> <li>• Change the brake fluid.</li> <li>• Drain/flush the fuel tank.</li> <li>• Flush or replace the coolant-system fluid.</li> </ul>

**Note:** Determine the left and right sides of the machine from the normal operating position.

## **⚠ DANGER**

Only qualified and authorized personnel should maintain, repair, adjust, or inspect the machine.

Avoid fire hazards and have fire protection equipment present in the work area. Do not use an open flame to check the level or leakage of fuel, battery electrolyte, or coolant. Do not use open pans of fuel or flammable cleaning fluids for cleaning parts.

## **⚠ CAUTION**

If you leave the key in the key switch, someone could accidentally start the engine and seriously injure you or other bystanders.

Remove the key from the key switch before you do any maintenance.

## **Operating in Adverse Conditions**

**Important:** If the machine is subjected to any of the conditions listed below, perform maintenance twice as frequently:

- Desert operation
- Cold-climate operation below 0°C (32°F)
- Trailer towing
- Frequent operation on dusty roads
- Construction work
- After extended operation in mud, sand, water, or similar dirty conditions, have your brakes inspected and cleaned as soon as possible. This prevents any abrasive material from causing excessive wear.

# Pre-Maintenance Procedures

Many of the subjects covered in this maintenance section require raising and lowering the bed. To prevent serious injury or death, take the following precautions.

## ⚠ WARNING

A raised bed full of material without the proper safety support rod may lower unexpectedly. Working under an unsupported raised bed may cause injury to you or others.

- Before servicing or making adjustments to the machine, park the machine on a level surface, engage the parking brake, shut off the engine, and remove the key.
- Remove any load material from the bed or other attachment and insert the safety support on a fully extended cylinder rod before working under a raised bed.

## Using the Bed Support

**Important:** Always install or remove the bed support from the outside of the bed.

1. Raise the bed until the lift cylinders are fully extended.
2. Remove the bed support from the storage brackets on the back of the ROPS panel (Figure 32).

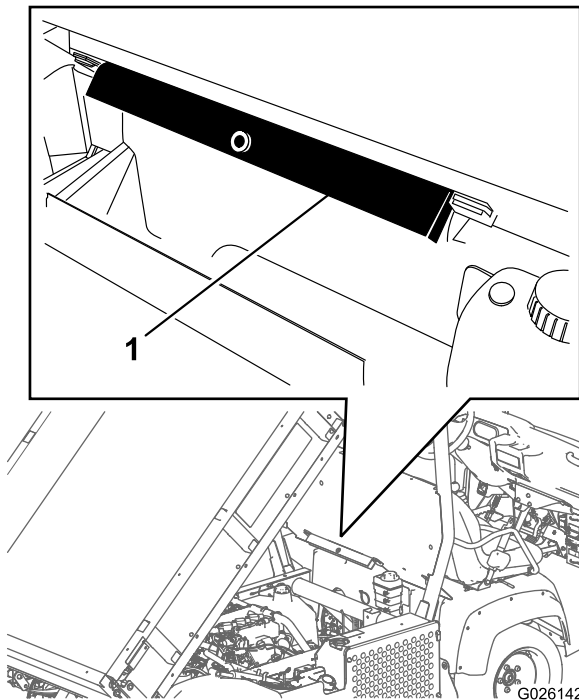

Figure 32

1. Bed support

3. Push the bed support onto the cylinder rod, ensuring that the support end tabs rest on the end of the cylinder barrel, and on the cylinder-rod end (Figure 33).

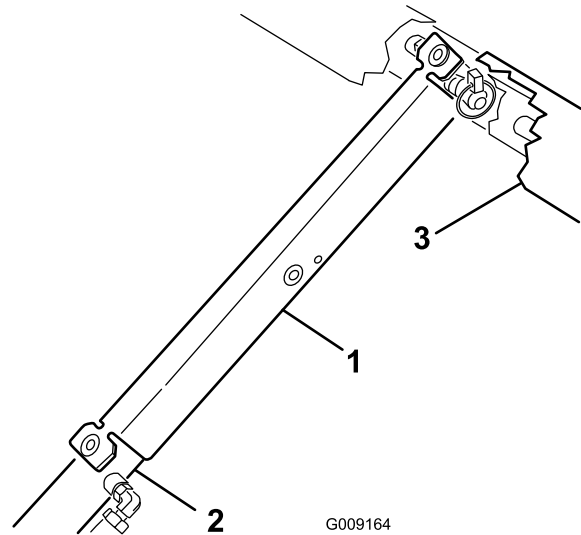

Figure 33

1. Bed support
2. Cylinder barrel
3. Bed

4. Remove the bed support from the cylinder and insert it into the brackets on the back of the ROPS panel.

**Important:** Do not try to lower the bed with the bed-safety support on the cylinder.

# Removing the Full Bed

1. Start the engine, engage the hydraulic-lift lever, and lower the bed until the cylinders are loose in the slots.
2. Release the lift lever and shut off the engine.
3. Remove the lynch pins from the outer ends of the cylinder-rod clevis pins (Figure 34).

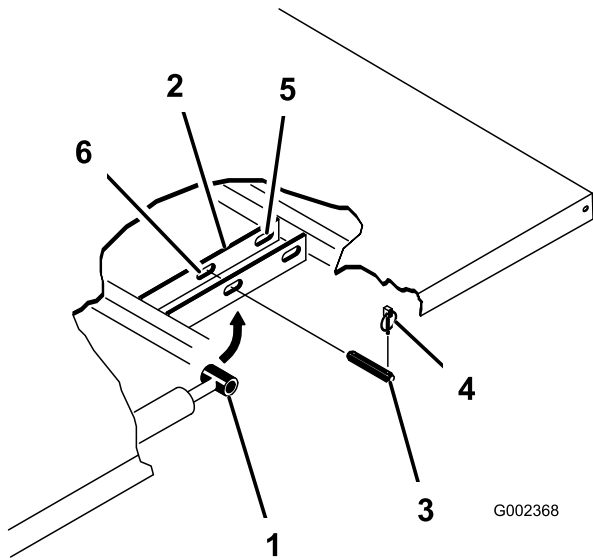

Figure 34

- |                       |                          |
|-----------------------|--------------------------|
| 1. Cylinder-rod end   | 4. Lynch pin             |
| 2. Bed-mounting plate | 5. Rear slots (full bed) |
| 3. Clevis pin         | 6. Front slots (2/3 bed) |

4. Remove the clevis pins securing the cylinder-rod ends to the bed-mounting plates by pushing the pins toward the inside (Figure 34).
5. Remove the lynch pins and clevis pins securing the pivot brackets to the frame channels (Figure 34).
6. Lift the bed off the machine.

**Important:** The full bed weighs approximately 148 kg (325 lb), so do not try to install or remove it by yourself.

Use an overhead hoist or get the help of 2 or 3 other people.

7. Store the cylinders in the storage clips.
8. Engage the hydraulic-lift-lock lever on the machine to prevent accidental extension of the lift cylinders.

# Installing the Full Bed

**Note:** If you install the bed sides on the flat bed, it is easier to install them before installing the bed on the machine.

**Note:** Ensure that the rear pivot plates are bolted to the bed frame/channel so that the lower end angles to the rear (Figure 35).

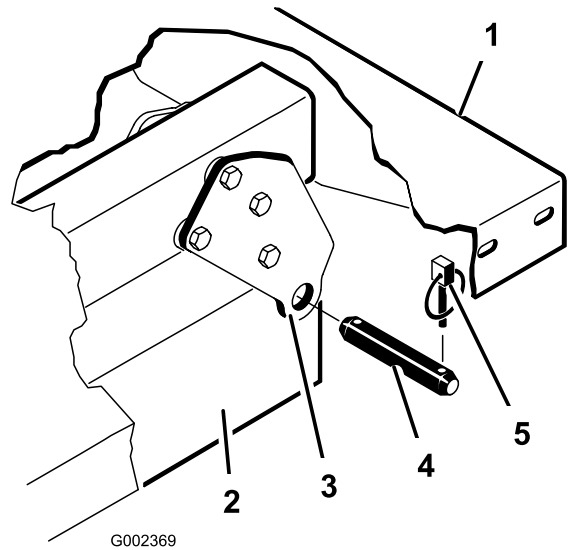

Figure 35

- |                             |               |
|-----------------------------|---------------|
| 1. Left, rear corner of bed | 4. Clevis pin |
| 2. Machine-frame channel    | 5. Lynch pin  |
| 3. Pivot plate              |               |

**Important:** The full bed weighs approximately 148 kg (325 lb), so do not try to install or remove it by yourself. Use an overhead hoist or get the help of 2 or 3 other people.

**Note:** Ensure that the spacer brackets and wear blocks (Figure 36) are installed with the carriage-bolt heads positioned inside the machine.

# Raising the Machine

## ⚠ DANGER

A machine on a jack may be unstable and slip off the jack, injuring anyone beneath it.

- Do not start the machine while the machine is on a jack.
- Always remove the key from the key switch before getting off of the machine.
- Block the tires when the machine is on a jack.
- Do not start the engine while the machine is on a jack, because the engine vibration or wheel movement could cause the machine to slip off the jack.
- Do not work under the machine without jack stands supporting it. The machine could slip off a jack, injuring anyone beneath it.
- When jacking up the front of the machine, always place a wooden block (or similar material) between the jack and the machine frame.
- The jacking point at the front of the machine is under the front center frame support (Figure 37) and at the rear it is under the axle (Figure 38).

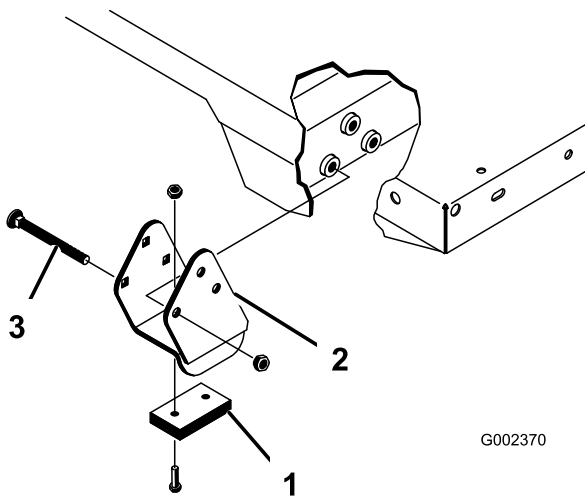

Figure 36

1. Wear block
2. Spacer bracket
3. Carriage bolt

1. Ensure that the lift cylinders are fully retracted.
2. Carefully set the bed onto the machine frame, aligning the rear bed pivot-plate holes with the holes in the rear frame channel and install 2 clevis pins and lynch pins (Figure 36).
3. With the bed lowered, secure each cylinder rod end, to the appropriate slots in the bed-mounting plates with a clevis pin and lynch pin.
4. Insert the clevis pin from outside of the bed with the lynch pin toward the outside (Figure 36).

**Note:** The rear slots are for a full bed installation and front slots are for a 2/3 bed installation.

**Note:** The engine may need to be started to extend or retract the cylinders for alignment with the holes.

**Note:** The unused slot can be plugged with a bolt and nut to prevent assembly errors.

5. Start the engine and engage the hydraulic-lift lever to raise the bed.
6. Release the lift lever and turn off the engine.
7. Install the bed-safety support to prevent accidental lowering of the bed; refer to [Using the Bed Support](#) (page 38).
8. Install the lynch pins to the inside ends of the clevis pins.

**Note:** If the automatic-tailgate release has been installed on the bed, ensure that the front dump link rod has been placed on the inside of the left side clevis pin before you install the lynch pin.

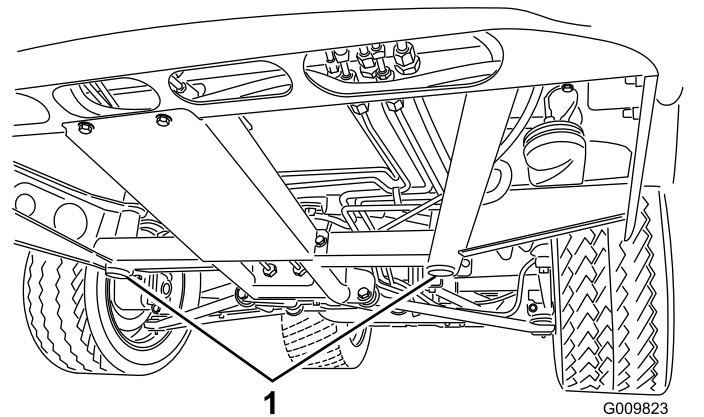
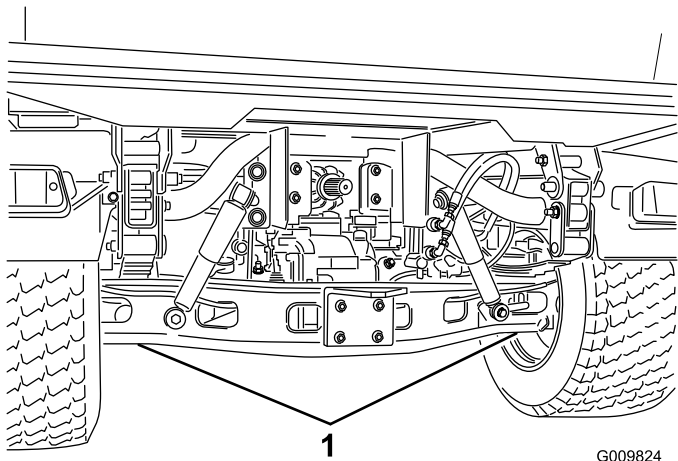

Figure 37

1. Front jacking points





G009824  
g009824

**Figure 38**

1. Rear jacking points

## Removing the Hood

1. While grasping the hood in the headlight openings, lift up the hood to release the lower mounting tabs from the frame slots ([Figure 39](#)).

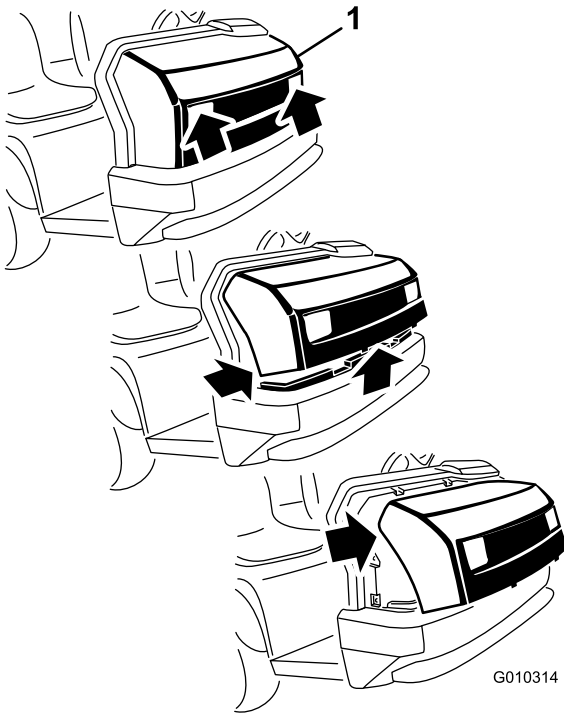

G010314

g010314

**Figure 39**

1. Hood
2. Pivot the bottom of the hood upward until the top mounting tabs can be pulled from the frame slots ([Figure 39](#)).
3. Pivot the top of the hood forward, and unplug the wire connectors from the head lights ([Figure 39](#)).
4. Remove the hood.

# Lubrication

## Greasing the Bearings and Bushings

**Service Interval:** Every 100 hours (lubricate more frequently in heavy duty applications).

The machine has grease fittings that must be lubricated regularly with No. 2 lithium grease.

The grease fitting locations and quantities are as follows:

- Ball joints (4), tie rods (2), pivot mounts (2) and steering cylinder (2) as shown in [Figure 40](#)
- Spring tower (2) as shown in [Figure 41](#)
- Clutch (1), accelerator (1), and brake (1) as shown in [Figure 42](#)
- U-joint (18) and 4-wheel-drive shaft (3) as shown in [Figure 43](#)

**Important:** When greasing the drive shaft universal shaft bearing crosses, pump grease until it comes out of all 4 cups at each cross.

1. Wipe each grease fitting clean so foreign matter cannot be forced into the bearing or bushing.
2. Pump grease into each bearing or bushing.
3. Wipe off excess grease.

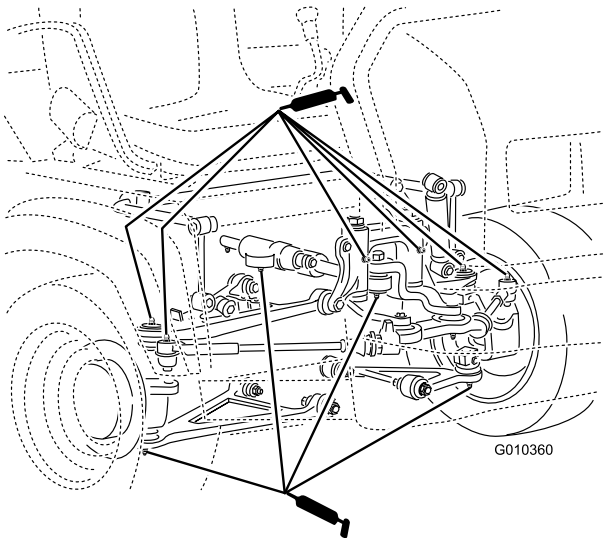

Figure 40

g010360

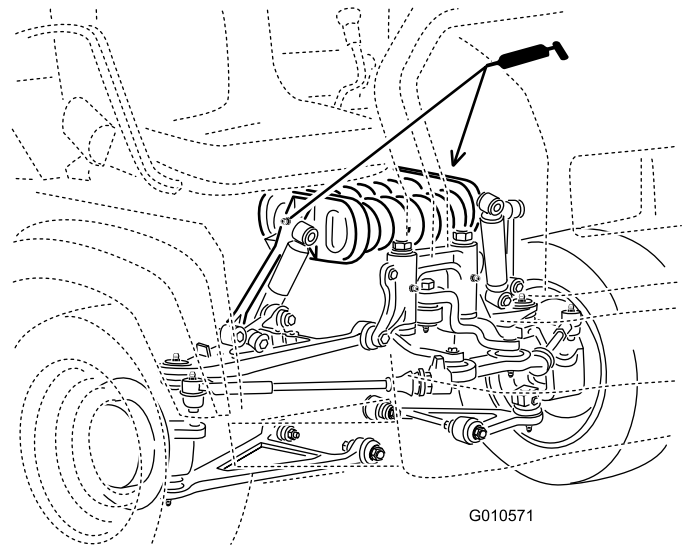

Figure 41

g010571

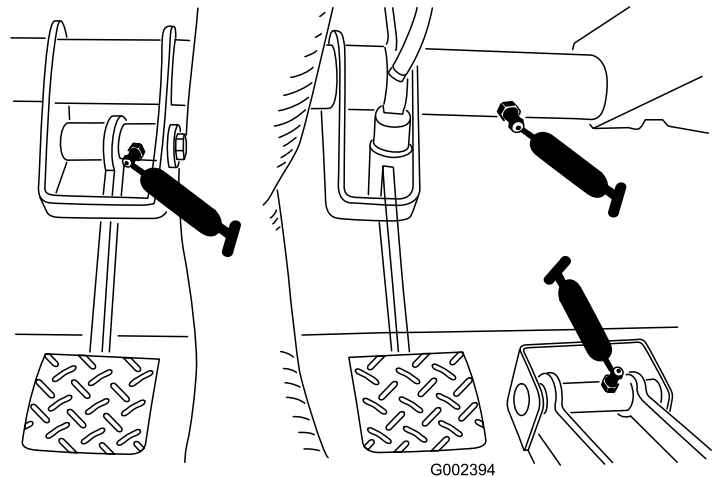
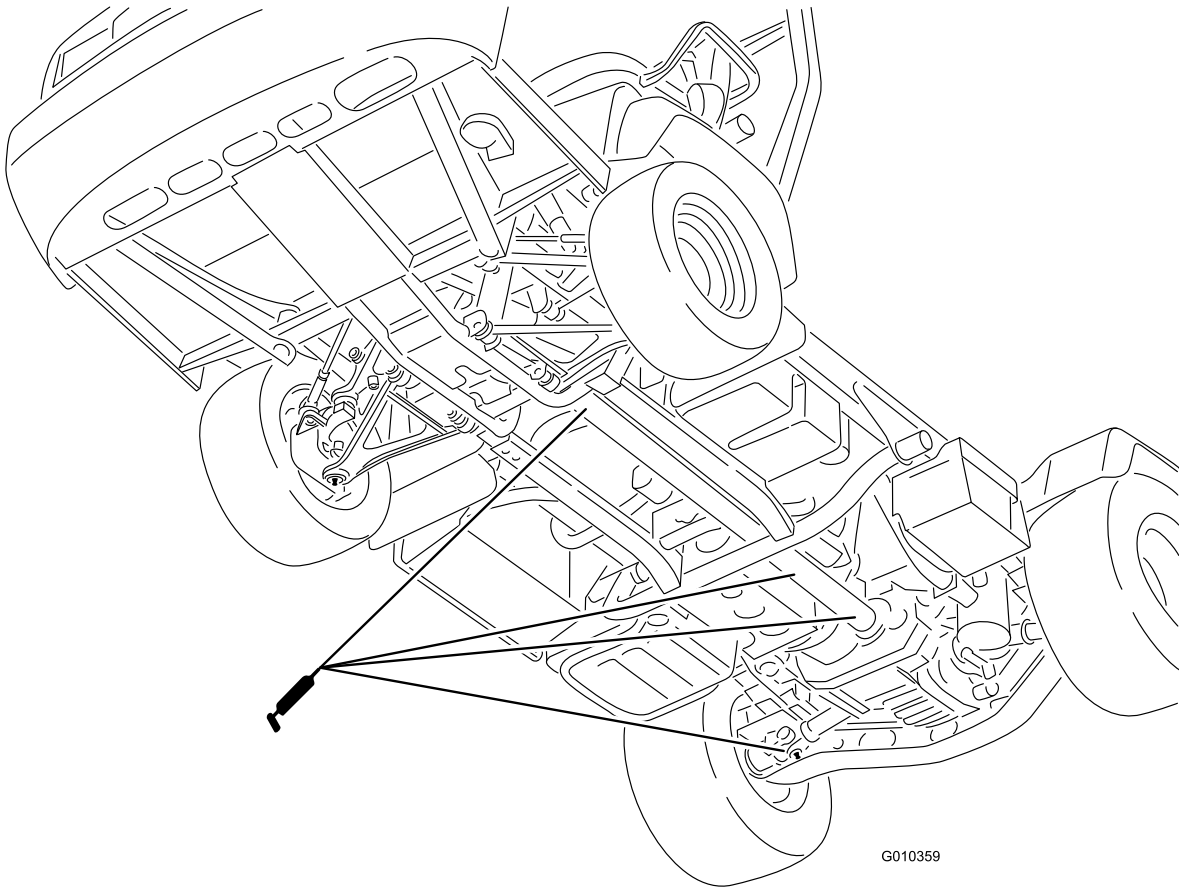

Figure 42

g002394



G010359

g010359

**Figure 43**

# Engine Maintenance

## Servicing the Air Cleaner

**Service Interval:** Every 25 hours—Remove the air-cleaner cover and clean out the debris.

Every 100 hours—Change the air-cleaner filter (more frequently in dusty or dirty conditions).

Inspect the air cleaner and hoses periodically to maintain maximum engine protection and to ensure maximum service life. Check the air-cleaner body for damage, which could possibly cause an air leak. Replace a damaged air-cleaner body.

Inspect and change the air-cleaner filter as described in the following procedure:

1. Release the latches on the air cleaner and pull the air-cleaner cover off the air-cleaner body (Figure 44).

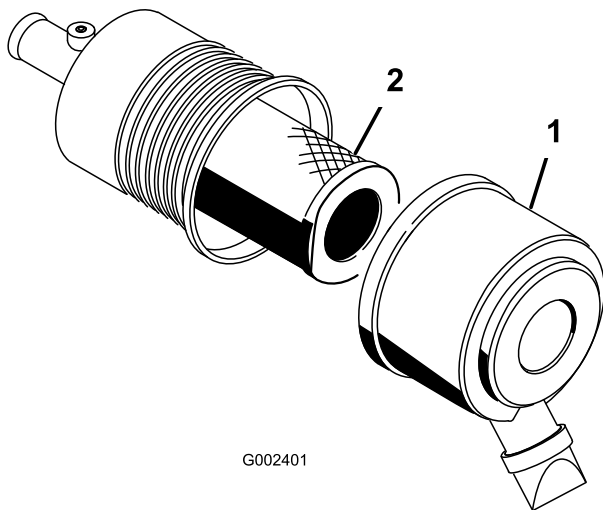

Figure 44

1. Air-cleaner cover
2. Filter

2. Squeeze the dust cap sides to open it and knock the dust out.
3. Gently slide the filter out of the air-cleaner body (Figure 44).

**Note:** Avoid knocking the filter into the side of the body.

**Note:** Do not attempt to clean the filter.

4. Inspect the new filter for damage by looking into the filter while shining a bright light on the outside of the filter.

**Note:** Holes in the filter appear as bright spots.

**Note:** Inspect the element for tears, an oily film, or damage to the rubber seal. If the filter is damaged, do not use it.

**Note:** To prevent engine damage, always operate the engine with the air filter and cover installed.

**Note:** Take special care to keep particulates from dropping into the clean areas of the air-filter housing.

5. Carefully slide the filter over the body tube (Figure 44).

**Note:** Ensure that it is fully seated by pushing on the outer rim of the filter while installing it.

6. Install the air-cleaner cover with the side facing up, and secure the latches (Figure 44).

## Changing the Engine Oil and Filter

**Service Interval:** After the first 50 hours

Every 200 hours

**Engine-oil quantity:** 3.2 L (3.4 US qt) (with a filter)

**Engine-oil type:** Detergent engine oil API SJ or higher

**Engine-oil viscosity:** 10W-30; Choose an engine-oil viscosity according to the ambient-air temperature to the table in Figure 45.

### USE THESE SAE VISCOSITY OILS

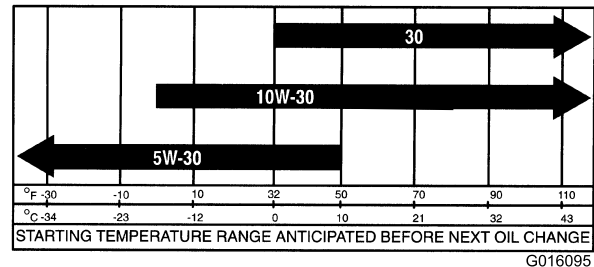
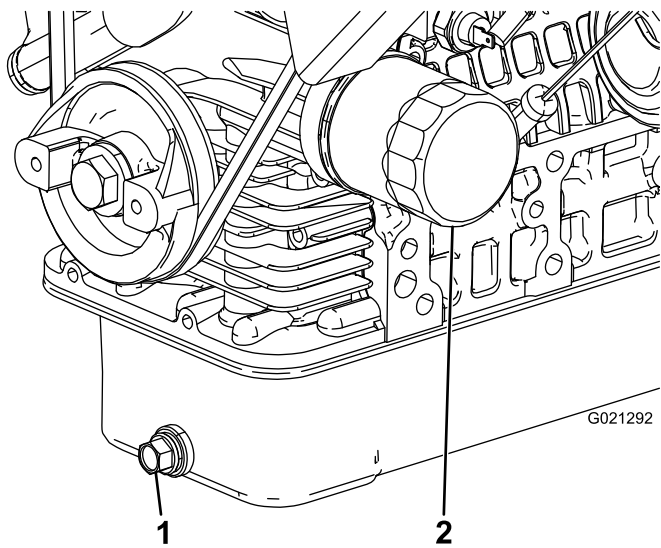

Figure 45

1. Raise the bed (if equipped), and place the safety support on the extended-lift cylinder to hold up the bed.
2. Remove the drain plug and let the oil flow into a drain pan (Figure 46).



**Figure 46**

1. Engine-oil-drain plug      2. Engine-oil filter

3. When the oil stops, install the drain plug.
4. Remove the oil filter (Figure 46).
5. Apply a light coat of clean oil to the new filter seal before screwing it on.
6. Screw the filter on until the gasket contacts the mounting plate, then tighten the filter 1/2 to 2/3 of a turn.

**Note: Do not overtighten.**

7. Add the specified oil to the crankcase.

# Fuel System Maintenance

## Checking the Fuel Lines and Connections

**Service Interval:** Every 400 hours/Yearly (whichever comes first)

Every 1,000 hours/Every 2 years (whichever comes first)

Inspect the fuel lines and connections for deterioration, damage, or loose connections.

## Servicing the Fuel Filter/Water Separator

### Draining the Fuel Filter/Water Separator

**Service Interval:** Before each use or daily—Drain water or other contaminants from the water separator.

1. Place a clean container under the fuel filter (Figure 47).
2. Loosen the drain plug on the bottom of the filter canister.

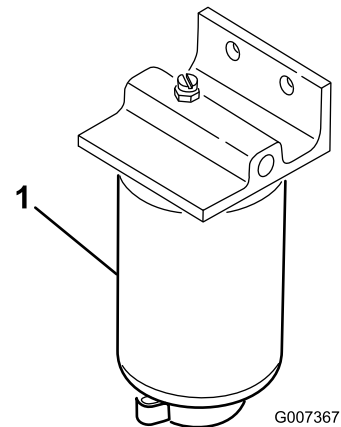

**Figure 47**

1. Filter canister

3. Tighten the drain plug on the bottom of the filter canister.

# Changing the Fuel Filter

**Service Interval:** Every 400 hours—Replace the fuel filter.

1. Drain the water from the water separator; refer to [Draining the Fuel Filter/Water Separator \(page 45\)](#).
2. Clean the area where the filter mounts ([Figure 47](#)).
3. Remove the filter and clean the mounting surface.
4. Lubricate the gasket on the filter with clean oil.
5. Install the filter by hand until the gasket contacts mounting surface, then rotate it an additional 1/2 turn.
6. Tighten the drain plug on the bottom of the filter canister.

# Electrical System Maintenance

## Servicing the Fuses

The fuses for the electrical system are located under the center of the dash panel ([Figure 48](#) and [Figure 49](#)).

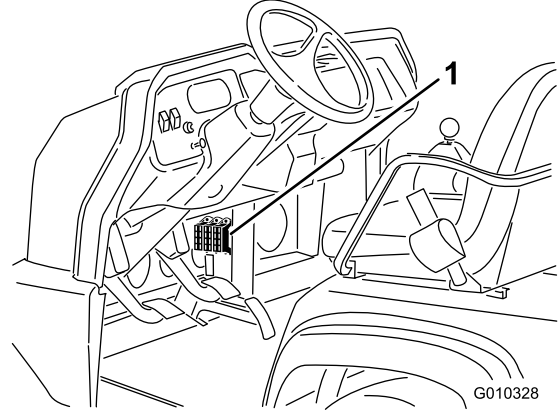

**Figure 48**

1. Fuses

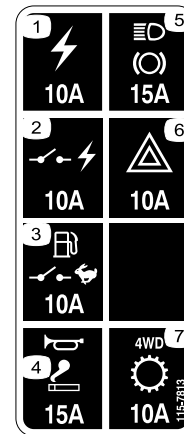

**Figure 49**

1. Power outlet—10 A
2. Switched power—10 A
3. Fuel pump, supervisor switch—10 A
4. Horn, power point—15 A
5. Lights, brake—15 A
6. Hazard—10 A
7. 4WD, Transmission—10 A

# Jump-Starting the Machine

## ⚠ WARNING

Jump-starting the machine can be dangerous, causing personal injury or damage to the electrical components in the machine.

- Never jump-start with a voltage source greater than 15 VDC; this damages the electrical system.
- Never attempt to jump-start a discharged battery that is frozen. It could rupture or explode during jump-starting.
- Observe all battery warnings while jump-starting the machine.
- Be sure that your machine is not touching the jump-start machine.
- Connecting cables to the wrong post could result in personal injury and/or damage to the electrical system.

1. Squeeze the battery cover to release the tabs from the battery base, and remove the battery cover from the battery base (Figure 50).

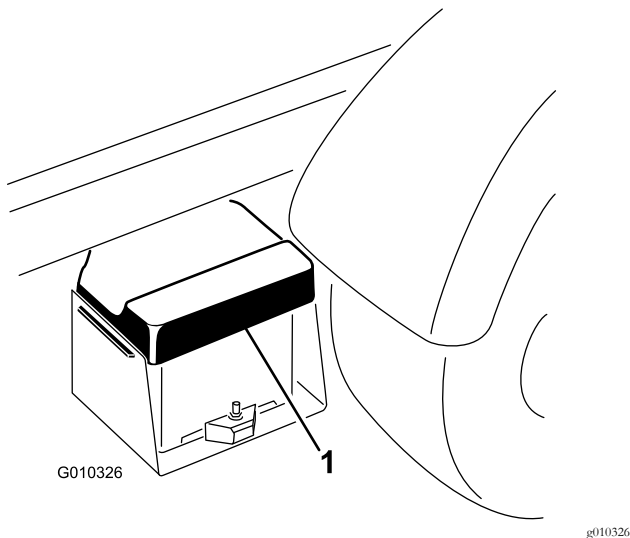

Figure 50

1. Battery cover

2. Connect a jumper cable between the positive posts of the 2 batteries (Figure 51).

**Note:** The positive post may be identified by a + sign on top of the battery cover.

3. Connect 1 end of the other jumper cable to the negative terminal of the battery in the other machine.

**Note:** The negative terminal has “NEG” on the battery cover.

**Note:** Do not connect the other end of the jumper cable to the negative post of the discharged battery. Connect the jumper cable to the engine or frame. Do not connect the jumper cable to the fuel system.

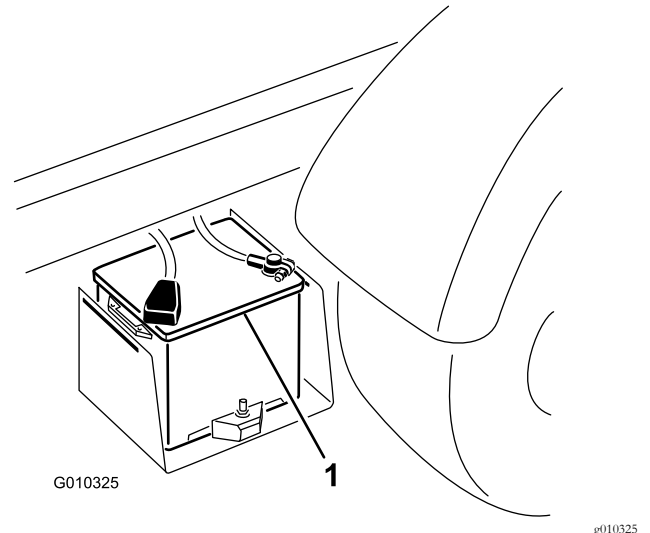

Figure 51

1. Battery

4. Start the engine in the machine providing the jump-start.

**Note:** Let it run for a few minutes, then start the engine.

5. Remove the negative jumper cable first from the engine, then the battery in the other machine.
6. Install the battery cover to the battery base.

# Servicing the Battery

**Service Interval:** Every 50 hours—Check the battery-fluid level (every 30 days if in storage).

Every 50 hours—Check the battery-cable connections.

## ⚠ WARNING

### CALIFORNIA Proposition 65 Warning

Battery posts, terminals, and related accessories contain lead and lead compounds, chemicals known to the State of California to cause cancer and reproductive harm.  
Wash hands after handling.

## ⚠ DANGER

Battery electrolyte contains sulfuric acid, which is a deadly poison and causes severe burns.

- Do not drink electrolyte and avoid contact with skin, eyes or clothing. Wear safety glasses to shield your eyes and rubber gloves to protect your hands.
- Fill the battery where clean water is always available for flushing the skin.
- Keep the battery-electrolyte level properly maintained.
- Keep the top of the battery clean by washing it periodically with a brush dipped in ammonia or bicarbonate of soda solution. Flush the top surface with water after cleaning. Do not remove the fill cap while cleaning.
- Ensure that the battery cables are kept tight on the terminals to provide good electrical contact.
- If corrosion occurs at terminals, remove the battery cover, disconnect the cables (negative (–) cable first), and scrape the clamps and terminals separately. Connect the cables (positive (+) cable first) and coat the terminals with petroleum jelly.
- Maintain cell electrolyte level with distilled or demineralized water. Do not fill the cells above the bottom of the fill ring inside each cell.
- If you store the machine in a location where temperatures are extremely high, the battery runs down more rapidly than if the machine is stored in a location where temperatures are cool.

# Drive System Maintenance

## Changing the Front Differential Oil 4-Wheel-Drive Models Only

**Service Interval:** Every 800 hours (4-wheel-drive models only).

**Differential-oil specification:** Mobil 424 hydraulic fluid

1. Park the machine on a level surface, engage the parking brake, shut off the engine, and remove the key.
2. Clean the area around the drain plug on the side of the differential (Figure 52).
3. Place a drain pan under the drain plug.

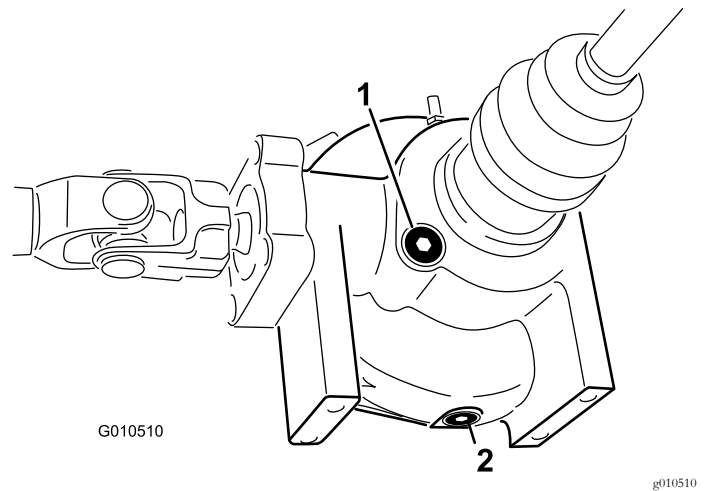

**Figure 52**

1. Fill/check plug

2. Drain plug

4. Remove the drain plug and let the oil flow into the drain pan.
5. Install and tighten the plug when the oil stops draining.
6. Clean the area around the fill/check plug on the bottom of the differential.
7. Remove the fill/check plug and add specified oil until the oil level is up to the hole.
8. Install the fill/check plug.



# Inspecting the Constant-Velocity Boot

## 4-Wheel-Drive Models Only

**Service Interval:** Every 200 hours (4-wheel-drive models only).

Inspect the constant-velocity boot for cracks, holes, or a loose clamp. Contact your Authorized Toro Distributor for repair if you find any damage.

# Adjusting the Shift Cables

**Service Interval:** After the first 10 hours

Every 200 hours

1. Move the shift lever to the NEUTRAL position.
2. Remove the clevis pins securing the shift cables to the transaxle-shift arms (Figure 53).

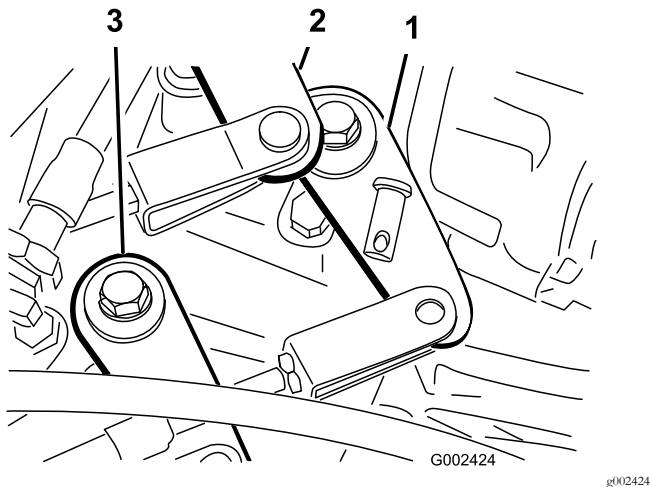

**Figure 53**

1. Shift arm (1st to reverse)
2. Shift arm (2nd to 3rd)
3. Shift arm (High to low)

3. Loosen the clevis jam nuts and adjust each clevis, so that the cable free play is equal forward and backward relative to the hole in the transaxle-shift arm (with the transaxle lever free play taken up in the same direction).
4. Install the clevis pins and tighten the jam nuts when finished.

# Adjusting the High-to-Low Cable

**Service Interval:** Every 200 hours

1. Remove the clevis pin securing the high-to-low cable to the transaxle (Figure 53).
2. Loosen the clevis jam nut and adjust the clevis so that the clevis hole aligns with the hole in the transaxle bracket.
3. Install the clevis pin and tighten the jam nut when finished.

# Adjusting Differential-Lock Cable

**Service Interval:** Every 200 hours

1. Move the differential-lock lever to the OFF position.
2. Loosen the jam nuts securing the differential-lock cable to the bracket on the transaxle (Figure 54).

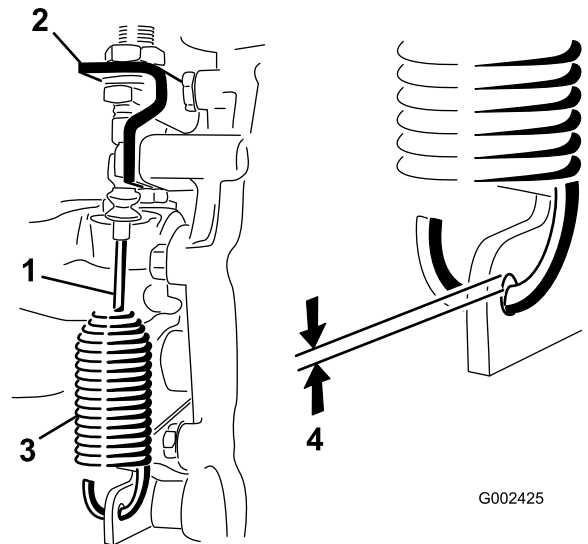

**Figure 54**

1. Differential-lock cable
2. Transaxle bracket
3. Spring
4. 0.25 to 1.5 mm (0.01 to 0.06 inch) gap

3. Adjust the jam nuts to obtain a 0.25 to 1.5 mm (0.01 to 0.06 inch) gap between the spring hook and the OD of the hole in the transaxle lever.
4. Tighten the jam nuts when finished.

# Inspecting the Tires

**Service Interval:** Every 100 hours

The air pressure in the front tires should be 220 kPa (32 psi) and the rear tires should be 124 kPa (18 psi).

Operating accidents, such as hitting curbs, can damage a tire or rim and also disrupt wheel alignment, so inspect the tire condition after an accident.

**Important:** Check the tire pressure frequently to ensure proper inflation. If the tires are not inflated to the correct pressure, the tires will wear prematurely and may cause 4-wheel drive to bind.

Figure 55 is an example of tire wear caused by under-inflation.

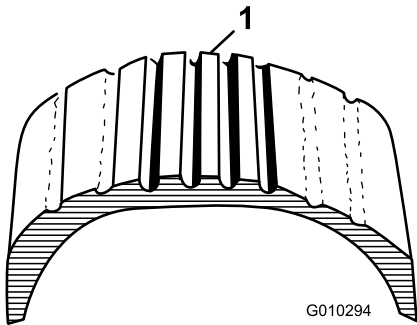

**Figure 55**

1. Under-inflated tire

Figure 56 is an example of tire wear caused by over inflation.

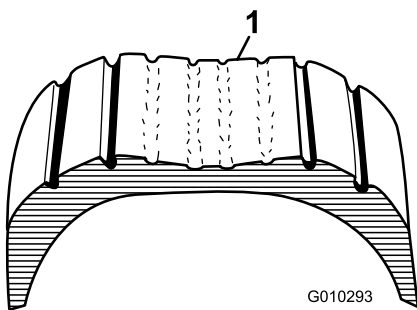

**Figure 56**

1. Over-inflated tire

# Checking the Front-Wheel Alignment

**Service Interval:** Every 400 hours/Yearly (whichever comes first)

1. Make sure that the tires are facing straight ahead.
2. Measure the center-to-center distance (at axle height) at the front and rear of the steering tires (Figure 57).

**Note:** The measurement must be within  $0 \pm 3$  mm ( $0 \pm 0.12$  inch) at the front of the tire then at the rear of the tire. Rotate the tire  $90^\circ$  and check the measurement.

**Important:** Check the measurements at consistent locations on the tire. The machine should be on a flat surface with the tires facing straight ahead.

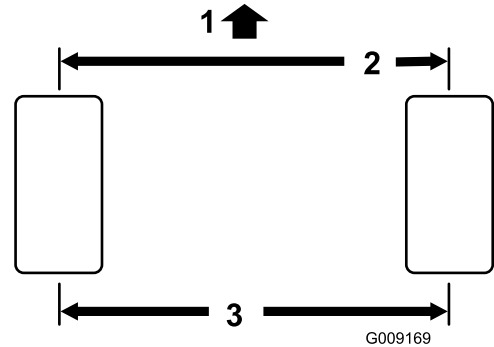
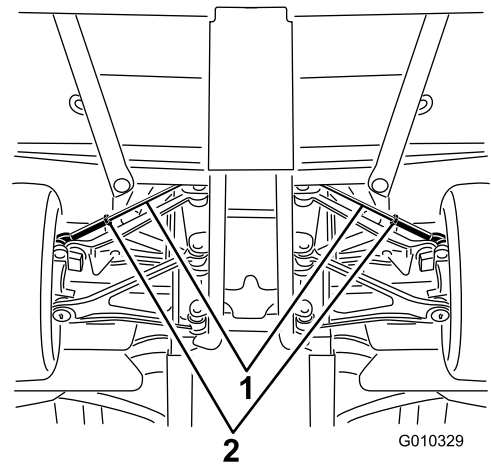

**Figure 57**

1. Front of the machine
2.  $0 \pm 3$  mm ( $0 \pm 0.12$  inch) front to rear of the tire
3. Center to center distance

3. Adjust the center-to-center distance as follows:

- A. Loosen the jam nut at the center of the tie rod (Figure 58).



**Figure 58**

1. Tie rods
2. Jam nuts

- B. Rotate the tie rod to move the front of the tire inward or outward to achieve the center to center distances from front to back.
- C. Tighten the tie rod jam nut when the adjustment is correct.
- D. Check to ensure that the tires turn an equal amount to the right and to the left.

**Note:** If the tires do not turn equally, refer to the *Service Manual* for the adjustment procedure.

# Cooling System Maintenance

## Removing Debris from the Cooling System

**Service Interval:** Before each use or daily (clean more frequently in dirty conditions).

1. Turn the engine off and clean the engine area thoroughly of all debris.
2. Unlatch and remove the radiator screen from the front of the radiator ([Figure 59](#)).

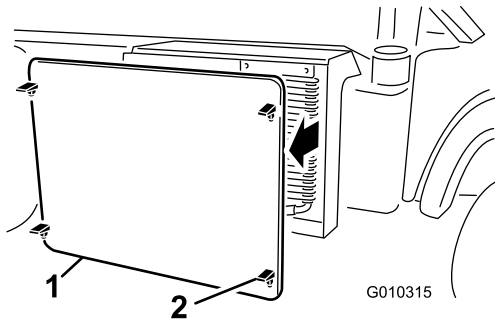
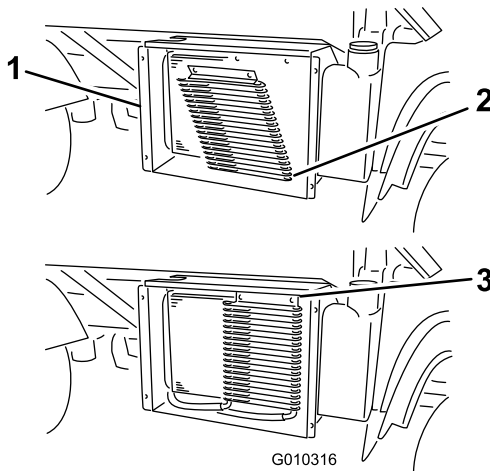

**Figure 59**

g010315

1. Radiator screen
2. Latch

3. If so equipped, rotate the latches and pivot the oil cooler away from the radiator ([Figure 60](#)).



**Figure 60**

g010316

1. Radiator housing
2. Oil cooler
3. Latches

4. Clean the radiator, oil cooler, and screen thoroughly with compressed air.

**Note:** Blow debris away from the radiator. Do not use water to clean external surfaces of the radiator.

5. Install the cooler and screen to the radiator.

## Changing the Engine Coolant

**Service Interval:** Every 1,000 hours/Every 2 years  
(whichever comes first)

**Coolant type:** 50/50 mixture of water and permanent ethylene-glycol antifreeze

**Note:** Multiple cycles of the following procedure may be required to properly flush and change the engine coolant.

1. Park the machine on a level surface.
2. Raise the bed (if so equipped) and place the safety support on the extended-lift cylinder to hold up the bed.

### ⚠ CAUTION

If the engine has been running, the pressurized, hot coolant can escape and cause burns.

- Do not open the reserve tank cap when the engine is running.
- Allow engine to cool at least 15 minutes or until the reserve tank cap is cool enough to touch without burning your hand.
- Use a rag when opening the reserve tank cap, and open the cap slowly to allow steam to escape.

3. Remove the radiator cap.

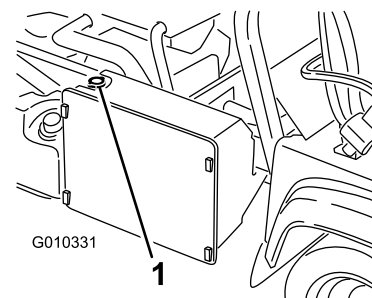

**Figure 61**

g010331

1. Radiator cap

4. Remove the reserve-tank cap ([Figure 62](#)).

# Brake Maintenance

## Adjusting the Parking Brake

**Service Interval:** After the first 10 hours

Every 200 hours

1. Remove the rubber grip from the parking-brake lever (Figure 63).

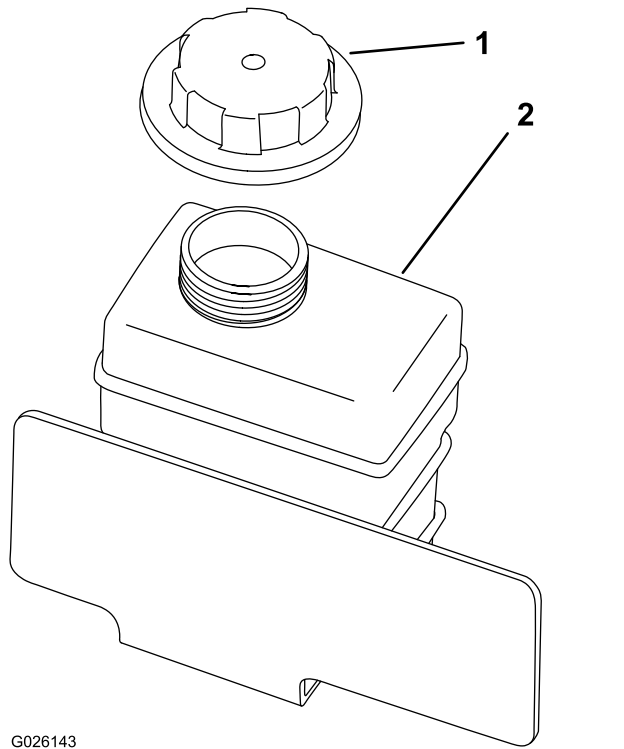

G026143

g026143

**Figure 62**

1. Reserve tank-cap
2. Reserve tank

5. Disconnect the lower radiator hose and allow coolant to flow into a drain pan.
6. When coolant stops, connect the lower radiator hose.
7. Remove the coolant-drain plug from the engine and allow coolant to flow into a drain pan.
8. When coolant stops, install the drain plug.
9. Slowly fill the radiator with a 50/50 mixture of water and permanent ethylene-glycol antifreeze.
10. Install the radiator cap.
11. Fill the reservoir tank to the bottom of the filler neck.
12. Start the engine and allow it to idle.
13. As air escapes, fill the reservoir to the bottom of the filler neck.

**Note:** Do not allow the engine to heat up to the running temperature.

14. Install the reserve-tank cap.
15. Run the machine until it reaches the operating temperature.
16. Turn off the machine and allow it to cool.
17. Check the coolant level again, and replenish it, if required.

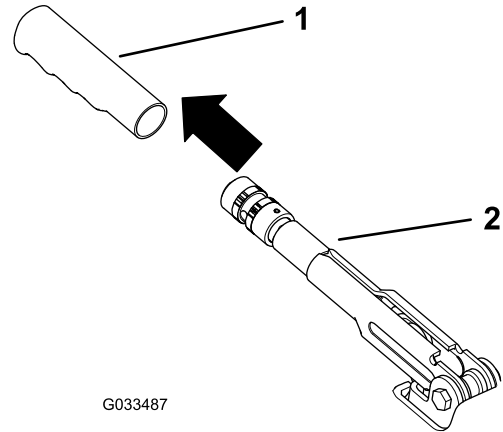

G033487

g033487

**Figure 63**

1. Grip
2. Parking-brake lever

2. Loosen the set screw securing the knob to the parking-brake lever (Figure 64).

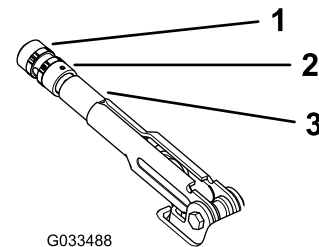

G033488

g033488

**Figure 64**

1. Knob
2. Set screw
3. Parking-brake lever

3. Rotate the knob until a force of 20 to 22 kg (45 to 50 lb) is required to actuate the lever.
4. Tighten the set screw when finished.

**Note:** If no adjustment is left at the handle, loosen the handle to the middle of the adjustment and adjust the cable at the rear, then repeat step 3.

5. Install the rubber grip onto the parking-brake lever.

# Adjusting the Brake Pedal

**Service Interval:** Every 200 hours

**Note:** Remove the front hood to ease the adjustment procedure.

1. Remove the cotter pin and clevis pin securing the master cylinder yoke to the brake-pedal pivot ([Figure 65](#)).

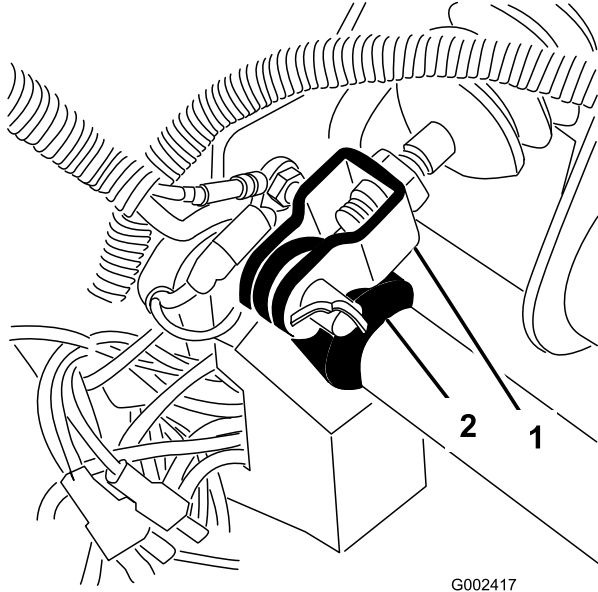

**Figure 65**

1. Master cylinder yoke
2. Brake-pedal pivot

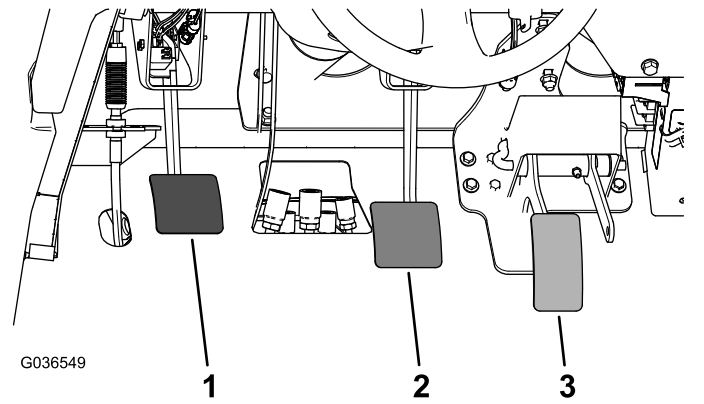

**Figure 66**

1. Clutch pedal
2. Brake pedal
3. Accelerator pedal

2. Lift up on the brake pedal ([Figure 66](#)) until it contacts the frame.
3. Loosen the jam nuts securing the yoke to the master cylinder shaft ([Figure 66](#)).
4. Adjust the yoke until its holes align with the hole in the brake-pedal pivot.
5. Secure the yoke to the pedal pivot with the clevis pin and cotter pin.
6. Tighten the jam nuts securing the yoke to the master cylinder shaft.

**Note:** The brake master cylinder must relieve pressure when properly adjusted.

# Belt Maintenance

## Adjusting the Alternator Belt

**Service Interval:** After the first 8 hours—Check the condition and tension of the alternator belt.

Every 200 hours—Check the condition and tension of the alternator belt.

1. Raise the bed (if equipped) and position the safety support on the extended-lift cylinder to hold up the bed.
2. Check the tension by pressing the belt at mid span between the crankshaft and alternator pulleys with 10 kg (22 lb) of force (Figure 67).

**Note:** A new belt should deflect 8 to 12 mm (0.3 to 0.5 inch).

**Note:** A used belt should deflect 10 to 14 mm (0.4 to 0.55 inch). If the deflection is incorrect, proceed to the next step. If correct, continue operation.

3. To adjust the belt tension, complete the following:
  - A. Loosen the 2 alternator-mounting bolts (Figure 67).

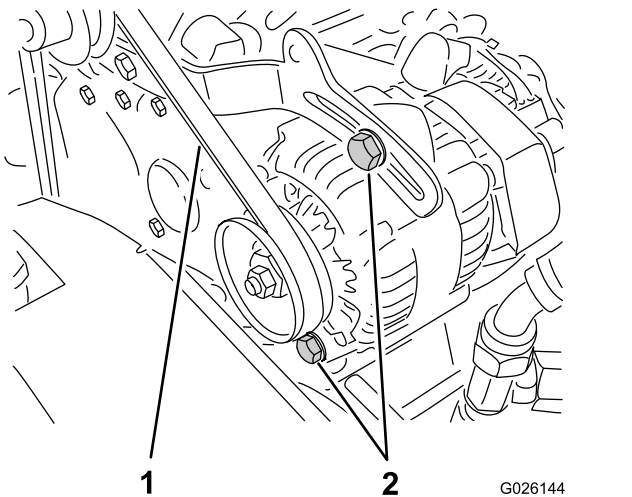

Figure 67

1. Alternator belt
2. Alternator-mounting bolts

- B. Using a pry bar, rotate the alternator until the proper belt tension is attained, then tighten the mounting bolts (Figure 67).

# Controls System Maintenance

## Adjusting the Accelerator Pedal

1. Park the machine on a level surface, engage the parking brake, shut off the engine, and remove the key.
2. Adjust the ball joint on the accelerator cable (Figure 68) to allow 2.54 to 6.35 mm (0.100 to 0.250 inch) of clearance between the accelerator-pedal arm and the top of the diamond tread floor plate (Figure 69), when a 11.3 kg (25 lb) force is applied to the center of the pedal.

**Note:** The engine must not be running and the return spring must be attached.

3. Tighten the locknut (Figure 68).

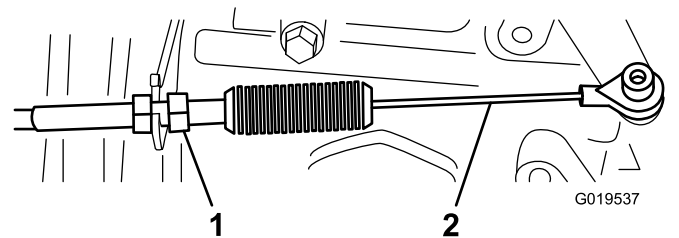

Figure 68

1. Locknut
2. Accelerator cable

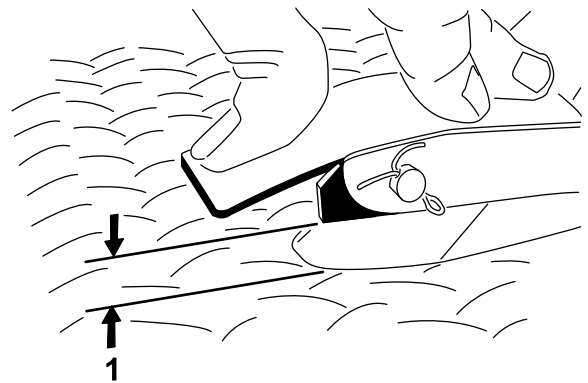

Figure 69

1. 2.54 to 6.35 mm (0.100 to 0.250 inch) clearance

**Important:** The maximum high-idle speed is 3,650 rpm. Do not adjust the high-idle stop.

# Adjusting the Clutch Pedal

**Service Interval:** Every 200 hours

**Note:** You can adjust the clutch-pedal cable at the bell housing or at the clutch-pedal pivot. You can remove the front hood to ease the access to the pedal pivot.

1. Loosen the jam nuts securing the clutch cable to the bracket on the bell housing (Figure 70).

**Note:** You may remove and rotate the ball joint if additional adjustment is required.

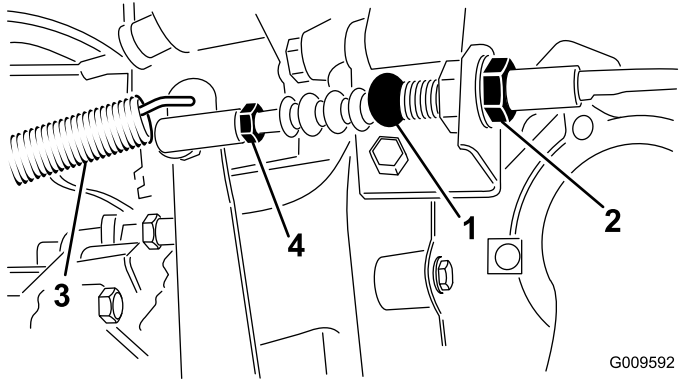

**Figure 70**

- |                 |                  |
|-----------------|------------------|
| 1. Clutch cable | 3. Return spring |
| 2. Jam nuts     | 4. Ball joint    |

2. Disconnect the return spring from the clutch lever.
3. Adjust the jam nuts or ball joint until the rear edge of the clutch pedal is 9.2 to 9.8 cm (3-5/8 to 3-7/8 inches) from the top of the floor plate diamond pattern, when an 1.8 kg (4 lb) force is applied to the pedal (Figure 71).

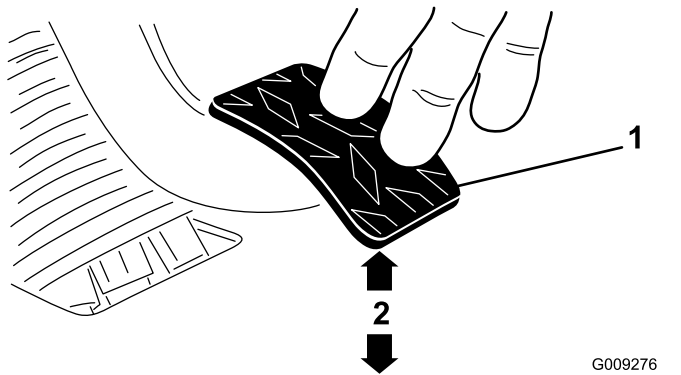

**Figure 71**

- |                 |  |
|-----------------|--|
| 1. Clutch pedal | 2. 9.2 to 9.8 cm (3-5/8 to 3-7/8 inches) |
|-----------------|--|

**Note:** Force is applied so the clutch release bearing lightly contacts the pressure plate fingers.

4. Tighten the jam nuts after the adjustment has been attained.

5. Check the 9.2 to 9.8 cm (3-5/8 to 3-7/8 inches) dimension after the jam nuts have been tightened to ensure proper adjustment.

**Note:** Adjust again if it is necessary.

6. Connect the return spring to the clutch lever.

**Important:** Ensure that the rod end is positioned squarely on the ball, not twisted, and remains parallel to the clutch pedal after the jam nut is tightened (Figure 72).

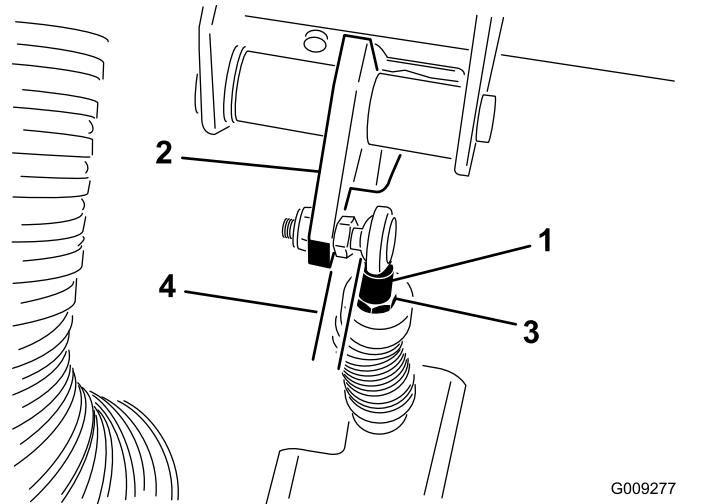

**Figure 72**

- |                         |                    |
|-------------------------|--------------------|
| 1. Clutch-cable rod end | 3. Rod end jam nut |
| 2. Clutch pedal         | 4. Parallel        |

**Note:** The clutch free play should never be less than 19 mm (3/4 inch).

## Converting the Speedometer

You can convert the speedometer from mph to km/h or km/h to mph.

1. Park the machine on a level surface, engage the parking brake, shut off the engine, and remove the key.
2. Remove the hood; refer to [Removing the Hood \(page 41\)](#).
3. Locate the 2 loose wires next to the speedometer.
4. Remove the connector plug from the harness wire and connect the wires together.

**Note:** The speedometer switches to km/h or mph.

5. Install the hood.

# Hydraulic System Maintenance

## Changing the Hydraulic Fluid and Cleaning the Strainer

**Service Interval:** Every 800 hours

**Hydraulic-fluid capacity:** 7 L (7.5 US qt)

**Hydraulic-fluid type:** Dexron III ATF

1. Park the machine on a level surface, engage the parking brake, shut off the engine, and remove the key.
2. Remove the drain plug from the side of the reservoir, and let the hydraulic fluid flow into a drain pan (Figure 73).

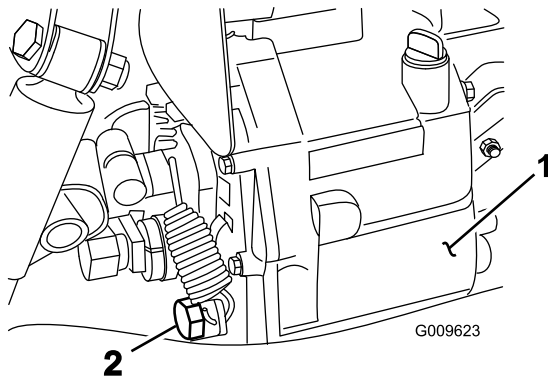
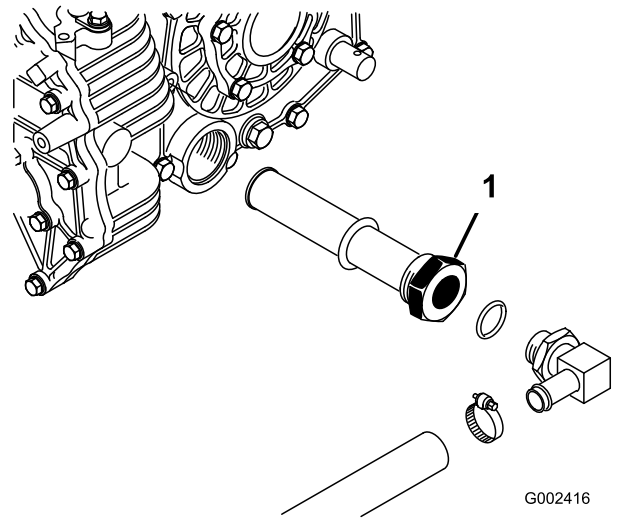

**Figure 73**

1. Hydraulic reservoir
2. Drain plug

3. Note the orientation of the hydraulic hose and 90° fitting connected to the strainer on the side of the reservoir (Figure 74).
4. Remove the hydraulic hose and 90° fitting.
5. Remove the strainer and clean it by back flushing it with a clean de-greaser.

**Note:** Allow it to air dry before installing.



**Figure 74**

1. Hydraulic strainer
6. Install the strainer.
7. Install the hydraulic hose and 90° fitting to the strainer in the same orientation.
8. Install and tighten the drain plug.
9. Fill the reservoir with approximately 7 L (7.5 US qt) of the specified hydraulic fluid; refer to [Checking the Transaxle/Hydraulic-Fluid Level](#) (page 25).
10. Start the engine and operate the machine to fill the hydraulic system.
11. Check the hydraulic-fluid level and replenish it, if required.

**Important:** Use only the hydraulic fluid specified. Other fluids could damage the system.



# Replacing the Hydraulic Filter

**Service Interval:** After the first 10 hours

Every 800 hours

**Important:** Use of any other filter may void the warranty on some components.

1. Park the machine on a level surface, engage the parking brake, shut off the engine, and remove the key.
2. Clean the area around the filter-mounting area.
3. Place a drain pan under the filter and remove the filter (Figure 75).

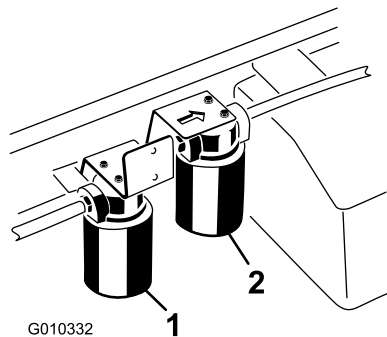

**Figure 75**

1. Hydraulic filter
2. High-flow hydraulic filter

4. Lubricate the gasket on the new filter.
5. Ensure that the filter mounting area is clean.
6. Screw the filter on until the gasket contacts the mounting plate, and tighten the filter 1/2 turn.
7. Start the engine and let it run for about 2 minutes to purge air from the system.
8. Shut off the engine and check the hydraulic-fluid level and for leaks.

## Changing the High-Flow Hydraulic Fluid and Filter TC Models Only

**Service Interval:** After the first 10 hours—Change the high-flow hydraulic fluid filter (TC models only).

Every 800 hours—Change the high-flow hydraulic fluid and filter (TC models only).

**Hydraulic-fluid capacity:** approximately 15 L (4 US gallons)

**Hydraulic-fluid type:** Toro Premium All Season Hydraulic Fluid (Available in 5 gallon pails or 55 gallon drums. See parts catalog or Toro distributor for part numbers.)

**Alternate fluids:** If the Toro fluid is not available, another conventional petroleum-based fluid may be used provided it meets the following material properties and industry specifications. Consult with your lubricant distributor to identify a satisfactory product.

**Note:** Toro will not assume responsibility for damage caused by improper substitutions, so use only products from reputable manufacturers who will stand behind their recommendation.

### High Viscosity Index/Low Pour Point Antiwear Hydraulic Fluid, ISO VG 46

#### Material Properties:

- Viscosity—ASTM D445 cSt @ 40°C: 44 to 48/cSt @ 100°C: 7.9 to 8.5
- Viscosity Index, ASTM D2270—140 to 152
- Pour Point, ASTM D97— -35°F to -46°F
- FZG, Fail stage—11 or better
- Water content (new fluid)—500 ppm (maximum)

#### Industry Specifications:

Vickers I-286-S, Vickers M-2950-S, Denison HF-0, Vickers 35 VQ 25 (Eaton ATS373-C)

**Note:** Many hydraulic fluids are almost colorless, making it difficult to spot leaks. A red dye additive for the hydraulic system fluid is available in 20 ml (0.67 oz) bottles. A bottle is sufficient for 15 to 22 L (4 to 6 US gallons) of hydraulic fluid. Order Part No. 44-2500 from your authorized Toro distributor.

**Note:** If the fluid becomes contaminated, contact your local Toro distributor because the system must be flushed. Contaminated fluid may look milky or black when compared to clean fluid. The service interval may need to be increased if using multiple attachments as the fluid may become contaminated quicker with the mixing of different hydraulic fluids.

1. Clean the area around the high-flow-filter mounting area (Figure 75).
2. Place a drain pan under the filter and remove the filter.

**Note:** If the fluid is not going to be drained, disconnect and plug the hydraulic line going to the filter.

3. Lubricate the new filter-sealing gasket and hand turn the filter onto the filter head until the gasket contacts the filter head. Then tighten it 3/4 turn further. The filter should now be sealed.
4. Fill the hydraulic reservoir with approximately 15 L (4 US gallons) of hydraulic fluid.
5. Start the machine and run it at idle for about 2 minutes to circulate the fluid and remove any air trapped in the system.
6. Stop the machine and check the fluid level.

7. Verify the fluid level.
8. Dispose of the fluid properly.

## Raising the Cargo Box in an Emergency

The cargo box can be raised in an emergency without starting the engine by cranking starter or by jumping the hydraulic system.

### Raising the Cargo Box using the Starter

Crank the starter while holding the lift lever in the Raise position. Run the starter for 10 seconds, then wait 60 seconds before engaging the starter again. If the engine does not crank, you must remove the load and box (attachment) to service the engine or transaxle.

### Raising the Cargo Box by Jumping the Hydraulic System

#### ⚠ CAUTION

A raised bed full of material without the proper safety support rod may lower unexpectedly. Working under an unsupported raised bed may cause injury to you or others.

- Before servicing or making adjustments to the machine, park the machine on a level surface, engage the parking brake, shut off the engine, and remove the key.
- Remove any load material from the bed or other attachment and insert the safety support on a fully extended cylinder rod before working under a raised bed.

You will need 2 hydraulic hoses, each with a male and female quick coupler, that fit the machine couplers, to perform this operation.

1. Back another machine up to the rear of the disabled machine.

**Important:** The machine hydraulic system uses Dexron III ATF. To avoid system contamination, make sure that the machine used to jump the hydraulic system uses an equivalent fluid.

2. On both machine, disconnect the 2 quick-coupler hoses from the hoses secured to the coupler bracket (Figure 76).

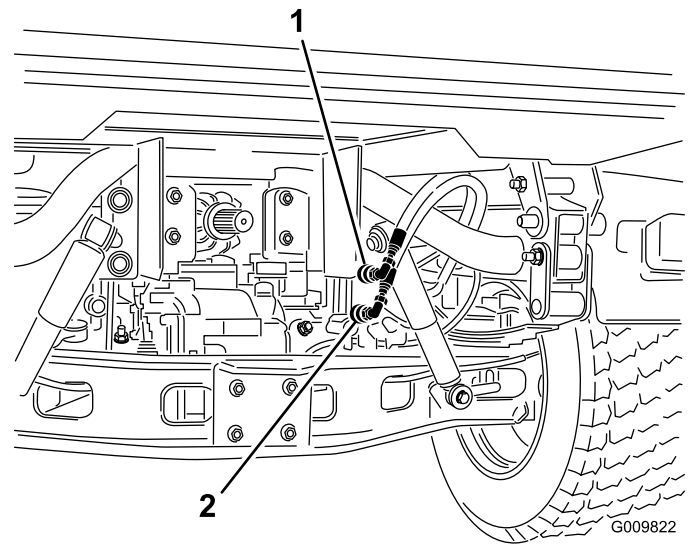

Figure 76

1. Quick-coupler hose A
2. Quick-coupler hose B

3. On the disabled machine, connect the 2 jumper hoses to the hoses that were disconnected (Figure 77).
4. Cap the unused fittings.

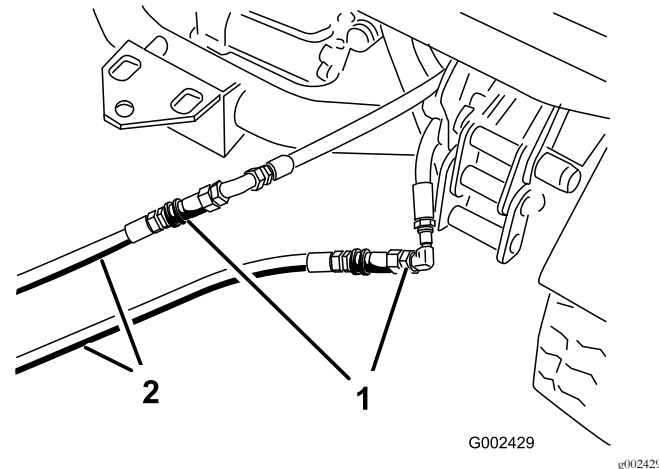
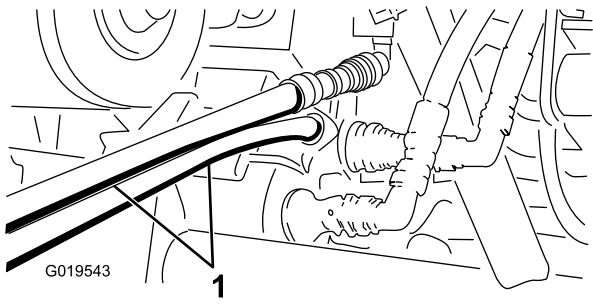

Figure 77

1. Disconnected hoses
2. Jumper hoses

5. On the other machine, connect the 2 hoses to the coupler still in the coupler bracket (connect the top hose to the top coupler and the bottom hose to the bottom coupler) (Figure 78).
6. Cap the unused fittings.



**Figure 78**

g019543

1. Jumper hoses

---

7. Keep all bystanders away from the machines.
8. Start the second machine and move the lift lever to the raise position, which raises the disabled cargo box.
9. Move the hydraulic-lift lever to the NEUTRAL position, and engage the lift-lever lock.
10. Install the bed support onto the extended lift cylinder; refer to [Using the Bed Support \(page 38\)](#).

**Note:** With both the machine turned off, move the lift lever back and forth to remove the system pressure and ease the disconnection of the quick couplers.

11. After completing the operation, remove the jumper hoses and connect the hydraulic hoses to both machines.

**Important:** Check the hydraulic fluid levels, in both machines, before resuming operation.

# Cleaning

## Washing the Machine

Wash the machine as needed. Use water alone or with a mild detergent. You may use a rag when washing the machine.

**Important:** Do not use power-washing equipment to wash the machine. Power-washing equipment may damage the electrical system, loosen important decals, or wash away necessary grease at friction points. Avoid excessive use of water near the control panel, engine, and battery.

**Important:** Do not wash the machine with the engine running. Washing the machine with the engine running may result in internal engine damage.

# Storage

1. Park the machine on a level surface, engage the parking brake, shut off the engine, and remove the key.
2. Clean dirt and grime from the entire machine, including the outside of the engine cylinder head fins and blower housing.
3. Inspect the brakes; refer to [Checking the Brake-Fluid Level \(page 28\)](#).
4. Service the air cleaner; refer to [Servicing the Air Cleaner \(page 44\)](#).
5. Seal the air cleaner inlet and the exhaust outlet with weatherproof tape.
6. Grease the machine; refer to [Greasing the Bearings and Bushings \(page 42\)](#).
7. Change the engine oil and filter; refer to [Changing the Engine Oil and Filter \(page 44\)](#).
8. Flush the fuel tank with fresh, clean diesel fuel.
9. Secure all fuel system fittings.
10. Check the tire pressure; refer to [Checking the Tire Pressure \(page 27\)](#).
11. Check anti freeze protection and add a 50/50 solution of water and anti freeze as needed for expected minimum temperature in your area.
12. Remove the battery from the chassis, check the electrolyte level, and charge it fully; refer to [Servicing the Battery \(page 48\)](#).

**Note:** Do not connect the battery cables to the battery posts during storage.

**Important:** The battery must be fully charged to prevent it from freezing and being damaged at temperatures below 0°C (32°F). A fully charged battery maintains its charge for about 50 days at temperatures lower than 4°C (40°F). If the temperatures will be above 4°C (40°F), check the water level in the battery and charge it every 30 days.

13. Check and tighten all bolts, nuts, and screws. Repair or replace any part that is damaged.
14. Paint all scratched or bare metal surfaces.  
Paint is available from your Authorized Toro Service Dealer.
15. Store the machine in a clean, dry garage or storage area.
16. Cover the machine to protect it and keep it clean.

**Notes:**

**Notes:**

## **European Privacy Notice**

### **The Information Toro Collects**

Toro Warranty Company (Toro) respects your privacy. In order to process your warranty claim and contact you in the event of a product recall, we ask you to share certain personal information with us, either directly or through your local Toro company or dealer.

The Toro warranty system is hosted on servers located within the United States where privacy law may not provide the same protection as applies in your country.

**BY SHARING YOUR PERSONAL INFORMATION WITH US, YOU ARE CONSENTING TO THE PROCESSING OF YOUR PERSONAL INFORMATION AS DESCRIBED IN THIS PRIVACY NOTICE.**

### **The Way Toro Uses Information**

Toro may use your personal information to process warranty claims, to contact you in the event of a product recall and for any other purpose which we tell you about. Toro may share your information with Toro's affiliates, dealers or other business partners in connection with any of these activities. We will not sell your personal information to any other company. We reserve the right to disclose personal information in order to comply with applicable laws and with requests by the appropriate authorities, to operate our systems properly or for our own protection or that of other users.

### **Retention of your Personal Information**

We will keep your personal information as long as we need it for the purposes for which it was originally collected or for other legitimate purposes (such as regulatory compliance), or as required by applicable law.

### **Toro's Commitment to Security of Your Personal Information**

We take reasonable precautions in order to protect the security of your personal information. We also take steps to maintain the accuracy and current status of personal information.

### **Access and Correction of your Personal Information**

If you would like to review or correct your personal information, please contact us by email at [legal@toro.com](mailto:legal@toro.com).

## **Australian Consumer Law**

Australian customers will find details relating to the Australian Consumer Law either inside the box or at your local Toro Dealer.



# The Toro Warranty

## A Two-Year Limited Warranty

### Conditions and Products Covered

The Toro Company and its affiliate, Toro Warranty Company, pursuant to an agreement between them, jointly warrant your Toro Commercial product ("Product") to be free from defects in materials or workmanship for two years or 1500 operational hours\*, whichever occurs first. This warranty is applicable to all products with the exception of Aerators (refer to separate warranty statements for these products). Where a warrantable condition exists, we will repair the Product at no cost to you including diagnostics, labor, parts, and transportation. This warranty begins on the date the Product is delivered to the original retail purchaser.

\* Product equipped with an hour meter.

### Instructions for Obtaining Warranty Service

You are responsible for notifying the Commercial Products Distributor or Authorized Commercial Products Dealer from whom you purchased the Product as soon as you believe a warrantable condition exists. If you need help locating a Commercial Products Distributor or Authorized Dealer, or if you have questions regarding your warranty rights or responsibilities, you may contact us at:

Toro Commercial Products Service Department  
Toro Warranty Company  
8111 Lyndale Avenue South  
Bloomington, MN 55420-1196  
952-888-8801 or 800-952-2740  
E-mail: commercial.warranty@toro.com

### Owner Responsibilities

As the Product owner, you are responsible for required maintenance and adjustments stated in your *Operator's Manual*. Failure to perform required maintenance and adjustments can be grounds for disallowing a warranty claim.

### Items and Conditions Not Covered

Not all product failures or malfunctions that occur during the warranty period are defects in materials or workmanship. This warranty does not cover the following:

- Product failures which result from the use of non-Toro replacement parts, or from installation and use of add-on, or modified non-Toro branded accessories and products. A separate warranty may be provided by the manufacturer of these items.
- Product failures which result from failure to perform recommended maintenance and/or adjustments. Failure to properly maintain your Toro product per the Recommended Maintenance listed in the *Operator's Manual* can result in claims for warranty being denied.
- Product failures which result from operating the Product in an abusive, negligent, or reckless manner.
- Parts subject to consumption through use unless found to be defective. Examples of parts which are consumed, or used up, during normal Product operation include, but are not limited to, brake pads and linings, clutch linings, blades, reels, rollers and bearings (sealed or greasable), bed knives, spark plugs, castor wheels and bearings, tires, filters, belts, and certain sprayer components such as diaphragms, nozzles, and check valves, etc.
- Failures caused by outside influence. Conditions considered to be outside influence include, but are not limited to, weather, storage practices, contamination, use of unapproved fuels, coolants, lubricants, additives, fertilizers, water, or chemicals, etc.
- Failure or performance issues due to the use of fuels (e.g. gasoline, diesel, or biodiesel) that do not conform to their respective industry standards.

### Countries Other than the United States or Canada

Customers who have purchased Toro products exported from the United States or Canada should contact their Toro Distributor (Dealer) to obtain guarantee policies for your country, province, or state. If for any reason you are dissatisfied with your Distributor's service or have difficulty obtaining guarantee information, contact the Toro importer.

- Normal noise, vibration, wear and tear, and deterioration.
- Normal "wear and tear" includes, but is not limited to, damage to seats due to wear or abrasion, worn painted surfaces, scratched decals or windows, etc.

### Parts

Parts scheduled for replacement as required maintenance are warranted for the period of time up to the scheduled replacement time for that part. Parts replaced under this warranty are covered for the duration of the original product warranty and become the property of Toro. Toro will make the final decision whether to repair any existing part or assembly or replace it. Toro may use remanufactured parts for warranty repairs.

### Deep Cycle and Lithium-Ion Battery Warranty:

Deep cycle and Lithium-Ion batteries have a specified total number of kilowatt-hours they can deliver during their lifetime. Operating, recharging, and maintenance techniques can extend or reduce total battery life. As the batteries in this product are consumed, the amount of useful work between charging intervals will slowly decrease until the battery is completely worn out. Replacement of worn out batteries, due to normal consumption, is the responsibility of the product owner. Battery replacement may be required during the normal product warranty period at owner's expense. Note: (Lithium-Ion battery only): A Lithium-Ion battery has a part only prorated warranty beginning year 3 through year 5 based on the time in service and kilowatt hours used. Refer to the *Operator's Manual* for additional information.

### Maintenance is at Owner's Expense

Engine tune-up, lubrication, cleaning and polishing, replacement of filters, coolant, and completing recommended maintenance are some of the normal services Toro products require that are at the owner's expense.

### General Conditions

Repair by an Authorized Toro Distributor or Dealer is your sole remedy under this warranty.

**Neither The Toro Company nor Toro Warranty Company is liable for indirect, incidental or consequential damages in connection with the use of the Toro Products covered by this warranty, including any cost or expense of providing substitute equipment or service during reasonable periods of malfunction or non-use pending completion of repairs under this warranty. Except for the Emissions warranty referenced below, if applicable, there is no other express warranty. All implied warranties of merchantability and fitness for use are limited to the duration of this express warranty.**

Some states do not allow exclusions of incidental or consequential damages, or limitations on how long an implied warranty lasts, so the above exclusions and limitations may not apply to you. This warranty gives you specific legal rights, and you may also have other rights which vary from state to state.

### Note regarding engine warranty:

The Emissions Control System on your Product may be covered by a separate warranty meeting requirements established by the U.S. Environmental Protection Agency (EPA) and/or the California Air Resources Board (CARB). The hour limitations set forth above do not apply to the Emissions Control System Warranty. Refer to the Engine Emission Control Warranty Statement supplied with your product or contained in the engine manufacturer's documentation for details