



## Brake Cable Kit

### 21in Heavy-Duty Recycler®/Rear Bagger Lawn Mower

Model No. 133-2680

Model No. 136-7000

## Installation Instructions

Use the appropriate kit for your lawn mower model as follows:

- Lawn mower model no. 22295—kit no. 133-2680
- Lawn mower model no. 22297—kit no. 136-7000

### ⚠ WARNING

#### CALIFORNIA

#### Proposition 65 Warning

This product contains a chemical or chemicals known to the State of California to cause cancer, birth defects, or reproductive harm.

# Installation

## Loose Parts

Use the chart below to verify that all parts have been shipped.

| Procedure | Description  | Qty. | Use                      |
|-----------|--------------|------|--------------------------|
| <b>2</b>  | Brake cable  | 1    | Install the brake cable. |
|           | Cable anchor | 1    |                          |
|           | Screw        | 1    |                          |

# 1

## Removing the Brake Cable

### No Parts Required

### Procedure

1. Shut off the engine and wait for all moving parts to stop.
2. Disconnect the spark-plug wire from the spark plug.
3. Disconnect the brake cable from the blade-control bar (Figure 1 or Figure 2 as appropriate for your kit); keep the bolt and the nut.

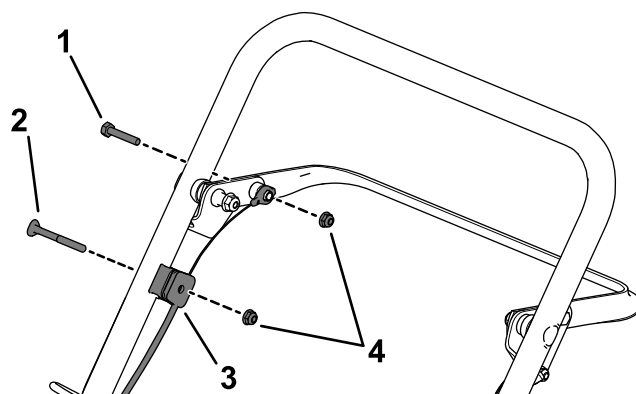

**Figure 1**  
Kit 133-2680

- |                    |                 |
|--------------------|-----------------|
| 1. Bolt (keep)     | 3. Cable anchor |
| 2. Screw (discard) | 4. Nut (keep)   |



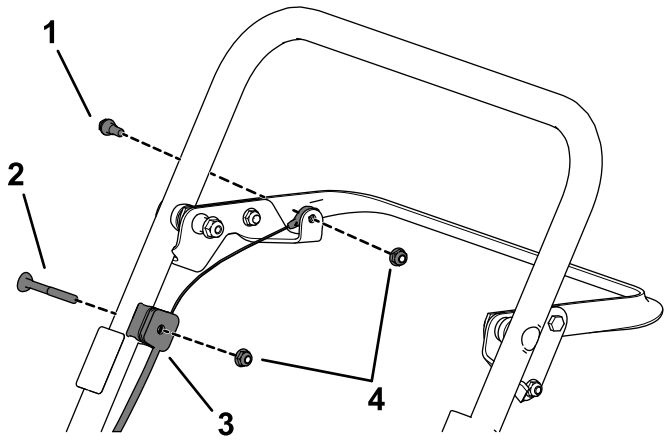

g187414

**Figure 2**  
Kit 136-7000

- |                    |                 |
|--------------------|-----------------|
| 1. Bolt (keep)     | 3. Cable anchor |
| 2. Screw (discard) | 4. Nut (keep)   |

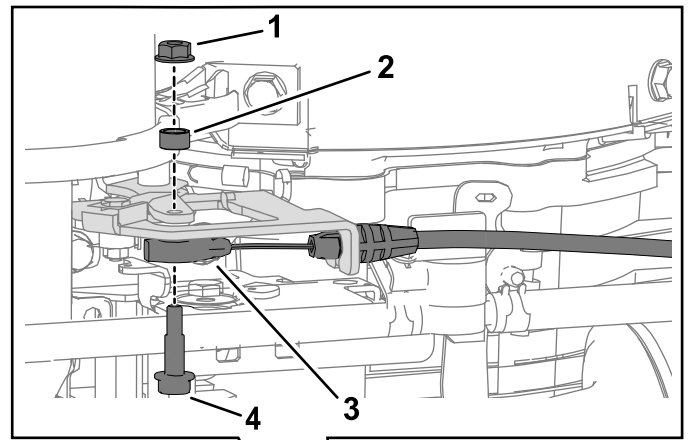

g187634

**Figure 4**  
Kit 136-7000

- |           |                |
|-----------|----------------|
| 1. Nut    | 3. Brake cable |
| 2. Spacer | 4. Bolt        |

- 
4. Disconnect the brake cable from the cable anchor (Figure 1 or Figure 2 as appropriate for your kit); discard the screw, but keep the nut.
  5. Disconnect the brake cable from the engine (Figure 3 or Figure 4 as appropriate for your kit), then discard it.

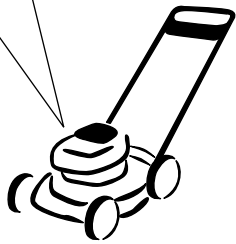
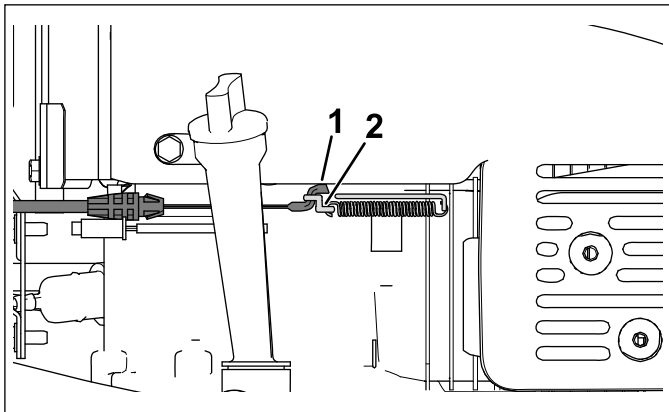

g187780

**Figure 3**  
Kit 133-2680

- |                |                               |
|----------------|-------------------------------|
| 1. Brake cable | 2. Engine connection location |
|----------------|-------------------------------|

# 2

## Installing and Adjusting the Brake Cable

### Parts needed for this procedure:

|   |              |
|---|--------------|
| 1 | Brake cable  |
| 1 | Cable anchor |
| 1 | Screw        |

### Installing the Brake Cable

**Important:** If you are installing this kit on a machine with serial numbers 400000000–999999999, skip steps 1 and 2.

1. Locate the cable anchor's post and cut it at the indicated location on [Figure 5](#).

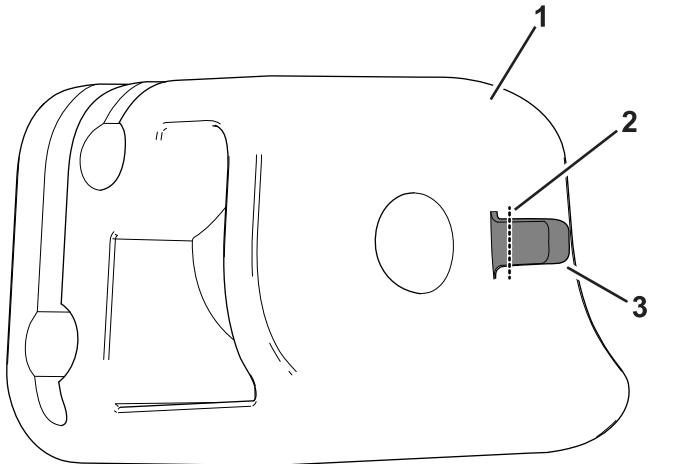
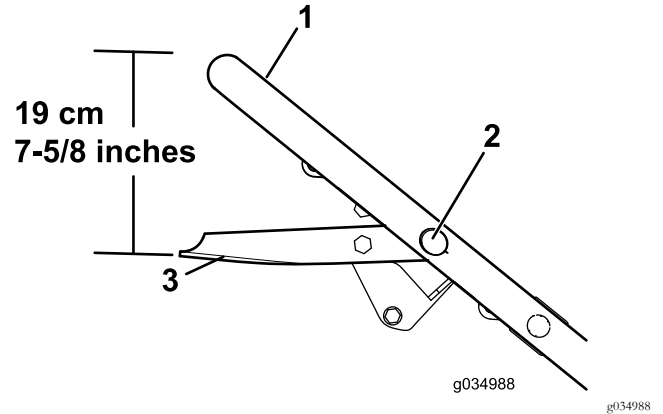

**Figure 5**

1. Cable anchor
2. Cut location
3. Post

## Adjusting the Brake Cable

1. Hold the blade-control bar at 19 cm (7-5/8 inches) from the top of the handle as shown in [Figure 6](#).



**Figure 6**

1. Handle
2. Cable-anchor nut
3. Blade-control bar

2. Pull down on the cable conduit to remove the slack from the brake cable.
3. Tighten the cable-anchor nut.
4. Release the blade-control bar and verify that there is slack in the brake cable.

2. Remove the remaining piece of the post from the cable anchor.
3. Attach the cable anchor to the brake cable.
4. Attach the brake cable to the blade-control bar ([Figure 1](#) or [Figure 2](#) as appropriate for your kit) using the bolt and the nut that you previously removed.
5. Secure the cable anchor to the handle ([Figure 1](#) or [Figure 2](#) as appropriate for your kit) using a screw (included in the kit) and the nut that you previously removed.
6. Route the brake cable between the handle and the deck.
7. Attach the brake cable to the engine ([Figure 3](#) or [Figure 4](#) as appropriate for your kit).



**Count on it.**