



# Electric Lift Kit

## Workman® GTX Utility Vehicle

Model No. 07143—Serial No. 316000001 and Up

Model No. 07144—Serial No. 316000001 and Up

### Installation Instructions

#### ⚠ WARNING

##### CALIFORNIA Proposition 65 Warning

This product contains a chemical or chemicals known to the State of California to cause cancer, birth defects, or reproductive harm.

**Note:** Reuse any mounting hardware that you removed and is not replaced with hardware from the kit.

## Preparing the Machine

1. Park the machine on a level surface.
2. Engage the parking brake.
3. Shut off the engine and remove the key from the key switch.

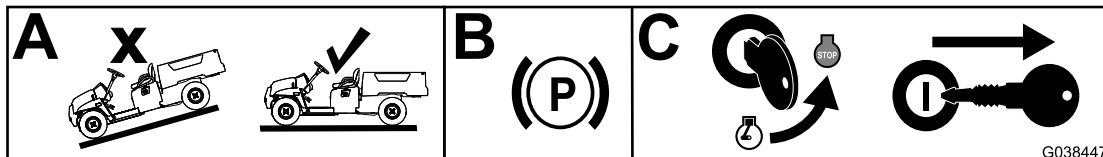

G038447

g038447



# Placing the Bed into the Service Position

**Note:** If the draw bar is installed on the machine, you must remove it before placing the bed into the service position.

Insert the prop rod into the service position.

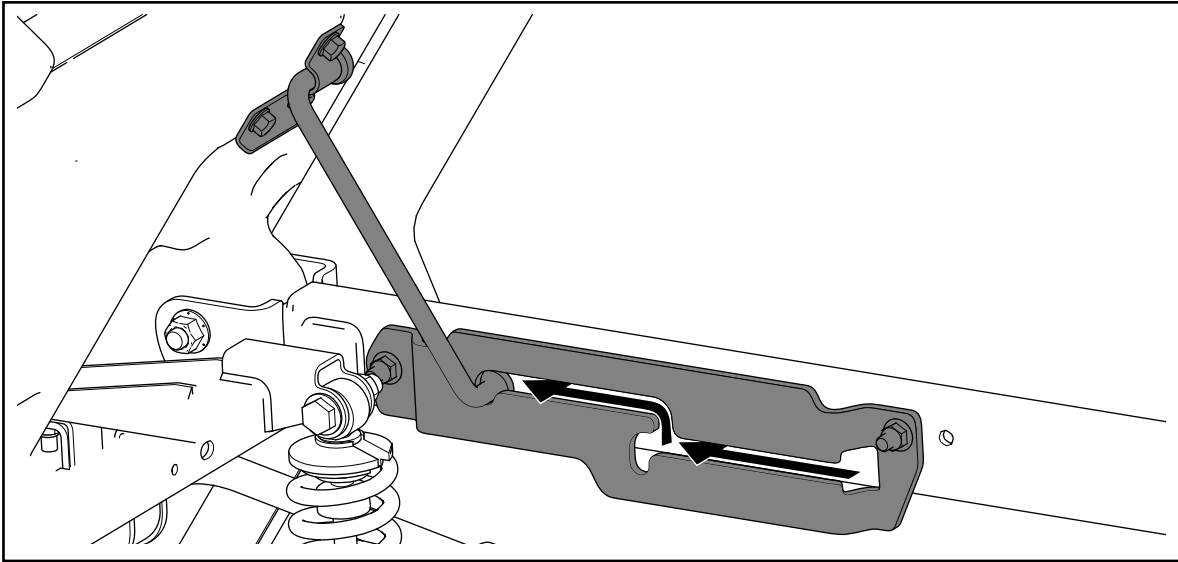
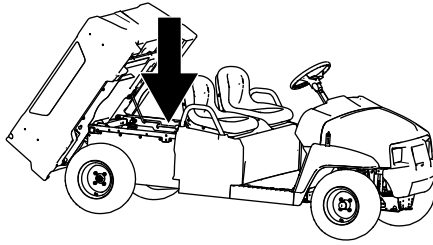

g036022

g036022

# Installing the Lift Bracket

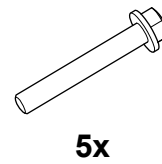
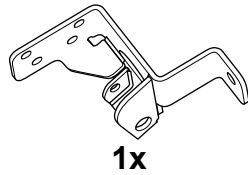

1. Remove the existing bolt and nut from the rear-frame tube.

**Note:** Discard the bolt and nut.

2. Remove the 2 existing plastic rivets from the rear-frame tube.

**Note:** Retain the 2 plastic rivets.

3. Install the lift bracket to the rear-frame tube using the 5 flange-head bolts ( $3/8 \times 2\text{-}1/2$  inches) and 5 flange nuts ( $3/8$  inch).

4. Install the 2 previously removed plastic rivets into the rear-frame tube.

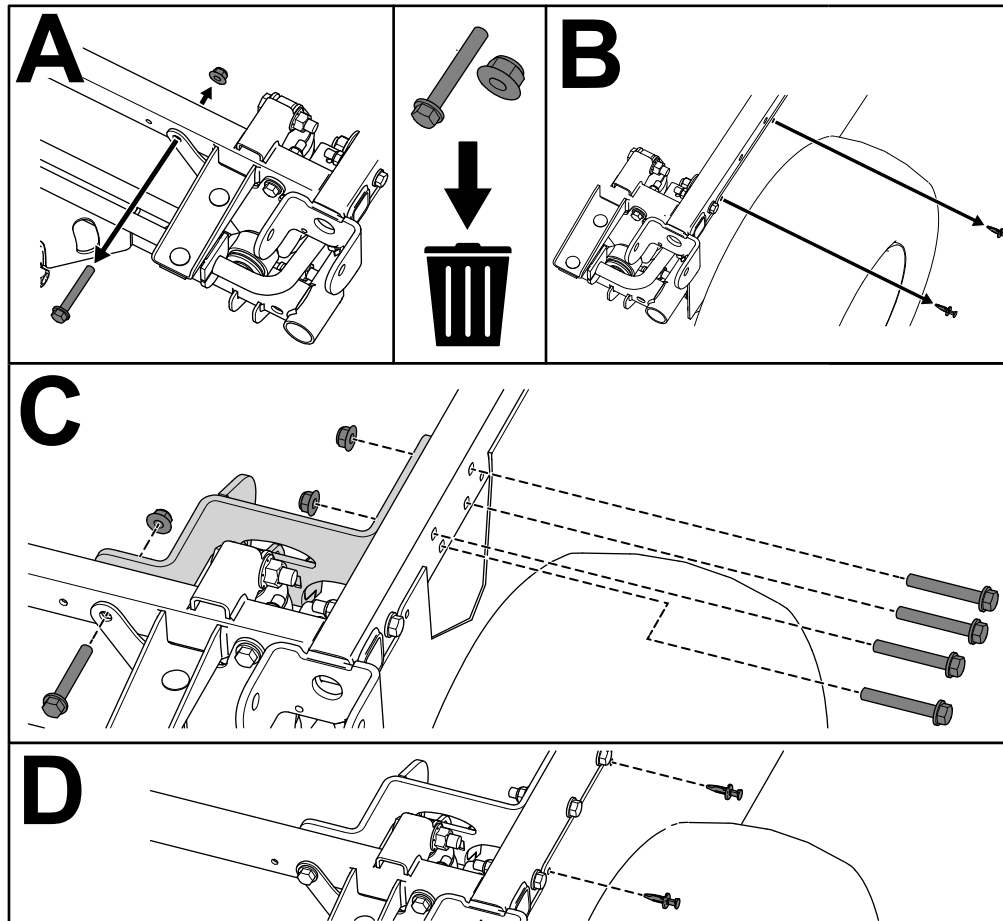
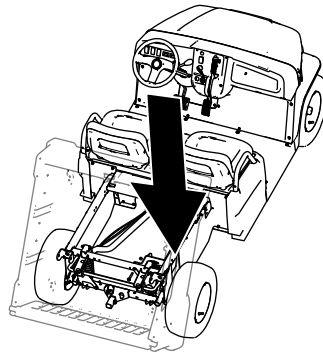

# Installing the Lift Latch

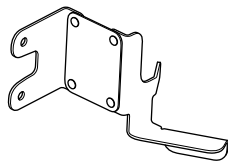

1x

1. Remove the 2 existing bolts from the cargo-bed lever.
2. Install the lift latch to the cargo-bed lever using the 2 previously removed bolts, and torque the bolts to 15 to 16 N·m (11 to 12 ft-lb).

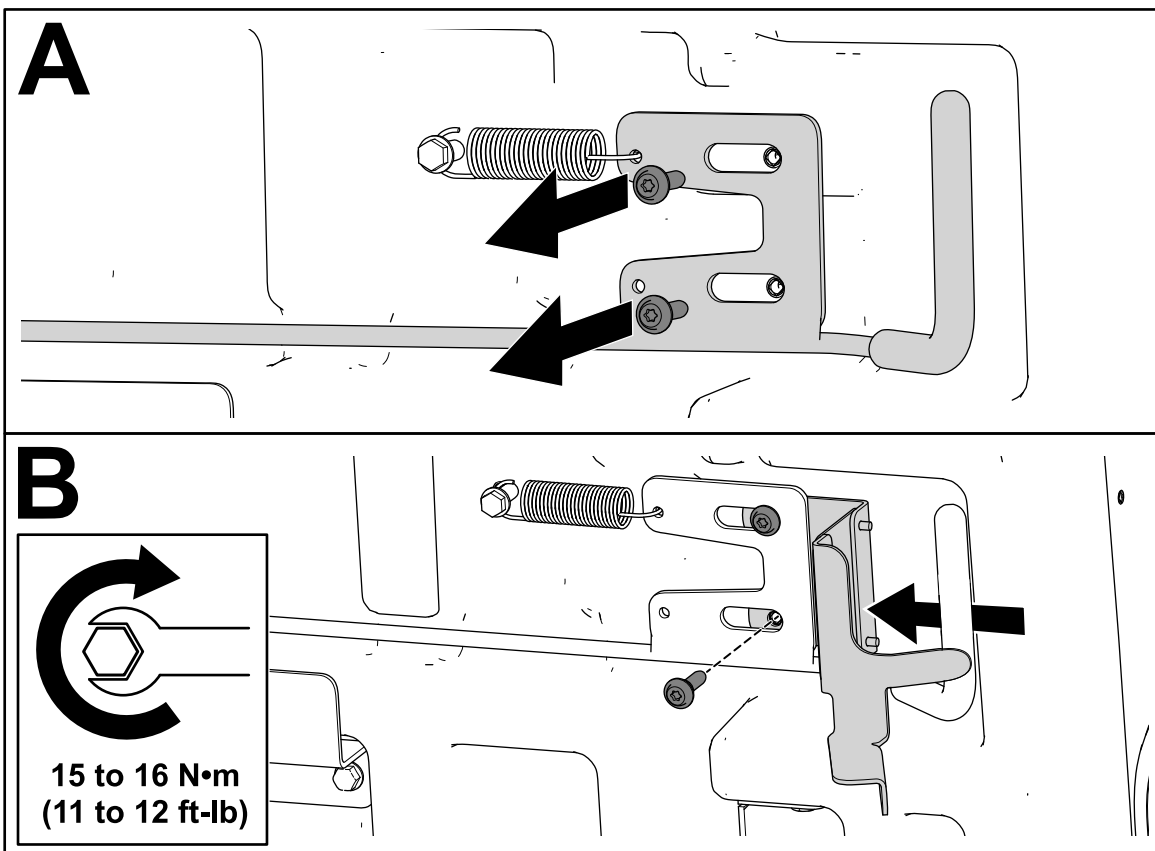
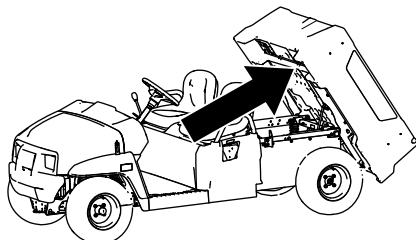

g035996

g035996

# Installing the Lift Plate

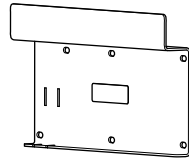

1x

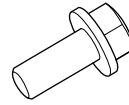

6x

1. Remove the 6 existing bolts and bed braces from the cargo bed.

**Note:** Discard the bolts and bed braces.

2. Install the lift plate to the cargo bed using the 6 bolts, and torque the bolts to 15 to 16 N·m (11 to 12 ft-lb).

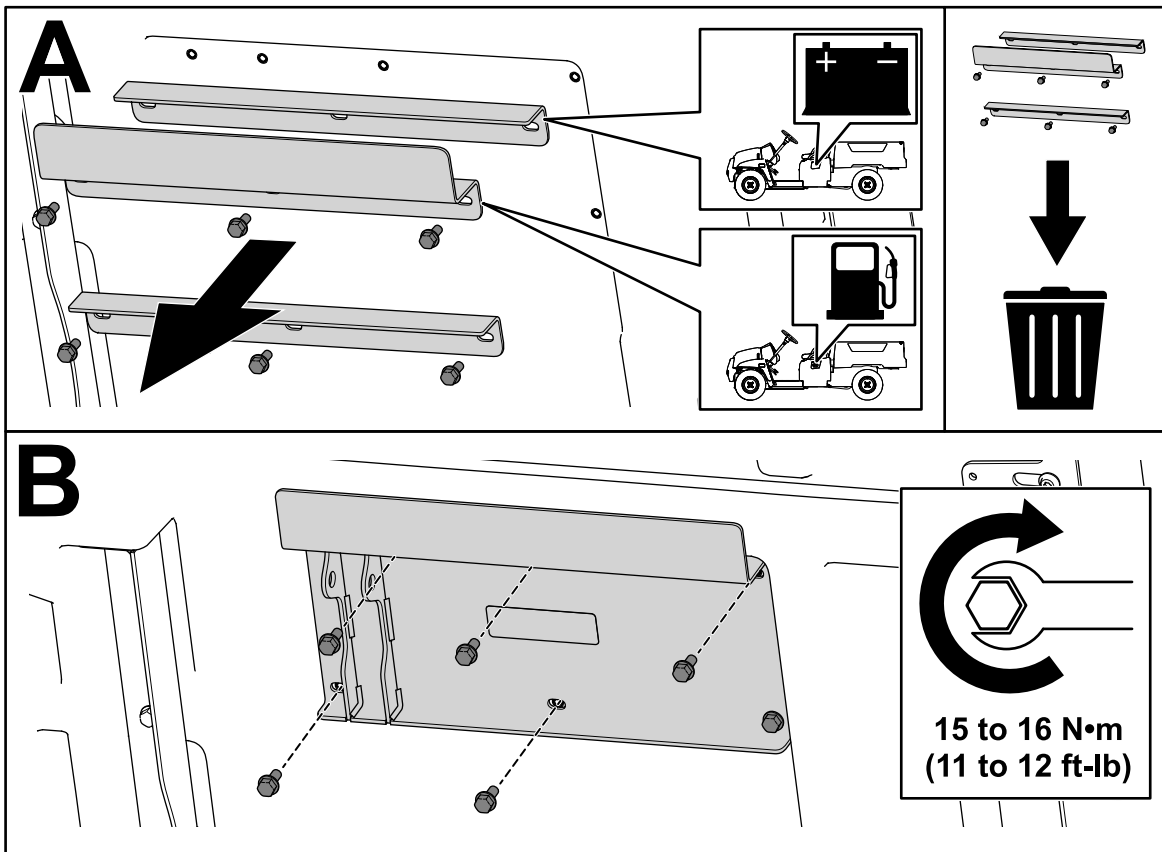
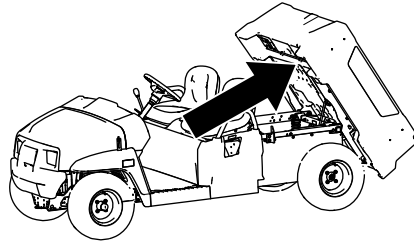

g035960

g035960

# Installing the Actuator Stop

## Electric Machine Only

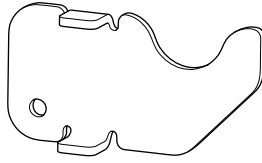

1x

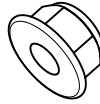

1x

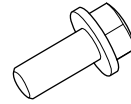

1x

Install the actuator stop to the battery tray mounting bracket using the bolt and nut.

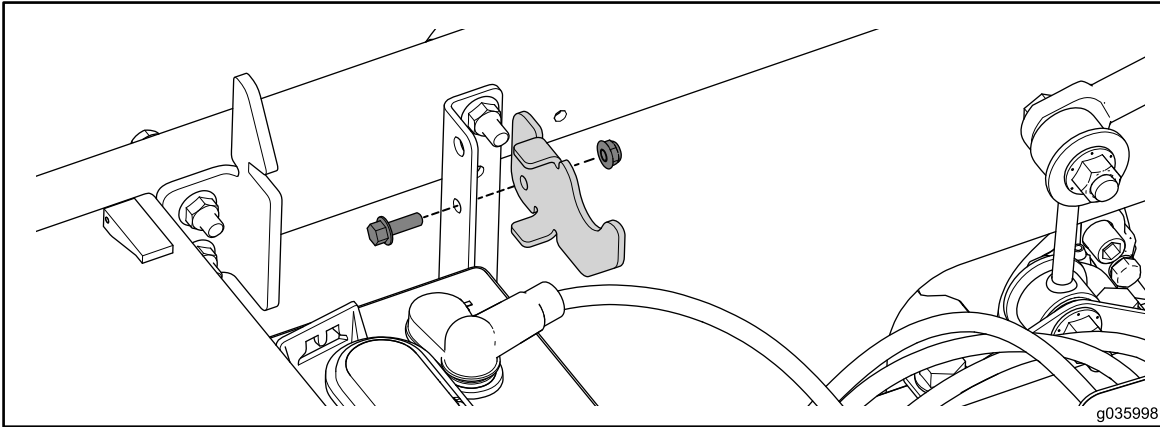
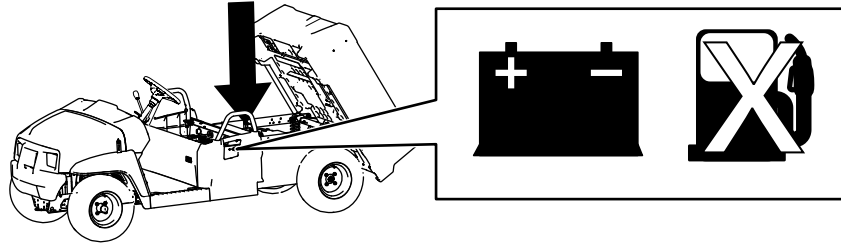

Electric Machine Shown

g035998

# Installing the Fuse

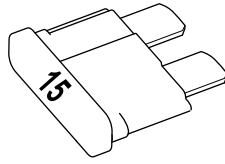

1x

Install the 15A fuse into the fuse block.

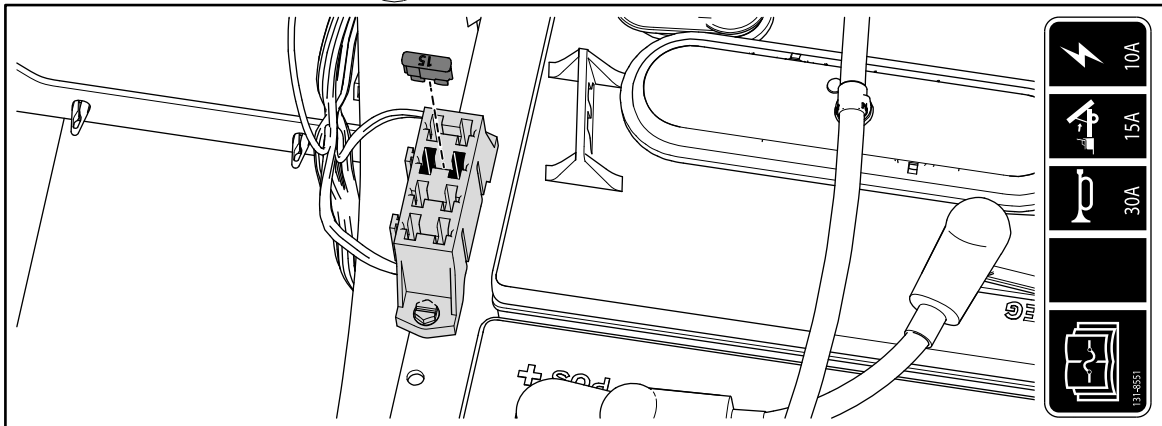
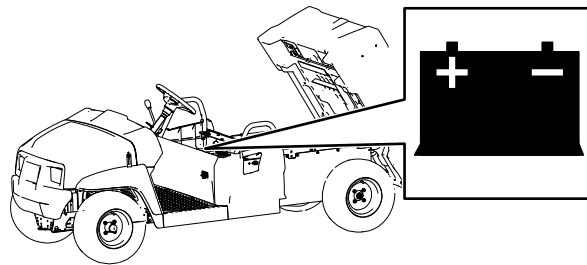
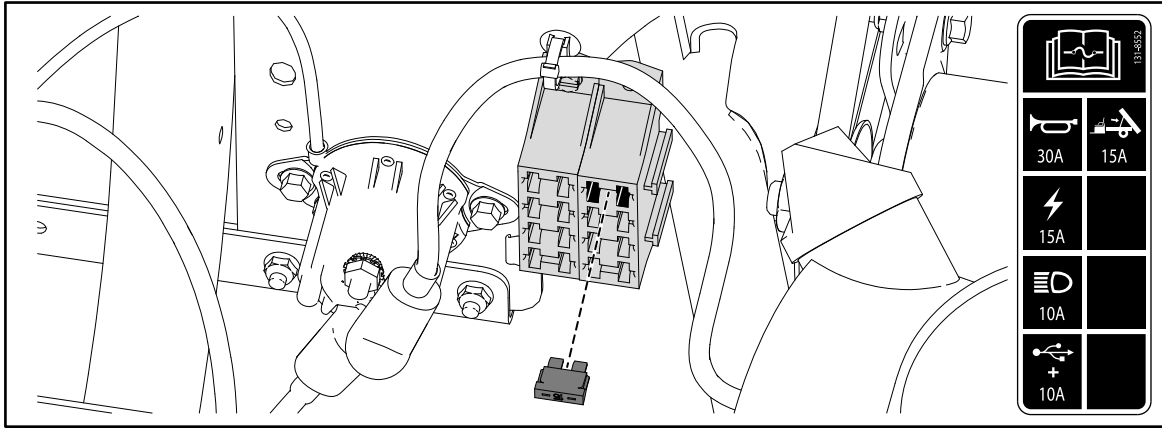
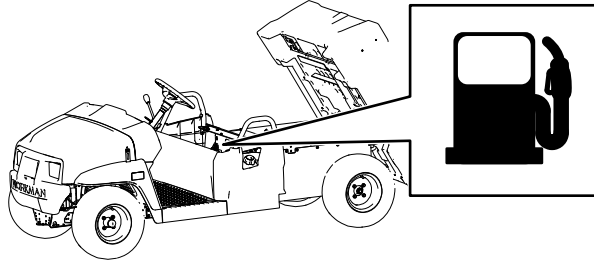

**Gasoline Machine Shown on Top; Electric Machine Shown on Bottom**

g185787

# Installing the Switch

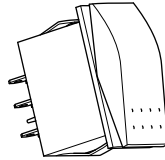

1x

1. Remove the plastic cover from the dashboard.
2. Install the switch connector through the opening in the dashboard.
3. Install the switch to the switch connector.
4. Ensure that the switch is oriented properly.

**Note:** Discard the plastic cover.

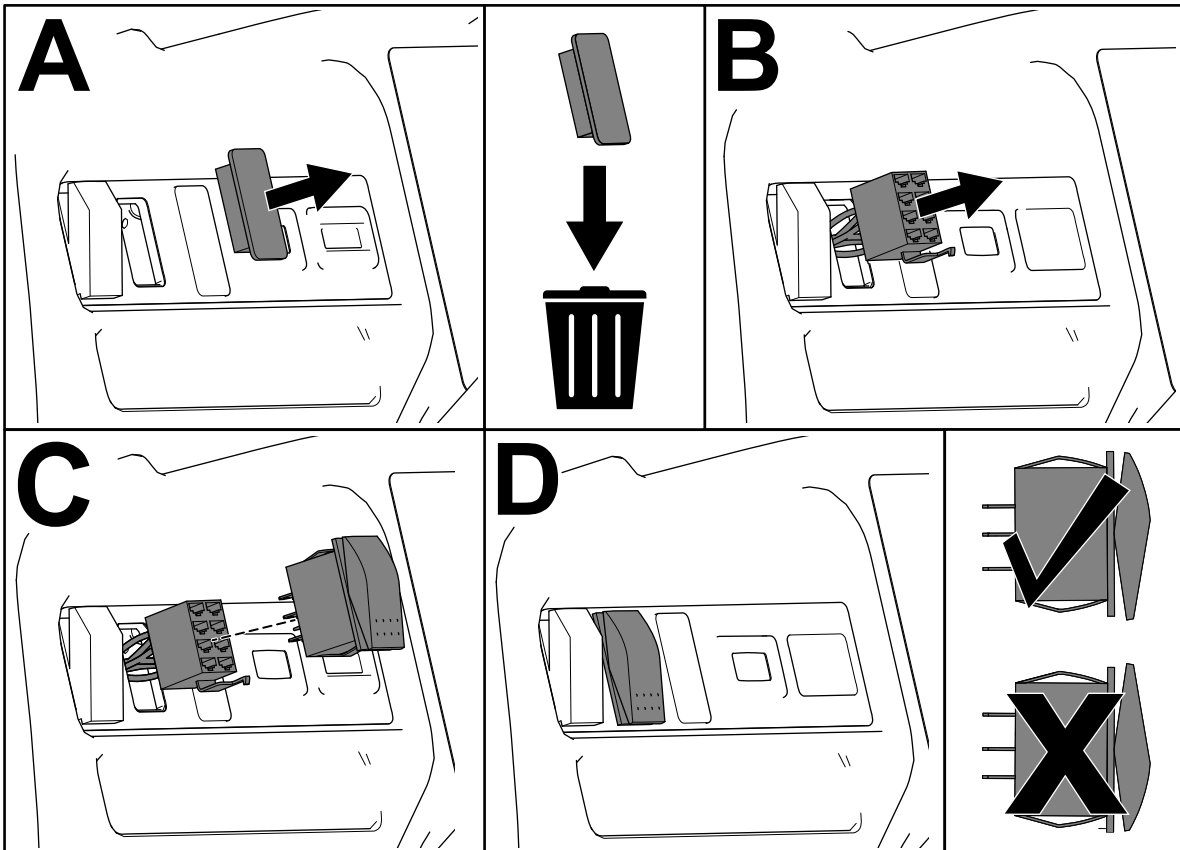
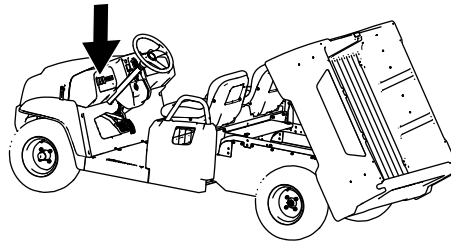

g036019

g036019



# Installing the Lift Cylinder

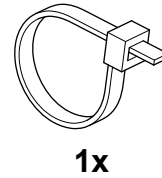
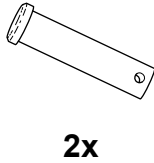
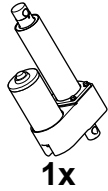

**Important:** Use the cable tie to secure the lift-cylinder wire to the wire harness, away from sharp or moving parts. Ensure that you allow enough slack in the wire harness for its full range of motion.

1. Install the lift cylinder using a clevis pin and hairpin cotter.
2. Connect the wire harness and secure it to the machine rail using the cable tie.
3. Rotate the lift cylinder upward to a 45° angle, then use a block to support the lift cylinder.
4. Press upward on the switch to extend the lift cylinder.
5. Install the extended portion of the lift cylinder to the cargo bed using a clevis pin and hairpin cotter.

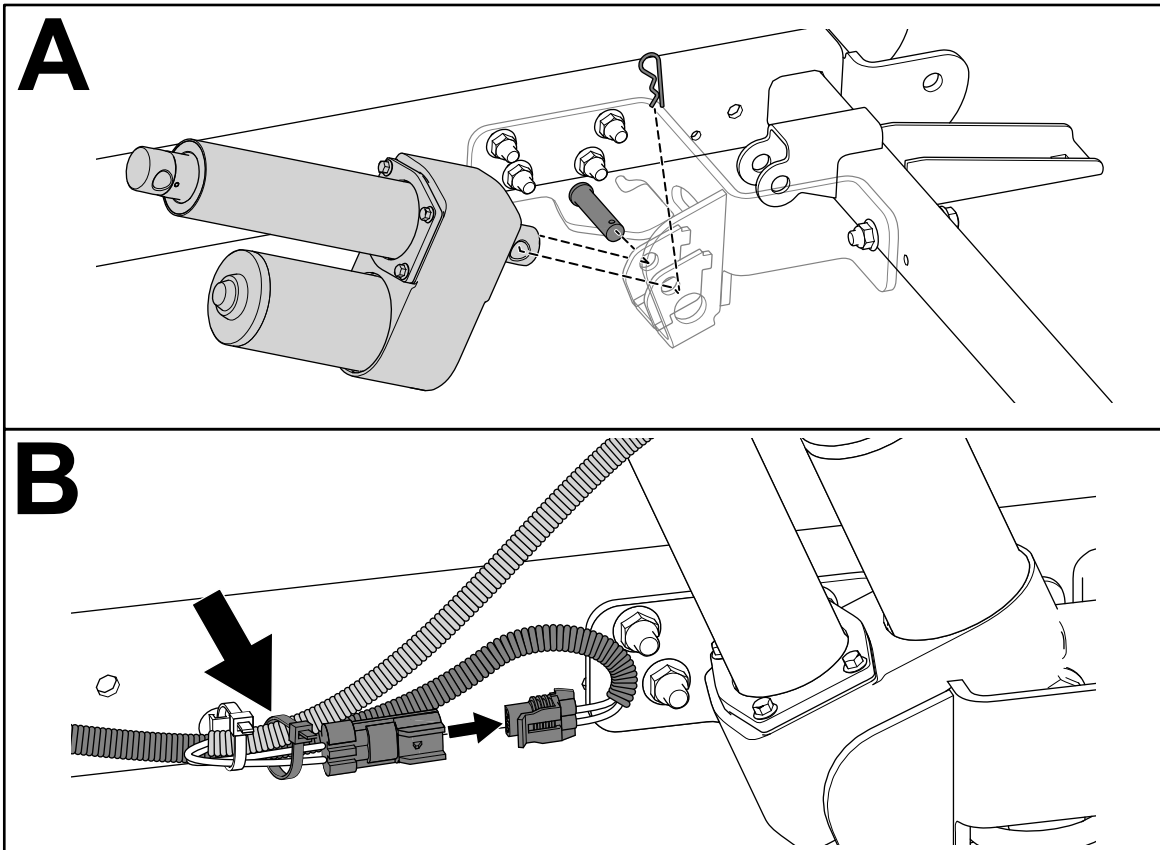
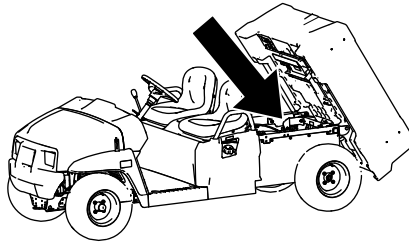

g036021

g036021

**Important:** Use a block to support the lift cylinder so that it extends upward at a 45° angle.

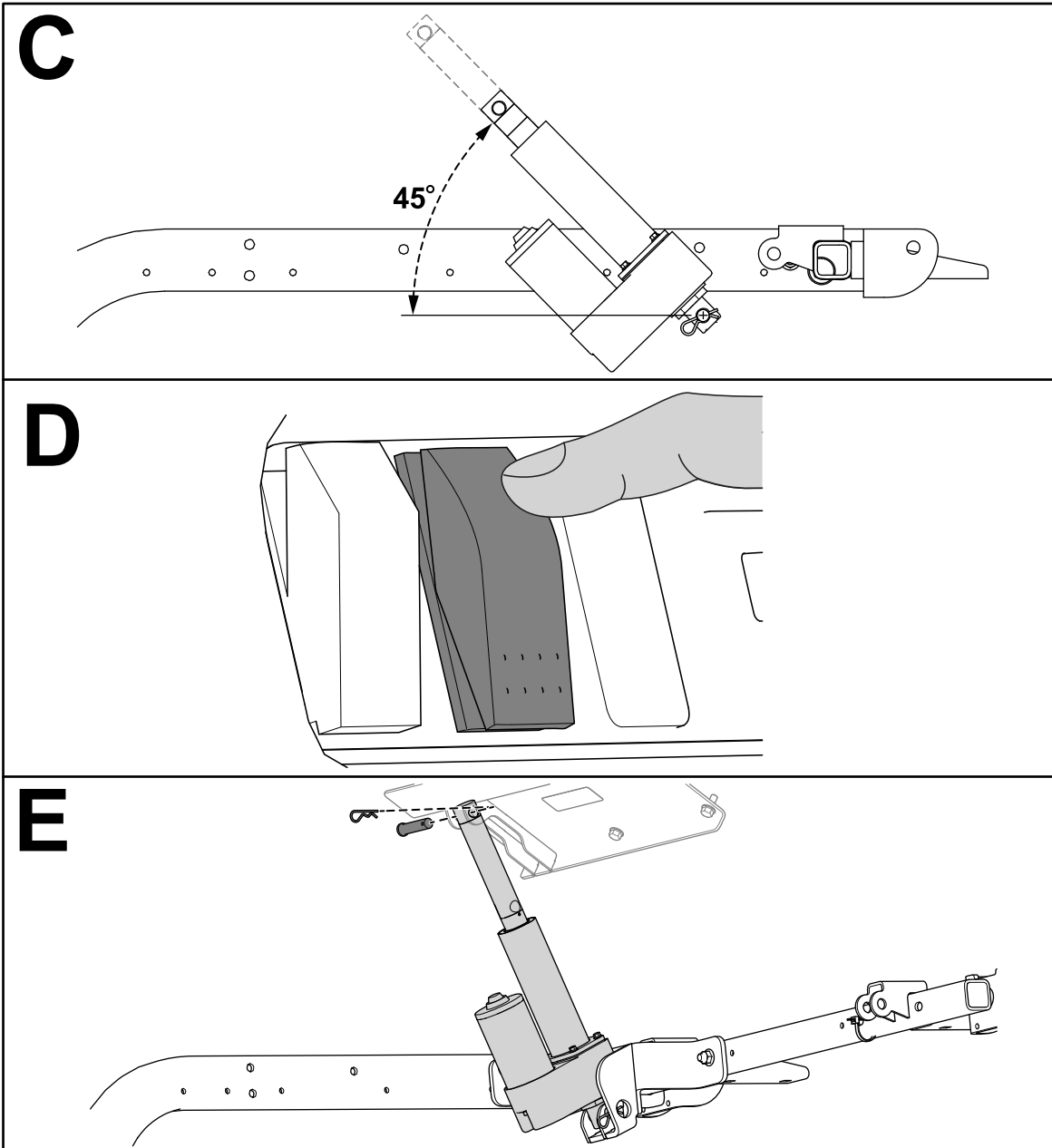

g185788

# Removing the Prop-Rod Assembly

Remove the 2 bolts (3/8 x 2-1/2 inches), 2 flange nuts (3/8 inch), and 3 bolts (5/16 x 3/4 inch) from the prop-rod assembly, and remove the prop-rod assembly.

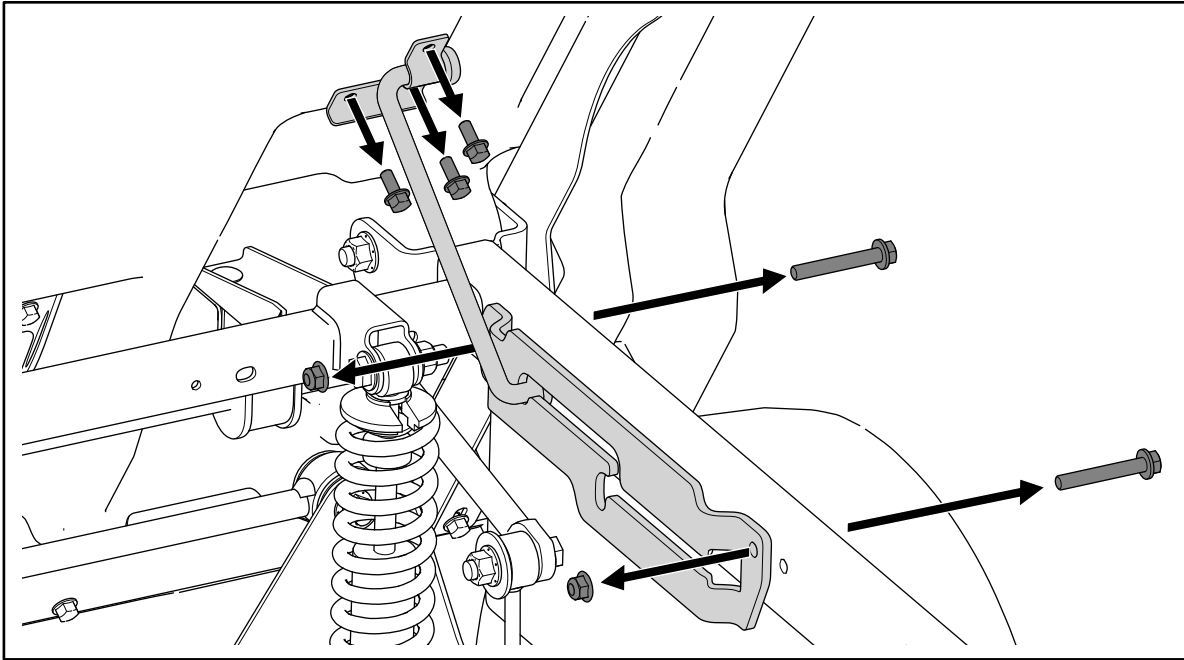
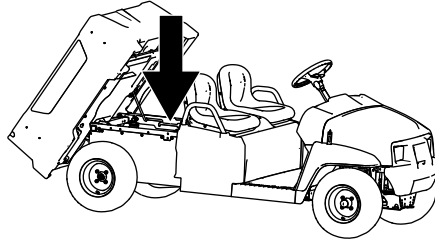

g036807

g036807

# Operation

## ⚠ WARNING

Driving the machine with the cargo box raised may cause the machine to tip or roll easier. The box structure may become damaged if you operate the machine with the box raised.

- Operate the machine only when the cargo box is down.
- After dumping the contents in the cargo box, lower the box.

## ⚠ CAUTION

The weight of the box may be heavy. Hands or other body parts could be crushed.

Keep hands and other body parts clear when lowering the box.

## Unlocking and Locking the Bed Latch

**Important:** Unlock the bed latch when using the electric lift to raise and lower the bed.

**Important:** Lock the bed latch when using rear attachments.

To unlock the bed latch, pull the bed latch toward you.

To lock the bed latch, push the bed-latch bracket toward the center of the machine until you hear the bed latch lock into position.

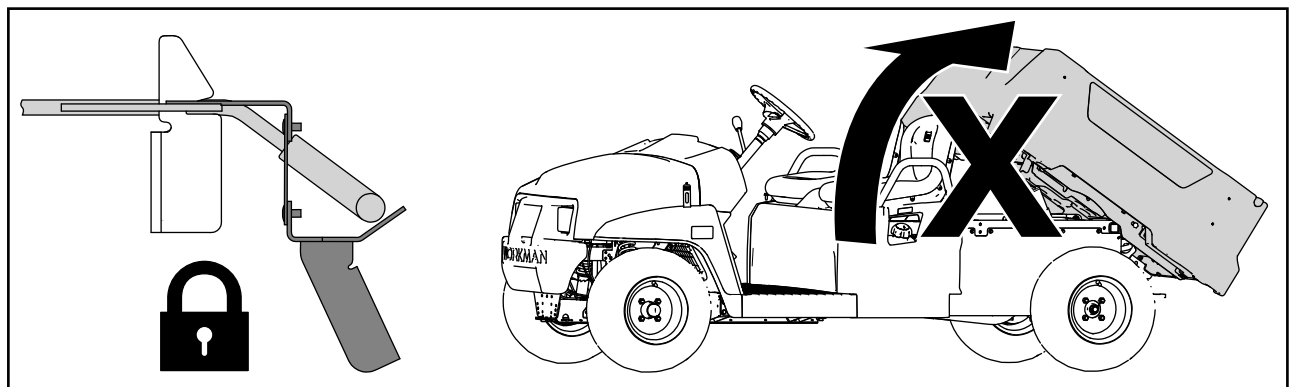
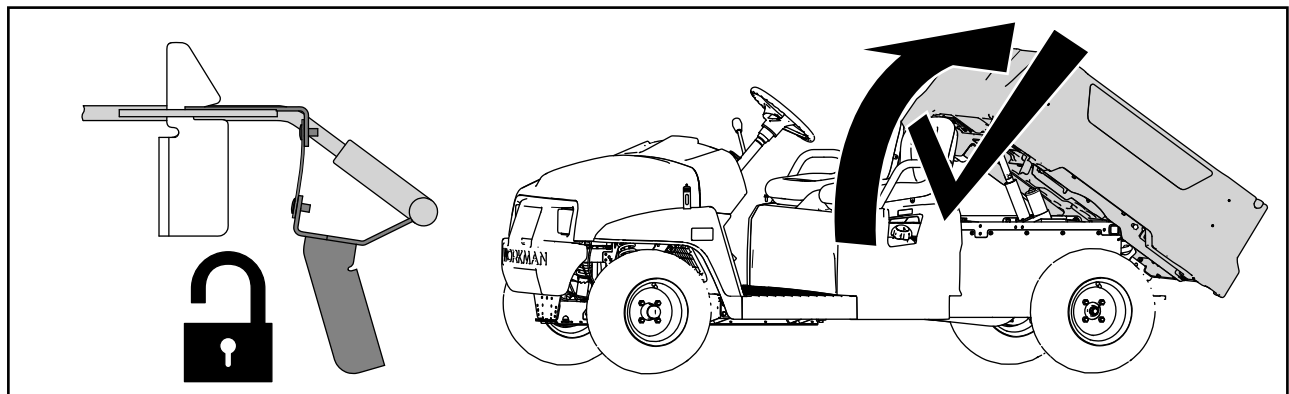
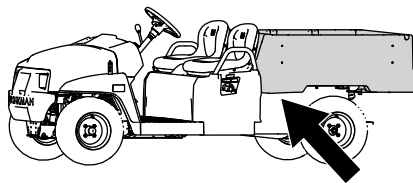

g037384

g037384

# Raising and Lowering the Bed

**Important:** Unlock the bed latch when using the electric lift to raise and lower the bed.

Press upward on the switch to raise the bed.

Press downward on the switch to lower the bed.

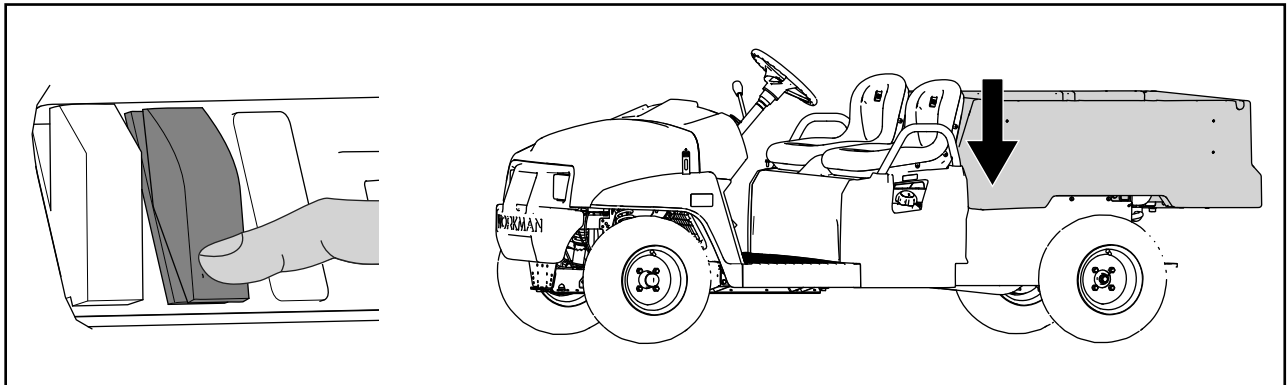
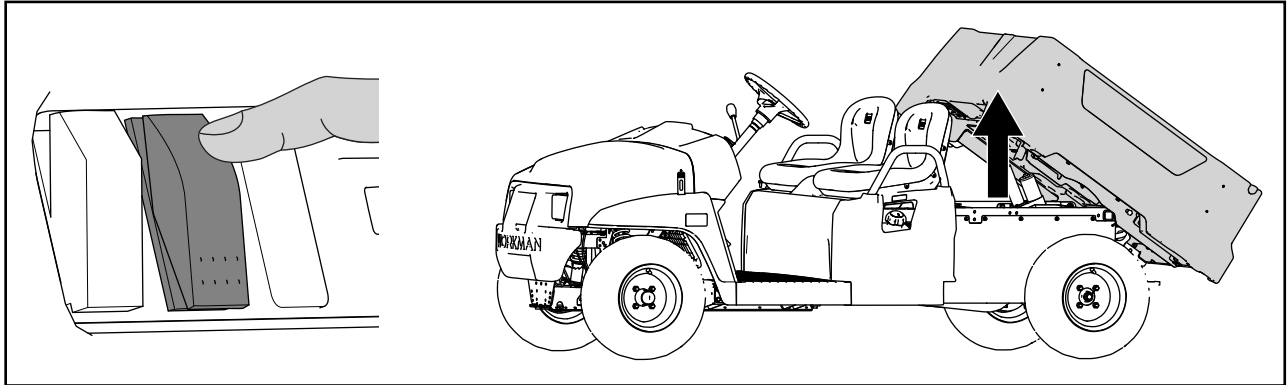

g036086

g036086

**Notes:**

# Declaration of Incorporation

Model No.	Serial No.	Product Description	Invoice Description	General Description	Directive
07143	316000001 and Up	48V Electric Lift Kit, Workman GTX Utility Vehicle	48V ELECTRIC LIFT KIT, WORKMAN GT	Utility Vehicle	2006/42/EC, 2004/108/EC
07144	316000001 and Up	12V Electric Lift Kit, Workman GTX Utility Vehicle	12V ELECTRIC LIFT KIT, WORKMAN GT	Utility Vehicle	2006/42/EC, 2004/108/EC

Relevant technical documentation has been compiled as required per Part B of Annex VII of 2006/42/EC.

We will undertake to transmit, in response to requests by national authorities, relevant information on this partly completed machinery. The method of transmission shall be electronic transmittal.

This machinery shall not be put into service until incorporated into approved Toro models as indicated on the associated Declaration of Conformity and in accordance with all instructions, whereby it can be declared in conformity with all relevant Directives.

Certified:



David Klis  
Sr. Engineering Manager  
8111 Lyndale Ave. South  
Bloomington, MN 55420, USA  
September 14, 2016

EU Technical Contact:

Marc Vermeiren  
Toro Europe NV  
B-2260 Oevel-Westerloo  
Belgium

Tel. 0032 14 562960  
Fax 0032 14 581911



# The Toro Warranty

## A Two-Year Limited Warranty

### Conditions and Products Covered

The Toro Company and its affiliate, Toro Warranty Company, pursuant to an agreement between them, jointly warrant your Toro Commercial product ("Product") to be free from defects in materials or workmanship for two years or 1500 operational hours\*, whichever occurs first. This warranty is applicable to all products with the exception of Aerators (refer to separate warranty statements for these products). Where a warrantable condition exists, we will repair the Product at no cost to you including diagnostics, labor, parts, and transportation. This warranty begins on the date the Product is delivered to the original retail purchaser.

\* Product equipped with an hour meter.

### Instructions for Obtaining Warranty Service

You are responsible for notifying the Commercial Products Distributor or Authorized Commercial Products Dealer from whom you purchased the Product as soon as you believe a warrantable condition exists. If you need help locating a Commercial Products Distributor or Authorized Dealer, or if you have questions regarding your warranty rights or responsibilities, you may contact us at:

Toro Commercial Products Service Department  
Toro Warranty Company  
8111 Lyndale Avenue South  
Bloomington, MN 55420-1196  
952-888-8801 or 800-952-2740  
E-mail: commercial.warranty@toro.com

### Owner Responsibilities

As the Product owner, you are responsible for required maintenance and adjustments stated in your *Operator's Manual*. Failure to perform required maintenance and adjustments can be grounds for disallowing a warranty claim.

### Items and Conditions Not Covered

Not all product failures or malfunctions that occur during the warranty period are defects in materials or workmanship. This warranty does not cover the following:

- Product failures which result from the use of non-Toro replacement parts, or from installation and use of add-on, or modified non-Toro branded accessories and products. A separate warranty may be provided by the manufacturer of these items.
- Product failures which result from failure to perform recommended maintenance and/or adjustments. Failure to properly maintain your Toro product per the Recommended Maintenance listed in the *Operator's Manual* can result in claims for warranty being denied.
- Product failures which result from operating the Product in an abusive, negligent, or reckless manner.
- Parts subject to consumption through use unless found to be defective. Examples of parts which are consumed, or used up, during normal Product operation include, but are not limited to, brake pads and linings, clutch linings, blades, reels, rollers and bearings (sealed or greasable), bed knives, spark plugs, castor wheels and bearings, tires, filters, belts, and certain sprayer components such as diaphragms, nozzles, and check valves, etc.
- Failures caused by outside influence. Conditions considered to be outside influence include, but are not limited to, weather, storage practices, contamination, use of unapproved fuels, coolants, lubricants, additives, fertilizers, water, or chemicals, etc.
- Failure or performance issues due to the use of fuels (e.g. gasoline, diesel, or biodiesel) that do not conform to their respective industry standards.

### Countries Other than the United States or Canada

Customers who have purchased Toro products exported from the United States or Canada should contact their Toro Distributor (Dealer) to obtain guarantee policies for your country, province, or state. If for any reason you are dissatisfied with your Distributor's service or have difficulty obtaining guarantee information, contact the Toro importer.

- Normal noise, vibration, wear and tear, and deterioration.
- Normal "wear and tear" includes, but is not limited to, damage to seats due to wear or abrasion, worn painted surfaces, scratched decals or windows, etc.

### Parts

Parts scheduled for replacement as required maintenance are warranted for the period of time up to the scheduled replacement time for that part. Parts replaced under this warranty are covered for the duration of the original product warranty and become the property of Toro. Toro will make the final decision whether to repair any existing part or assembly or replace it. Toro may use remanufactured parts for warranty repairs.

### Deep Cycle and Lithium-Ion Battery Warranty:

Deep cycle and Lithium-Ion batteries have a specified total number of kilowatt-hours they can deliver during their lifetime. Operating, recharging, and maintenance techniques can extend or reduce total battery life. As the batteries in this product are consumed, the amount of useful work between charging intervals will slowly decrease until the battery is completely worn out. Replacement of worn out batteries, due to normal consumption, is the responsibility of the product owner. Battery replacement may be required during the normal product warranty period at owner's expense. Note: (Lithium-Ion battery only): A Lithium-Ion battery has a part only prorated warranty beginning year 3 through year 5 based on the time in service and kilowatt hours used. Refer to the *Operator's Manual* for additional information.

### Maintenance is at Owner's Expense

Engine tune-up, lubrication, cleaning and polishing, replacement of filters, coolant, and completing recommended maintenance are some of the normal services Toro products require that are at the owner's expense.

### General Conditions

Repair by an Authorized Toro Distributor or Dealer is your sole remedy under this warranty.

**Neither The Toro Company nor Toro Warranty Company is liable for indirect, incidental or consequential damages in connection with the use of the Toro Products covered by this warranty, including any cost or expense of providing substitute equipment or service during reasonable periods of malfunction or non-use pending completion of repairs under this warranty. Except for the Emissions warranty referenced below, if applicable, there is no other express warranty. All implied warranties of merchantability and fitness for use are limited to the duration of this express warranty.**

Some states do not allow exclusions of incidental or consequential damages, or limitations on how long an implied warranty lasts, so the above exclusions and limitations may not apply to you. This warranty gives you specific legal rights, and you may also have other rights which vary from state to state.

### Note regarding engine warranty:

The Emissions Control System on your Product may be covered by a separate warranty meeting requirements established by the U.S. Environmental Protection Agency (EPA) and/or the California Air Resources Board (CARB). The hour limitations set forth above do not apply to the Emissions Control System Warranty. Refer to the Engine Emission Control Warranty Statement supplied with your product or contained in the engine manufacturer's documentation for details.