



43 cm Recycler®

Walk-Behind Power Mower

Model No. 21012B-6900001 & Up
Model No. 21013B-6900001 & Up

Operator's Manual

IMPORTANT: Read this manual carefully. It contains information about your safety and the safety of others. Also become familiar with the controls and their proper use before you operate the product.

Introduction

Thank you for purchasing a Toro product.

All of us at Toro want you to be completely satisfied with your new product, so feel free to contact your local Authorized Service Dealer for help with service, genuine Toro parts, or other information you may require.

Whenever you contact your Authorized Service Dealer or the factory, always know the model and serial numbers of your product. These numbers will help the Service Dealer or Service Representative provide exact information about your specific product. You will find the model and serial number decal located in a unique place on the product as shown below.

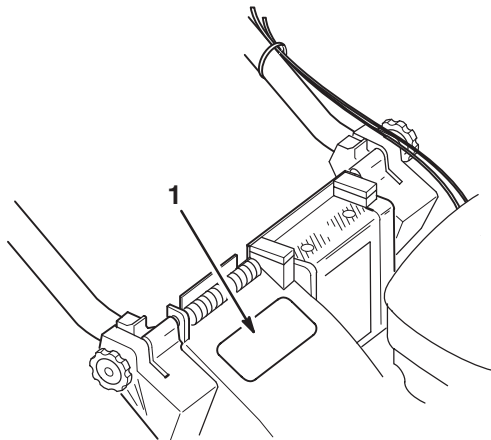

1694

1. Model and Serial Number Decal

For your convenience, write the product model and serial numbers in the space below.

Model No: _____
Serial No. _____

Read this manual carefully to learn how to operate and maintain your product correctly. Reading this manual will help you and others avoid personal injury and damage to the product. Although Toro designs, produces and markets safe, state-of-the-art products, you are responsible for using the product properly and safely. You are also responsible for training persons who you allow to use the product about safe operation.

The Toro warning system in this manual identifies potential hazards and has special safety messages that help you and others avoid personal injury, even death. **DANGER**, **WARNING** and **CAUTION** are signal words used to identify the level of hazard. However, regardless of the hazard, be extremely careful.

DANGER signals an extreme hazard that will cause serious injury or death if the recommended precautions are not followed.

WARNING signals a hazard that may cause serious injury or death if the recommended precautions are not followed.

CAUTION signals a hazard that may cause minor or moderate injury if the recommended precautions are not followed.

Two other words are also used to highlight information. “Important” calls attention to special mechanical information and “Note” emphasizes general information worthy of special attention.

The left and right side of the machine is determined by standing behind the handle in the normal operator’s position.

Contents

	Page		Page
Safety	2	Maintenance	17
Training	2	Servicing Air Cleaner	17
Preparation	2	Draining Gasoline	17
Operation	2	Changing Crankcase Oil	18
Sound Pressure Level	4	Spark Plug	18
Sound Power Level	4	Adjusting Throttle	19
Vibration Level	4	Adjusting Brake Cable	19
Symbol Glossary	4	Adjusting Wheel Traction Drive	20
Assembly	8	Inspecting/Removing/ Sharpening Blade	21
Handle	8	Lubrication	22
Starter Rope	8	Cleaning	23
Grass Bag Ramp	9	Storage	25
Discharge Tunnel Plug	9		
Before Starting	10		
Fill Crankcase With Oil	10		
Fill Fuel Tank With Gasoline	11		
Operation	12		
Controls	12		
Starting Engine	12		
Stopping Engine	13		
Grass Bag	13		
Discharge Tunnel Plug	14		
Adjusting Cutting Height	14		
Recycling Tips	15		

Safety

Training

1. Read the instructions carefully. Be familiar with the controls and the proper use of the equipment.
2. Never allow children or people unfamiliar with these instructions to use the lawnmower. Local regulations may restrict the age of the operator.
3. Never mow while people, especially children, or pets are nearby.
4. Keep in mind that the operator or user is responsible for accidents or hazards occurring to other people or their property.

Preparation

1. While mowing, always wear substantial footwear and long trousers. Do not operate the equipment when barefoot or wearing open sandals.
2. Thoroughly inspect the area where the equipment is to be used and remove all objects which may be thrown by the machine.
3. **WARNING** – Petrol is highly flammable.
 - Store fuel in containers specifically designed for this purpose.
 - Refuel outdoors only and do not smoke while refuelling.
 - Add fuel before starting the engine. Never remove the cap of the fuel tank or add petrol while the engine is running or when the engine is hot.
- If petrol is spilled, do not attempt to start the engine but move the machine away from the area of spillage and avoid creating any source of ignition until petrol vapors have dissipated.
- Replace all fuel tanks and container caps securely.
4. Replace faulty silencers.
5. Before using, always visually inspect to see that the blades, blade bolts and cutter assembly are not worn or damaged. Replace worn or damaged blades and bolts in sets to preserve balance.
6. On multi-bladed machines, take care as rotating one blade can cause other blades to rotate.

Operation

1. Do not operate the engine in a confined space where dangerous carbon monoxide fumes can collect.
2. Mow only in daylight or in good artificial light.
3. Avoid operating the equipment in wet grass, where feasible.
4. Always be sure of your footing on slopes.
5. Walk, never run.
6. For wheeled rotary machines, mow across the face of slopes, never up and down.
7. Exercise extreme caution when changing direction on slopes.
8. Do not mow excessively steep slopes.
9. Use extreme caution when reversing or pulling the lawnmower towards you.

10. Stop the blade(s) if the lawnmower has to be tilted for transportation when crossing surfaces other than grass, and when transporting the lawnmower to and from the area to be mowed.
11. Never operate the lawnmower with defective guards or shields, or without safety devices for example deflectors and/or grass catchers in place.
12. Do not change the engine governor settings or overspeed the engine.
13. Disengage all blade and drive clutches before starting the engine.
14. Start the engine or switch on the motor carefully according to instructions and with feet well away from the blade(s).
15. Do not tilt the lawnmower when starting the engine or switching on the motor, except if the lawnmower has to be tilted for starting. In this case, do not tilt it more than absolutely necessary and lift only the part which is away from the operator.
16. Do not start the engine when standing in front of the discharge chute.
17. Do not put hands or feet near or under rotating parts. Keep clear of the discharge opening at all times.
18. Never pick up or carry a lawnmower while the engine is running.
19. Stop the engine and disconnect the spark plug wire.
 - before clearing blockages or unclogging chute;
 - before checking, cleaning or working on the lawnmower;
 - after striking a foreign object. Inspect the lawnmower for damage and make repairs before restarting and operating the lawnmower;
- if lawnmower starts to vibrate abnormally (check immediately).
20. Stop the engine
 - whenever you leave the lawnmower;
 - before refuelling.
21. Reduce the throttle setting during engine shut down and, if the engine is provided with a shut-off valve, turn the fuel off at the conclusion of mowing.

Maintenance and storage

1. Keep all nuts, bolts and screws tight to be sure the equipment is in safe working condition.
2. Never store the equipment with petrol in the tank inside a building where fumes may reach an open flame or spark.
3. Allow the engine to cool before storing in any enclosure.
4. To reduce the fire hazard, keep the engine, silencer, battery compartment and petrol storage area free of grass, leaves, or excessive grease.
5. Check the grass catcher frequently for wear or deterioration.
6. Replace worn or damaged parts for safety.
7. If the fuel tank has to be drained, this should be done outdoors.

Sound Pressure Level

Model 21012B

This unit has an equivalent continuous A-weighted sound pressure at the operator ear of: 80.2 dB(A), based on measurements of identical machines per ANSI B71.5-1984 procedures.

Model 21013B

This unit has an equivalent continuous A-weighted sound pressure at the operator ear of: 81.9 dB(A), based on measurements of identical machines per ANSI B71.5-1984 procedures.

Sound Power Level

This unit has a sound power level of: 96 dB(A)/1 pW, based on measurements of identical machines per Directive 84/538/EEC and amendments.

Vibration Level

This unit has a maximum hand-arm vibration level of 5.41 m/s², based on measurement of identical machines per ISO 5349 procedures.

Symbol Glossary

Safety alert triangle — symbol within triangle indicates a hazard.



Safety alert symbol



Read operator's manual.



Consult technical manual for proper service procedures.



Stay a safe distance from the machine.

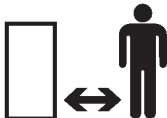

Do not open or remove safety shields while engine is running.



Rotating blade can cut off toes or fingers. Stay clear of mower blade as long as engine is running.



To avoid blade failure when mulching, use blade stiffener when mower is equipped with mulching plug.

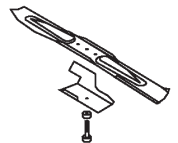

Transmission



Oil



Stay a safe distance from the mower.

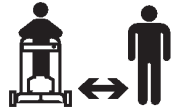

Throw or flying objects — Whole body exposure



Thrown or flying objects — Rotary side-mounted mower. Keep deflector shield in place.



Stop engine before leaving operator position.



Hourmeter/elapsed operating hours



Fast



Slow



Decreasing/Increasing



Grease lubrication point



On/Run



Engage

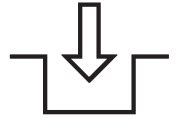

Disengage



Battery charging condition

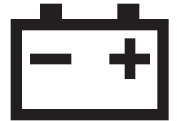

Fuel

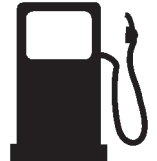

Neutral



First gear



Second gear



Third gear



Engine start



Engine stop



Choke



Primer (start aid)



Push primer three times.

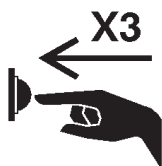

Properly dispose of batteries.



Insert key in ignition switch.



Turn key in ignition switch.



Move control.



Cutting element — basic symbol



Cutting element — height adjustment



Pull rope.



Wheel



Wheel traction



Lower control bar.



Raise control bar.



Raise/lower control bar.



Raise/lower control bar.



Move control forward.

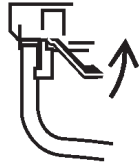

Move control rearward.

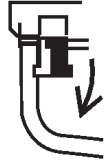

Raise control bar.



Raise control bar.



Lower control bar.



Assembly

Handle

Assembly

1. Loosen knobs on mounting brackets (Fig. 1).

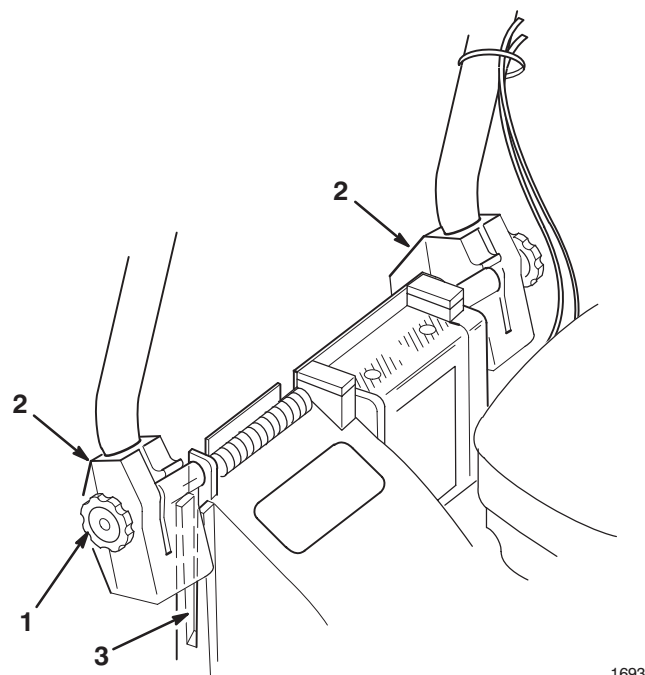

Figure 1

1. Knob
2. Handle bracket
3. Housing pocket

2. Position mounting brackets in a vertical position so that holes face up.
3. Slide handle ends into holes in mounting brackets until handle ends are completely seated in brackets (Fig. 1). Make sure cables are positioned on top of left mounting bracket (Fig. 2).
4. Rotate handle and mounting brackets rearward until brackets fit securely into housing pockets (Fig. 2).
5. Tighten knobs until edges of slots on top of mounting brackets touch.

6. Use cable ties to secure cables to left handle (Fig. 2).

Note: Make sure cables do not interfere with the raising or lowering of discharge door.

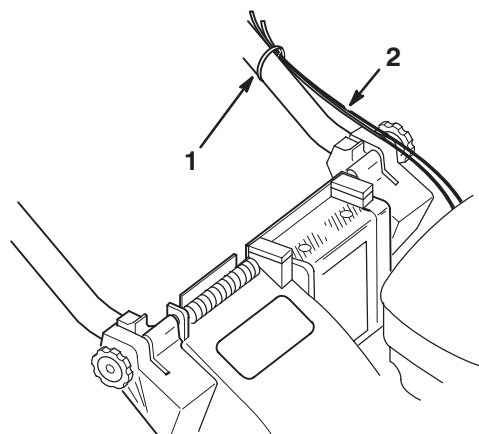

Figure 2

1. Cable tie
2. Cables

Starter Rope

1. Pull starter rope through rope guide on handle (Fig. 3). By squeezing control bar to handle, blade brake will release and allow rope to be pulled up easily to loop.

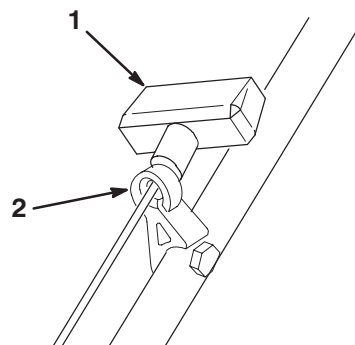

Figure 3

1. Recoil starter
2. Rope guide

Grass Bag Ramp

1. Snap three (3) tabs on grass bag ramp onto grass bag frame (Fig. 4 & 5).

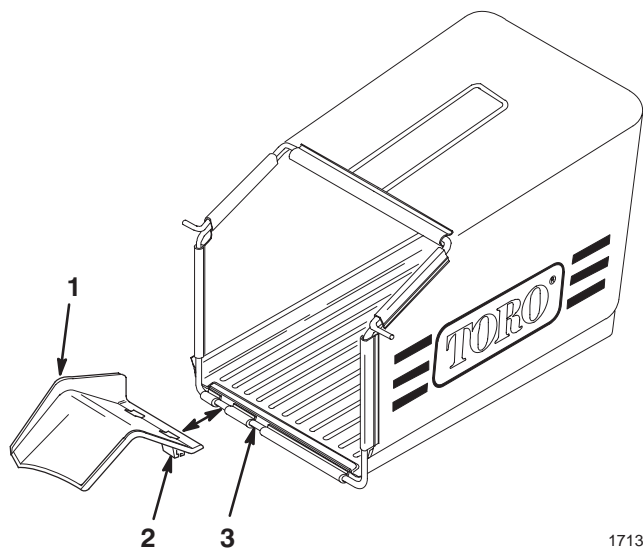

Figure 4

1. Grass bag ramp
2. Tab
3. Grass bag frame

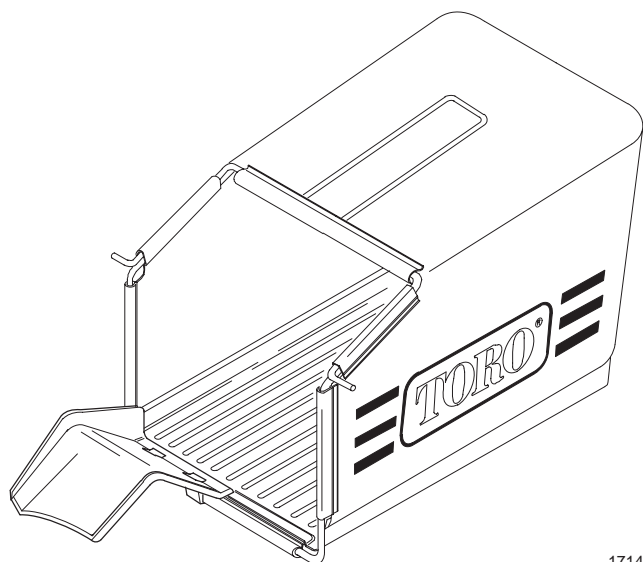

Figure 5

Discharge Tunnel Plug

1. Make sure engine is off.
2. Open discharge door and insert plug into discharge tunnel opening (Fig. 6). Since the plug is slightly wider than the discharge tunnel opening, you must rotate the plug clockwise slightly while inserting it.

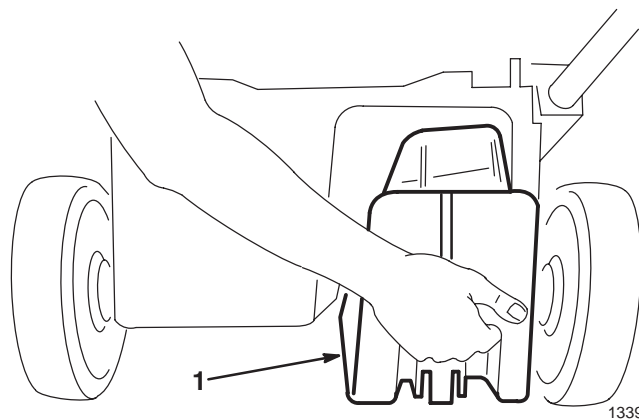

Figure 6

1. Plug

3. Push plug all the way into the discharge tunnel opening.
4. Lower discharge door over plug.

Before Starting

Fill Crankcase With Oil

Initially, crankcase must be filled with 0.6 L (20 ounces) of SAE 30 oil. Use any high quality detergent oil having the American Petroleum Institute (API) “service classification”—SF, SG or SH.

Before each use, assure oil level is between ADD and FULL marks (Fig. 7). Add oil if level is low.

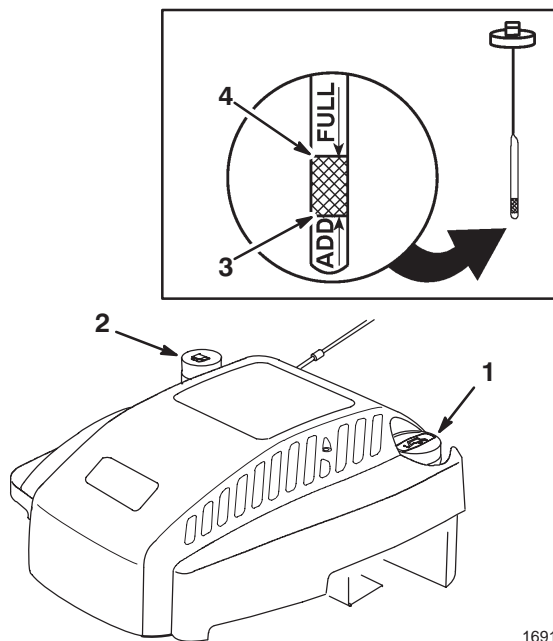

Figure 7

- | | |
|------------------|--------------|
| 1. Dipstick | 3. ADD mark |
| 2. Fuel tank cap | 4. FULL mark |

1. Position mower on level surface and clean around oil dipstick.
2. Remove dipstick by rotating cap counterclockwise 1/4 turn.
3. Wipe dipstick and insert it into filler neck. Rotate cap 1/4 turn. Then remove dipstick and check level of oil (Fig. 7). If level is low, add only enough oil to raise level to FULL mark on dipstick. **DO NOT FILL ABOVE FULL**

MARK BECAUSE ENGINE COULD BE DAMAGED WHEN STARTED. POUR OIL SLOWLY.

Note: Check oil level each time mower is used or after every 5 hours of mower operation. Initially, change oil after the first 2 hours of operation; thereafter, change oil after every 25 hours of operation. More frequent oil changes are required in dusty or dirty conditions.

4. Insert dipstick into filler neck and rotate cap clockwise 1/4 turn to lock it in place.

Fill Fuel Tank With Gasoline

DANGER

POTENTIAL HAZARD

- In certain conditions gasoline is extremely flammable and highly explosive.

WHAT CAN HAPPEN

- A fire or explosion from gasoline can burn you, others, and cause property damage.

HOW TO AVOID THE HAZARD

- Use a funnel and fill the fuel tank outdoors, in an open area, when the engine is cold. Wipe up any gasoline that spills.
- Do not fill the fuel tank completely full. Add gasoline to the fuel tank until the level is 6 mm to 13 mm (1/4" to 1/2") below the bottom of the filler neck. This empty space in the tank allows gasoline to expand.
- Never smoke when handling gasoline, and stay away from an open flame or where gasoline fumes may be ignited by a spark.
- Store gasoline in an approved container and keep it out of the reach of children.
- Never buy more than a 30-day supply of gasoline.

1. Clean around fuel tank cap and remove cap from tank (Fig. 7). Do not fill tank full. Using unleaded gasoline, fill fuel tank to within 6 to 13 mm (1/4" to 1/2") from top of tank, not into filler neck.
2. Install fuel tank cap and wipe up any spilled gasoline.

Toro also recommends that Toro Stabilizer/Conditioner be used regularly in all Toro gasoline powered products during operation and storage seasons. Toro Stabilizer/Conditioner cleans the engine during operation and prevents gum-like varnish deposits from forming in the engine during periods of storage.

IMPORTANT: Do not mix oil with the gasoline. Never use methanol, gasoline containing methanol, gasohol containing more than 10% ethanol, premium gasoline, or white gas because engine fuel system damage could result.

Do not use fuel additives other than those manufactured for fuel stabilization during storage such as Toro's Stabilizer/Conditioner or a similar product. Toro's Stabilizer/Conditioner is a petroleum distillate based conditioner/stabilizer. Toro does not recommend stabilizers with an alcohol base such as ethanol, methanol or isopropyl. Additives should not be used to try to enhance the power or performance of machine.

Operation

Controls

Self-propelled control bar (self-propelled model), throttle, blade control bar and recoil starter are on the handle (Fig. 8 and 9).

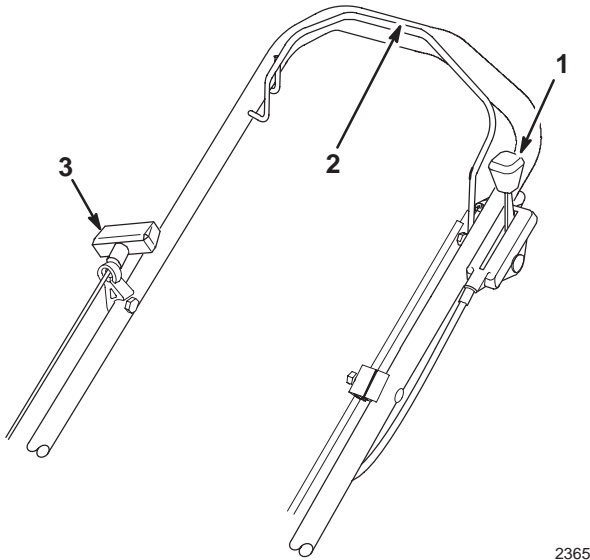

Hand push model

Figure 8

- | | |
|----------------------|-------------------|
| 1. Throttle lever | 3. Recoil starter |
| 2. Blade control bar | |

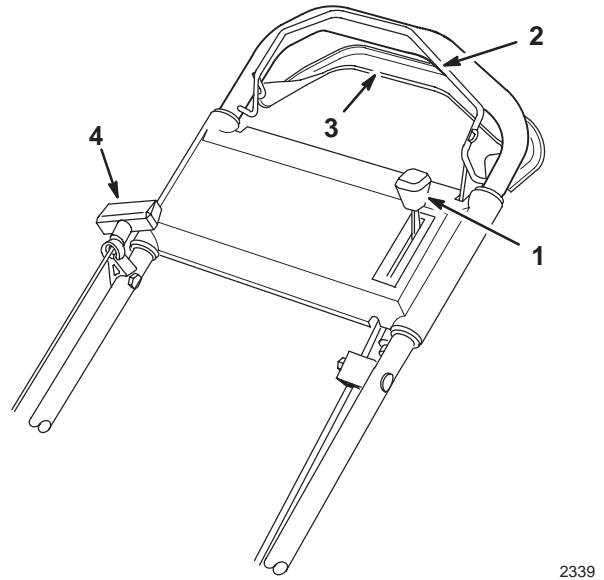

Self-propelled model

Figure 9

- | | |
|----------------------|-------------------------------|
| 1. Throttle lever | 3. Self-propelled control bar |
| 2. Blade control bar | 4. Recoil starter |

Starting Engine

1. Push spark plug wire onto spark plug (Fig. 10).
2. Push primer three (3) times (Fig. 10). **Wait about two (2) seconds between each push.**

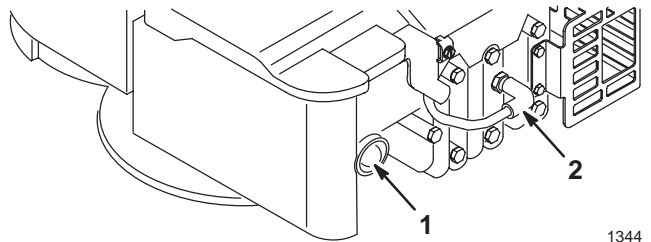

Figure 10

- | | |
|-----------|--------------------|
| 1. Primer | 2. Spark plug wire |
|-----------|--------------------|



Note: Do not use primer to restart a warm engine after a short shutdown. However, cool weather may require priming to be repeated.

3. Move throttle forward to  (FAST) position.

Hand Push model

- Hold blade control bar against handle.
- Pull recoil starter out until slack in rope is taken up. Then pull vigorously to start the engine.

Self-propelled model

- Hold blade control bar against handle.
 - Pull recoil starter out until slack in rope is taken up. Then pull vigorously to start the engine.
 - Slowly squeeze the self-propelled control bar against the handle to engage the traction mechanism. The mower is equipped with a single ground speed. When the control bar is tight against the handle, the mower will self-propel at maximum ground speed.
4. When engine starts, regulate throttle as desired between  (FAST) and  (SLOW).

Stopping Engine

1. Release blade control bar. Engine and blade will stop. See your dealer immediately if they do not. To stop self-propelling, release the self-propel control bar. Stay behind the handle until all moving parts stop.
2. Pull wire off spark plug if mower will be unattended or not used.

To Restart Engine

1. Move throttle lever to  (FAST) position and repeat steps 3 and 4 in STARTING ENGINE procedure.
2. If engine does not start after two attempts, repeat steps 2–4 in STARTING ENGINE procedure.

Grass Bag

Installing

1. Stop engine and wait for all parts to stop.
2. Raise discharge door, slide bag ramp attached to bag into discharge opening, and hook bag frame onto mounting bracket (Fig. 11). Allow discharge door to rest on top of bag (Fig. 12).

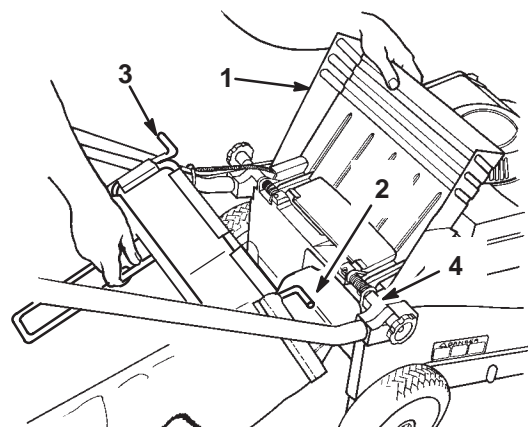

1715

Figure 11

- | | |
|-------------------|---------------------|
| 1. Discharge door | 3. Bag frame hook |
| 2. Bag ramp | 4. Mounting bracket |

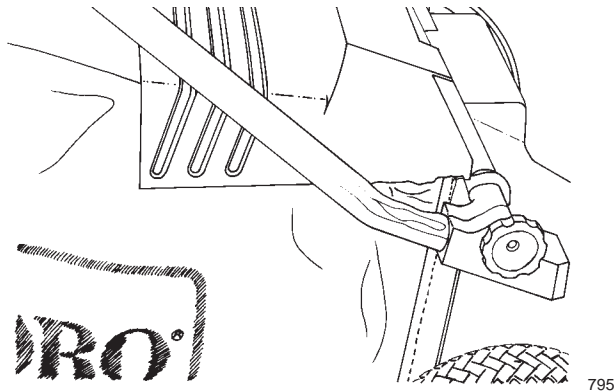

Figure 12

Removing

1. **Stop engine and wait for all moving parts to stop.** For protection, always keep hands and feet away from mower housing while engine is running. Raise discharge door. While holding discharge door up, grasp handle on grass bag and lift bag off mower. Allow discharge door to close.

Note: When removing the grass bag, the bag ramp scoops out any clippings that may be plugging the discharge opening. If the discharge opening remains plugged, clear all clippings from the mower with a stick.

Emptying

1. Grasp bag frame handle and rear of grass bag. Gradually tip bag forward to empty clippings.

Discharge Tunnel Plug

1. Make sure engine is off.
2. Open discharge door and insert plug into discharge tunnel opening (Fig. 13). Since the plug is slightly wider than the discharge tunnel opening, you must rotate the plug clockwise slightly while inserting it.

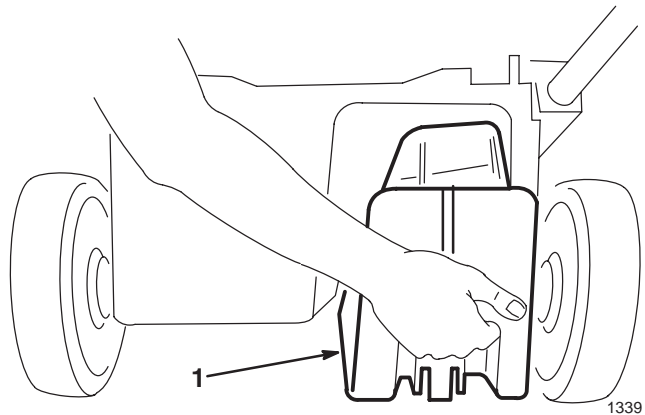

Figure 13

1. Plug

3. Push plug all the way into the discharge tunnel opening.
4. Lower discharge door over plug.

Adjusting Cutting Height

The six (6) letters on the belt cover represent the height-of-cut settings. All wheels automatically adjust to the same height-of-cut setting.

1. Stop the engine and pull wire off spark plug (Fig. 10).
2. Use one or two fingers to squeeze the height-of-cut adjustment lever (Fig. 14).

To raise the wheel height, squeeze the lever to unlock the height-of-cut and pull up on the mower. Release lever when desired height is found. To lower the height, squeeze the height-of-cut adjustment lever and push down on the mower **while rolling the mower forward**. Use the pointer on the link rod to locate the correct setting.

3. Make sure the height adjustment lever is locked into a height setting before beginning operation. The height should not change when the height-of-cut is locked.

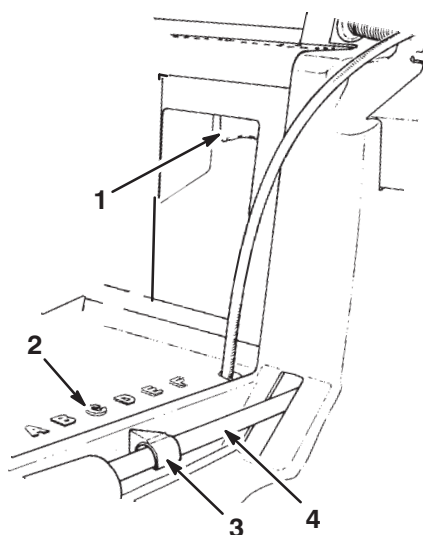

Figure 14

- | | |
|-----------------------------------|-------------|
| 1. Height-of-cut adjustment lever | 3. Pointer |
| 2. Height settings | 4. Link rod |

1711

! WARNING

POTENTIAL HAZARD

- Wet grass or leaves can cause you to slip and contact blade.

WHAT CAN HAPPEN

- Blade contact can seriously injure you.

HOW TO AVOID THE HAZARD

- Mow only in dry conditions.

- Set engine speed to fastest position. Maximum horsepower provides best cutting results.
- Clean clippings or leaves from underside of mower deck after each mowing.
- Keep engine in good running condition. Cutting and recutting requires more horsepower.
- Clean air filter more frequently. Cutting and recutting stirs up more clippings and dust which clogs the air filter and reduces engine performance.

Recycling Tips

General Tips

Follow these instructions whether cutting grass or leaves for the best cutting results and lawn appearance:

- Maintain a **sharp blade** throughout the cutting season. Periodically file down nicks on blade.

Only mow dry grass or leaves. Wet grass and leaves tend to clump on yard and may cause mower to plug or engine to stall. They also may be slippery to walk on and could cause you to slip and fall.

Cutting Grass

- Grass grows at different rates at different times of the year. In the heat of the summer, it is generally best to cut grass at the C, D or E height-of-cut settings. Only about 1/3 of the grass blade should be cut off. Cutting below the C setting is not recommended unless grass is sparse or it is late fall when grass growth begins to slow down.
- When cutting grass over six inches tall, you may want to first mow using the highest height-of-cut setting and a slower walking speed; then mow again at a lower setting for best lawn appearance. If grass is too long and leaves clumps on top of lawn, mower may plug and cause engine to stall.
- Alternate mowing direction. This helps disperse clippings over lawn for even fertilization.

If the finished cut lawn appearance is unsatisfactory, try one or more of the following:

- Sharpen the blade.
- Walk at a slower pace while mowing.
- Raise the height-of-cut setting on your mower.
- Cut grass more frequently.
- Overlap cutting swaths instead of cutting a full swath with each pass.
- Mow across the marginal areas a second time.

Cutting Leaves

- When cutting is complete, always be sure that 50% of the lawn shows through the cut leaf cover. This may require one or more passes over the leaves.
- Walk at a slower mowing speed if leaves are not being cut up finely enough to be hidden down in the grass.
- If you cut up a lot of oak leaves, you might want to add lime to your grass in the spring. Lime reduces the acidity of oak leaves.

Maintenance

CAUTION

POTENTIAL HAZARD

- If you leave the wire on the spark plug, someone could start the engine.

WHAT CAN HAPPEN

- Accidental starting of engine could seriously injure you or other bystanders.

HOW TO AVOID THE HAZARD

- Pull wire off spark plug before you do any maintenance. Also push wire aside so it does not accidentally contact spark plug.

Servicing Air Cleaner

Normally, replace air cleaner after every 25 operating hours. More frequent replacing is required when mower is operated in dusty or dirty conditions. See your Authorized Toro Service Dealer for replacement parts.

1. Stop engine and pull wire off spark plug (Fig. 15).

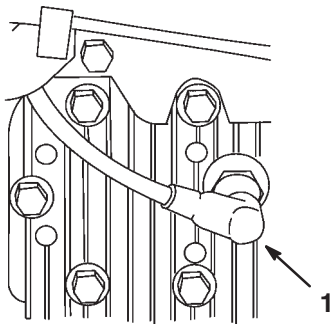

Figure 15

1. Spark plug wire

2. Remove screw securing air cleaner cover to engine (Fig. 16). Tilt cover down and clean cover thoroughly.
3. Remove paper air cleaner filter (Fig. 16) and discard.
4. Insert a new paper air cleaner filter.
5. Reinstall air cleaner cover and secure with screw.

IMPORTANT: Do not operate engine without air cleaner filter otherwise extreme engine wear and damage will likely result.

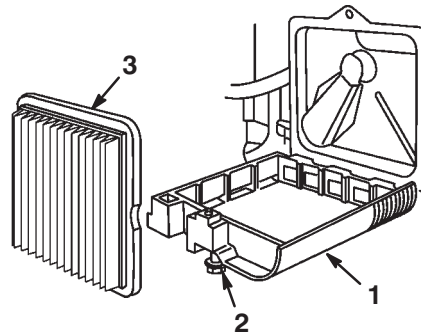

Figure 16

1. Cover
2. Screw
3. Paper filter

1003

Draining Gasoline

1. Stop engine and wait for engine to cool. Pull wire off spark plug (Fig. 15).

IMPORTANT: Drain gasoline from a cold engine only.

2. Remove cap from fuel tank and use a pump-type syphon to drain fuel into a clean gas can.

Note: This is the only procedure recommended for draining fuel.

Changing Crankcase Oil

Change oil after the first 2 operating hours and after every 25 hours thereafter. Since warm oil drains better and carries more contaminants than cold, run engine for several minutes or so before draining oil.

1. Stop engine and pull wire off spark plug (Fig. 15).
2. Drain gasoline from fuel tank: refer to Draining Gasoline.
3. Tip mower on its left side (Fig. 17).
4. Place a drain pan under mower.
5. Remove drain plug from underside of mower (Fig. 17).

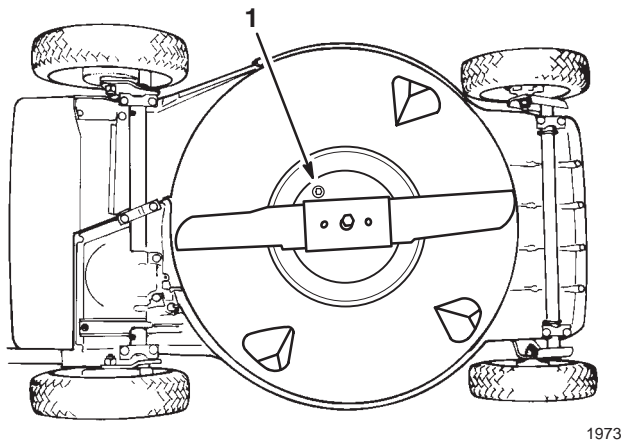

Figure 17

1. Oil drain plug

6. Lower mower allowing oil to drain into pan.
7. After draining, clean drain plug and reinstall it.
8. Set mower upright.
9. Wipe up any spilled oil.
10. Fill engine with fresh oil: refer to Fill Crankcase With Oil.

Spark Plug

Use a Champion RJ19LM spark plug or equivalent. Correct air gap is 0.76 mm (0.030"). Remove plug after every 25 operating hours and check its condition.

1. Stop engine and pull wire off spark plug (Fig. 15).
2. Clean around spark plug and remove plug from cylinder head.

IMPORTANT: Replace a cracked, fouled, or dirty spark plug. Do not sand blast, scrape, or clean electrodes because engine damage could result from grit entering cylinder.

3. Set air gap at 0.76 mm (0.030") (Fig. 18). Install correctly gapped spark plug and gasket seal. Tighten plug firmly to 20 N·m (15 ft-lb).

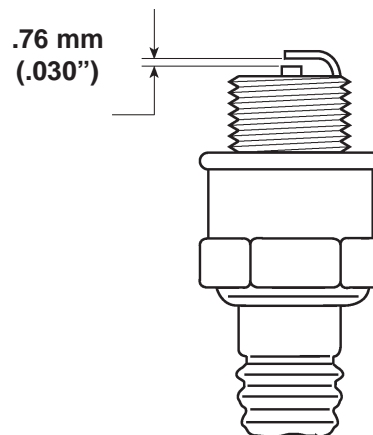

Figure 18

4. Reconnect spark plug wire when maintenance is completed.

Adjusting Throttle

Throttle control adjustment may be required if engine does not start or stop. Whenever a new throttle control cable is installed, throttle must be adjusted.

1. Stop engine and pull wire off spark plug (Fig. 15).
2. Remove (2) screws from engine cover and lift off cover (Fig. 19).

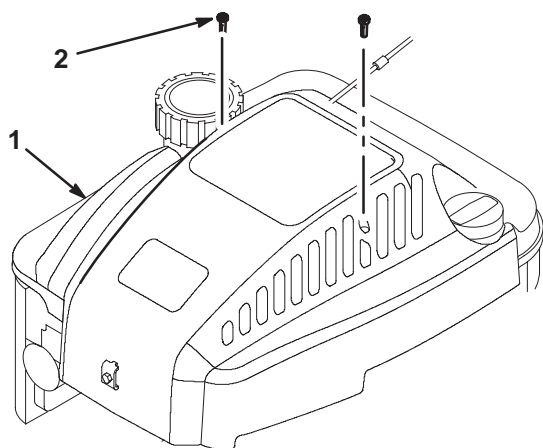

1709

Figure 19

1. Cover
2. Screw (2)

3. Loosen cable clamp screw until throttle cable slides (Fig. 20).

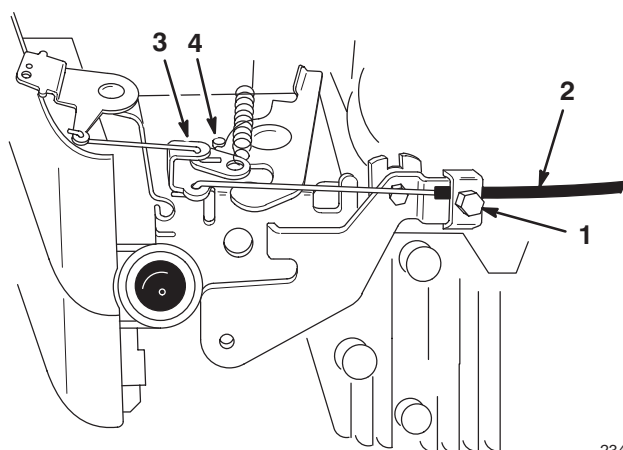

2348

Figure 20

1. Cable clamp screw
2. Throttle cable
3. Throttle lever
4. Stop

4. Move throttle control to  (FAST) position.
5. Move throttle cable until throttle lever contacts stop (Fig. 20).
6. Tighten cable clamp screw to lock adjustment in place.
7. Reinstall engine cover with (2) screws. Torque screws to 8-10 in.-lbs. (.9-1.1 N·m)

Adjusting Brake Cable

Whenever a new blade brake cable assembly is installed, an adjustment is required.

1. Stop the engine. Pull the wire off the spark plug.
2. CHECK ADJUSTMENT—Move the blade control bar toward the handle until the slack in the wire is removed. The gap between the blade control bar and the handle must be 1.5mm-4.6mm ($1/16$ "- $3/16$ ") (Fig. 21 and Fig. 22).

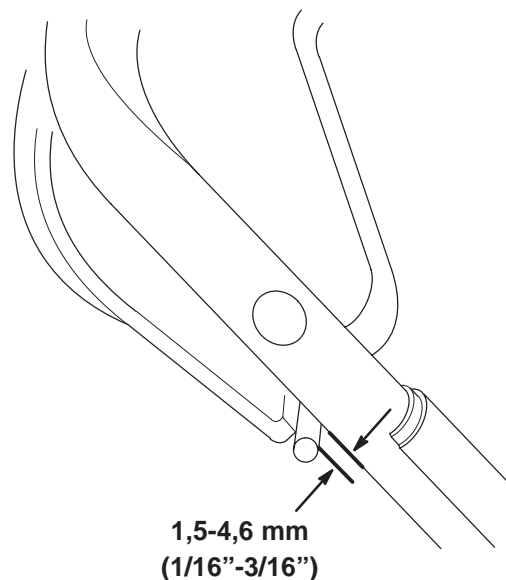

2340

Self-propelled model shown

Figure 21

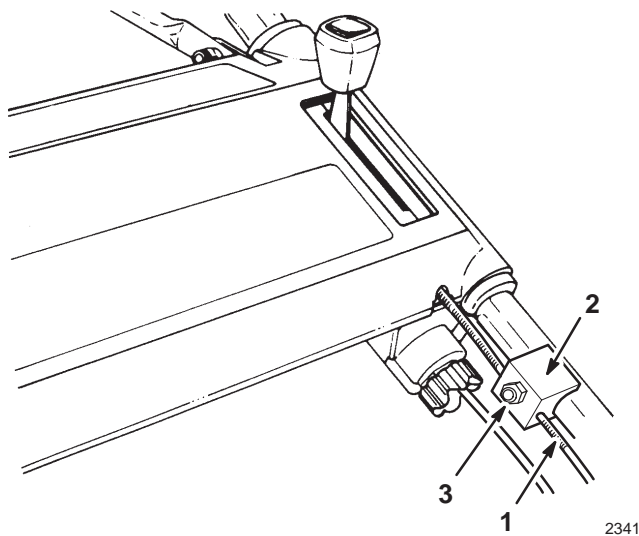

Self-propelled model shown

Figure 22

1. Cable conduit
2. Cable bracket
3. Nut

3. **ADJUST CABLE CONDUIT**—Loosen the nut on the cable bracket. Insert 1.5mm-4.6mm ($1/16$ "– $3/16$ ") object between the brake control bar and handle. Pull down on the cable conduit until all slack is removed from the wire. Then tighten the nut.

Adjusting Wheel Traction Drive

(self-propelled model only)

If mower does not self-propel or has a tendency to creep forward when drive is not engaged, an adjustment to the wheel traction control cable is necessary.

1. Stop the engine.
2. Turn knob clockwise if mower has tendency to creep when drive is not engaged. Turn knob counterclockwise if mower does not propel when drive is engaged.

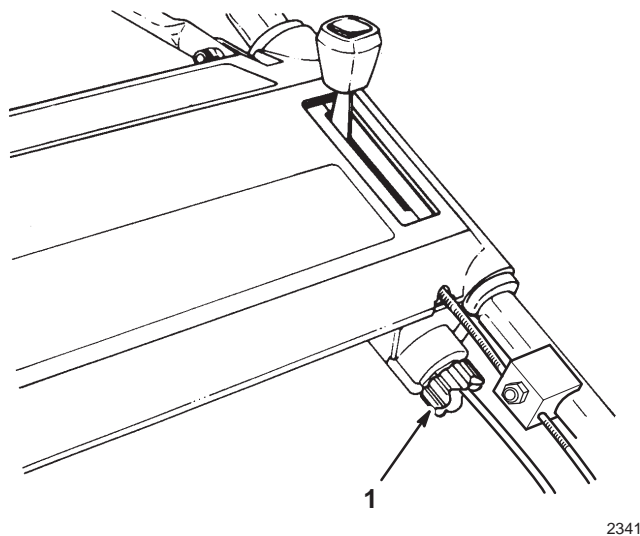

Figure 23

1. Adjustment knob

Note: Determine left and right sides of mower by standing in the operator's position.

Adjustment is correct when:

- mower does not creep forward when traction is disengaged
- self-propelled control bar is at a comfortable operating distance from the handle for operator's hand when disengaging and engaging the self-propelled drive

Note: Do not overadjust cable. Cable should be just tight enough to make wheels turn when self-propelled control bar is at a distance from the handle that is comfortable for operator's hand. Overadjusting may require excessive operator effort to engage or disengage self-propelled drive.

If you need help, see your Authorized Toro Service Dealer.

Inspecting/Removing/Sharpening Blade

A straight, sharp blade provides maximum cutting performance. Regularly inspect and sharpen blade.

WARNING

POTENTIAL HAZARD

- Blade is sharp.

WHAT CAN HAPPEN

- Contact with sharp blade can cause serious personal injury.

HOW TO AVOID THE HAZARD

- Wear gloves or wrap sharp edges of the blade with a rag.

1. Stop engine and pull wire off spark plug (Fig. 15).
2. Drain gasoline from fuel tank. See Drain Gasoline section.

WARNING

POTENTIAL HAZARD

- Gasoline is extremely flammable, highly explosive and under certain conditions can cause personal injury or property damage.

WHAT CAN HAPPEN

- Tipping mower may cause fuel leakage from carburetor or fuel tank.

HOW TO AVOID THE HAZARD

- Avoid fuel spills by running engine dry or remove gas with hand pump, never siphon.

3. Tip mower on its left side (Fig. 24). Avoid rotating the blade because starting problems may result.

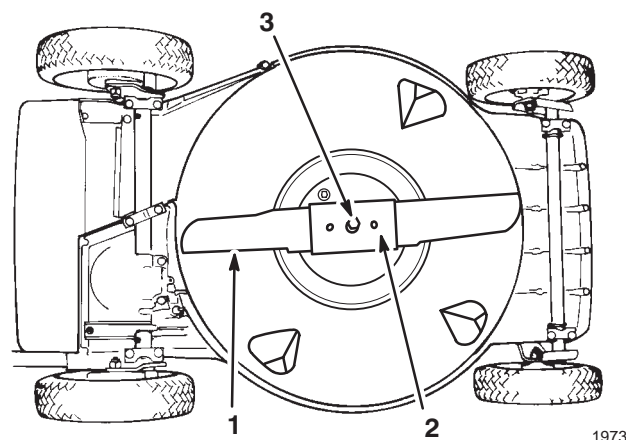

Figure 24

1. Blade
2. Blade stiffener
3. Blade bolt and lockwasher

4. INSPECTING BLADE—Carefully examine blade for sharpness and wear, especially where flat and curved parts meet (Fig. 25A). Since sand and abrasive material can wear away the metal that connects the flat and curved parts of the blade, check blade before using the mower. If a slot or wear is noticed, (Fig. 25B & C), replace blade. Refer to step 5.

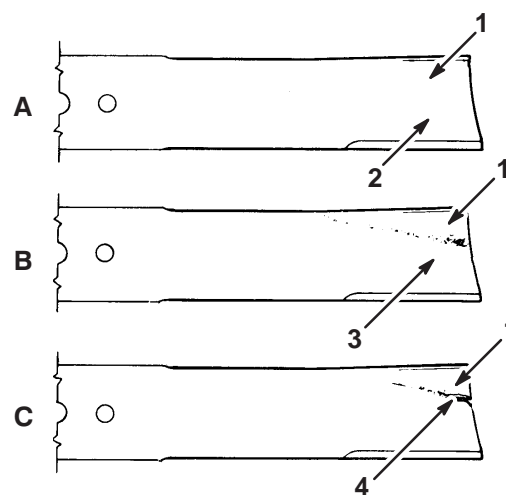

Figure 25

1. Sail
2. Flat part of blade
3. Wear
4. Slot formed

Note: For best performance, install new blade before cutting season begins. During the year, file down small nicks to maintain the cutting edge.



DANGER

POTENTIAL HAZARD

- A worn or damaged blade could break and a piece of blade could be thrown into operator's or bystander's area.

WHAT CAN HAPPEN

- A thrown piece of blade could cause serious personal injury or death to operator or bystanders.

HOW TO AVOID THE HAZARD

- Inspect blade periodically for wear or damage.
- Replace a worn or damaged blade.

5. REMOVING BLADE—Grasp end of blade using a rag or thickly padded glove. Remove blade bolt, lockwasher, blade and blade stiffener (Fig. 24).
6. SHARPENING BLADE—Using a file, sharpen top side of blade and maintain original cutting angle (Fig. 26). The blade will remain balanced if same amount of material is removed from both cutting edges.

IMPORTANT: Check balance of blade by putting it on a blade balancer. An inexpensive balancer can be purchased at a hardware store. A balanced blade stays in a horizontal position and an unbalanced blade settles to the heavy side. If blade is not balanced, file more metal off cutting edge on heavy end of blade.

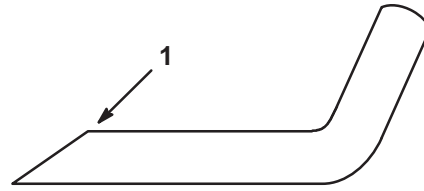

Figure 26

153

1. Sharpen at this angle only

7. Install sharp, balanced TORO blade, blade stiffener, lockwasher and blade bolt. Sail part of blade must point toward top of mower housing to ensure correct installation. Tighten the blade bolt to 68 N·m (50 ft·lb).



WARNING

POTENTIAL HAZARD

- When sharpening blade, pieces of blade could be accidentally thrown.

WHAT CAN HAPPEN

- Thrown objects can cause serious eye injury.

HOW TO AVOID THE HAZARD

- Wear proper eye protection when sharpening blade.



WARNING

POTENTIAL HAZARD

- Operating mower without stiffener in place could cause blade to flex, bend or break.

WHAT CAN HAPPEN

- A broken blade could cause serious injury or death to operator or bystanders.

HOW TO AVOID THE HAZARD

- Do not operate mower without stiffener.

Lubrication

After every 25 operating hours or when season ends, front and rear wheels must be lubricated.

1. Apply one or two drops of light oil on inside and outside of all wheel bolts. Spin wheels to distribute oil into bushings. Wipe up excess oil.
2. SELF-PROPELLED MODEL—Drain gasoline; refer to Draining Gasoline, page 17.
3. Set mower to highest height-of-cut setting (E).
4. Tip mower on its left side. Wipe grease fittings with clean rag (Fig. 27). Install grease gun onto fitting and gently apply one or two pumps of #2 Multi-Purpose Lithium Base Grease.

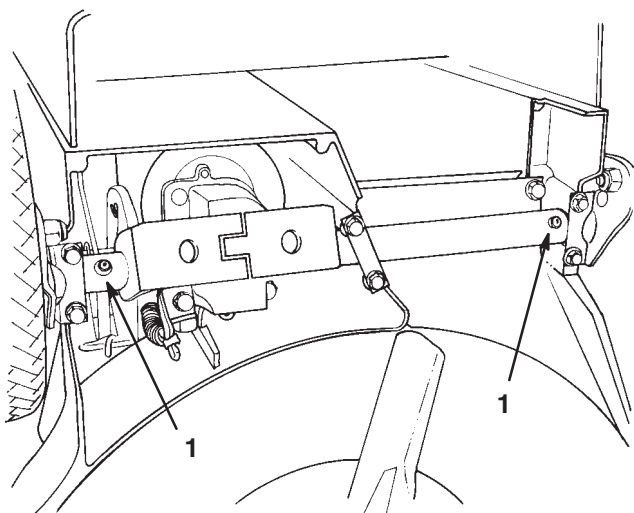

Figure 27

1. Grease fitting (self-propelled model)

Cleaning

Plug and Discharge Tunnel

To ensure best performance, the discharge tunnel plug must be cleaned after each use. When grass is thick and lush, clippings may collect on and around the plug; this may make plug removal difficult. After each use, remove plug from discharge tunnel and clean off all debris.

Underside of Mower Housing

Keep underside of mower housing clean. Be especially careful to keep kickers free of debris (Fig. 29).

Washing Method

1. Position mower on a flat surface near a garden hose.
2. Start the engine.
3. Hold the running garden hose at handle level and direct water to flow on ground just in front of right rear tire (Fig. 28). The rotating blade will draw water under the housing and wash out clippings. Let the water run for a few minutes or until you no longer see clippings being washed out from under housing.

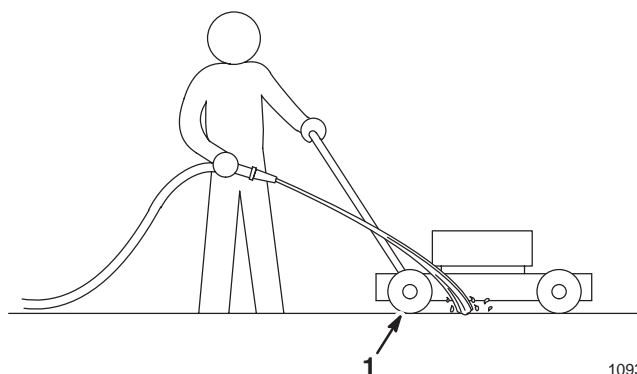

Figure 28

1. Right rear wheel

4. Stop the engine.
5. Turn off the garden hose.
6. Restart mower and let it run for a few minutes to dry out moisture on the mower and its components.

Scraping Method

If washing does not remove all debris from under deck, tip mower and scrape it clean.

1. Pull wire off spark plug.

2. Drain gasoline; refer to Draining Gasoline, page 17.

! WARNING

POTENTIAL HAZARD

- Gasoline is extremely flammable, highly explosive and under certain conditions can cause personal injury or property damage.

WHAT CAN HAPPEN

- Tipping mower may cause fuel leakage from carburetor or fuel tank.

HOW TO AVOID THE HAZARD

- Avoid fuel spills by running engine dry or remove gas with hand pump, never siphon.

3. If grass bag is installed on mower, close door in mower housing and remove grass bag.
4. Tip mower on its left side (Fig. 29). Avoid rotating blade because starting problems may result.

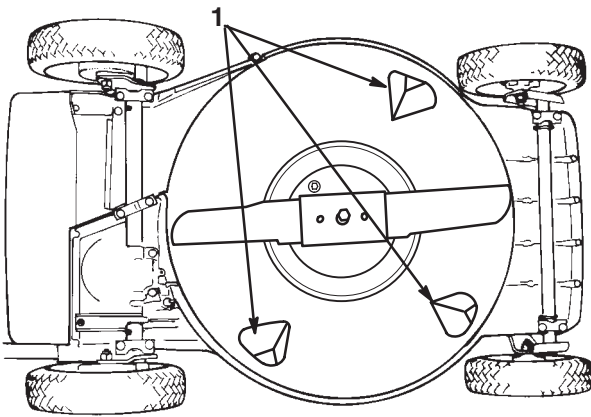

Figure 29

1. Kicker plates

5. Remove dirt and grass clippings with a hardwood scraper. Avoid burrs and sharp edges.
6. Turn mower upright.
7. Refill gas tank.
8. Reconnect spark plug wire.

Storage

1. For long term storage, it is recommended that gasoline be drained from fuel tank or use a fuel additive before storing. To drain gasoline, refer to Draining Gasoline. After fuel is drained, start engine and let it idle until all fuel is consumed and engine stops. If gasoline is not drained, gum-like varnish deposits will form and cause poor engine operation or even starting problems.

Fuel can be left in gas tank only if a fuel additive, such as Toro's Stabilizer/Conditioner, is added to gasoline and run through engine before storing. Toro's Stabilizer/Conditioner is a petroleum distillate based conditioner/stabilizer. Toro does not recommend stabilizers with an alcohol base, such as ethanol, methanol or isopropyl. Use fuel additive in recommended quantities as specified on container.

Under normal conditions, fuel additives remain effective in fuel for 6-8 months.

2. Drain oil: refer to Changing Crankcase Oil. After oil is drained, do not fill crankcase with oil until the following steps (3–10) are completed.
3. Remove spark plug and pour 30 ml (2 tablespoons) of SAE 30 oil into hole in cylinder. Pull starter rope slowly to coat inside of cylinder. Install spark plug and tighten to 20 N·m (15 ft-lb). **DO NOT INSTALL WIRE ON SPARK PLUG.**
4. Clean mower housing; refer to Cleaning Mower Housing.
5. Check condition of blade; refer to Inspecting/Removing/Sharpening Blade.
6. Tighten all nuts, bolts, and screws.
7. Clean dirt, chaff, grass clippings, and grime from external parts of the engine, shrouding, and top of mower housing.
8. Clean air cleaner; refer to Servicing Air Cleaner.
9. Lubricate the wheels; refer to Lubrication section.
10. Touch up all rusted or chipped paint surfaces. Toro Re-Kote paint is available from an Authorized TORO Service Dealer.
11. Fill crankcase with oil; refer to Fill Crankcase With Oil.
12. Store mower in a clean, dry place. Cover mower to keep it clean and protected.

