



## 36" Recycler® Kit

for Mid-Size Mowers

MODEL NO. 30142

**INSTALLATION  
INSTRUCTIONS**

### Loose Parts

**Note:** Use the chart below to identify parts for assembly.

DESCRIPTION	QTY.	USE
Baffle	1	Install Recycler® baffle
Bolt 5/16-18 x 5/8" (16 mm)	1	
Flange nut 5/16-18	6	
Blocker plate	1	Install blocker plate
Bolt 3/8-16 x 1" (25 mm)	1	
Flange nut 3/8-16	1	
Bolt 1/4-20 x 3/4" (19 mm)	2	
Flange nut 1/4-20	2	
Cover plate	1	Cover discharge opening
Bolt 3/8-16 x 3/4" (19 mm)	4	
Flange nut 3/8-16	4	
Kicker	2	Install kickers
Bolt 5/16-18 x 5/8" (16 mm)	4	
Flange nut 5/16-18	4	
Recycler® blade	2	Replace standard blades on mower

### Preparing the Mower

1. Remove belt cover from top of mower.
2. Thoroughly clean underside of the mower. All debris must be removed to ensure that baffles and kickers will fit properly against the cutting chamber.
3. Tilt the mower up and support with jack stands to ease installation of kit.
4. Flip up discharge chute and remove the discharge baffle near discharge opening (Fig. 1).

**Note:** Replace hardware in top of mower when baffle is removed for safety and to save for use when using mower to side discharge.

**⚠ DANGER**

**POTENTIAL HAZARD**

- Open holes in the mower expose you and others to thrown debris.

**WHAT CAN HAPPEN**

- Debris thrown out of holes in the mower can cause injury.

**HOW TO AVOID THE HAZARD**

- Never operate the mower without hardware mounted in all holes in the mower.
- Install hardware in all open holes when the Recycler® kit is removed.

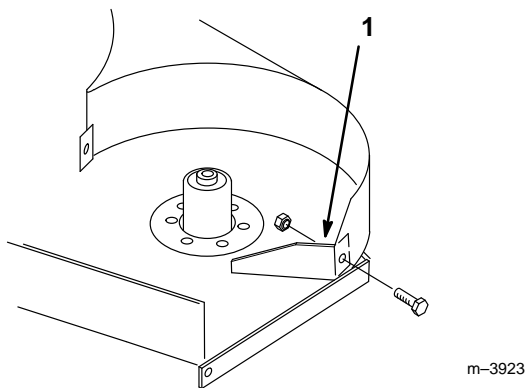

**Figure 1**

1. Discharge baffle

**Installing the Baffle**

1. Remove the (5) 5/16–18 x 5/8” (16 mm) carriage bolt and 3/8” locknuts from the holes where the baffles will be installed (Fig. 2).

**Note:** Save hardware for use when using mower to side discharge.

2. Place the baffle inside cutting chamber with studs through the top. Secure studs to top of mower with (5) 5/16-18 flange nuts and to the back baffle with a 5/16-18 x 5/8” (16 mm) bolt and 5/16-18 flange nut (Fig. 2).

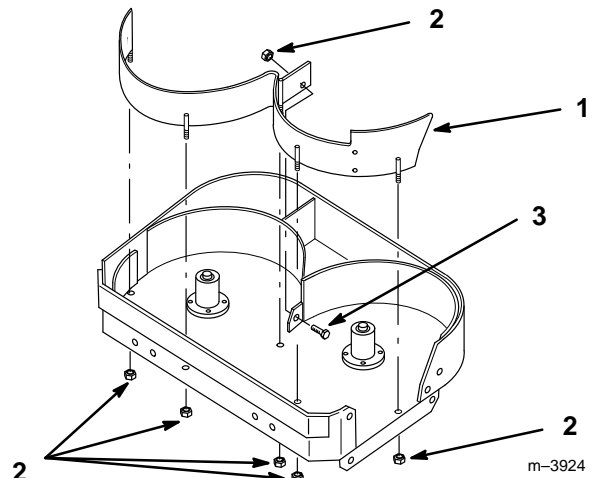

**Figure 2**

- |                       |                                |
|-----------------------|--------------------------------|
| 1. Baffle             | 3. Bolt 5/16–18 x 5/8” (16 mm) |
| 2. flange nut 5/16-18 |                                |

3. Place the blocker plate inside cutting chamber between the front and baffle. Secure blocker to the front of mower with 3/8–16 x 1” bolt and a 3/8–16 flange nut, replacing existing caster mounting hardware, and to the front of the baffle with (2) 1/4–20 x 5/8” (16 mm) bolt and (2) 1/4–20 flange nuts (Fig. 2).

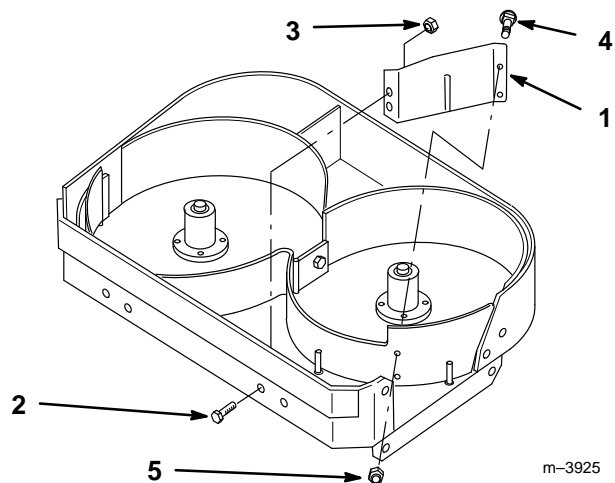

**Figure 3**

- |                               |                               |
|-------------------------------|-------------------------------|
| 1. Blocker plate              | 4. Bolt 1/4–20 x 5/8” (16 mm) |
| 2. Bolt 3/8–16 x 5/8” (16 mm) | 5. flange nut 1/4–20          |
| 3. Flange nut 3/8–16          |                               |

- Place (4) 3/8-16 x 3/4" (19 mm) bolts, through from outside of discharge cover plate. Secure bolts with (4) 3/8-16 flange nuts (Fig. 4).

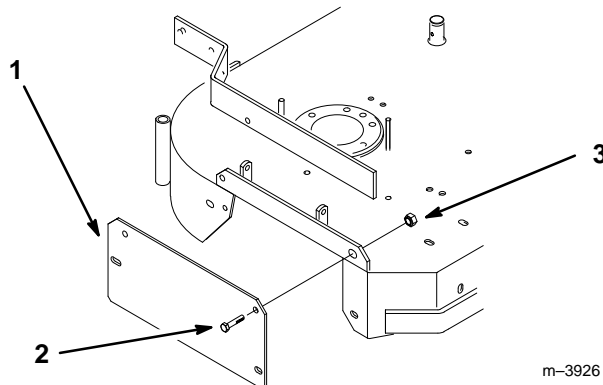

**Figure 4**

- Discharge cover plate
- Bolt 3/8-16 x 3/4" (19 mm)
- Flange nut 3/8-16

- Tighten all mounting hardware securely.

## Installing the Kickers

- Measure from the spindle center lines, and locate kickers as shown (Fig. 5). Right spindles 7/16" (11 mm) off to the right and left spindle 1-7/8" (48 mm) off to the left (Fig. 5).
- Holding kickers tight against baffle, mark, center punch and drill (2) 11/32" (9 mm) holes for each kicker (Fig. 5).

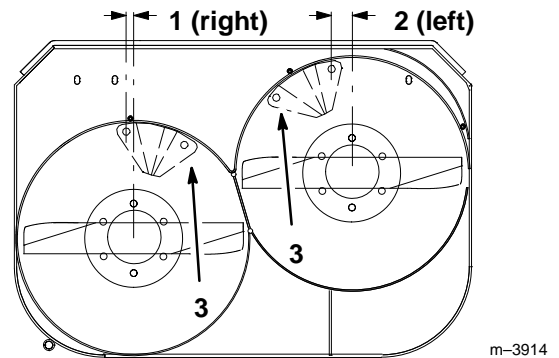

**Figure 5**

- 7/16" (11 mm)
- 1-7/8" (48 mm)
- Mark, center punch and drill 11/32" (9 mm) holes

Place (2) kickers inside the mower over drilled holes. Secure each kicker with (2) 5/16-18 x 5/8" (16 mm) bolts, through from the bottom of the mower, and (2) 5/16-18 flange nuts (Fig. 6).

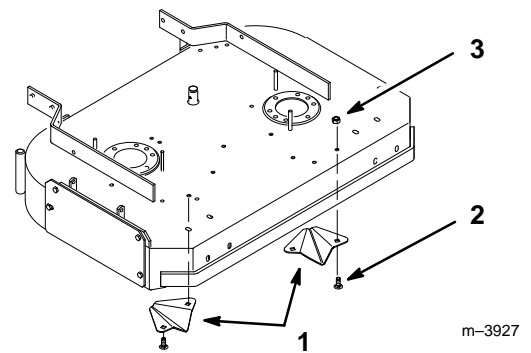

**Figure 6**

- Kicker
- Bolt 5/16-18 x 5/8" (16 mm)
- Flange nut 5/16-16

- Tighten all mounting hardware securely.

## Installing the Recycler® Blades

1. Remove the standard blades (Fig. 7). Refer to Operator's Manual.
2. Place the blade onto the bolt, over cone washer. Select proper number of spacer(s) for height-of-cut and slide bolt into spindle (Fig. 7).

**IMPORTANT: The sail (curved part of the blade) must be pointing toward the inside of the mower to ensure proper cutting.**

3. Install remaining spacer(s) for proper height-of-cut and secure with thin washer and nut (Fig. 7).
4. Torque the blade bolt to 75–80 ft. lb. (101–108 N•m).
5. Rotate the blades to ensure that there is at least 1/8" clearance between the blades and baffles.
6. Remove jack stands and lower mower.

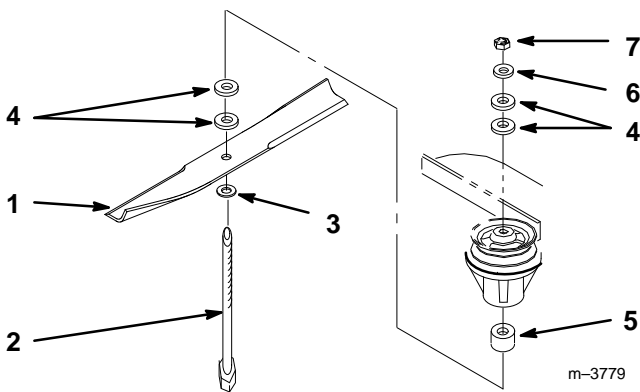

Figure 7

- |                   |                |
|-------------------|----------------|
| 1. High-lift lade | 5. Tube        |
| 2. Blade bolt     | 6. Thin washer |
| 3. Cone washer    | 7. Nut         |
| 4. Spacer         |                |

## Removing Baffles for Side Discharge Cutting

1. Thoroughly clean the mower.
2. Tilt the mower up and support with jack stands to ease removal of kit.
3. Remove the mounting hardware from the baffle, blocker plate, kickers and discharge cover plate.

**Note:** Save the hardware for use when installing the baffle.

### DANGER

#### POTENTIAL HAZARD

- Open holes in the mower expose you and others to thrown debris.

#### WHAT CAN HAPPEN

- Debris thrown out of holes in the mower can cause injury.

#### HOW TO AVOID THE HAZARD

- Never operate the mower without hardware mounted in all holes in the mower.
- Install hardware all open holes when the Recycler® is removed.

4. Install previously removed discharge baffle
5. Install previously removed standard blades.
6. Remove jack stands and lower mower.