



**Count on it.**

**Operator's Manual**

# 18in Dethatcher

Model No. 23513—Serial No. 31600001 and Up

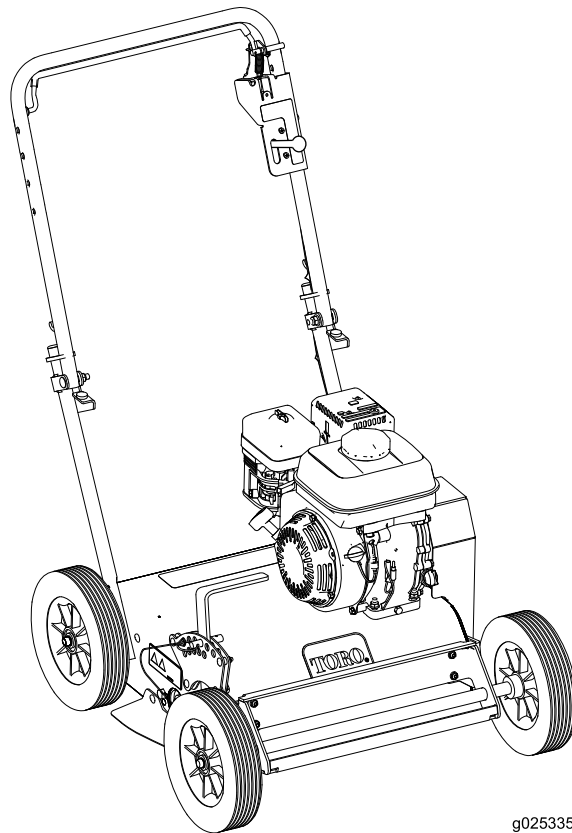

g025335



This product complies with all relevant European directives; for details, please see the separate product specific Declaration of Conformity (DOC) sheet.

**▲ WARNING**

**CALIFORNIA  
Proposition 65 Warning**

**This product contains a chemical or chemicals known to the State of California to cause cancer, birth defects, or reproductive harm.**

**The engine exhaust from this product contains chemicals known to the State of California to cause cancer, birth defects, or other reproductive harm.**

It is a violation of California Public Resource Code Section 4442 or 4443 to use or operate the engine on any forest-covered, brush-covered, or grass-covered land unless the engine is equipped with a spark arrester, as defined in Section 4442, maintained in effective working order or the engine is constructed, equipped, and maintained for the prevention of fire.

This spark ignition system complies with Canadian ICES-002.

# Introduction

This machine dethatches turf. It is intended for small to medium sized lawn applications in residential and commercial properties.

Read this information carefully to learn how to operate and maintain your product properly and to avoid injury and product damage. You are responsible for operating the product properly and safely.

You may contact Toro directly at [www.Toro.com](http://www.Toro.com) for product and accessory information, help finding a dealer, or to register your product.

Whenever you need service, genuine Toro parts, or additional information, contact an Authorized Service Dealer or Toro Customer Service and have the model and serial numbers of your product ready. [Figure 1](#) illustrates the location of the model and serial numbers on the product. Write the numbers in the space provided.

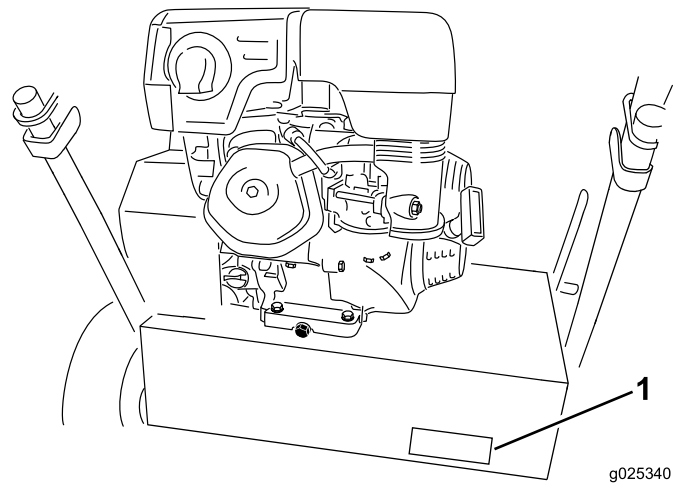

**Figure 1**

1. Location of the model and serial numbers

<b>Model No.</b> _____
<b>Serial No.</b> _____

This manual identifies potential hazards and has safety messages identified by the safety-alert symbol ([Figure 2](#)), which signals a hazard that may cause serious injury or death if you do not follow the recommended precautions.



**Figure 2**

1. Safety-alert symbol

This manual uses 2 words to highlight information.

**Important** calls attention to special mechanical information and **Note** emphasizes general information worthy of special attention.

# Contents

Safety .....	3
Safe Operating Practices .....	3
Safety and Instructional Decals .....	4
Setup .....	6
Unfolding the Handle .....	6
Checking the Engine-Oil Level.....	6
Product Overview .....	6
Controls .....	6
Specifications .....	8
Attachments/Accessories.....	8
Operation .....	9
Checking the Engine-Oil Level.....	9
Cleaning Debris from the Machine.....	9
Adding Fuel.....	9
Starting and Shutting Off the Engine.....	11
Operating the Machine.....	11
Operating Tips .....	11
Maintenance .....	12
Recommended Maintenance Schedule(s) .....	12
Premaintenance Procedures .....	12
Disconnecting the Spark-Plug Wire.....	12
Engine Maintenance .....	13
Servicing the Air Cleaner .....	13
Servicing the Engine Oil.....	13
Cleaning the Sediment Cup.....	14
Servicing the Spark Plug .....	14
Belt Maintenance .....	15
Checking the Belt Tension .....	15
Adjusting the Belt Tension.....	16
Maintaining the Flail Blades .....	16
Inspecting the Flail Blades .....	16
Replacing the Flail Blades .....	16
Storage .....	18
Removing the Machine from Storage.....	18

# Safety

**Improper use or maintenance by the operator or owner can result in injury. To reduce the potential for injury, comply with these safety instructions and always pay attention to the safety alert symbol, which means *Caution*, *Warning*, or *Danger*—personal safety instruction. Failure to comply with the instruction may result in personal injury or death.**

## Safe Operating Practices

The following instructions are based on the ANSI B71.4—2004 standard.

### Training

- Read the *Operator's Manual* and other training material. If the operator(s) or mechanic(s) cannot read English, it is the owner's responsibility to explain this material to them.
- Become familiar with the safe operation of the equipment, operator controls, and safety signs.
- All operators and mechanics should be trained. The owner is responsible for training the users.
- Never let children or untrained people operate or service the equipment. Local regulations may restrict the age of the operator.
- The owner/user can prevent and is responsible for accidents or injuries occurring to himself or herself, other people, or property.

### Preparation

- Evaluate the terrain to determine what accessories and attachments are needed to properly and safely perform the job. Only use accessories and attachments approved by the manufacturer.
- Wear appropriate clothing including eye protection; slip-resistant, substantial footwear; and hearing protection. Tie back long hair and do not wear jewelry.
- Inspect the area where the equipment is to be used and remove all objects such as rocks, toys, and wire, which can be contacted by the machine.
- Use extra care when handling fuel and other fluids. They are flammable and vapors are explosive.
  - Use only an approved container.
  - Never remove the fuel-tank cap or add fuel with the engine running.
  - Allow the engine to cool before refueling.
  - Do not smoke.
  - Never refuel or drain the machine indoors.
- Check that the operator presence controls, safety switches, and shields are attached and functioning properly. Do not operate them unless they are functioning properly.

## Operation

- Never run an engine in an enclosed area.
- Only operate in good light, keeping away from holes and hidden hazards.
- Start the engine only from the operator's position.
- Never operate without the shields, covers, or other guards securely in place. Be sure all interlocks are functioning properly.
- Do not change the engine governor setting or overspeed the engine.
- Raise the flail blades, stop the machine, and shut off the engine before leaving the operator's position for any reason.
- Stop the equipment and inspect the flail blades after striking an object or if an abnormal vibration occurs. Make necessary repairs before resuming operation.
- Keep hands and feet away from the flail blade area.
- Keep pets and bystanders away from the machine.
- Be alert, slow down, and use caution when making turns. Look behind and to the side before changing directions.
- Do not operate the machine while ill, tired, or under the influence of alcohol or drugs.
- Lightning can cause severe injury or death. If lightning is seen or thunder is heard in the area, do not operate the machine; seek shelter.
- Use extreme care when loading or unloading the machine into a trailer or truck.
- Use care when approaching blind corners, shrubs, trees, or other objects that may obscure vision.
- Always be aware of obstacles that may be in the area of operation. Plan your path to avoid contact with any obstacle by you or the machine.

## Slope Operation

- Do not operate on slopes when grass is wet. Slippery conditions reduce traction and could cause sliding and loss of control.
- Remove or mark obstacles such as rocks, tree limbs, etc. from the operating area.
- Always avoid sudden starting or stopping on a slope. If tires lose traction, disengage the flail blades and proceed slowly off the slope.

## Maintenance and Storage

- Wait for all movement to stop before adjusting, cleaning, or repairing. Raise the flail blades, stop the machine, shut off the engine, and disconnect the spark-plug wire.
- Clean grass and debris from the blades, drives, mufflers, and engine to help prevent fires. Clean up oil or fuel spills.
- Let the engine cool before storing, and do not store the machine near a flame.
- Shut off the fuel while storing or transporting the machine on trailers. Do not store fuel near flames or drain indoors.
- Park the machine on a level surface. Never allow untrained personnel to service it.
- Use jack stands or safety latches to support components when required.
- Carefully release pressure from components with stored energy.
- Remove the spark-plug wire before making any repairs.
- Keep hands and feet away from moving parts. If possible, do not make adjustments with the engine running.
- Keep all parts in good working condition and all hardware tightened. Replace all worn or damaged decals.
- Use only Toro-approved attachments. The warranty may be voided if the machine is used with unapproved attachments.

## Safety and Instructional Decals



Safety decals and instructions are easily visible to the operator and are located near any area of potential danger. Replace any decal that is damaged or lost.

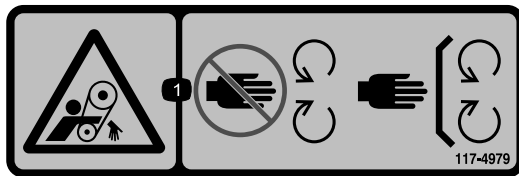

117-4979

1. Warning—stay away from moving parts; keep all guards in place.



93-7321

1. Warning—stay away from moving parts; keep all guards in place.

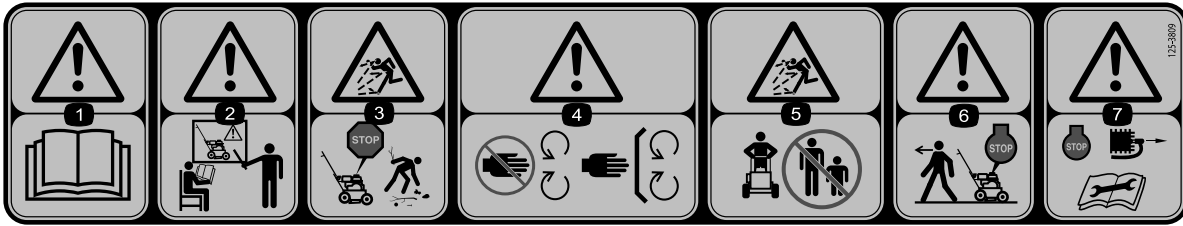

125-3809

1. Warning—read the *Operator's Manual*.
2. Warning—do not operate this machine unless you are trained.
3. Thrown object hazard—shut off the engine and remove any debris from your path.
4. Warning—stay away from moving parts; keep all guards in place.
5. Thrown object hazard—keep bystanders away from the machine.
6. Warning—shut off the engine before walking away from the machine.
7. Warning—shut off the engine and disconnect the spark plug wire before performing maintenance on the machine.



125-3897

1. Warning—stay away from moving parts; keep all guards and shields in place.

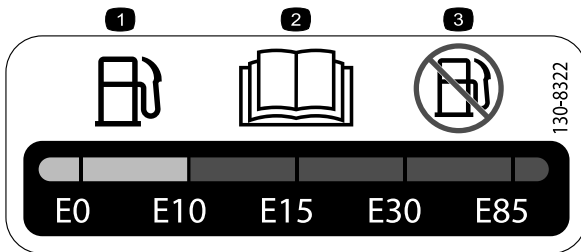

130-8322

1. Only use fuel with an alcohol content by volume under 10%.
2. Read the *Operator's Manual* for more information on fuel.
3. Do not use fuel with an alcohol content by volume greater than 10%.

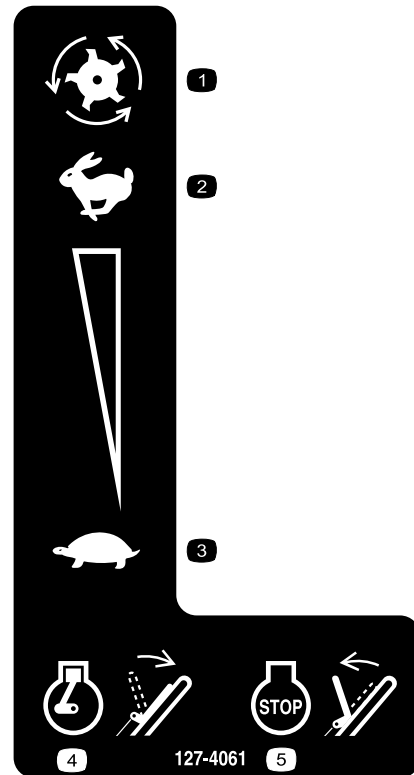

127-4061

1. Cutting blades
2. Fast
3. Slow
4. Hold the handle to start the engine.
5. Release the handle to shut off the engine.

# Setup

## Unfolding the Handle

1. Raise the handle to the operating position (Figure 3).

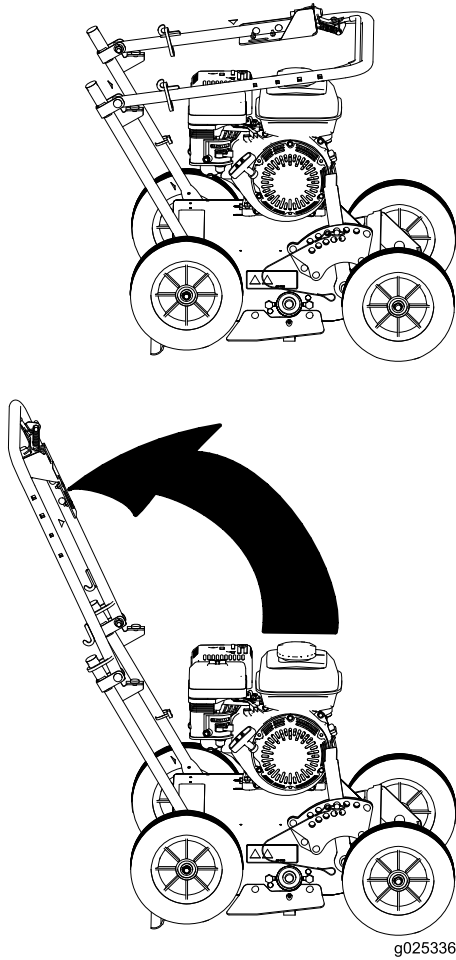

Figure 3

2. Slide the oval locking rings down each side of the upper handle over the lower handle, locking the handle sections together (Figure 3).

## Checking the Engine-Oil Level

The machine comes from the factory with oil in the engine crankcase, however, it may be necessary to add oil; refer to [Servicing the Engine Oil](#) (page 13).

# Product Overview

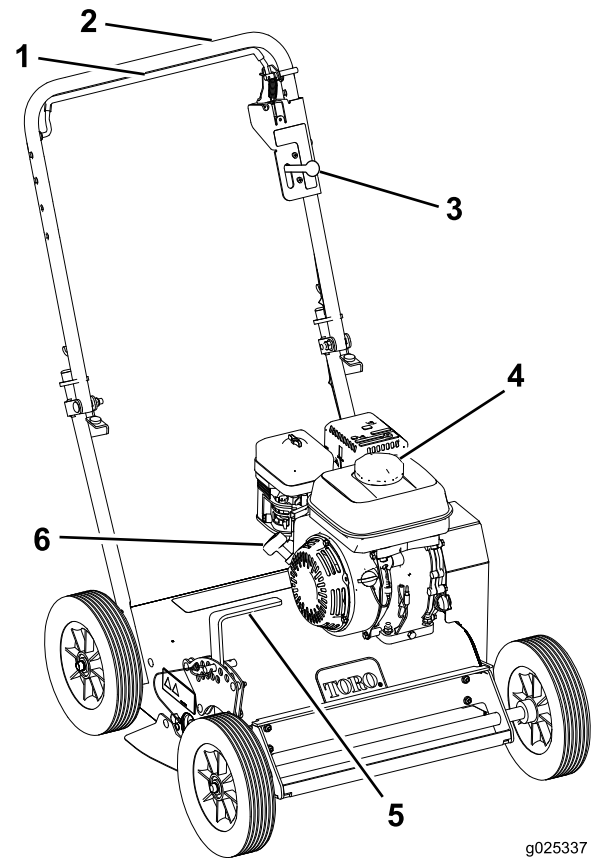

Figure 4

- |                           |                          |
|---------------------------|--------------------------|
| 1. Operator-presence bail | 4. Fuel tank             |
| 2. Handle                 | 5. Depth-control lever   |
| 3. Throttle-control lever | 6. Recoil-starter handle |

## Controls

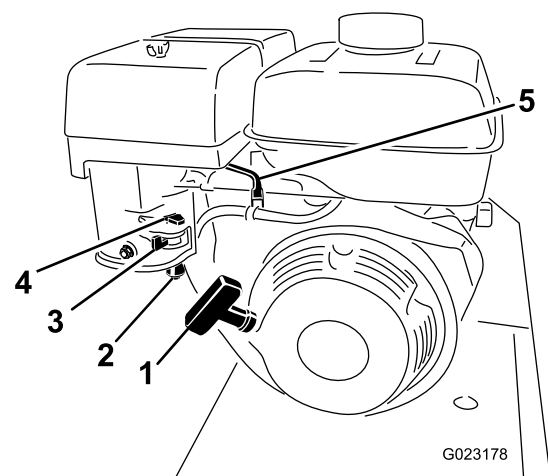

Figure 5

- |                       |                   |
|-----------------------|-------------------|
| 1. Recoil starter     | 4. Choke lever    |
| 2. Sediment cup       | 5. Throttle lever |
| 3. Fuel-shutoff valve |                   |

## Recoil Starter

Pull the recoil-starter handle to start the engine (Figure 5).

## Fuel-Shutoff Valve

Close the fuel-shutoff valve when transporting or storing the machine (Figure 5).

## Choke Lever

Before starting a cold engine, move the choke lever forward. After the engine starts, regulate the choke to keep the engine running smoothly. As soon as possible, move the choke lever all the way rearward.

**Note:** A warm engine requires little or no choking.

## Operator-Presence Bail

The operator-presence bail allows the machine to start/run.

To start the machine, hold down the operator presence bail (Figure 6). Continue to hold down the operator presence bail to allow the machine to run.

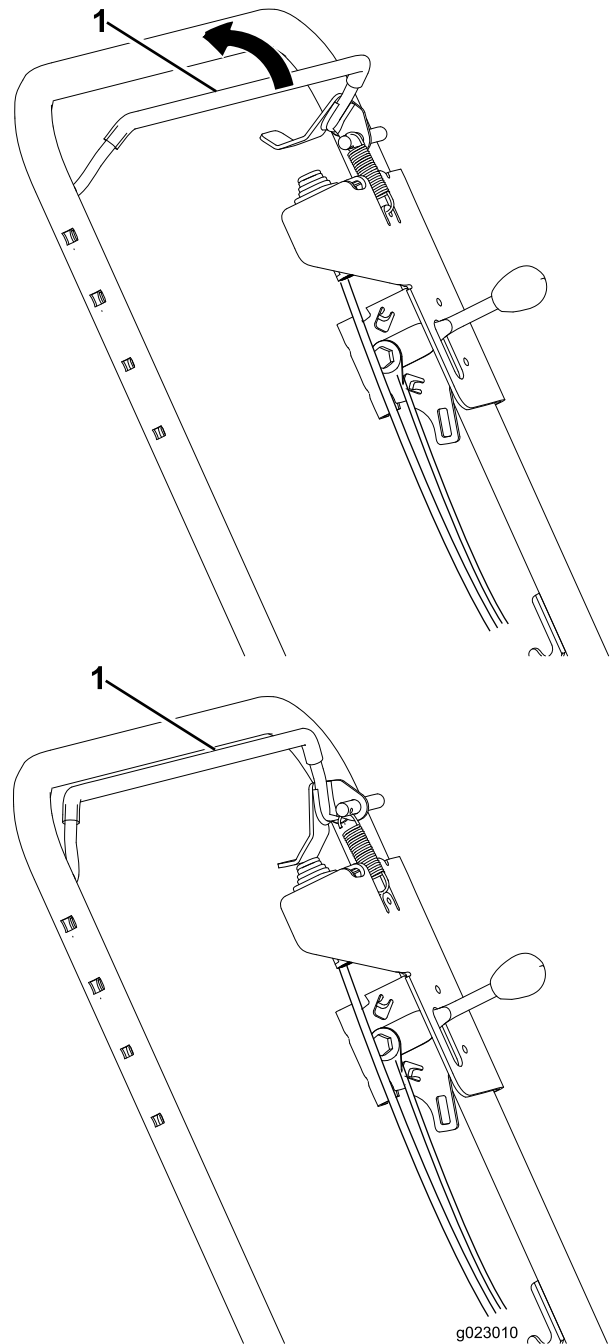

**Figure 6**

1. Operator-presence bail

## Throttle Lever

Move the control forward to increase the engine speed, and rearward to decrease speed (Figure 7).

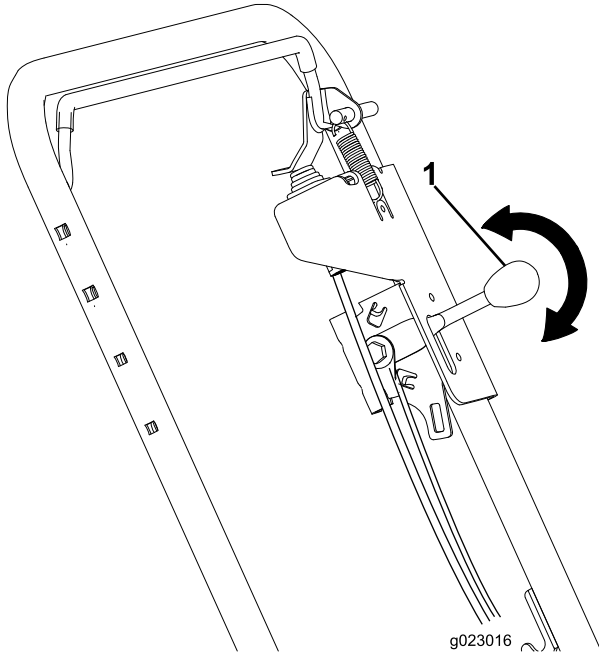

Figure 7

1. Throttle lever

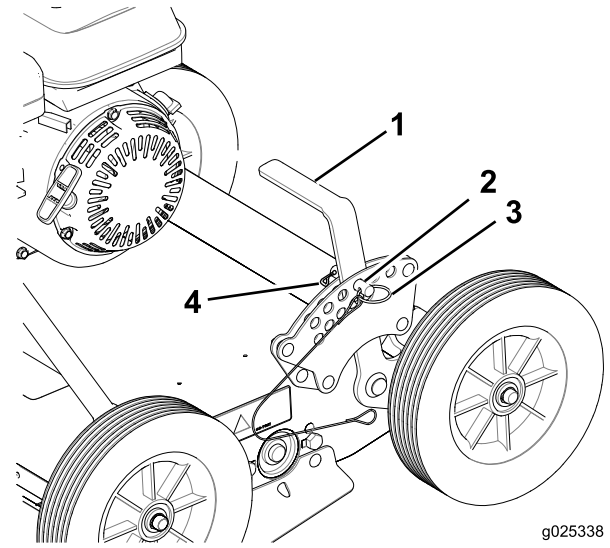

Figure 8

1. Depth-control lever
2. Transport-position hole
3. Hairpin cotter
4. Locking pin

## Depth-Control Lever

The depth-control lever allows you to set the depth of the flail blades in 10 different cutting positions along with 1 position for transportation.

To adjust the depth, remove the hairpin cotter, pull the locking pin out, and move the lever forward or rearward to the desired depth setting (Figure 8).

**Important:** Do not pull the lever side-to-side, as this bends the lever.

## Specifications

**Note:** Specifications and design are subject to change without notice.

Width	69.9 cm (27.5 inches)
Length (operating)	111.8 cm (44 inches)
Length (with handle stored)	86.4 cm (34 inches)
Height (operating)	94 cm (37 inches)
Height (with handle stored)	63.5 cm (25 inches)
Weight	61.2 kg (135 lb)

## Attachments/Accessories

Approved attachments and accessories are available for use with the machine to enhance and expand its capabilities. Contact an Authorized Service Dealer or Distributor or go to [www.Toro.com](http://www.Toro.com) for a list of all approved attachments and accessories.



# Operation

**Note:** Determine the left and right sides of the machine from the normal operating position.

## Checking the Engine-Oil Level

**Service Interval:** Before each use or daily

1. Shut off the engine, disengage the flail blades, and wait for all moving parts to stop.
2. Clean around the dipstick to prevent dirt from falling into the filler hole, which causes damage to the engine (Figure 9).

**Note:** Ensure that the engine is level.

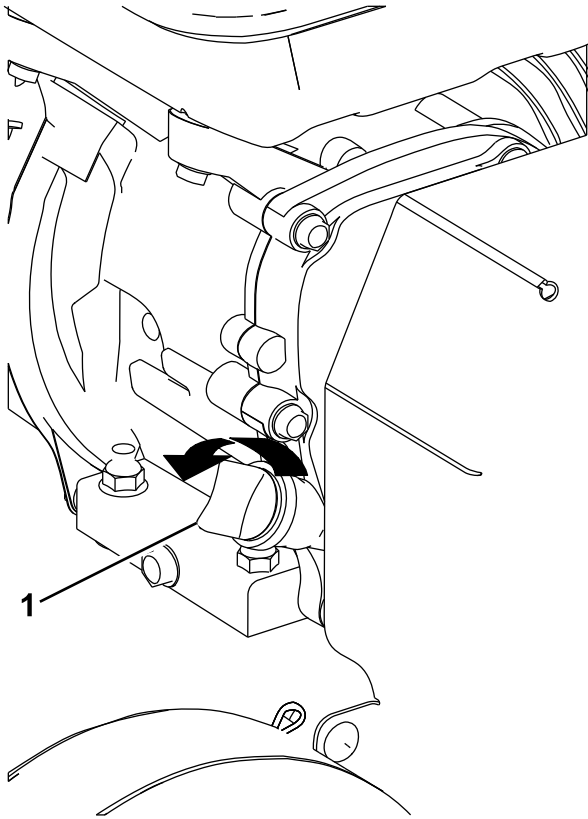

**Figure 9**

g019540

1. Dipstick
3. Unscrew the dipstick and wipe the end clean (Figure 9).
4. Insert the dipstick fully onto the filler tube (Figure 9).

**Important:** Do not screw it in.

5. Remove the dipstick again and look at the end (Figure 10).

**Note:** If the engine-oil level is low, slowly pour only enough oil into the filler tube to raise the level to the middle of the dipstick

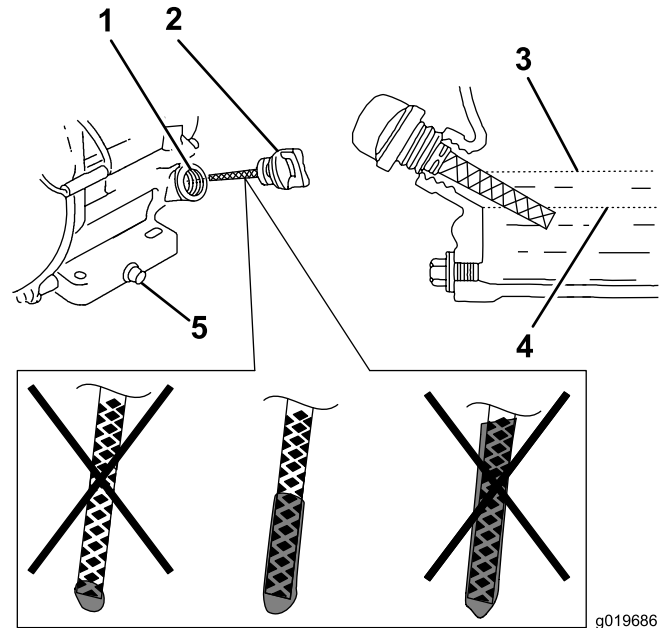

g019686

**Figure 10**

1. Filler tube
2. Dipstick
3. Upper limit
4. Lower limit
5. Oil-drain bolt

**Important:** Do not overfill the crankcase with engine oil and run the engine; engine damage may result.

## Cleaning Debris from the Machine

**Service Interval:** Before each use or daily

1. Disengage the flail blades, shut off the engine, and wait for all moving parts to stop.
2. Brush dirt and debris away from the air cleaner and engine openings.

## Adding Fuel

**Recommended Fuel:**

- For best results, use only clean, fresh (less than 30 days old), unleaded fuel with an octane rating of 87 or higher ((R+M)/2 rating method).
- **Ethanol:** Fuel with up to 10% ethanol (gasohol) or 15% MTBE (methyl tertiary butyl ether) by volume is acceptable. Ethanol and MTBE are not the same. Fuel with 15% ethanol (E15) by volume is not approved for use. **Never use fuel that contains more than 10% ethanol by volume**, such as E15 (contains 15% ethanol), E20 (contains 20% ethanol), or E85 (contains up to 85% ethanol). Using unapproved fuel may cause performance problems and/or engine damage which may not be covered under warranty.
- **Do not** use fuel containing methanol.

- Do not store fuel either in the fuel tank or fuel containers over the winter unless a fuel stabilizer is used.
- Do not add oil to fuel.

**Important:** To reduce starting problems, add fuel stabilizer to the fuel all season, mixing it with fuel less than 30 days old; run the machine dry before storing it for more than 30 days.

Do not use fuel additives other than a fuel stabilizer/conditioner. Do not use fuel stabilizers with an alcohol base such as ethanol, methanol, or isopropanol.

## ⚠ DANGER

In certain conditions, fuel is extremely flammable and highly explosive. A fire or explosion from fuel can burn you and others and can damage property.

- Fill the fuel tank outdoors, in an open area, when the engine is cold. Wipe up any fuel that spills.
- Never fill the fuel tank inside an enclosed trailer.
- Do not fill the fuel tank completely full. Add fuel to the fuel tank until the level is 6 to 13 mm (1/4 to 1/2 inch) below the bottom of the filler neck. This empty space in the tank allows fuel to expand.
- Never smoke when handling fuel, and stay away from an open flame or where fuel fumes may be ignited by a spark.
- Store fuel in an approved container and keep it out of the reach of children. Never buy more than a 30-day supply of fuel.
- Do not operate without the entire exhaust system in place and in proper working condition.

## ⚠ DANGER

In certain conditions during fueling, static electricity can be released, causing a spark which can ignite the fuel vapors. A fire or explosion from fuel can burn you and others and can damage property.

- Always place fuel containers on the ground away from your vehicle before filling.
- Do not fill fuel containers inside a vehicle or on a truck or trailer bed, because interior carpets or plastic truck bed liners may insulate the container and slow the loss of any static charge.
- When practical, remove fuel-powered equipment from the truck or trailer, and refuel the equipment with its wheels on the ground.
- If this is not possible, then refuel such equipment on a truck or trailer from a portable container rather than from a fuel-dispenser nozzle.
- If a fuel-dispenser nozzle must be used, keep the nozzle in contact with the rim of the fuel tank or container opening at all times until fueling is complete.

## Filling the Fuel Tank

1. Disengage the flail blades, shut off the engine, and wait for all moving parts to stop.
2. Allow the engine to cool.
3. Clean around the fuel-tank cap and remove it (Figure 11).

**Note:** The cap is tethered to the fuel tank.

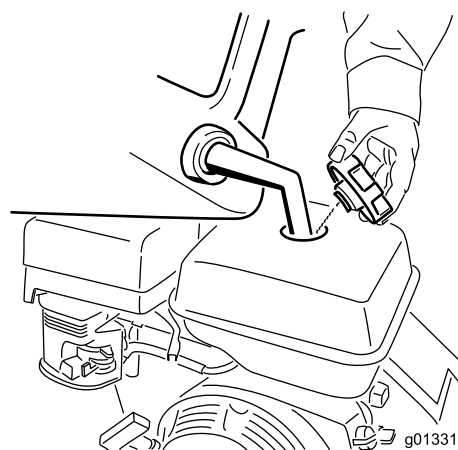

Figure 11

4. Add unleaded fuel to the fuel tank until the level is just inside the mesh filter basket.

**Important:** This space in the tank allows fuel to expand. Do not fill the fuel tank completely full.

5. Install the fuel-tank cap securely.

6. Wipe up any spilled fuel.

## Starting and Shutting Off the Engine

### Starting the Engine

1. Turn on the fuel valve.
2. Move the choke lever forward if you are starting a cold engine.
3. Move the throttle lever midway between the SLOW (turtle) and FAST (rabbit) positions.

**Note:** A warm or hot engine may not require choking.

4. With one hand, hold down the operator-presence bail.
5. Pull the recoil handle sharply to start the engine.
6. After the engine starts, gradually move the choke to the right.

**Note:** If the engine stalls or hesitates, move the choke left again until the engine warms up.

7. Move the throttle lever to desired setting.

### Shutting Off the Engine

1. Release the operator-presence bail.
2. Turn the fuel valve off.
3. Wait for all moving parts to stop.

## Operating the Machine

1. Move the depth-control lever to the desired setting.
2. Start the engine.
3. Push down on the handle to raise the front wheels off the ground.
4. Slowly lower the front wheels to the ground, allowing the blades to gradually work into the grass and soil.
5. When finished, release the operator presence bail, shut off the engine, and raise the cutting blades to the transport setting.

## Operating Tips

### Dethatching

- Set the flail blades 3 to 6 mm (1/8 to 1/4 inch) into the earth (below the zero position).
- Mow yard shorter than normal mowing length before dethatching.
- Dethatch a lawn before the prime growing season.
- After dethatching, remove thatch and debris from lawn with rake.
- Use time of soil exposure to fertilize and seed lawn.
- Give lawn extra watering after dethatching.

### Power Raking/Renovation

To break new ground or till an existing lawn, set the flail blades 6 to 12 mm (1/4 to 1/2 inch) into the earth (below the zero position). Allow the machine to move at its own pace through the soil, going forward and backward over the area to be leveled, or making multiple passes from different directions.

# Maintenance

## Recommended Maintenance Schedule(s)

Maintenance Service Interval	Maintenance Procedure
After the first 25 hours	<ul style="list-style-type: none"><li>• Change the engine oil.</li></ul>
Before each use or daily	<ul style="list-style-type: none"><li>• Check the engine-oil level.</li><li>• Clean debris from the machine.</li><li>• Inspect the air-cleaner elements.</li><li>• Check the belt tension. If the engine is working but the flails seem underpowered, check the belt tension</li><li>• Check the flail blades for wear or damage.</li><li>• Check for loose fasteners.</li></ul>
Every 50 hours	<ul style="list-style-type: none"><li>• Clean the air-filter elements. Clean them more frequently in dusty operating conditions.</li></ul>
Every 100 hours	<ul style="list-style-type: none"><li>• Change the engine oil.</li><li>• Clean the sediment cup.</li><li>• Inspect, clean, and adjust the spark plug; replace it if necessary.</li></ul>
Every 200 hours	<ul style="list-style-type: none"><li>• Replace the spark plug.</li></ul>
Every 300 hours	<ul style="list-style-type: none"><li>• Replace the paper air-cleaner element. Replace it more frequently in dusty operating conditions.</li></ul>
Yearly or before storage	<ul style="list-style-type: none"><li>• Touch up chipped paint.</li></ul>

## Premaintenance Procedures

### Disconnecting the Spark-Plug Wire

Before performing any maintenance on the engine, belts, or cutting blades, disconnect the spark-plug wire from the spark plug ([Figure 12](#)).

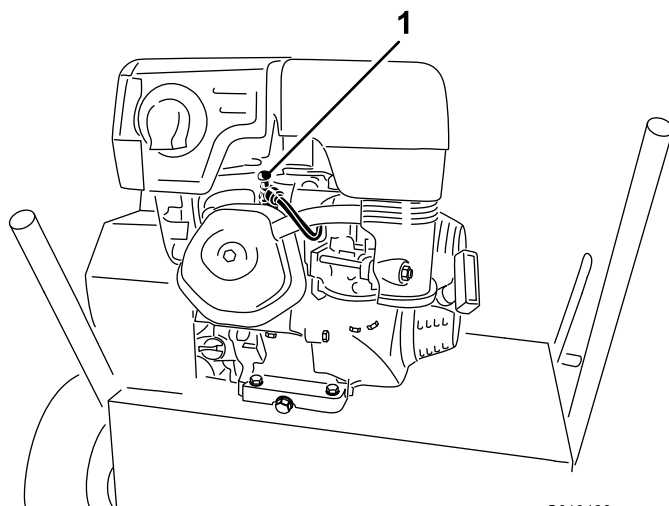

G019426

**Figure 12**

1. Spark-plug wire

# Engine Maintenance

## Servicing the Air Cleaner

**Service Interval:** Before each use or daily—Inspect the air-cleaner elements.

Every 50 hours—Clean the air-filter elements. Clean them more frequently in dusty operating conditions.

Every 300 hours/Yearly (whichever comes first)—Replace the paper air-cleaner element. Replace it more frequently in dusty operating conditions.

**Important:** Do not operate the engine without the air-filter assembly; extreme engine damage will occur.

1. Shut off the engine and wait for all moving parts to stop.
2. Disconnect the wire from the spark plug.
3. Remove the nut that secures the cover (Figure 13).

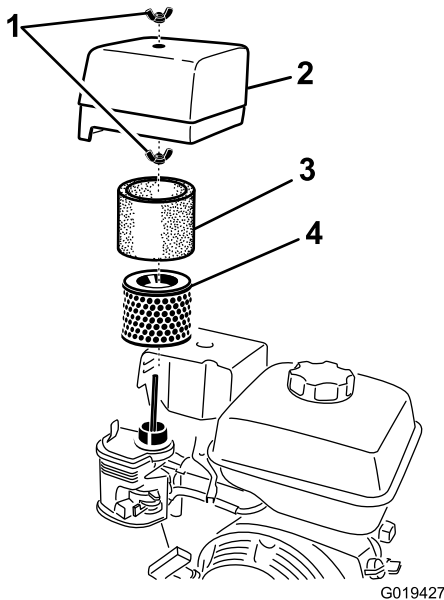

Figure 13

- |          |                  |
|----------|------------------|
| 1. Nut   | 3. Paper element |
| 2. Cover | 4. Foam element  |

4. Remove the cover.

**Note:** Be careful to prevent dirt and debris from falling into the base.

5. Remove the nut-restraining air-filter assembly.
6. Remove the foam and paper elements from the base (Figure 13).
7. Remove the foam element from the paper element (Figure 13).
8. Inspect the foam and paper elements, and replace them if they are damaged or excessively dirty.
9. If the paper element is excessively dirty, replace it.

**Note:** Never try to brush dirt off the paper element; brushing forces the dirt into the fibers.

10. Clean the foam element in warm, soapy water or in a **nonflammable** solvent.
11. Rinse and dry the foam element thoroughly.
12. Dip the foam element in clean engine oil, then squeeze out the excess oil.

**Note:** Excess oil in the foam element restricts the air flow through the element and may reach the paper filter and clog it.

13. Wipe dirt from the base and the cover with a moist rag.

**Note:** Be careful to prevent dirt and debris from entering the air duct leading to the carburetor.

14. Install the air-cleaner elements and ensure that they are properly positioned.
15. Securely install the cover with the nut.

## Servicing the Engine Oil

**Oil Type:** Detergent oil (API service SJ or higher)

**Crankcase Capacity:** 1.1 L (37 oz)

**Viscosity:** See the table below (Figure 14).

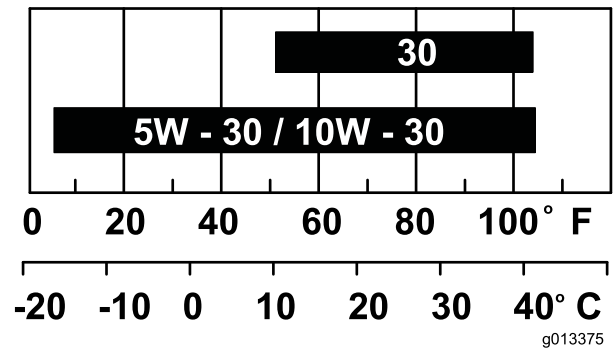

Figure 14

## Changing the Engine Oil

**Service Interval:** After the first 25 hours

Every 100 hours

### ⚠ WARNING

**Oil may be hot after the engine has been run, and contact with hot oil can cause severe personal injury.**

**Avoid contacting the hot engine oil when you drain it.**

1. Shut off the engine by releasing the operator-presence bail, disengage the flail blades, and wait for all moving parts to stop.

2. Disconnect the wire from the spark plug.
3. Raise the front wheels a few inches off the ground and place a pan under the drain plug to catch the oil.
4. Remove the drain plug (Figure 15).

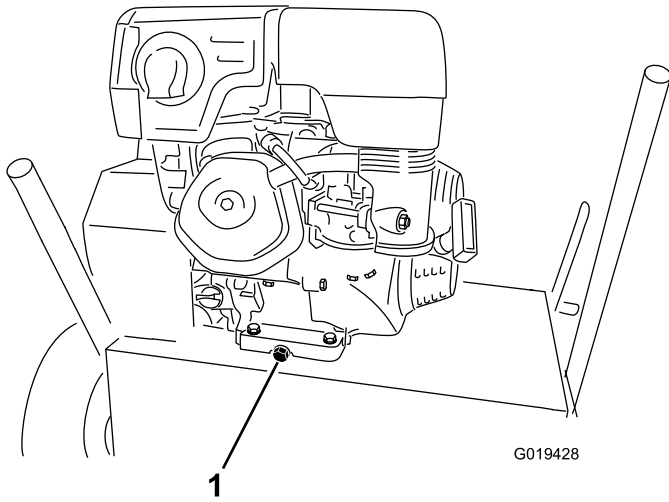

**Figure 15**

1. Drain plug

5. When the oil has drained completely, lower the front wheels to the ground, replace the drain plug, and torque to 18 N·m (13 ft-lb).
 

**Note:** Dispose of the used oil at a certified recycling center.
6. Remove the dipstick and slowly pour oil into the filler hole until the oil level reaches the middle of the dipstick (Figure 10).
7. Replace and secure the dipstick.
8. Wipe up any spilled oil.
9. Connect the wire to the spark plug.

## Cleaning the Sediment Cup

**Service Interval:** Every 100 hours

### **⚠ DANGER**

**In certain conditions, fuel is extremely flammable and highly explosive. A fire or explosion from fuel can burn you and others and can damage property.**

- Shut off the engine and keep heat, sparks, and flame away.
- Handle fuel only outdoors.
- Wipe up spills immediately.
- Do not smoke while handling fuel.

1. Shut off the engine and wait for all moving parts to stop.

2. Disconnect the wire from the spark plug.
3. Move the fuel-shutoff valve to the OFF position.
4. Remove the sediment cup and O-ring (Figure 16).

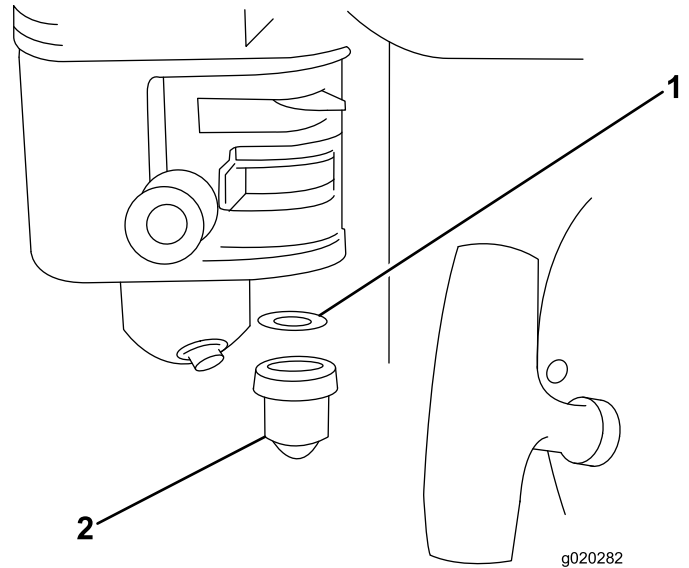

**Figure 16**

1. O-ring
2. Sediment cup

5. Wash the sediment cup in a non-flammable solvent and dry it thoroughly.
6. Place the O-ring in the fuel valve and install the sediment cup, tightening it securely.
7. Move the fuel-shutoff lever to the ON position.

**Note:** If any fuel leaks, repeat this procedure and replace the O-ring.

## Servicing the Spark Plug

**Service Interval:** Every 100 hours—Inspect, clean, and adjust the spark plug; replace it if necessary.

Every 200 hours—Replace the spark plug.

Use an **NGK BPR6ES** spark plug or equivalent.

1. Shut off the engine and wait for all moving parts to stop.
2. Disconnect the wire from the spark plug.
3. Clean around the spark plug.
4. Remove the spark plug from the cylinder head.

**Important:** Replace a cracked, fouled, or dirty spark plug. Do not clean the electrodes because grit entering the cylinder can damage the engine.

5. Set the gap on the plug to 0.76 mm (0.03 inch) as shown in Figure 17.

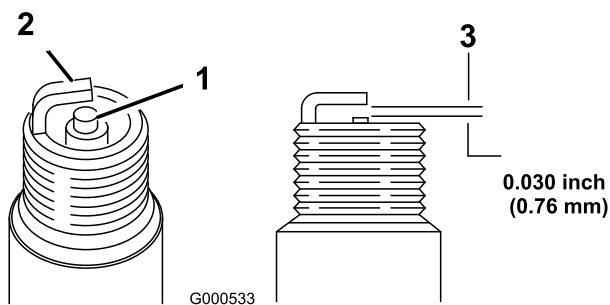

**Figure 17**

1. Center-electrode insulator
2. Side electrode
3. Air gap (not to scale)

6. Carefully install the spark plug by hand (to avoid cross threading) until it is hand tight.
7. Tighten the spark plug an additional 1/2 turn if it is new; otherwise, tighten it an additional 1/8 to 1/4 turn.

**Important:** A loose spark plug can become very hot and can damage the engine; overtightening a spark plug may damage the threads in the cylinder head.

8. Connect the wire to the spark plug.

# Belt Maintenance

## Checking the Belt Tension

**Service Interval:** Before each use or daily—Check the belt tension. If the engine is working but the flails seem underpowered, check the belt tension

1. Stop the machine on a level surface, shut off the engine, disconnect the spark-plug wire, and raise the flail blades to the highest position.
2. Remove the belt cover from the left side of the machine (Figure 18).

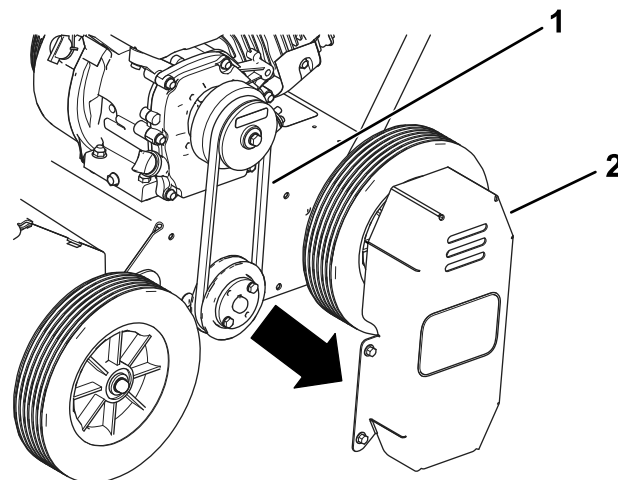

**Figure 18**

1. Belt
2. Cover

3. Check the tension of the belt (Figure 18).

**Note:** The belt should not flex more than a 12 mm (1/2 inch) with moderate finger pressure applied to the span just above the machine frame.

4. If the belt tension is loose, refer to [Adjusting the Belt Tension](#) (page 16).
5. Install the belt cover before operating the machine.

## Adjusting the Belt Tension

1. Stop the machine on a level surface and shut off the engine by releasing the operator-presence bail.
2. To tighten the belt, loosen the 4 mounting nuts securing the engine to the frame.

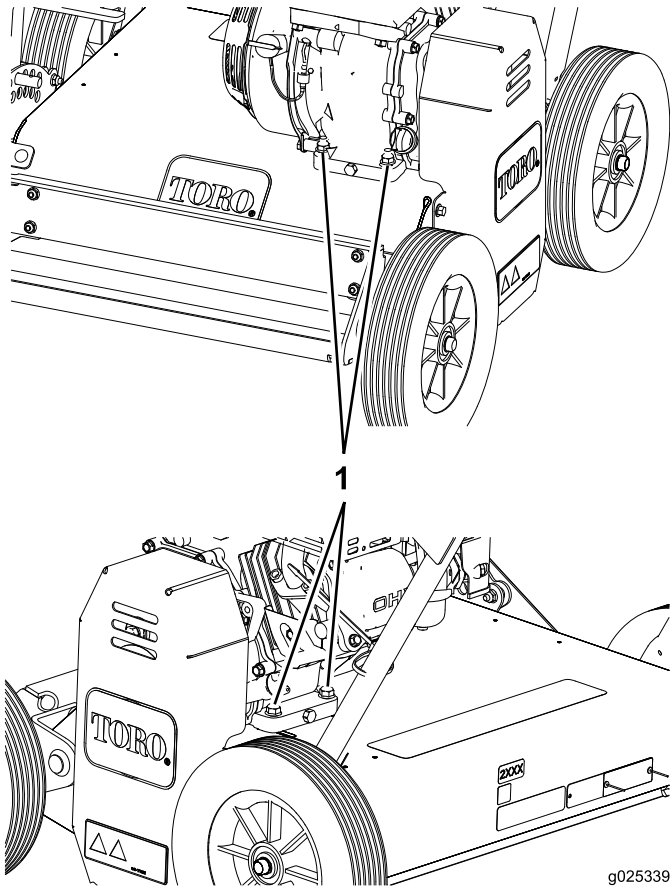

Figure 19

### 1. Mounting nuts

3. Move the engine to tighten the belt to the proper tension.
4. Secure the 4 mounting nuts and bolts.

**Note:** Torque the bolts that secure the engine to the frame to 271 N·m (200 in-lb).

## Maintaining the Flail Blades

### Inspecting the Flail Blades

**Service Interval:** Before each use or daily—Check the flail blades for wear or damage.

When the flail blades are worn down and are no longer functioning properly, refer to [Replacing the Flail Blades \(page 16\)](#).

**Important:** Perform this procedure when the fuel tank is empty or nearly empty. Tip the machine forward to keep air filter up.

### Replacing the Flail Blades

When the flail blades are worn down and no longer functioning properly, replace them as follows:

**Important:** Perform this procedure when the fuel tank is empty or nearly empty.

1. Stop the machine on a level surface and shut off the engine by releasing the operator-presence bail.
2. Lower the flail blades to the lowest position.
3. Tilt the machine forward onto its nose, and rest it on a block of wood.

**Note:** It will take 2 people to tip the machine forward safely.

4. Spin the flail-blade assembly.

**Note:** It should spin freely. If it makes a grinding noise and is halting, the bearings are worn; replace them when you replace the blades.

5. Remove the cotter pin from the rod with the worn down flail ([Figure 20](#)).
6. Carefully pull out the rod to release the flails and spacers ([Figure 20](#)).
7. Replace worn down flails with new ones and discard the old flails.



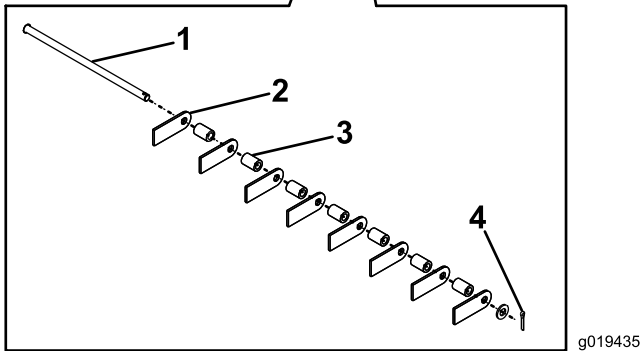
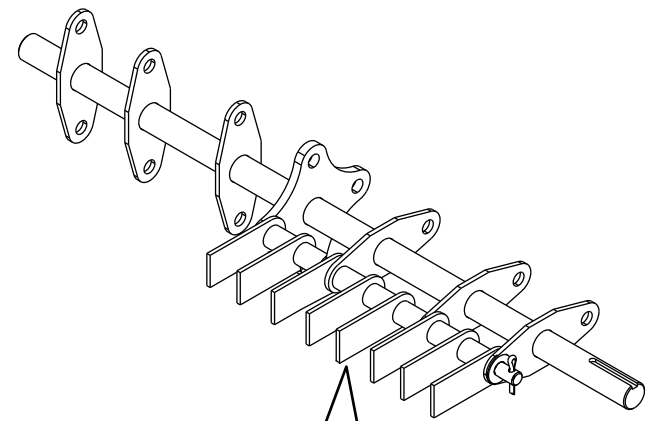

**Figure 20**

- |          |               |
|----------|---------------|
| 1. Rod   | 3. Spacer     |
| 2. Flail | 4. Cotter pin |

- 
8. Carefully add flails and spacers to rod in the same order as they were removed.

**Important:** Align the rod with the formed head toward the center of the machine.

9. Add the cotter pin to lock the rod, flails, and spacers into place.

# Storage

1. Raise the flail blades, stop the machine, shut off the engine, and disconnect the spark-plug wire.
2. Remove dirt and grime from the entire machine.

**Important:** You can wash the machine with mild detergent and water. Do not pressure wash the machine. Avoid excessive use of water, especially near the engine.

3. Service the air cleaner; refer to [Servicing the Air Cleaner \(page 13\)](#).
4. Change the engine oil; refer to [Changing the Engine Oil \(page 13\)](#).
5. For storage over 30 days, prepare the machine as follows:
  - A. Add a petroleum-based stabilizer/conditioner to the fuel in the tank. Follow the mixing instructions from the stabilizer manufacturer. **Do not use an alcohol-based stabilizer (ethanol or methanol).**

**Note:** A fuel stabilizer/conditioner is most effective when mixed with fresh fuel and used at all times.

  - B. Run the engine until it stops from running out of fuel.
  - C. Choke the engine.
  - D. Start and run the engine until it will not start again.
  - E. Dispose of fuel properly. Recycle the fuel according to local codes.

**Important:** Do not store stabilizer/conditioned fuel over 90 days.

6. Check and tighten all bolts, nuts, and screws. Repair or replace any part that is damaged.
7. Paint all scratched or bare metal surfaces with paint from an Authorized Service Dealer.
8. Store the machine in a clean, dry garage or storage area.
9. Cover the machine to protect it and keep it clean.

# Removing the Machine from Storage

1. Check and tighten all fasteners.
2. Inspect the spark plug and replace it if it is dirty, worn, or cracked; refer to the engine *Owner's Manual*.
3. Install the spark plug until it is hand-tight, then an additional 1/2 turn if it is new, otherwise, tighten it an additional 1/8 to 1/4 turn.
4. Perform any needed maintenance procedures; refer to [Maintenance \(page 12\)](#).
5. Check the engine-oil level; refer to [Checking the Engine-Oil Level \(page 9\)](#).
6. Fill the fuel tank with fresh fuel; refer to [Adding Fuel \(page 9\)](#).
7. Connect the wire to the spark plug.

## International Distributor List

<b>Distributor:</b>	<b>Country:</b>	<b>Phone Number:</b>	<b>Distributor:</b>	<b>Country:</b>	<b>Phone Number:</b>
Agrolanc Kft	Hungary	36 27 539 640	Maquiver S.A.	Colombia	57 1 236 4079
Asian American Industrial (AAI)	Hong Kong	852 2497 7804	Maruyama Mfg. Co. Inc.	Japan	81 3 3252 2285
B-Ray Corporation	Korea	82 32 551 2076	Mountfield a.s.	Czech Republic	420 255 704 220
Brisa Goods LLC	Mexico	1 210 495 2417	Mountfield a.s.	Slovakia	420 255 704 220
Casco Sales Company	Puerto Rico	787 788 8383	Munditol S.A.	Argentina	54 11 4 821 9999
Ceres S.A.	Costa Rica	506 239 1138	Norma Garden	Russia	7 495 411 61 20
CSSC Turf Equipment (pvt) Ltd.	Sri Lanka	94 11 2746100	Oslinger Turf Equipment SA	Ecuador	593 4 239 6970
Cyril Johnston & Co.	Northern Ireland	44 2890 813 121	Oy Hako Ground and Garden Ab	Finland	358 987 00733
Cyril Johnston & Co.	Republic of Ireland	44 2890 813 121	Parkland Products Ltd.	New Zealand	64 3 34 93760
Fat Dragon	China	886 10 80841322	Perfetto	Poland	48 61 8 208 416
Femco S.A.	Guatemala	502 442 3277	Pratoverde SRL.	Italy	39 049 9128 128
FIVEMANS New-Tech Co., Ltd	China	86-10-6381 6136	Prochaska & Cie	Austria	43 1 278 5100
ForGarder OU	Estonia	372 384 6060	RT Cohen 2004 Ltd.	Israel	972 986 17979
G.Y.K. Company Ltd.	Japan	81 726 325 861	Riversa	Spain	34 9 52 83 7500
Geomechaniki of Athens	Greece	30 10 935 0054	Lely Turfcare	Denmark	45 66 109 200
Golf international Turizm	Turkey	90 216 336 5993	Lely (U.K.) Limited	United Kingdom	44 1480 226 800
Hako Ground and Garden	Sweden	46 35 10 0000	Solvart S.A.S.	France	33 1 30 81 77 00
Hako Ground and Garden	Norway	47 22 90 7760	Spypros Stavrinides Limited	Cyprus	357 22 434131
Hayter Limited (U.K.)	United Kingdom	44 1279 723 444	Surge Systems India Limited	India	91 1 292299901
Hydroturf Int. Co Dubai	United Arab Emirates	97 14 347 9479	T-Markt Logistics Ltd.	Hungary	36 26 525 500
Hydroturf Egypt LLC	Egypt	202 519 4308	Toro Australia	Australia	61 3 9580 7355
Irrimac	Portugal	351 21 238 8260	Toro Europe NV	Belgium	32 14 562 960
Irrigation Products Int'l Pvt Ltd.	India	0091 44 2449 4387	Valtech	Morocco	212 5 3766 3636
Jean Heybroek b.v.	Netherlands	31 30 639 4611	Victus Emak	Poland	48 61 823 8369

### European Privacy Notice

#### The Information Toro Collects

Toro Warranty Company (Toro) respects your privacy. In order to process your warranty claim and contact you in the event of a product recall, we ask you to share certain personal information with us, either directly or through your local Toro company or dealer.

The Toro warranty system is hosted on servers located within the United States where privacy law may not provide the same protection as applies in your country.

BY SHARING YOUR PERSONAL INFORMATION WITH US, YOU ARE CONSENTING TO THE PROCESSING OF YOUR PERSONAL INFORMATION AS DESCRIBED IN THIS PRIVACY NOTICE.

#### The Way Toro Uses Information

Toro may use your personal information to process warranty claims, to contact you in the event of a product recall and for any other purpose which we tell you about. Toro may share your information with Toro's affiliates, dealers or other business partners in connection with any of these activities. We will not sell your personal information to any other company. We reserve the right to disclose personal information in order to comply with applicable laws and with requests by the appropriate authorities, to operate our systems properly or for our own protection or that of other users.

#### Retention of your Personal Information

We will keep your personal information as long as we need it for the purposes for which it was originally collected or for other legitimate purposes (such as regulatory compliance), or as required by applicable law.

#### Toro's Commitment to Security of Your Personal Information

We take reasonable precautions in order to protect the security of your personal information. We also take steps to maintain the accuracy and current status of personal information.

#### Access and Correction of your Personal Information

If you would like to review or correct your personal information, please contact us by email at [legal@toro.com](mailto:legal@toro.com).

### Australian Consumer Law

Australian customers will find details relating to the Australian Consumer Law either inside the box or at your local Toro Dealer.



# The Toro Warranty

A limited warranty (see warranty periods below)

SWS  
Turf Renovation

## Conditions and Products Covered

The Toro Company and its affiliate, Toro Warranty Company, pursuant to an agreement between them, jointly warrant your Toro Products listed below to be free from defects in materials or workmanship.

This warranty covers the cost of parts and labor, but you must pay transportation costs.

The following time periods apply from the date of purchase:

Products	Warranty Period
Turf Renovation	
Walk-Behind Aerator	1 year
• Engine	2 years
Stand-On Aerator	1 year
• Battery	90 days Parts and Labor
	1 year Parts Only
• Engine	2 years
Dethatcher	1 year
• Engine	2 years
Turf Seeder	1 year
• Engine	2 years
Stand-On Spreader Sprayer	1 year
• Battery	90 days Parts and Labor
	1 year Parts Only
• Engine	2 years
Walk-Behind Rotary Broom	1 year
• Engine	2 years

Where a warrantable condition exists, we will repair the Product at no cost to you including diagnosis, labor, and parts.

## Instructions for Obtaining Warranty Service

If you think that your Toro Product contains a defect in materials or workmanship, follow this procedure\*\*:

1. Contact any Authorized Servicing Outlet to arrange service at their dealership. To locate one convenient to you, access our website at [www.Toro.com](http://www.Toro.com). Select "Where to Buy" and select "Contractor" under product type. You may also call our toll free number below.
2. Bring the product and your proof of purchase (sales receipt) to them.
3. If for any reason you are dissatisfied with the Service Outlet's analysis or with the assistance provided, contact us at:

SWS Customer Care Department  
Toro Warranty Company  
8111 Lyndale Avenue South  
Bloomington, MN 55420-1196  
Toll Free: 888-384-9939

\*\*Toro Authorized Rental Customers who have purchased products directly from Toro and have signed the Toro Rental Customer Agreement have the ability to perform their own warranty work. Please visit Toro's Rental Portal for electronic warranty claim filing procedures or call the toll free number above.

## Owner Responsibilities

You must maintain your Toro Product by following the maintenance procedures described in the *Operator's Manual*. Such routine maintenance, whether performed by a dealer or by you, is at your expense. Parts

scheduled for replacement as required maintenance ("Maintenance Parts"), are warranted for the period of time up to the scheduled replacement time for that part. Failure to perform required maintenance and adjustments can be grounds for disallowing a warranty claim.

## Items and Conditions Not Covered

Not all product failures or malfunctions that occur during the warranty period are defects in materials or workmanship. This express warranty does not cover the following:

- Product failures which result from installation and use of add-on, modified, or unapproved accessories
- Failure to perform required maintenance and/or adjustments
- Repairs necessary due to failure to follow recommended fuel procedure (consult *Operator's Manual* for more details)
  - Removing contaminants from the fuel system is not covered
  - Use of old fuel (more than one month old) or fuel which contains more than 10% ethanol or more than 15% MTBE
  - Failure to drain the fuel system prior to any period of non-use over one month
- Product failures which result from operating the product in an abusive, negligent or reckless manner
- Parts subject to consumption through use unless found to be defective. Examples of parts which are consumed, include, belts, cutters, blades, teeth, spark plugs, tires, filters, etc.
- Failures caused by outside influence include, weather, storage, contamination, lubricants, additives, or chemicals, etc.
- Normal "wear and tear" items includes painted surfaces and scratched decals, etc.
- Any component covered by a separate manufacturer's warranty
- Pickup and delivery charges

## General Conditions

Repair by an Authorized Servicing Outlet or Self-Service as an Authorized Rental Customer is your sole remedy under the warranty.

**Neither The Toro Company nor Toro Warranty Company is liable for indirect, incidental or consequential damages in connection with the use of the Toro Products covered by this warranty, including any cost or expense of providing substitute equipment or service during reasonable periods of malfunction or non-use pending completion of repairs under this warranty. All implied warranties of merchantability and fitness for use are limited to the duration of this express warranty. Some states do not allow exclusions of incidental or consequential damages, or limitations on how long an implied warranty lasts, so the above exclusions and limitations may not apply to you.**

This warranty gives you specific legal rights, and you may also have other rights which vary from state to state.

Except for the engine warranty coverage and the Emissions warranty referenced below, if applicable, there is no other express warranty. The Emissions Control System on your Product may be covered by a separate warranty meeting requirements established by the U.S. Environmental Protection Agency (EPA) or the California Air Resources Board (CARB). Refer to the California Emission Control Warranty Statement supplied with your Product or contained in the engine manufacturer's documentation for details.

## Countries Other than the United States or Canada

Customers who have purchased Toro products outside the United States or Canada should contact their Toro Distributor (Dealer) to obtain guarantee policies for your country, province, or state. If for any reason you are dissatisfied with your Distributor's service or have difficulty obtaining guarantee information, contact the Toro importer. If all other remedies fail, you may contact us at Toro Warranty Company.

**Australian Consumer Law:** Australian customers will find details relating to the Australian Consumer Law either inside the box or at your local Toro Dealer.