



Kit anti-scalp

Tondeuse GrandStand®

N° de modèle 133-1440

Instructions de montage

⚠ ATTENTION

CALIFORNIE

Proposition 65 - Avertissement

Ce produit contient une ou des substances chimiques considérées par l'état de Californie comme capables de provoquer des cancers, des anomalies congénitales ou d'autres troubles de la reproduction.

Préparation de la machine

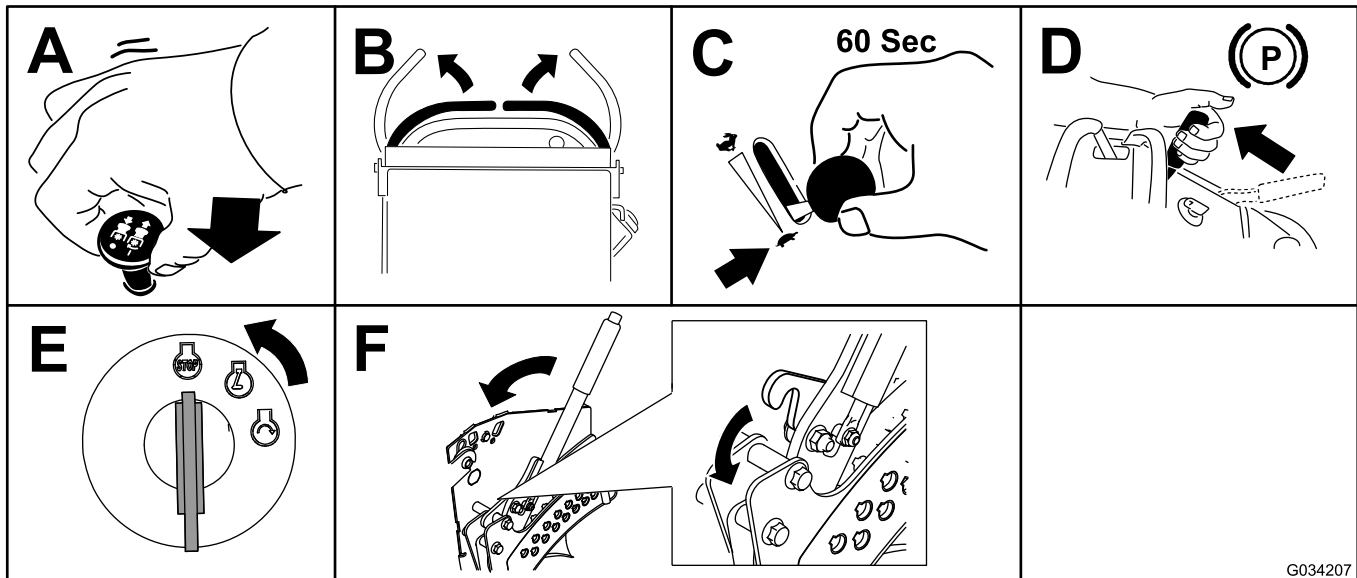

Montage des galets sur les supports

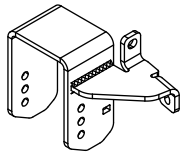

x1

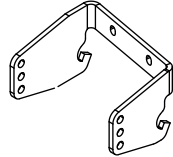

x1

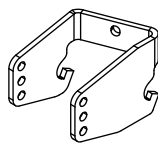

x1

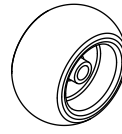

x4

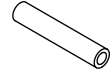

x2

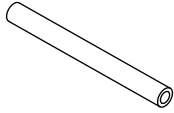

x1



x2

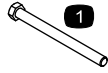

x2

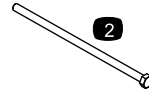

x1



x2



x1

G034208

1. 3/8 x 4-1/2 po

2. 5/16 x 7-1/2 po

3. 3/8 po

4. 5/16 po

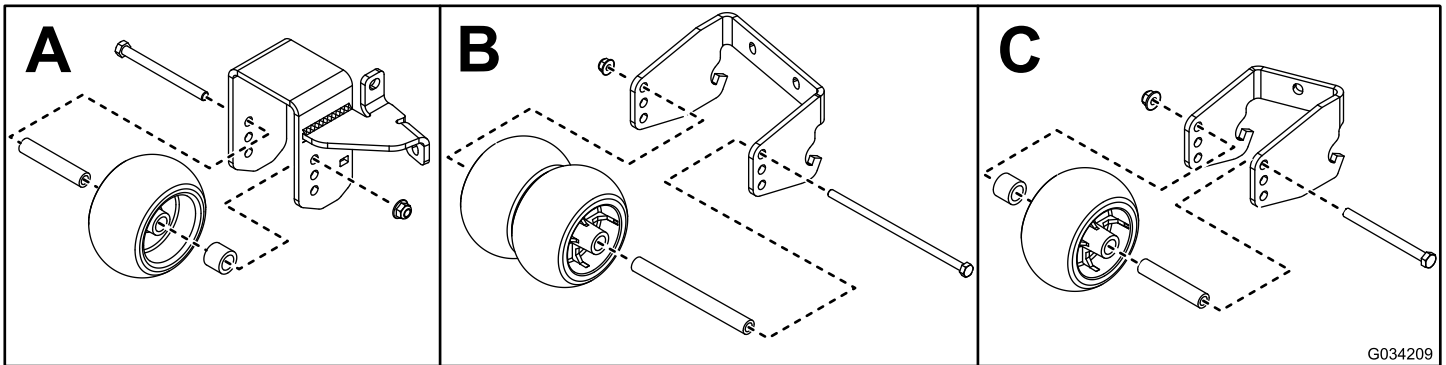

Montage des supports sur le tablier de coupe

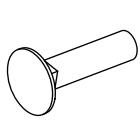

x1

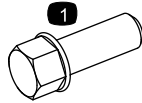

x1

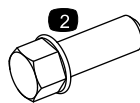

x4



x1



x1

G034210

1. 3/8 x 1-1/4 po

2. 3/8 x 1 po

3. 5/16 po

4. 3/8 po

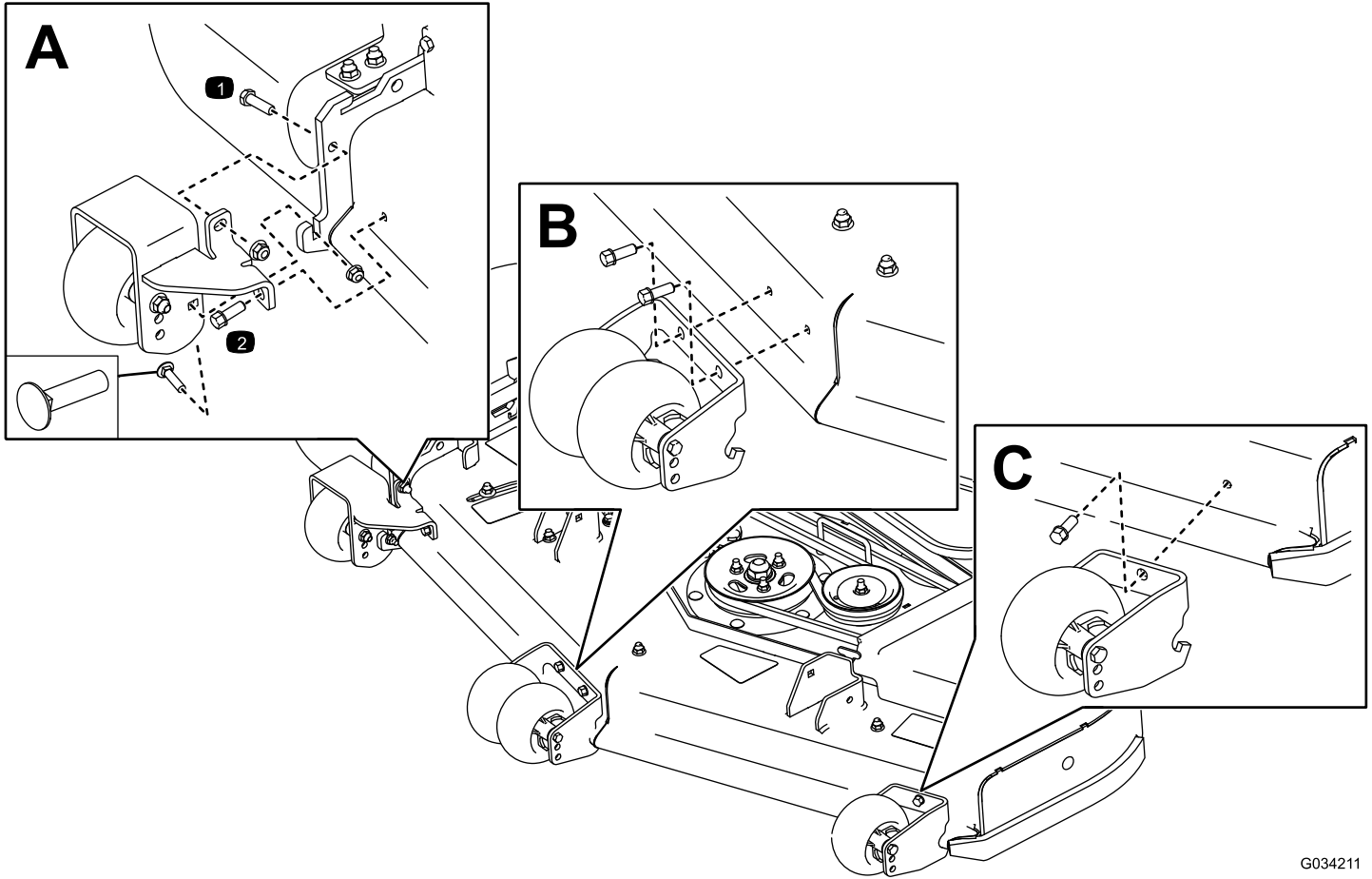

G034211



Count on it.